

Panasonic®

**Owner's Manual
Portable Wireless
Speaker System**

Model No. SC-NJ03



Thank you for purchasing this product. Please read these instructions carefully before using this product, and save this manual for future use.

Register online at www.panasonic.com/register (U.S. customers only)

If you have any questions, visit: U.S.A. and Puerto Rico : www.panasonic.com/support

P

Panasonic Corporation of North America

Two Riverfront Plaza, Newark, NJ 07102-5490
<http://www.panasonic.com>

© Panasonic Corporation 2014
Printed in China



VQT5J47
F0214TA0

IMPORTANT SAFETY INSTRUCTIONS

Read these operating instructions carefully before using the unit. Follow the safety instructions on the unit and the applicable safety instructions listed below. Keep these operating instructions handy for future reference.

- 1 Read these instructions.
- 2 Keep these instructions.
- 3 Heed all warnings.
- 4 Follow all instructions.
- 5 Do not use this apparatus near water.
- 6 Clean only with dry cloth.
- 7 Do not block any ventilation openings. Install in accordance with the manufacturer's instructions.
- 8 Do not install near any heat sources such as radiators, heat registers, stoves, or other apparatus (including amplifiers) that produce heat.
- 9 Do not defeat the safety purpose of the polarized or grounding-type plug. A polarized plug has two blades with one wider than the other. A grounding-type plug has two blades and a third grounding prong. The wide blade or the third prong are provided for your safety. If the provided plug does not fit into your outlet, consult an electrician for replacement of the obsolete outlet.
- 10 Protect the power cord from being walked on or pinched particularly at plugs, convenience receptacles, and the point where they exit from the apparatus.
- 11 Only use attachments/accessories specified by the manufacturer.
- 12 Use only with the cart, stand, tripod, bracket, or table specified by the manufacturer, or sold with the apparatus. When a cart is used, use caution when moving the cart/apparatus combination to avoid injury from tip-over.
- 13 Unplug this apparatus during lightning storms or when unused for long periods of time.
- 14 Refer all servicing to qualified service personnel. Servicing is required when the apparatus has been damaged in any way, such as power-supply cord or plug is damaged, liquid has been spilled or objects have fallen into the apparatus, the apparatus has been exposed to rain or moisture, does not operate normally, or has been dropped.



Precautions

■ **WARNING**

- Unit**
- To reduce the risk of fire, electric shock or product damage,
 - Do not expose this unit to rain, moisture, dripping or splashing.
 - Do not place objects filled with liquids, such as vases, on this unit.
 - Use only the recommended accessories.
 - Do not remove the covers.
 - Do not repair this unit by yourself. Refer servicing to qualified service personnel.

DC cable
The cable is the disconnecting device. Install this unit so that the cable can be unplugged from the USB terminal of PC immediately.

■ **CAUTION**

- Unit**
- Do not throw.
 - Do not hit this unit to anything. Do not apply strong pressure to this unit. External case may break when strong impact is applied, causing to damage or malfunction.
 - Do not leave the unit in a car exposed to direct sunlight for a long period of time with doors and windows closed.
 - Product identification marking is located on the bottom of the unit.
 - Keep the volume knob out of reach of children to prevent swallowing.
 - Do not use this unit continuously with high volume sound. This may deteriorate the sound quality of the speaker and severely shorten the life of the speaker.

- Battery pack (Lithium ion battery pack)**
This unit has a built-in battery. The following is the caution for removing the battery when disposing of this unit.
- Do not heat or expose to flame.
 - Do not short circuit.
 - Do not disassemble, crush.
 - Do not re-use.
 - Do not place in microwave ovens.

Licenses

- Android and Google Play are trademarks of Google Inc.
- The Bluetooth® word mark and logos are owned by the Bluetooth SIG, Inc. and any use of such marks by Panasonic Corporation is under license. Other trademarks and trade names are those of their respective owners.

Accessories

Check the supplied accessories before using this unit.

- **1 DC cable (SFQ0004)**
 - The DC cable is dedicated for this unit, so do not use with other devices.
- **1 Carrying Poach (SFQ0003)**

Note

- Product numbers provided in this Owner's Manual correct as of December 2013. These may be subject to change.

Control reference guide

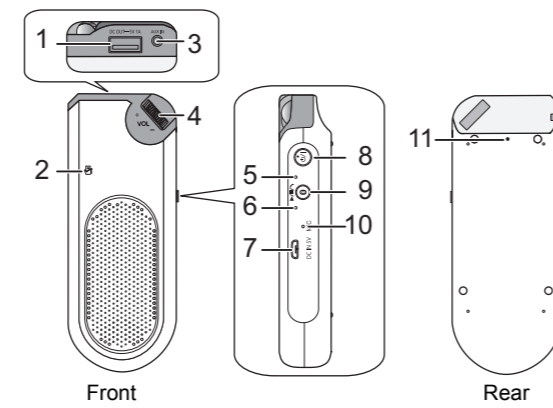

- 1 DC OUT terminal
- 2 NFC touch area
- 3 AUX IN jack
- 4 Volume knob: Adjusts the volume
 - When the maximum or minimum volume is reached, you will be notified by a beep sound.
- 5 Battery indicator (red)
- 6 Bluetooth® indicator (blue)
- 7 DC IN terminal
- 8 Standby/on switch [⏻/⏻]
- 9 Bluetooth® pairing button /Play button/Pause button/Call button [Ⓛ]
- 10 Microphone
- 11 RESET switch [RESET]
 - When this unit does not turn off/on or is not operating correctly in any other way, press the switch by inserting a straightened clip, etc.

Conforms to UL STD 60065.

THE FOLLOWING APPLIES ONLY IN THE U.S.A.

This device complies with Part 15 of FCC Rules. Operation is subject to the following two conditions:
(1) This device may not cause interference, and
(2) This device must accept any interference, including interference that may cause undesired operation of this device.
SC-NJ03
FCC ID:ACJ-SC-NJ03
This equipment complies with FCC radiation exposure limits set forth for an uncontrolled environment and meets the FCC radio frequency (RF) Exposure Guidelines. This equipment has very low levels of RF energy that it deemed to comply without maximum permissive exposure evaluation (MPE). But it is desirable that it should be installed and operated keeping the radiator at least 20 cm or more away from person's body (excluding extremities: hands, wrists, feet and ankles).

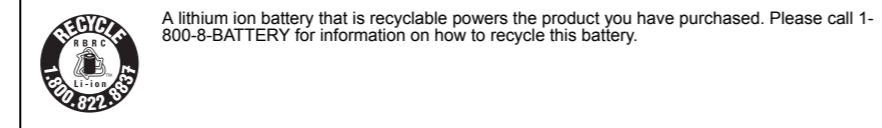

FCC Note:
This equipment has been tested and found to comply with the limits for a Class B digital device, pursuant to Part 15 of the FCC Rules. These limits are designed to provide reasonable protection against harmful interference in a residential installation. This equipment generates, uses and can radiate radio frequency energy and, if not installed and used in accordance with the instructions, may cause harmful interference to radio communications. However, there is no guarantee that interference will not occur in a particular installation. If this equipment does cause harmful interference to radio or television reception, which can be determined by turning the equipment off and on, the user is encouraged to try to correct the interference by one or more of the following measures:

- Reorient or relocate the receiving antenna.
- Increase the separation between the equipment and receiver.
- Connect the equipment into an outlet on a circuit different from that to which the receiver is connected.
- Consult the dealer or an experienced radio/TV technician for help.

FCC Caution: To assure continued compliance, follow the attached installation instructions and use only shielded interface cables when connecting to peripheral devices. Any changes or modifications not expressly approved by the party responsible for compliance could void the user's authority to operate this equipment.

This device complies with Part 15 of the FCC Rules. Operation is subject to the following two conditions:
(1) This device may not cause harmful interference, and
(2) This device must accept any interference received, including interference that may cause undesired operation.

Declaration of Conformity
Trade Name: Panasonic
Model No.: SC-NJ03
Responsible Party:
Panasonic Corporation of North America
Two Riverfront Plaza, Newark, NJ 07102-5490
Support Contact: <http://www.panasonic.com/contactinfo>

About the power of this unit

This unit has a built-in battery. Please charge the battery before using this unit for the first time.

- If the battery level is low when this unit is turned on, the battery indicator (red) blinks.

■ **Charging the battery**

Connect this unit with the power turned off and the PC with the power turned on using the DC cable (supplied).

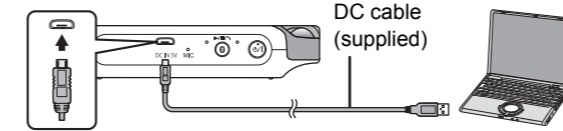

If charging is necessary, the battery indicator (red) lights. When charging is complete, the battery indicator goes off.

Battery Charge time	Approx. 6 hours*1
---------------------	-------------------

*1 When charging at the surrounding temperature of 25 °C (+77 °F) after the battery is depleted

■ **Using this unit with a built-in battery**

Unplugging the DC cable and turning on the power by pressing the [⏻/⏻]. If the battery level is low during use, the battery indicator (red) blinks.

About the battery indicator (red) blinking status when the battery level is low.

Blinking Speed	Battery status
Slow blinking (at approximately 2 second intervals)	About 15%*2
Fast blinking (at approximately 1 second intervals)	About 5%*2

*2 These battery statuses of the unit serve only as an approximation, and may vary according to the conditions of use.

■ **Using and charging by connecting to a PC turned on**

Press [⏻/⏻] to turn this unit on. The Bluetooth® indicator (blue) blinks or lights, and it is possible to operate this unit with the supplied power from a PC.

- The volume will decrease compared with using a built-in battery power, however this does not mean a malfunction with this unit.
- It takes longer to charge while this unit is turned on.

Note

- Do not use any other DC cables except the supplied one. (Operation is not guaranteed.)
- When this unit is not used over a long period of time, charge the built-in battery at least once every six months to prevent it from deteriorating.
- Communication is not possible when this unit is connected to a PC.
- Charging may not start if the battery level is sufficiently high even if it is not full.
- To ensure safety, in the case of an excessive input signal, the system may be automatically interrupted and power is turned off.

Auto Power Off

This unit automatically turns off if there is no audio input and no operation is performed for approximately 10 minutes.

Note

- This function will not operate when the AUX input is used while connected with the DC cable.
- This function may operate even when the music is being played back if the volume of the connected device is low.
- This function may not operate depending on the connected device.
- When the DC OUT terminal is in use, this function will not work.

Listening to audio from a Bluetooth® device

Preparation

Enable the Bluetooth® function of the device you want to connect to, please bring it closer to the unit.

- Use a Bluetooth® device within the approximate range of 10 m (33 ft.) from the unit.
- If you intend to use an NFC (Near Field Communication)-compatible Bluetooth® device, proceed to "One-Touch Connection (Connecting by NFC)".

Connecting via Bluetooth® menu

■ **Pairing with Bluetooth® device**

- 1 Press [⏻/⏻] to turn this unit on.**
The Bluetooth® indicator (blue) blinks slowly.
 - If this unit is being used for the first time (factory preset state):
The Bluetooth® indicator (blue) blinks fast. → The unit will enter pairing standby.
→ Skip to step 3.
- 2 Press and hold [Ⓛ] until the Bluetooth® indicator (blue) blinks fast.**
The unit will enter pairing standby.
- 3 Select "SC-NJ03/NJ40" from the Bluetooth® device's Bluetooth® menu.**
When the Bluetooth® device is paired and connected, the Bluetooth® indicator (blue) on the unit lights up.
 - If prompted for a passkey, input "0000".
 - If the Bluetooth® device need to operate the Bluetooth® pairing setting and the Bluetooth® connecting setting, operate both settings.
 - The Bluetooth® device displays this unit as SC-NJ03/NJ40.
- 4 Start playing back audio on your Bluetooth® device.**
 - The volume can be adjusted by rotating the volume knob of the unit. When the maximum or minimum volume is reached, you will be notified by a beep sound.
 - Press the [Ⓛ] on this unit to play back/stop media.
(If the Bluetooth® device is compatible with AVRCP (profile).

■ **Listening to audio from a paired device**

When this unit is turned on, the Bluetooth® indicator (blue) will blink slowly indicating that the unit is in connection standby mode. Please perform Steps 3 and 4.

- When the power is turned on, this unit is connected to the last-used Bluetooth® device. At this point, please perform Step 4.

One-Touch Connection (Connecting by NFC)

For NFC-compatible Android™ (Ver.4.1 or later) devices only

Just placing an NFC (Near Field Communication)-compatible Bluetooth® device on the unit, you can complete all preparations, from registering a Bluetooth® device to establishing a connection.

Preparation

Turn on the NFC feature of the device.

- 1 Touch and hold your device on the NFC touch area of this unit.
(Until a pop-up window on your device indicates that the connection is established.)**
When the unit recognizes your device, a beep sound is emitted.
 - When the Bluetooth® device is paired and connected, the Bluetooth® indicator (blue) on the unit lights up. Once the registration and connection of the Bluetooth® device is complete, move the device away from the unit.
 - When the Bluetooth® indicator (blue) does not light up even if you have touched the NFC touch area, change the touching position.
- 2 Start playing back audio on your Bluetooth® device.**

■ **Connecting to another device**

If you touch another device to this unit, you can update the Bluetooth® connection. The previously connected device will be disconnected automatically.

Disconnecting Bluetooth®

- Turn off this unit or the device.
- Stop / disable the Bluetooth® transmission of the device.

Note

- This unit can only be connected to one device at a time.
- This unit can register up to 4 devices.
When the number of registered devices exceeds the maximum limit, a device that has not made a Bluetooth® connection for the longest time will be replaced. This will cancel the registration of the device. To use the device again, re-register it.
- If the image and sound are out of sync during playback, restart the playback app you are using. If the problem persists, connect the Bluetooth® device and this unit with an audio cable (commercially-available).
- The One-Touch Connection may not work properly depending on the type of device being used.
- Depending on the specifications and settings of a device, it can fail to connect or some operations can be different.
- Refer to the operating instructions of the Bluetooth® device for details.

