

Panasonic®

Operating Instructions 54" Class 1080p Plasma HDTV (54.1 inches measured diagonally)

Model No. **TC-P54Z1**

Quick Start Guide

(See page 8-24)



- For assistance (U.S.A./Puerto Rico), please call:
1-877-95-VIERA (958-4372)
or visit us at www.panasonic.com/contactinfo
- For assistance (Canada), please call:
1-866-330-0014
or visit us at www.vieraconcierge.ca

Customer's Record

The model number and serial number of this product can be found on its back cover. You should note this serial number in the space provided below and retain this book, plus your purchase receipt, as a permanent record of your purchase to aid in identification in the event of theft or loss, and for Warranty Service purposes.

Model Number _____

Serial Number _____



English

Please read these instructions before operating your set and retain them for future reference.
The images shown in this manual are for illustrative purposes only.

Panasonic Corporation

Web Site: <http://panasonic.net/>

© Panasonic Corporation 2009

Printed in Japan
PBS0109F0

TQBC2488

Turn your own living room into a movie theater!
Experience an amazing level of multimedia excitement

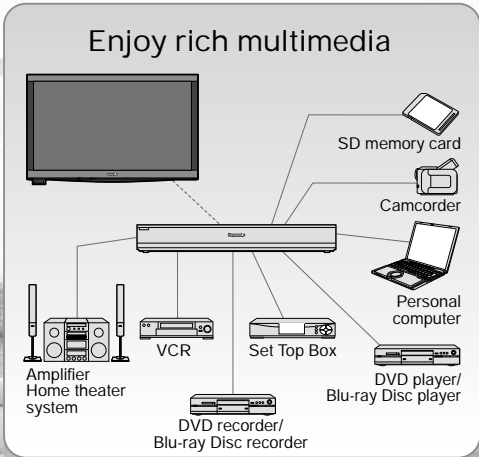

 This product qualifies for ENERGY STAR in the "Home" setting and this is the setting in which energy savings will be achieved. Any modifications to the "Home" setting or other factory default settings could result in greater energy consumption beyond levels that meet ENERGY STAR qualifications.

Contents

Please read before using the unit

- Safety Precautions 4
- Notes 7

Quick Start Guide

- Accessories/Optional Accessory 8
- Basic Connection 15
- Identifying Controls 19
- First Time Setup 21

Enjoy your TV!

Basic Features





- Watching TV 25
- Using VIERA TOOLS 27
- Viewing from an SD Card 28
- Watching Videos and DVDs 32
- VIERA CAST™ 34
- Network Camera 36
- Displaying PC Screen on TV 38

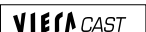

Advanced Features

- How to Use Menu Functions (picture, sound quality, etc.) 40
- VIERA Link™ / HDAVI Control™ 44
- Network setting 50
- VIERA CAST setting 52
- Lock 54
- Editing and Setting Channels 56
- Closed Caption 58
- Input Labels 59
- Using Timer 60
- Remote pairing 61
- Recommended AV Connections 62

FAQs, etc.

- Ratings List for Lock 63
- Technical Information 64
- Care and Cleaning 68
- Specifications 69
- FAQ 70
- Limited Warranty (for U.S.A. and Puerto Rico only) 72
- Customer Services Directory (for U.S.A. and Puerto Rico) 73
- Limited Warranty (for Canada) 74

 VIERA Link™ is a trademark of Panasonic Corporation.	 VIERA CAST™ is a trademark of Panasonic Corporation.	 SDHC Logo is a trademark.
 HDMI, the HDMI logo and High-Definition Multimedia Interface are trademarks or registered trademarks of HDMI Licensing LLC.	Manufactured under license from Dolby Laboratories. Dolby and the double-D symbol are trademarks of Dolby Laboratories.	 www.CE.org/safety

 HD3D Sound Manufactured under license from BBE Sound, Inc.	 High Definition Sound Licensed by BBE Sound, Inc. under one or more of the following US patents: 5510752, 5736897. BBE and BBE symbol are registered trademarks of BBE Sound, Inc.
HDAVI Control™ is a trademark of Panasonic Corporation.	
The WiHD™ logo is licensed for use by WirelessHD, LLC.	

Quick Start Guide

Viewing

Advanced

FAQs, etc.

Safety Precautions



The lightning flash with arrowhead within a triangle is intended to tell the user that parts inside the product are a risk of electric shock to persons.

The exclamation point within a triangle is intended to tell the user that important operating and servicing instructions are in the papers with the appliance.

WARNING: To reduce the risk of fire or electric shock, do not expose this apparatus to rain or moisture. Do not place liquid containers (flower vase, cups, cosmetics, etc.) above the set (including on shelves above, etc.).

Important Safety Instructions

- 1) Read these instructions.
- 2) Keep these instructions.
- 3) Heed all warnings.
- 4) Follow all instructions.
- 5) Do not use this apparatus near water.
- 6) Clean only with dry cloth.
- 7) Do not block any ventilation openings. Install in accordance with the manufacturer's instructions.
- 8) Do not install near any heat sources such as radiators, heat registers, stoves, or other apparatus (including amplifiers) that produce heat.
- 9) Do not defeat the safety purpose of the polarized or grounding-type plug. A polarized plug has two blades with one wider than the other. A grounding type plug has two blades and a third grounding prong. The wide blade or the third prong are provided for your safety. If the provided plug does not fit into your outlet, consult an electrician for replacement of the obsolete outlet.
- 10) Protect the power cord from being walked on or pinched particularly at plugs, convenience receptacles, and the point where they exit from the apparatus.
- 11) Only use attachments / accessories specified by the manufacturer.
- 12) Use only with the cart, stand, tripod, bracket, or table specified by the manufacturer, or sold with the apparatus. When a cart is used, use caution when moving the cart / apparatus combination to avoid injury from tip-over.
- 13) Unplug this apparatus during lightning storms or when unused for long periods of time.
- 14) Refer all servicing to qualified service personnel. Servicing is required when the apparatus has been damaged in any way, such as power-supply cord or plug is damaged, liquid has been spilled or objects have fallen into the apparatus, the apparatus has been exposed to rain or moisture, does not operate normally, or has been dropped.
- 15) To prevent electric shock, ensure the grounding pin on the AC cord power plug is securely connected.



WARNING/CAUTION



Small parts can present choking hazard if accidentally swallowed. Keep small parts away from young children. Discard unneeded small parts and other objects, including packaging materials and plastic bags/sheets to prevent them from being played with by young children, creating the potential risk of suffocation.

- **Set up**
This Plasma TV may fall and can cause personal injury or even death if not installed correctly. To prevent personal injury or death, follow these warnings:
 - Install the Plasma TV in accordance with the manufacturer's recommended pedestal or stand, corresponding hardware and installation instructions. This Plasma TV is for use only with the following optional accessories. Use with any other type of optional accessories may cause instability. The following accessories are manufactured by Panasonic Corporation.
 - Wall-hanging bracket (Vertical) TY-WK5P1SW
 - Be sure to ask a qualified technician to carry out the installation and set-up. Two or more people are required to install or remove the television.

- Some wall mounts (wall-hanging brackets) are not designed to be mounted to walls with steel studs or old cinder block constructions. Ask your dealer or licensed contractor to properly secure the wall-hanging bracket.
- Do not place the Plasma TV or its stand on a sloped or unstable surface. The Plasma TV may fall or tip over.
- Do not support the Plasma TV on a non-specified pedestal.
- Do not place the Plasma TV on furniture that can easily be used as steps, such as a chest of drawers.
- Do not climb or allow children to climb on the Plasma TV
- Place or install the Plasma TV where it cannot be pushed, pulled over or knocked down.
- Route all cords and cables such that they cannot be tripped over or pulled by curious children.
- Do not place any objects on top of the Plasma TV. If water spills onto the Plasma TV or foreign objects get inside it, a short-circuit may occur which could result in fire or electric shock. If any foreign objects get inside the Plasma TV, please consult an Authorized Service Center.

■ AC Power Supply Cord

- To prevent fire or electric shock:
- The Plasma TV is designed to operate on a 120 V AC, 60 Hz service. Insert the power cord plug as far as it will go into the wall socket. If the plug is not fully inserted, heat may generate, which could cause a fire.
 - Do not handle the power cord plug with wet hands.
 - Do not do anything that might damage the power supply cord.
 - When disconnecting the power supply cord, hold the plug, not the cord.

■ Handling the power supply cord

- Insert the power plug fully into the socket outlet. (If the power plug is loose, it could generate heat and cause fire.)
- Ensure that the power plug is easily accessible.
- Ensure the earth pin on the power plug is securely connected to prevent electrical shock.
 - An apparatus with CLASS I construction shall be connected to a power socket outlet with a protective earthing connection.
- Do not touch the power plug with a wet hand. (This may cause electrical shock.)
- Do not use any power cord other than that provided with this TV. (This may cause fire or electrical shock.)
- Do not damage the power cord. (A damaged cord may cause fire or electrical shock.)
 - Do not move the TV with the cord plugged in the socket outlet.
 - Do not place a heavy object on the cord or place the cord near a high-temperature object.
 - Do not twist the cord, bend it excessively, or stretch it.
 - Do not pull on the cord. Hold onto the power plug body when disconnecting cord.
 - Do not use a damaged power plug or socket outlet.

■ Radio waves

- Do not place this TV in any medical institutions or locations with medical devices. Radio waves from this TV may interfere with the medical devices and cause accidents due to the malfunction.
- Do not use this TV near any automatic control devices such as automatic doors or fire alarms. Radio waves from this TV may interfere with the automatic control devices and cause accidents due to the malfunction.
- Keep the RF remote control, Tuner Box and Wireless Unit away at least 8.7 inches (22 cm) from the location where a cardiac pacemaker is implanted. Radio waves from this TV may interfere with the operation of the pacemaker.
- Do not disassemble the RF remote control, Tuner Box or Wireless Unit. It may cause troubles such as difficulties in communication.

■ If Problems Occur During Use

- If a problem occurs (such as no picture or no sound), or if smoke or an abnormal odor is detected from the Plasma TV, unplug the power supply cord immediately. Continued use of the TV under these conditions might cause a fire or permanent damage to the TV. Have the TV evaluated by an Authorized Service Center. Servicing of the TV by unauthorized personnel is strongly discouraged due to its high voltage.
- If water or an object gets inside the Plasma TV, if the Plasma TV is dropped, or if the enclosure becomes damaged, unplug the power supply cord immediately. A short-circuit may occur, which could cause a fire. Contact an Authorized Service Center for an evaluation.



- Do not cover the ventilation holes. Doing so may cause the Plasma TV to overheat, which can cause a fire or damage to the Plasma TV.
- Leave a space of 3 15/16" (10 cm) or more at the top, left and right, and 2 3/4" (7 cm) or more at the rear.
- When using the pedestal, keep the space between the bottom of the TV and the pedestal or stand surface clear from objects that may obstruct ventilation.

■ When Moving the Plasma TV

- Be sure to disconnect all cables before moving the Plasma TV. Moving the TV with its cables attached might damage the cables which, in turn, can cause fire or electric shock
- To prevent an electric shock, disconnect the power plug from the wall outlet as a safety precaution before carrying out any cleaning.
- Transport only in upright position. Transporting the unit with its display panel facing upright or downward may cause damage to the internal circuitry.
- Using a dry cloth, clean any dust from the power supply cord and plug regularly. Build-up of dust on the power cord plug can increase humidity, which might damage the insulation and cause a fire. This Plasma TV radiates infrared rays; therefore, it may affect other infrared communication equipment. Install your infrared sensor in a place away from direct or reflected light from your Plasma TV. The TV will still consume some power as long as the power supply cord is connected to the wall outlet.
- Display panel is made of glass. Do not apply strong force or impact to the display panel. This may cause damage resulting in injury.
- The TV is heavy. TV should be handled by 2 or more people. Support as shown to avoid injury by the TV tipping or falling. When the Wireless Unit (Receiver) is attached, do not hold it.

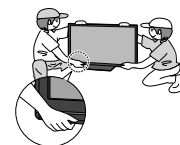

Safety Precautions (Continued)

FCC STATEMENT

FCC RF Exposure Warning:

- This product contains wireless transmitter that complies with FCC radiation exposure limits set forth for an uncontrolled environment.
- This product's internal mounted wireless transmitter must not be installed or operated within 20 cm (8 inches) spacing between all person's body (excluding extremities of hands, wrist and feet for RF remote control) and other outside wireless transmitters.
- This product's wireless transmitter must not be co-located or operated with any other antenna or transmitter.

This equipment has been tested and found to comply with the limits for a Class B digital device, pursuant to Part 15 of the FCC Rules. These limits are designed to provide reasonable protection against harmful interference in a residential installation. This equipment generates, uses and can radiate radio frequency energy and, if not installed and used in accordance with the instructions, may cause harmful interference to radio communications. However, there is no guarantee that interference will not occur in a particular installation. If this equipment does cause harmful interference to radio or television reception, which can be determined by turning the equipment off and on, the user is encouraged to try to correct the interference by one or more of the following measures:

- Reorient or relocate the receiving antenna.
- Increase the separation between the equipment and receiver.
- Connect the equipment into an outlet on a circuit different from that to which the receiver is connected.
- Consult the dealer or an experienced radio/TV technician for help.

This device complies with Part 15 of the FCC Rules and RSS-210 of Industry Canada. Operation is subject to the following two conditions: (1) This device may not cause harmful interference, and (2) this device must accept any interference received, including interference that may cause undesired operation.

FCC Caution:

To assure continued compliance, follow the attached installation instructions and use only shielded interface cables when connecting to computer or peripheral devices. Any changes or modifications not expressly approved by Panasonic Corp. of North America could void the user's authority to operate this device.

FCC Declaration of Conformity
Model No. TC-P54Z1

Responsible Party: Panasonic Corporation of North America
One Panasonic Way, Secaucus, NJ 07094
Contact Source: Panasonic Consumer Electronics Company
1-877-95-VIERA (958-4372)
email: consumerproducts@panasonic.com

CANADIAN NOTICE: For Model TC-P54Z1

This Class B digital apparatus complies with Canadian ICES-003.



WARNING

CEA CHILD SAFETY NOTICES: Flat panel displays are not always supported on the proper stands or installed according to the manufacturer's recommendations. Flat panel displays that are inappropriately situated on dressers, bookcases, shelves, desks, speakers, chests or carts may fall over and may cause personal injury or even death.

The consumer electronics industry (of which Panasonic is a member) is committed to making home entertainment enjoyable and safe. To prevent personal injury or death, be sure to follow the following safety guidelines:

TUNE INTO SAFETY:

- One size does NOT fit all. Follow the manufacturer's recommendations for the safe installation and use of your flat panel display.
- Carefully read and understand all enclosed instructions for proper use of this product.
- Don't allow children to climb on or play with furniture and television sets.
- Don't place flat panel displays on furniture that can easily be used as steps, such as a chest of drawers.
- Remember that children can become excited while watching a program, especially on "larger than life" flat panel displays. Care should be taken to install the display where it cannot be pushed, pulled over, or knocked down.
- Care should be taken to route all cords and cables connected to the flat panel display so that they cannot be pulled or grabbed by curious children.

WALL MOUNTING: IF YOU DECIDE TO WALL MOUNT YOUR FLAT PANEL DISPLAY, ALWAYS:

- Use a mount that has been recommended by the display manufacturer and/or listed by an independent laboratory (such as UL, CSA, ETL).
- Follow all instructions supplied by the display and wall mount manufacturers.
- If you have any doubts about your ability to safely install your flat panel display, contact your retailer about professional installation.
- Make sure the wall where you are mounting the display is appropriate. Some wall mounts are not designed to be mounted to walls with steel studs or old cinder block construction. If you are unsure, contact a professional installer.
- A minimum of two people are required for installation. Flat panel displays can be heavy.

Panasonic recommends that a qualified installer perform the wall-mount installation. See page 4.

Notes

■ Do not display a still picture for a long time

This causes the image to remain on the plasma screen

("Image retention"). This is not considered a malfunction and is not covered by the warranty.



To prevent "Image retention", the screen saver is automatically activated after a few minutes if no signals are sent or no operations are performed. (p. 71)

Typical still images

- Channel number and other logos
- Image displayed in 4:3 mode
- SD Card photo
- Video game
- Computer image

■ Set up

- Do not place the unit where it's exposed to sunlight or other bright light (including reflections).
- Use of some types of fluorescent lighting may reduce the remote control's transmission range.

Accessories/Optional Accessory

Accessories

✓ Check you have all the items shown.

Accessories

- Remote Control Transmitter
● N2QAYB000005
- Batteries for the Remote Control Transmitter (2)
● AA Battery
- Cleaning cloth
- Pedestal
● TBLX0107
How to assemble (p. 9)
- Tuner Box
● TU-Z100U
- Cable clamer (2)
- Operating Instructions
- Product Registration Card (U.S.A.)
- Quick Setup Guide
- Customer Care Plan Card (U.S.A.)
- Wireless Unit set → p. 11 (Receiver and Transmitter)
- Speaker set → p. 10
- RS232C terminal Specifications

Optional Accessory

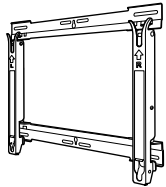

Wall-hanging bracket (vertical)
● TY-WK5P1SW

Note

- In order to maintain the TV's performance and safety, be absolutely sure to ask your dealer or a licensed contractor to secure the wall-hanging brackets.
- Carefully read the instructions accompanying the plasma TV stand or pedestal, and be absolutely sure to take steps to prevent the TV from tipping over.
- Handle the TV carefully during installation since subjecting it to impact or other forces may cause its panel to crack.

Installing the remote's batteries

1

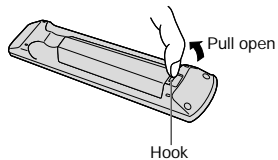

2

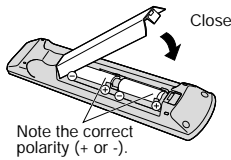

Caution

- Incorrect installation may cause battery leakage and corrosion, resulting in damage to the remote control.
 - Do not mix old and new batteries.
 - Do not mix different battery types (such as alkaline and manganese batteries).
 - Do not use rechargeable (Ni-Cd) batteries.
- Do not burn or break batteries.
- Do not disassemble or modify the remote control.

Attaching the pedestal to TV

Assembling the pedestal

- Be careful not to scratch the surface (part with gloss finish) of the base during assembly
- Remove the cable cover attached to the frame. (It will be used again after the pedestal is attached to the display Unit.)

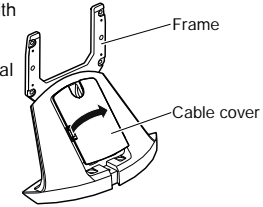

- Fix securely with assembly screws (A). (Total 2 screws)
- Tighten screws firmly (tightening torque: 18 - 20 N·m)

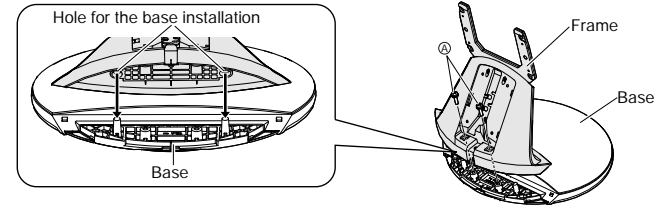

Set-up

① Attach the pedestal to TV

- Slide the pedestal frame posts into the brackets on the back of the TV.
- Fix securely with assembly screws (C). (Total 4 screws)
- Tighten screws firmly (tightening torque: 15 - 18 N·m)

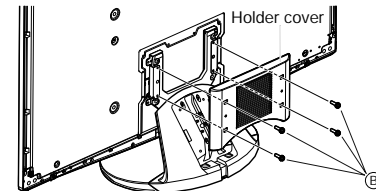
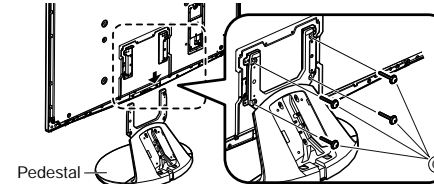

- Attach the Holder cover with assembly screws (B). (Total 4 screws)

② Attach the cable cover

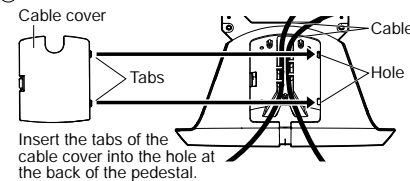

Insert the tabs of the cable cover into the hole at the back of the pedestal.

- Place each cable in the groove at the back of the pedestal and snap the cable cover in.
* The lower part of the groove is separated in right and left. Use the one suitable for you.

Accessories

Assembly screws

- (A) M8 × 30 (Silver) (2)
- (B) M4 × 10 (Black) (4)
- (C) M5 × 25 (Black) (4)

Base (1)



Frame (1)

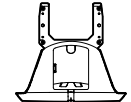

Holder cover (1)

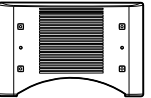

Accessories/Optional Accessory

Attaching the pedestal to TV

Warning

- Do not disassemble or modify the pedestal.
- Otherwise the TV may fall over and become damaged, and personal injury may result.

Caution

- Do not use any other TV and displays.
- Otherwise the TV may fall over and become damaged, and personal injury may result.
 - Do not use the pedestal if it becomes warped or physically damaged.
 - If you use the pedestal when it is physically damaged, personal injury may result. Contact your nearest Panasonic Dealer immediately.
- During set-up, make sure that all screws are securely tightened.
- If sufficient care is not taken to ensure screws are properly tightened during assembly, the pedestal will not be strong enough to support the TV, and it might fall over and become damaged, and personal injury may result.

Attaching the Speaker to TV

- ① Fix the Mounting bracket securely to the back of the Display unit with Assembly screws (total 16 screws).
- ② Insert the speaker mounting screws temporarily in the screw outermost holes of the speaker and fix the speaker mounting screws to the speaker mounting bracket.
 - Orient the front side of the Mounting bracket toward the rear side of the speaker and display Unit side.
 - Fix it same as the speaker at the other side.
 - There will be a gap between the Display Unit and the speaker.

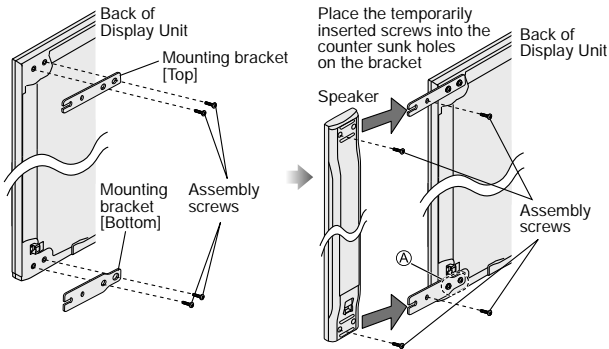

- ③ Connect Display Unit and speaker with speaker cable.
 - Fix it in the same way as the speaker on the other side.

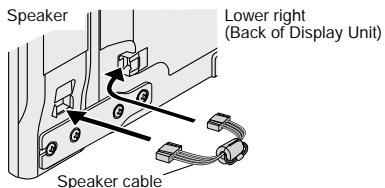

Note

- Tighten the screws firmly.
- Insert to the end of the speaker cable terminal firmly.
- Loosen the screw shown in fig. (A) above to adjust the gap between the speaker and the display Unit.
- Do not hold the speaker to transport the unit.

Accessories

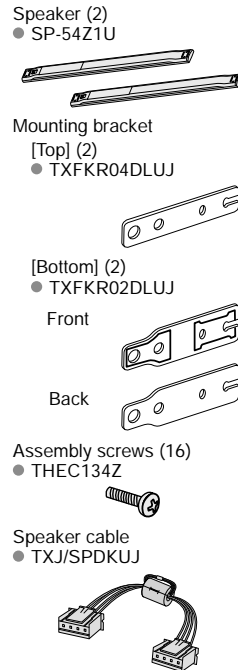

(Continued)

Connecting Display Unit, Tuner Box and Wireless Unit

Wired connection

- Connect Display Unit to Tuner Box

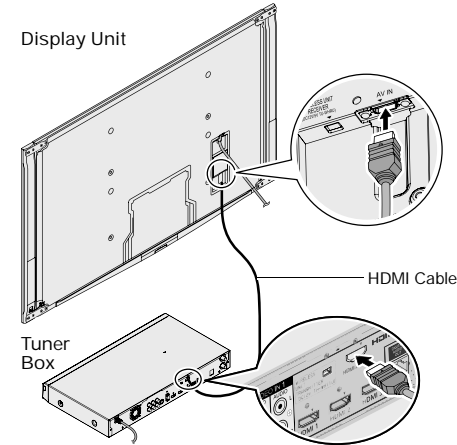

Wireless connection

- Connect Wireless Unit (Receiver) to Display Unit

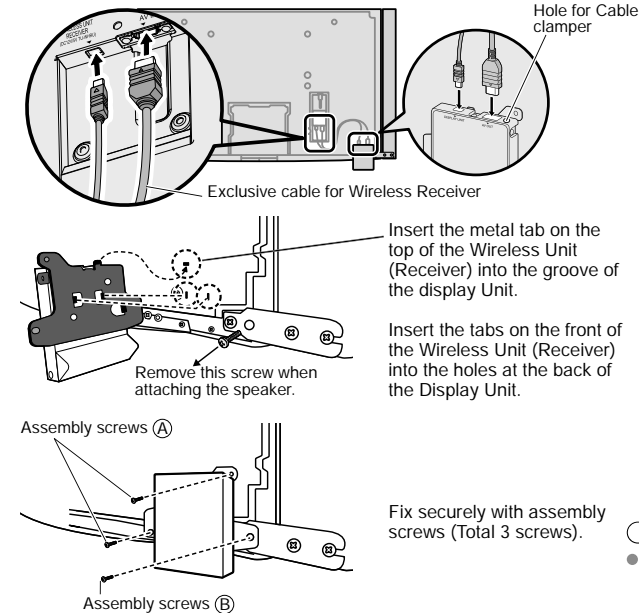

Accessories

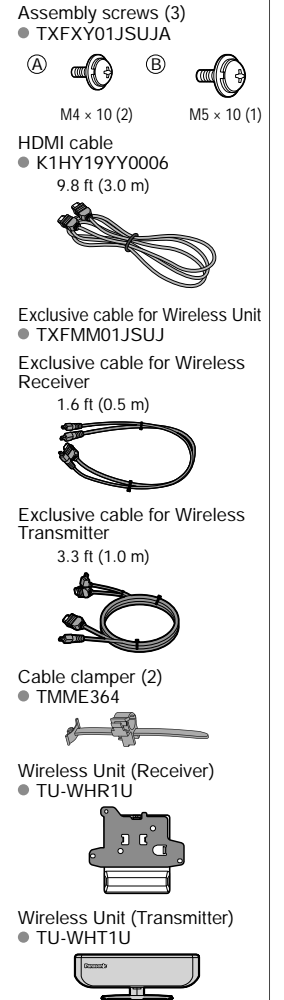

Caution

- Do not disassemble or modify the Wireless Unit.

Accessories/Optional Accessory

- Connect Wireless Unit (Transmitter) to Tuner Box

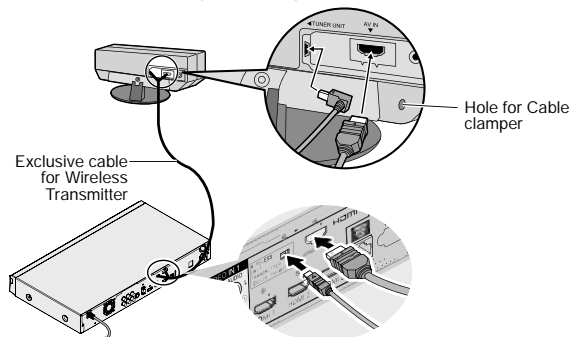

■ Cable Binding for Wireless Unit

- Wireless Unit (Receiver)
- Wireless Unit (Transmitter)

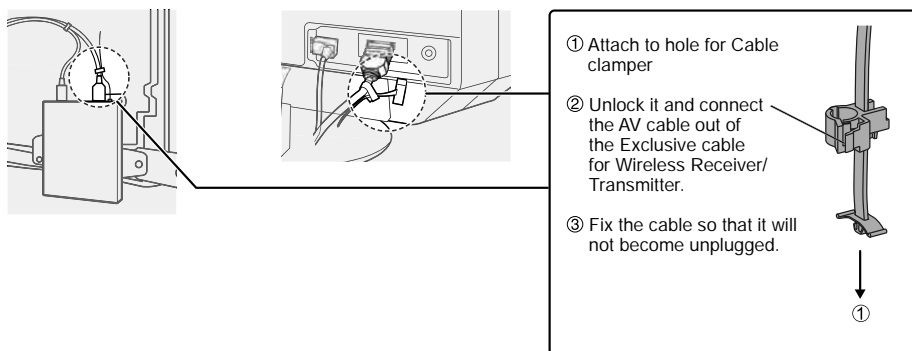

Note

- Do not connect any other device than Wireless Unit to the HDMI terminal of the Display Unit/Tuner Box.
- If the connection is not correct, the following icons will be displayed when the Display unit and the Tuner box are turned on.



This Display Unit is connected to a device other than Tuner Box.

(Continued)

Installing the Display Unit and Tuner Box

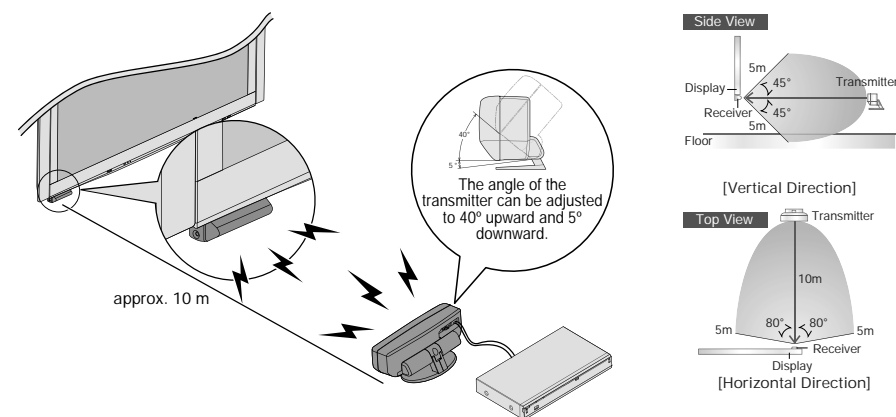

Precautions for Wireless Unit

Transmission Range

Use the Wireless Unit (Transmitter) within a straight line distance of 10 m (approx.) from the Wireless Unit (Receiver). The range may be shortened if there are any obstacles or the surrounding environment or building structure affects the transmission.

Installation Environment

Do not install this apparatus in the following locations to avoid distortion of image or audio or unit failure due to the radio performance degradation.

- Location subject to be high temperature (near the heater etc.)
- Location with poor air circulation (at the end of a closed rack etc.)

In the following cases, the image or audio may be distorted or intermittent, or the apparatus may not operate properly:

- There is a strong obstacle for the radio waves between the Wireless Unit (Transmitter) and Wireless Unit (Receiver). (furniture, AV devices, rack, rack door etc.)
- Wireless Unit (Transmitter) is not facing the Wireless Unit (Receiver).
- Wireless Unit (Transmitter) is placed significantly far from the front of Wireless Unit (Receiver) direction. (Especially in a high position near the TV display, behind the TV, behind the right side of the pedestal)

Interference from Other Devices

If the Wireless Unit (Transmitter)/Wireless Unit (Receiver) is too close to other devices, failures such as malfunction or slow remote control response may occur due to the radio wave interference.

Keep the transmitter away from the following devices as much as possible:

- Wireless LAN, Microwaves, Telephones, Other electric devices

Accessories/Optional Accessory (Continued)

Cable Binding Instructions

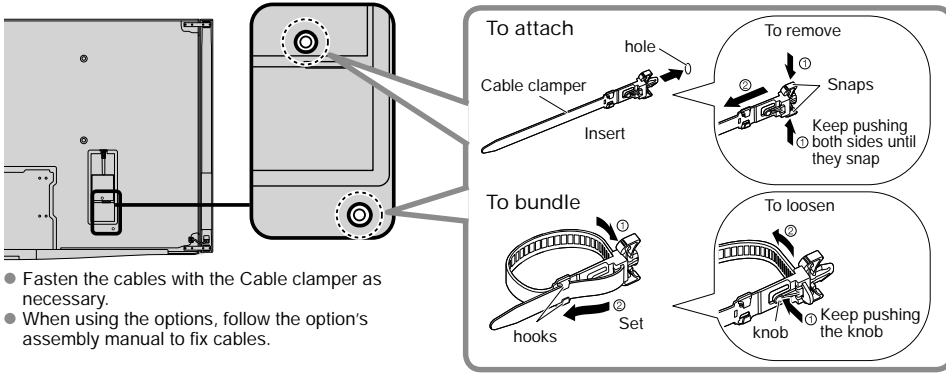

- Fasten the cables with the Cable clasper as necessary.
- When using the options, follow the option's assembly manual to fix cables.

Reference of connection

Antenna terminal



- Firmly tighten by hand.

Pin terminals

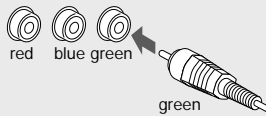

- Match colors of plugs and terminals.
- Insert firmly.

HDMI terminal

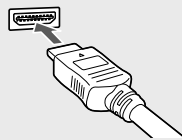

- Insert firmly.

Basic Connection

Example 1 Connecting Antenna (To watch TV)

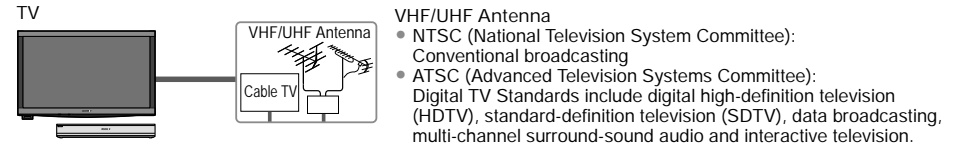

To connect the antenna terminal and Cable Box

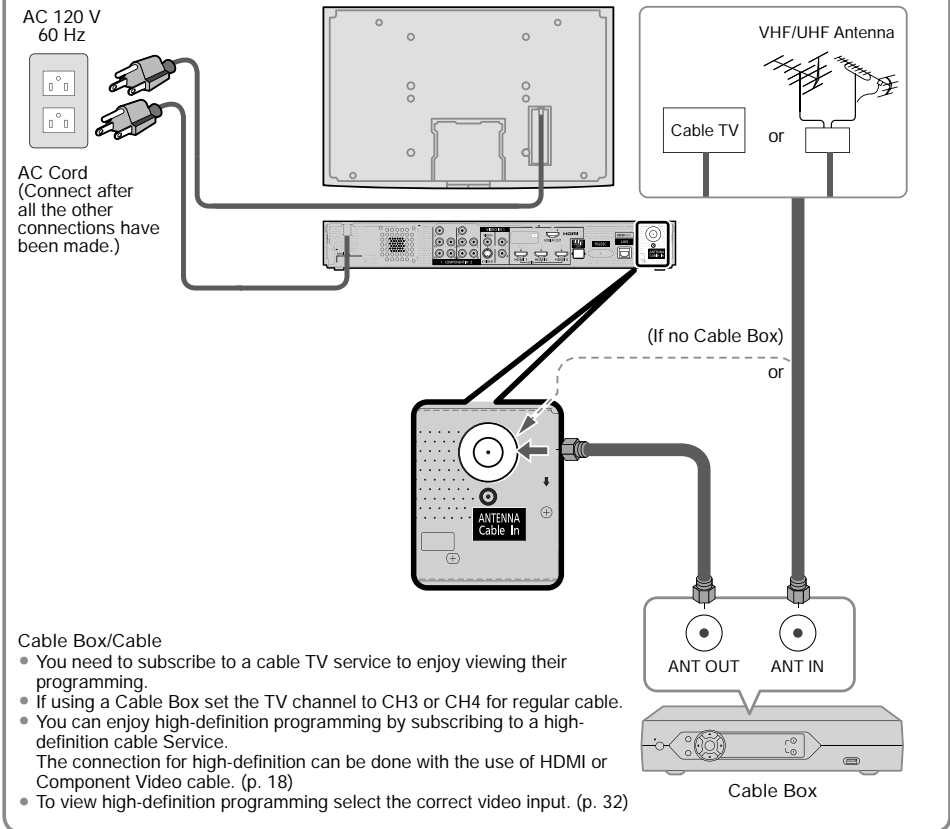

Note

- Not all cables and external equipment shown in this book are supplied with the TV.
- For more details on the external equipment's connections, please refer to the operating manuals for the equipment.
- When disconnecting the power cord, be absolutely sure to disconnect the power cord plug from the wall outlet first.
- For additional assistance, visit us at: www.panasonic.com
www.panasonic.ca

Basic Connection (Continued)

Example 2 Connecting DVD recorder (VCR) (To record/playback)

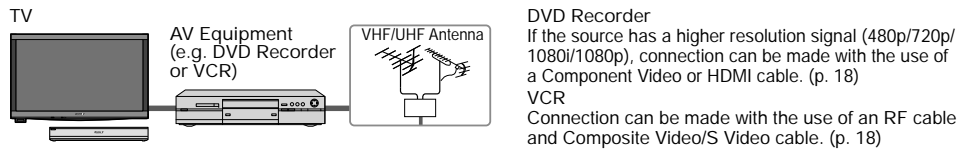

To connect the antenna terminal and DVD recorder or VCR

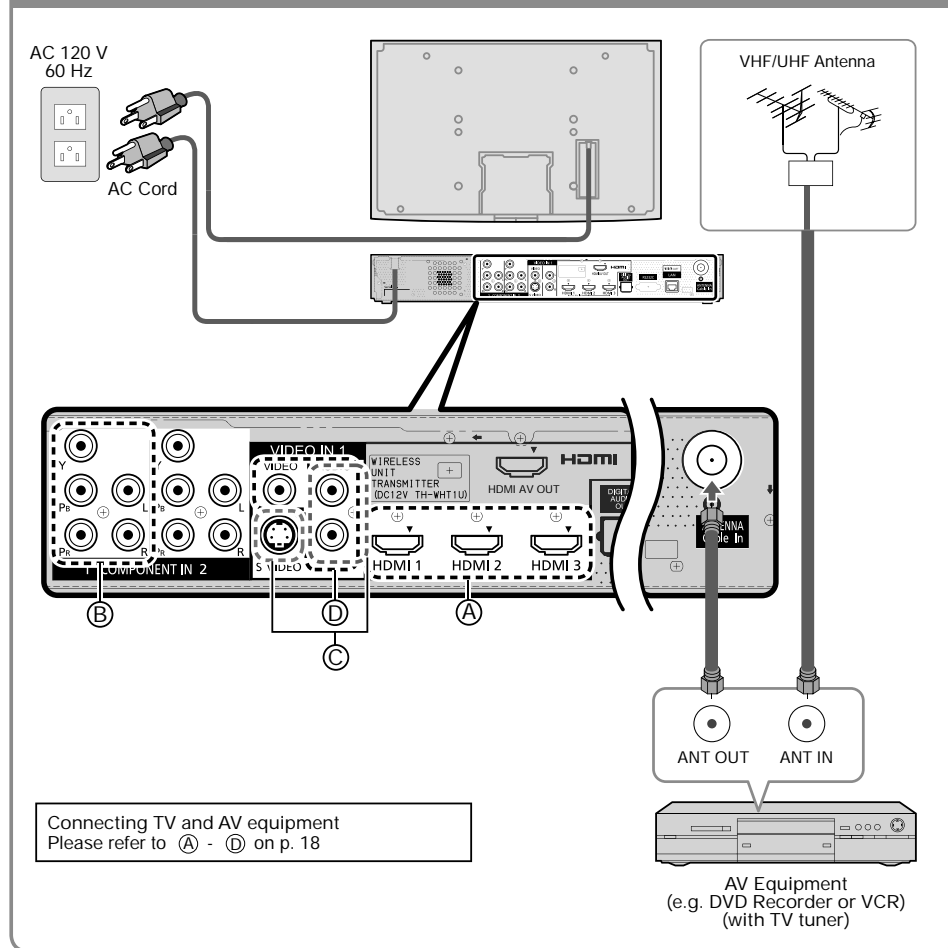

Example 3 Connecting DVD recorder (VCR) and satellite receiver

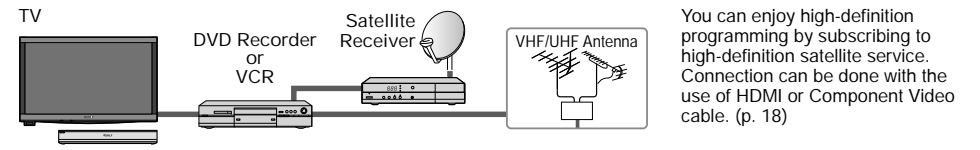

To connect the antenna terminal and Satellite Receiver and DVD recorder or VCR

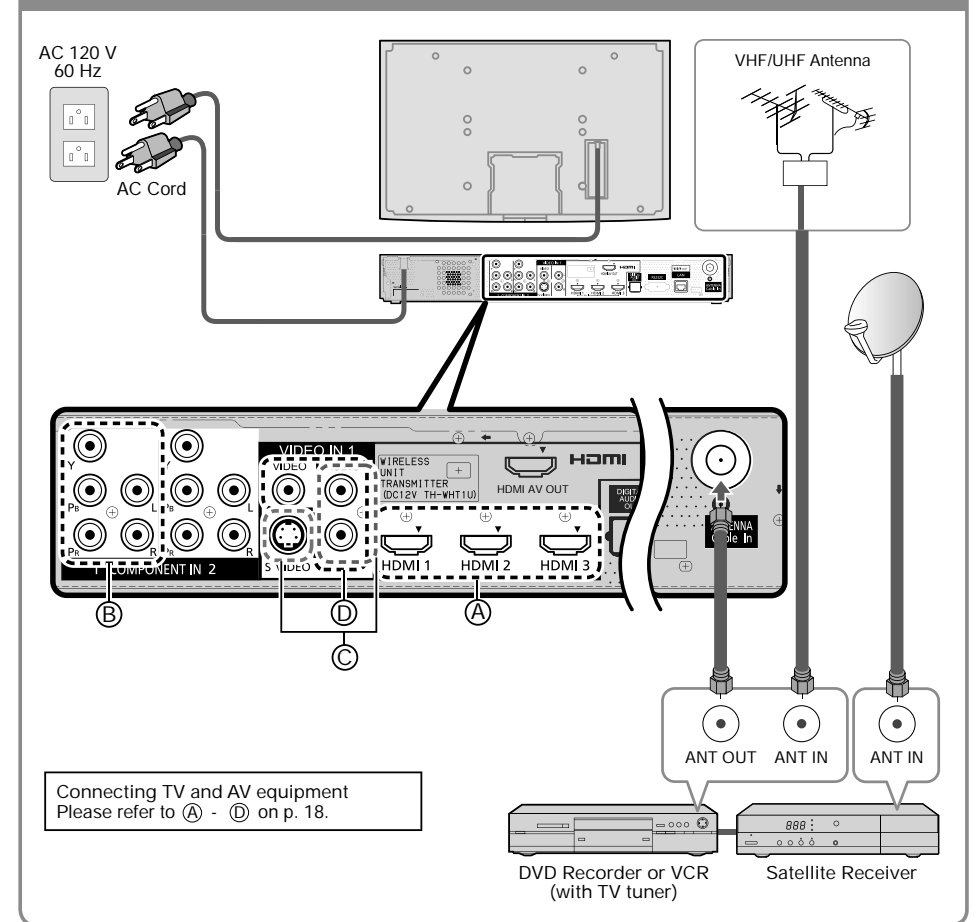

Note

For details of external equipment connections, please refer to the operating manuals for the equipment.

Basic Connection (Continued)

AV cable connections

High-Definition

(A) To use HDMI terminals

AV Equipment
e.g. Blu-ray Disc player

- Connecting to HDMI terminals will enable you to enjoy high-definition digital images and high-quality sound.
- The HDMI connection is required for a 1080p signal.
- For "VIERA Link™ connections", please refer to p. 45.

(B) To use COMPONENT terminals

AV Equipment
e.g. Blu-ray Disc player

- Recorders may also be connected to COMPOSITE or S VIDEO terminals. (see below)

Standard-Definition

(C) To use S VIDEO terminals

AV Equipment
e.g. DVD Recorder
or
e.g. VCR

(D) To use COMPOSITE terminals

AV Equipment
e.g. DVD Recorder
or
e.g. VCR

- The S Video input will override the composite video signal when S Video cable is connected. Connect either S Video or Video cable.
- Connecting to S VIDEO terminals will enable you to enjoy greater picture quality than using Composite terminals.

- Note**
- Some programs contain a copyright protection signal to prevent recording.
 - When the copyright protection program is displayed, do not connect the other TV monitor through a VCR. Video signals fed through VCRs may be affected by copyright protection systems and the picture will be distorted on the other TV monitor.
 - For more details on the external equipment's connections, please refer to the operating manuals for the equipment.

Identifying Controls

TV controls/indicators

Display Unit

Front of Display Unit

Power button
Remote control sensor
C.A.T.S. sensor. (Contrast Automatic Tracking System).

Back of Display Unit

HDMI terminal (For Tuner Box or Wireless Unit connection)
DC terminal (For Wireless Unit connection)

Front of Tuner Box

Power button
Volume up/down
Power indicator (on: red, off: no light)

Selects channels in sequence

Tuner Box

Front of Tuner Box

Power button
Volume up/down
Displays the Main menu.
Selects channels in sequence
HDMI 4 terminal
VIDEO IN 2 terminals
PC terminal
SD card slot
Changes the input mode
Chooses menu and submenu entries.

Back of Tuner Box

DC terminal (For Wireless Unit connection)
HDMI AV OUT terminal (For Display Unit or Wireless Unit connection)

Other terminals → p. 62

Wireless Unit

Front of Wireless Unit (Transmitter)

- Off: Power off
- Red: Power on and no communication
- Green: Power on and communication state good
- Orange: Power on and communication state not good
- Red (blinking): Indicates malfunction

Back of Wireless Unit (Transmitter)

AV terminal (For Tuner Box connection)
DC terminal (For Tuner Box connection)

Front of Wireless Unit (Receiver)

- Off: Power off
- Red: Power on and no communication
- Green: Power on and communication state good
- Red (blinking): Indicates malfunction

Back of Wireless Unit (Receiver)

AV terminal (For Display Unit connection)
DC terminal (For Display Unit connection)

- When the red LED is blinking, unplug the Exclusive cable for Wireless Receiver /Transmitter and consult your local Panasonic dealer.

Quick Start
● Identifying Controls
● Basic Connection (AV cable connections)

Identifying Controls (Continued)

Remote control

This TV uses a RF remote control.

The remote control is operable when it is not facing the Display Unit or Tuner Box.

As the radio waves reflect on walls or other obstacles, the remote control is operable even there are obstacles between the remote control and the Tuner Box.

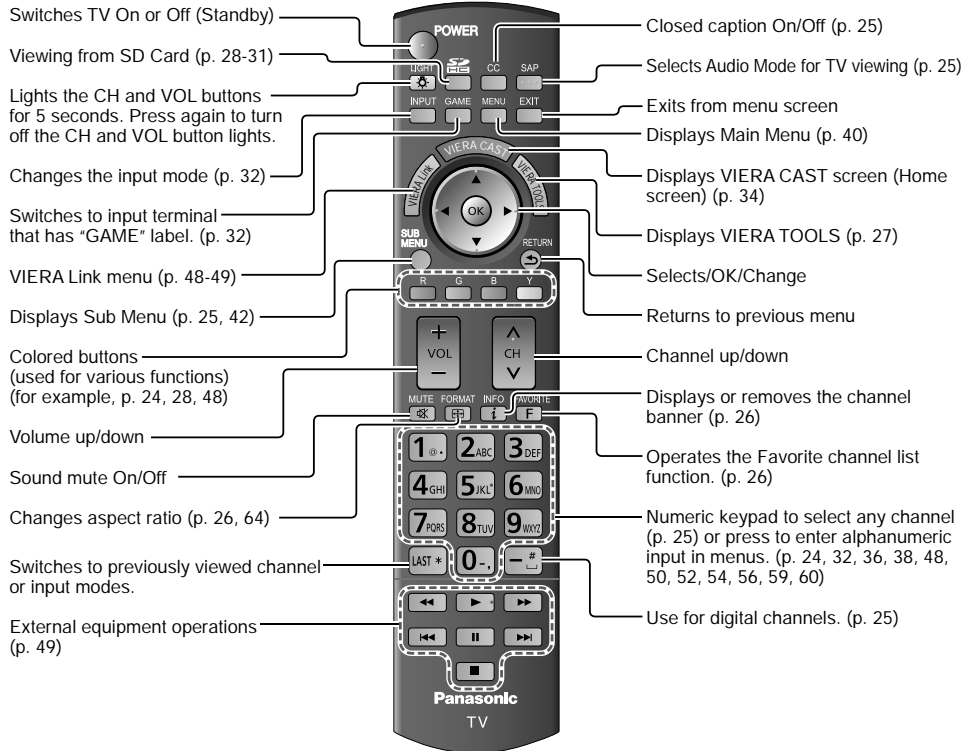

Transmission Range

Use the RF remote control within the range of 7 m from the TV tuner.

The range may be shortened if there are any obstacles or the surrounding environment or building structure affects the transmission.

Interference from Other Devices

If the TV tuner is too close to another device, failures such as malfunction or slow remote control response may occur due to the radio wave interference.

Keep the transmitter away from the following devices as much as possible:

- Wireless LAN, Microwaves, Telephones, Other electric devices

First Time Setup (Remote registration)

Make sure to register your remote control with the following procedure when the TV is turned on for the first time.

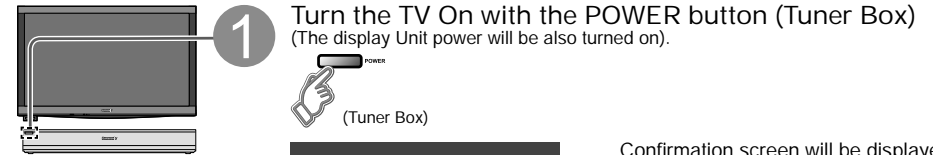

1 Turn the TV On with the POWER button (Tuner Box)
(The display Unit power will be also turned on).



Confirmation screen will be displayed.

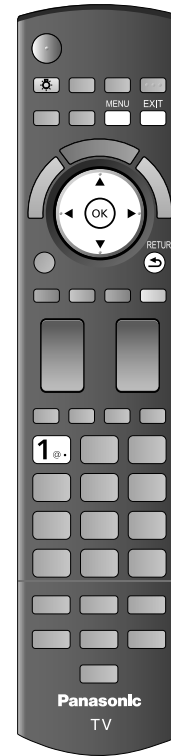

2 Press the 'OK' button and the '1' button
● If there is no registered remote control, the "Remote registration" screen is displayed every time the TV is turned on.

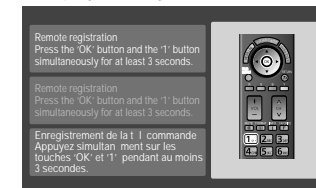

Error or Time out (30 sec)

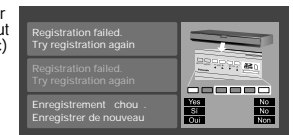

Select "Yes"

You can also go to step ③ selecting "No". (Use control panel of Tuner Box, when Remote control is not available)

Succeed

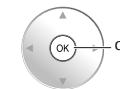
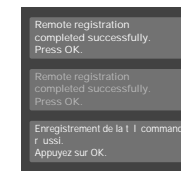

- Remote registration ▶ (p. 61)

Technical Information (Continued)

PC Input Terminals Connection

- Computer signals which can be input are those with a horizontal scanning frequency of 15 to 110 kHz and vertical scanning frequency of 48 to 120 Hz. (However, the image will not be displayed properly if the signals exceed 1,200 lines.)
- Some PC models cannot be connected to the set.
- There is no need to use an adapter for computers with IBM PC/AT compatible D-sub 15P terminal.
- The maximum resolution: 1,280 × 1,024
- If the display resolution exceeds these maximums, it may not be possible to show fine detail with sufficient clarity.
- Signal Names for D-sub 15P Connector

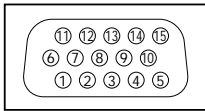

Pin Layout for PC Input Terminal

Pin No.	Signal Name	Pin No.	Signal Name	Pin No.	Signal Name
①	R	⑥	GND (Ground)	⑪	NC (not connected)
②	G	⑦	GND (Ground)	⑫	NC
③	B	⑧	GND (Ground)	⑬	HD/SYNC
④	NC (not connected)	⑨	NC (not connected)	⑭	VD
⑤	GND (Ground)	⑩	GND (Ground)	⑮	NC

Care and Cleaning

First, unplug the Power cord plug from the wall outlet.

Display panel

The front of the display panel has been specially treated. Wipe the panel surface gently using only a cleaning cloth or a soft, lint-free cloth.

- If the surface is particularly dirty, soak a soft, lint-free cloth in diluted mild liquid dish soap (1 part mild liquid dish soap diluted by 100 times the amount of water) and then wring the cloth to remove excess liquid. Use this cloth to wipe the surface of the display panel, then wipe it evenly with a dry cloth of the same type until the surface is dry.
- Do not scratch or hit the surface of the panel with fingernails or other hard objects. Furthermore, avoid contact with volatile substances such as insect sprays, solvents, and thinner; otherwise, the quality of the surface may be adversely affected.

Cabinet

If the cabinet becomes dirty, wipe it with a soft, dry cloth.

- If the cabinet is particularly dirty, soak the cloth in a weak mild liquid dish soap and then wring the cloth dry. Use this cloth to wipe the cabinet and then wipe it dry with a dry cloth.
- Do not allow any mild liquid dish soap to come into direct contact with the surface of the Plasma TV.
- If water droplets get inside the unit, operating problems may result.
- Avoid contact with volatile substances such as insect sprays, solvents, and thinner; otherwise, the quality of the cabinet surface may be adversely affected or the coating may peel off. Furthermore, do not leave it for long periods in contact with articles made from rubber or PVC.

Pedestal

Cleaning

- Wipe the surfaces with a soft, dry cloth. If the unit is particularly dirty, clean it using a cloth soaked with water to which a small amount of mild liquid dish soap has been added and then wipe with a dry cloth.
- Do not use products such as solvents, thinner, or household wax for cleaning, as they can damage the surface coating. (If using a chemically-treated cloth, follow the instructions supplied with the cloth.)
- Do not attach sticky tape or labels, as they can make the surface of the pedestal dirty. Do not allow long-term contact with rubber, vinyl products, or the like. (Doing so will cause deterioration.)

Wireless Unit

- Wipe the glossy surface of Transmitter and Receiver gently with the Cleaning cloth (included).

Specifications

		TC-P54Z1
Power Source	AC 120 V, 60 Hz	
Power Consumption	Maximum	Display Unit: *** W / Tuner Box: *** W (Wireless Unit (Receiver) 12 W / Wireless Unit (Transmitter) 10 W)
	Standby condition	Display Unit: ** W / Tuner Box: * W
Plasma Display panel	Drive method	AC type
	Aspect Ratio	16:9
	Visible screen size (W × H × Diagonal) (No. of pixels)	54" class (54.1 inches measured diagonally) 47.1" × 26.5" × 54.1" (1,198 mm × 673 mm × 1,473 mm) 2,073,600 (1,920 (W) × 1,080 (H)) [5,760 × 1,080 dots]
Sound	Audio Output 20 W [(3 W + 7 W) × 2] (10 % THD)	
PC signals	VGA, SVGA, XGA, WXGA, SXGA Horizontal scanning frequency 31 - 69 kHz Vertical scanning frequency 59 - 86 Hz	
Channel Capability (Digital/Analog)	VHF/UHF: 2 - 69, CATV: 1 - 135	
Operating Conditions	Temperature: 32 °F - 104 °F (0 °C - 40 °C) Humidity: 20 % - 80 % RH (non-condensing)	
Connection terminals	VIDEO IN 1	VIDEO: RCA PIN Type × 1 1.0 V [p-p] (75 Ω) S-VIDEO: Mini DIN 4-pin Y: 1.0 V [p-p] (75 Ω) AUDIO L-R: RCA PIN Type × 2 0.5 V [rms]
	VIDEO IN 2	VIDEO: RCA PIN Type × 1 1.0 V [p-p] (75 Ω) AUDIO L-R: RCA PIN Type × 2 0.5 V [rms]
	COMPONENT IN 1-2	Y: 1.0 V [p-p] (including synchronization) Pb, Pr: ±0.35 V [p-p] AUDIO L-R: RCA PIN Type × 2 0.5 V [rms]
	HDMI 1-4	TYPE A Connector × 4 * This TV supports *HDMI Control 4* function.
	PC	D-SUB 15PIN: R,G,B / 0.7 V [p-p] (75 Ω) HD, VD / 1.0 - 5.0 V [p-p] (high impedance)
	RS232C (Serial)	D-sub 9pin for external control
	LAN (for VIERA CAST IPTV)	RJ45 (10BASE-T/100BASE-TX)
	Card slot	SD CARD slot × 1
AUDIO OUT	AUDIO L-R: RCA PIN Type × 2 0.5 V [rms]	
DIGITAL AUDIO OUT	PCM / Dolby Digital, Fiber Optic	
FEATURES	3D Y/C FILTER CLOSED CAPTION V-Chip IPTV (VIERA CAST) Photo viewer Movie player HDAVI Control 4	
Dimensions (W × H × D)	Display Unit Including pedestal	56.3" × 35.2" × 15.0" (1,428 mm × 893 mm × 379 mm)
	Display Unit only	56.3" × 32.3" × 1.0" (1,428 mm × 820 mm × 25 mm)
Mass	Tuner Box	17.0" × 2.4" × 9.8" (430 mm × 59 mm × 240 mm)
	Wireless Unit (Transmitter)	7.5" × 2.8" × 2.8" (190 mm × 69 mm × 70 mm)
	Wireless Unit (Receiver)	5.8" × 5.3" × 1.9" (146 mm × 133 mm × 46 mm)
	Display Unit	83.8 lb (38.0 kg)
	Display Unit only	70.6 lb (32.0 kg)
	Tuner Box	6.7 lb (3.0 kg)
	Wireless Unit (Transmitter)	0.7 lb (280 g)
	Wireless Unit (Receiver)	0.9 lb (400 g)

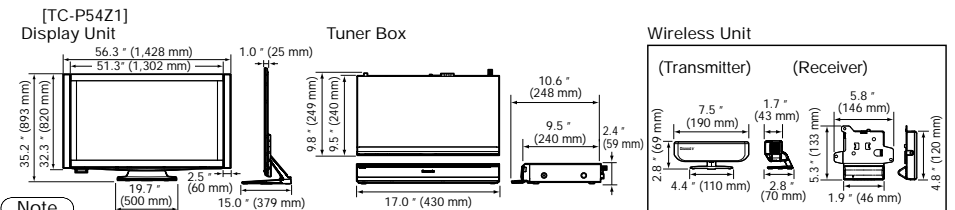

Note

- Design and Specifications are subject to change without notice. Mass and Dimensions shown are approximate.
- Dimensions and Mass are the values for a speaker installation.