

PANDIGITAL

PHOTOLINK Scanner



User Guide

Table of Contents

Table of Contents	2
Read This First	4
What's In the Box	6
Introduction	7
PHOTOLINK Scanner Diagram	7
Front view	7
Rear view	8
Scanner Indicator Lights	9
Operating the Scanner	10
Initial Setup.....	10
Power on the PHOTOLINK Scanner	11
Scan a Photo	11
Suitable and Unsuitable Original Types	13
Orientation of the Original and Scanned Image.....	13
Photo Protection Sleeves	14
Image Crop.....	15
Connect PHOTOLINK Scanner to a PC.....	16
System Requirements (for PC)	16
Make Connection to PC	16
Windows Explorer with Microsoft Vista View.....	18
For Windows Vista Users.....	18
For Windows XP Users	19
Safely Disconnect the Scanner from PC.....	20
Scan2PC Manager (Scanner to PC Utility)	21
Installing the Scan2PC Manager.....	21
System Requirements.....	21
Using the Scan2PC Manager.....	22
Supported Memory Cards	23
File Naming and Storage Rules.....	24
Scanner Maintenance.....	24
Cleaning the PHOTOLINK Scanner	24
Cleaning the Roller.....	25

Cleaning the Image Sensor..... 26
Calibrate the **PHOTOLINK** Scanner..... 27
Storing the **PHOTOLINK** Scanner..... 27
Technical Specifications 28
Frequently Asked Questions/ Troubleshooting 29
Limited Warranty..... 30
FCC Statement..... 31

Read This First

Please read the following important safety instructions carefully before using the **PHOTOLINK** Scanner. Failure to observe these instructions may result in personal injuries or damages to this scanner.

Important Safety Precautions

Always follow these basic safety precautions when using your **PHOTOLINK** Scanner. This will reduce the risk of fire, electric shock, and injury.



Do not place this scanner under direct sunlight or near heat sources, such as in a closed car under sunlight or near a stove. The outer casing of this scanner may become deformed and the sophisticated sensors inside may become damaged due to excessive heat.



Do not use this scanner near water, in the rain or allow any liquid to get inside this product. Water and moisture may cause short-circuit to the electronic components and lead to malfunctions.



Do not use this scanner in dusty environments. Dust grains may cover this scanner and scratch the original to be scanned. Do not scan originals that are contaminated by dusts or other particles.



Do not use this scanner near strong electromagnetic sources, such as a microwave oven or television. The electromagnetic interference may cause this scanner to malfunction.



Do not attempt to disassemble or modify this scanner. There are no user serviceable parts inside this scanner, and unauthorized modifications will void your warranty.



Do not drop or apply shock/vibration to this scanner. Strong impacts may damage the components inside.



Do not insert objects other than compatible memory cards into the memory card slots of this scanner. The metal contacts inside the slots can easily become damaged by foreign objects.



Do not use an unknown power adapter other than the one supplied with this scanner. Connecting this scanner to an unknown power adapter is very dangerous and may lead to fire or explosion.



Do not cut, bend, modify, place heavy objects or step on the cable of the power adapter. Otherwise the external insulation may be damaged and result in short-circuit or fire.



The power connector and USB port on this scanner are designed solely for connecting to the supplied power adapter and optional USB cable. Do not insert any other objects into these sockets.



If there are strange odors or heat emitting from this scanner or any signs of malfunction, disconnect this scanner from the power immediately and contact your dealer for inspection or service.

Disclaimer

Pandigital reserves the right to revise this publication and to make changes from time to time in the contents thereof without obligation to notify any person of such revision or changes.

Copyright

Copyright Pandigital. All rights reserved. No part of this publication may be reproduced, transmitted, transcribed, stored in a retrieval system or translated into any language or computer language, in any form or by any means, electronic, mechanical, magnetic, optical, chemical, manual or otherwise, without the prior written permission of Pandigital. **PHOTOLINK** One Touch Scanner – product names and trademarks used in this publication are the properties of their respective owners.

Notes about copyrighted materials

Avoid scanning and re-distributing copyrighted originals and images or those of *unknown* sources. Doing so may violate your local copyright laws and related regulations. Pandigital cannot be made liable for the losses that may result from breaching the laws described above.

Disposal of this product

To help protect the environment, dispose of this scanner properly according to your local regulations regarding the disposal of waste products.

What's In the Box

Check the package for the following items. If there is any item missing or damaged, please contact your place of purchase immediately.

- **PHOTOLINK** Photo Scanner
- AC Power Adapter
- Printed User Guide and Warranty Card
- SD Memory Card (*contains SCAN2PC Manager & Installation Guide, and User Guides in English, French, & Spanish*)
- Calibration Card
- Two Plastic Protection Sleeves
- Roller Cleaning Sheet
- Sensor Cleaning Swab
- USB Cable

Introduction

Welcome to the Pandigital Multimedia **PHOTOLINK** Scanner! Now you can scan your printed photos and store them into your memory card, no computer is necessary. Simply insert a memory card into the **PHOTOLINK** Scanner, and power on. When the unit is ready, feed your printed photo into the **PHOTOLINK** Scanner and your pictures will be stored in the memory card. It's as easy as that.

If you do want to store your photos directly into your PC, it's just as easy via a USB cable.

PHOTOLINK Scanner Diagram

Front view

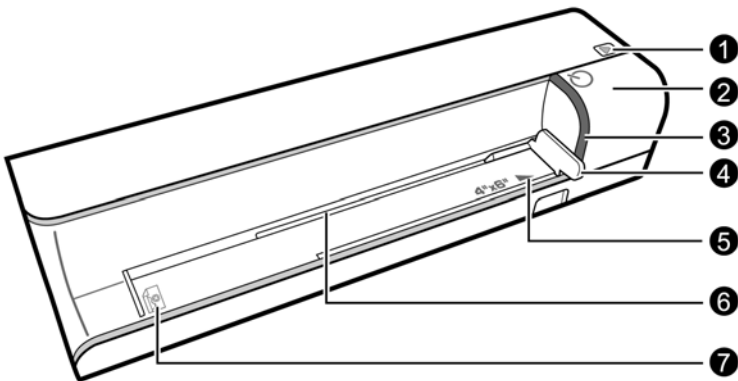

No.	Name	Function/ Description
①	Status/ Card Indicator Light	Indicates the operating status of the scanner and memory card. (Refer to "Indicator Lights" on page 9.)
②	Power Button	Press to power on or off. Press and hold this button for 5 seconds to enter cleaning mode. (Refer to "Cleaning the scanner" on page 24.)

No.	Name	Function/ Description
③	Power Indicator	Indicates the power status of the scanner. (Refer to "Indicator Lights" on page 9.)
④	Paper Guide Slide	Slide the guide to adjust for smaller than 4x6" originals to ensure the proper alignment.
⑤	4x6" insert Marker	Insert a 4x6" original against the right side of slot for proper alignment.
⑥	Feeding Slot	Insert an original photo into this slot to begin scanning.
⑦	Orientation guide	Indicates the correct position and orientation of the original for proper scanning.

Rear view

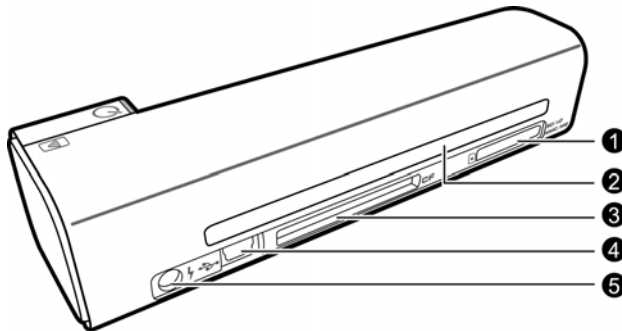

No.	Name	Function/ Description
①	SD/xD/MMC/MS card slot	Accepts the following types of memory cards: SD, xD, MMC and MS. (Refer to "Supported Memory Cards" on page 23.)
②	Output slot	The scanned original comes out from this slot.
③	CF card slot	Accepts a Type I CF card. (Refer to "Supported Memory Cards" on page 23.)
④	Mini USB connector	For connecting to a computer via a USB cable.
⑤	Power connector	For connecting to the supplied power adapter.

Scanner Indicator Lights

Listed below are the indicator light patterns and the functions they represent:

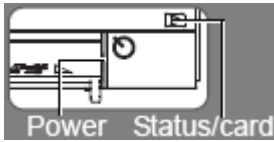

Indicator Lighting Patterns and the Functions they represent	◐	●	Initializing system and memory card. Please wait until the scanner completes the initialization process before using it.
	●	◐	The scanner is ready for use.
	●	●	The scanners power is off.
	◐	◐	<p>Initializing system and memory card. Please wait until the initialization process is complete before using the scanner.</p> <p>Busy scanning and storing image files. Please wait until the process is complete before scanning another original.</p> <p>Sensor cleaning in progress. Please wait until the process is complete before performing any operations.</p>
	✱	✱	Paper jam. Press the Power button. The scanner will advance the original so you can remove the jammed original from the output slot.
	●	✱	No memory card, card full (free space below 1MB), card error or SD card locked. Remove files from the card to free up space, unlock the card if it is locked, or try another card.
<p>◐: Blinking slowly; ✱: Blinking rapidly; ◐: Steadily on; ●: Off;</p>			

Operating the Scanner

Initial Setup



1. Peel off the tape that secures the guide lever (first time only procedure.)
-



2. Connect the plug on the power adapter cable to the power connector on the scanner.
-



3. Plug the power adapter into a power outlet.

 **Note:** The type of power plug and socket illustrated may differ from that of your region.

4. Insert an unlocked (writable) memory card into a suitable memory card slot. If both slots are occupied, the scanner will take the following priority when storing the scanned images:



SD (MMC) > CF > xD > MS/MS Pro/MS Duo

For example, if both SD and CF cards are inserted, the scanner will only store the scanned images onto the SD card.



Notes:

- Always insert a memory card before scanning.
 - Be careful when inserting a CF card. The pins inside the CF memory card slot are subject to damages easily, and such damage is not recoverable and is not covered by the product warranty.
 - The scanner only accepts memory cards in FAT16 or FAT32 format. NTFS and other file formats are not supported.
-

Power on the PHOTOLINK Scanner



1. Press the Power button. The power indicator light blinks.



Note: For more information on the indicator lights, refer to “Indicator Lights” on page 9.



2. Wait until the power indicator stops blinking and then goes off. The Status/ card indicator will light up, indicating that the scanner is ready.



Note: Do not insert an original photo into the feeding slot when the power indicator is blinking. The original photo will not be scanned.

Scan a Photo

1. Insert your photo into one of the plastic protection sleeves (*included with scanner.*)
2. With the side to be scanned facing upward and in correct orientation as indicated by the orientation guide, place one edge of the photo on the scanner and adjust the guide lever so that the photo aligns against the left side of the feeding slot.
3. Insert the photo into the feeding slot.

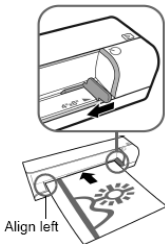

WARNING: Do not scan glossy photos in humid environments (humidity higher than 70% RH); the surface of the photo will become sticky and cause the scanner to jam.

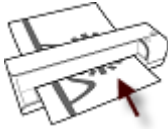

The photo will be fed through the slot and scanned automatically. The Power and Status/card indicator lights blink while scanning.



Note: Refer to page 13 for how to insert photos and other types of originals.



When scanning is completed, the Power and Status/card indicator lights will keep blinking for a while, indicating that the scanner is processing the image and storing the file onto the memory card.

Wait until the indicator lights stop blinking before inserting and scanning the next photo.



WARNING: Insert only one sheet at a time. Insert the next original photo only when the previous one is done. Otherwise the scanner will fail to function properly.



Notes:

- Do not remove the memory card or disconnect the power supply while the indicators are blinking.
 - This scanner only supports output images in JPEG (.jpg) format, and the date/ time attribute will not be added.
 - For more information on how this scanner stores the scanned image files on the memory card, refer to "Orientation" on page 13. If the memory card is near full (lower than 1MB), the status/card indicator blinks (*refer to "Indicator Lights" on page 9*). Use another card or delete some files on it if necessary.
-



1. To power down the scanner after all photos are scanned, press and hold the power button for one second. The power indicator will blink and then go off.
 2. Now it is OK to disconnect the power and remove the memory card from the scanner.
-

Suitable and Unsuitable Original Types

The **PHOTOLINK** Scanner is designed to obtain the best scanning results with the following types of originals:

- 3.5"x5" and 4"x6" photos
- Business cards (1.5mm or thinner)

Do not use the following types of originals for scanning, otherwise the scanner will malfunction or cause the original to jam in the slot.

- Photos/business cards thicker than 1.5mm
- Photos/business cards with either side shorter than 42mm
- Photos/business cards with lots of black or dark colors
- Photos/business cards with dark colors surrounding the edges
- Transparencies (filmstrips, celluloid..., etc.)
- Printed images (pictures on newspapers, magazines..., etc.)
- Soft and thin materials (thin paper, cloth..., etc.)
- Photos/business cards that exceed the following acceptable size:

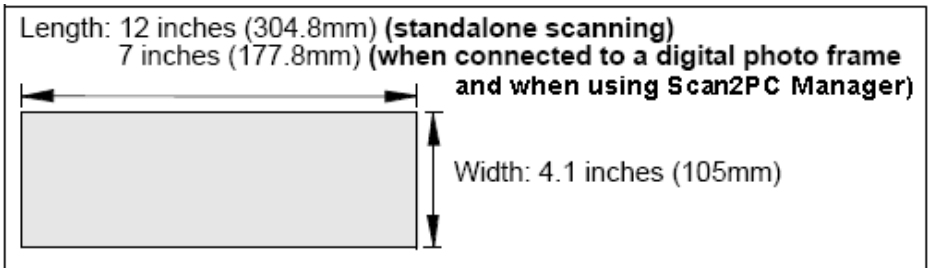

Orientation of the Original and Scanned Image

Refer to the illustrations below for the relationship between the orientation of the original when scanning and that of the scanned image when displayed on the computer screen.

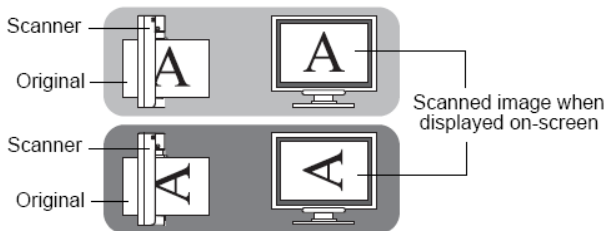
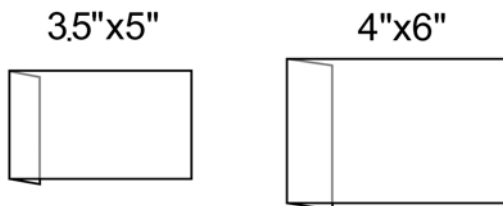

Photo Protection Sleeves

IMPORTANT: To protect your photos, insert your photos into the supplied clear plastic sleeves before scanning your photos.

Included with your **PHOTOLINK** Scanner are two different sized clear plastic protection sleeves: (Please use the supplied 3"x5" and 4"x6" plastic sleeves for matching size photo scanning)



1. Insert the photo into the plastic sleeve as shown below.

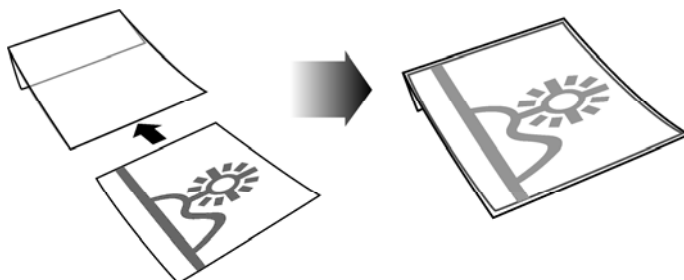

2. Insert the plastic sleeve (with the folded side first) into the feeding slot of the scanner.

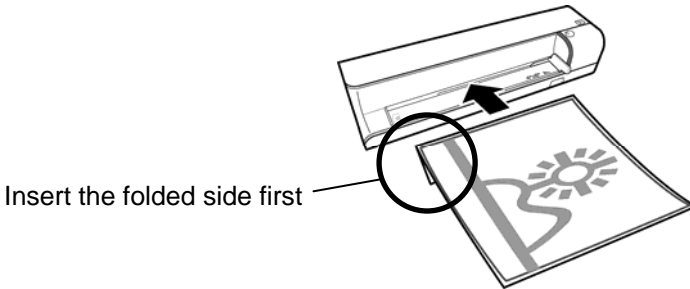

Notes:

- Remove the plastic sheath when scanning none 3.5"x5" or 4"x6" photos to prevent improper auto-cropping function.
- To prevent the photos from getting stuck in the sleeves over time, remove the photos from the plastic sleeve after scanning.
- If the plastic sleeves are not in use, store them in a safe place and keep them protected from accumulating dust.

Image Crop

The **PHOTOLINK** Scanner has a built-in cropping function that detects and automatically crops dark edges of an original as it is scanned. Please refer to the illustration below.

Cropping (about 2mm, as measured on the original)

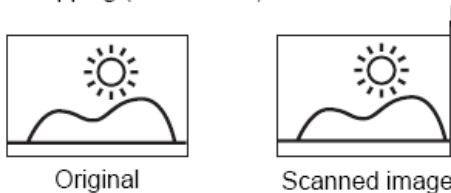

Connect PHOTOLINK Scanner to a PC

By connecting the scanner to a computer, you can access the scanned images on the memory card directly, or use the scanner as a memory card reader, so that you can freely copy, paste or delete files to and from the memory card using the computer.

System Requirements (for PC)

Operating system:

- **Windows:** Windows 2000 Pro, XP, Vista or later ver.
- **Macintosh:** Mac OS X or later versions

USB Port Supported:

- USB 1.1 or 2.0 port

Make Connection to PC



1. Connect the plug on the power adapter cord to the power connector on the scanner.



2. Plug the power adapter into an electrical outlet.



Note: The type of power plug and socket illustrated may differ from that of your region.



3. Connect the mini end of the USB cable (included with scanner) to the Mini USB connector on the scanner.
-

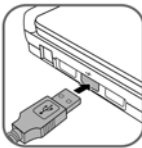

4. Connect the large end of the USB cable to a USB port on the PC.

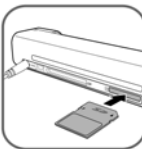

5. Insert an unlocked (writable) memory card into a suitable memory card slot. If both slots are occupied, the scanner will take the following priority when storing the scanned images:

SD (MMC) > CF > xD > MS/MS Pro/MS Duo

For example, if both SD and CF cards are inserted, the scanner will store the scanned images onto the SD card only.



6. Press the Power button; the power indicator light blinks.



Note: For more information, refer to “Indicator Lights” on page 9.

The **PHOTOLINK** Scanner will be recognized by the computer as a removable disk (Windows system). You should see a drive named “PDSCAN” in Windows Explorer (see below figure). Within the drive there’s a folder called “Photo1” into which your scanned images are stored. Now, you are ready to view or edit the files on the memory card.



Notes:

- If the memory cards are subsequently removed and re-inserted, the scanner will only recognize the card first inserted. For example, if you remove and re-insert the CF card after the SD card, only the SD card will be recognized.
 - Do not remove the memory card while the computer is accessing the files on it.
-

Windows Explorer with Microsoft Vista View

- You should see an additional drive appear in your PC.
- When you click on the “PDSCAN” drive (D: in this case), “PHOTO1” folder appears in the right pane.

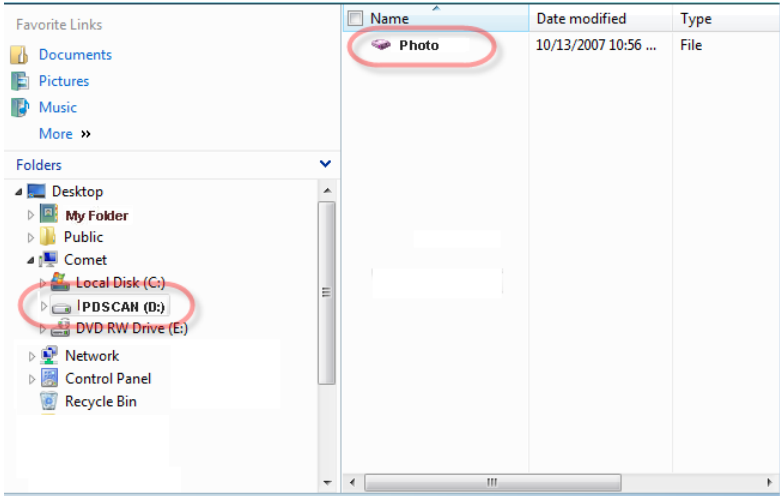

For Windows Vista Users

When the **PHOTOLINK** Scanner is connected with your PC via a USB cable with an inserted SD Card, a pop-up “AutoPlay” window will appear.

To view photos on the PC while scanning, change Windows Explorer’s setting as follows:

1. Select **“Open folder to view files”** option.
2. Check the **“Always do this for pictures”** checkbox.



Note: Do not select “Take no Action” or “Set AutoPlay” to default in the Control Panel.

For Windows XP Users

When the **PHOTOLINK** Scanner is connected with your PC via a USB cable with an inserted SD Card, a pop-up “PDSCAN” window will appear.

To view photos on the PC while scanning, change Windows Explorer’s setting as follows:

1. Select “**Open folder to view files using Windows Explorer**”.
2. Select the “**Always do the selected action**” checkbox.
3. Click **OK**.

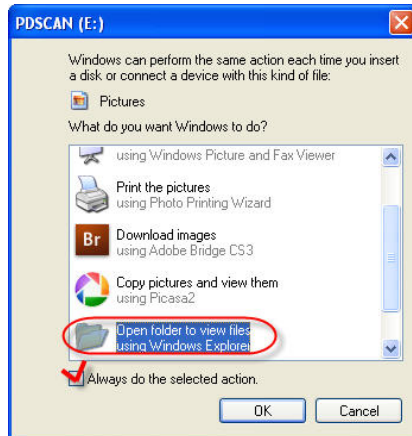

Safely Disconnect the Scanner from PC

Windows Systems

- On the Windows System Tray, click the hardware removal icon as indicated below.

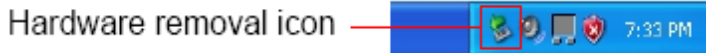

- Click the 'Safely remove USB mass Storage device' message with the corresponding Drive.
- When the message 'Safe to remove Hardware' displays, you can safely remove the scanner's USB cable.

Macintosh Systems

- Click and drag the hard disk icon to Trash, which will become an eject function.
- Disconnect the scanner USB cable from your computer.

Scan2PC Manager (Scanner to PC Utility)

With the Scan2PC Manager, you can easily scan photos and save the scanned images directly to the connected PC. You can also choose the location where the scanned images will be saved.

Installing the Scan2PC Manager

System Requirements

Before installing the Scan2PC Manager, make sure that your PC is compatible with the following system requirements:

- Operating system: Windows 200, XP, Vista 32-Bit
(*The Scan2PC Manager is not supported on the Macintosh operating systems.*)
 - Free hard disk space: 6MB
 - A Pandigital **PHOTOLINK** Scanner that is correctly connected to the PC and is working properly
1. Insert the SD card (*included with scanner*) into the SD memory card slot on the Scanner.
 2. Open 'My Computer' on your desktop, locate and double-click the SD card folder named **Pandigital**, and then double-click the **Utility** folder.
 3. Double-click the "**Scan2PC Manager.exe**" file.
 4. Follow the on-screen instructions to complete the installation.



Notes:

- Once installed, the Scan2PC Manager runs automatically upon PC startup, and the  icon stays on the system tray.
- If you want to close the Scan2PC Manager temporarily, right-click on the icon and select Exit.



Using the Scan2PC Manager

1. When the **PHOTOLINK** Scanner is detected by the PC, the following Scan2PC Manager window will pop up automatically:



2. Now you can specify the location where you want the scanned images to be saved; on the memory card (**Memory Card**) or in a specific folder on the PC (**Scan to PC**). If **Scan to PC** is selected, the scanned images will be saved to the following location by default:

Windows 2000 and XP: C:\Documents and Settings*(your username)*\My Documents\My Pictures\PhotoLink\



Windows Vista: C:\Documents and Settings*(your username)*\Documents\Pictures\PhotoLink\

You can also click the  button to select a different location you prefer.

3. Scan your original. The scanned image will be saved to the location you selected in step 2.

Each scanned image is given a file name with the prefix “PD_” followed by a 4- digit serial number in the sequence the image is stored. For example, PD_0001.jpg, PD_0002.jpg... If the file name reaches PD_9999.jpg in the “Photo1” folder, a new folder named “Photo2” will automatically be created to store subsequent new files, and so on.



Note: If you want to start the Scan2PC Manager manually, double-click the  icon on the Desktop, or right-click the  icon in the system tray and select **Setting**.



If you want to close the Scan2PC Manager temporarily, right-click on the icon and select **Exit**.



Supported Memory Cards



• CF (CompactFlash)
Type I

- MS (MemoryStick)
- MS Pro
- MS Pro Duo (adapter needed)
- MS Duo (adapter needed)
- MMC (MultiMediaCard)
- RS-MMC (adapter needed)
- xD (extreme Digital, H-type and M-type)
- SD (SecureDigital)
- Mini SD (adapter needed)
- micro SD/T-Flash (adapter needed)

File Naming and Storage Rules

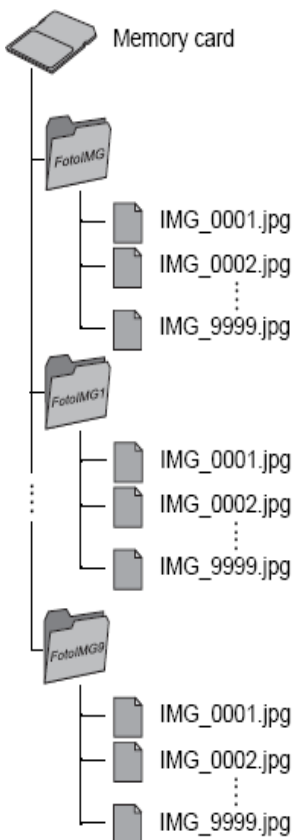

- If the memory card (volume name - PDSCAN) is used with the scanner for the first time, the scanner creates a folder named “PHOTO1” in the root folder to store the scanned image files. Each image file has a prefix “IMG_ = PD_” followed by a 4- digit serial number in the sequence the image is stored.
- If the file name reaches PD_9999.jpg in the “PHOTO1” folder, another new folder named “PHOTO2” will automatically be created to store subsequent new files, and so on.
- If the memory card already contains folders created by the scanner, the scanner will store the images in the last folder created.
- There can be up to 9 folders (PHOTO1..9, PD_0001... PD_9999) on a memory card. If exceeded, the Status/card indicator blinks. (*Refer to “Indicator Lights” on page 9.*)

To continue using this memory card, delete some files to free up space.

Scanner Maintenance

Cleaning the **PHOTOLINK** Scanner

In order to maintain the scanned image quality and prevent dust accumulation, it is recommended that you clean the scanner (outer

casing, image sensor and roller inside the scanner) regularly (about every 100-150 scans) using only the recommended and supplied tools.

⚠ WARNING: Do not use any solvents or corrosive liquid (for example, alcohol, kerosene..., etc.) to clean any part of the scanner, otherwise the plastic material will be permanently damaged.

Cleaning the Roller

-
1. Follow the instructions above to clean the scanner's outer casing first.
-
2. Connect the power supply to the scanner.
-



3. With scanner power off, press and hold the power button for 5 seconds. The scanner will enter cleaning mode. The power and status/card indicators will be lit.
-

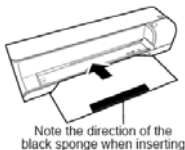

4. Insert the supplied roller cleaning sheet as shown. Note the direction of the sponge on the sheet when inserting.



Note: Make sure that there is no visible dust on the sheet before inserting it into the feeding slot.

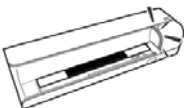

5. The cleaning sheet will be brought into the feeding slot automatically, and the cleaning process will begin. During the cleaning process, the Power and Status/card indicator lights will blink slowly and simultaneously.
-

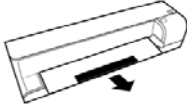

6. When the cleaning process is completed, the cleaning sheet will be ejected from the feeding slot, and the power indicator light will go off.

Remove the cleaning sheet, store it in a safe place and protect it from dust.

Cleaning the Image Sensor

1. Follow the instructions on page 24 to clean the outer casing of the scanner first.
-

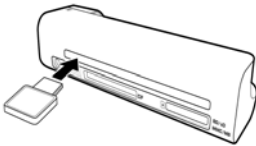

2. With the scanner powered off and disconnected from the power supply, insert the sensor cleaning swab into one end of the output slot.



Note: Make sure that there is no visible dust on the swab before inserting it into the output slot.

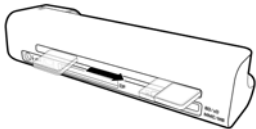

3. Gently slide the sensor cleaning swab to the other end of the output slot.
-

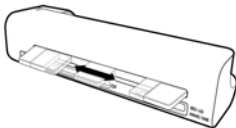

4. Repeat step 3 two or three times consecutively.

CAUTION: Do not apply too much force on the swab.



5. Remove the sensor cleaning swab, store it in a safe place and protect it from dust.
-

Calibrate the PHOTOLINK Scanner

If the scanned image looks fuzzy or there are strange stripes on it, the scanner may need calibrating in order for the sensor to resume its original precision. To calibrate the scanner:

-
1. Follow the instructions on page 24 to clean the roller and image sensor, and then follow the instruction in “Initial Setup” on page 10 to prepare the scanner for scanning.
-

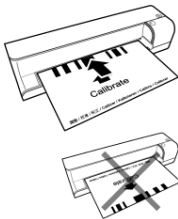

2. Insert the calibration card as shown. The scanner will scan the pattern on the calibration card and perform calibration to the sensor inside automatically.



Note: Make sure that the calibration card is inserted in the correct direction, otherwise the calibration won't work.

Storing the PHOTOLINK Scanner

If the scanner will not be used for a prolonged period of time, follow the instructions below to store the scanner for future use.

1. Disconnect the scanner from power supply.

2. Place the scanner and power adapter in a box or bag to keep them from accumulation of dust.
3. Place it in a cool and dry place, inaccessible to small children.
4. After long-term storage, it is recommended that you clean and calibrate the scanner before use.

Technical Specifications

Specification		PHOTOLINK "One Touch" Scanner
Operation System		Windows 2000 Pro, XP and Vista; Apple Macintosh OS 9, X (Leopard)
Document Size (Max)		Up to A6 / 4" x 6"
Output image formats		JPEG
Resolution	Image	Up to 1800 x 1200 @ 4x6 photo scanned
	Optical	300 x 300 dpi (dot per inch)
Interfaces	Memory Cards	CF I, SD, MMC, MS, MS Pro, xD
	USB	Mini USB port USB, Compatible with the USB 2.0 specification
USB Mass Storage Supported		Windows 2000/XP/Vista; Mac OS 9.x & OS X
Power	Input	100-240W
	Output	6V, 1.5A
Photo feeding		Sheet feed type
Dimension/ Net weight		156(L) x 48(H) x 38(D) MM / 2.75 lbs (170g)
Recommended Operating Environment		15°C ~ 35°C; 20% RH ~ 70% RH

Frequently Asked Questions/ Troubleshooting

Q: There are strange lines on the scanned image, or the image is not clear.

A: Check the following:

- Are there scratches on the original, or is the original clean? Remove any stains or dust from the original before scanning.
- Has the scanner been used for a long period of time without cleaning and calibration? Follow the instructions for "Cleaning the Scanner" on page 24 and "Calibrating the Scanner" on page 27, and then try again.

Q: The original gets stuck halfway in the feeding slot.

A: Press the Power button. The scanner will advance the original so you can remove the jammed original from the output slot.

Q: The status indicator blinks rapidly and no scan is possible.

A: Check the following:

- Is the memory card inserted properly into the memory card slot? Re-insert the card and try again.
- Is the SD card locked (set to write-protect)? Unlock the card.
- Is the memory card full? The indicator blinks when the free space on the memory card is below 1MB. Use another card if necessary.
- Make sure the memory cards are in FAT or FAT32 file formats only, not NTFS or any other file format.
- Did you insert the next original before the scanning process of the previous one is completed? Power off and then on the scanner and try again. Make sure that you scan the next original only after the scanning process of the previous one is completed
- Does the length of the original exceed the maximum acceptable size? Refer to "Suitable and Unsuitable types of originals" on page 13 for more information.

Q: The scanner feels warm to the touch.

A: It is normal for the scanner to emit a small amount of heat (around 30-45 Celsius) after prolonged use. However, if there are strange odors coming from the scanner or the scanner feels hot to the touch, disconnect the scanner immediately from the power supply or the computer.

Limited Warranty

The limited warranty set forth below is given by Pandigital with respect to Pandigital brand electronics products purchased and used in the United States of America. Pandigital warrants this product against defects in material or workmanship as follows:

LABOR: For a period of ninety (90) days from the date of purchase, if this product is found to be defective, Pandigital will repair or replace the product, at its option, at no charge. After this ninety (90) day period, labor charges will be charged on a case by case basis.

PARTS: For a period of ninety (90) days from the date of purchase, if this product is found to be defective, Pandigital will supply at no cost, new or rebuilt replacement parts, at its option, at no charge. After this ninety (90) day period, parts will be charged for on a case by case basis.

This warranty does not cover: (1) customer instruction, installation or setup; (2) cosmetic damage or damage due to accident, misuse, abuse or negligence; (3) commercial use of the product; (4) modification of any part of the product; (5) damage due to improper operation, improper maintenance, or connection to an improper power supply; (6) loss of data, regardless of value or format, that may result through proper and/or improper use of the product; (7) damage due to an attempted repair of the product by anyone other than a facility authorized by Pandigital to service the product; (8) consumables (such as fuses and batteries). This warranty is valid only in the United States.

The product must be accompanied by a copy of the original retail purchase receipt. If no proof of purchase is attached, the warranty will not be honored and repair costs will be charged. This warranty is only valid with written documentation detailing the complaint attached to the outside or inside of the carton. This warranty is invalid if the factory applied serial number has been altered and or removed from the product. This warranty does not provide protection for the loss of data, regardless of format. Pandigital reserves the right to modify and design this product without prior notice, written or otherwise.

To obtain warranty service, you must deliver the product freight prepaid in either its original packaging or packaging affording an equal degree of protection, plus proof of purchase.

Technical support telephone number: 1-800-715-5354.

Repair or replacement as provided under this warranty is the

exclusive remedy of the consumer. Pandigital, its parent company, affiliates or subsidiaries, shall not be liable for any incidental or consequential damages for breach of any expressed or implied warranty on this product. Except to the extent prohibited by applicable law, any implied warranty of merchantability or fitness for a particular purpose on this product is limited in duration to the duration of this warranty.

Some states do not allow the exclusion or limitation of incidental or consequential damages, or allow limitation on how long an implied warranty lasts, so the above limitations or exclusions may not apply. This warranty gives you specific legal rights, and you may have other rights, which vary from state to state.

All content included on the Pandigital website as well as Pandigital products, including preloaded demonstration images, digital media, digital cookbooks, text, graphics, logos, designs, photographs, button icons, images, audio/video clips, digital downloads, data compilations, and software, is the property of Pandigital or its suppliers and is protected by United States and international copyright laws or other intellectual property laws and treaties. Said content shall not be reproduced or used without express written permission from Pandigital and its suppliers respectively.

Use of this product constitutes acceptance of these terms and conditions of warranty.

FCC Statement

FCC Part 15 Information

This equipment has been tested and found to comply with the limits for a Class B digital device, pursuant to Part 15 of the Federal Communication Commission (FCC) Rules. These limits are designed to provide reasonable protection against harmful interference in a residential installation.

This equipment generates, uses, and can radiate radio frequency energy and if not installed and used in accordance with the instructions, may cause harmful interference to radio communications. However, there is no guarantee that interference will not occur in a particular installation. If this equipment does cause harmful interference to radio or television reception, which can be determined by turning the equipment off and on, the user is encouraged to try to correct the interference by one or more of the following measures:

- Reorient or relocate the receiving antenna.
- Increase the separation between the equipment and receiver.
- Connect the equipment to an outlet on a circuit different from that to which the receiver is connected.
- Consult the dealer or an experienced radio/TV technician for help.



WARNING: Changes or modification to this unit not expressly approved by the party responsible for compliance could void the user's authority to operate the equipment"