

Hurriking™

QUICK START GUIDE

Dual SimCard for iPhone SM-9001

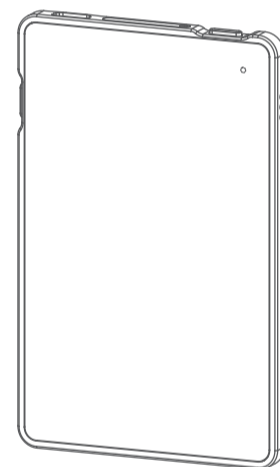

Specifications

CPU Brand	MTK		
Frequency	850MHZ \ 900MHZ \ 1800MHZ \ 1900MHZ		
Bluetooth	4.0	SIM Card	Micro
Battery	Lithium ion	Battery Capacity	500mAh
Working Time	4.5 Hours	Standby Time	100~120 Hours
Charging Duration	2.5 Hours	Selfie	Support
Safeguard	iPhone and Valuables	Compatible with	iPhone\iPod\ iPad Touch
Weight	32g	Size	85.0*54.0*4.0mm

Product overview

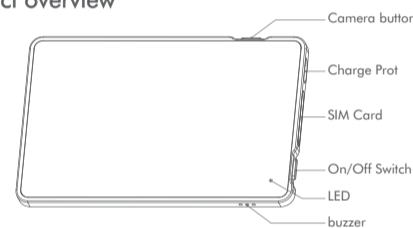

Button

On/Off Switch: Press the button for 4S to turn on the device,press the button for 3S will turn off the device,RED LED light will be shut off after 7 seconds.
Button for Selfie: Turn on the camera with APP opened, press selfie button take selfie.

Install the SIM card

1. Take out card pocket with a pin.



2. Install the SIM into the groove.



1

3. Insert the card pocket back the device.



Charge the battery

You need charge the battery if you used the device first time or have not used it for long time.
You will turn on the device when charging, the LED will indicate red during charging, will change to green when charging completed.

Check the battery status

(Charging the device will automatically turn it on when it's off), indicator light is red when it's charging, it turns to green when it's fully charged.

Selfie

1. When device connected with iPhone, iPad or iPod Touch, and with APP opened, press selfie button to turn on the camera, press again to take selfie.
2. Open the More Card APP, turn on the camera manually, press the selfie button to take selfie.

Search your Phones

When device connected with iPhone, iPad or iPod Touch and with More Card APP opened, press the selfie button for 3 seconds and then release, the phone will ring twice, repeat the process till find the phone.

Alarm

When device connected with iPhone, iPad or iPod Touch and with More Card APP opened, if the distance between phone and the device over 10 meters, the phone will ring for 4 times and the device will ring for 100 seconds to remind you. This function can be shut in the settings.

How to use the device

Install More Card:
Search and install "More Card" from App Store.

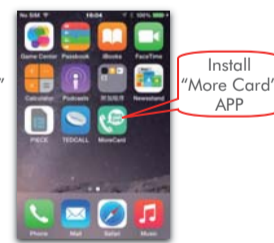

2

Connect the device with your iPhone\iPod&iPod Touch

1. Turn on 'Bluetooth' with your iPhone from "Setting"

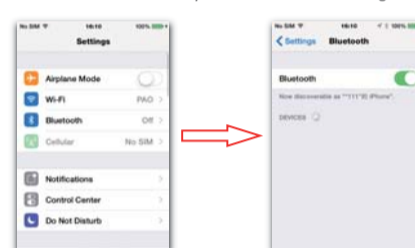

2. The device will enter "Bluetooth Search Mode".
3. Open More Card APP, More Card will request to access your MicPhone and contact when you use it for the first time, please press "Allow", click "setting" then "Searching device", when your iPhone was found in the list, click "Connect".

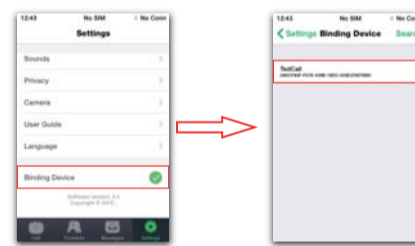

Make a call

1. Dial directly :
Open More Card,
you could dial the number from the keyboard directly.



3

2. Dial the number in your contacts:
Open More Card, select the The contact and dial.



Check and send message

Open More Card:
You could find the messages you received, Press write icon at top right Corner, + You could edit and write a message.

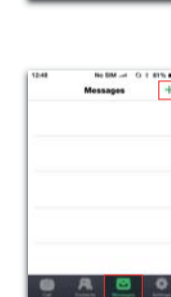

APP Setting

1. Sound setting:
you could set the sound and vibration patterns.



2. Privacy Setting:
you could set gesture lock, SMS reply and blacklist.



4

3. Camera setting:
Open camera, you could selfie With the "Camera button" within 10 Meters.

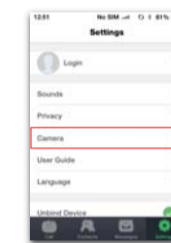

4. Language setting:
Only English and Chinese Available, other languages will be updated.



5. More configurations:
you could also set alert when lost, beep accessory, battery in percentage and Bluetooth Selfie/Answer/hang up.



6. Message reply:
You could send message when you are not available for a call.



5

The Company reserves the final interpretation of this quick start guide, APP is subject to upgrade without further notice.
APP function updated in APP setting options in the User's Guide Learn.

Troubleshooting:

1. the phone will not work with the device:
Please check the Bluetooth on the phone is turned on;
Please check the device is turned on;
Please check the device is on pairing status, has not connected with other phones.
2. Phone has connected with device but there's no network signal:
Check that the SIM card is valid and properly installed;
Turn the device off, remove the SIM card reload, and then turn it on;
3. Can not take selfie photo:
Make sure the distance between your phone and device is within 10 meters; Please turn on the camera in the APP.
4. The distance between your phone and device is more than 10 meters, but they don't send alarm:
Select "More Settings" and turn on the alarm.
5. Can not charge the device:
Check the power adapter is properly plugged into an electrical outlet;
Replace the power adapter;
Check the charging cable is properly inserted, or replace charging cable.

Safety Caution

This safety caution contains content applies to the mobile devices. Some may not apply to your device, in order to protect you and others from harm, or to protect your equipment from damage, please read the safety caution before using the device.
Do not use a damaged power cord or plug;
Insecure connection can cause electric shock or fire;
Do not touch the power cord with wet hands, or by pulling on the cord charger allocated under way;
Doing so may cause an electric shock death;
Do not bend or damage the power cord;
Doing so may cause an electric shock or fire;
Do not use or touch equipment with wet hands while charging;
Doing so may cause an electrical shock;
Avoid short circuit;
Doing so may cause electric shock or fire, battery may failure or explosion;
Do not use the device outdoors during thunderstorms;
Doing so may cause electric shock or equipment failure;
Do not replace the battery;
Otherwise it will cause damage to the equipment;
Do not drop the device.
Handling Device:
Do not place the device in a fire, do not place the device on heating equipment (such as microwave ovens, oven or radiator) near or inside the equipment from overheating could cause the battery to explode.
Do not crush or puncture the device;
Do not allow the device to external high pressure, it may cause an internal short circuit and overheating;
Do not use your device in the case may be affected by radio frequency interference like hospital, plane or car, etc.
Do not use the device at a refueling;
Do not use the device in the vicinity of the device or instrument;
emitting radio frequencies;
Radio frequency may cause the device to malfunction;
This device is electromagnetic radiation Specific Absorption Rate (SAR) maximum of 1.216W/kg;
conform to the national standard GB 21288-2007

NOTE: This equipment has been tested and found to comply with the limits for a Class B digital device, pursuant to part 15 of the FCC Rules. These limits are designed to provide reasonable protection against harmful interference in a residential installation. This equipment generates, uses and can radiate radio frequency energy and, if not installed and used in accordance with the instructions, may cause harmful interference to radio communications. However, there is no guarantee that interference will not occur in a particular installation. If this equipment does cause harmful interference to radio or television reception, which can be determined by turning the equipment off and on, the user is encouraged to try to correct the interference by one or more of the following measures:

- Reorient or relocate the receiving antenna.
- Increase the separation between the equipment and receiver.
- Connect the equipment into an outlet on a circuit different from that to which the receiver is connected.
- Consult the dealer or an experienced radio/TV technician for help.

This device complies with part 15 of the FCC rules. Operation is subject to the following two conditions:

- (1) this device may not cause harmful interference, and
- (2) this device must accept any interference received, including interference that may cause undesired operation.

Changes or modifications to this unit not expressly approved by the party responsible for compliance could void the user's authority to operate the equipment.