



6V BMW i8 Spyder



Owner's Manual and Assembly Instructions

Model W480E-FRC

Read and understand the entire manual before assembly and operation. The vehicle must be assembled by an adult who has read and understands the instructions.

Made in China.

Styles and colours may vary. Do not return to store. Visit us online at www.rollplay.net for assistance and replacement parts.

Save this manual with your sales receipt.



BMW i8 Children's Electronic Car manufactured by Paragon Child Products Co., Ltd. The BMW trademarks are used under license from BMW AG. BMW i8 name and associated logos are trademarks of BMW AG.

Introduction

Thank you for purchasing the BMW i8. We hope the rider enjoys it for miles to come. Please read this instruction guide carefully before assembling and operating the vehicle.

Please contact RollPlay Customer Service with any questions.

Hours: 9 AM - 5 PM (CST), Monday - Friday

Web: www.rollplay.net

Email: customerservice@rollplay.net

Phone: 1-888-982-9309

Specifications:

| | |
|------------------|--|
| BATTERY | 6V 7AH |
| MOTOR | 6V 15W |
| AGE | 3 Years and Up |
| MAX WEIGHT | 77 lbs. |
| PRODUCT SIZE | 64 x 40 x 127 cm (25,2 x 15,75 x 50 in) |
| SPEED | 4 km/h (2.5 mi/h) |
| RECHARGE TIME | 8-12 Hours |
| TYPICAL RUN TIME | 1-2 Hours |
| CHARGER OUTPUT | DC 7.0V0.7A |

IMPORTANT!

**YOU MUST CHARGE THE BATTERY
FOR 24 HOURS BEFORE FIRST USE!**

Charge the battery after each use.

Charge the battery at least once a month, even if the vehicle is not in use.

**DO NOT RETURN THIS ITEM
TO THE STORE!**

Email or call Customer Service if you need assistance or replacement parts.

customerservice@rollplay.net
1-888-982-9309

**Read this entire manual to ensure
proper assembly and safe operation
of the vehicle.**

This page is intentionally left blank.

| | |
|--|----|
| Safety | 6 |
| Parts | 8 |
| Charging Instructions | 9 |
| Assemble the Front Wheels | 10 |
| Assemble the Left Rear Wheel | 11 |
| Assemble the Right Rear Wheel | 12 |
| Attach the Steering Wheel | 13 |
| Attach the Mirrors | 14 |
| Attach the Seat | 15 |
| Battery Removal | 16 |
| Operating Instructions | 17 |
| Remote Operating Instructions | 18 |
| Remote Operating Instructions | 19 |
| Maintenance | 20 |
| General Care | 21 |
| Troubleshooting Guide | 22 |
| FCC Information | 24 |
| Service and Repairs | 25 |
| Warranty | 26 |
| Product Registration | 28 |



WARNING: SAFETY RIDING RULES

The user must follow all safety rules and guidelines, or serious injury or death may occur to the user.

- Always use common sense and safe practices when using the vehicle. The user must be at least 3 years old and weigh no more than 35 kg (77 lbs).
- This product contains small parts that are for adult assembly only. Keep small children away when assembling. Remove and dispose of all protective material and plastic bags before assembly.
- Riders must always wear a fitted helmet that complies with U.S. Consumer Product Safety Commission (CPSC) Standard CFR 1203.
- Only sit on the seat in the vehicle.
- Do not allow more than one rider.
- Do not overload the vehicle. Do not remove the weight restriction decals.
- Do not pull the vehicle with another vehicle or similar device.
- Keep body parts such as hands, legs, hair and clothing away from moving parts. Moving parts can cause serious injury.
- Always wear shoes in the vehicle.
- Do not operate near streets or motor vehicles.
- Do not operate near drop-offs such as steps, steep inclines or hills. Operate on relatively level ground.
- Do not operate near water, swimming pools or other fluids.
- Do not operate in dangerous weather conditions such as rain or snow.
- Do not operate near loose dirt, mud, sand or fine gravel.
- Do not operate near flammable vapors (gasoline, paint thinner, acetone, etc.).
- Always use the vehicle in a safe, secure environment with adult supervision.

PREVENT INJURIES AND DEATHS:

NEVER LEAVE CHILD UNATTENDED. ALWAYS keep child in view when child is in vehicle. Direct adult supervision is **REQUIRED**.

NEVER use in roadways, near cars, on or near steep inclines or steps, swimming pools or other bodies of water.

ALWAYS wear shoes

ALWAYS sit on the seat

RISK OF FIRE. Do not bypass.



WARNING!

DO NOT mix old and new batteries
DO NOT mix alkaline, standard (carbon-zinc) or
rechargeable (nickel-cadmium) batteries.



WARNING: BATTERY SAFETY

- Battery posts, terminals and related accessories contain lead and lead compound (acid) chemicals known to the state of California to cause cancer, reproductive harm, and are toxic and corrosive. DO NOT open the battery.



- Contact exposure to battery leakage (lead acid) may cause serious injury. Immediately contact your doctor if exposure occurs. If the chemical is on the skin, flush immediately with cool water for 15 minutes. If the chemical is swallowed, immediately give the person water or milk. Do not give water or milk if the person is vomiting or has decreased alertness. Do not induce vomiting.

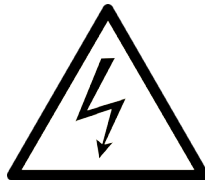

- Tampering with or modifying the electric circuit system may cause shock, fire or explosion. It could permanently damage the system. Keep the charger housing closed to prevent exposed wiring, which may cause electric shock.

IMPORTANT: Before using the vehicle for the first time, the battery must be charged for a full 24 hours (no more than 30 hours).



WARNING: ADULT SUPERVISION REQUIRED

- Before using the vehicle, the rider must understand the vehicle controls and safety issues.
- It is the responsibility of the adult to educate the child and to determine if the child is capable of understanding the vehicle controls.
- An adult must ALWAYS directly supervise the use of this vehicle.
- NEVER leave a child unsupervised in the vehicle.

8 Parts

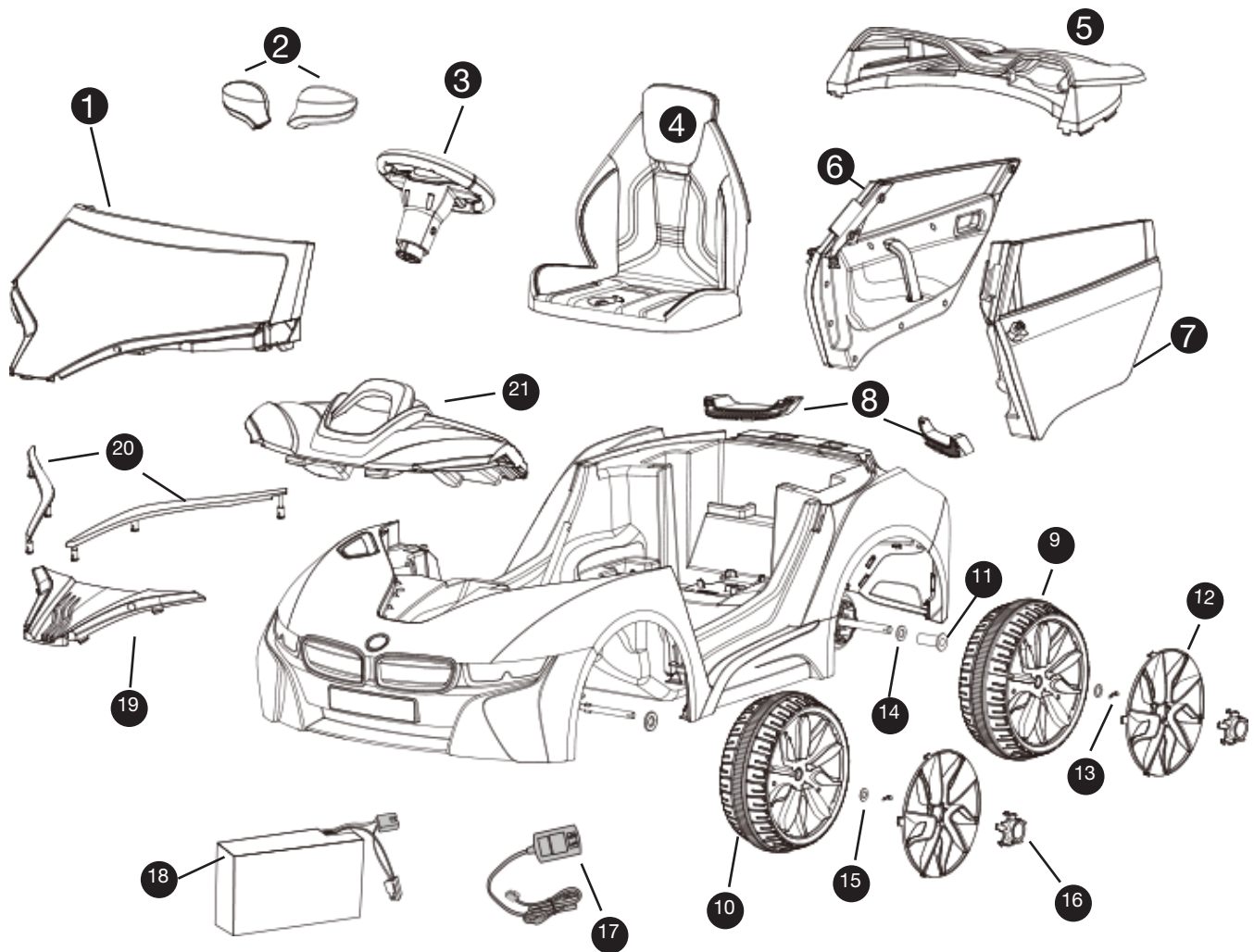

- | | |
|----------------------------|---|
| 1. Windshield | 14. Large Washers $\varnothing 12$ (3) |
| 2. Mirrors (2) | 15. Small Washers $\varnothing 10$ (4) |
| 3. Steering Wheel Assembly | 16. Hubcaps (4) |
| 4. Seat | 17. Charger |
| 5. Spoiler | 18. Battery |
| 6. Right Door | 19. Front Grill |
| 7. Left Door | 20. Front Panels (2) |
| 8. Rear Caps (2) | 21. Dashboard |
| 9. Rear Wheels (2) | 22. Steering Wheel Screw |
| 10. Front Wheels (2) | 23. Steering Wheel Nut |
| 11. Inner Wheel Spacer | 24. MP3 Cable |
| 12. Rims (4) | 25. Blister Pack (parts 11, 13-15, 22-24) |
| 13. Snap Pins (4) | |

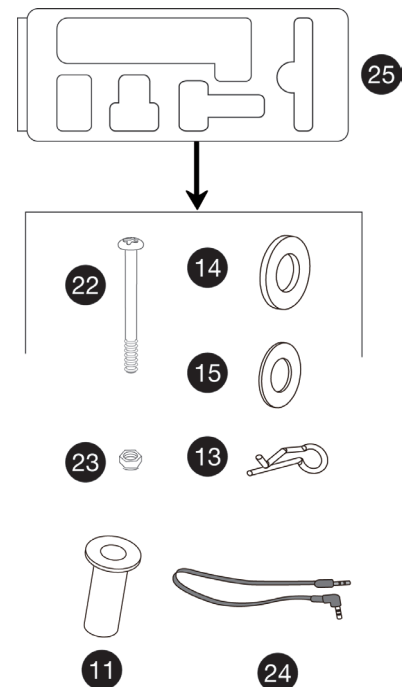

YOU MUST CHARGE THE BATTERY FOR 24 HOURS BEFORE THE FIRST USE!

ONLY AN ADULT SHOULD HANDLE THE BATTERY AND CHARGER.

To Charge the Battery:

1. Ensure the car is stopped and turned off.
2. Unlock and remove the seat.
3. Unplug the red battery connector (A) from the red engine connector (B).
4. Plug into a 120 V outlet.

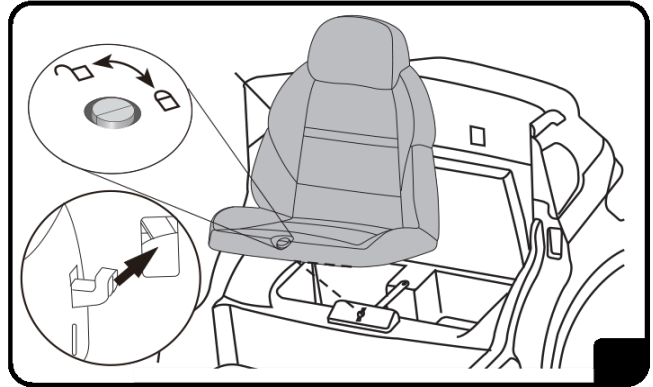

To Unplug the Battery:

1. Unplug the battery charger (D) from the outlet.
2. Unplug the red battery connector (A).
3. Reconnect the red battery connector (A) to the red engine connector (B).
4. Replace the seat and tighten lock.

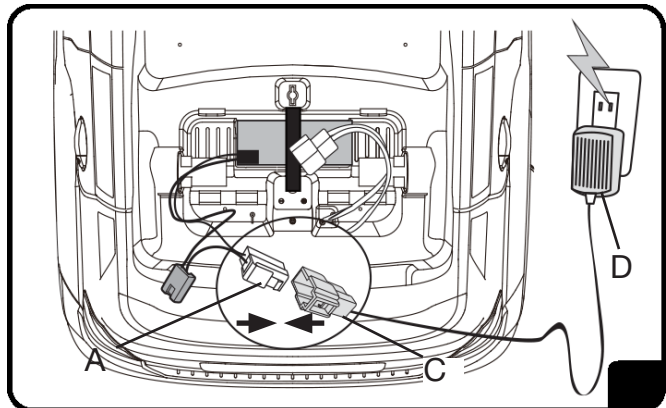
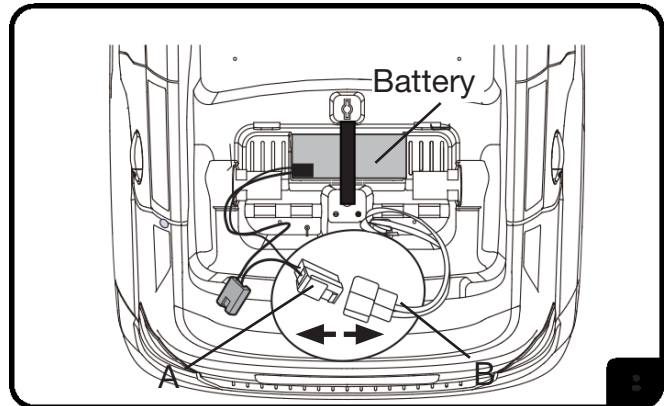

Note: It is not necessary to remove the battery for charging. However, if the battery does not reach the outlet, it can be removed for charging. For Battery Removal instructions, see Page 16.

10 Assemble the Front Wheels

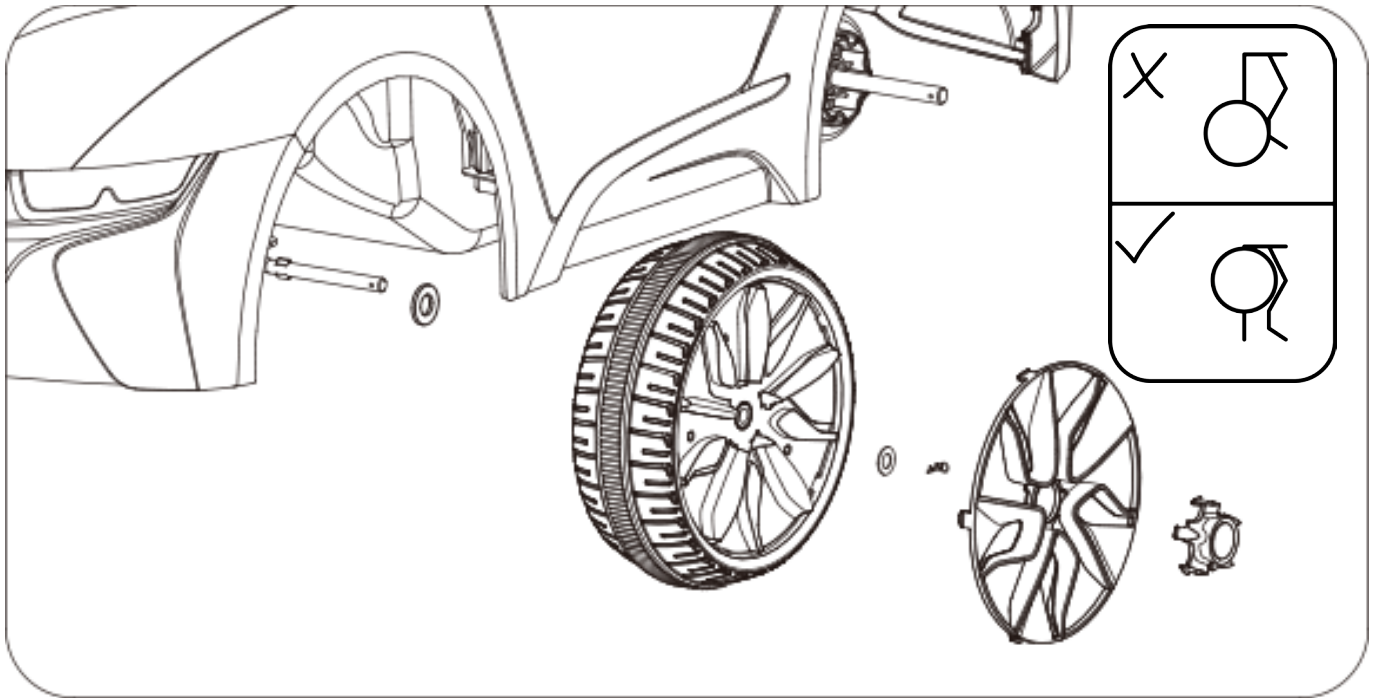

1. Locate the snap pins (13) and small washers (15) from the blister pack.
2. Slide a small washer (15) onto the axle.
3. Slide the front wheel (10) onto the front wheel axle.
4. Slide another small washer (15) onto the axle.
5. Push the straight end of the snap pin (13) into the hole on the front wheel axle to secure the parts into place.
6. Snap the rim onto the wheel (12), and snap the hubcap (16) onto the rim.
7. Repeat steps 1-5 for the other front wheel.

Assemble the Left Rear Wheel 11

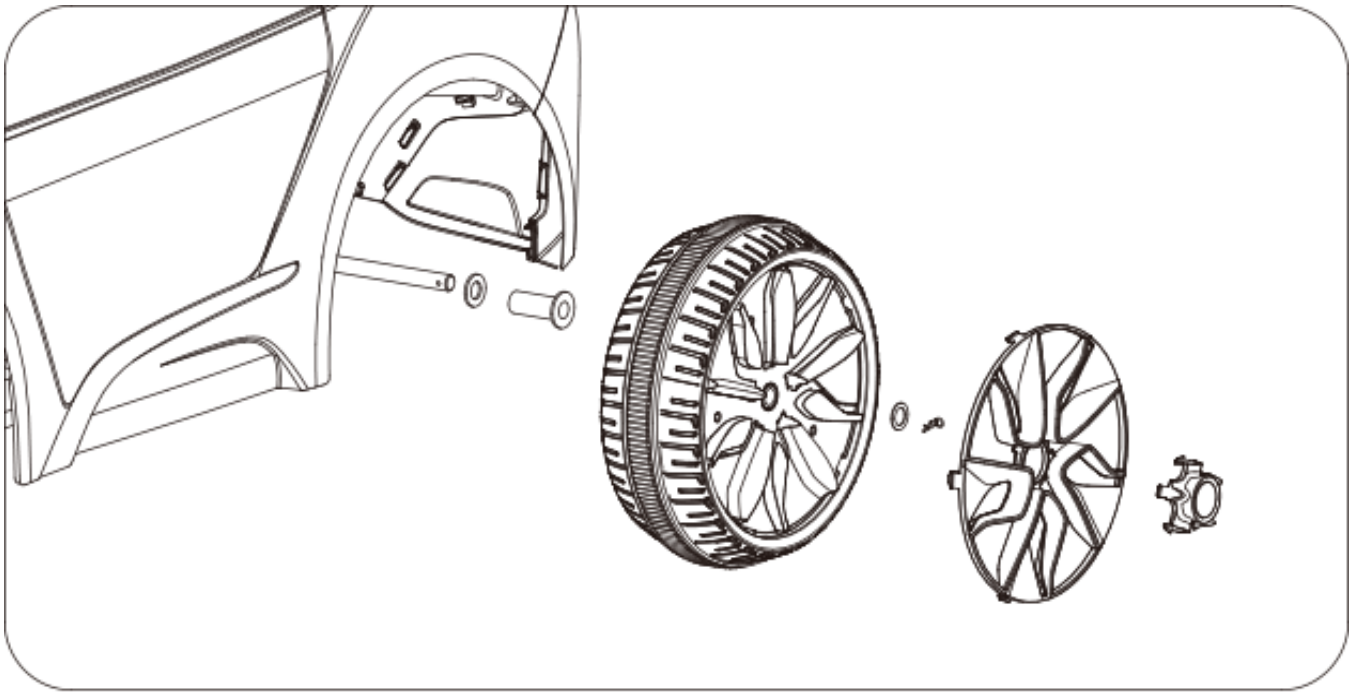

1. Locate the snap pins (13), inner wheel spacer (11), and large washers (14) from the blister pack.
2. Slide a large washer (14) onto the rear wheel axle.
3. Slide the inner wheel spacer onto the rear left wheel axle.
4. Slide the rear wheel onto the axle.
5. Slide another large washer onto the rear axle.
6. Push the straight end of the snap pin (13) into the hole on the axle.
7. Snap the rim onto the wheel, and snap the hubcap onto the rim.

12 Assemble the Right Rear Wheel

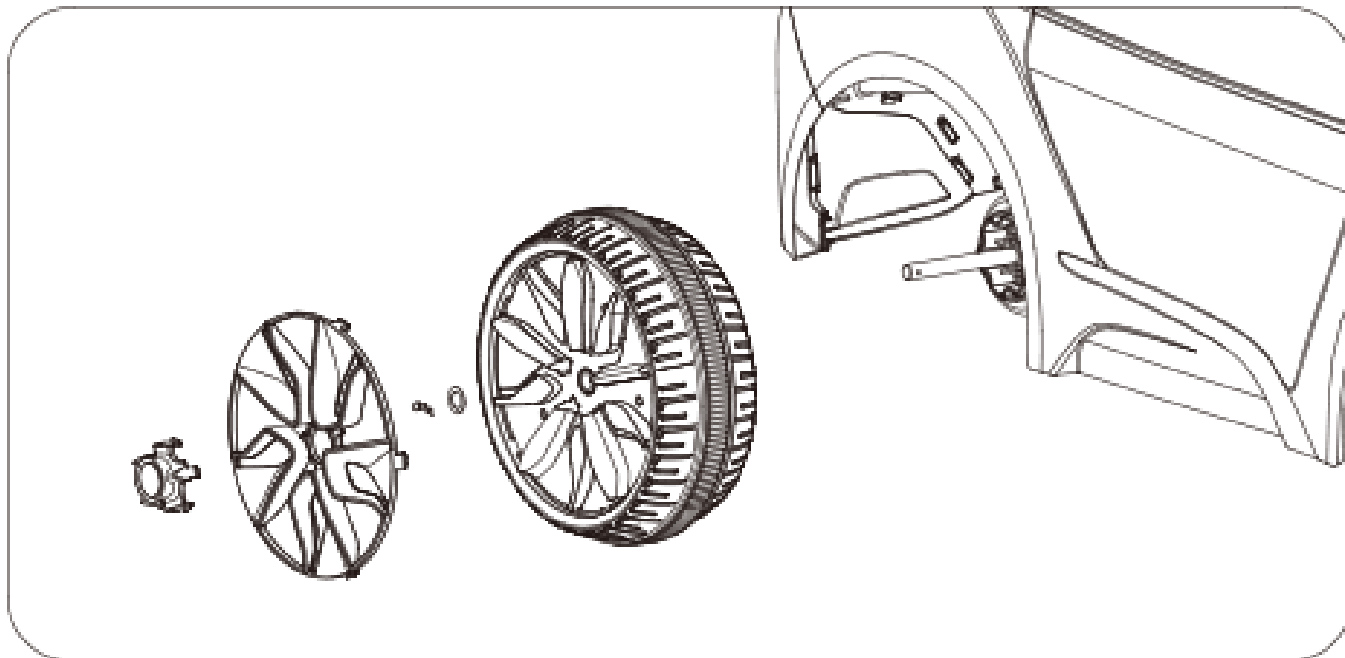

1. Slide the rear wheel with the gear teeth facing inward onto the right rear wheel axle.
2. Line up the gear teeth on the wheel with the grooves on the gear box.
3. Slide the large washer (14) onto the rear wheel axle.
4. Push the straight end of the snap pin through the hole on the rear wheel axle.
5. Snap the rim onto the wheel, and snap the hubcap onto the rim.

Attach the Steering Wheel 13

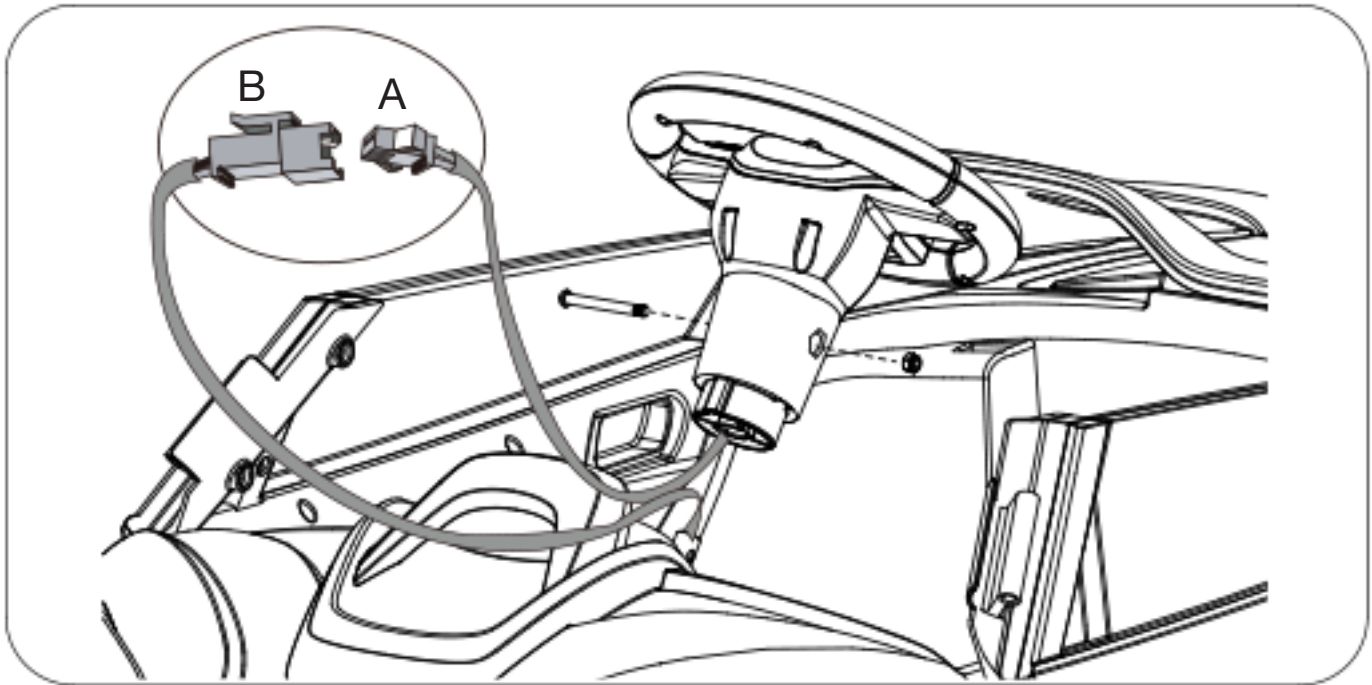

1. Locate the steering wheel screw (22) and steering wheel nut (23) from the blister pack.
2. Plug the steering wheel connector (A) into the dashboard connector (B).
3. Insert the steering wheel (3) into the steering rod, and match the screw holes of the steering wheel and the steering rod.
4. Insert the screw into the hole and fasten the nut to secure.

14 Attach the Mirrors

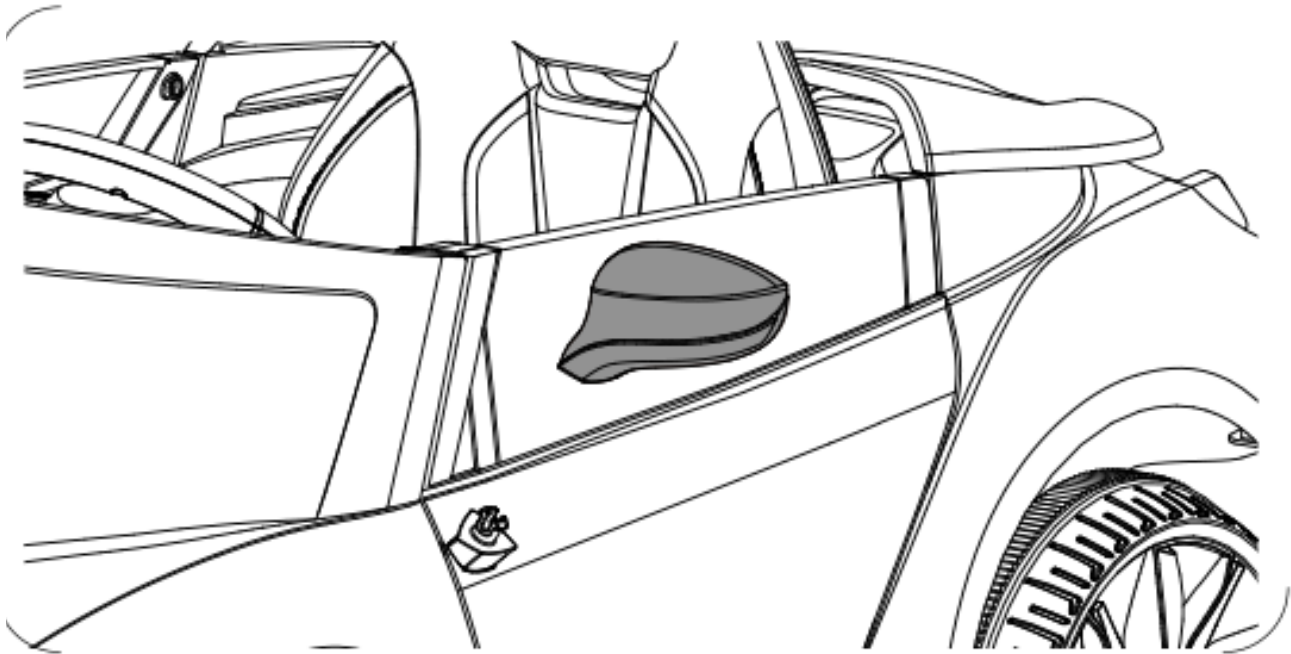

1. Insert the left mirror into the slot on the left door near the windshield
2. Push down on the mirror until it clicks into place
3. Repeat steps 1-2 for the right mirror

Attach the Seat 15

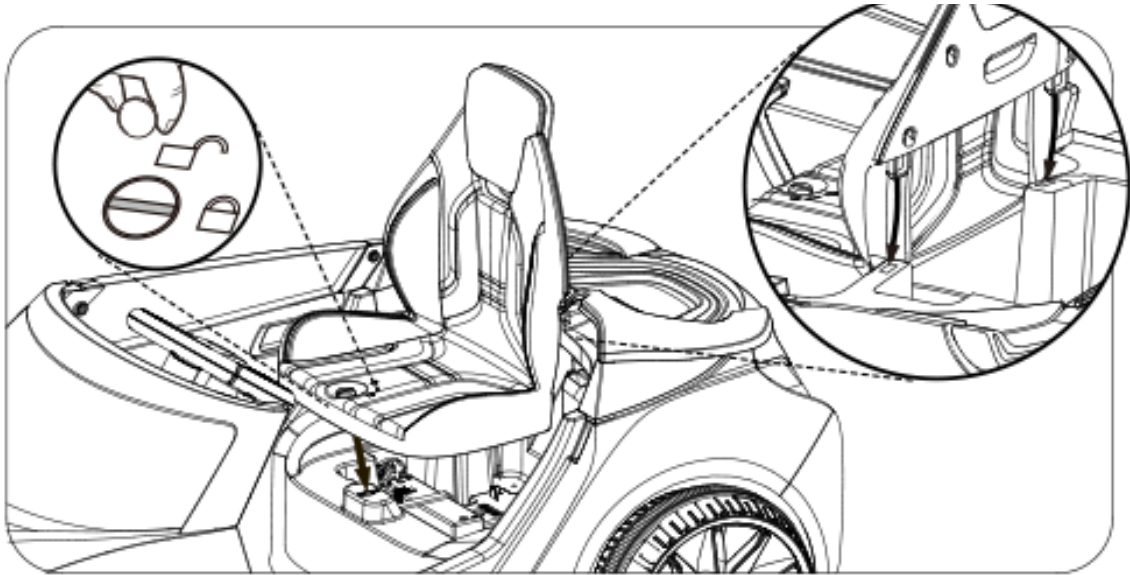

1. Position the seat over the battery compartment
2. Slide in the latches on the back of the seat into the slots on the body of the car
3. Turn the thumbscrew on the seat clockwise to lock it into place

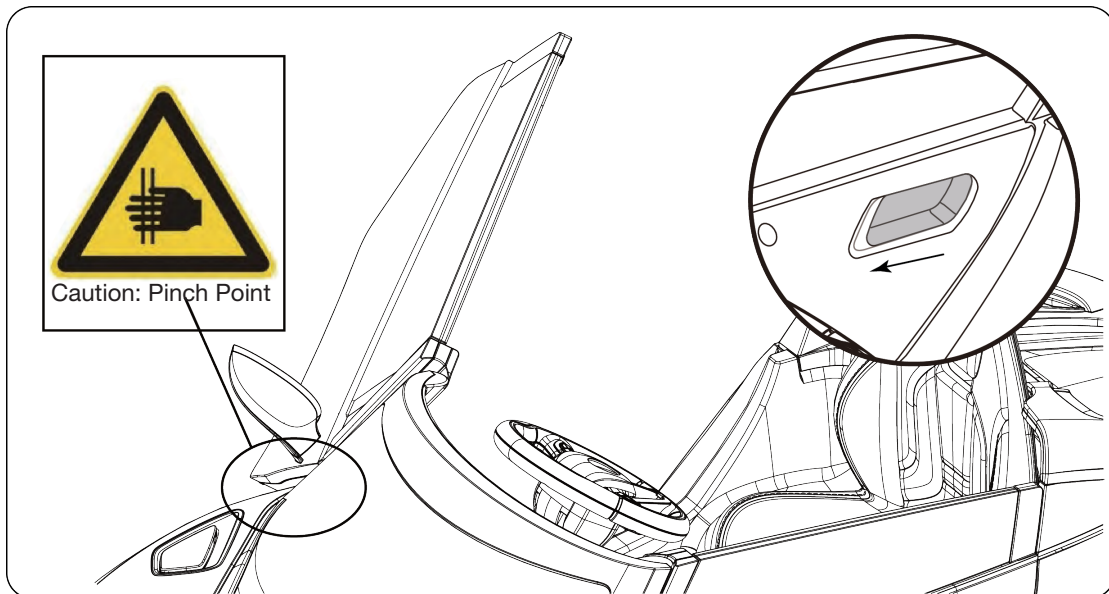

Opening Doors

1. To open the doors, locate the handle inside the door. Push the handle in, and pull the door out slightly. The door will finish opening automatically.
2. Push the door back to the close position, and it will lock into place.

16 Battery Removal

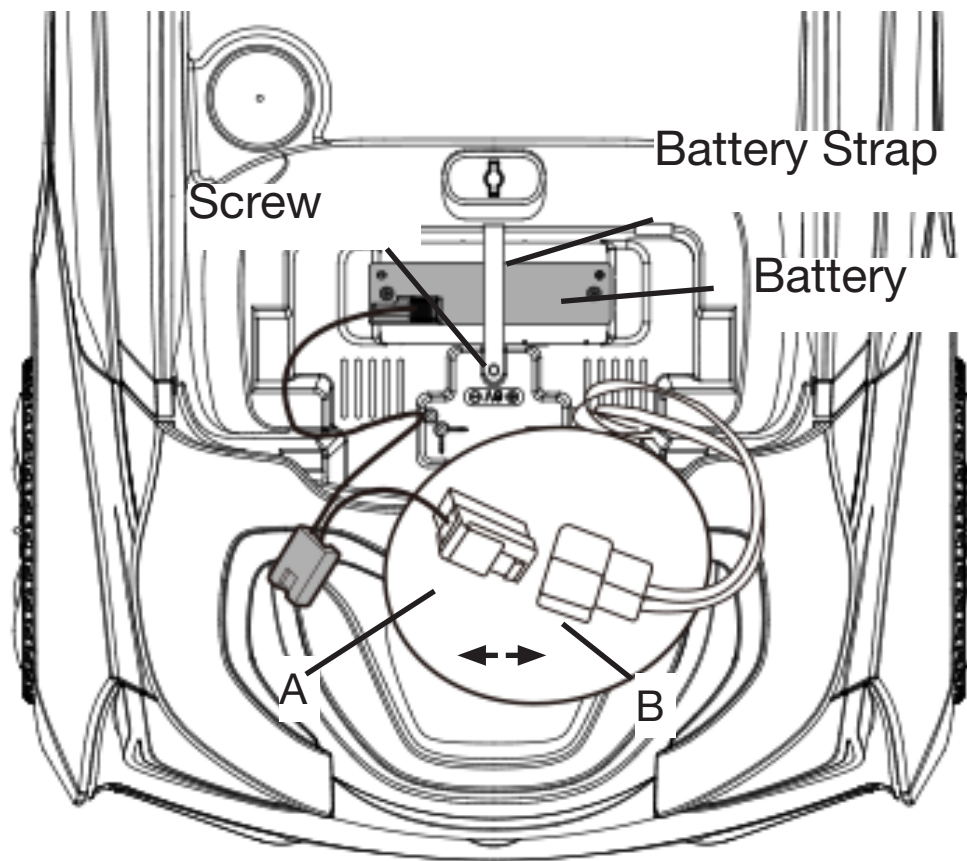

1. Disconnect the red battery connector (A) from the red engine connector (B) .
2. Loosen and remove the screw.
3. Pull out the battery strap bar.
4. Remove the battery.

Note: It is not necessary to remove the battery for charging. However, if the battery does not reach the outlet, it can be removed for charging.

Operating Instructions 17

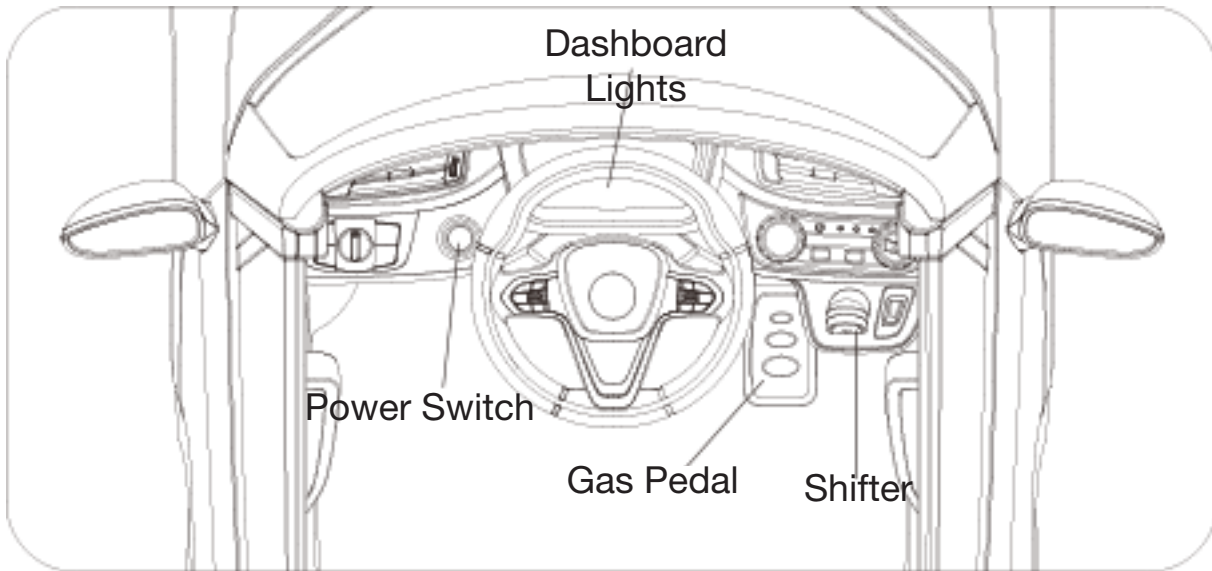

- Power Switch: Press the power switch to turn on the car. A power light will indicate that the car is turned on. Press the power switch to turn off the car.
- Dashboard Lights: The dashboard lights will light up when the power switch is pushed to on
- Gas Pedal: Press the gas pedal to put the car in motion. Release to stop. The headlights will turn on when the car is moving forward.
- Shifter: Push the shifter up to move forward, press down to move in reverse.

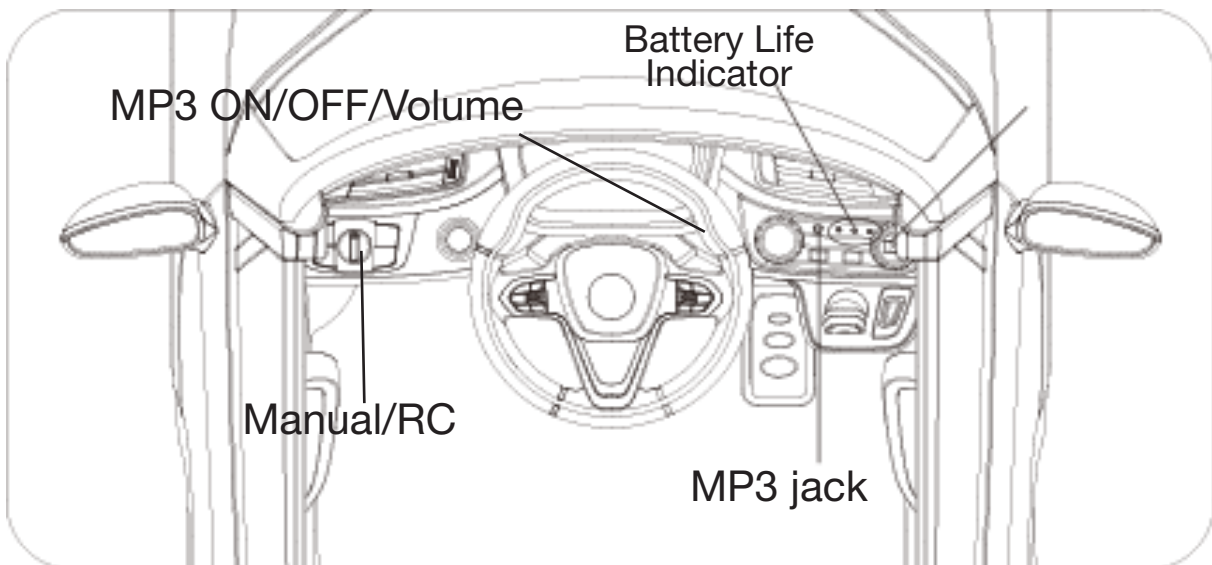

- Battery Life Button: When the car is on, press the battery life indicator button to check the battery life.
- Battery Life Indicator: **Green, Yellow, Red Lights:** Battery is fully charged. **Yellow, Red Lights:** Battery power is low. **Red Light:** Battery is extremely low and needs recharging.
- MP3 Connector: Insert the MP3 cable into the MP3 jack and connect to an MP3 device. The volume is controlled on the MP3 device.
- Manual/RC: See Page 18.

18 Remote Operating Instructions

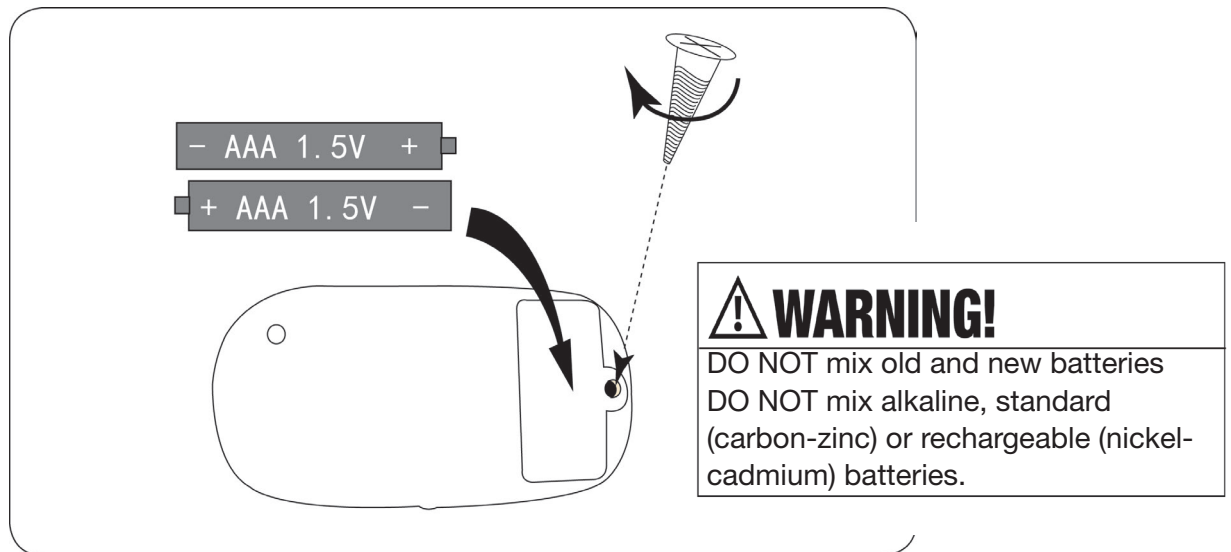

1. You need 2 x 1.5V AAA batteries (not included).
2. Open the battery cover with a screwdriver.
3. Put the two batteries into the battery compartment with correct polarity, and put the battery cover on. Note: If the red bulb does not work, change the battery according to the instructions.

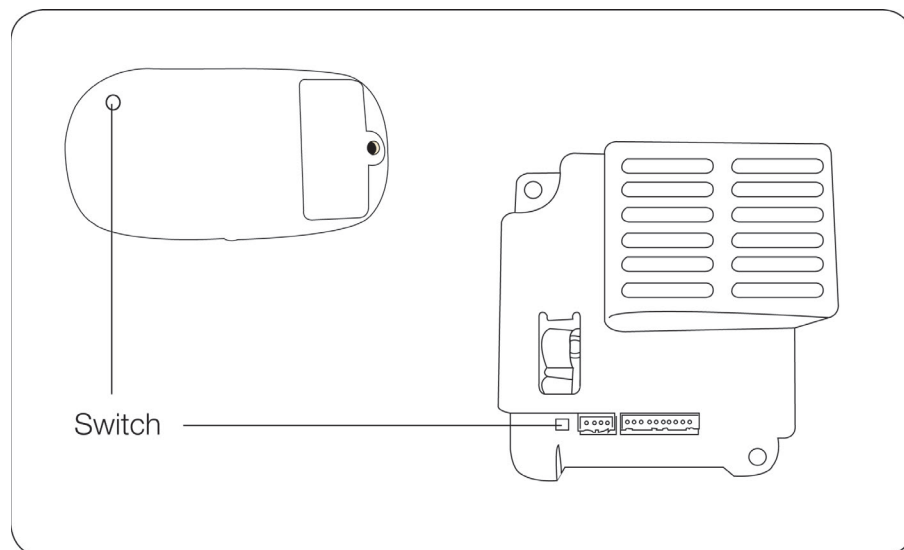

Connecting Remote Control:

1. Press the small button on the bottom of the remote control, and the speed indicator lights on the remote will flash.
2. Press the switch on the circuit board under the car seat. Hold down the switch until the flashing light on the remote stops. The remote and car are now connected.
3. To turn off the remote connection, press the button on the remote control.

Remote Operating Instructions 19

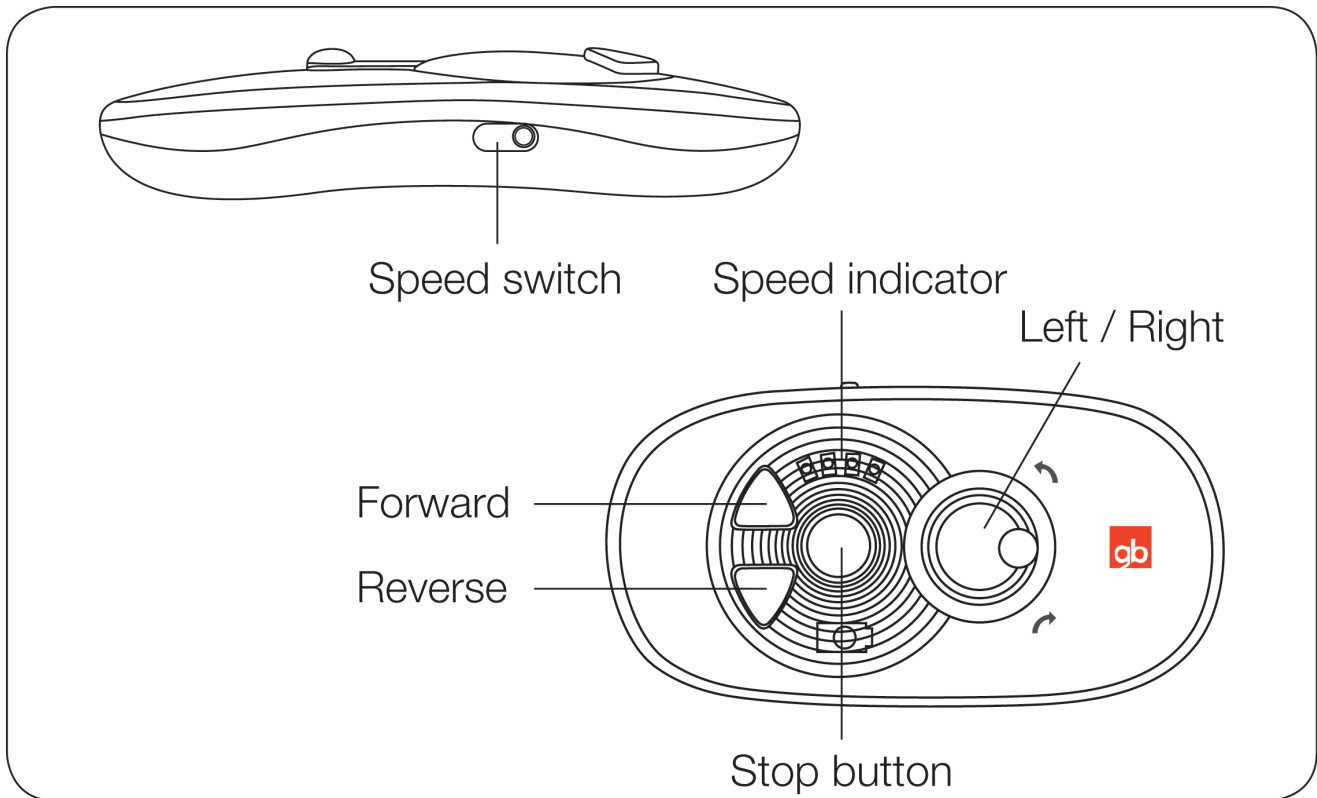

Remote Control:

1. Turn on Power switch.
2. There are four speed levels showed on remote control. 1 indicator is the lowest speed, and four indicators is the fastest. Set the optional speed.
3. Press Forward button to go forward. Press Reverse button to go backward. The car stops when not pressing any button.
4. 'Left/Right' button on remote control turns the car to the left and right direction.
5. The remote will turn off automatically after five seconds with no operation.
6. The stop button can stop the car in both manual and remote control mode.

Important Battery and Charger Information

- Only an adult who has read and understands the safety warnings may handle and operate the battery and battery charger. Keep away from children.
- Charge the battery for 24 hours before using the vehicle for the first time.
- Charge the battery immediately after each use. Charge for at least 8-12 hours, but no more than 20 hours.
- Charge the battery at least once a month, even if the vehicle is not used or stored.
- Never leave the battery in a discharged condition.
- Connect the terminal of the battery and charger, then plug the charger into a 120V AC outlet.
- It is normal for the charger to heat slightly. If the charger rises above 71°C / 160°F, disconnect the charger and call Customer Service for assistance.
- Keep the charger away from water or excessive moisture to prevent short-circuiting.
- Only use the charger specified with the original item. **Do not charge the battery with any other charger.**
- Do not attempt to recharge non-rechargeable batteries with the original charger.
- **Do not replace the battery with any other battery, or the warranty will be voided.** If you need a replacement battery, see Page 25 for replacement information.
- Remove damaged batteries from the car immediately. Recycle or dispose of the used batteries responsibly.
- Do not short circuit the supply terminals.
- Do not leave the battery connected in the vehicle for extended periods of time when the vehicle is not being used. Disconnect the battery connector from the engine connector before storing.
- The vehicle is equipped with a thermal fuse to protect the electric circuit. If the vehicle cuts out, turn the vehicle off and on to reset.

- Regularly inspect all vehicle parts to ensure they are in good working condition.
- Regularly inspect the charger, cord, plug, and other related parts for damage.
- Remove any damaged parts and immediately contact Customer Service for replacement parts. See Service and Repairs on Page 25 for more information.
- DO NOT operate the vehicle if there are any damaged parts.
- Carefully clean the vehicle with a damp cloth and mild soap. Do not get water in or near any electrical parts. Do not wash the vehicle with a hose.
- Store the vehicle indoors or use a tarp to cover it. Keep away from stoves, heaters, or other sources of heat.

22 Troubleshooting Guide

Completely read through the manual and troubleshooting guide before contacting Customer Service.

| Problem | Potential Cause | Solution |
|------------------------------------|---------------------------------|---|
| Vehicle does not run | Battery is low | Recharge the battery |
| | Thermal fuse tripped | Reset fuse |
| | Snap pins are loose | Tighten snap pins |
| | Loose wires or loose connectors | Ensure the battery connectors are securely attached. If wires are loose, contact Consumer Service for |
| | Battery is dead | Call Customer Service for replacement battery |
| | Electrical system is damaged | Call Customer Service |
| | Motor is damaged | Call Customer Service |
| Vehicle only runs for a short time | Undercharged battery | Ensure a secure connection when the battery is recharging. Recharge for at least 8-12 hours |
| | Overcharged battery | Never charge the battery for more than 30 hours |
| | Battery is old | Replace battery |
| Vehicle runs slowly | Battery is not fully charged | Ensure a secure connection when the battery is recharging |
| | Battery is old | Call Customer Service to order replacement battery |
| | Too much weight on vehicle | Reduce weight on vehicle (77 lbs max) |
| | Harsh conditions | Operate the vehicle on level ground and safe surfaces |

| Problem | Potential Cause | Solution |
|---|---|---|
| Vehicle needs a push to start | Loose wires or loose connectors | Ensure the battery connectors are securely attached. If wires are loose, contact Customer Service |
| | “Dead spot” on motor | A “dead spot” means electricity is not being delivered to the terminal. Contact Customer Service |
| Difficulty shifting | Attempting to shift while vehicle is moving | Stop the vehicle before shifting |
| Motor or gear box making grinding noises | Motor or gear damage | Contact Customer Service |
| Battery will not recharge | Charger is not plugged in | Plug in the charger to a functional wall outlet |
| | Charger is not working | Call Customer Service for a replacement |
| | Loose connector or loose adapter | Check that the connectors are securely plugged in to each other |
| Battery makes bubbling noise while recharging | This is normal | No action required |
| Charger is warm | This is normal | No action required |

24 **FCC Information**

This device complies with part 15 of the FCC Rules. Operation is subject to the following two conditions: (1) this device may not cause harmful interference, and (2) this device must accept any interference received, including interference that may cause undesired operation.

This equipment has been tested and found to comply with the limits for a Class B digital device, pursuant to Part 15 of the FCC Rules. These limits are designed to provide reasonable protection against harmful interference in a residential installation.

This equipment generates, uses and can radiate radio frequency energy and, if not installed and used in accordance with the instructions, may cause harmful interference to radio communications. However, there is no guarantee that interference will not occur in a particular installation. If this equipment does cause harmful interference to radio or television reception, which can be determined by turning the equipment off and on, the user is encouraged to try to correct the interference by one or more of the following measures:

- Reorient or relocate the receiving antenna.
- Increase the distance between the equipment and the receiver.
- Consult dealer or an experienced radio/TV technician for help.
- Connect the equipment into an outlet on a circuit different from that to which the receiver is connected.
- Check the state or local requirements for the product before using the product.

Caution: Changes or modifications not expressly approved by the party responsible for compliance could void the user's authority to operate the equipment.

Do not return this vehicle to the store.

If your product requires service, repairs or replacement parts, please visit us online at www.rollplay.net

Or contact us at:

Phone: 1-888-982-9309

Email: customerservice@rollplay.net

Web: www.rollplay.net

Hours: 9 AM - 5 PM (CST), Monday - Friday

For a list of available replacement parts, please visit www.rollplay.net.

RollPlay™ 6-Volt Limited Warranty

- One-year limited warranty from the date of purchase with proof of purchase from an RollPlay certified retailer.
- Six month limited warranty on the 6-Volt battery with proof of purchase from an RollPlay certified retailer.
- This one-year limited warranty covers the ride-on vehicle against defects in materials and workmanship to the original purchaser. Proof of purchase receipt from an RollPlay certified reseller is required.
- RollPlay ensures the original 6-Volt battery is warranted for 6 months from initial purchase of the vehicle from a certified retailer. Proof of purchase receipt required.
- This warranty covers normal use and does not cover the RollPlay vehicle or battery if deemed damaged by unreasonable use, modification, neglect, accident, abuse, misuse, improper service or other causes not arising out of defects in materials or workmanship. Evidence of any attempt at consumer repair will void this warranty.
- This warranty does not cover, and is not intended to exclude any liability on the part of RollPlay, whether under this warranty or implied by law for any indirect or consequential damages for breach of warranty. Some states may not allow the exclusion or limitation so this limitation may not apply to you.

Should you need service or assistance with your vehicle during the warranty period:

- Please do not return vehicle to the store.
 - Consult the troubleshooting guide in this manual and online at www.rollplay.net
- or
- Call RollPlay Customer Service at 1-888-982-9309

Note: This warranty gives you specific legal rights. You may also have other rights that may vary from state to state.

Please save your original sales receipt.

This page is intentionally left blank.

28 Product Registration

Fill out the form below and mail it to:

RollPlay Products
1131 W Blackhawk St.
Second Floor
Chicago, IL 60642

OR fill out the form online at **www.rollplay.net**

We will use the information provided only for your warranty. We will not sell, rent or share your personal information.

Product Registration

First Name: _____ Last Name: _____ Title: _____

Address: _____

City: _____ State: _____ Zip Code: _____

Email: _____ Phone: _____

Date of Purchase: _____

The following product information is on the cover of the owner's manual.

Product Name: _____ Model Number: _____

Serial Number: _____ Place of Purchase: _____