



QWA20 Instruction manual

ATTENTION:

THANK YOU FOR PURCHASING THE QWA20 WIRELESS AMPLIFIER. TO ENSURE YOU GET THE MOST OUT OF YOUR NEW PURCHASE, PLEASE TAKE A MOMENT TO READ THIS INSTRUCTION AND INSTALLATION MANUAL.

Please read through the entire instruction manual before installation.

IMPORTANT SAFETY INSTRUCTIONS

To reduce the risk of fire or electrical shock, do not expose this product to rain or moisture. Never use this or other electrical equipment if wet.

To prevent injury, this product must be securely attached to the wall/ceiling in accordance with the installation instructions.

BEFORE INSTALLING

Before you install the amplifier it is best to make sure that the units are tested and working as intended.

Prepare the amplifier on a table or flat surface in the same room that the QWA20 will be installed. Plug the power adaptor cord to the QWA20 and make sure that a set of speaker are installed.

Make sure that a strong wireless **2.4 GHz signal** is available in the room where the test was done. Note the setup can only be done using a **2.4 GHz wireless frequency**. After the set-up is completed you will be able to access the wireless speakers through your 5 GHz wireless network (if you have a dual band modem). If you do not have a strong signal in the room, the amplifier may not perform as intended. Q6-REP Wi-Fi repeater to extend the signal may be necessary if you have a low Wi-Fi signal.

INSTALLING THE QWA20 TO YOUR NETWORK

Step 1

Download "Muzo Player" from the App Store (IOS) or Google play (Android). This app is required to set-up the QWA20 Wi-Fi amplifier.



Step 2

After the app is installed on your device, open Muzo Player app and follow each step on the App. Make sure that the device that you will be using is connected to your **Wi-Fi 2.4 Ghz router**, or in **2.4 GHz mode** on you dual band router.

Step 3

Once Muzo player is opened, a screen will appear "searching for Muzo Player wireless Hi-Fi system". At the bottom click add device.

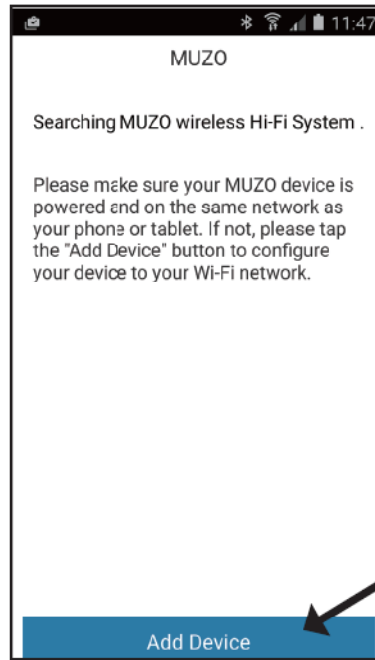

Next it will take you to a screen to add your wi-fi router (SSID) name of your wi-fi network and password. Make sure that your router (SSID) is listed on the app. Enter your password in the app and press next.

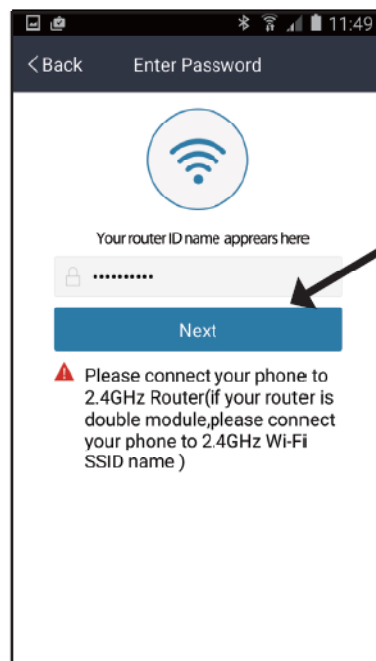

Now it will prompt you to press the WPS/Reset button located on the top of the amplifier for 1 second, and press the next button on the top right hand corner on the app. The app will now connect to the amplifier and configure the amplifier to your router. A screen will appear "Device connection succeeded" .Press finish on the top right hand side to complete the set-up.

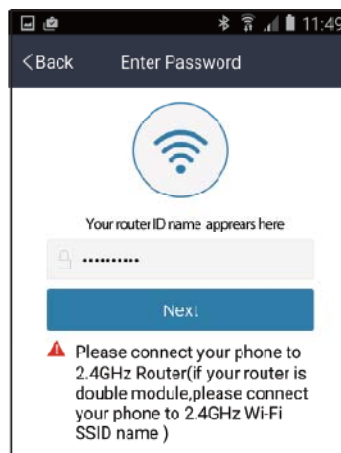

ADDING ADDITINAL SPEAKERS/AMPLIFIERS

Press the + sign on the top of the app and repeat step 3

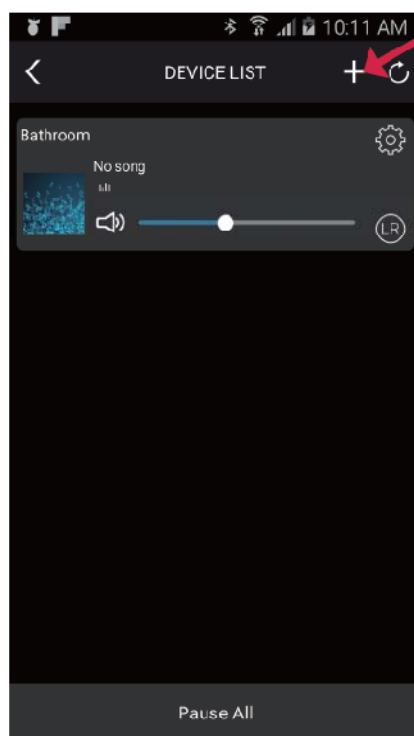

NAMING THE AMPLIFIER

You can select one of the names already in the app or select custom to create your own name for the amplifier. Once done : press the "done" button on the top.

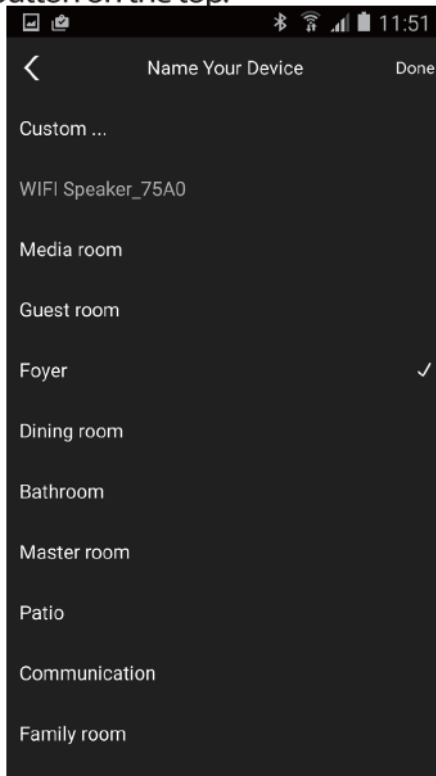

OVERVIEW OF THE APP

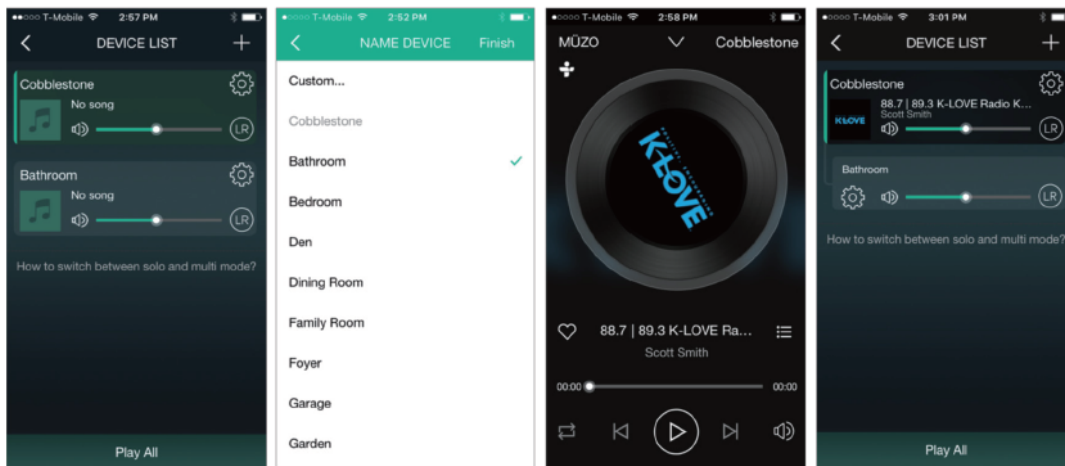

LISTEN TO DIFFERENT STATIONS IN DIFFERENT ROOMS

NAME YOUR QWA20 BY ROOMS

CONTROL MUSIC PLAY ON THIS SCREEN

LISTEN TO MUSIC IN SYNC IN MULTIPLE ROOMS

INSTRUCTIONS

MY MUSIC

Through 'My Music,' you can access the music that you have saved on your iOS or Android device's internal storage. You can also access music stored in music server. There are other options such as "recently played" and user created playlists etc.

In iOS, only music sync from your iTunes are accessible by the MUZO player. It is grouped by artists, album, playlists, or track. In each category, it is in alphabetical order. On Android device, all the music in the device is accessible, and it can be grouped by folder too..

CUSTOMIZE MUSIC SERVICES IN MAIN SCREEN

Once you customize the music services in the player settings, you will see your selections on the main screen.

SETTINGS

In this menu, shown on Screen 2, you'll be able to configure which music services you want to display on your main screen list.

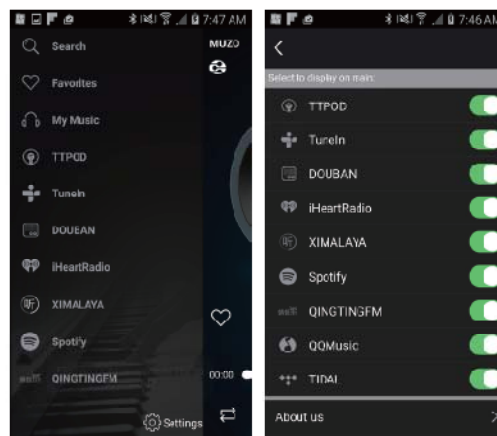

SCREEN 1

SCREEN 2

SPOTIFY Spotify

You can control music play through your Spotify app. Go to the Connect screen and select your QWA20. For example: "Family Room". Once you connect, you can stream Spotify to any room connected with a QWA20. In order to use Spotify on your connected speakers you need to install Spotify on your connected Smart-phone or Tablet. Go to the App Store or the Play Store and search for the Spotify App. Install the App and login into your account. If you do not have an account you will need to set one up.

IHEARTRADIO

iHeartRadio allows you to stream radio stations to your QWA20. Enter the menu and select 'iHeartRadio'. Select 'Genre' to choose the genre of radio you would like to listen to or select 'Country' and then the 'Region' to select localized radio stations.

AIRPLAY

You can play music through AirPlay on your iOS device. To do this you need to ensure that your iOS device and the Q6WF connected speakers are connected to the same Wi-Fi network. Swipe up from the bottom of your iOS device and select 'AirPlay'. Select your Q6WF and start playing your music.

NOTE: On multi-channel mode when you have two or more Q6WF units together, selecting AirPlay will play the selected music on all the speakers. Ensure that you increase the volume on the unit when listening to music on AirPlay.

TIDAL TIDAL

TIDAL is the perfect match for the QWA20 streaming music in lossless, high fidelity audio quality, ensuring the best sound experience possible. Add high definition music videos, curate editorials by music journalists, artists and experts, and so much more.

NOTE: Currently only available on iOS.

TUNEIN

TuneIn allows you to stream different channels of music and streaming talk radio. Enter the menu and select 'TuneIn'. Afterwards you will be prompted to localize or select a genre of music to begin playing.

TTPOD

Ttpod is a free music service with hundreds of millions of users. Search for any song in China through this music service.

DOUBAN

Douban provides personalized music.

XIMALAYA

Ximalaya is one of the largest and complete audio resource platforms in China.

QQMUSIC

With millions of tracks on QQMusic, the right music is always at your fingertips whether you're working out, playing or relaxing. Diversified ways are here to discover music you will love. The latest hits, the artists or DJs you like, intelligent recommendation based on your listening history, your next favorite songs are waiting for you.

NOTE: Currently only available on iOS.

QINGTINGFM

Enjoy live radio, news, music, fiction, comic, and podcast radio service. **NOTE:** Currently only available on iOS.

FACTORY RESET

To factory reset the QWA20, press the WPS/Reset switch located on the top of the speaker for more than 10 seconds. Once you let go of the switch the speaker will let you know that you have restored back to factory settings.

Playing the QWA20 directly

Step 1

You do not need to install the QWA20 to your wireless network in order to play music. You can connect directly to the speaker through your Wi-Fi on your device. Remember this option allows only one speaker to be connected at the same time and you will not have any access to music content on the net.

To do this after the app is installed on your device: Do not open the app yet. On your device go to "Setting" and select Wi-Fi. Search for the QWA20 Wi-Fi speaker and connect. Now you can listen to your music stored on your phone.

INSTALLING THE QWA20 AMPLIFIER

STEP 1

Run speaker wire from the QWA20 to the speakers that you intend to connect. Strip 1/2" (12mm) of insulation from each of the two conductors of the wire to expose the bare metal. Now twist each conductor individually into a single strand. Connect to "+" terminal, and to "-" terminal on the rear of the QWA20.



STEP 2

Connect the speaker wire from the QWA20 to the speakers that you intend to connect. Make sure that the correct polarity on the speaker wire is connected to the "+" terminal, and to "-" terminal on the rear of the Speaker.

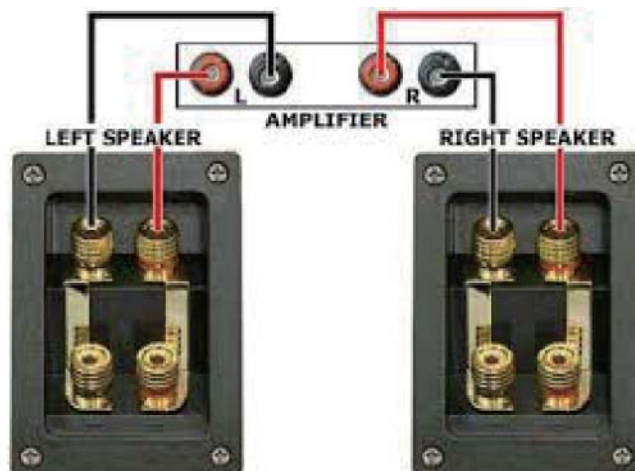

WARRANTY

AMPLIFIER

QWA20 Wi-Fi amplifier are warranted to the original purchaser against original factory defects in material or workmanship for a period of 1 year. The warranty does not cover misuse. The period is based on the date of the original purchase. The warranty is only valid in the country of purchase. The warranty is non-transferable. It is valid only when purchased from an authorized OMAGE dealer.

For the warranty to remain valid, all servicing must be done by OMAGE or our duly authorized service facility. In the event that service is required, contact the authorized OMAGE dealer from whom you purchased the equipment. After receiving written authorization and instructions from the dealer, return the equipment, freight prepaid, and packed in the original carton with the original packing material and we suggest you insure the shipment to cover possible damages in transit. OMAGE will not be liable for damages in transit to its facilities. Include a written description of the claimed defect and your original sales slip showing date of purchase.

FCC Statement

This equipment has been tested and found to comply with the limits for a Class B digital device, pursuant to part 15 of the FCC rules. These limits are designed to provide reasonable protection against harmful interference in a residential installation. This equipment generates uses and can radiate radio frequency energy and, if not installed and used in accordance with the instructions, may cause harmful interference to radio communications. However, there is no guarantee that interference will not occur in a particular installation. If this equipment does cause harmful interference to radio or television reception, which can be determined by turning the equipment off and on, the user is encouraged to try to correct the interference by one or more of the following measures:

- Reorient or relocate the receiving antenna.
- Increase the separation between the equipment and receiver.
- Connect the equipment into an outlet on a circuit different from that to which the receiver is connected.
- Consult the dealer or an experienced radio/TV technician for help.

To assure continued compliance, any changes or modifications not expressly approved by the party.

Responsible for compliance could void the user's authority to operate this equipment. (Example- use only shielded interface cables when connecting to computer or peripheral devices).

This equipment complies with Part 15 of the FCC Rules. Operation is subject to the following two conditions:

- (1) This device may not cause harmful interference, and
- (2) This device must accept any interference received, including interference that may cause undesired operation.

FCC Radiation Exposure Statement:

The equipment complies with FCC Radiation exposure limits set forth for uncontrolled environment. This equipment should be installed and operated with minimum distance 20cm between the radiator and your body.