



**Wireless  
Slim Keyboard  
& Mouse  
Desktop Set**



**Targus®**

**USER GUIDE**

Visit our Website at [www.targus.com/emea](http://www.targus.com/emea)  
Features and specifications subject to change without notice.  
© 2006 Targus Group International, Inc. and Targus Group (UK) Ltd.

AKM04EU / 410-0629-003A



PMS Black  
30%



PMS Black  
100%

# TARGUS WIRELESS SLIM KEYBOARD & MOUSE DESKTOP SET

## Introduction

Congratulations in purchasing the Targus wireless slim keyboard & mouse desktop set. This combo set offers the latest technology for users to remotely control their computer and to enhance their flexibility by providing 13 hot keys on the keyboard. In addition, the wireless optical mouse is rechargeable via USB cable so that it save operating cost, eliminating the cost of replacing with new batteries. The mouse is operable while being charged so it never goes out of power.

## Contents

- Wireless 27 Mhz slim keyboard
- Wireless 27 Mhz rechargeable mouse
- USB desktop receiver with attached USB charge cable
- Software Driver (for 98 / ME / 2000)
- 2 x AA Batteries (for keyboard)
- 2 x AAA Rechargeable Batteries (for mouse)
- User Guide

## System Requirements

### Hardware

- PC with an Intel<sup>®</sup> Pentium<sup>®</sup> processor or equivalent
- USB 1.1 or 2.0 port

### Operating System

- Windows<sup>®</sup> 2000 / XP

# Installing the Batteries

## Rechargeable Mouse

1. Remove the battery cover at the bottom of the mouse by pressing the tab and lifting the cover open.

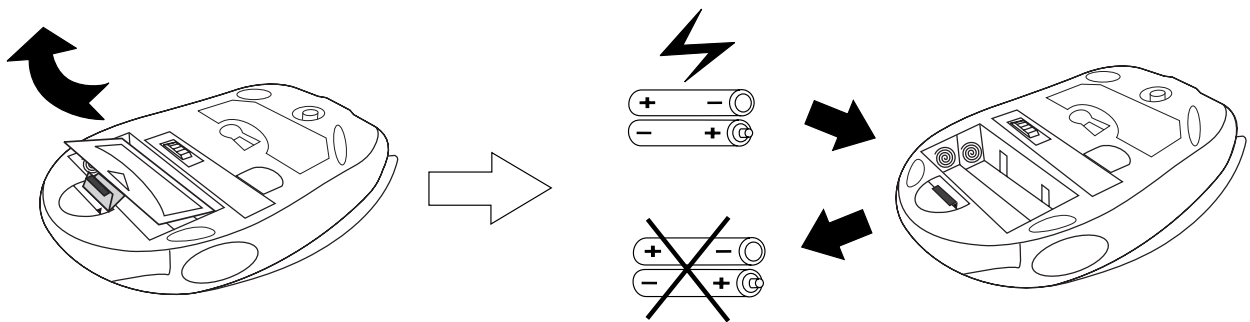

## Removing the battery cover

2. Insert the supplied rechargeable batteries, making sure that the positive (+) and negative (-) ends of each battery match the polarity indicators inside the battery housing.



NOTE: This device uses rechargeable batteries. Please make sure that they are fully charged before initial use.

3. Replace the battery cover back into position until it “clicks” firmly into place.

## Slim Keyboard

- 1 Remove the battery cover located on the bottom of the keyboard by sliding the cover to the left.
- 2 Insert the supplied batteries, making sure that the positive (+) and negative (-) ends of each battery match the polarity indicators inside the battery housing.

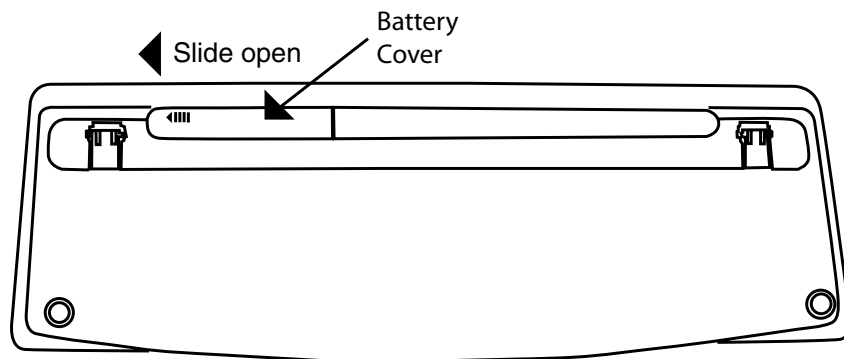

### Removing the battery cover

## Installing the Driver

The driver supports Windows 98 / ME / 2000. If your OS is Windows XP the media hot keys are valid without installing the driver. When you change the interface port, please reinstall the driver.

1. Insert the driver CD-ROM to your computer. The PC system may automatically install the driver through selecting the PC auto-install function.
2. If the PC system does not set the auto-install function, please double click the file "Setup.exe" and follow the setup instructions to complete the driver installation.
3. Restart the computer.



Note: When uninstalling the driver, please make sure that you disable the driver program in the taskbar.

## Connecting the Receiver

Plug the USB receiver into an available USB port on your computer.

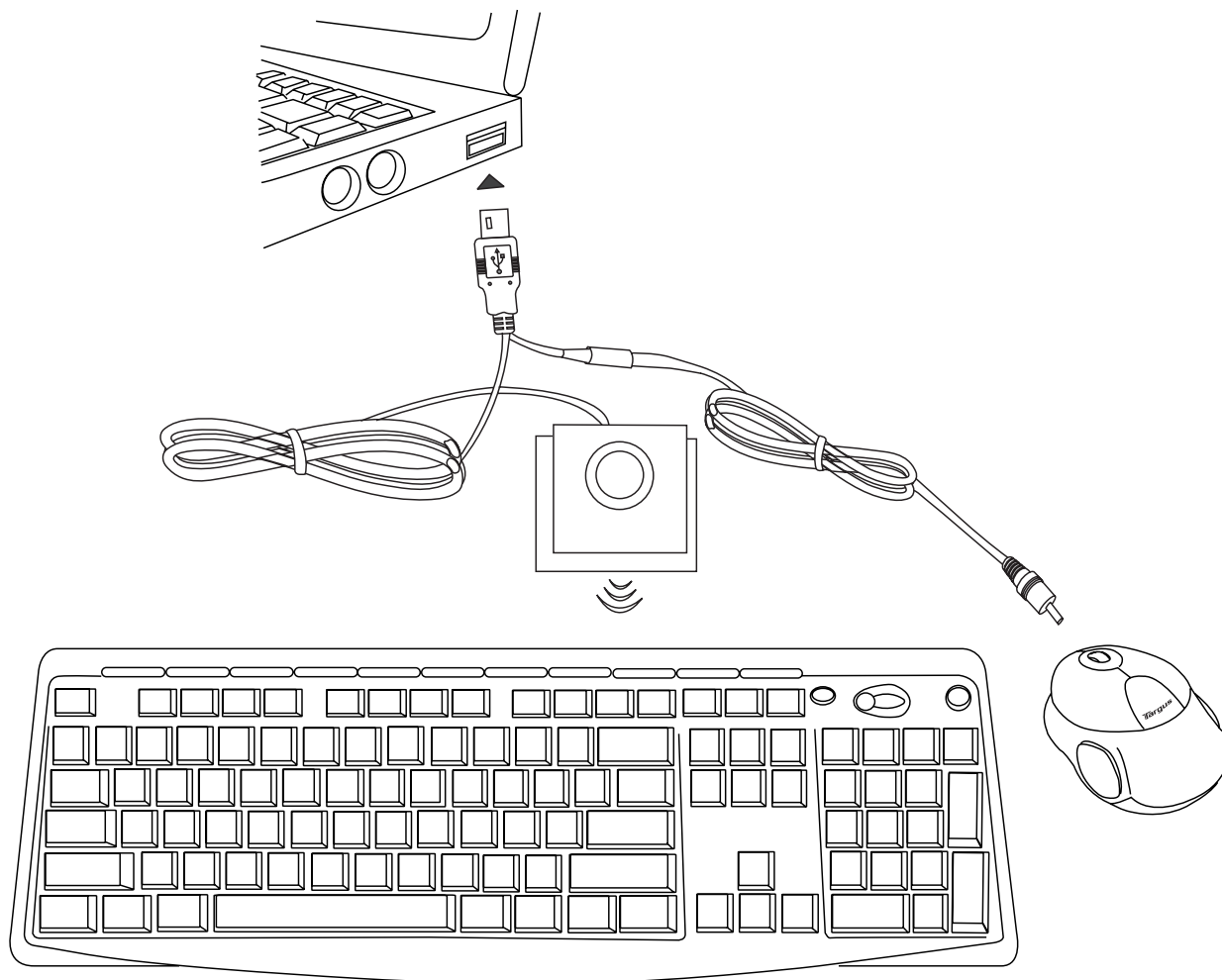

You are now ready to set the identification code to establish a communication link with the receiver.

## Establishing a Communication Link

The keyboard and mouse combo is a plug-n-play device. It should be operating once the USB devices are connected and recognized by the computer.

If the device is not working or you have recently replaced the batteries, please can try to reset the ID code between the receiver and the device. To do this, do the following:



**NOTE:** Make sure that your computer is turned on and has detected the USB receiver before you set the ID code.

## Mouse

- 1 Press and release the connection button on the receiver.
- 2 Switch the power “on” and press the connection button on the bottom of the mouse.

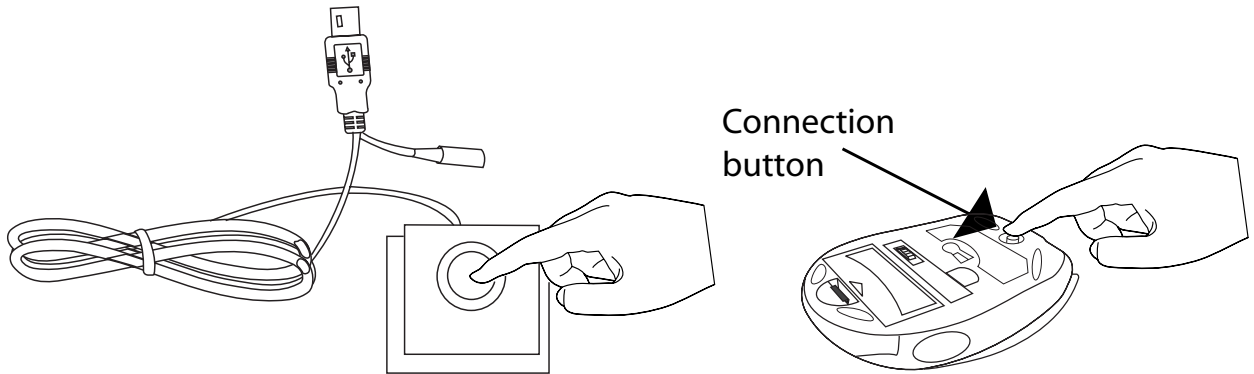

Try moving the mouse around. When the mouse cursor moves, it is set up with an ID and locked with the receiver.

You are now ready to use the mouse.

## Keyboard

- 1 Press and release the connection button on the receiver.
- 2 Press the connection button on the upper right corner of the keyboard.

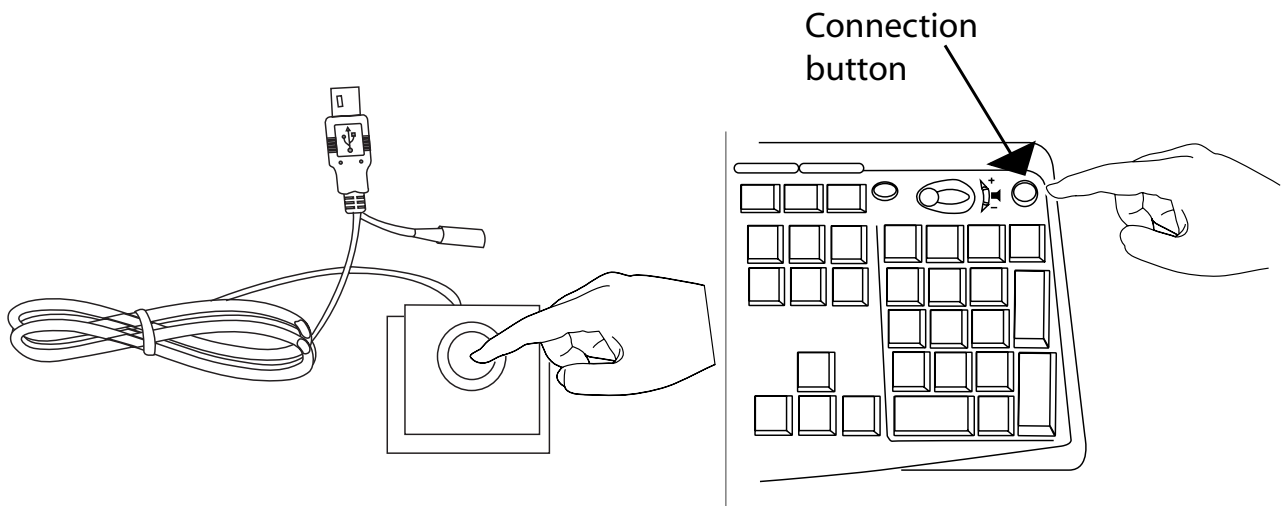

Try pressing the keys on the keyboard to test the connection.

# Charging the Batteries (for optical mouse)

For best results, you should charge the mouse at least 8 hours before using it. You can do this via the supplied USB charge cable. To do this:

- 1 Connect the cable's USB connector into an available USB port on your computer
- 2 Connect the other end to the mouse.



NOTE: TO CONTINUOUSLY CHARGE THE MOUSE VIA THE USB CHARGE CABLE, YOUR COMPUTER MUST BE ON AND AWAKE. FOR BEST RESULTS, TURN OFF YOUR COMPUTER'S POWER MANAGEMENT FEATURE WHILE CHARGING THE MOUSE.

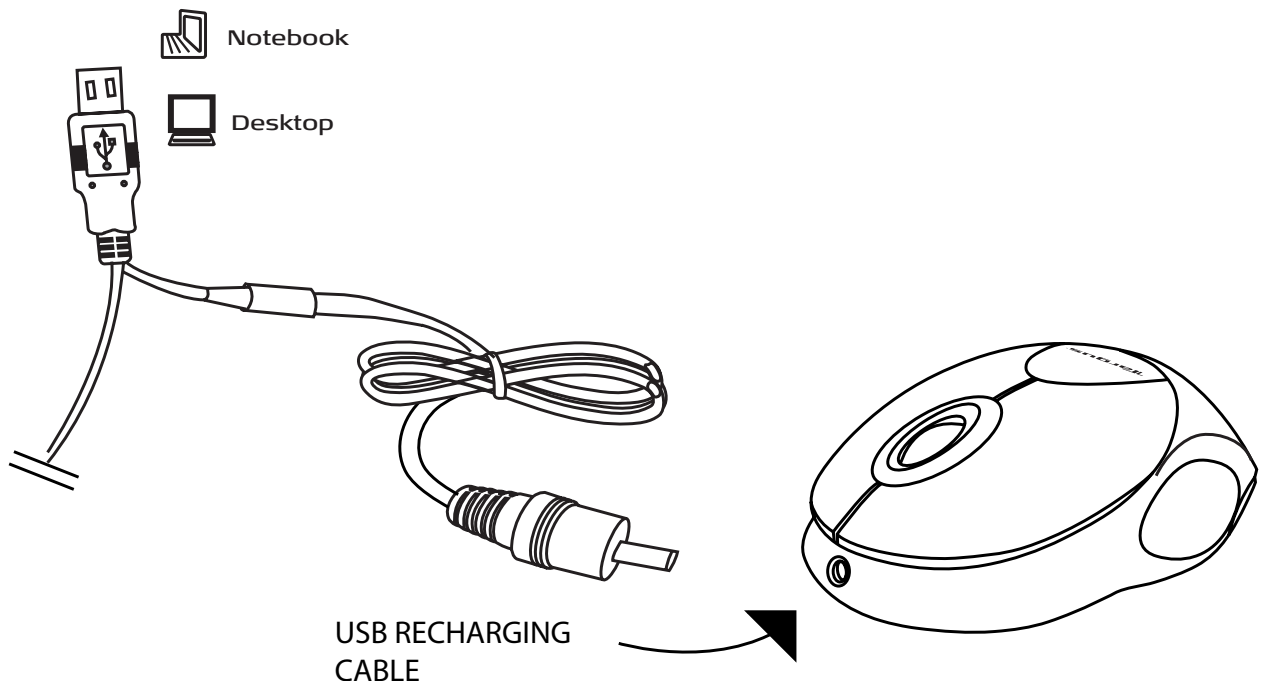

## Operating Notes for Wireless Mice with Recharging Feature via USB Cable

1. Charge the mouse for at least 8 hours before using it. And please make sure only rechargeable batteries (the ones that come with your product) are used.
2. Your computer needs to stay powered on for the mouse to charge. Follow these steps to prevent your computer from going in to Standby or Hibernate:
  - a) Click “Start”
  - b) Click “Control Panel”
  - c) Click “Performance and Maintenance” (Skip in Classic View)
  - d) Click “Power Options”
  - e) Make sure “System Standby:” and “System Hibernates:” under “Plugged in” are set to “Never”
3. If you use your notebook computer’s LCD monitor, please do not close the lid. (Please ignore this step if you use an external monitor with your notebook lid closed.)
4. If your mouse does not respond after a period of inactivity, please wake it up by pressing one of the buttons on the mouse or moving the mouse around.











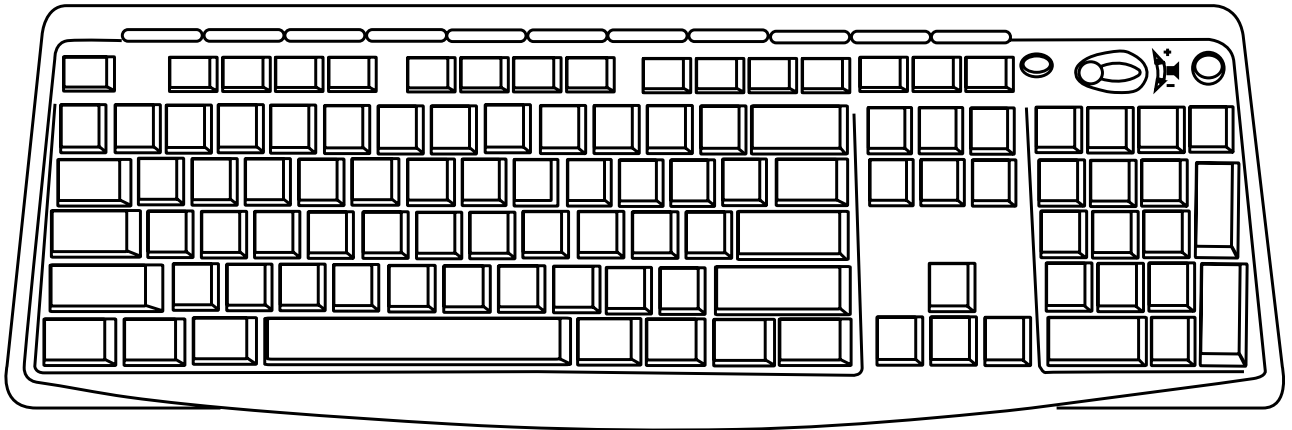

# Using the Slim Keyboard







This slim keyboard performs a number of functions. It can work as a standard keyboard, and a multimedia/internet control panel.

## Using the multimedia/internet controls

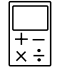









### Media / Internet keys

Key	Function
	Previous Track
	Next Track
	Play / Pause
	Mute
	Volume Up
	Volume Down
	Default Media Player
	Stop

Key	Function
	Turn on Calculator
	Default E-mail Program
	Default Internet browser
	Internet page forward
	Internet page backward
	Refresh page

## Media Players Compatibility

The keyboard is compatible to the following Media Players:

									
iTunes V.6.0.1.3	✓	✓	✓	✓	✓	✓	✓	✓	✓
Musicmatch V.10	✓	✓	✓	✓	✓	✓	✓	✓	✓
Quintessential Player V.4.51	✓	✓	✓	✓	✓	✓	✓	✓	✓
Real Player V.10.5	✓	✓	✓	✓	✓	✓	✓	✓	✓
Windows Media Player V.10	✓	✓	✓	✓	✓	✓	✓	✓	✓



NOTE: DEPENDING ON THE MEDIA PLAYERS' SOFTWARE CAPABILITIES, THE KEYBOARD FUNCTIONS CAN VARY.

INSTRUCTIONS TO SET / CHANGE YOUR DEFAULT MEDIA PLAYER

- GO AND CLICK ON START BUTTON
- GO TO CONTROL PANEL, AND CHOOSE ADD/ REMOVE PROGRAM
- CLICK SET PROGRAM ACCESS AND DEFAULTS ON THE LEFT SIDE MENU. TO PERSONALIZE, CHOOSE CUSTOM IN THE MAIN SCREEN
- CHOOSE YOUR DEFAULT PROGRAM FOR MEDIA PLAYER
- IF YOUR PREFERRED MEDIA PLAYER PROGRAM IS NOT ON THE LIST, CLICK HELP FOR ASSISTANCE

# Troubleshooting

## **What do I do if the mouse/keyboard does not work?**

- Make sure that the polarity of the batteries is correct. The positive (+) and negative (-) ends of each battery must match the positive (+) and negative (-) connections in the battery housing.
- Check that the receiver's USB connector is firmly attached to the USB port on your computer.
- Verify that the device drivers are installed.
- Make sure you have established a communication link. See "Establishing a Communications Link".

## **When I use the mouse/keypad, other wireless devices work more slowly or fail temporarily – what should I do?**

- The mouse and keyboard may cause interference with any cordless, radio-based device such as a telephone, baby monitor, or toy. To reduce interference, move the mouse/keyboard's receiver and the base unit of the affected device as far away from each other as possible.

## **What do I do if the response time of the mouse\ keyboard is slow or it intermittently stops working?**

Try one or more of the following:

- Increase the distance between the receiver and the rest of your computer equipment.

- Increase the distance between the receiver and the base units of other wireless devices.
- Turn off any wireless devices and their base units that are near the mouse/keyboard's receiver.
- If you are using the mouse/keyboard on a metal surface, move it and the receiver to a non-metal surface. Metals, such as iron, aluminum or copper, shield the radio frequency transmission and may slow down the mouse/keyboard's response time or cause the mouse/keyboard to fail temporarily.
- Replace the batteries.

## Technical Support

For technical questions, please visit:

Internet	<a href="http://www.targus.com/support.asp">http://www.targus.com/support.asp</a>
English	<a href="http://www.targus.com/uk/support.asp">http://www.targus.com/uk/support.asp</a>
French	<a href="http://www.targus.com/fr/support.asp">http://www.targus.com/fr/support.asp</a>
German	<a href="http://www.targus.com/de/support.asp">http://www.targus.com/de/support.asp</a>
Spanish	<a href="http://www.targus.com/sp/support.asp">http://www.targus.com/sp/support.asp</a>
Italian	<a href="http://www.targus.com/it/support.asp">http://www.targus.com/it/support.asp</a>

Our knowledgeable staff is also available to answer your questions through one of the following telephone numbers.

Austria	01 795 676 42
Belgium	02-717-2451
Denmark	45 35-25-87 51
Finland	922948016
France	01-6453-9151
Germany	0211-6579-1151
Italy	02-4827-1151
Netherlands	02 0504 0671
Norway	022577729
Portugal	+351 21 415 4123
Spain	91 745 6221
Sweden	08-751-4058
Switzerland	01-212-0007
United Kingdom	020-7744-0330
Eastern Europe & others	+31 0 20 5040671

## **Product Registration**

Targus recommends that you register your Targus accessory shortly after purchasing it. To register your Targus accessory, go to: <http://www.targus.com/registration.asp>

You will need to provide your full name, email address, phone number, and company information (if applicable).

## **Warranty**

Targus warrants this product to be free from defects in materials and workmanship for two years. If your Targus accessory is found to be defective within that time, we will promptly repair or replace it. This warranty does not cover accidental damage, wear and tear, or consequential or incidental loss. Under no conditions is Targus liable for loss of, or damage to a computer; nor loss of, or damage to, programs, records, or data; nor any consequential or incidental damages, even if Targus has been informed of their possibility. This warranty does not affect your statutory rights.

## **Regulatory Compliance**

This device complies with Part 15 of the FCC Rules. Operation is subject to the following two conditions: (1) This device may not cause harmful interference, and (2) This device must accept any interference received, including interference that may cause undesired operation.

## **FCC Statement**

### **Tested to Comply**

This equipment has been tested and found to comply with the limits of a Class B digital device, pursuant to Part 15 of the FCC Rules. These limits are designed to provide reasonable protection against harmful interference in a residential installation. This equipment generates, uses, and can radiate radio frequency energy and if not installed and used in accordance with the instructions, may cause harmful interference to radio communications. However, there is no guarantee that interference will not occur in a particular installation.

If this equipment does cause harmful interference to radio or television reception, which can be determined by turning the

equipment off and on, the user is encouraged to try to correct the interference by one or more of the following measures:

- Reorient or relocate the receiving antenna;
- Increase the separation between the equipment and receiver;
- Connect the equipment into an outlet on a circuit different from that to which the receiver is connected;
- Consult the dealer or an experienced radio/TV technician for help.

This transmitter must not be co-located or operating in conjunction with any other antenna or transmitter. Any changes or modifications not expressly approved by the manufacturer could void the user's authority to operate this equipment.

## **Declaration of Conformity**

Hereby, Targus, declares that this device is in compliance with the essential requirements and other relevant provisions of Directive 1999/5/EC.

## **Targus Recycling Directive**

At the end of this product's useful life please dispose at an appropriate recycling collection point provided in your country. Targus recycling policy is available for viewing at:

[www.targus.com/recycling](http://www.targus.com/recycling)