

HoverCam®

ULTRA 10

Document Camera
Quick Start Guide

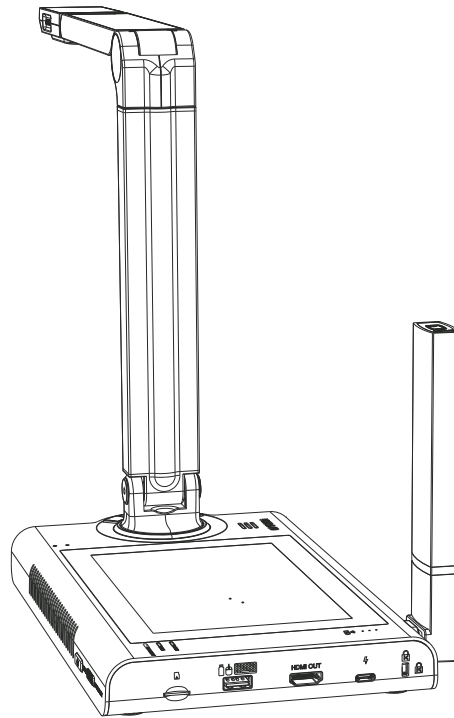

For further assistance please visit www.HoverCam.com/support to download the manual or email us at support@HoverCam.com

1.Powering On

To first use the Ultra 10, you can plug the included power cord into an available power outlet ,and plug the other end of the cord into the Ultra 10 Type-c outlet .

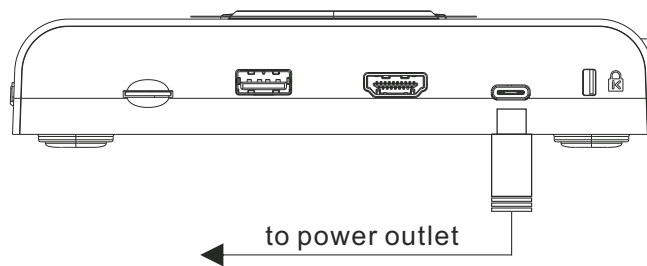

When the battery is full, you can remove the power cord and power it directly through the battery. Next ,press and hold the power button for five seconds . Boot-up time is approximately 60 seconds.

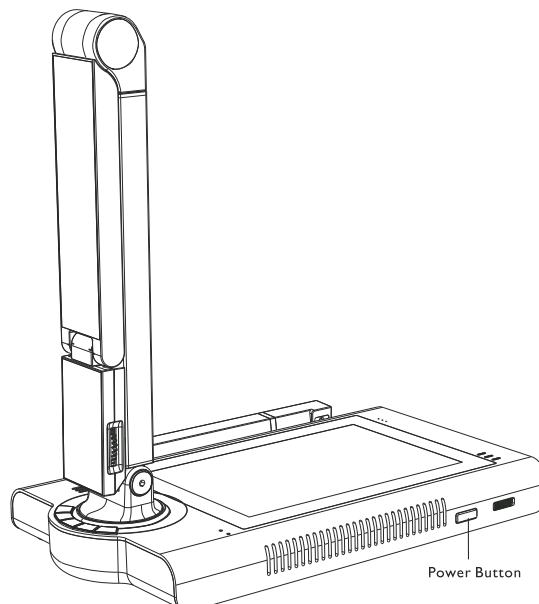

2.Connecting to Display

To connect Ultra 10 with HDMI,simply insert an HDMI cable to the HDMI-Out port on the Ultra 10 and the display you wish to use .Make sure the HDMI Switch is set to “OUT”.

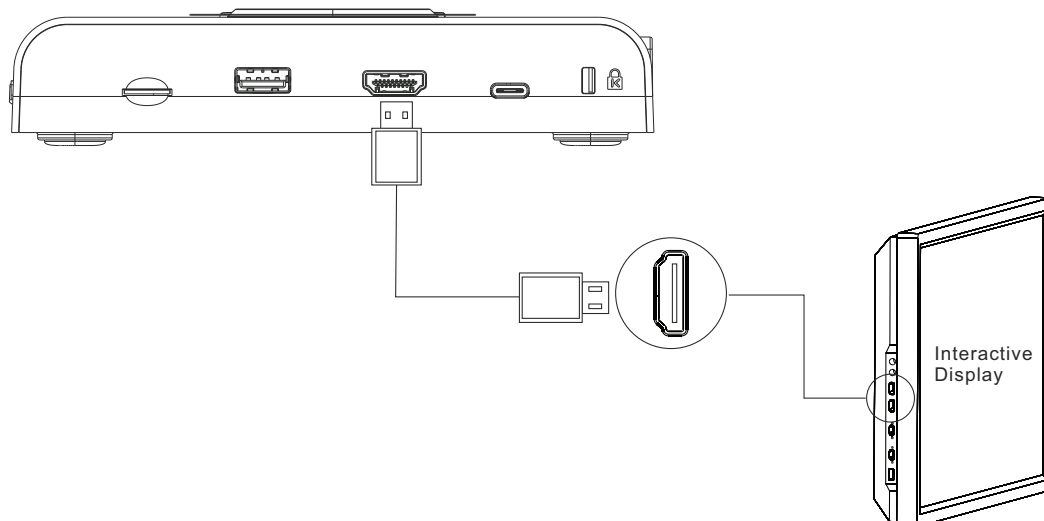

3.Connecting to Display

The Ultra 10 can be operated with a U Disk,with bluetooth mouse or wired mouse, and the keyboard

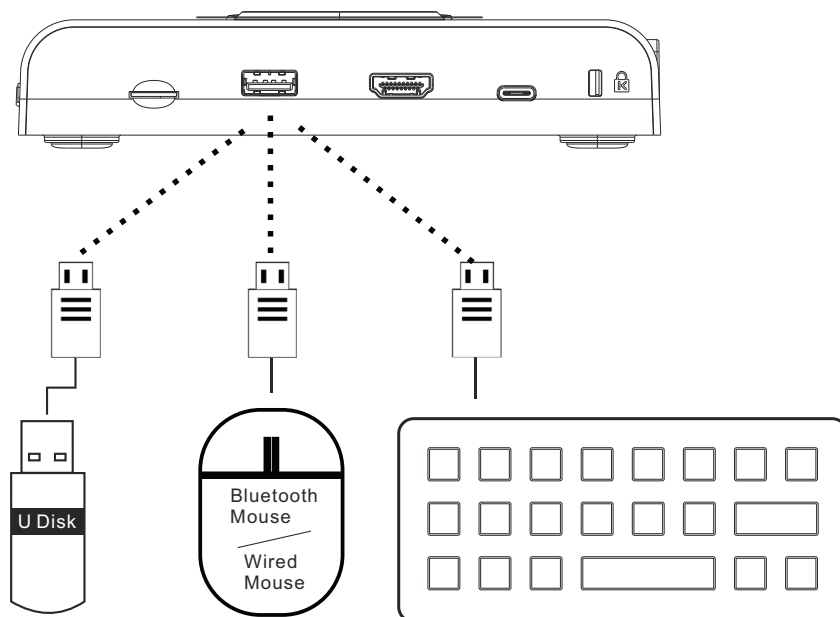

Direct connection to the display device via the HDMI data line or wireless transmission of data to the display device terminal via the receiver

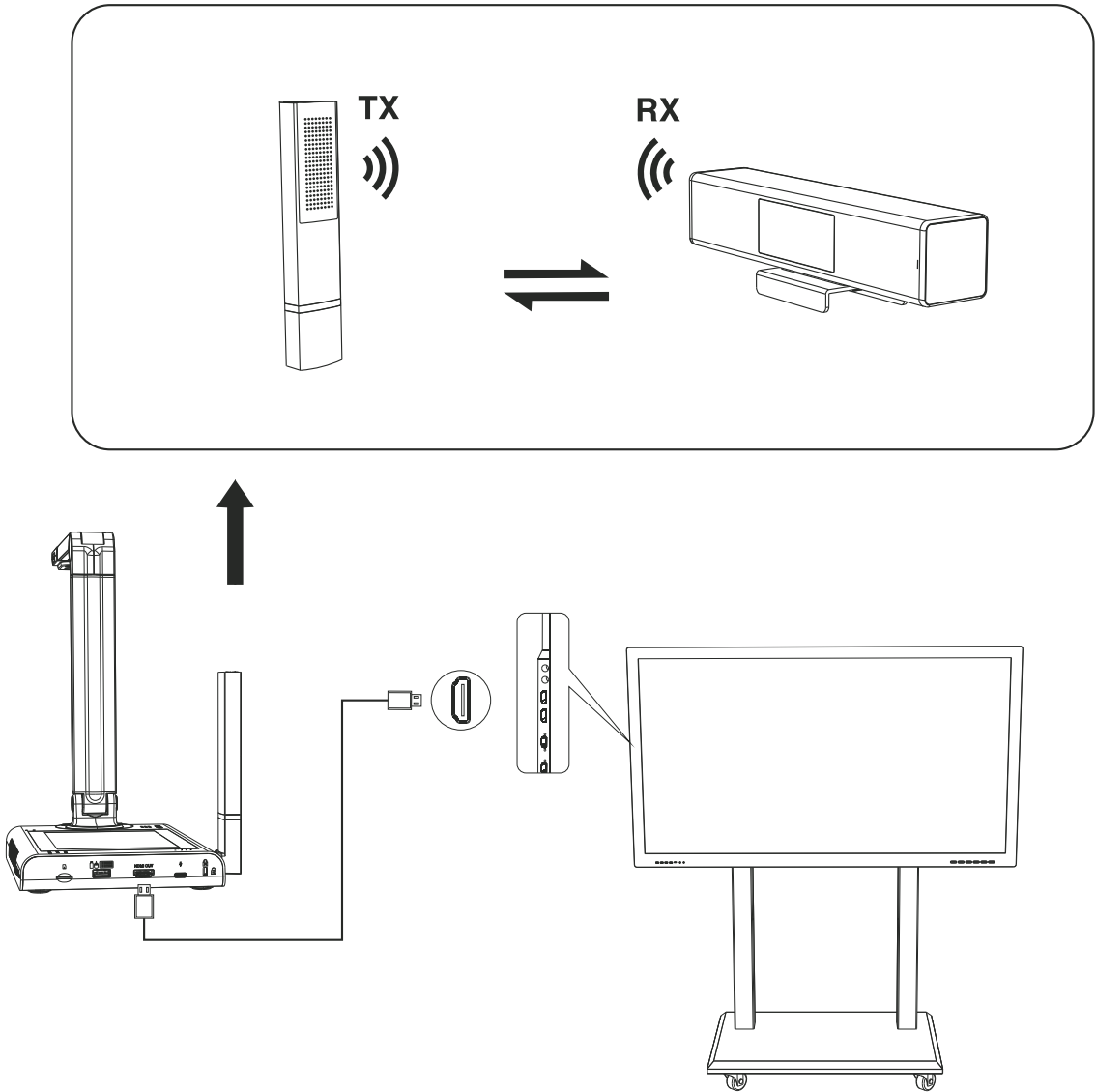

Installation:

Before use the DotCam RED, You need to install the "Flex 11".you can download the software on "www.HoverCam.com",then you found the Support Menu,and Click to Download,Then select "HoverCam Flex 11" for download

Pilot X & Ultra 10 Named In Tech & Learning Best of Show at ISTE 2019!
Pilot 3 AV Accessory of the Year Winner 2019!
Pilot 5 Best of Show at InfoComm 2019!

HOME PRODUCTS SOFTWARE **HoverCam** SUPPORT ABOUT US BUY

Downloads

HoverCam Flex 11

HoverCam Flex 11 is a PC software that uses similar functions and interface to Flex 10. Use Flex 11 for general instruction, audio and video-enable full-motion lesson recording, on-screen annotation, scanning, image projection and more. Flex 11 also offers advanced recording options such as time lapse and slow motion playback.

DOWNLOAD FOR PC

HoverCam Flex 10 for Mac

-
- 5 Select “Install HoverCam Flex 11” and go through the software installation process.



*When installing Flex 11 the installation may take a couple of minutes. Please be patient.

Congratulations! You are now ready to begin using your HoverCam Ultra 10 .

For instructions on using the LCD touch screen control panel - including how to capture an image and record video to the SD card – and for using HoverCam Flex 11 software on the computer, please refer to the User's Manual located on Ultra 10's flash drive or our website at www.HoverCam.com/support.

FCC Statement

This equipment has been tested and found to comply with the limits for a Class B digital device, pursuant to part 15 of the FCC rules. These limits are designed to provide reasonable protection against harmful interference in a residential installation. This equipment generates, uses and can radiate radio frequency energy and, if not installed and used in accordance with the instructions, may cause harmful interference to radio communications. However, there is no guarantee that interference will not occur in a particular installation. If this equipment does cause harmful interference to radio or television reception, which can be determined by turning the equipment off and on, the user is encouraged to try to correct the interference by one or more of the following measures:

- Reorient or relocate the receiving antenna.
- Increase the separation between the equipment and receiver.
- Connect the equipment into an outlet on a circuit different from that to which the receiver is connected.
- Consult the dealer or an experienced radio/TV technician for help.

Responsible for compliance could void the user's authority to operate this equipment. (Example- use only shielded interface cables when connecting to computer or peripheral devices).

Any Changes or modifications not expressly approved by the party responsible for compliance could void the user's authority to operate the equipment.

This equipment complies with Part 15 of the FCC Rules. Operation is subject to the following two conditions:

- (1) This device may not cause harmful interference, and
- (2) This device must accept any interference received, including interference that may cause undesired operation.

FCC Radiation Exposure Statement:

The device has been evaluated to meet general RF exposure requirement. The device can be used in portable exposure condition without restriction.