



Technical Support

 +44(0)845 8381716



support@paxton-access.co.uk

Technical help is available Monday - Friday from **07:00 - 19:00 (GMT)**.

Other documentation on Net2 can be found on our web site - <http://www.paxton-access.co.uk/>

Suitability

Wet environments



Security sensitive doors



Mounted on metal surface



Readers mounted together

500mm
between readers

Fitting



Reader covers

Additional covers are available in black, white, grey, blue and silver. Registered installers can order these free of charge by logging onto the secure installer extranet: <https://extranet.paxton-access.co.uk/index.asp>

If you are not a registered installer please call us on **+44 (0)845 838 1716** for more information.

Wiring

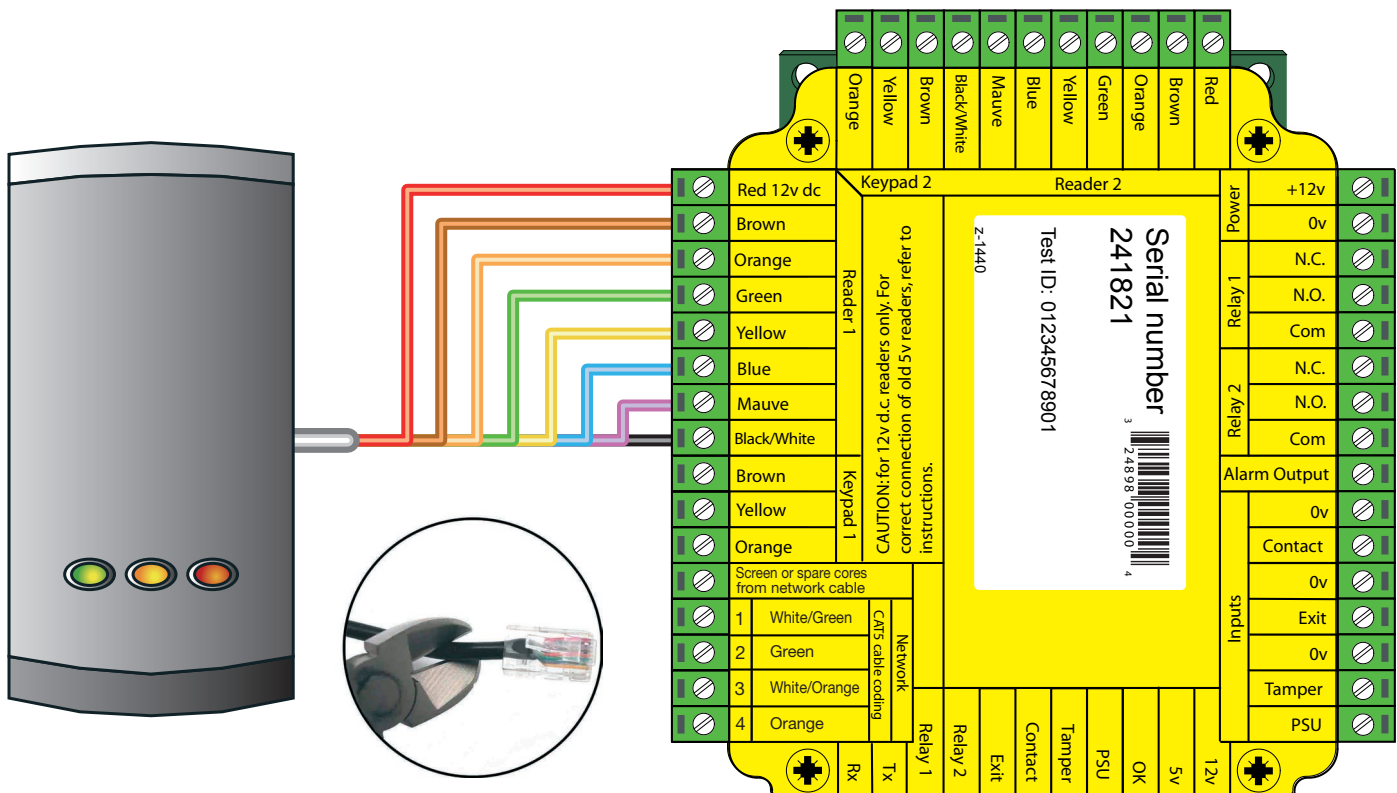
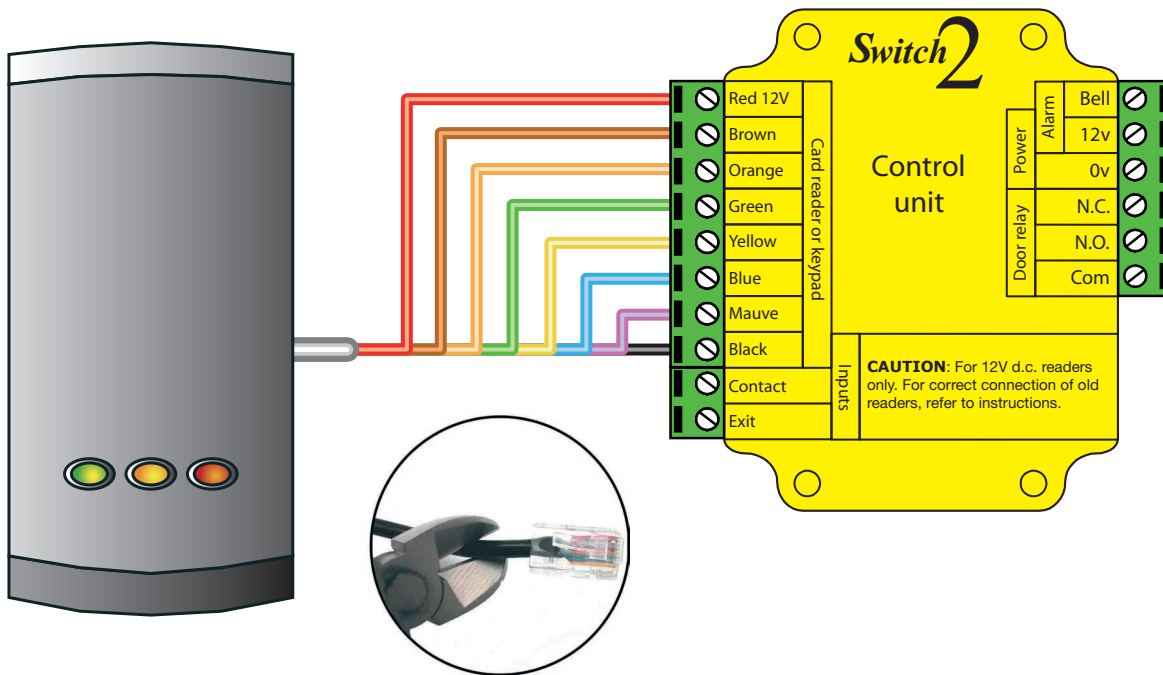

Cable extensions

Readers can be extended using Belden CR9540 10-core overall screened cable. The maximum cable length between reader and control unit is **100m**.

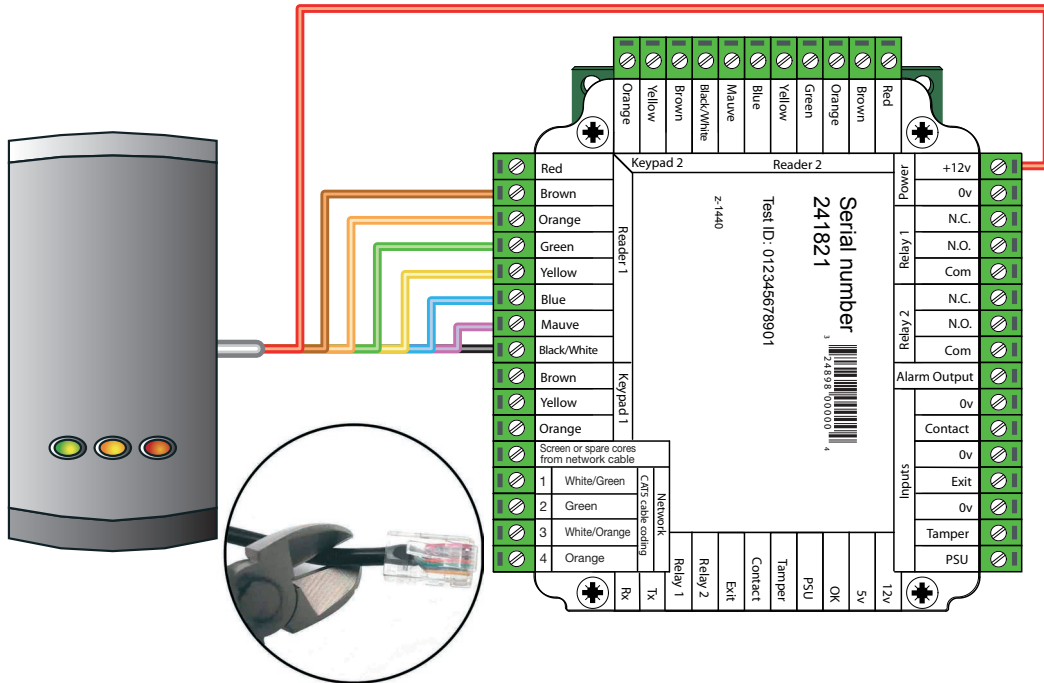
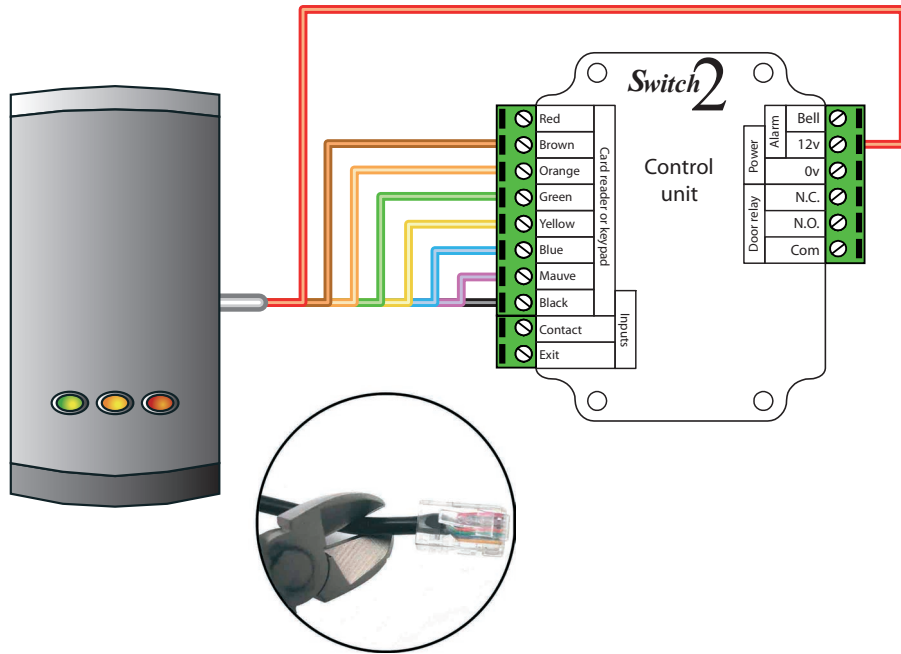

Screw connector wiring

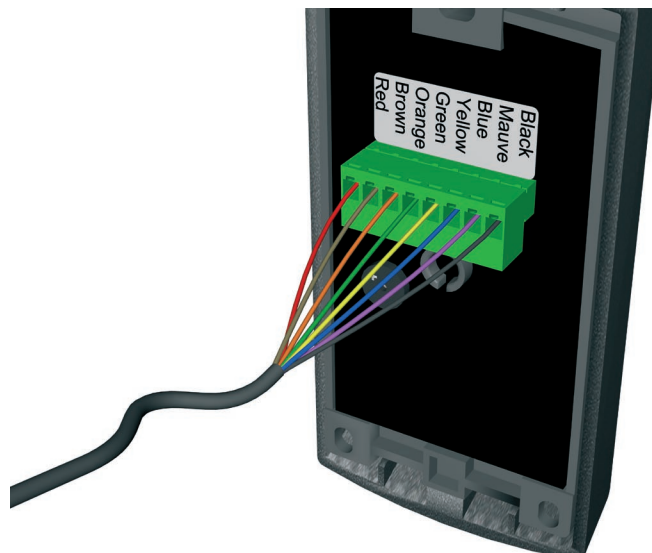

Specifications

Dimensions

PROXIMITY P38 reader	38 w	78 h	12.5 d	mm
PROXIMITY P50 reader	50 w	100 h	15 d	mm
PROXIMITY P75 reader	75 w	143 h	16 d	mm
Cable length		5		m

Electrical

Operating voltage	8 min	12 typ	14 max	V DC
Carrier frequency		125		kHz
Clock & data bit period		600		µs
Operating temperature	-20 min		70 max	deg C

FCC Compliance

This device complies with Part 15 of the FCC Rules. Operation is subject to the following two conditions: (1) this device may not cause harmful interference, and (2) this device must accept any interference received, including interference that may cause undesired operation.

Changes or modifications not expressly approved by the party responsible for compliance could void the user's authority to operate the equipment.