

DESCRIPTION

6 inch LED recessed narrow, medium, or wide beam downlight with 50° cut off specially designed for LED technology. Two-stage reflector system produces smooth distribution with excellent light control and low aperture brightness. Lumen packages include 1000, 1500, 2000 and 3000 lumens with color temperatures of 2700K, 3000K, 3500K, 4000K. Available with dim-to-warm technology – similar to halogen at full power, the 3000K LED warms smoothly as dimmed to 1850K creating a rich warm glow within the space.

SPECIFICATION FEATURES

Lower Shielding Reflector

Self-flanged, spun .050" thick aluminum lower reflector in combination with a lensed upper optical chamber provides superior lumen output with minimal source brightness. Available in all Portfolio Alzak® finishes.

Trim Retention

Lower reflector is retained with two torsion springs holding the flange tightly to the finished ceiling surface.

Plaster Frame / Collar

New Construction Housing: Die cast aluminum 1-1/2" deep collar accommodates ceiling materials up to 2".

Universal Mounting Bracket

Accepts 1/2" EMT, C channel and bar hangers and adjusts 5" vertically from above and below the ceiling.

Junction Box

(4) 1/2" and (2) 3/4" trade size pry outs positioned to allow straight conduit runs. Listed for (8) #12 AWG (four in, four out) 90°C conductors and feed thru branch wiring.

Thermal

Extruded aluminum heat sink conducts heat away from the LED module for optimal performance and long life.

LED

LED system contains a plurality of high brightness white LED's combined with a high reflectance upper reflector and convex transitional lens producing even distribution with no pixilation. Rated for 50,000 hours at 70% lumen maintenance. Auto resetting, thermally protected, LED's are turned off when safe operating temperatures are exceeded. Color variation within 3-step MacAdam ellipses. Flexible disconnect allows for tool-less replacement of LED engine from below ceiling. Available in 80 or 90 CRI.

D2W™ – dim-to-warm shifts CCT from 3000K to 1850K as fixture dims mimicking halogen sources.

Driver

Combination 120-277V 0-10V or 120V trailing edge phase cut driver provides flicker free dimming from 100% to 10%. Optional 1% 0-10V, Fifth Light, DMX or

Catalog #		Type
Project		
Comments		Date
Prepared by		

Lutron® Ecosystem. Driver can be serviced from above or through the aperture.

Code Compliance

Thermally protected and cULus listed for protected wet locations. IP66 rated when used with IP66 gasket kit accessory. Optional City of Chicago environmental air (CCEA) marking for plenum applications. EMI/RFI emissions per FCC 47CFR Part 18 Class B consumer limits. Non-IC rated - Insulation must be kept 3" from top and sides of housing. RoHS Compliant. Photometric testing completed in accordance with IES LM 79 standards. LED life testing completed in accordance with LM 80 standards.

Warranty

5-year warranty on LED housings, LED Modules and LED Trims.



**LD6A10 LD6A15
LD6A20 LD6A30
6L**

1000, 1500 Lumen LED
2000, 3000 Lumen LED

**6-Inch
Narrow, Medium, or Wide Beam
Downlight
New Construction**

D2W™

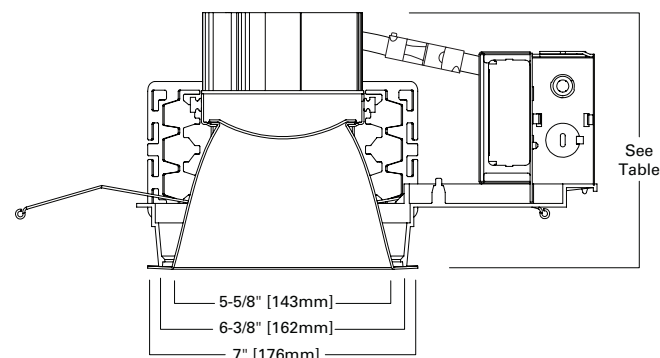

Distribution	Lumens	Height
Narrow	1000/1500	6-3/16"
Medium	1000/1500	6-9/16"
Wide	1000/1500	5-5/8"
Narrow	2000/3000	8-3/16"
Medium	2000/3000	8-9/16"
Wide	2000/3000	6-1/2"

TOP VIEW - NEW CONSTRUCTION

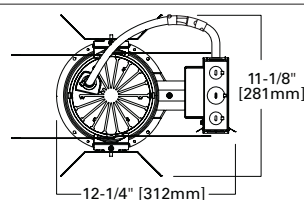

TOP VIEW - NEW CONSTRUCTION WITH BATTERY

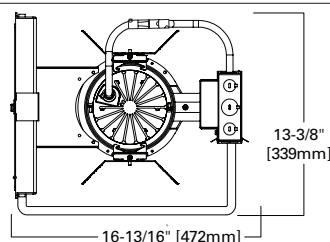

Showerlight



Refer to ENERGY STAR® Qualified Products List.



powered by
fifthlight
technology

ORDERING INFORMATION

EXAMPLE: LD6A15D010TE ERM6A15835 6LM0LI=6" LED Medium Beam Reflector, 1500 Lumen 3,500 K Color with Universal 120 - 277V, 0 - 10 Driver

Housing	Lumens ¹	Driver	Options ^{3,4}	Power Module	Lumens ¹	CRI	Color
LD6A=6" Aperture, LD6ACP=6" Aperture	10=1000 Lumens 15=1500 Lumens 20=2000 Lumens 30=3000 Lumens	1000, 1500, 2000 and 3000 Lumen D010TE=120-277V 0-10V 10% Dimming or Trailing Edge 120V Dimming D5LT=Fifth Light* (DALI) 0% Dimming DE010=0 to 100% Dimming, 120-277V 50/60Hz, 0-10V DL3=1 to 100% Dimming, 120-277V Lutron* Hi-Lume, Ecosystem or 3 Wire DLT=Hi-Lume Forward Phase 2-wire Dimming 120V DMX=DMX 0% Dimming 1000, 1500 and 2000 Lumen D010TR=120-277V 0-10V 10% Dimming or Leading Edge 120V Dimming	EMBOD=7W Bodine® Emergency Module with Remote Test Switch IEMBOD=7W Bodine® Emergency Module with Integral Test Switch ⁵ EM7=7W Emergency Module with Remote Test Switch ⁴ EM14=14W Emergency Module with Remote Test Switch ⁴ IEM7=7W Emergency Module with Integral Test Switch ^{5,4} IEM14=14W Emergency Module with Integral Test Switch ^{5,4}	ERW6A=6", For Wide Beam Reflector ERM6A=6", For Medium Beam Reflector ERN6A=6", For Narrow Beam Reflector	10=1000 Lumens 15=1500 Lumens 20=2000 Lumens 30=3000 Lumens	8=80 CRI 9=90 CRI	27=2700° K 30=3000° K 35=3500° K 40=4000° K 27CP=2700° K, Chicago Plenum 30CP=3000° K, Chicago plenum 35CP=3500° K, Chicago Plenum 40CP=4000° K, Chiago Plenum 30D2W= Dim to warm 3000° K to 1850° K (2000 lumen and below, 90 CRI)

Reflector	Finish	Options	Accessories
Narrow Beam (25°) ⁶ 6LN0=White Polymer Trim Ring 6LN0E=White Polymer Trim Ring, for Integral Emergency 6LN1=Self-flanged 6LN1E=Self-flanged, for Integral Emergency Medium Beam (50°) ⁶ 6LM0=White Polymer Trim Ring 6LM0E=White Polymer Trim Ring, for Integral Emergency 6LM1=Self-flanged 6LM1E=Self-flanged, for Integral Emergency Wide Beam (75°) ⁶ 6LW0=White Polymer Trim Ring 6LW1=Self-flanged	LI=Specular Clear H=Semi-Specular Clear WMH=Warm Haze G=Specular Gold WH=Wheat WHH=Wheat Haze GP=Graphite GPH=Graphite Haze B=Specular Black W=Gloss White 6LM0, 6LM0E, and 6LW0 Only BB=Black Baffle WB=White Baffle	Self-flanged Only WF=White Painted Flange	HB26 =C-channel Bar Hanger, 26" Long, Pair HB50 =C-channel Bar Hanger, 50" Long, Pair RMB22 =Wood Joist Bar Hanger, 22" Long, Pair H347 =347 To 120V Step Down Transformer, 75VA H347200 =347 to 120V Step Down Transformer, 200VA Housings, Specify Slope HS A6 =Slope Adapter for 6" Aperture Housings, Specify Slope TRM6 =Metal Trim Ring, Specify Color ² TRR6 =Rimless Trim Ring ² DT6 =Deco Trim ² LGSKT6IP66 = P66 Gasket Kit

- Notes:**
- 1 Nominal Lumens will vary depending on selected color, driver and reflector finish.
 - 2 Order trim with polymer trim ring (Consult specification sheet for color ordering information and options).
 - 3 Not available with Chicago Plenum.
 - 4 Not CSA approved.
 - 5 For use with narrow or medium beam.
 - 6 With LI finish.

ENERGY

ENERGY DATA			
Sound Rating: Class A standards			
(Values at non-dimming line voltage)			
Minimum Starting Temperature: -30°C (-22°F)			
EMI/RFI: FCC Title 47 CFR, Part 15, Class B (Consumer)			
Input Voltage: UNV (120V - 277V)			
Power Factor: >0.90 (at nominal input 120-277 VAC & 100% of Rated Output Power)			
3000 Lumen D010TE		2000 Lumen D010TE	
Input Power: 43.6W	THD: <17%	Input Power: 31.5W	THD: <20%
120V Input Current: .37A	277V Input Current: .16A	120V Input Current: .27A	277V Input Current: .12A
Maximum Non-IC Ambient Continuous		Maximum Non-IC Ambient Continuous	
Input Frequency: 50/60Hz		Input Frequency: 50/60Hz	
1500 Lumen D010TE		1000 Lumen D010TE	
Input Power: 22.4W	THD: <20%	Input Power: 14.1W	THD: <20%
120V Input Current: .12A	277V Input Current: .09A	120V Input Current: .12A	277V Input Current: .06A
Maximum Non-IC Ambient Continuous		Maximum Non-IC Ambient Continuous	
Input Frequency: 50-60Hz		Input Frequency: 50-60Hz	

Lumens	120V		277V	
	Inrush (A)	Duration (ms)	Inrush (A)	Duration (ms)
900/1000	0.486	0.4	0.848	0.182
1300/1500	0.717	1.58	0.531	1.24
1800/2000	0.832	0.405	1.25	0.788
2800/3000	1.09	0.3	1.23	0.294

PHOTOMETRICS

Test Number P135434		CANDLEPOWER DISTRIBUTION		CONE OF LIGHT		CANDELA TABLE		ZONAL LUMEN SUMMARY			LUMINANCE																													
Platform	LD6A15D010TE	Downlight				Degrees Vertical	Candela	Zone	Lumens	%Fixture	Average Candela Degrees	Average 0° Luminance																												
Element	ERM6A15835 6LM1H			<table border="1"> <thead> <tr> <th>D</th> <th>FC</th> <th>L</th> <th>W</th> </tr> </thead> <tbody> <tr><td>5.5'</td><td>51</td><td>5</td><td>5</td></tr> <tr><td>7'</td><td>32</td><td>6.4</td><td>6.4</td></tr> <tr><td>8'</td><td>24</td><td>7.2</td><td>7.2</td></tr> <tr><td>9'</td><td>19</td><td>8.2</td><td>8.2</td></tr> <tr><td>10'</td><td>16</td><td>9</td><td>9</td></tr> <tr><td>12'</td><td>11</td><td>11</td><td>11</td></tr> </tbody> </table>		D	FC	L	W	5.5'	51	5	5	7'	32	6.4	6.4	8'	24	7.2	7.2	9'	19	8.2	8.2	10'	16	9	9	12'	11	11	11	0	1549	0-30	969	68.2	45	11339
D	FC	L	W																																					
5.5'	51	5	5																																					
7'	32	6.4	6.4																																					
8'	24	7.2	7.2																																					
9'	19	8.2	8.2																																					
10'	16	9	9																																					
12'	11	11	11																																					
Lumens	1421	5	1514	0-40	1280	90.1																																		
Efficacy	62.9 Lm/W	15	1306	0-60	1410	99.2	55	3048																																
SC	0.9	25	1023	0-90	1421	100.0																																		
		35	493	90-180	0	0.0	75	403																																
		45	123	0-180	1421	100.0																																		
		55	27				85	0																																
		65	8																																					
		75	2																																					
		85	0																																					
		90	0																																					

Test Number P135314		CANDLEPOWER DISTRIBUTION		CONE OF LIGHT		CANDELA TABLE		ZONAL LUMEN SUMMARY			LUMINANCE																													
Platform	LD6A15D010TE	Downlight				Degrees Vertical	Candela	Zone	Lumens	%Fixture	Average Candela Degrees	Average 0° Luminance																												
Element	ERM6A15835 6LM1LI			<table border="1"> <thead> <tr> <th>D</th> <th>FC</th> <th>L</th> <th>W</th> </tr> </thead> <tbody> <tr><td>5.5'</td><td>73</td><td>4.4</td><td>4.4</td></tr> <tr><td>7'</td><td>45</td><td>5.6</td><td>5.6</td></tr> <tr><td>8'</td><td>34</td><td>6.4</td><td>6.4</td></tr> <tr><td>9'</td><td>27</td><td>7.2</td><td>7.2</td></tr> <tr><td>10'</td><td>22</td><td>8</td><td>8</td></tr> <tr><td>12'</td><td>15</td><td>9.6</td><td>9.6</td></tr> </tbody> </table>		D	FC	L	W	5.5'	73	4.4	4.4	7'	45	5.6	5.6	8'	34	6.4	6.4	9'	27	7.2	7.2	10'	22	8	8	12'	15	9.6	9.6	0	2195	0-30	1286	80.8	45	3072
D	FC	L	W																																					
5.5'	73	4.4	4.4																																					
7'	45	5.6	5.6																																					
8'	34	6.4	6.4																																					
9'	27	7.2	7.2																																					
10'	22	8	8																																					
12'	15	9.6	9.6																																					
Lumens	1592	5	2219	0-40	1550	97.4																																		
Efficacy	70.4 Lm/W	15	1968	0-60	1590	99.9	55	489																																
SC	0.8	25	1176	0-90	1592	100.0																																		
		35	409	90-180	0	0.0	75	277																																
		45	33	0-180	1592	100.0																																		
		55	4				85	0																																
		65	1																																					
		75	1																																					
		85	0																																					
		90	0																																					

Test Number P135490		CANDLEPOWER DISTRIBUTION		CONE OF LIGHT		CANDELA TABLE		ZONAL LUMEN SUMMARY			LUMINANCE																													
Platform	LD6A30D010TE	Downlight				Degrees Vertical	Candela	Zone	Lumens	%Fixture	Average Candela Degrees	Average 0° Luminance																												
Element	ERM6A30835 6LM1H			<table border="1"> <thead> <tr> <th>D</th> <th>FC</th> <th>L</th> <th>W</th> </tr> </thead> <tbody> <tr><td>5.5'</td><td>95</td><td>5</td><td>5</td></tr> <tr><td>7'</td><td>59</td><td>6.4</td><td>6.4</td></tr> <tr><td>8'</td><td>45</td><td>7.2</td><td>7.2</td></tr> <tr><td>9'</td><td>36</td><td>8.2</td><td>8.2</td></tr> <tr><td>10'</td><td>29</td><td>9</td><td>9</td></tr> <tr><td>12'</td><td>20</td><td>11</td><td>11</td></tr> </tbody> </table>		D	FC	L	W	5.5'	95	5	5	7'	59	6.4	6.4	8'	45	7.2	7.2	9'	36	8.2	8.2	10'	29	9	9	12'	20	11	11	0	2882	0-30	1804	68.2	45	21101
D	FC	L	W																																					
5.5'	95	5	5																																					
7'	59	6.4	6.4																																					
8'	45	7.2	7.2																																					
9'	36	8.2	8.2																																					
10'	29	9	9																																					
12'	20	11	11																																					
Lumens	2644	5	2818	0-40	2382	90.1																																		
Efficacy	58.2 Lm/W	15	2431	0-60	2623	99.2	55	5664																																
SC	0.9	25	1903	0-90	2644	100.0																																		
		35	918	90-180	0	0.0	75	731																																
		45	229	0-180	2644	100.0																																		
		55	50				85	0																																
		65	15																																					
		75	3																																					
		85	0																																					
		90	0																																					

Test Number P133453		CANDLEPOWER DISTRIBUTION		CONE OF LIGHT		CANDELA TABLE		ZONAL LUMEN SUMMARY			LUMINANCE																													
Platform	LD6A15D010TE	Downlight				Degrees Vertical	Candela	Zone	Lumens	%Fixture	Average Candela Degrees	Average 0° Luminance																												
Element	ERN6A15835 6LN1LI			<table border="1"> <thead> <tr> <th>D</th> <th>FC</th> <th>L</th> <th>W</th> </tr> </thead> <tbody> <tr><td>5.5'</td><td>147</td><td>2.2</td><td>2.2</td></tr> <tr><td>7'</td><td>91</td><td>2.8</td><td>2.8</td></tr> <tr><td>8'</td><td>70</td><td>3.2</td><td>3.2</td></tr> <tr><td>9'</td><td>55</td><td>3.6</td><td>3.6</td></tr> <tr><td>10'</td><td>45</td><td>4</td><td>4</td></tr> <tr><td>12'</td><td>31</td><td>4.8</td><td>4.8</td></tr> </tbody> </table>		D	FC	L	W	5.5'	147	2.2	2.2	7'	91	2.8	2.8	8'	70	3.2	3.2	9'	55	3.6	3.6	10'	45	4	4	12'	31	4.8	4.8	0	4459	0-30	1236	80.8	45	4355
D	FC	L	W																																					
5.5'	147	2.2	2.2																																					
7'	91	2.8	2.8																																					
8'	70	3.2	3.2																																					
9'	55	3.6	3.6																																					
10'	45	4	4																																					
12'	31	4.8	4.8																																					
Lumens	1530	5	3856	0-40	1478	96.6																																		
Efficacy	67.7 Lm/W	15	1782	0-60	1529	99.9	55	364																																
SC	0.4	25	869	0-90	1530	100.0																																		
		35	394	90-180	0	0.0	75	0																																
		45	47	0-180	1530	100.0																																		
		55	3				85	0																																
		65	1																																					
		75	0																																					
		85	0																																					
		90	0																																					

PHOTOMETRICS

TEST DATA		CANDLEPOWER DISTRIBUTION		CONE OF LIGHT				CANDELA TABLE		ZONAL LUMEN SUMMARY			LUMINANCE	
Test Number	P136034							Degrees Vertical	Candela	Zone	Lumens	%Fixture	Average Candela Degrees	Average 0° Luminance
Platform	LD6A15D010TE			D	FC	L	W	0	1055	0-30	934	57.0	45	25963
Element	ERW6A15835 6LW1LI			5.5'	36	6.6	6.6	5	1078	0-40	1366	83.4	55	4663
Lumens	1638			7'	22	8.4	8.4	15	1205	0-60	1634	99.7	65	355
Efficacy	72.5 Lm/W			8'	17	9.6	9.6	25	1079	0-90	1638	100.0	75	277
SC	1.1	9'	14	10.8	10.8	35	700	90-180	0	0.0	85	0		
		10'	11	12	12	45	281	0-180	1638	100.0	85	0		
		12'	8	14.4	14.4	55	41	0	0	0	0	0	0	
						65	2							
						75	1							
						85	0							
				90	0									

EM MULTIPLIER DATA

LUMENS	EM MULTIPLIER	
	7	14
900/1000	0.50	0.99
1300/1500	0.29	0.57
1800/2000	0.22	0.44
2800/3000	0.16	0.32