



Ring

Disk

Gotham Architectural Downlighting
Decorative Fluorescent Downlights

6" AF
Drop Luminous Ring/Disk

Horizontal Lamp
Double Twin-Tube or Triple-Tube

FEATURES

OPTICAL SYSTEM

- Self-flanged, semi-specular or matte-diffuse reflector. Patented Bounding Ray™ Optical Principle design (U.S. Patent No. 5,800,050) provides lamp before lamp image and smooth transition from top of reflector to bottom. Minimum flange matches reflector finish.
- Decorative element: 3/16"-thick low-iron glass with polished edges and sandblasted finish. Ring or disk style available. Precision-machined aluminum hardware with threaded spacers for easy maintenance.

MECHANICAL SYSTEM

- 16-gauge galvanized steel mounting/plaster frame with integral yoke to retain optical system. Maximum 7/8" ceiling thickness.
- 16-gauge galvanized steel mounting bars with continuous 4" vertical adjustment are shipped pre-installed. Post-installation adjustment possible without the use of tools from above or below the ceiling.
- Galvanized steel junction box with hinged access covers and spring latch. Two combination 1/2"-3/4" and three 1/2" knockouts for straight-through conduit runs. Capacity: 8 (4 in, 4 out) No. 12 AWG conductors, rated for 90°C.

ELECTRICAL SYSTEM

- Horizontally mounted, four-pin, positive-latch, thermoplastic socket.
- Class P, thermally protected, high-power-factor electronic ballast mounted to the junction box.
- SIMPLY5™ technology available.

LISTING

- Fixtures are UL Listed for thru-branch wiring, non-IC recessed mounting and damp locations. Listed and labeled to comply with Canadian standards.

WARRANTY

- 1-year limited warranty. Complete warranty terms located at www.acuitybrands.com/CustomerResources/Terms_and_conditions.aspx

ORDERING INFORMATION

EXAMPLE: AF 1/26TRT 6AR DLR MVOLT

Series	Wattage/Lamp	Aperture/Trim color	Decorative element	Finish	Voltage	Ballast ³
AF	1/13DTT	6AR Clear 6PR Pewter 6WTR Wheat 6WR ¹ White painted	DLR Drop luminous ring DLD Drop luminous disk	(blank) Semi-specular	MVOLT ² 120 277 347	(blank) Electronic ballast
	1/18DTT			LD Matte-diffuse		ECOS ^{2,4} EcoSystem® electronic dimming ballast. Minimum dimming level 5%
	1/26DTT			ADEZ ^{4,5} Advance Mark 10® electronic dimming ballast. Minimum dimming level 5%		
	2/13DTT					ADZT ^{4,5} Advance Mark 7® electronic dimming ballast. Minimum dimming level 5%
	2/18DTT					S5 ⁶ SIMPLY5™ system ballast. Minimum dimming level 15%
	2/26DTT					
	1/13TRT					
	1/18TRT					
	1/26TRT					
	1/32TRT					
	1/42TRT					

Options	
EL ^{5,7}	Emergency battery pack with integral test switch. Available with DLR only.
ELR ^{5,7}	Emergency battery pack. Remote test switch provided
ELHL ^{5,7}	High lumen output emergency battery pack. Integral test switch provided Available with DLR only.
ELRHL ^{5,7}	High lumen output emergency battery pack. Remote test switch provided
GMF ⁵	Single, slow-blow fuse
GLR ⁵	Single, fast-blow fuse
TRW	White painted flange (standard on WR)
TRBL	Black painted flange
WLP	With 3500 K lamp (shipped separately)
RRL ⁸	RELOC®-ready luminaire. Provides compatibility with Lithonia RELOC system. Access above ceiling required
CP ⁹	Chicago plenum
BDP ^{9,10}	Ballast disconnect plug
HW	Hardwire for S5 system; replaces RELOC
NEPP	Interface for Sensor Switch® nLight® network with integral power supply. Refer to TN-623-01.
WRL ¹¹	Wattage restriction label

All dimensions are inches (centimeters) unless otherwise noted.

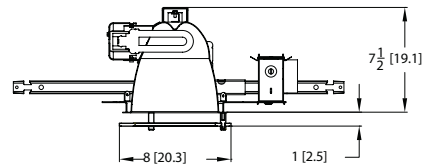
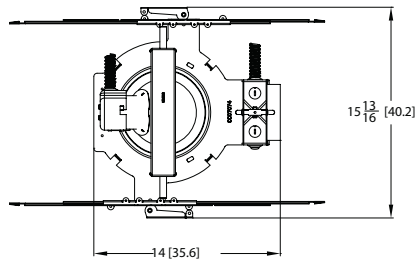

Aperture: 6-1/4 (15.9)
 Ceiling Opening: 7-1/8 (18.1)
 Overlap Trim: 7-1/2 (19.1)

DIMENSIONAL NOTES

- Maximum height depends on lamp type.
- 6-3/4" for double twin-tube (1/13DTT, 1/18DTT, 1/26DTT, 2/13DTT, 2/18DTT and 2/26DTT).
- 7-3/4" for triple-tube (1/13TRT, 1/18TRT, 1/26TRT, 1/32TRT and 1/42TRT).

ORDERING NOTES

1. Not available with finishes.
2. Multi-volt electronic ballast capable of operating on any voltage from 120V through 277V, 50 or 60 Hz.
3. For additional ballast types, refer to [TECH-250](#).
4. Not available with 13W.
5. Available in 120V or 277V only.
6. SIMPLY5™ includes 9" S5 MLC RELOC wiring system (shipped separately). Available in 120V or 277V only. Not available in 13W or 18W. See simply5.net for more information.
7. For dimensional changes, refer to [TECH-140](#).
8. For compatible RELOC systems, refer to [TECH-110](#).
9. Not available with emergency options.
10. Meets codes that require in-fixture disconnect.
11. Must specify wattage. Ex.: WRL32

Distribution Curve Distribution Data Output Data Coefficient of Utilization Illuminance: Single Luminaire 30" Above Floor

AF 1/26TRT 6AR DLD

(1) CF26TRT, 1800 LUMENS PER LAMP, 1.1 S/MH, TEST NO. LTL19760

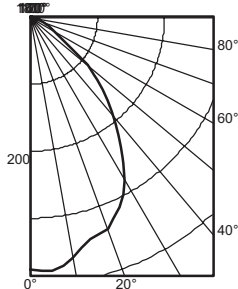

Ave Lumens	Zone	Lumens	% Lamp	pf	pc	pw	80%			70%			50%		
							50%	30%	10%	50%	30%	10%	50%	30%	10%
0	0° - 30°	276.5	15.4	0	43	43	43	42	42	42	40	40	40		
5	0° - 40°	423.2	23.5	1	39	38	37	38	37	36	37	36	35		
15	0° - 60°	597.8	33.2	2	35	33	31	34	33	31	33	32	30		
25	0° - 90°	649.6	36.1	3	32	29	27	31	29	27	30	28	27		
35	90° - 120°	2.1	0.1	4	29	26	24	28	26	24	27	25	24		
45	90° - 130°	2.4	0.1	5	26	23	21	26	23	21	25	23	21		
55	90° - 150°	4.2	0.2	6	24	21	19	24	21	19	23	21	19		
65	90° - 180°	5.0	0.3	7	22	19	17	22	19	17	21	19	17		
75	0° - 180°	654.6	*36.4	8	20	18	16	20	18	16	20	17	16		
85				9	19	16	14	19	16	14	18	16	14		
90				10	18	15	13	17	15	13	17	15	13		

Mounting Height	Initial Center Beam	50% beam - 58.8°		10% beam - 95.9°	
		Diameter	FC	Diameter	FC
8.0	12.5	6.2	6.2	12.2	1.2
10.0	6.7	8.5	3.4	16.6	0.7
12.0	4.2	10.7	2.1	21.1	0.4
14.0	2.9	13.0	1.4	25.5	0.3
16.0	2.1	15.2	1.0	29.9	0.2

AF 1/26TRT 6AR DLR

(1) CF26TRT, 1800 LUMENS PER LAMP, 1.1 S/MH, TEST NO. LTL19748

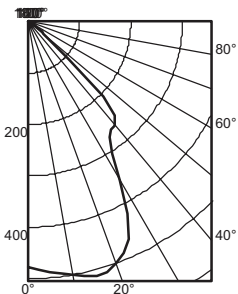

Ave Lumens	Zone	Lumens	% Lamp	pf	pc	pw	80%			70%			50%		
							50%	30%	10%	50%	30%	10%	50%	30%	10%
0	0° - 30°	397.3	22.1	0	51	51	51	50	50	50	47	47	47		
5	0° - 40°	577.6	32.1	1	46	45	44	46	44	43	44	43	42		
15	0° - 60°	742.0	41.2	2	42	40	39	42	40	38	40	39	37		
25	0° - 90°	763.1	42.4	3	39	36	34	38	36	34	37	35	33		
35	90° - 120°	1.8	0.1	4	36	33	31	35	33	31	34	32	30		
45	90° - 130°	2.1	0.1	5	33	30	28	32	30	28	32	29	27		
55	90° - 150°	4.0	0.2	6	30	27	25	30	27	25	29	27	25		
65	90° - 180°	4.7	0.3	7	28	25	23	28	25	23	27	25	23		
75	0° - 180°	767.8	*42.7	8	26	23	21	26	23	21	25	23	21		
85				9	24	21	19	24	21	19	24	21	19		
90				10	23	20	18	22	20	18	22	20	18		

Mounting Height	Initial Center Beam	50% beam - 59.5°		10% beam - 93.1°	
		Diameter	FC	Diameter	FC
8.0	15.8	6.3	7.9	11.6	1.6
10.0	8.5	8.6	4.2	15.8	0.8
12.0	5.3	10.9	2.6	20.0	0.5
14.0	3.6	13.1	1.8	24.3	0.4
16.0	2.6	15.4	1.3	28.5	0.3

AF 1/32TRT 6AR DLD

(1) CF32TRT, 2400 LUMENS PER LAMP, 1.1 S/MH, TEST NO. LTL19761

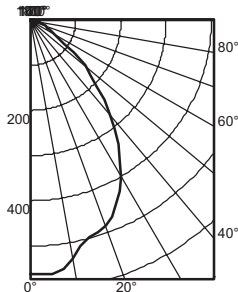

Ave Lumens	Zone	Lumens	% Lamp	pf	pc	pw	80%			70%			50%		
							50%	30%	10%	50%	30%	10%	50%	30%	10%
0	0° - 30°	400.7	16.7	0	46	46	46	45	45	45	43	43	43		
5	0° - 40°	610.1	25.4	1	42	41	39	41	40	39	39	38	37		
15	0° - 60°	856.4	35.7	2	38	36	34	37	35	33	36	34	33		
25	0° - 90°	929.9	38.7	3	34	32	29	34	31	29	32	30	29		
35	90° - 120°	3.2	0.1	4	31	28	26	30	28	26	30	27	25		
45	90° - 130°	3.6	0.1	5	28	25	23	28	25	23	27	25	23		
55	90° - 150°	6.2	0.3	6	26	23	21	26	23	21	25	22	20		
65	90° - 180°	7.2	0.3	7	24	21	19	23	21	19	23	20	19		
75	0° - 180°	937.1	*39.0	8	22	19	17	22	19	17	21	19	17		
85				9	20	18	16	20	17	16	20	17	15		
90				10	19	16	14	19	16	14	18	16	14		

Mounting Height	Initial Center Beam	50% beam - 57.1°		10% beam - 94.8°	
		Diameter	FC	Diameter	FC
8.0	18.6	6.0	9.3	12.0	1.9
10.0	10.0	8.2	5.0	16.3	1.0
12.0	6.2	10.3	3.1	20.7	0.6
14.0	4.3	12.5	2.1	25.0	0.4
16.0	3.1	14.7	1.5	29.3	0.3

AF 1/32TRT 6AR DLR

(1) CF32TRT, 2400 LUMENS PER LAMP, 1.1 S/MH, TEST NO. LTL19749

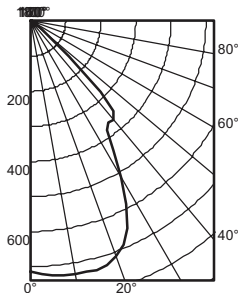

Ave Lumens	Zone	Lumens	% Lamp	pf	pc	pw	80%			70%			50%		
							50%	30%	10%	50%	30%	10%	50%	30%	10%
0	0° - 30°	567.8	23.7	0	54	54	54	52	52	52	50	50	50		
5	0° - 40°	820.2	34.2	1	49	48	47	48	47	46	46	45	44		
15	0° - 60°	1047.4	43.6	2	45	43	41	44	42	41	43	41	40		
25	0° - 90°	1077.4	44.9	3	41	39	36	41	38	36	39	37	36		
35	90° - 120°	1.7	0.1	4	38	35	33	37	35	32	36	34	32		
45	90° - 130°	2.1	0.1	5	35	32	30	34	32	29	34	31	29		
55	90° - 150°	5.0	0.2	6	32	29	27	32	29	27	31	28	26		
65	90° - 180°	6.1	0.3	7	30	27	24	30	27	24	29	26	24		
75	0° - 180°	1083.5	*45.1	8	28	25	22	27	24	22	27	24	22		
85				9	26	23	21	26	23	21	25	22	21		
90				10	24	21	19	24	21	19	23	21	19		

Mounting Height	Initial Center Beam	50% beam - 58.5°		10% beam - 92.5°	
		Diameter	FC	Diameter	FC
8.0	23.6	6.2	11.8	11.5	2.4
10.0	12.7	8.4	6.3	15.7	1.3
12.0	7.9	10.6	4.0	19.8	0.8
14.0	5.4	12.9	2.7	24.0	0.5
16.0	3.9	15.1	2.0	28.2	0.4

PHOTOMETRY NOTES

- Tested to current IES and NEMA standards under stabilized laboratory conditions.
- Actual performance may differ as a result of end-user environment and application.
- Consult factory or IES file for microgroove baffle, black cone or other photometric reports.