



PHOENIX[®]
DURABILITY X DESIGN™

Metallic LED VP Series

LED Vaporproof Fixture

US Patent No. D642,327, US8,348,476 B2 and D650,518

Aluminum and brass vaporproof fixtures UL rated for hazardous and wet locations

Durable design with an array of mounting and globe options

For use on marine vessels, mining equipment, tankers and other demanding applications

LED technology increases efficiency, eliminates maintenance and supports green initiatives



Dimensions

Ceiling Mount

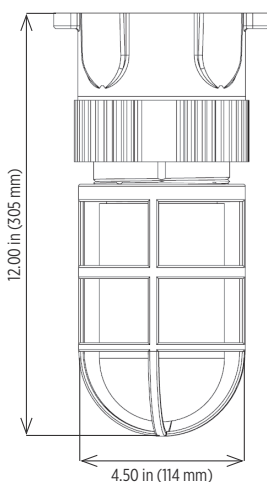

Wall Mount

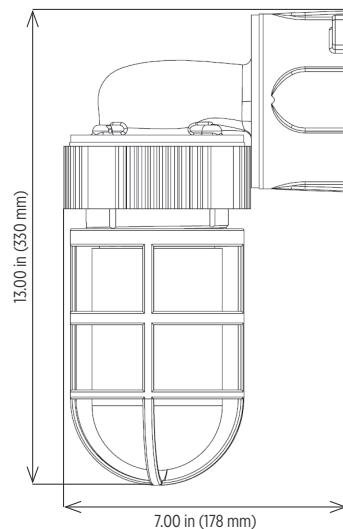

Mounting Dimensions

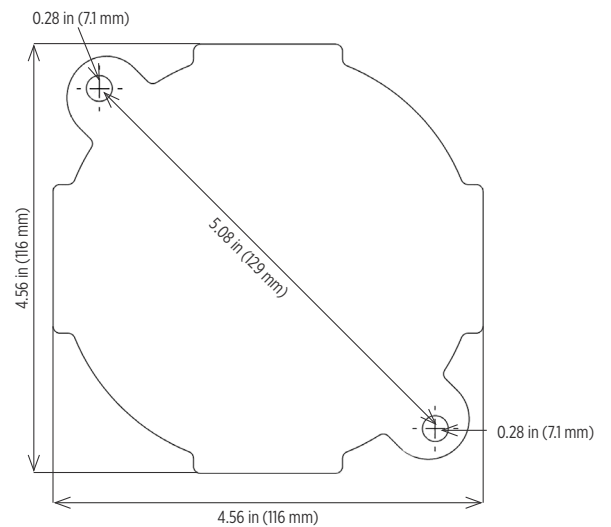

Metallic LED VP Series

LED Vaporproof Fixture

Specifications

Construction	Cast brass for the VB Series Ultra-low copper content, marine grade aluminum for VA Series Long-life silicone gaskets
Globe	Frosted heat treated glass - standard on VA Amber heat treated glass - standard on VB
Guard	All fixtures come with a guard. Guards may be discarded if not needed. Cast brass for the VB Series Ultra-low copper content marine grade aluminum for the VA Series
Hardware	Marine grade (316) stainless steel external hardware
Grounding	Junction boxes include hardware to ground the fixture
Light source	Bridgelux LED array 17W, 1336 lumens Sealed in optically clear silicone Cool white - 5600K Warm white - 3000K (VA only) 50,000 hour rated life
Power source	100-277V AC, 50-60Hz Class 2 rated driver standard on all units Over-voltage, over-current, short-circuit protection with auto recovery Fully potted Dimming capability
Ambient operating temperature	-30°C to +40°C
Ambient storage temperature	-40°C to +40°C
Mounting	Wall (bulkhead) mount Ceiling mount
Outlets	One ½ inch NPT outlet for power connection
Weight	VAC: 5.0 lb (2.3 kg) VAW: 6.0 lb (2.7 kg) VBC: 10.0 lb (4.5 kg) VBW: 13.0 lb (5.9 kg) Add approximately 1.0 lb to each for shipping weight
Warranty	5 years

Compliances

UL/cUL Certified to:

- UL 1598 Suitable for Wet Locations
- UL 1598A Marine Outside Type (Saltwater)
- UL 844 Hazardous Location
Class I, Division 2 Groups A, B, C, D
Class I, Zone 2
T3A, 180°C maximum surface temperature
Class II, Division 2 Groups F, G
T4A, 120°C maximum surface temperature
- CSA C22.2 No. 137-1981
- CSA C22.2 No. 250.0-08

IP66 rated
ABS

Contact factory for IES files



Meets the requirements of the
Buy American Act (BAA) and/or the
American Recovery and Reinvestment Act (ARRA)



Ordering Information

Example: VA-W-17LED-CW-FGC

Fixture	Mount	Wattage/Type	Color Temperature	Globe ²
VA	W	17LED	CW	FGC ³
VB	C		WW ¹	GHA ⁴

Fixture	Mount	Wattage/Type	Color Temperature
VA Aluminum	W Wall mount	17LED 17W	CW Cool white - 5600K
VB Brass	C Ceiling mount		WW ¹ Warm white - 3000K (VA only)

Globe²

FGC³ Frosted heat treated glass - standard on VA

GHA⁴ Amber heat treated glass - standard on VB

Notes

- 1 Warm white (WW) available on VA only
- 2 Color variations may occur depending on the color temperature of the LED
- 3 Frosted heat treated glass (FGC) available on VA only. For other globe options, see accessories below.
- 4 Amber heat treated glass (GHA) available on VB only. For other globe options, see accessories below.

Special Projects: We may be able to accommodate your special projects, so please don't hesitate to ask about additional options. Minimum order quantities and/or extended lead times will apply. Contact your Phoenix representative with specific inquiries.

Accessories (order separately)

Globes

FGC	Frosted heat treated glass
GHA	Amber heat treated glass
GHB	Blue heat treated glass
GHC	Clear heat treated glass
GHG	Green heat treated glass
GHO	Opal heat treated glass
GHR	Red heat treated glass
GPC	Clear prismatic glass
PPA	Amber polycarbonate prismatic - to be used without guard
PPC	Clear polycarbonate prismatic - to be used without guard
PPR	Red polycarbonate prismatic - to be used without guard



Metallic LED VP Series

LED Vaporproof Fixture

PHOENIX[®]
DURABILITY X DESIGN™

Cover photo: Brass fixture shown on a shovel at a mine site in the US

Product design and specifications are subject to change without notice. The most current version of this specification sheet can be found on our website: www.phoenixlighting.com.



Phoenix Products Company Inc. 8711 West Port Avenue Milwaukee, WI 53224 USA
Phone: +1 414.973.3300 Toll Free: 800.438.1214 Fax: +1 414.973.3210 www.phoenixlighting.com

N5610650K
11.03.15