

# Delivery Systems

Work Surface Connectivity Boxes

# HUBBELL



Delivering Power and Data  
to the Work Surface



## Pre-Wired Work Surface Series

The Hubbell Work Surface Series products deliver power and low voltage services to the work surface. An open architecture design allows keystone jacks or Hubbell iSTATION™ connectivity to configure specific needs for AV and multi-media, making them the perfect solution for kiosks, work stations and hospitality applications.



Multiple finish options to match any style or décor. All models in the Work Surface Series are pre-wired for easy installation.



WSBC21UBK

### Square Lift-Up Style

Description	Dimensions	Finish	Catalog Number
Two (2) pre-wired 15A outlets with 6-ft. power supply cord; 1-Unit opening for Hubbell iSTATION modules. Unit rotates up when in use and down to conceal services when not in use.	5.75"L x 5.39"W x 4.25"H	Black Silver	<b>WSBC21UBK</b> <b>WSBC21USV</b>



WSBA11BK

### Square Mini Lift-Up Style

Description	Dimensions	Finish	Catalog Number
One (1) pre-wired 15A outlet with 9-ft. power supply cord; One (1) RJ-45 jack installed with 6-ft. patch cord. Unit rotates up a 30° angle.	3.7"L x 3.7"W x 2.93"H	Black Brushed Stainless Steel	<b>WSBA11BK</b> <b>WSBA11BSS</b>
Two (2) pre-wired 15A outlets with 9-ft. power supply cord (power only).	3.7"L x 3.7"W x 2.93"H	Black Brushed Stainless Steel	<b>WSBA2BK</b> <b>WSBA2BSS</b>





# Pre-Wired Work Surface Series

These Work Surface boxes deliver power and data services above the table and also provide convenience outlets below the table surface. Units can easily be disconnected when tables are moved or stored, providing a flexible electrical and low-voltage infrastructure.



Integrates with Hubbell keystone devices and iSTATION™ modules for AV and Multi-media solutions.

## Recessed Concealed Services

Description	Dimensions	Finish	Catalog Number
Two (2) pre-wired 15A outlets with 6-ft. power supply cord; One (1) Low Voltage Plate included with 1-Unit opening for Hubbell iSTATION modules; Two (2) additional 1-Unit openings provided in base of unit.	8.98"L x 5.47"W x 2.97"H	Black Brushed Anod. Alum. Brushed Stainless Steel	<b>WSBB23UBK</b> <b>WSBB23UBAL</b> <b>WSBB23UBSS</b>
Empty Enclosure intended for field wiring.	8.98"L x 5.47"W x 2.97"H	Black	<b>WSBBHWBK</b>



**WSBB23UBK**



**WSBF22BK**



**WSBFGROMSV**

## Grommet Style

Description	Dimensions	Finish	Catalog Number
Two (2) pre-wired 15A recessed outlets with 6-ft. power supply cord; Two (2) Hubbell Keystone openings.	8.62"L x 3.0"W x 2.25"H	Black Silver	<b>WSBF22BK</b> <b>WSBF22SV</b>
Flush Grommet Cover with dust shield.	5.68"L x 3.39"W x 0.96"H	Black Silver Stainless Steel Brushed Aluminum	<b>WSBFGROMBK</b> <b>WSBFGROMSV</b> <b>WSBFGROMBSS</b> <b>WSBFGROMBAL</b>



# Pre-Wired Work Surface Series

Lab benches and computer stations often require convenience power and data services for user interface. These two modules offer several configurations that can mount to table edges, above or below the surface.



Several profile options offer power and low-voltage services, depending on the requirements.



**WSBD21UBK**

## Under Table Mount



Description	Dimensions	Finish	Catalog Number
Two (2) pre-wired 15A outlets with 9-ft. power supply cord; One (1) Low Voltage Plate included with 1-Unit opening for Hubbell iSTATION™ modules.	6.50"L x 1.75"W x 2.25"H	Black	<b>WSBD21UBK</b>



**WSBE22SV**

## Work Surface Mount



Description	Dimensions	Finish	Catalog Number
One (1) pre-wired 15A outlet with 9-ft. power supply cord; One (1) Hubbell Keystone opening.	3.57"L x 2.19"W x 2.50"H	Black Silver	<b>WSBE11BK</b> <b>WSBE11SV</b>
Two (2) pre-wired 15A outlets with 9-ft. power supply cord; Two (2) Hubbell Keystone openings.	6.32"L x 2.19"W x 2.50"H	Black Silver	<b>WSBE22BK</b> <b>WSBE22SV</b>
Three (3) pre-wired 15A outlets with 9-ft. power supply cord; One (1) Low Voltage Plate included with 1-Unit opening for Hubbell iSTATION™ modules.	8.25"L x 2.19"W x 2.50"H	Black Silver	<b>WSBE31UBK</b> <b>WSBE31USV</b>
Mounting bracket with thumb screw (optional).	n/a	n/a	<b>WSBECLAMP</b>





# Pre-Wired Work Surface “Elite” Series

The “Elite” series of work surface boxes offer a higher end solution for the most attractive spaces. Power and data services blend with the environment, but are easy to access. Architectural finishes ensure a pleasing look.



*Architectural finishes for high end spaces. Conceal services while providing an easy interface for users. Cable management features reduce clutter.*

## Recessed Concealed Services

Description	Dimensions	Finish	Catalog Number
Four (4) pre-wired 15A outlets with 6-ft. power supply cord; Three (3) Low Voltage Plates included with 1-Unit opening for Hubbell iSTATION™ modules. With dampened, retractable cover.	15.0"L x 9.0"W x 6.25"H	Black Anod. Alum. Clear Anod. Alum. Black Silver	<b>WSBG43UBBA</b> <b>WSBG43UBAL</b> <b>WSBG43UBK</b> <b>WSBG43USV</b>



**WSBG43UBAL**  
(Cover doors shown open)

## Pop-Up Style

Description	Dimensions	Finish	Catalog Number
Base Unit with Four (4) pre-wired 15A outlets with 6-ft. power supply cord; Two (2) Low Voltage plates included with 1-Unit opening for Hubbell iSTATION™ modules.	8.90"L x 8.90"W x 13.9"H	—	<b>WSBH42U</b>
Trim Ring and Decorative Round Top.	5.25" Diameter	Black Stainless Steel	<b>WSBHTRBK</b> <b>WSBHTRBSS</b>



**WSBH42U with**  
**WSBHTRBK**



# Furniture and Work Surface Connectivity Boxes



HBLSHA2



HBLPHA2



HBLCON2



HBLMIR2



HBLMAR2

## Square Flush Mount Boxes

Description	Dimensions	Finish	Catalog Number
2-Gang Square Flush Mount Box with Cover.	6.5"L x 6.5"W x 3.75"H	Black	<b>HBLSHA2</b>
2-Gang Square Flush Mount Box with Cover.	6.5"L x 6.5"W x 3.75"H	Stainless Steel	<b>HBLSHA2BSS</b>

## Rectangular Flush Mount Boxes

Description	Dimensions	Finish	Catalog Number
2-Gang Rectangular Flush Mount with Cover.	10.75"L x 4.06"W x 3.5"H	Black	<b>HBLPHA2</b>
2-Gang Rectangular Flush Mount with Cover.	10.75"L x 4.06"W x 3.5"H	Stainless Steel	<b>HBLPHA2BSS</b>
4-Gang Rectangular Flush Mount with Cover.	10.75"L x 6.5"W x 3.5"H	Black	<b>HBLPHA4</b>
4-Gang Rectangular Flush Mount with Cover.	10.75"L x 6.5"W x 3.5"H	Stainless Steel	<b>HBLPHA4BSS</b>

## Surface Mount Boxes

Description	Dimensions	Finish	Catalog Number
2-Gang Surface Mount Box.	4.19"L x 4.81"W x 2.44"H	Black	<b>HBLCON2</b>
3-Gang Surface Mount Box.	6.19"L x 4.81"W x 2.44"H	Black	<b>HBLCON3</b>

## Recessed Mount Boxes

Description	Dimensions	Finish	Catalog Number
4-Gang Recessed Mount.	10.25"L x 7.0"W x 5.88"H	Black	<b>HBLMIR2</b>
8-Gang Recessed Mount.	31.0"L x 10.25"W x 5.88"H	Black	<b>HBLMIR4</b>

## Under Desk Mount Boxes

Description	Dimensions	Finish	Catalog Number
2-Gang Under Desk Mount.	9.19"L x 3.0"W x 2.88"H	Black	<b>HBLMAR2</b>
3-Gang Under Desk Mount.	13.69"L x 3.0"W x 2.88"H	Black	<b>HBLMAR3</b>

## Hubbell – Screw Type Face Plates

HBLST302SBK	HBLDE301SBK	HBLBL300SBK	HBLIMFSBK	HBL317SBK
				
Duplex	Style Line® Decorator Opening	Blank	3-Unit Hubbell iSTATION™	Hubbell 6-Port

## Table Top Boxes



TTBKSBK



TTBXLRBK



TTBDS1BK



TTBDS2BK

## Low Voltage Only

Description	Dimensions	Finish	Catalog Number
Table Top box; 2-inch diameter hole; One (1) keystone opening; Keystone modules sold separately.	2.19" Diameter	Black Anod. Alum. Clear Anod. Alum. Solid Brass	<b>TTBKSBK</b> <b>TTBKSA</b> <b>TTBKSB</b>
Table Top box; 2-inch diameter hole; One (1) XLR microphone jack installed.	2.19" Diameter	Black Anod. Alum. Clear Anod. Alum. Solid Brass	<b>TTBXLRBK</b> <b>TTBXLRAL</b> <b>TTBXLRR</b>

## Pre-Wired Dual-Service



Description	Dimensions	Finish	Catalog Number
Table Top box; 3.5-inch diameter hole; One (1) pre-wired 15A outlet with 9-ft. power supply cord; One (1) 3.5mm screw terminal audio jack; One (1) 15-pin gender changer F/F; Two (2) keystone openings; Keystone modules sold separately.	3.88" Diameter	Black Anod. Alum. Clear Anod. Alum. Solid Brass	<b>TTBDS1BK</b> <b>TTBDS1AL</b> <b>TTBDS1BR</b>
Table Top box; 3.5-inch diameter hole; Two (2) pre-wired 15A outlets with 9-ft. power supply cord; Two (2) keystone openings; Keystone modules sold separately.	3.88" Diameter	Black Anod. Alum. Clear Anod. Alum. Solid Brass	<b>TTBDS2BK</b> <b>TTBDS2AL</b> <b>TTBDS2BR</b>

# Wiring Devices and Multimedia Connectivity

## Hubbell Power Devices

	<b>Extra Heavy Duty Spec Grade</b>	15A, 125V <b>HBL5262x</b> 20A, 125V <b>HBL5362x</b>
	<b>Hubbell-Pro™</b>	15A, 125V <b>5262x</b> 20A, 125V <b>5362x</b>
	<b>Style Line® Decorator</b>	15A, 125V <b>DR15x</b> 20A, 125V <b>DR20x</b>
	<b>Isolated Ground (Orange)</b>	15A, 125V <b>IG5252</b> 20A, 125V <b>IG5352</b>
	<b>Surge Suppression</b>	15A, 125V <b>HBL5262xSA</b> 20A, 125V <b>HBL5362xSA</b>
	<b>Heavy Duty Commercial LED GFCI</b>	15A, 125V <b>GF15xLA</b> 20A, 125V <b>GF20xLA</b>

x=colors: AL (Almond), BK (Black), GY (Gray), I (Ivory), OW (Office White), W (White) or no suffix (Brown)

## Blank Data Frames

	<b>Duplex Outlet Frame</b>	2-Port <b>BR106x</b> 4-Port <b>Q106x</b>
	<b>Style Line® Decorator Frame</b>	2-Port <b>ISF2x</b> 3-Port <b>ISF3x</b> 4-Port <b>ISF4x</b> 6-Port <b>ISF6x</b>

x=colors: AL (Almond), BK (Black), GY (Gray), EI (Electric Ivory), OW (Office White) or W (White).

## Work Surface Box Data Plates

	<b>Data Plates**</b>	Blank, 1-Unit <b>WSBPLATE1</b> iSTATION™ <b>WSBPLATE2</b> Cut-out, 1-Unit
--	----------------------	---

\*\* For use with "Work Surface Box" series only, catalog numbers starting with WSB.

## Keystone Snap Fit

<b>Jacks</b>	<b>Category 6</b>	<b>Category 5e</b>
Snap Fit	<b>HXJ6x</b>	<b>HXJ5Ex</b>

x=colors: B (Blue), OW (Office White) or W (White).

## USB Coupler

A to B	<b>SFUSBABx</b>
A to A	<b>SFUSBAAx</b>

x=colors: B (Blue), OW (Office White) or W (White).

## Data Coupler

Category 6	<b>SFC6BK</b>
Category 5e	<b>SFC5EBK</b>

## RCA Connector

Solder	<b>SFRCx(x)</b>
110 Termination	<b>SFRC110(x)</b>
Pass-through	<b>SFRC(x)Rx</b>

x=colors: AL (Almond), BK (Black), GY (Gray), EI (Electric Ivory), OW (Office White) or W (White)

(x)= insulator color: BK (Black), B (Blue), GN (Green), OR (Orange), R (Red), W (White) or Y (Yellow).

## XLR 3-Pin Connector

Solder	<b>XLR10</b>
Screw Terminal	<b>XLRST10</b>
Blank Module, 1.5-Unit, 10 PK	<b>IMAVB15W</b>

## HDMI Connector

Coupler	<b>HDMIC1</b>
3" Tail	<b>HDMIT1</b>
Blank Module, 1-Unit, 10 PK	<b>IMBDS1W</b>

## HDMI Decorator Frame

Description	1-Port	2-Port
-------------	--------	--------

Female to Female **NS801x** **NS802x**

x=color: AL (Almond), BK (Black), GY (Gray), I (Ivory), LA (Light Almond) or W (White).

## AV Horizontal Run

Description	Non-Plenum	Plenum
8-Pin	<b>VGA6xxxBK</b>	<b>VGA6PxxxBK</b>

xxx=length: 5 ft. (05) to 100 ft. (100). Order in multiples of 5 ft.

## X-END™

**X-END™ Keystone Snap Fit Connectors**  
8-Pin Female; Black

Keystone, 4" Tail  
Keystone, 90°  
Keystone, Straight



**SFAVCT**  
**SFAVCN**  
**SFAVCS**

**X-END™ AV Plug-n-Play Bulk Connectors**  
15-Pin HD15; 8-Pin Female

Straight 180°  
Angled 45°  
Right Angle 90°



**15S6P1\***  
**15A6P1\***  
**15N6P1\***

\* Add 0 at end of part number to get a package of 10 pieces.

**X-END™ Plug-n-Play Modules**  
8-Pin Female

S-Video with 3.5mm Audio; 1-Unit  
S-Video with 2 RCA L/R Audio; 1-Unit  
3 RCA Composite Video with L/R Audio; 1-Unit  
3 RCA Component Video; 1-Unit  
3 RCA Composite S-Video with L/R Audio; 1.5-Unit  
4 RCA Component Video with S/PDIF; 1.5-Unit  
5 RCA Component Video with LR Audio; 1.5-Unit  
3 RCA Component with 3.5mm Audio; 1.5-Unit  
3 RCA Component with S-Video; 1.5-Unit  
5-BNC RGBHV; 1.5-Unit



**IMS3581xx**  
**IMSR81xx**  
**IMR8P1xx**  
**IMCR81xx**  
**IMSRC815xx**  
**IMCRD815xx**  
**IMCAR815xx**  
**IMC35815xx**  
**IMSCCR815xx**  
**IMB815xx**

xx = Module Color: AL (Almond), BK (Black), EI (Electric Ivory), GY (Gray), LA (Light Almond), OW (Office White) or W (White).

**X-END™ AV Plug-n-Play Application Tails**  
8-Pin Female; 1-ft. Tail

S-Video with 3.5mm Audio  
S-Video with 2 RCA L/R Audio  
3 RCA Composite Video with L/R Audio  
3 RCA Component Video  
3 RCA Composite S-Video with L/R Audio  
4 RCA Component Video with S/PDIF  
5 RCA Component Video with LR Audio  
3 RCA Component with 3.5mm Audio  
3 RCA Component with S-Video  
5-BNC RGBHV  
15-Pin HD15 Female (VGA Style)  
15-Pin HD15 Male (VGA Style)



**AVS35T1**  
**AVSRAT1**  
**AVRCT1**  
**AVCRT1**  
**AVSRCT1**  
**AVCRDT1**  
**AVCART1**  
**AVC35T1**  
**AVSCRT1**  
**AVBT1**  
**15T6P1\***  
**15MP6P1\***

\* Add 0 at end of part number to get a package of 10 pieces.

**X-END™ AV Plug-n-Play Application Patching Runs**  
8-Pin Female

S-Video with 3.5mm Audio  
S-Video with 2 RCA L/R Audio  
3 RCA Composite Video with L/R Audio  
3 RCA Component Video  
3 RCA Composite S-Video with L/R Audio  
4 RCA Component Video with S/PDIF  
5 RCA Component Video with LR Audio  
3 RCA Component with 3.5mm Audio  
3 RCA Component with S-Video  
5-BNC RGBHV  
15-Pin HD15 Female (VGA Style)



**AVS35xx**  
**AVSRAxx**  
**AVRCxx**  
**AVCRxx**  
**AVSRCxx**  
**AVCRDxx**  
**AVCARxx**  
**AVC35xx**  
**AVSCRxx**  
**AVBxx**  
**AV15Mxx**

xx = length: 05 = 5'; 10 = 10'

## Hubbell iSTATION™ Modules and Frames

	<b>Keystone Module</b>	1-Port, 1-Unit <b>IM1K1x</b> 2-Port, 1-Unit <b>IM2K1x</b>		<b>Angled Keystone Module</b>	1-Port, 1.5-Unit <b>IM1KA15x</b> 2-Port, 1.5-Unit <b>IM2KA15x</b>		<b>15/9-Pin or HDMI Blank Module</b>	1-Unit <b>IMBDS1x</b> 2-Unit with 3.5mm Stereo Jack <b>IMB15315x</b>
--	------------------------	--	--	-------------------------------	--	--	--------------------------------------	---

For color options replace x with the following: AL (Almond), BK (Black), GY (Gray), EI (Electric Ivory), OW (Office White) or W (White). Please visit our website at [www.hubbell-wiring.com](http://www.hubbell-wiring.com) to view colors in our virtual catalog.



Visit our website [www.hubbell-wiring.com](http://www.hubbell-wiring.com) for complete product line.



#### 1 AV Ceiling Box

Configured with 15A power outlet, 15-pin feed through and 3.5mm audio jack. This unit allows for further customizing by populating two keystone openings. Plenum and non-plenum versions available.

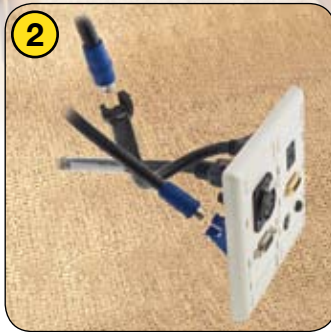

#### 2 X-END™ Plug-n-Play AV System

X-END's main focus is the integration of connections from multimedia devices and applications such as:

- Display devices
- White boarding
- Videoconferencing
- Webcasting
- Streaming media content



#### 3 FPTV Connection Enclosure

Hubbell's netSELECT® Flat Panel Television enclosure delivers high-density connectivity and power in the wall. This allows flat panel displays and interactive "smart" boards to sit flush against walls with no dangling cords. It quickly installs to studs or sheetrock without additional components or hardware.



#### 4 SystemOne FRPT and Floor Box

Hubbell SystemOne sub-plates are designed to meet the growing needs of the audio and video markets. Some sub-plates provide power outlets with Hubbell's audio/video products including 15-pin SVGA, RCA, S-Video, 3.5mm stereo, and XLR microphone jacks. Other sub-plates can accommodate Extron® Electronics MAAP and AAP series audio/video modules.

**HUBBELL®**  
Wiring Systems

[www.hubbell-wiring.com](http://www.hubbell-wiring.com)  
[www.hubbell-premise.com](http://www.hubbell-premise.com)

