

CAM-KIT™

Security camera mounting kit.
Universal bracket mounts to 3-1/2" and 4" round or octagonal boxes and single-gang device boxes. Also fits FL430 CAM-LIGHT™ BOX.



SC5

FEATURES AND BENEFITS

- Fits any camera hole pattern
- Low cost
- Installs in less than two minutes
- Installs cameras with a base diameter up to 4-1/2"

CATALOG NUMBER	UPC/DCI/NAED MFG #018997	COLOR	UNIT PKG	STD PKG	DIM A	DIM B	DIM C	DIM D	DIM E	DIM F
SC5	18058	White	1	20	4.875	5.564	.703	5.375	.750	.718
SC5BL	18220	Black	1	20	4.875	5.564	.703	5.375	.750	.718

Includes 5" plastic mounting plate, camera mounting bracket and mounting screws.

PATENTED.

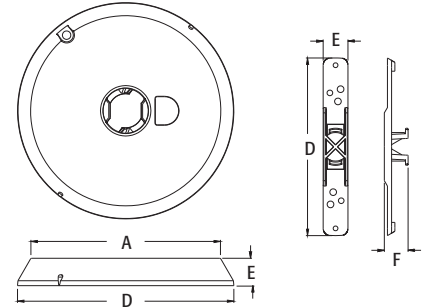

Installation Instructions - SC5 for Security Cameras



Use your camera base as a template and drill holes.



Attach camera to mounting plate (screws provided).



Mount the bracket to the existing box using screws provided.



With camera mounted, install the mounting plate to the box by placing it on the bracket and turning clockwise to lock. Install set screw.



Finished installation.

Scan For Video

