

MOD™ 4 LED Recessed Slot

Fixture Type:

Project Name:

Ordering Guide

Feature	Code	Options	Description
Series		4L	MOD
Ceiling Type		DW PT LG NG SS	Drywall Drywall with plaster trim 15/16 Grid 9/16 Grid 9/16 Screw Slot & 9/16 Tegular *Ceiling Type cannot be retrofitted in the field
Fixture distribution		D AD	Direct Asymmetric Direct
Row length (in feet)		---	Enter in foot increments. Note fixture lengths below.
Row length adder (in inches)		/3 /6 /9	Row length +3" Row length +6" Row length +9" *Excludes Individual Grid Mounts
Max length in row		02 03 04 05 06 08	2', 609mm 3', 914mm 4', 1219mm 5', 1524mm* 6', 1829mm 8', 2438mm *Not available for row mounting
Downlight diffuser		SOF REG BWO ASYM	Soft Diffuse Lens Regressed Diffuse Lens* Blade Baffle with Overlay* Asymmetric Diffuser Lens**/** *Not available with Patterns **Must be ordered with AD
Finish/Color		C1 C2 C3 C4 C5 C6 CC	Matte White (Default) Textured Matte White Light Silver Machined Aluminum Carbon Black Textured Camera Black Custom Color
Color temperature		30K 35K 40K 2230TD 2750T 2765T	3000K 3500K 4000K 2200K-3000K SpectraSync™ Dim-to-Warm* 2700K-5000K SpectraSync™ Tunable White* 2700K-6500K SpectraSync™ Tunable White* *Must be ordered with D05 Driver option; excludes 2' and 3' lengths
Direct output/ft (specifiable in 50 lumens/ft increments)		D030 D110	300 1100
Driver		NDM D10 D01 D05 LEC LHI LTW DALI	Non Dimming 10% Dimming, 0-10V 1% Dimming, 0-10V* 5% Dimming, 0-10V Lutron Ecosystem Dimming Lutron Hi-Lume 3-Wire Dimming Lutron Hi-Lume 2-Wire Dimming DALI *Consult Factory
Circuiting		1C	1 Circuit

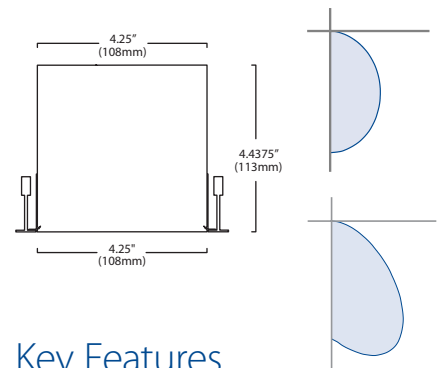
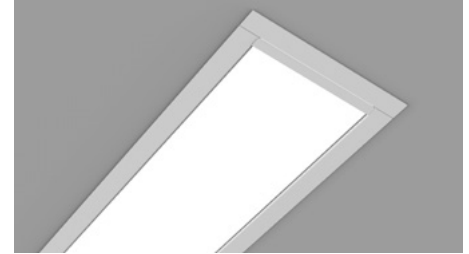

Key Features

- Variable Intensity technology provides specifiable lumen output/wattage
- End cap design eliminates visible diffuser seams/gaps
- 2 SDCM color variation

Performance

Nomenclature	Lumens/ft	W/ft	Efficacy
D030	300	2.9	104
D035	350	3.4	104
D040	400	3.8	104
D045	450	4.3	104
D050	500	4.8	104
D055	550	5.3	103
D060	600	5.4	103
D065	650	6.4	102
D070	700	6.9	102
D075	750	7.4	101
D080	800	7.9	101
D085	850	8.5	100
D090	900	9.0	100
D095	950	9.6	99.
D100	1000	10.2	99
D105	1050	10.7	98
D110	1100	11.3	97

(wattage may vary up to 5% from published)



Quick Find litecontrol.com

4L-R-D

MOD™ 4 LED Recessed Slot

Ordering Guide (continued)

Voltage		UNV 120 277 347	Universal Voltage 120 Volt 277 Volt 347 Volt* *Excludes Emergency Battery Pack 'EF' Option. Excludes DALI and Lutron (LTW/LHI/LEC) Dimming Drivers
Optional Features	Code	Options	Description
Nightlight		_NL	Nightlight Circuit Required. Enter quantity. 2NL = 2 nightlight circuits/row
Emergency		ICP7	Emergency Battery. Integral-Iota CP-07. Enter quantity. Example: 2ICP7 = 2 Emergency batteries/row. *Not available for 2' or 3'
Thru-wiring		W1 W2 W3	No Thru Wire Provide Normal and Emergency Thru Wiring* Provide Normal Thru Wiring Only *Only applicable when specified with emergency
Patterns		PTRN	Contact Factory for pattern configurations. Approval drawings required. See page 4.
Sensors		SD1 SO1 SZ1	Daylight Sensor Required. Enter quantity. 2SD1=2 daylight sensors/row Occupancy Sensor Required. Enter quantity. 2SO1=2 occupancy sensors/row Zigbee Radio Module Required. Enter quantity.* 2SZ1=2 radio modules/row *Radio controls up to 10 drivers
Chicago Environmental Air Modification		CCEA	Chicago Environmental Air Modification

Output Exceptions:

Value	Direct Output- Total lm/ft	Direct Drivers
D030	300	2' fixture lengths: Excludes LEC, LHI, LTW, D01, DALI Dimming Drivers, and 347V 3' fixture lengths: Excludes DALI Dimming Drivers, D01, and 347V 4' fixture lengths: Excludes D01
D035	350	2' fixture lengths: Excludes LEC, LHI, LTW, D01, DALI Dimming Drivers, and 347V 3' fixture lengths: Excludes D01, DALI Dimming Drivers, and 347V
D040	400	2' fixture lengths: Excludes LEC, LHI, LTW, D01, DALI Dimming Drivers, and 347V 3' fixture lengths: Excludes D01
D045	450	2' fixture lengths: Excludes DALI Dimming Drivers, D01, and 347V 3' fixture lengths: Excludes D01
D050	500	2' fixture lengths: Excludes D01, DALI Dimming Drivers, and 347V
D055	550	2' fixture lengths: Excludes D01, DALI Dimming Drivers, and 347V
D060	600	2' fixture lengths: Excludes D01
D065	650	2' fixture lengths: Excludes D01

MOD™ 4 LED Recessed Slot

Details

Construction:

Die-formed and welded steel. Wiring knockouts in top.
End caps- Die formed steel. Install from below via magnetic interface.
Overlaps diffuser at each fixture end to eliminate gaps/LED visibility.

Downlight diffuser:

SOF-Soft diffuse acrylic lens.
REG- Regressed softglo lens with painted steel inserts. Output multiplier (.77").
BWO- White blade baffle with softglo lens overlay. Output multiplier (.70").
ASYM- Highly transmissive diffuse acrylic lens with linear prisms
3', 4', 6', & 8' lengths available.

Finish/Color:

Visit www.litecontrol.com/finishes for details.

CCT:

30K-3000K output multiplier (.975)
35K-3500K output multiplier (1.0)
40K-4000K output multiplier (1.05)

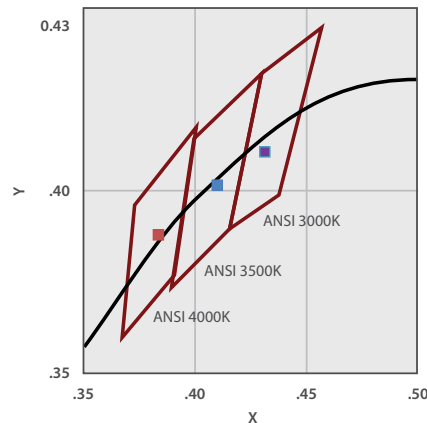

Color Variation:

2 step MacAdam ellipse

Output (VI technology):

Variable Intensity (VI) technology allows precise specification of fixture output/wattage. Fixture will be programmed and labeled to specification.
Specify each in 50 lumen increments/ft within the below range:

	Lumens/ft	Nomenclature
Direct		
Min:	300	D030
Max:	1100	D110

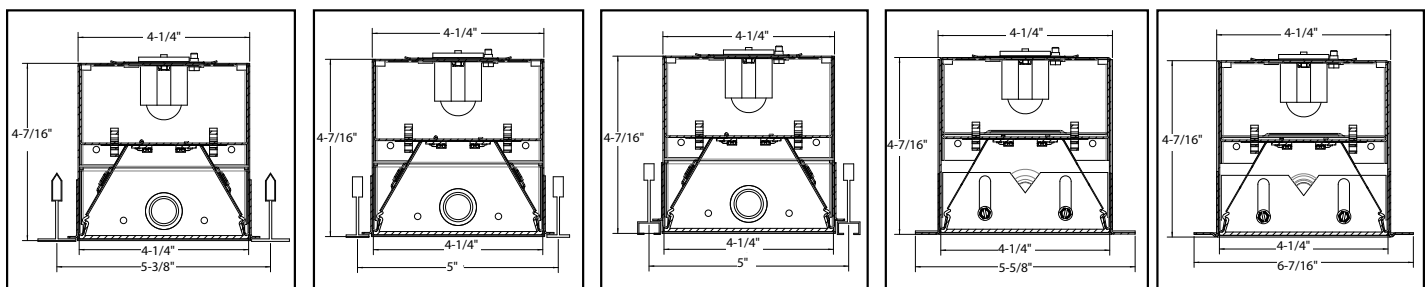

4L-LG

4L-NG

4L-SS

4L-DW

4L-PT

Driver:

NDM: Non-dimming. Fixture will be wired for fixed light output.
D10: 100%-10% dimming range. Fixture will be wired for low voltage 0-10V dimming control.
D01: 100%-1% dimming range. Fixture will be wired for low voltage 0-10V dimming control. Consult factory.
D05: Osram 5% Dimming, 0-10V. Only option if either 2230TD, 2750T or 2765T is selected.
LEC: 100 %- 1% dimming range. Lutron Ecosystem compatible using Lutron A-Series driver.
LHI: 100%-1% dimming range. Lutron Hi-Lume 3 wire dimming compatible using Lutron A-Series driver.
LTW: Lutron Hi-Lume 2-Wire dimming using Lutron A-Series driver.
DALI: DALI compatible.
*See driver limitations in Output section above.

Field Accessibility:

LED boards and drivers can be accessed and removed from fixture, while installed. LED boards can be replaced either individually or as part of 2' module.

Circuiting:

1C (1 Circuit) Fixture wired for a single circuit.

Nightlight:

See separate LC-Nightlight spec sheet for additional details.

Emergency:

Inverter-Compatible. Provided by others.
Integral-IOTA CP7
See separate LC-Emergency spec sheet for additional details.

Thru wiring:

See separate LC-Thruwire spec sheet for additional details.

Sensors:

Daylight sensor(Wattstopper part #FD301). Installs between diffusers.
Occupancy sensor(Wattstopper FS-305 with FS-L6 lens). Installs between diffusers.
Zigbee radio module(Osram Sylvania part #ZBHA-CLM-DIM). Installs in knockout.
See separate LC-Control spec sheet for additional details.

SpectraSync™ Color Tuning Technology:

Control your space based on the needs of the application, specific activities throughout the day and preferences of the occupants with two distinct SpectraSync™ Color Tuning Technology.

Dim to Warm: Dim to Warm mimics the familiar warming effect that occurs with traditional incandescent sources as they are dimmed. (Available with 2200K-3000K).

Tunable White: Tunable White offers users the ability to tailor CCT to their personal preference, enhancing task visibility, material and colors or the aesthetics of the space. (Available with 2700K-5000K or 2700K-6500K).

See separate [SpectraSync™ Tech Sheet](#) for additional details.

See separate [NX™ Solutions Guide](#) for additional details.



MOD™ 4 LED Recessed Slot

Details (continued)

System Connectors:

90° corners available. One piece construction, ready to install, with diffusers that match adjoining fixtures. Corner system connectors must be used to form patterns. The length of each outside or inside lighted 90° corner is 12".

Rated Life (LED Board):

Tested in accordance to LM79-2008 & derived from EPA TM-21 calculator
 L70: 280,000 (calculated per TM-21 extrapolated curve)
 L70: >61,000 (reported per TM-21/LM80 6x's limitation)
 L90: 72,000 (calculated per TM-21 extrapolated curve)
 L90: >61,000 (reported per TM-21/LM80 6x's limitation)

Rated Life (Driver):

Standard = 100,000 hours
 Lutron = 50,000 hours

Fixture weight:

3 lbs/ft.

Ratings:

CSA listed for damp locations. IBEW. AF of L. IC Rated.

Warranty:

5 years. See www.litecontrol.com for details.

Fixture Mounting:

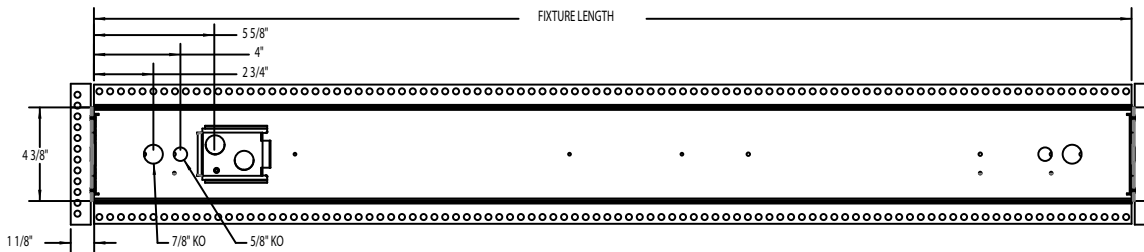
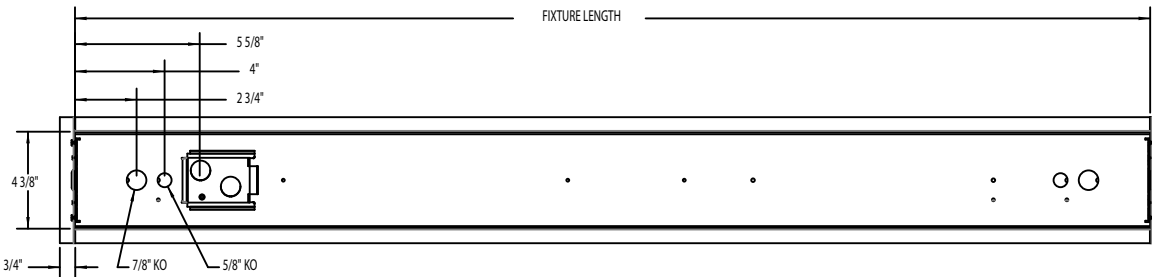
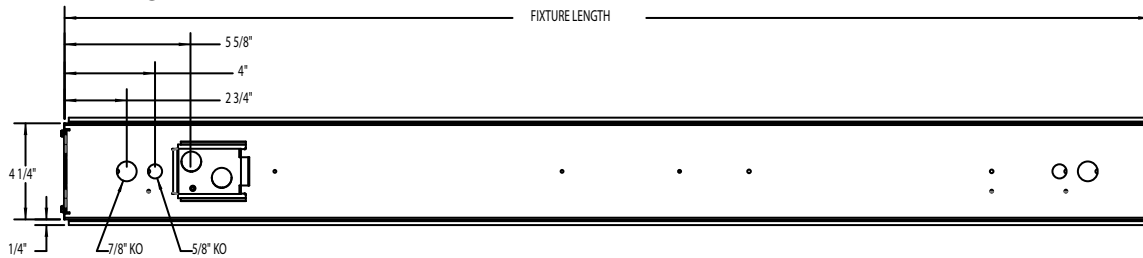

Patterns:

Drywall

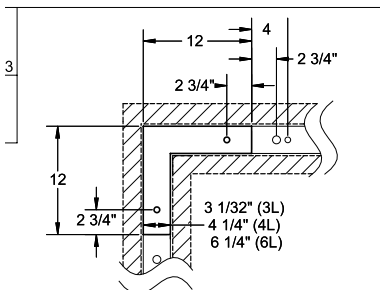

Grid

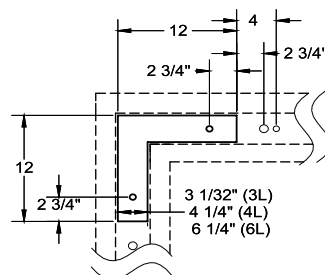

○ = 5/8" DIA. KO'S FOR 1/4" - 20 THREADED ROD
 ○ = 7/8" DIA. FEED KO'S

○ = 5/8" DIA. KO'S FOR 1/4" - 20 THREADED ROD
 ○ = 7/8" DIA. FEED KO'S

Quick Find litecontrol.com **4L-R-D**

MOD™ 4 LED Recessed Slot

Details (continued)

Color Characteristics:

Value	Ordering Code		
	30K	35K	40K
Rf	83	82	82
Rg	96	96	96
CCT (K)	3009	3494	3975
Duv	-0.0009	-0.0004	-0.0003
x	0.435	0.4052	0.3814
y	0.4012	0.3898	0.3768
CIE Ra	83	83	84

Spectral Distribution:

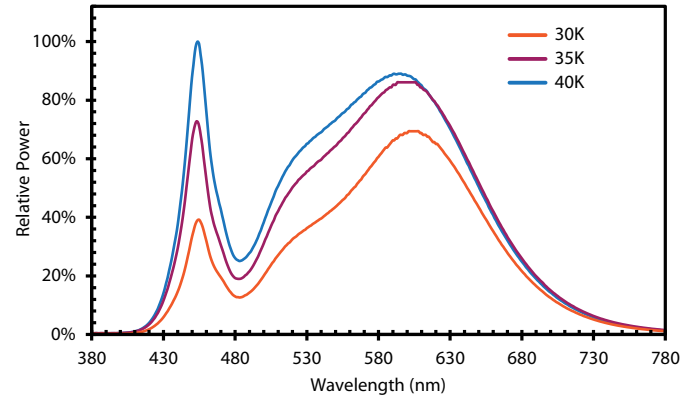

Color Vector Graphic:

30K:

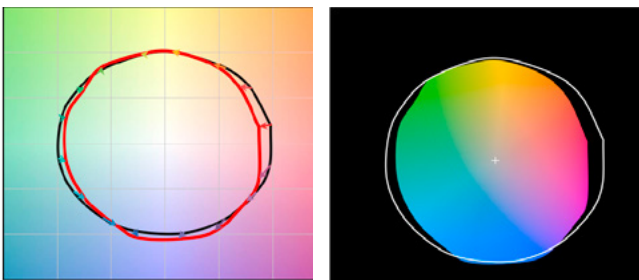

35K:

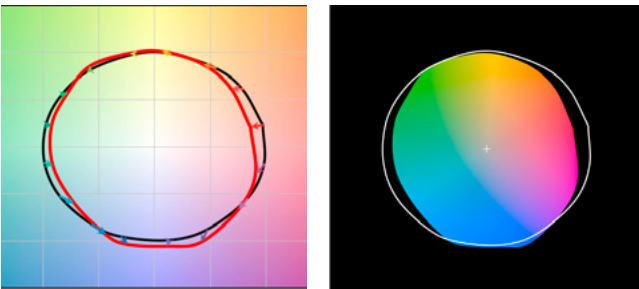

40K:

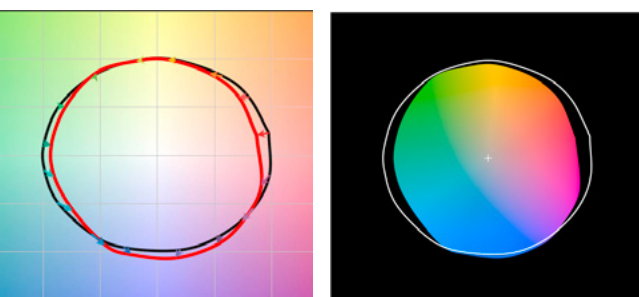

Color Gamut/Fidelity Plot

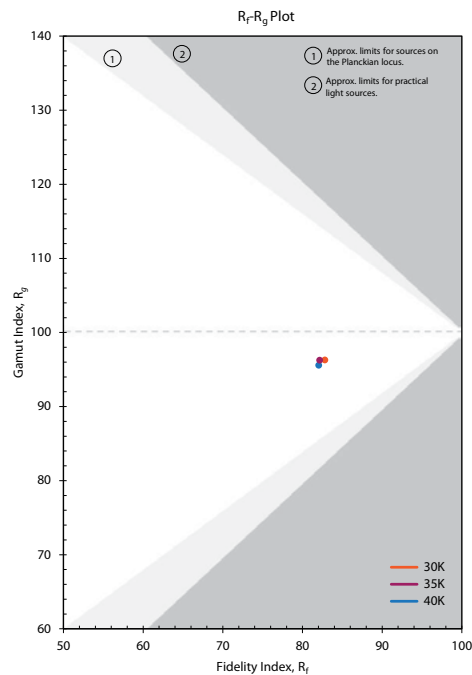

CRI:

80 minimum

CCT	CRI	R1	R2	R3	R4	R5	R6	R7	R8	R9	R10	R11	R12	R13	R14
30K	83	82	91	97	81	82	89	84	62	13	79	79	69	84	99
35K	83	81	89	95	81	81	85	86	65	13	73	79	62	83	97
40K	84	82	90	94	82	82	85	87	68	17	74	80	60	84	97

Quick Find litecontrol.com

4L-R-D

MOD™ 4 LED Recessed Slot

Photometry

Fixture: 4L-R-D-XX-XX-SOF-CX-35K-D100
CCT: 3500K
Output: D100
Nominal lumens: 1000 lumens/ft
Efficacy: 98 lm/W
Test report: 4L-R-D-04-SOF-X-CX-35K-D100.IES

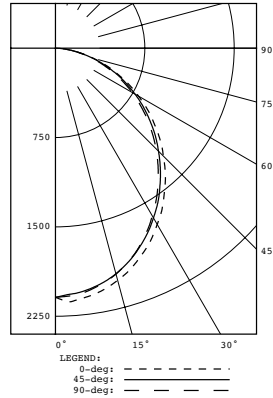

Zonal Lumens		
Zone	Lumens	Lamp %
0-40	1885.8	47.1%
0-60	3214.6	80.4%
0-90	4000.1	100.0%
90-180	0.0	0.0%
0-180	4000.1	100.0%

Fixture: 4L-R-AD-XX-XX-ASYM-CX-35K-D050
CCT: 3500K
Output: D050
Nominal lumens: 500 lumens/ft
Efficacy: 107.8 lm/W
Test report: 4L-R-AD-XX-XX-ASYM-CX-35K-D050.IES

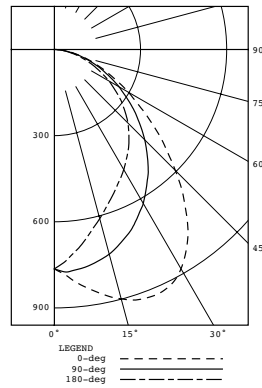

Zonal Lumens		
Zone	Lumens	Lamp %
0-40	982	48.7%
0-60	1658	82.3%
0-90	2016	100.0%
90-180	0	0.0%
0-180	2016	100.0%