

SERVICE INFORMATION — DO NOT REMOVE

IMPORTANT SAFETY NOTICE

THIS INFORMATION IS INTENDED FOR USE BY INDIVIDUALS POSSESSING ADEQUATE BACKGROUNDS OF ELECTRICAL, ELECTRONIC AND MECHANICAL EXPERIENCE. ANY ATTEMPT TO REPAIR A MAJOR APPLIANCE MAY RESULT IN PERSONAL INJURY AND PROPERTY DAMAGE. THE MANUFACTURER OR SELLER CANNOT BE RESPONSIBLE FOR THE INTERPRETATION OF THIS INFORMATION, NOR CAN IT ASSUME ANY LIABILITY IN CONNECTION WITH ITS USE.

DISCONNECT POWER BEFORE SERVICING

IMPORTANT – RECONNECT ALL GROUNDING DEVICES IF GROUNDING WIRES, SCREWS, STRAPS, CLIPS, NUTS OR WASHERS USED TO COMPLETE A PATH TO GROUND ARE REMOVED FOR SERVICE, THEY MUST BE RETURNED TO THEIR ORIGINAL POSITION AND PROPERLY FASTENED.

WARNING



Certain internal parts are intentionally not grounded and may present a risk of electric shock only during servicing. Service personnel – **DO NOT** contact the following parts while the appliance is energized: **heating element, water valve, main pump and drain pump and active vent motor (if present).**

WASHABILITY COMPLAINTS

Hot Water – Ample supply of water at 120°F minimum temperature is necessary. Do not use dishwasher soon after using clothes washer or filling bathtub.

Loading – Consult Owner's Manual on loading procedures.

Amount of Water – Make sure dishwasher is level. Check water level, allowing dishwasher to fill normally for first fill. The water level should be to the center of the float dome. If water level is low, check for clogged screen in water valve and check float switch.

Detergent Module Leakage – Some moisture in cup is normal. Detergent must not be soaking wet, oozing out and down the inner door panel. If a leak is detected, check detergent module door lid, latch operation, and gasket seal.

Proper Amount of Detergent – Use full detergent cup of fresh detergent in hard water. Use only enough detergent to get good wash performance in soft water.

Rinse Agent – Use rinse agent if spotting is a problem.

Water Valve – Check valve for intermittent operation. Valve coil can be direct tested. Allow to heat normally, then check to see if coil opens.

Spray Arm – Check to be sure spray arm spins freely and jets are not clogged.

FILTER AND DRAIN SYSTEM

Will Not Pump Out

1. Enter service mode and check drain pump operation (see service mode).
2. Check cover inlet (Figure 3) in the bottom of the tub. Make sure that it is clear of food particles.
3. Check for blocked or partially blocked drain line and air gap.
4. Check routing of drain hose system. It must be free from kinks.
5. Remove lower spray arm (Figure 3).
6. Remove main conduit mounting screw (Figure 3).
7. Lift main conduit tab, pull and rotate main conduit out of hub (Figure 3).
8. Remove the cover inlet, check sump and drain outlet (Figure 3). It may be blocked by a toothpick or other object.
9. Check drain pump valve (Figure 1) for correct operation. Water should flow only from the pump to the high drain loop.
10. Drain line check valve (Figure 1) must pass water in the drain line direction only.

MOTOR-PUMP MECHANISM

Motor Stalled-Hums

1. Disconnect Power. Try to turn motor shaft clockwise to determine if seal is stuck and can be broken loose. If motor shaft cannot be turned, cutter blade may be bound up. Proceed to step 2.
2. On inside of dishwasher, remove the cover inlet (Figure 3) and reach down into the sump (Figure 1). Check for blockages such as bone, wire ties, etc. If it contains debris, clean thoroughly. If motor shaft cannot be turned, remove mechanism.

To Remove Motor-Pump Mechanism:

1. Remove cover inlet (Figure 3). With syringe, remove all water from sump (Figure 3).
2. Loosen main pump clamp and pump connector clamp (Figure 1).
3. Remove hanger that holds motor to tub frame (Figure 1).
4. Motor-pump mechanism can now be removed from under dishwasher.

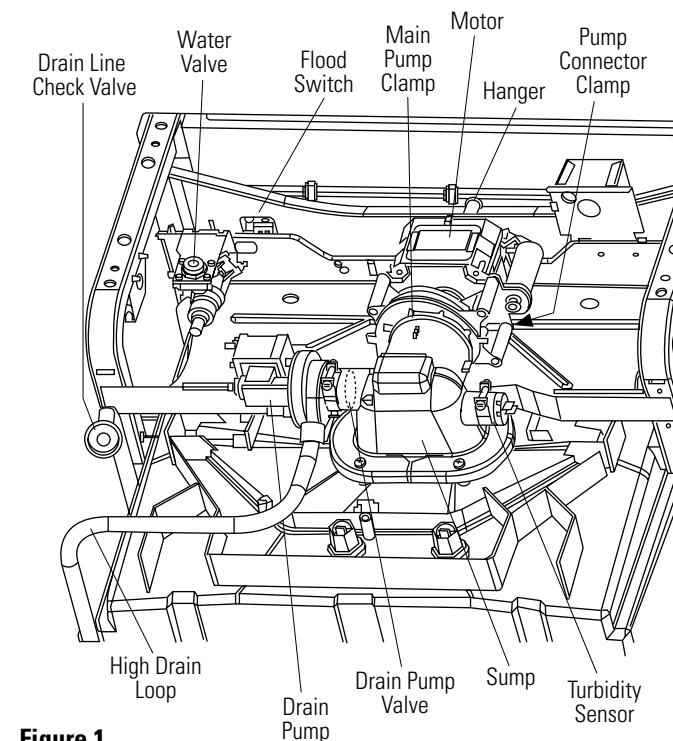

Figure 1

TO SERVICE WASH ARM ASSEMBLIES:

Check Wash Arms

1. Check holes in spray arm for bits of china, seeds and other foreign matter.
2. Check spray arms for rotation.

To Disassemble Mid-Level Arm (Figure 2):

1. Pull upper rack all the way out.
 2. Remove nut on bottom of mid arm. This will allow the mid arm and bearing to be removed.
 3. To remove conduit, remove screw (some models) from hub. Press tab on side of mid bracket to release the hub and mid conduit.
 4. To reinstall arm, reverse procedure.
- NOTE:** Mid arm to be installed with spray jets facing the upper rack. Bearing to be placed between nut and bottom of mid arm.

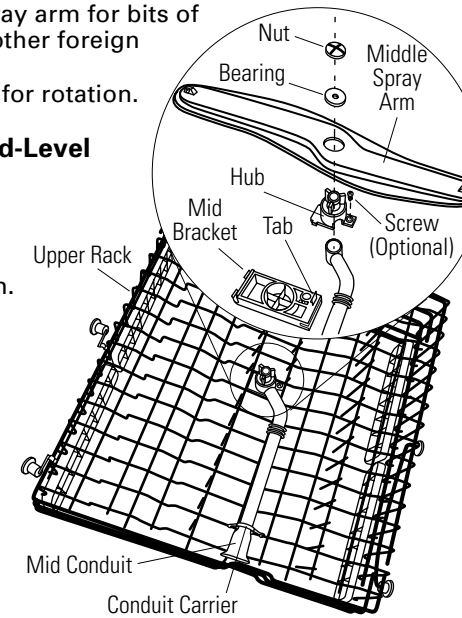

Figure 2

To Remove Lower Arm and Fine Filter Assembly (Figure 3):

1. Remove lower rack from dishwasher.
 2. Gently lift and rotate lower spray arm counter clockwise to remove.
 3. Rotate nut hub counterclockwise to remove. Gently lift fine filter assembly up. Remove fine filter drain from sump.
 4. Clean fine filter screen if soil is present.
 5. To reinstall fine filter and lower spray arm reverse procedure.
- NOTE:** When installing fine filter make sure the drain port of the filter is engaged with the drain for the fine filter.

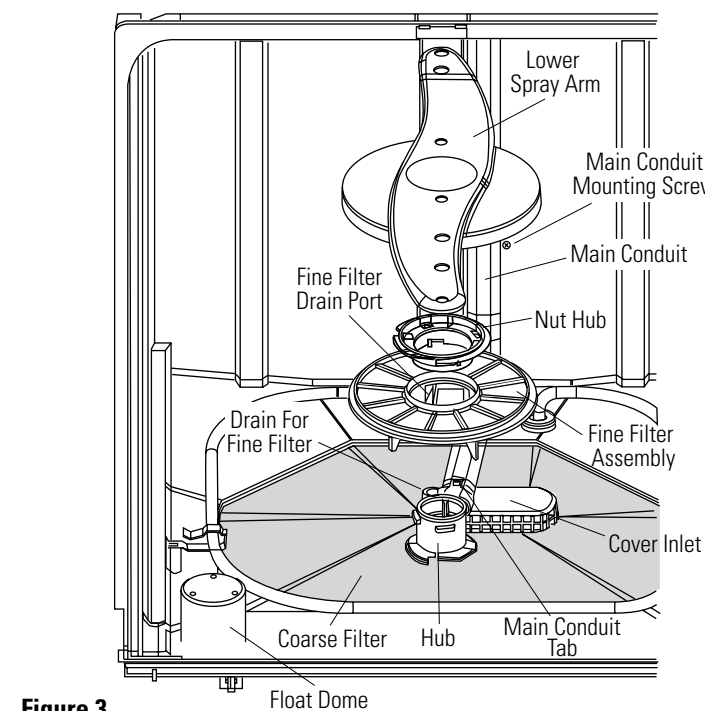

Figure 3

CALROD® HEATING ELEMENT

To Remove Heating Element (Figure 4):

1. Disconnect Power and remove wire leads from heating element.
2. Unscrew two heating element nuts.
3. Remove heating element supports.
4. Lift and remove heating element.

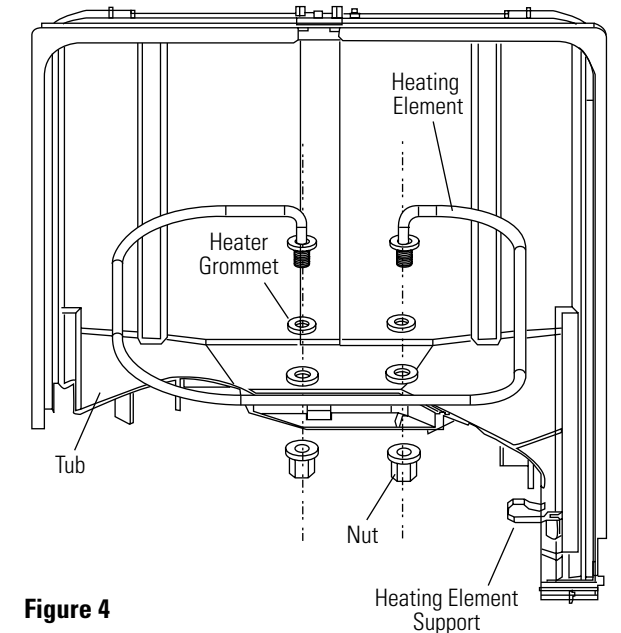

Figure 4

DOOR COMPONENTS (Figure 5)

The door components are accessible by removing three screws from each side of inner door and two screws at the bottom of the door. Carefully separate the inner door panel from the outer door panel. The active vent can be accessed by removing the screws on the escutcheon.

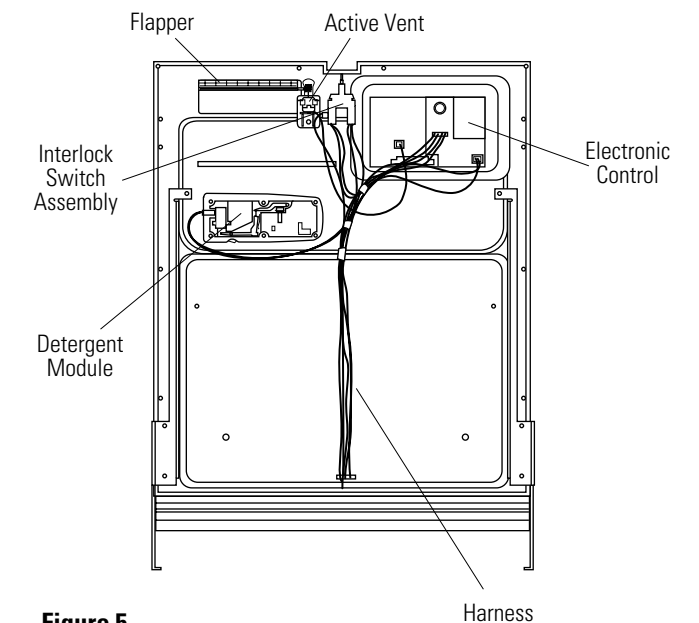

Figure 5

165D6290G033

FLASHING DISPLAY LIGHTS	
Status Indicator Lights	What It Means
START/RESET	Cycle has been interrupted by pressing the START/RESET keypad. Light will quit flashing after the dishwasher automatically drains out the water.
CLEAN	Unit has no water. Check the water supply. If water is turned on call for service.

THIS DISHWASHER IS PROGRAMMED WITH A SERVICE MODE TO AID THE TECHNICIAN IN TROUBLESHOOTING THE DISHWASHER. EACH COMPONENT MAY BE CYCLED TO DETECT IF IT IS FUNCTIONING CORRECTLY. COMPONENTS ARE CYCLED BY PRESSING KEYPADS TO THE RIGHT OR LEFT OF THE START/RESET KEYPAD. DETERMINE WHICH TYPE OF CONTROL PANEL IS PRESENT (FLAT OR BOWED) AND THEN USE THE MATRIX BELOW TO DETERMINE HOW TO CYCLE EACH COMPONENT.

FLAT PANEL

BOWED PANEL

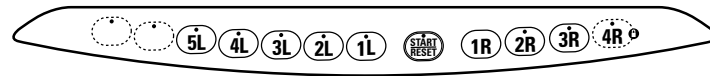
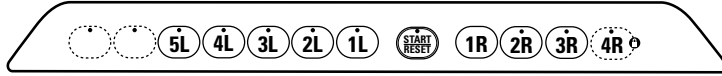

○ Indicates Keypad Used Only on Some Models

○ Indicates Keypad Used Only on Some Models

TO ENTER SERVICE MODE :

PRESS THE COOKWARE (POTS & PANS ON SOME MODELS) AND THE HEATED DRY KEYPAD SIMULTANEOUSLY FOR 3 SECONDS.

TO EXIT SERVICE MODE :

PRESS THE START/RESET KEYPAD AT ANYTIME TIME TO EXIT.

TRITON XL SERVICE MODE TEST MATRIX *

KEYPAD		DESCRIPTION	TIME in seconds**
PAD	CONTROL TYPE		
Keypads to the left of the Start/Reset keypad (Selections)			
1L	FLAT	Activates Drain Pump	75
	BOWED	Activates Detergent Module	
2L	FLAT	Activates Detergent Module	60
	BOWED	Activates Main Pump	
3L	FLAT	Activates Main Pump	75
	BOWED	Activates Heating Element	
4L	FLAT	Activates Heating Element	300
	BOWED	Activates Drain Pump	
5L	FLAT	Activates Water Valve (Length of time is model dependent)	50 or 71
	BOWED		
START/RESET Used to EXIT Service Mode			
Keypads to the right of the Start/Reset keypad (Enhancement/Extras)			
1R	FLAT	Activates the following in order: Status LEDs; Wash LEDs; Start/Reset and Option LEDs; finally "888" will be shown on the 3 digit display (some models)	3 seconds each cycle
	BOWED		
2R	FLAT	Opens Active Vent	
	BOWED		
3R	FLAT	Closes Active Vent	
	BOWED		

***NOTE :** Service mode may be used for 30 minutes maximum. After 30 minutes the service mode will automatically turn off.

****NOTE :** Component will be activated for indicated time. Component may be deactivated by pressing the same keypad that was pressed to activate the component.

165D7995P001

WARNING: POWER **MUST** BE DISCONNECTED BEFORE SERVICING THE APPLIANCE.

