



Geotech Environmental Equipment, Inc  
2650 East 40th Avenue Denver, Colorado 80205  
1-800-833 -7958 website: www.geotechenv.com

# AC CONTROLLER INSTRUCTIONS AND PUMP MAINTENANCE

## BASIC OPERATION

- Verify main power switch is in OFF position.
- Plug power cord into controller.
- Plug power cord into AC supply outlet.
- Switch main power to ON position.
- Wait for initialization sequence to complete.

- From main menu:

UP     START PUMP  
DOWN     LOAD WELL

- Press  to start the pump at default settings.

- Wait for pump start up to finish.

PUMPING WELL #nn  
PUMP START UP

- Press  or  to adjust pump speed to achieve desired flow rate.

PUMPING WELL #nn  
nnn DR ON nn

OR

PUMPING WELL #nn  
nnn DR OFF nn

- Pump water at desired pump speed.
- Press  to stop pump and return to main menu.

## SETTING DRY RUN

**NOTE:** Set point must be above 100 for Dry Run protection to be activated

- Press  to toggle Dry Run ON and OFF

**FOR MAINTENANCE AND SERVICE PLEASE CALL GEOTECH DIRECTLY AT 1-800-833-7958**  
NOTE: LOADING WELL #0 WILL LOAD DEFAULT START UP CONFIGURATION

## DIS-ASSEMBLY AND CLEANING

- Disconnect pump cable from controller.
- Unscrew outer housing (No tools needed).

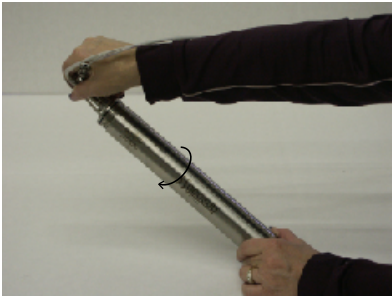

- Remove inner housing by pulling apart, slightly twisting while pulling may help.
- The control module may become disconnected from the motor lead while pulling apart, this is normal.
- Remove motor assembly from inner housing by pulling apart, slightly twisting while pulling may help.
- Inspect motor assembly, impeller, and control module for damage or wear.
- Inspect internal wires for cuts or breaks, making sure all wires have insulation covering them.

- Inspect all o-rings for nicks, cuts, brittleness
- Decontaminate outer and inner housing.
- Decontaminate the motor assembly and control module.
- Decontaminate top cap and hose barb
- Clean all threads thoroughly to make sure nothing will bind them.
- Insert motor assembly back into inner housing, **be careful not to damage O-rings.**
- Connect control module wires back onto motor lead.

**Note:** A very small amount of inert grease may be used to help lubricate O-ring seals.

- Twist the motor assembly and inner housing assembly 180 degrees, twisting the wires to create more room.
- Push the inner housing over the top cap, **be careful not to damage O-rings.**
- Install the outer housing **making sure the threads do not bind.**

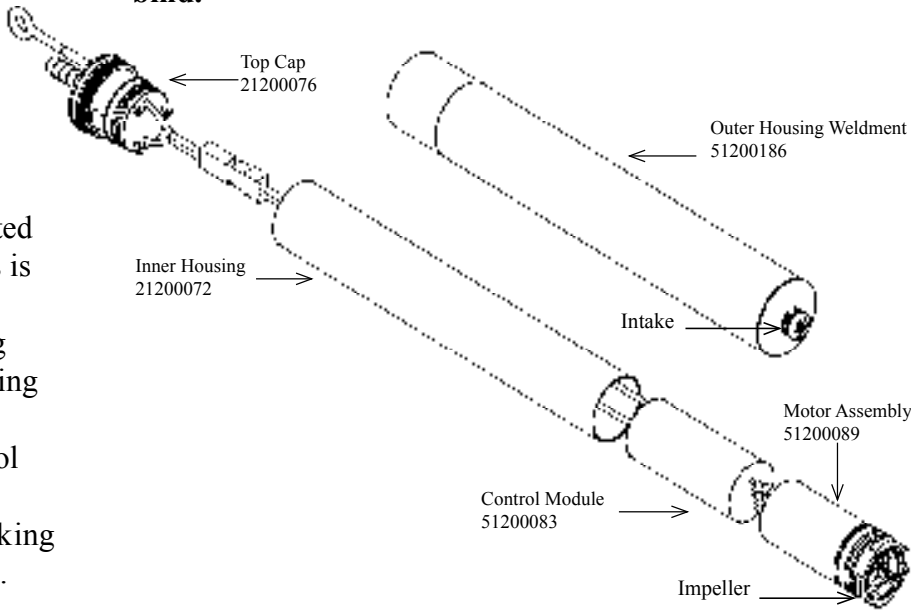

PARTS	PART #
1. AC CONTROLLER 300 WATT 120 volts	81200031
2. AC CONTROLLER 300 WATT 230 volts	81200032
3. FUSE	11200746
4. MANUAL	11200813
5. GOLD CONNECTORS & HEAT SHRINK	11200754
6. O-RING KIT	51200088
7. CHECK VALVE	81200033