

Vertical Lamp

VL Post Top Mount

FEATURES

- Classic, Cylindrical style luminaire for architectural relevance and reduced wind loads
- Pulse start metal halide and high pressure sodium sources
- Semi-cutoff, vertical optical systems in asymmetric and symmetric patterns
- Available in four sizes from pedestrian zone to site/roadway zone
- Sealed optical chamber, IP-66 rated

VLP



SITE / ROADWAY

ORDERING INFORMATION (Example)

FM	VLP17N3F	WH	100PMH120	A-30/HS	PRA16-6188FM/WH																		
MOUNTING		FIXTURE FINISH		FIXTURE OPTIONS																			
EPA 17" 21" 25" 29"		BL Black DB Dark Bronze LG Light Gray SG Stealth Gray™ PS Platinum Silver WH White CC Custom Color* *Consult representative		A-30 120 Volt photocell A-31 208 Volt photocell A-32 240 Volt photocell A-33 277 Volt photocell A-34 480 Volt photocell A-35 347 Volt Photocell L17 Polycarbonate Lens ³ HS Houseside shield ⁴ HSC Houseside shield for Convex Glass Lens ⁵ REV Accent Reveals																			
<table border="1"> <tr> <th>FM</th> <th>PT</th> <th>DM</th> </tr> <tr> <td>Flush Mount</td> <td>Pole Tenon Mount</td> <td>Direct Mount</td> </tr> <tr> <td>0.7</td> <td>0.7</td> <td>0.7</td> </tr> <tr> <td>1.0</td> <td>1.0</td> <td>1.0</td> </tr> <tr> <td>1.2</td> <td>1.2</td> <td>1.2</td> </tr> <tr> <td>1.5</td> <td>1.5</td> <td>1.5</td> </tr> </table> NOTE: EPA is for Fixture only		FM	PT	DM	Flush Mount	Pole Tenon Mount	Direct Mount	0.7	0.7	0.7	1.0	1.0	1.0	1.2	1.2	1.2	1.5	1.5	1.5	POLE		See p. 762-765 for ordering no., pole and arm EPA.	
FM	PT	DM																					
Flush Mount	Pole Tenon Mount	Direct Mount																					
0.7	0.7	0.7																					
1.0	1.0	1.0																					
1.2	1.2	1.2																					
1.5	1.5	1.5																					

FIXTURE - POST TOP MOUNT				
	Asymmetric Wide	Asymmetric Medium	Square Wide	Square Medium
VL-17 Convex Lens	VLP17W3	VLP17M3	VLP17W5	VLP17M5
VL-17 Op. Flat Lens	—	VLP17N3F	—	VLP17N5F
VL-21 Convex Lens	VLP21W3	VLP21M3	VLP21W5	VLP21M5
VL-21 Op. Flat Lens	—	VLP21N3F	—	VLP21N5F
VL-25 Convex Lens	VLP25W3	VLP25M3	VLP25W5	VLP25M5
VL-25 Op. Flat Lens	—	VLP25N3F	—	VLP25N5F
VL-29 Convex Lens	VLP29W3	VLP29M3	VLP29W5	VLP29M5
VL-29 Op. Flat Lens	—	VLP29N3F	—	VLP29N5F

ELECTRICAL MODULE					
VL17		VL25		VL29	
70PMH	70W PMH ²	175PMH	175W PMH ²	70HPS	70W HPS
100PMH	100W PMH ²	250PMH	250W PMH ²	100HPS	100W HPS
150PMH	150W PMH ²	400PMH	400W PMH ²	150HPS	150W HPS
175PMH	175W PMH ²	VL29		VL21/VL25	
200PMH	200W PMH ²	750PMH	750W PMH ²	150HPS	150W HPS
VL21		1000PMH	1000W PMH ²	250HPS	250W HPS
175PMH	175W PMH ²	1000MH	1000W MH	400HPS	400W HPS
250PMH	250W PMH ²	VL29		750HPS	750W HPS
320PMH	320W PMH ²			1000HPS	1000W HPS
350PMH	350W PMH ²				
400PMH	400W PMH ²				

Voltagess: 120V, 208V⁶, 240V⁶, 277V, 347V, 480V¹
 PMH = Pulse Start Metal Halide, MH = Metal Halide, HPS = High Pressure Sodium

¹ 480V with medium base sockets may require approval of local building code authority.
² Manufacturers of metal halide lamps recommend turning them off for 15 minutes once per week when under continuous operation to reduce risk of arc tube rupture at end of life. See lamp manufacturers' specs for color temperature variations. Use only in high-vandalism situations.
³ Useful life is limited by UV discoloration from sunlight and metal halide lamps.

⁴ Recommended for fixtures with optional flat glass lens. Asymmetric distribution only.
⁵ Asymmetric distributions only. For fixtures with standard convex glass lens or optional polycarbonate lens.
⁶ Only available with Type IV reflectors. Constant wattage isolated ballast is required on all 208V and 240V Canadian orders.

NOTE: Due to the Energy Independence and Security Act (EISA) of 2007, Kim Lighting can no longer supply probe start Metal Halide ballasts with its luminaires, effective January 1, 2009. Contact Kim Lighting for availability of replacement ballasts for warranty service claims. (Visit www.aboutlightingcontrols.org or the Library of Congress website for more details).

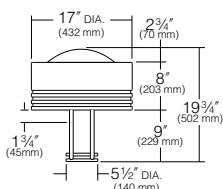

VL17P

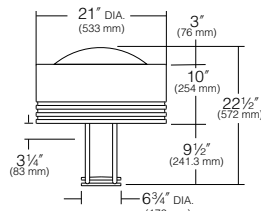

VL21P

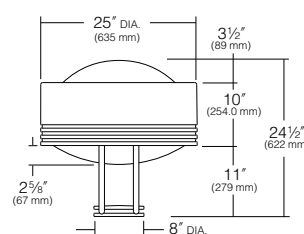

VL25P

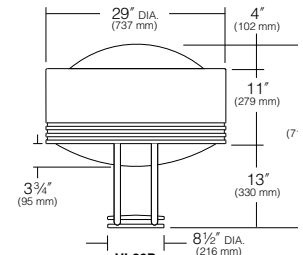

VL29P