

Self Cleaning Functions

Ionizer **NEW**

The ion-filled breeze created by the ionizer neutralises the electrical charge on the documents to be scanned, and reduces the amount of paper dust that clings to their surface. This ion-filled breeze also flows through the paper path and removes paper dust from the scanning glass to reduce the need for the user to clean the glass.

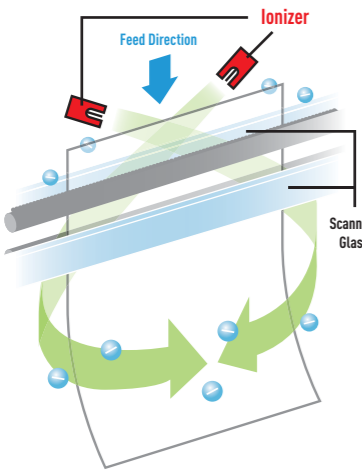

Scanning Glass Cleaning Brush **NEW**

The brush directly cleans the scanning glass to further prevent paper dust. This eliminates the need for maintenance and ensures comfortable scanning operations.

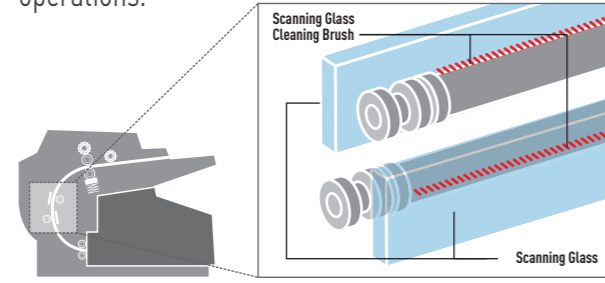

High-Reliability Scanning

Accurately Feeds Various Sized Documents Mixed Document Feeding

Documents with different sizes and thicknesses can all be fed together. They can be set in centre, left, or right alignment. By using left or right single-side alignment, there is no more need to spend time organising documents according to their size, so scanning is fast and easy. This function greatly increases work efficiency.

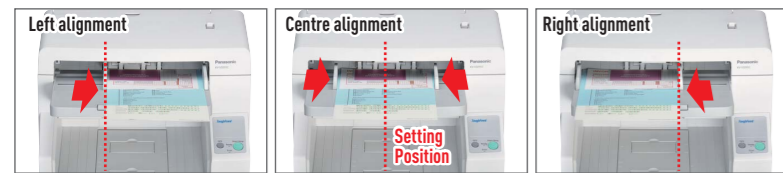

The scanner feeds accurately, regardless of alignment.



High-Speed Scanning of Sheets up to 100 feet Long Long Paper Mode

The highly reliable paper feed mechanism quickly and stably scans long documents. This function boosts work efficiency by smoothly scanning long documents like continuous business forms or electrocardiograms.

Raises filing efficiency Pre-Imprinter

The pre-imprinter prints text (date and/or number) onto the surface of a document before its image is scanned, so the text data is included in the scanned image data. This improves filing efficiency.

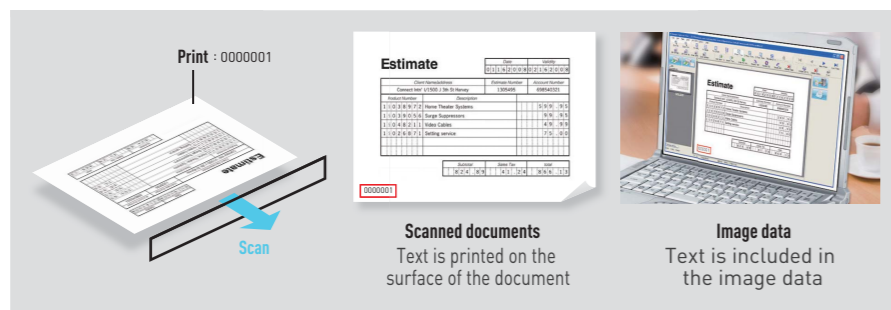

Optional Flatbed Scanner

Easily Scan Documents and Booklets Single User Interface

By selectively using the KV-S5055C and the optional KV-SS080,* you can easily scan documents and booklets, and save them in the same document.

*To operate the KV-SS080, the KV-S5055C is required.
The KV-SS080 does not operate as a standalone unit.

Save Time by Reducing the Number of Scans Multi-Crop

Place various sized documents on the flatbed and scan them all at once, then crop whatever parts you need. This is convenient for scanning multiple business cards and thick documents.

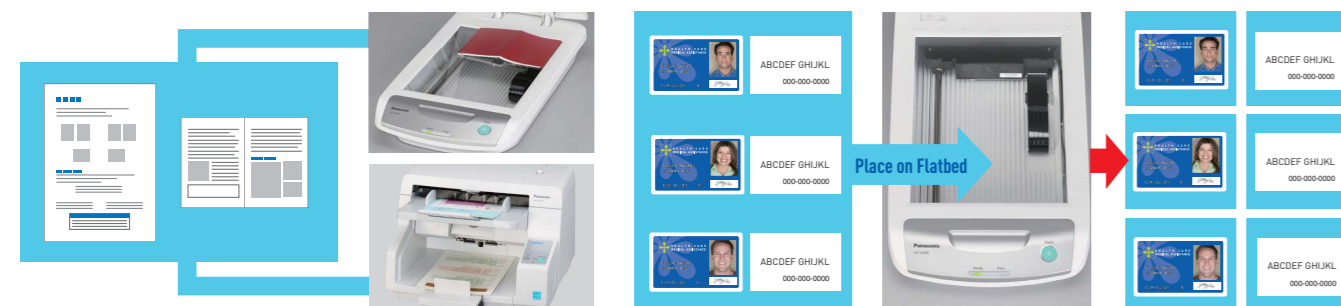

Easy Maintenance

The clamshell design allows full, easy access to the entire paper path, so you can clear paper jams, clean the unit, or replace a roller easily without having to call a service technician.

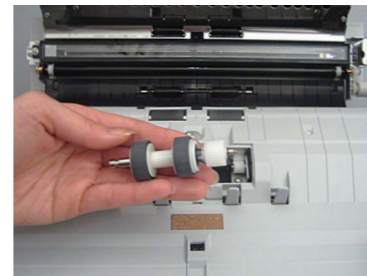

Rollers are easy to replace.

KV-S5055C Specifications		
Scanning Face	Duplex	
Scanning Method	Front side: CCD (600 dpi) Back side: CCD (600 dpi) Selectable black and white background reference	
Scanning Speed *1	Binary / Colour A4 size 200 dpi	Simplex: Up to 70 ppm (Portrait) Up to 140 ppm (Landscape)
		Duplex: Up to 140 ppm (Portrait) Up to 180 ipm (Landscape)
	Binary / Colour A4 size 300 dpi	Simplex: Up to 50 ppm (Portrait) Up to 40 ppm (Landscape)
		Duplex: Up to 100 ipm (Portrait) Up to 120 ipm (Landscape)
Resolution	100 - 600 dpi (1 dpi step). Optical: 600 dpi (Main and Sub feeding directions)	
Detection	Ultrasonic double feed detection (1 position), Stapled document detection	
Compression	JPEG (colour, greyscale)	
Tonal Gradation	Binary, Greyscale (8 bit), Colour, MultiStream: Binary & Greyscale, Binary & Colour	
Binary Mode Halftone	Dither, Error diffusion	
Image Control	Image emphasis, Dynamic threshold, Automatic separation, Invert, White level from paper	
Other Functions	Length control, Barcode detection (ISIS), Patch code detection, Automatic separation, Control sheet, Long paper mode	
Maximum Image Size	395 x 2,540 mm (12.01 x 100 in.)	
Paper *2	Size	Minimum: 48 x 70 mm (1.9 x 2.75 in.) Maximum: 297 x 432 mm (11.7 x 17 in.)
	Thickness	0.04 - 0.2 mm (1.6 - 7.9 mils) Note: 1 mil = 0.001 in.
	Weight	20 - 157 g/m ² (5 - 42 lbs.)
Hopper Capacity	Up to 200 sheets (75 g/m ² , 20 lbs.) New paper	
Interface	USB 2.0	
Power Requirement	AC 100 - 120 V, 50/60 Hz AC 220 - 240 V, 50/60 Hz	
Power Consumption	Maximum (Scanning)	0.5 A (220 - 240 V), 1.0 A (100 - 120 V)
	Minimum (Standby)	0.2 A (220 - 240 V), 0.4 A (100 - 120 V)
	Sleep mode	3.5 W or less (220 - 240 V, 100 - 120 V)
Operating Environment	Temperature: 15 - 30 °C (59 - 86 °F) Humidity: 20 - 80 % RH	
Storage Environment	Temperature: 0 - 40 °C (32 - 104 °F) Humidity: 10 - 80 % RH	
External Dimensions *3 (W x D x H)	448 x 444 x 339 mm (18.5 x 17.5 x 13.4 in.)	
Weight *3	18 kg (40 lbs.)	
Accessories	CD-ROM: Device driver, Operation manual, Installation manual, Control data sheet, Image Capture Plus software, ISIS [®] / TWAIN driver software, User utility software, Quick Scan Pro (DEMO) Installation manual, Power cord, Roller cleaning paper, Shading paper, USB cable (2.4 m) & Blower	
Options	Roller exchange kit: KV-SS039 (Paper feed roller module, Double feed prevention roller) Roller cleaning paper: KV-SS03 Imprinter unit (Pre): KV-SS014 Ink cartridge: KV-SS021 Flatbed Scanner: KV-SS080	

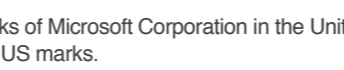
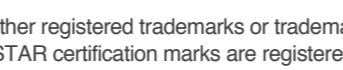
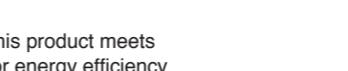
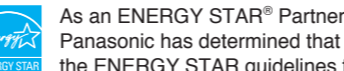
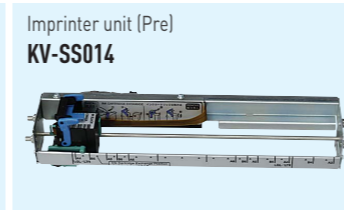
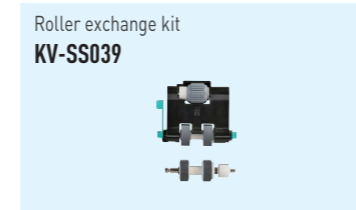

Windows[®] and Windows Vista[®] are either registered trademarks or trademarks of Microsoft Corporation in the United States and/or other countries. ENERGY STAR[®] and the ENERGY STAR certification marks are registered US marks. ISIS[®] and QuickScan are registered trademarks or trademarks of EMC Corporation in the United States and other countries. All other trademarks identified herein are the property of their respective owners. Design and specifications are subject to change without notice.



High-Volume ADF

The ADF (Automatic Document Feeder) holds up to 200 sheets of paper to allow continuous scanning of large document runs.



Optional Flatbed Scanner KV-SS080 Specifications		
Scanning Type	Flatbed	
Scanning Method	CCD	
Scanning Resolution	100 - 600 dpi (1 dpi step)	
Scanning Speed *1 A4 size 200 dpi	3.6 sec. (Binary and Colour)	
Paper Size	Maximum 216 x 297 mm (8.5 x 11.7 in.)	
Interface	USB 2.0	
Power Requirement	AC 100 - 240 V, 50/60 Hz	
Power Consumption	Scanning	0.2 A (200 - 240 V), 0.35 A (100 - 120 V)
	Standby	0.15 A (200 - 240 V), 0.25 A (100 - 120 V)
	Sleep mode	3.5 W or less (200 - 240 V, 100 - 120 V)
Operating Environment	Temperature: 15 - 30 °C (59 - 86 °F) Humidity: 30 - 80 % RH	
Storage Environment	Temperature: 0 - 35 °C (32 - 95 °F) Humidity: 10 - 80 % RH	
Dimensions *1 (W x D x H)	287 x 518 x 83.5 mm (11.3 x 20.4 x 3.3 in.)	
Weight *2	3.4 kg (7.5 lbs.)	
Accessories	CD-ROM: Operating manual AC adaptor, Power cord, USB cable	

*1 The scanning speed differs depending on the host computer, the operating system, the application, the measuring method, the quantity of data in the image, and the paper type. The scanning speed depends on a measuring method of Panasonic.
*2 "Weight in pounds" of paper represents the weight of 500 sheets (42 x 559 mm / 17 x 22 in.).
*3 Scan quality cannot be guaranteed for documents with a non-standard size.
*4 Dimensions and weights are approximate.

Dimensions

KV-S5055C



KV-SS080



Panasonic

ideas for life

Colour Document Scanner KV-S5055C



ToughFeed Innovative Paper Feed Mechanism

- Stapled Document Detection
- Ultrasonic Double-Feed Detection
- Superior Roller Mechanisms

- Mixed Document Feeding
- Long Paper Mode
- 90 ppm / 180 ipm*
- * A4, Landscape, 200 dpi, Binary/Colour
- High-Volume, 200-page ADF

- Self Cleaning Functions
- Ionizer **NEW**
- Scanning Glass Cleaning Brush **NEW**



KV-S5055C



KV-SS080
[Optional Flatbed Scanner]



This product is designed to reduce hazardous chemical substances.
MG-C535EE 1005 Printed in Japan

Boost Your Business Efficiency with an A3-Size Compatible, High-Speed, Fast-Feeding Scanner

The fast 90-ppm* scan speed and 200-page ADF (Automatic Document Feeder) of the KV-S5055C make it ideal for both large-volume scanning and dispersed input. ToughFeed, Panasonic's unique paper feed mechanism, also minimises the possibility of damaging important documents and ensures precise feeding to make your office work even more efficient.

* A4, Landscape, 200 dpi, Binary/Colour.



ToughFeed Innovative Paper Feed Mechanism

Preventing Damage to the Scanning Glass Staped Document Detection

Multiple sensors are used to detect various types of stapled documents, and to immediately stop the scanner when stapling is detected. This minimises damage to both the document and the optical glass.

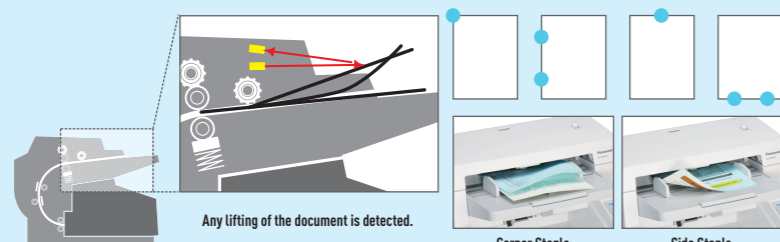

Staples are quickly and accurately detected, to minimise damage to the optical glass and the document.

Accurate Scanning Ultrasonic Double-Feed Detection

The KV-S5055C is equipped with an ultrasonic sensor, which accurately detects double-feeding even when scanning documents of various thicknesses. When detected, the ultrasonic sensor prevents double-feeding by immediately stopping the scanning process.

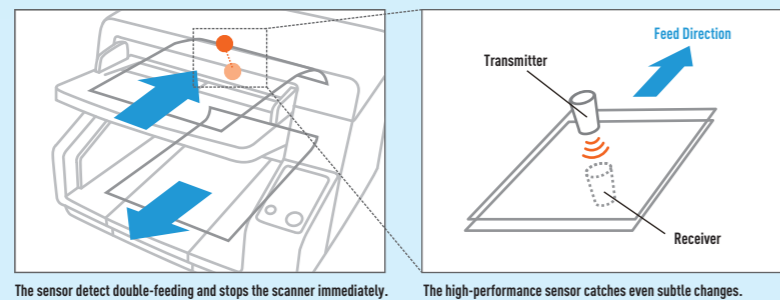

Precise Feeding Superior Roller Mechanisms

The paper feed rollers separate from the paper each time a sheet is fed, so the tendency to double-feed caused by the paper feed roller pressure is reduced, even when feeding paper of different thicknesses. Any paper sliding is also detected and the double feed prevention roller pressure is increased to prevent the paper from slipping and jamming.

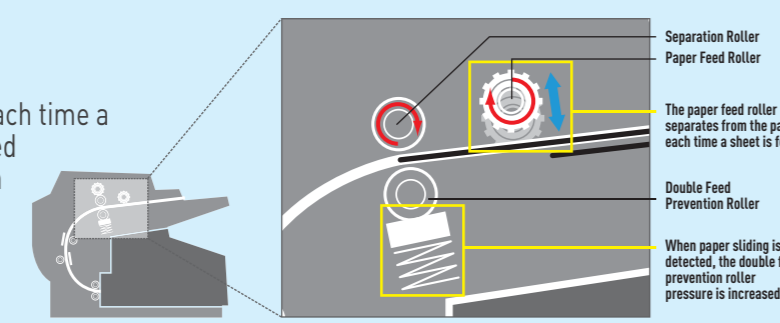

Double Feed Skip (DFS) Key NEW

Should a scan operation stop due to the detection of double-feeding, simply press the DFS key to resume scanning. This is convenient when you don't want scanning to stop due to documents with things like receipts or sticky notes attached, or envelopes.

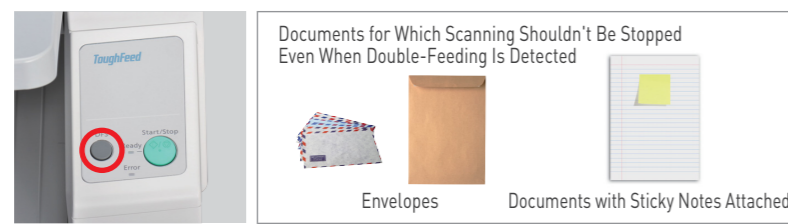

Image Capture Plus Enables Versatile Image Processing

Image Capture Plus is an application that transfers image data scanned by a Panasonic high-speed document scanner to a PC in the form of an image file. This software lets you edit scanned pages (switch pages, delete pages, etc.) intuitively using thumbnail images. It also allows you to make various settings to facilitate complex scanning processes and serves as a powerful tool for efficiently processing routine business work, such as filing.

Intuitive Operation

Scanned images can be displayed page by page in a thumbnail list. Pages can be easily moved and their positions switched by dragging and dropping the thumbnails of the pages.

Moving pages within a document

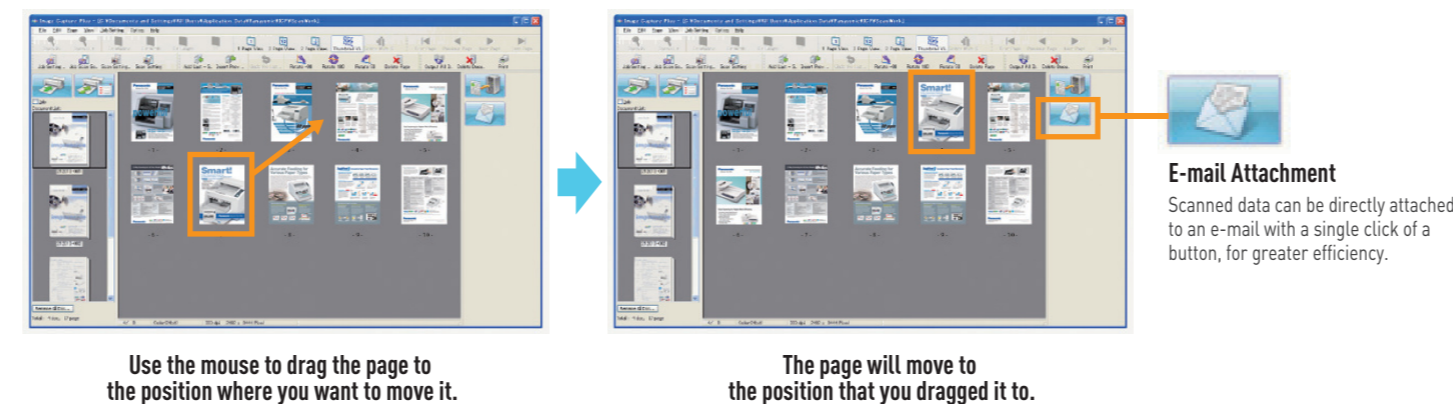

Use the mouse to drag the page to the position where you want to move it.

The page will move to the position that you dragged it to.

E-mail Attachment
Scanned data can be directly attached to an e-mail with a single click of a button, for greater efficiency.

Easy-to-Use Data Formats

Images can be saved in various data formats, such as PDF, JPEG, TIFF and Bitmap. Scanned data can be moved and saved in a selected folder all at once. Plus, PDF data and text-searchable data can be generated.

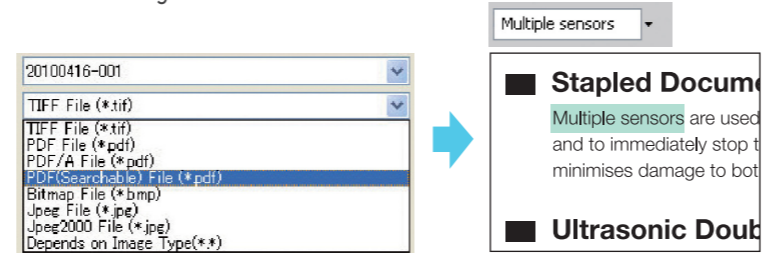

Select PDF (Searchable).

Text-searchable data is generated.

PreScan

In the preview window, you can confirm what the scanned image will look like under the current scan settings. You can make fine adjustments to brightness, contrast and other parameters while looking at the final result, and then save the desired scan settings. This boosts work efficiency by preventing wasted scans.



A Wealth of Image Processing Functions

No more worries about the document's direction Automatic Image Orientation

Even when documents are set in different directions, this function detects the direction of the scanned text in documents and automatically rotates it into the correct direction.

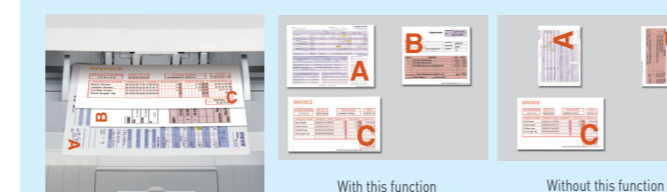

No more need to pre-sort documents Automatic Binary/ Colour Distinction

Automatic Binary/ Colour Distinction allows the scanner to recognise colour and black and white pages. This feature reduces scan to file size while promoting a more efficient scanning process.

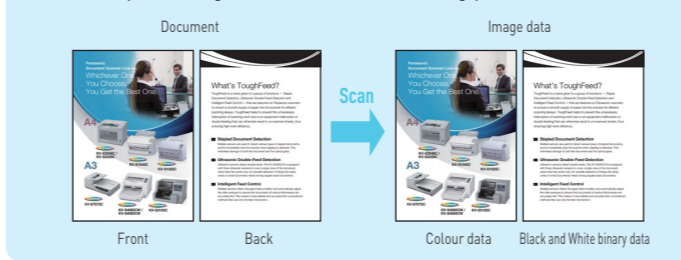

Two-in-one convenience Double Exposure

Double Exposure automatically scans then saves two-sided documents into a single-page file. It is highly effective for documents printed on both sides, such as checks, stock certificates, post cards, and business cards.

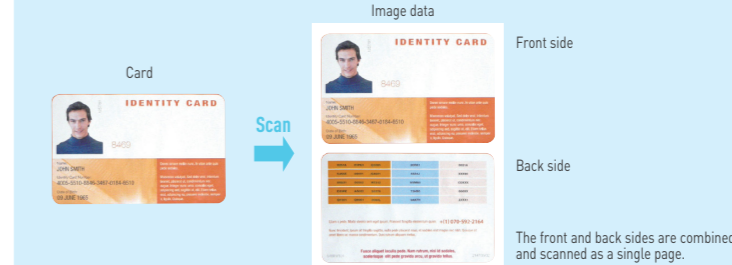

You can convert only the desired pages into electronic form Blank Page Removal

When scanning a set of documents that contains both single-sided and double-sided sheets, this function automatically skips over the blank sides.

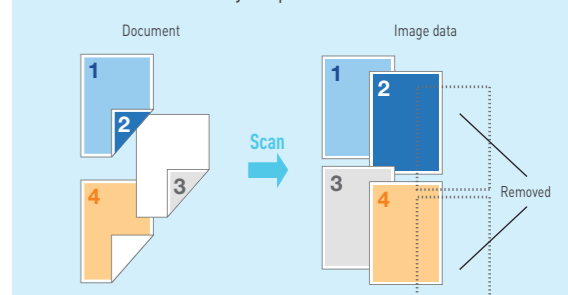

Eliminates post-processing Automatic Crop and De-Skew

When you scan documents of mixed size, the documents are automatically cropped and stored in the appropriate size. Also, skewed documents are automatically straightened when they are scanned.

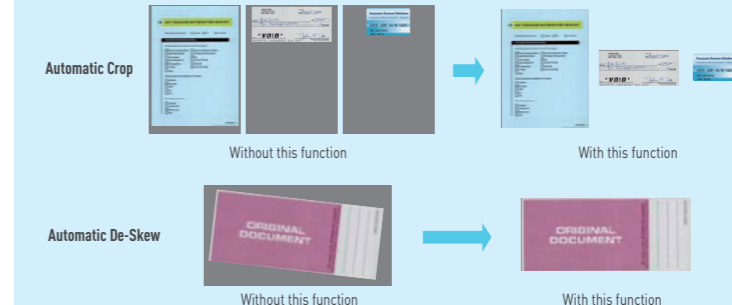

Single pass for dual output Multi Stream

The Multistream function enables a single scan to be saved as two separate formats simultaneously. For example the document will be saved in monochrome (B/W) for OCR and archival purposes, and saved as a full colour image for short term on-screen retrieval.

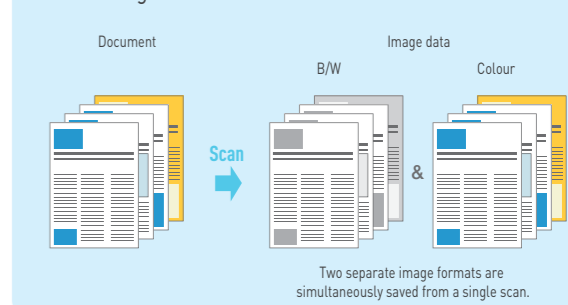

Excellent readability and accuracy Dynamic Threshold

With the Dynamic Threshold function, the background density and colour are automatically detected section by section, and the scan setting (brightness control) is automatically adjusted to ensure sharp scanning of both text and images.

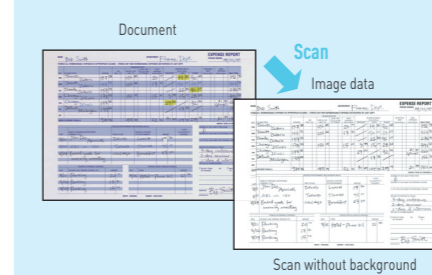

Convenient for OCR processing Multi Colour Dropout

Any of up to three specific colour ranges on the document can be selected as a dropout colour. This function, when used in form processing applications, can greatly improve OCR performance and accuracy, resulting in increased productivity and potential cost savings.

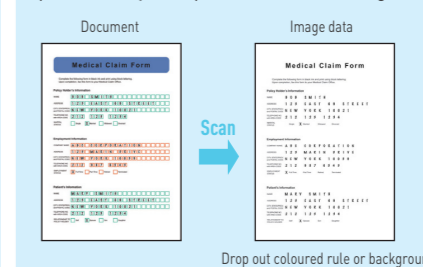

Punch holes from the document are removed from the image Hole Removal

The Hole Removal function removes the punch hole marks from the scanned image. Round or square black shapes around the edges are replaced with the colour closest to the document.



No more fuzzy backgrounds Smooth Background

The Smooth Background function analyses images while scanning for background colour content, and outputs the images with the background colour solidified. This increases viewing clarity and reduces JPEG output file size.

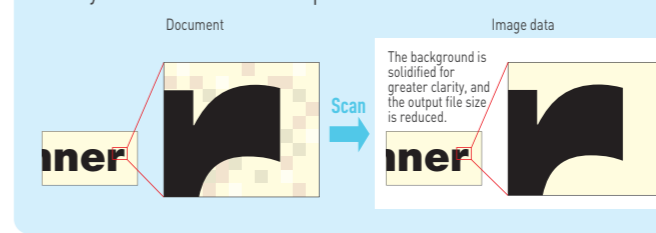

Easily get the data you need from each page 2-Page Separation

2-Page Separation automatically divides the single image into two single sheets. Dividing scanned documents saves time and trouble because it makes complex editing operations unnecessary.

