

# 8" LED Downlight

## LF8SL

120V-277V  
High Efficacy  
0-10V Dimming

### APPLICATIONS:

LiteFrame LF8SL is a 8" specification grade LED open downlight that utilizes remote phosphor technology to obtain color consistency, energy savings, and low maintenance costs. 50,000 hours minimum life up to 35°C (95°F) in open plenum applications.

### HOUSING:

One-piece 22 gauge non-corrosive steel platform. Pre-wired j-box with snap-on cover for easy access. Snap-in connection from driver compartment allows easy installation of light engine/trim assembly without tools above or below the ceiling and can be upgraded to accommodate technology improvements. Approve for 8 (4 in/4 out) No. 12 AWG conductors rated for 90°C through wiring.

### REFLECTOR:

High purity aluminum, Alzak, iridescence suppressed, semi-diffuse reflector. Self-trim standard. Painted white self-trim (WT) available as option.

### LED LIGHT ENGINE:

The LF8SL uses the Philips Fortimo DLM Gen 5 LED Module with remote phosphor technology. This technology provides controlled color consistency (3 SDCM) from fixture to fixture. The system is designed for optional life and lumen maintenance (>50,000 hours at 70% lumen maintenance). Both reflector and light engine assembly are mechanically retained to housing. The light engine comes standard with 90 CRI in all Kelvin temperatures.

### LED DRIVER:

The LF8SL utilizes the Philips Fortimo LED Driver specifically

designed to optimize efficiency of the Fortimo DLM Module. Driver is designed to match the 50,000 hour minimum life expectancy of the system. Meets UL Class 2, inherent short circuit protection, self limited, overload protected. If critical temperatures are reached on driver or LED module, integrated thermal feedback loop will gradually reduce current to protect system life. Driver is universal 120V-277V. Optional Lutron Series A driver is also available.

### DIMMING:

Comes standard with 0-10V dimming capability. Flicker-free dimming to 10%. 0-10V control may consume up to 1mA. 0-10V, Lutron 2 wire, 3 wire, and EcoSystem dimming available to 1% and DMX with RDM (remote device management) dimming to less than 0.1%.

### INSTALLATION:

Adjustable Bar hangers included. Universal adjustable mounting brackets also accept 1/2" EMT conduit or 1 1/2" or 3/4" lathing channel (by others) or Prescolite 24" bar hangers (B24 or B6).

### CERTIFICATIONS:

CSA certified to US and Canadian safety standards. Suitable for wet locations. Approved for through wiring. Non-IC rated. EM and EMR is damp rated and for US use only. ENERGY STAR qualified with open clear Alzak reflector. UL approved for NSF2 splash zone applications.

### WARRANTY:

5 year warranty. See [www.prescolite.com](http://www.prescolite.com) for details.

DATE: \_\_\_\_\_ TYPE: \_\_\_\_\_

FIRM NAME: \_\_\_\_\_

PROJECT: \_\_\_\_\_

# LiteFrame®



Ceiling Cutout: 8 1/4"  
Maximum Ceiling Thickness 1 1/4"  
For conversion to millimeters,  
multiply inches by 25.4  
Not to Scale

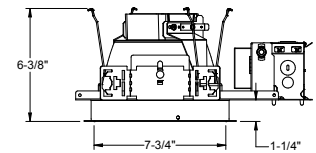
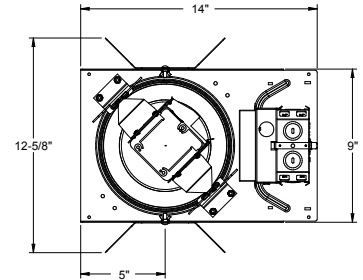

See page 4 for EMR, CP, LV(E) and NX(W)E line art

CATALOG NUMBER:

EXAMPLE: LF8SL 8LFSL15L40K

Order housing, reflector, and accessories separately

STANDARD 0-10V DIMMING

ALTERNATIVE DIMMING TO 1% & 0.1%

HOUSING	DRIVER OPTION	HOUSING OPTIONS	TRIM APERTURE	OUTPUT	KELVIN	REF. FINISH OPTIONS	REF. COLOR OPTIONS	REFLECTOR OPTIONS	ACCESSORIES	
<b>LF8SL</b> Standard Lumen 0-10V 10% dimming 120-277V	<i>Standard 0-10V 10% Dimming</i> <input type="checkbox"/> <b>DM1</b> 0-10V dimming at 1% <input type="checkbox"/> <b>DMT<sup>10,11</sup></b> SpectraSync™ Tunable White <input type="checkbox"/> <b>DMTW<sup>12</sup></b> SpectraSync™ Tunable Dim to Warm <b>VOLTAGE OPTION</b> <i>Standard 120V-277V</i> <input type="checkbox"/> <b>347</b> 347V	<input type="checkbox"/> <b>EM<sup>2,3</sup></b> Emergency Battery Pack with integral test switch and indicator light <input type="checkbox"/> <b>EMR<sup>2</sup></b> Emergency Battery Pack with remote test switch and indicator light <input type="checkbox"/> <b>CP<sup>2,5,6,7,13</sup></b> Chicago Plenum <input type="checkbox"/> <b>LV<sup>9</sup></b> Lutron Vive Enabled, 0-10V, 120-277V <input type="checkbox"/> <b>NXWE<sup>5,14,15</sup></b> NX Wireless Enabled <input type="checkbox"/> <b>NXE<sup>5,14,15</sup></b> NX Enabled, Dual SmartPorts	<input type="checkbox"/> <b>8LFSL</b> Semi-Diffuse Clear Alzak <input type="checkbox"/> <b>11L</b> 1100 Lumen Module <input type="checkbox"/> <b>15L</b> 1500 Lumen Module <input type="checkbox"/> <b>20L<sup>13</sup></b> 2000 Lumen Module <input type="checkbox"/> <b>2230TD</b> 2200K-3000K SpectraSync™ Dim to Warm <input type="checkbox"/> <b>2750T</b> 2700K-5000K SpectraSync™ Tunable White <input type="checkbox"/> <b>2765T</b> 2700K-6500K SpectraSync™ Tunable White	<input type="checkbox"/> <b>30K</b> 3000 Kelvin, 90 CRI <input type="checkbox"/> <b>35K</b> 3500 Kelvin, 90 CRI <input type="checkbox"/> <b>40K</b> 4000 Kelvin, 90 CRI <input type="checkbox"/> <b>2230TD</b> 2200K-3000K SpectraSync™ Dim to Warm <input type="checkbox"/> <b>2750T</b> 2700K-5000K SpectraSync™ Tunable White <input type="checkbox"/> <b>2765T</b> 2700K-6500K SpectraSync™ Tunable White	<input type="checkbox"/> <b>SP</b> Specular <input type="checkbox"/> <b>SS</b> Semi-Specular <input type="checkbox"/> <b>MFC</b> American Matte™ <input type="checkbox"/> <b>V</b> Kurt Versen Specular <input type="checkbox"/> <b>VS</b> Kurt Versen Softglow® <input type="checkbox"/> <b>VSS</b> Kurt Versen SoftSheen™	<i>Standard Clear Alzak</i> <input type="checkbox"/> <b>CG</b> Champagne Gold Alzak <input type="checkbox"/> <b>GD</b> Gold Alzak <input type="checkbox"/> <b>BL</b> Black Alzak <input type="checkbox"/> <b>WE</b> Wheat Alzak <input type="checkbox"/> <b>LW</b> Light Wheat Alzak <input type="checkbox"/> <b>PW</b> Pewter Alzak <input type="checkbox"/> <b>WH</b> Painted Matte White Reflector and Flange <input type="checkbox"/> <b>BC</b> Painted Black Reflector and Flange	<input type="checkbox"/> <b>EM<sup>2,3</sup></b> Pre-punched reflector for integral switch <input type="checkbox"/> <b>AM<sup>4,6</sup></b> Antimicrobial coating on clear Alzak reflector only <input type="checkbox"/> <b>CP<sup>2,5,6,7,13</sup></b> Chicago Plenum <b>TRIM OPTIONS</b> <input type="checkbox"/> <b>WT</b> Painted White Flange Only <input type="checkbox"/> <b>TRG</b> Trim Ring Gasket	<input type="checkbox"/> <b>B24</b> Set of two 24" bar hangers for T-bar ceilings <input type="checkbox"/> <b>B6</b> Set of two (2) bar hangers for ceiling joist up to 24" centers <input type="checkbox"/> <b>LF5C8</b> 8" Reflector screw cover <input type="checkbox"/> <b>SCA8D</b> Sloped ceiling adapter (see note on back page) <input type="checkbox"/> <b>Signos8</b> Architectural glass elements. Refer to specification sheets ARCH-SIG-005 and -007 <input type="checkbox"/> <b>LiteGear<sup>8</sup></b> Inverter, single phase central lighting, 125VA-250VA <input type="checkbox"/> <b>LPS Series<sup>8</sup></b> LitePower micro-inverter, 20VA-55VA		
<b>Use with HDM/2DM/DMX dimming option: Match Housing to Trim Output</b>										
<input type="checkbox"/> <b>LF8SL11L</b> <input type="checkbox"/> <b>LF8SL15L</b> <input type="checkbox"/> <b>LF8SL20L</b>	<input type="checkbox"/> <b>HDM<sup>1</sup></b> Hi-Lume 1% 3-wire/ EcoSystem LED Driver <input type="checkbox"/> <b>2DM<sup>1</sup></b> Hi-Lume 1% 2-wire LED Driver (120V only) <input type="checkbox"/> <b>DMX<sup>1</sup></b> DMX with RDM dimming to <0.1%	<input type="checkbox"/> <b>120</b> 120V <input type="checkbox"/> <b>277</b> 277V	<input type="checkbox"/> <b>LVE (HDM Only)</b> Lutron Vive Enabled, EcoSystem <i>*HDM, 2DM &amp; DMX also available with EMR and VVV</i>							
<p><small>Notes:</small></p> <ol style="list-style-type: none"> <li>For HDM, 2DM and DMX options, housing output must match trim output</li> <li>Not available with 347V</li> <li>EM options required on both housing and trim</li> <li>Clear Alzak standard. Consult factory for other colors</li> <li>Not available with EMR, DMX, LV or LVE</li> <li>Not available with EM</li> <li>CP options required on both housing and trim</li> <li>See Central Inverter =compatibility note and web links on page 3</li> <li>LV requires standard dimming or DM1</li> <li>Must select either 2750T or 2765T Kelvin with DMT driver option</li> <li>Not available with LV or LVE</li> <li>Must select 2230TD with DMTW driver option</li> <li>Not compatible with DMT or DMTW</li> <li>Not available with CP option</li> <li>Not available with HDM, 2DM, or DMX</li> </ol>										



In a continuing effort to offer the best product possible we reserve the right to change, without notice, specifications or materials that in our opinion will not alter the function of the product.  
Web: [www.prescolite.com](http://www.prescolite.com) • Tech Support: (888) 777-4832

LF8-LED-023

# PHOTOMETRIC DATA

## LiteFrame - 8" LF8SL Downlight

DRIVER DATA	8LFSL20L	8LFSL15L	8LFSL11L
Input Voltage	120-277V	120-277V	120-277V
Input Frequency	50/60 Hz	50/60 Hz	50/60 Hz
Input Current	0.213A (120V) 0.092A (277V)	0.162A (120V) 0.070A (277V)	0.118A (120V) 0.051A (277V)
Input Power	25.5W	19.4W	14.1W
Constant Current Output	200-700mA	200-1000mA	200-1000mA
Power Factor	≥0.90	≥0.90	≥0.90
THD	<20%	<20%	<20%
EMI Filtering	FCC 47CFR Part 15, Class A	FCC 47CFR Part 15, Class A	FCC 47CFR Part 15, Class A
Operating Temperature	-20°C to 35°C	-20°C to 35°C	-20°C to 35°C
Dimming	0-10V	0-10V	0-10V

Over-voltage, over-current, short-circuit protected

\*Power consumption and photometric output may vary slightly with HDM or 2DM option.

When operating in EM mode, the fixture will deliver approximately 30% of the published full lumen output.

### LF8SL 8LFSL20L30K

LED Light Engine: 3000K, 90 CRI  
System Wattage: 25.5W  
Fixture Delivered Lumens: 1853  
Fixture Efficacy: 72.7  
Spacing Criteria: 1.2

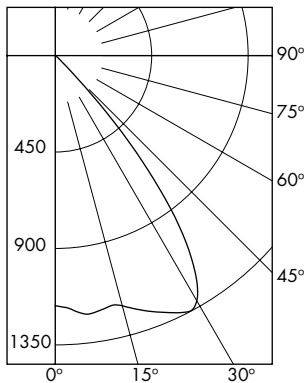

#### CANDELA DISTRIBUTION

DEG	CANDELA
0	1167
5	1201
15	1209
25	1324
35	1063
45	103
55	8
65	2
75	0
85	0
90	0

Test No. 17.00130

Tested at 25°C Ambient in accordance to IESNA LM-79-2008

#### ZONAL LUMEN SUMMARY

ZONE	LUMENS	%LUMINAIRE
0-30	1072	57.8
0-40	1704	91.9
0-60	1851	99.9
0-90	1853	100.0
90-180	0	0.0
0-180	1853	100.0

#### LUMINANCE DATA IN CANDELA/SQ. METER

Angle in Vertical	Average
45°	7985
55°	765
65°	259
75°	0
85°	0

#### COEFFICIENTS OF UTILIZATION Zonal Cavity Method

Room Cavity Ratio	% Effective Ceiling Cavity Reflectance																
	80%			70%			50%			30%			10%				
	70	50	30	10	70	50	30	10	50	30	10	50	30	10	50	30	
1	113	110	108	105	111	108	106	104	104	102	100	100	99	97	97	96	95
2	107	102	97	94	105	100	96	93	97	94	91	94	91	89	91	89	87
3	101	94	89	84	99	93	88	84	90	86	82	88	84	81	85	82	80
4	95	87	81	77	93	86	80	76	84	79	75	82	78	74	80	76	73
5	90	81	74	70	88	80	74	69	78	73	69	76	72	68	75	71	67
6	85	75	68	64	83	74	68	63	72	67	63	71	66	63	70	65	62
7	80	70	63	58	78	69	63	58	68	62	58	66	61	58	65	61	57
8	75	65	58	54	74	64	58	54	63	57	53	62	57	53	61	56	53
9	71	60	54	50	70	60	54	50	59	53	49	58	53	49	57	52	49
10	67	57	50	46	66	56	50	46	55	50	46	54	49	46	54	49	45

LF8SL 8LFSL20L30K

Test No. 17.00130

### LF8SL 8LFSL15L30K

LED Light Engine: 3000K, 90 CRI  
System Wattage: 19.4W  
Fixture Delivered Lumens: 1406  
Fixture Efficacy: 72.5  
Spacing Criteria: 1.2

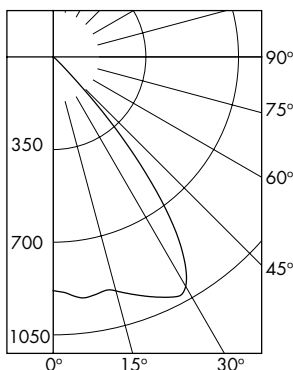

#### CANDELA DISTRIBUTION

DEG	CANDELA
0	883
5	907
15	915
25	1002
35	809
45	81
55	6
65	2
75	0
85	0
90	0

Test No. 17.00129

Tested at 25°C Ambient in accordance to IESNA LM-79-2008

#### ZONAL LUMEN SUMMARY

ZONE	LUMENS	%LUMINAIRE
0-30	811	57.7
0-40	1291	91.8
0-60	1404	99.9
0-90	1406	100.0
90-180	0	0.0
0-180	1406	100.0

#### LUMINANCE DATA IN CANDELA/SQ. METER

Angle in Vertical	Average
45°	3532
55°	323
65°	146
75°	0
85°	0

#### COEFFICIENTS OF UTILIZATION Zonal Cavity Method

Room Cavity Ratio	% Effective Ceiling Cavity Reflectance																
	80%			70%			50%			30%			10%				
	70	50	30	10	70	50	30	10	50	30	10	50	30	10	50	30	
1	113	110	108	105	111	108	106	104	104	102	100	100	99	97	97	96	95
2	107	102	97	94	105	100	96	93	97	94	91	94	91	89	91	89	87
3	101	94	89	84	99	93	88	84	90	86	82	88	84	81	85	82	80
4	95	87	81	76	93	86	80	76	84	79	75	82	78	74	80	76	73
5	90	81	74	70	88	80	74	69	78	73	69	76	72	68	74	71	67
6	85	75	68	64	83	74	68	63	72	67	63	71	66	63	70	65	62
7	80	70	63	58	78	69	63	58	68	62	58	66	61	58	65	61	57
8	75	65	58	54	74	64	58	54	63	57	53	62	57	53	61	56	53
9	71	60	54	50	70	60	54	49	59	53	49	58	53	49	57	52	49
10	67	56	50	46	66	56	50	46	55	50	46	54	49	46	54	49	45

LF8SL 8LFSL15L30K

Test No. 17.00129

Web: [www.prescolite.com](http://www.prescolite.com) • Tech Support: (888) 777-4832

701 Millennium Boulevard • Greenville, SC 29607 U.S.A. • Phone (864) 678-1000

Copyright ©2017 Prescolite, Inc., a division of Hubbell Lighting, Inc. All Rights Reserved

Specifications subject to change without notice. • Printed in U.S.A. • LFR-LED-023 • 9/18/17



# PHOTOMETRIC DATA

## LiteFrame - 8" LF8SL Downlight

### LF8SL 8LFSL11L30K

LED Light Engine: 3000K, 90 CRI  
 System Wattage: 14.1W  
 Fixture Delivered Lumens: 1038  
 Fixture Efficacy: 73.6  
 Spacing Criteria: 1.2

### ZONAL LUMEN SUMMARY

ZONE	LUMENS	%LUMINAIRE
0-30	597	57.5
0-40	952	91.7
0-60	1037	99.9
0-90	1038	100.0
90-180	0	0.0
0-180	1038	100.0

### LUMINANCE DATA IN CANDELA/SQ. METER

Angle in Vertical	Average
45°	2747
55°	215
65°	73
75°	0
85°	0

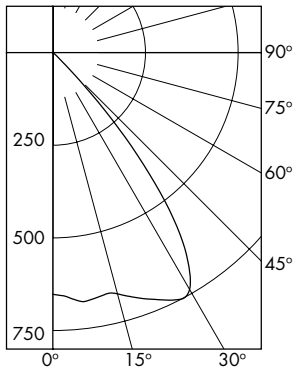

### CANDELA DISTRIBUTION

DEG	CANDELA
0	652
5	669
15	674
25	737
35	598
45	63
55	4
65	1
75	0
85	0
90	0

Test No. 17.00128

Tested at 25°C Ambient in accordance to IESNA LM-79-2008

### COEFFICIENTS OF UTILIZATION Zonal Cavity Method

Room Cavity Ratio	% Effective Ceiling Cavity Reflectance																
	80%		70%		50%		30%		10%								
	70	50	30	10	70	50	30	10	50	30	10						
1	113	110	108	105	111	108	106	104	104	102	100	100	99	97	97	96	94
2	107	102	97	94	105	100	96	93	97	94	91	94	91	89	91	89	87
3	101	94	89	84	99	93	88	84	90	86	82	88	84	81	85	82	80
4	95	87	81	76	93	86	80	76	84	79	75	82	77	74	80	76	73
5	90	81	74	70	88	80	74	69	78	73	69	76	72	68	74	71	67
6	84	75	68	64	83	74	68	63	72	67	63	71	66	62	70	65	62
7	80	69	63	58	78	69	63	58	67	62	58	66	61	57	65	61	57
8	75	65	58	54	74	64	58	54	63	57	53	62	57	53	61	56	53
9	71	60	54	50	70	60	54	49	59	53	49	58	53	49	57	52	49
10	67	56	50	46	66	56	50	46	55	49	46	54	49	45	54	49	45

LF8SL 8LFSL11L30K

Test No. 17.00128

### Dimming Compatibility Table

Dimming Ballast	Manufacturer	Web Link
DM/DM1	Lutron DTV	<a href="http://bit.ly/11jSvZg">http://bit.ly/11jSvZg</a>
DM/DM1	Leviton AWRMG-7xx, AWSMG-7xx, AWSMT-7xx	<a href="http://bit.ly/1BJn2R9">http://bit.ly/1BJn2R9</a>
HDM	Lutron	<a href="http://bit.ly/1vtjHA1">http://bit.ly/1vtjHA1</a>
2DM	Lutron	<a href="http://bit.ly/1S4WjXK">http://bit.ly/1S4WjXK</a>

### DMX

See instruction sheet on [www.prescolite.com](http://www.prescolite.com) for connection & installation information.  
 Other useful links: <http://www.eldoled.com/led-drivers/powerdrive/50-watt/ac-561s/>

### Central Inverters

For full fixture output in back-up mode, we recommend you visit [www.dual-lite.com](http://www.dual-lite.com) for your Central Lighting Inverter options. Please contact your local Hubbell representative for any assistance with proper sizing and loading of your inverter selection. Central lighting inverters must be ordered separately.

**LiteGear:** [www.dual-lite.com/products/litegear\\_lg\\_series](http://www.dual-lite.com/products/litegear_lg_series)

**LPS Series:** [www.dual-lite.com/products/lps](http://www.dual-lite.com/products/lps)

### SpectraSync™ Color Tuning Technology:

Control your space based on the needs of the application, specific activities throughout the day and preferences of the occupants with two distinct SpectraSync™ Color Tuning Technology.

**Dim to Warm:** Dim to Warm mimics the familiar warming effect that occurs with traditional incandescent sources as they are dimmed. (Available with 2200K-3000K).

**Tunable White:** Tunable White offers users the ability to tailor CCT to their personal preference, enhancing task visibility, material and colors or the aesthetics of the space. (Available with 2700K-5000K or 2700K-6500K).

See separate [SpectraSync™ Tech Sheet](#) for additional details.

### NX Distributed Intelligence:

Supports indoor and outdoor applications, wired, wireless and hybrid networked NX lighting control deployments and enables emerging applications such as Hubbell Lighting's SpectraSync™ color tuning technology.

See separate [NX™ Solutions Guide](#) for additional details.

See Hubbell Controls Solution [NX Brochure](#).

### NOTES:

When ordering a sloped ceiling adapter, specify the degree of slope in 5° increments, max. of 35°. For a more precise degree or wet ceiling applications, please contact factory. Sloped ceiling adapter and housing must be installed at the same time.

Web: [www.prescolite.com](http://www.prescolite.com) • Tech Support: (888) 777-4832  
 701 Millennium Boulevard • Greenville, SC 29607 U.S.A. • Phone (864) 678-1000  
 Copyright ©2017 Prescolite, Inc., a division of Hubbell Lighting, Inc. All Rights Reserved  
 Specifications subject to change without notice. • Printed in U.S.A. • LFR-LED-023 • 9/18/17



# LiteFrame - 8" LF8SL Downlight

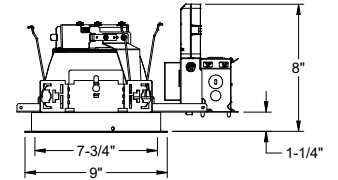
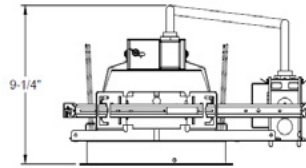
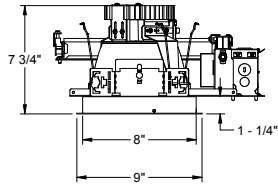
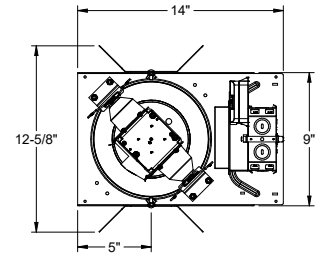
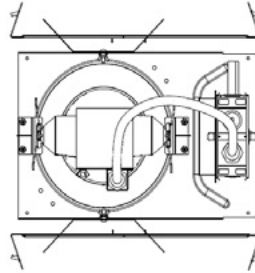
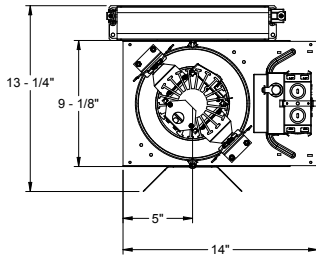

**LF8SL EM VERSION**  
(EMR DIMENSIONS ARE THE SAME)

**LF8SL CP**

**LF8SL LV(E)**

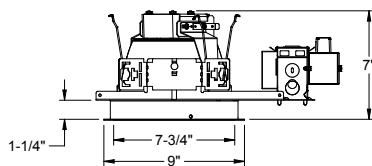
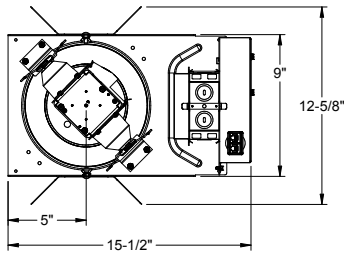

**LF8SL NX(W/E)**