

TaperFill® Tri-Taper™ Hip System  
a Short Stem *Optimized*



# TaperFill® Tri-Taper™ Hip System

## System Overview

- Ti Alloy material
- 14 stem sizes
- 135° neck angle
- Broach only system
- ~30 mm reduced stem lengths vs. the Linear® Hip stem
- P<sup>2</sup> proximal porous coating

## Standard and Offset options

Direct lateralization of the neck allows for increased stability without increased leg-length

## Data Driven Tri-Taper™ Design

Anthropomorphic data, constructed from CT scans of male and female femurs, was used to determine optimal stem design and AP growth. A 12 degree proximal taper (1) provides inherent fixation and rotational stability through increased surface area contact with cortical bone structures. A 4 degree distal taper (2) reduces the possibility of stress shielding and helps account for proximal/distal mismatch.

The ML taper (3) of the TaperFill™ stem is identical to DJO's Linear® Hip stem which has demonstrated over 17 years of clinical success.

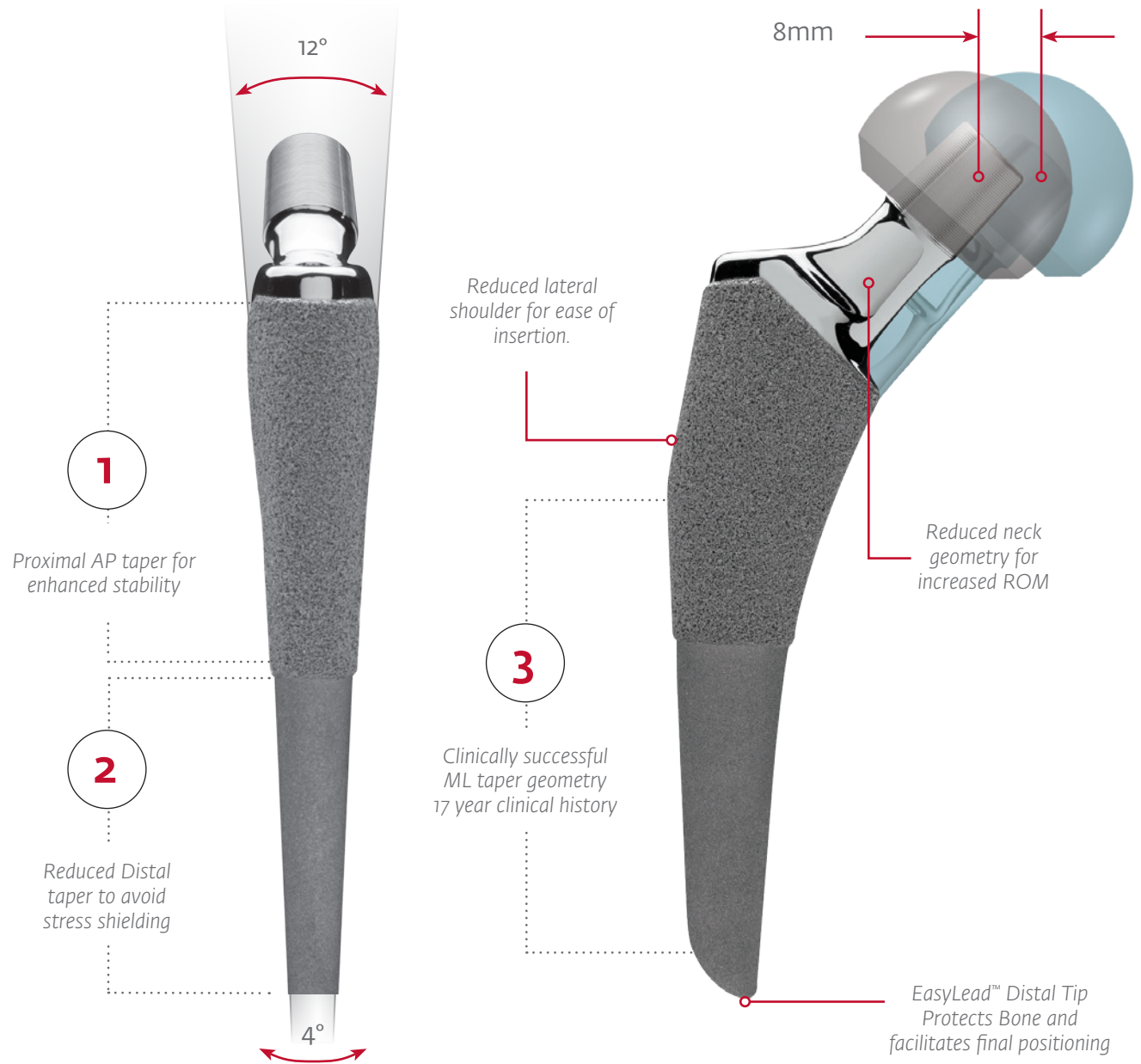

# P<sup>2</sup><sup>™</sup>

P<sup>2</sup>, a new proprietary **Titanium Porous** coating by DJO Surgical, is the first **porous** porous coating in the world wherein the non-spherical bead itself is also porous – giving it its name, P-Squared (P<sup>2</sup>). Consisting of variability in pore sizes, very similar to a “lava rock” type of structure, P<sup>2</sup> aids in the apposition of bone for superior in-growth results.

## Advanced Bearing Surfaces

TaperFill<sup>®</sup> is compatible with DJO’s advanced bearing surface options.

HXe+ provides all the wear advantages of highly crosslinked UHMWPE without the reduction of material strength. HXe+ is a proprietary blended resin that neutralizes the negative effects of free radicals, negating the need to re-melt or anneal the material after cross-linking.

BioloX Delta Ceramic heads are available in sizes up to 44mm.

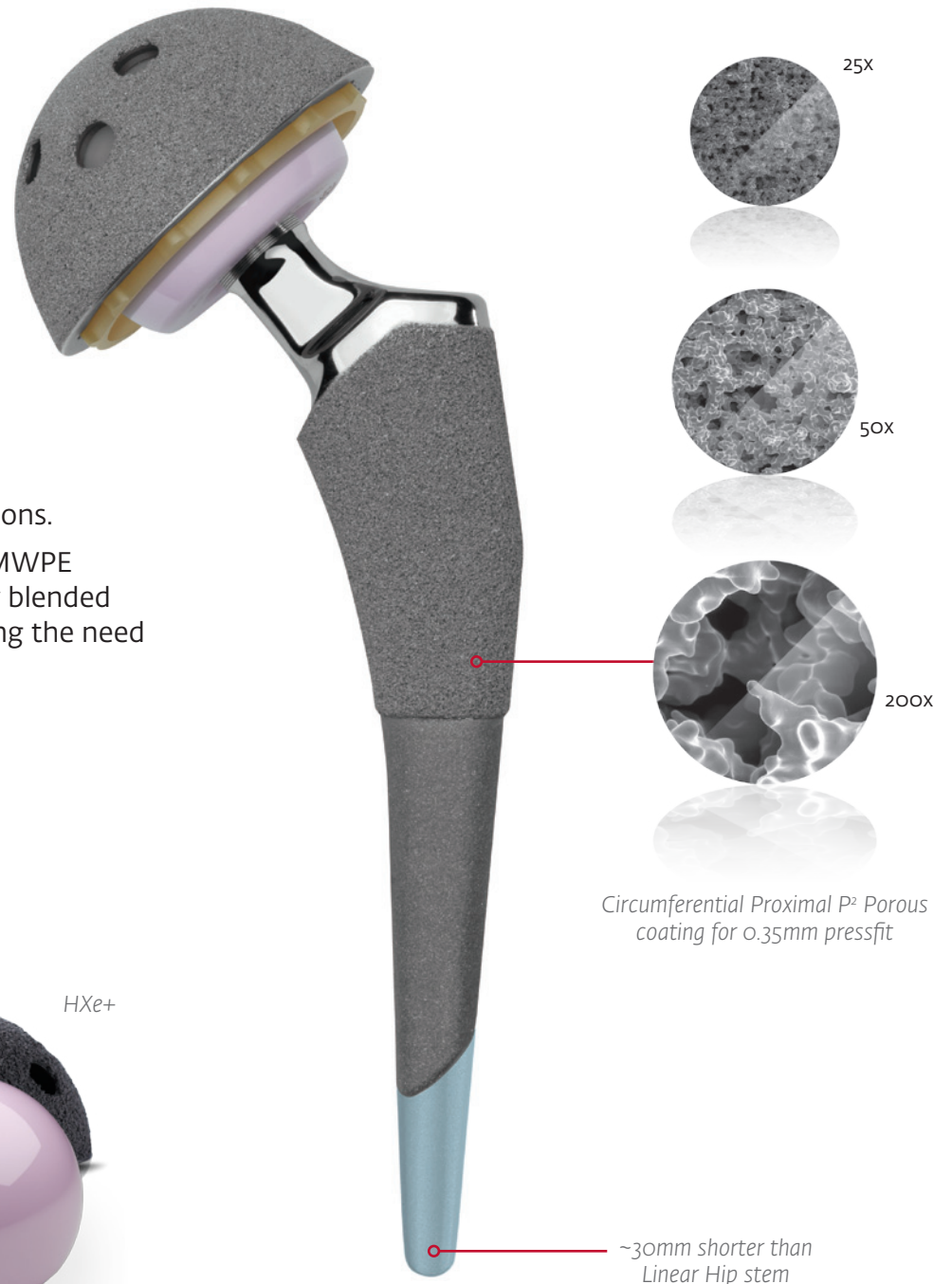

FMP Acetabular Shell w/ P<sup>2</sup>



HXe+

The Ideal Vitamin E blended polyethylene



**DJO Surgical | A DJO Global Company**

**T** 800.456.8696 **D** 512.832.9500 **F** 512.834.6300  
9800 Metric Blvd. | Austin, TX 78758 | U.S.A.

[djosurgical.com](http://djosurgical.com)

*Together in Motion™*

CAUTION: Federal Law (USA)  
restricts this device to sale by  
or on the order of a physician.

See package insert  
for a complete listing of  
indications, contraindications,  
warnings, and precautions.