

CONSULT FACTORY FOR
SPECIAL CONFIGURATIONS

7D-22-4XXA SHEET 1 OF 2 1/21/15

MOUNTING PATTERN			DRIVE PATTERN	RATIO: 16:1 THRUST: 30,000 LB [133 KN] TORQUE: 1,600 FT-LB [2170 N-M] TEMPERATURE: -20° TO 150°F [-29° TO 66°C] WEIGHT: 115 LBS [52 KGS] GREASED FOR LIFE PLATED STANDARD SHAFT	MANUAL MULTI-TURN ACTUATOR COMMERCIAL GRADE	
STD	MIN	MAX	STD		DYNATORQUE	BG44
ϕ 7.625 1/2-13 UNC	ϕ 6.875 3/8-16 UNC	ϕ 10.180 5/8-11 UNC	ϕ 4.500 1/2-13 UNC			

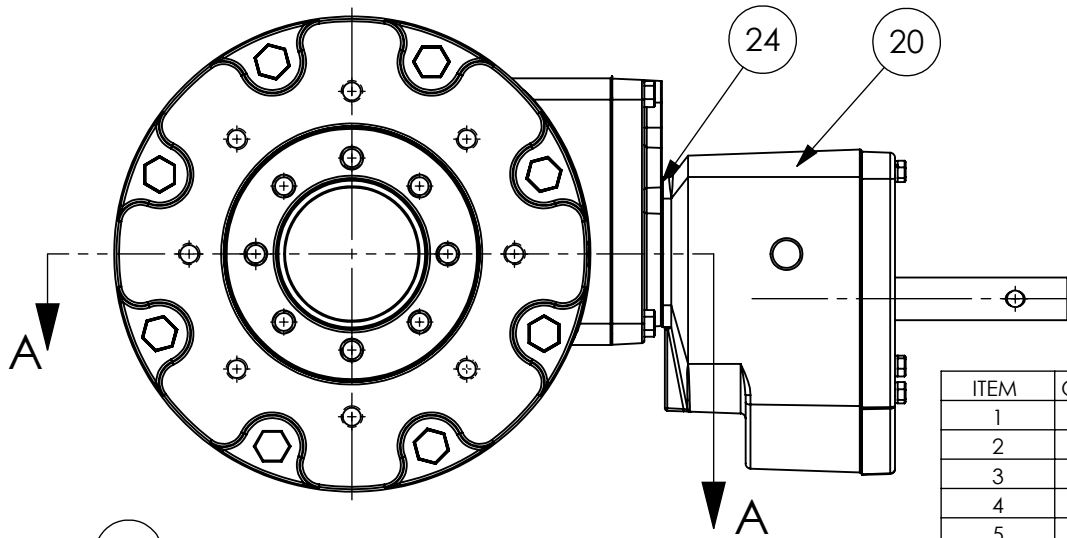
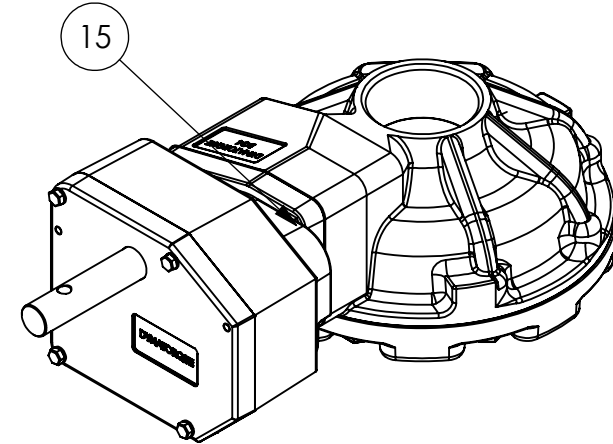
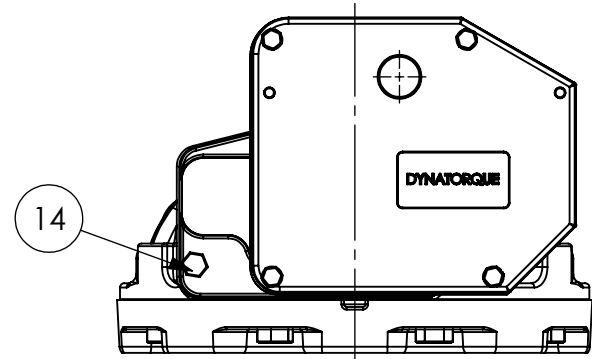
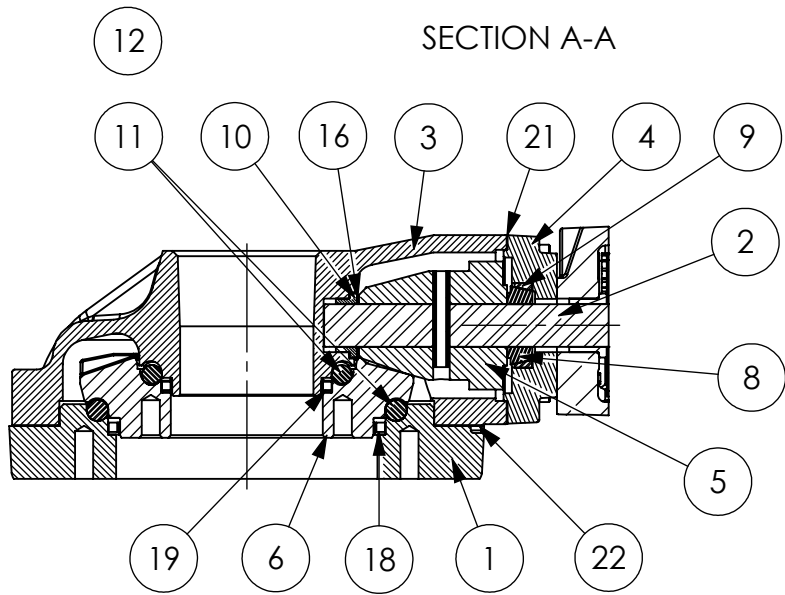

- 7 UNIT IS PAINTED BLACK ENAMEL.
- 17 UNIT BEARINGS & GEAR TEETH ARE GREASED.

ITEM	QTY.	DESCRIPTION	ITEM	QTY.	DESCRIPTION
1	1	BEARING RET, BG4, STD	15	3	HHCS , 3/8-16 X .875
2	1	SHAFT,BG4,SPUR	16	1	WASHER, WAVE
3	1	HOUSING, BG4, MACH	17	1	GREASE,COMMERCIAL GRADE
4	1	BRG HSG,BG44	18	1	LIP SEAL,6.00
5	1	BEVEL PINION,BG4,MACH	19	1	LIP SEAL,3.50
6	1	BEVEL GEAR, BG4, MACH	20	1	SPUR, 4:1
7	1	BLACK ENAMEL	21	1	GASKET, BRG HSG
8	1	ROLLER BEARING,CONE	22	1	GASKET, BRG RET
9	1	ROLLER BEARING,CUP	23	15	HHCS, 1/2-13 X 1.25 LG
10	1	BEARING,FLANGED,1.0	24	1	RTV SEALANT
11	36	BALL BEARING, .500 DIA	DYNATORQUE WWW.DYNATORQUE.COM A BRAND OF		
12	36	BALL BEARING, .469 DIA			
13	1	COIL PIN, .375, 2.25			
14	1	HHCS, 3/8-16 X 1.25 LG			

BG44