

CONSULT FACTORY FOR  
SPECIAL CONFIGURATIONS

7D-22-4XX SHEET 1 OF 2 1/21/15

MOUNTING PATTERN			DRIVE PATTERN	RATIO: 4:1 THRUST: 30,000 LB [133 KN] TORQUE: 1,600 FT-LB [2170 N-M] TEMPERATURE: -20° TO 150°F [-29° TO 66°C] EST. WEIGHT: 83 LBS [37.7 KG] GREASED FOR LIFE PLATED STANDARD SHAFT	MANUAL MULTI-TURN ACTUATOR COMMERCIAL GRADE	
STD	MIN	MAX	STD		<b>DYNATORQUE</b>	<b>BG4</b>
$\phi 7.625$ 1/2-13 UNC	$\phi 6.875$ 3/8-16 UNC	$\phi 10.180$ 5/8-11 UNC	$\phi 4.500$ 1/2-13 UNC			

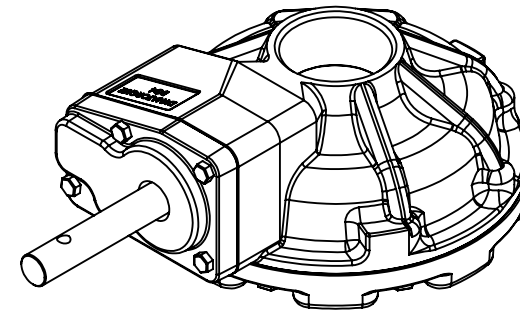
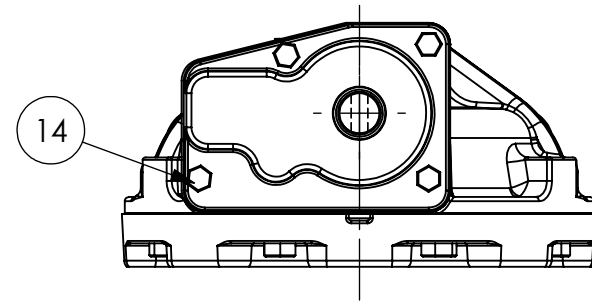
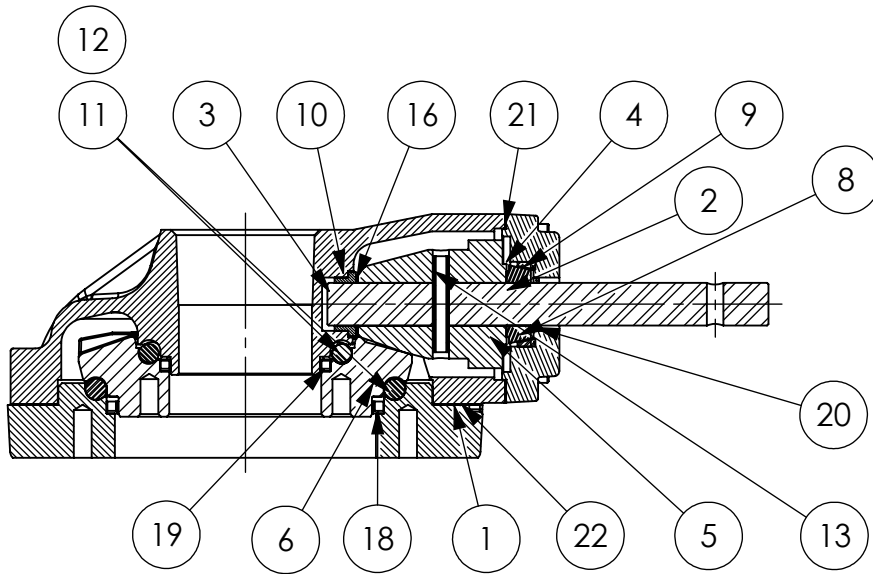

SECTION A-A

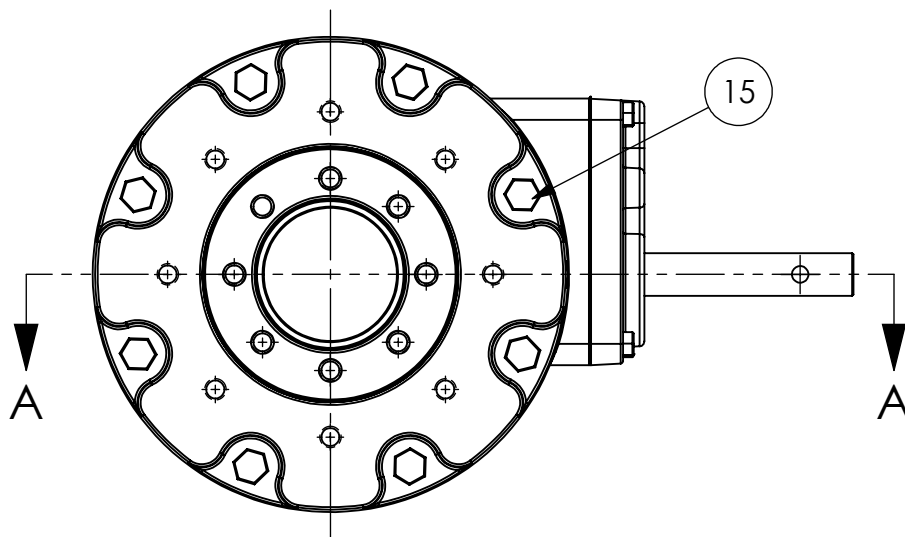

7 UNIT IS PAINTED BLACK ENAMEL.

17 UNIT BEARINGS & GEAR TEETH ARE GREASED.

ITEM	QTY.	DESCRIPTION	ITEM	QTY.	DESCRIPTION
1	1	BEARING RET, BG4, STD	15	8	HHCS, 1/2-13 X 1.25 LG
2	1	SHAFT, BG4/BG4GT	16	1	WASHER, WAVE
3	1	HOUSING, BG4, MACH	17	2	GREASE, COMMERCIAL GRADE
4	1	BEARING, HSG, MACHING	18	1	LIP SEAL, 6.00
5	1	BEVEL PINION, BG4, MACH	19	1	LIP SEAL, 3.50
6	1	BEVEL GEAR, BG4, MACH	20	1	LIP SEAL, 1.00
7	1	BLACK ENAMEL	21	1	GASKET, BRG HSG
8	1	ROLLER BEARING, CONE	22	1	GASKET, BRG RET
9	1	ROLLER BEARING, CUP			
10	1	BEARING, FLANGED, 1.0			
11	36	BALL BEARING, .500 DIA			
12	36	BALL BEARING, .469 DIA			
13	1	COIL PIN, .375, 2.25			
14	4	HHCS, 3/8-16 X 1.25 LG			

**DYNATORQUE**

WWW.DYNATORQUE.COM

A BRAND OF CAMERON

**BG4**