

智能书写本说明书

智能書寫本說明書

Digit-Note Quick Start Guide

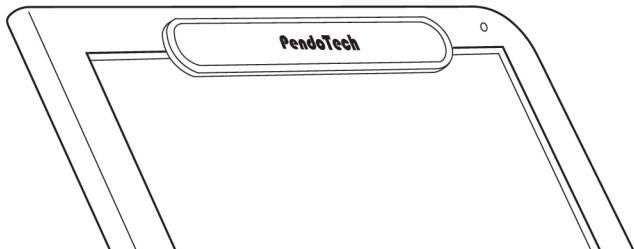

产品概览

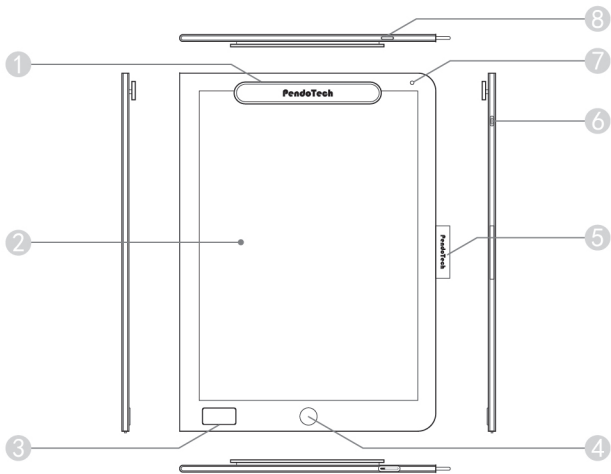

正面

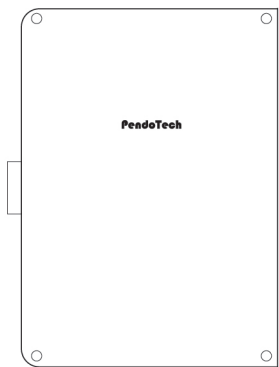

- 1 夹子
- 2 A4感应区域
- 3 状态显示屏
- 4 Home键
- 5 笔插
- 6 Micro-USB 接口
- 7 LED状态指示灯
- 8 电源键
- 9 电磁手写笔
- 10 复位键
(位于前后壳之间)

背面

产品连接

蓝牙连接：

开机后，打开平板电脑或手机的蓝牙，或在电脑上插上USB型蓝牙适配器*，然后打开相应的软件，按照软件指示，进行蓝牙配对。连接蓝牙后，若需要中途断开重新连接，请长按Home键持续三秒钟

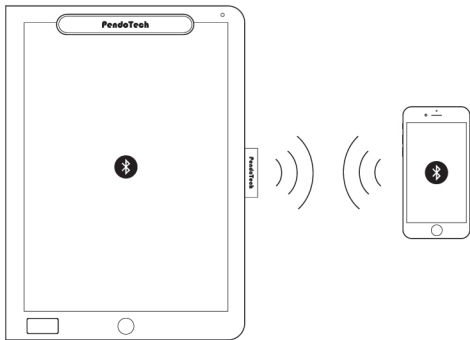

*USB型蓝牙适配器需要额外购买

USB连接：

开机后，您也可将设备通过USB线连接到电脑设备进行充电或数据传输。*数据传输功能通过软件端进行开启或关闭

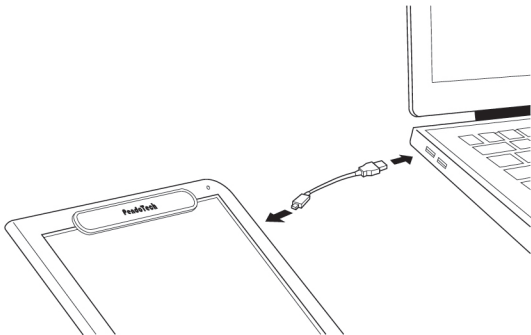

*USB连接线在PH-1410-J及PH-1410-EDU型号上仅供充电，无数据传输功能

开始使用

可放厚度不超过6.5mm的纸或本子在感应区（最大支持A4尺寸），用夹子固定

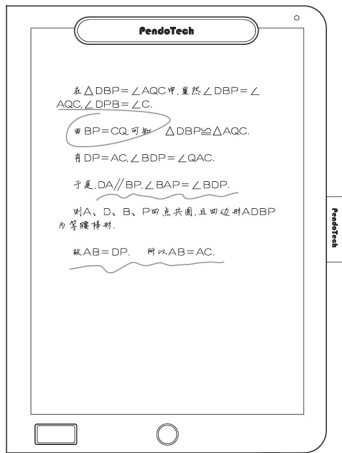

存储模式下独立使用

- 1、开机后，直接在纸上进行书写，每写完一页，轻按Home键即可保存该页内容，所有内容会保存在设备内
- 2、需要将设备内的数据上传到软件端的时候，通过蓝牙或USB连接相应设备后，在软件端操作即可完成*#

存储模式下连接设备使用

- 1、开机后，通过蓝牙或USB连接相应设备*
- 2、在纸上进行书写，每写完一页，在软件端操作即可将该页内容及时上传到相应的软件端#

实时模式下连接设备使用

- 1、开机后，通过蓝牙或USB连接相应设备*
- 2、通过软件打开实时模式
- 3、在纸上进行书写，所书写的每一笔内容都会实时显示在软件端，设备内不会存储任何书写内容

*USB连接线在PH-1410-J及PH-1410-EDU型号上仅供充电，无数据传输功能

#具体操作步骤可能因不同软件的设置不同而有所不同，如有疑问，请咨询客服或代理商

状态显示屏

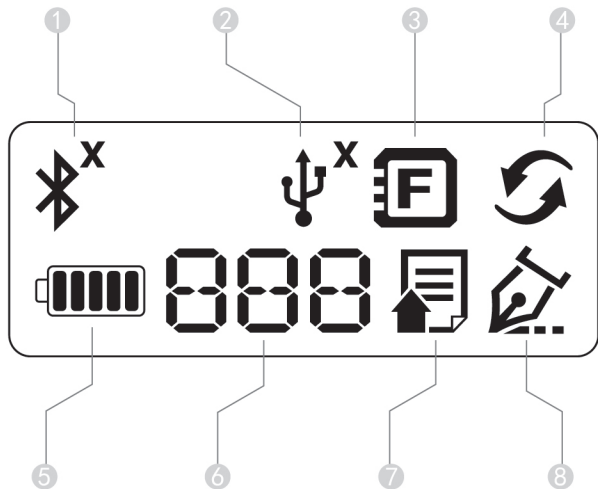

-
- 1 蓝牙连接状态
 - 2 USB数据传输连接状态
 - 3 存储模式（F出现时表示存储将满）
 - 4 实时模式
 - 5 电池电量
 - 6 已存储页数
 - 7 已存储文件上传中
 - 8 笔书写中

* 其中，及图标右上角没有 X 的时候表示已连接并可以传输数据，有 X 的时候表示数据传输断开，和两个图标只在存储模式中显示，

在 PH-1410-J 及 PH-1410-EDU 型号中不会显示

* 专门应用场景中的组网模式，和图标会同时亮起

LED状态指示灯

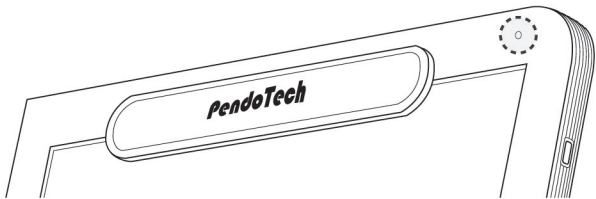

红色闪烁：电量 \leq 10%时，低电量警告



红色常亮：充电中



绿色长亮：电量充满

产品配件

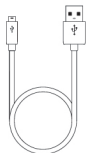

USB连接线*



笔芯三支



换笔芯器

* USB连接线在PH-1410-J及PH-1410-EDU型号上仅供充电，无数据传输功能

更换笔芯

1

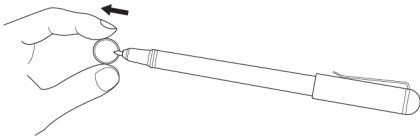

2

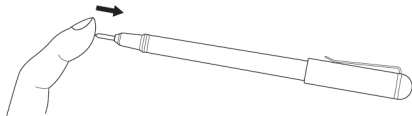

产品恢复出厂设置

用户同时按住Home键和电源键，持续五秒钟，即可将产品恢复出厂设置，恢复出厂设置前请先备份设备内已经存储的数据，否则恢复出厂设置后，设备内的所有数据将被清空

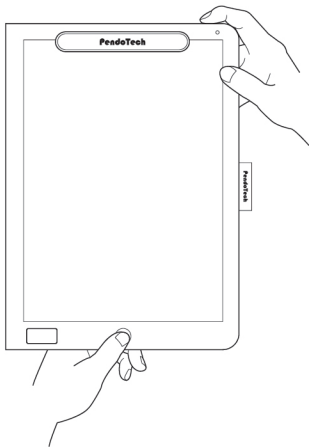

產品概覽

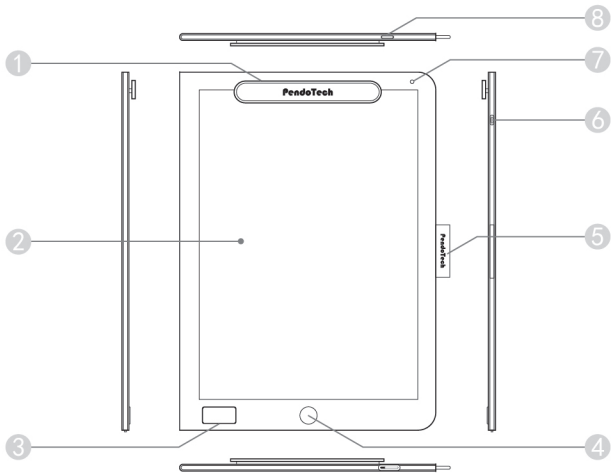

正面

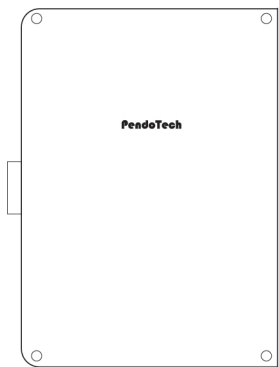

- 1 夾子
- 2 A4感應區域
- 3 狀態顯示屏
- 4 Home鍵
- 5 筆插
- 6 Micro-USB 接口
- 7 LED狀態指示燈
- 8 電源鍵
- 9 電磁手寫筆
- 10 復位鍵
(位于前後殼之間)

背面

產品連接

藍牙連接：

開機後，打開平板電腦或手機的藍牙，或在電腦上插上USB型藍牙適配器*，然後打開相應的軟體，按照軟體指示，進行藍牙配對。連接藍牙後，若需要中途斷開重新連接，請長按Home鍵持續三秒鐘

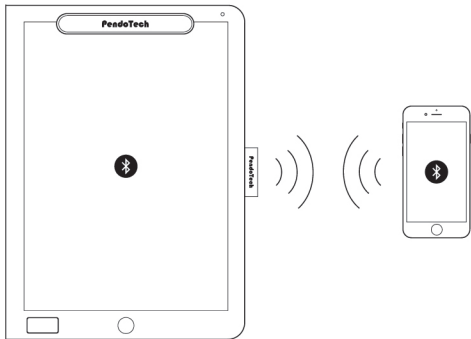

*USB型藍牙適配器需要額外購買

USB連接：

開機後，您也可將設備通過USB綫連接到電腦設備進行充電或數據傳輸。*資料傳輸功能通過軟體端進行開啓或關閉

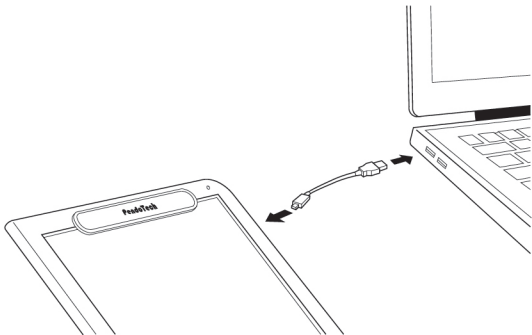

*USB連接線在PH-1410-J及PH-1410-EDU型號上僅供充電，無資料傳輸功能

開始使用

可放厚度不超過6.5mm的紙或本子在感應區（最大支持A4尺寸），用夾子固定

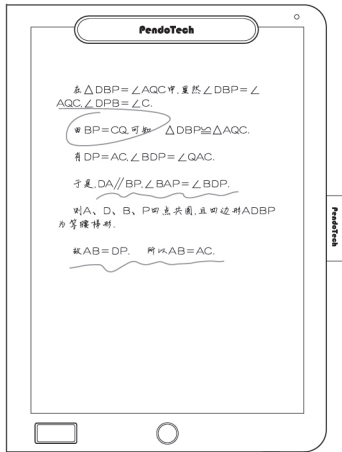

存儲模式下獨立使用

- 1、開機後，直接在紙上進行書寫，每寫完一頁，輕按Home鍵即可保存該頁內容，所有內容會保存在設備內
- 2、需要將設備內的資料上傳到軟體端的時候，通過藍牙或USB連接相應設備後，在軟體體操作即可完成*#

存儲模式下連接設備使用

- 1、開機後，通過藍牙或USB連接相應設備*
- 2、在紙上進行書寫，每寫完一頁，在軟體端操作即可將該頁內容及時上傳到相應的軟體端#

實時模式下連接設備使用

- 1、開機後，通過藍牙或USB連接相應設備*
- 2、通過軟體打開實時模式
- 3、在紙上進行書寫，所書寫的每一筆內容都會實時顯示在軟體端，設備內不會存儲任何書寫內容

*USB連接線在PH-1410-J及PH-1410-EDU型號上僅供充電，無資料傳輸功能
#具體操作步驟可能因不同軟體的設置不同而有所不同，如有疑問，請諮詢客服或代理商

狀態顯示屏

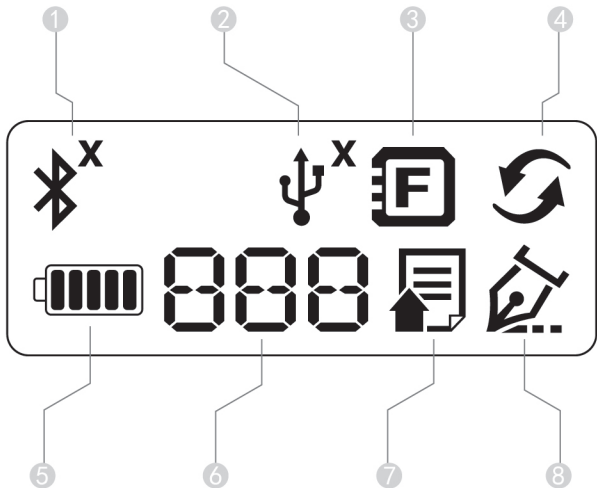





-
- 1 藍牙連接狀態
 - 2 USB資料傳輸連接狀態
 - 3 存儲模式（F出現時表示存儲將滿）
 - 4 實時模式
 - 5 電池電量
 - 6 已存儲頁數
 - 7 已存儲文件上傳中
 - 8 筆書寫中

* 其中，及圖示右上角沒有X的時候表示已連接並可以傳輸資料，有X的時候表示資料傳輸斷開，和兩個圖示只在存儲模式中顯示，在 PH-1410-J 及 PH-1410-EDU 型號中不會顯示

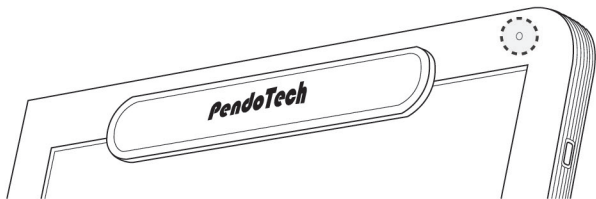
* 專門應用場景中的組網模式，和圖示會同時亮起

LED狀態指示燈



-  紅色閃爍：電量 \leq 10%時，低電量警告
-  紅色常亮：充電中
-  綠色長亮：電量充滿

產品配件

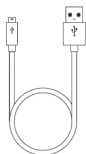

USB連接綫*



筆芯三支



換筆芯器

*USB連接綫在PH-1410-J及PH-1410-EDU型號上僅供充電，無資料傳輸功能

更換筆芯

1

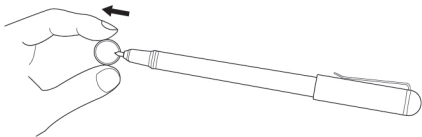

2

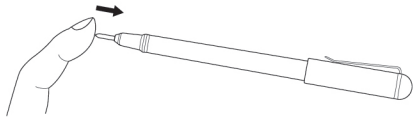

產品恢復出廠設置

用戶同時按住Home鍵和電源鍵，持續五秒鐘，即可將產品恢復出廠設置，恢復出廠設置前請先備份設備內已經存儲的資料，否則恢復出廠設置後，設備內的所有資料將被清空

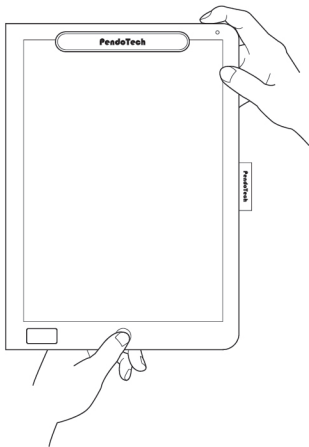

Getting to Know the Digit-Note

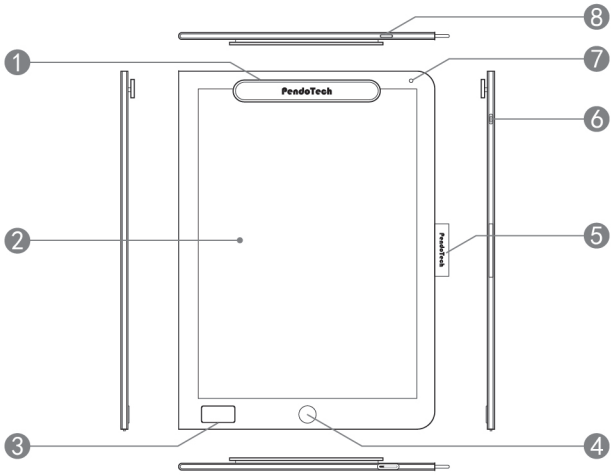

Front

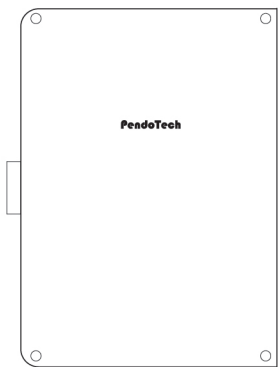

- 1 Clip
- 2 A4 writing area
- 3 Status screen
- 4 Home button
- 5 Pen holder
- 6 Micro-USB
- 7 Status LED
- 8 Power button
- 9 Pen
- 10 Reset button
(Between Front and Back cover)

Back

Connection:

Bluetooth 4.0 connection :

Open the Digit-Note, open the Bluetooth of your pad or phone, or plug the USB Bluetooth Dongle *to your computer, then open related software to operate according to software's guidance.If reconnection needed, please press the Home button for 3 seconds.

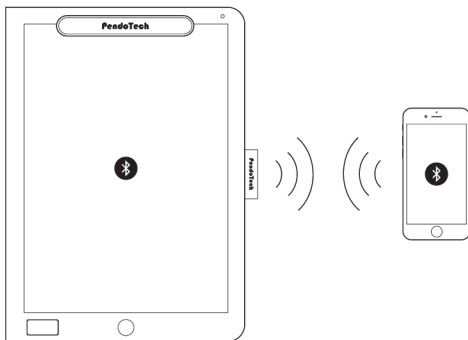

USB Connection :

Open the Digit-Note, plug the device to computer by USB cable to charge or transfer data.*The data transfer function is opened or closed by software.

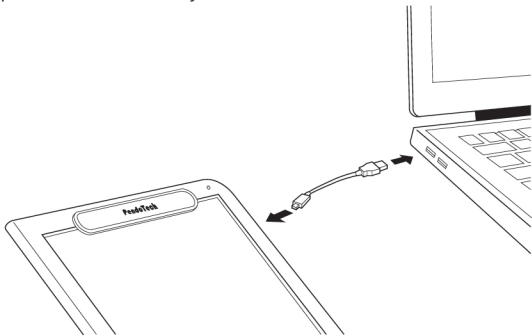

*The USB Bluetooth Dongle needs to be purchased as accessory.

*USB only provides power charge for PH-1410-J & PH-1410-EDU, no data transfer.

Getting Started:

You can put paper or writing pad no thicker than 6.5mm into the A4 writing area, and clip the paper or writing pad (A4 size maximum).

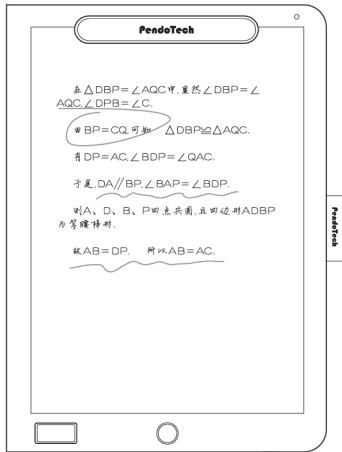

Storage mode in stand-alone use:

- 1、 Power on the device, write on paper, press Home button after finishing every page on paper, then, the contents will be saved in the device correspondently in the form of pages.
- 2、 When you need to upload all the saved pages, you can connect the device via Bluetooth or USB cable*, then, operate in software to upload. #

Storage mode in connected use:

- 1、 Power on the device, and connect it via Bluetooth or USB cable*.
- 2、 Write on paper, press Home button after finishing every page, then, each page will be uploaded right after every time you operate in software to upload. #

Real time mode in connected use

- 1、 Power on the device, and connect it via Bluetooth or USB cable*.
- 2、 Open the real time mode in software.
- 3、 Write on paper, every stroke you are writing will be displayed on software immediately, and all the contents you write will not be saved in the device.





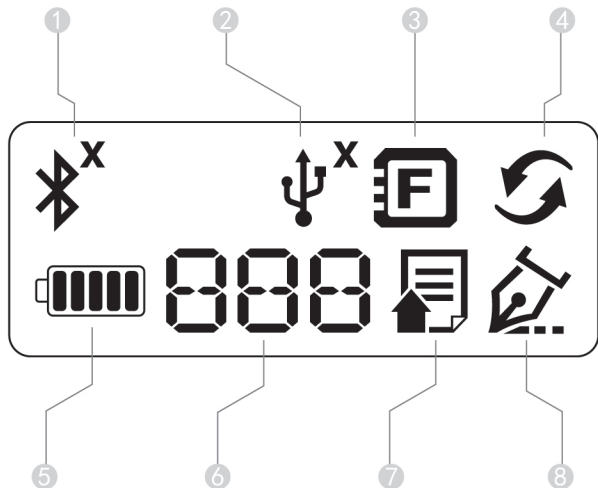

*USB only provides power charge for PH-1410-J & PH-1410-EDU, no data transfer.

#Upload procedures might be different for different software, and if help needed, please contact Service hotline or local dealers.

Status Screen







-
- 1 Bluetooth status
 - 2 USB data transfer status
 - 3 Storage mode (F shows when full storage)
 - 4 Real time mode
 - 5 Battery status
 - 6 Stored page numbers
 - 7 Uploading
 - 8 Pen signal

*The “x” on  and  icons will disappear when device is connected and able to transfer data, and “x” will appear when data transfer disconnected.    These two icons only show in storage mode, and  icon will not show on PH-1410-J and PH-1410-EDU.

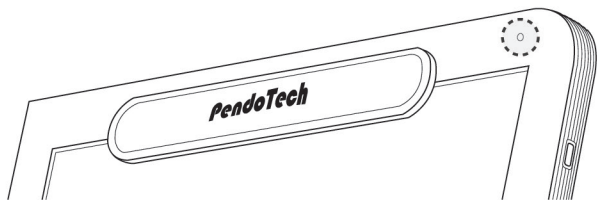
*In special multi-people connection scenario,  and  will show simultaneously.

Status LED



-  Red light flash: low battery $\leq 10\%$
-  Red light on: charging
-  Green light on: fully charged

Accessories

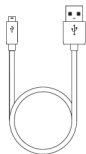

USB Cable*



Ink Cartridge



Cartridge
Changer

*USB only provides power charge for PH-1410-J & PH-1410-EDU, no data transfer.

Change Ink Cartridge

1

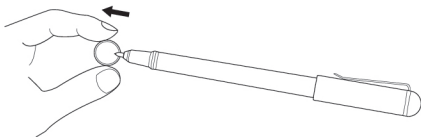

2

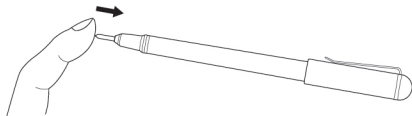

Restore Factory Settings

Press Home button and Power button simultaneously for 5 seconds, the product will restore to the factory settings. Please back-up all the data you have stored in the device, otherwise you will lose all the data after the device restored to factory settings.

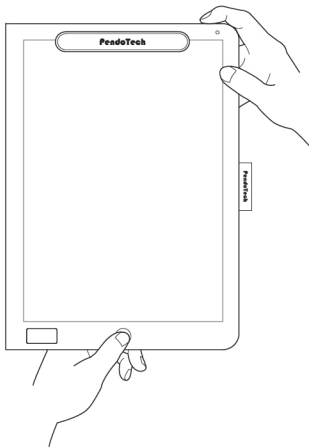

© Copyright 2016 Pendo Technology China Corporation. All rights reserved. PendoTech, PendoTech logo, Digit-Note and PendoPDF are registered trademarks of Pendo Technology China Corporation. All other company names and product names are trademarks and/or registered trademarks of their respective owners.

Pendo Technology China Corporation has made every effort to ensure the accuracy and completeness of this document. However, as ongoing development efforts are continually improving the capabilities of our products, we cannot guarantee the accuracy of the contents of this document. We disclaim liability for errors, omissions or future changes.



欢迎关注我们 Follow us on Wechat

总公司：上海磐度信息科技有限公司

地址：上海市闸北区广中西路777弄多媒体广场99号江裕大厦205室

电话：+86-021-6064 6161

Hong Kong Office: Pendo Technology Limited

Address : Unit C2, 20/F, TG Place, 10 Shing Yip Street, Kwun Tong, Hong Kong

Telephone : +852-3755 4277

网址Website : <http://www.pendo-tech.com/>

服务电话 Service hotline : 400-615-5185

服务电邮 Service email : cs@pendo-tech.com

FCC Statement

This equipment has been tested and found to comply with the limits for a Class B digital device, pursuant to Part 15 of the FCC Rules. These limits are designed to provide reasonable protection against harmful interference in a residential installation. This equipment generates uses and can radiate radio frequency energy and, if not installed and used in accordance with the instructions, may cause harmful interference to radio communications. However, there is no guarantee that interference will not occur in a particular installation. If this equipment does cause harmful interference to radio or television reception, which can be determined by turning the equipment off and on, the user is encouraged to try to correct the interference by one or more of the following measures:

- Reorient or relocate the receiving antenna.
- Increase the separation between the equipment and receiver.
- Connect the equipment into an outlet on a circuit different from that to which the receiver is connected.
- Consult the dealer or an experienced radio/TV technician for help.

Changes or modifications not expressly approved by the party responsible for compliance could void the user's authority to operate the equipment.

This device complies with part 15 of the FCC Rules. Operation is subject to the following two conditions:

- (1) This device may not cause harmful interference, and
- (2) this device must accept any interference received, including interference that may cause undesired operation.