

 圓美智能 PERFECT INTELLIGENT TECHNOLOGY	<b>Stretched Display User Manual</b>	Model	PDI350UFP01
		Version	1.0
		Page	1

# MENU



1.	Product Descriptions .....	2
2.	Product Diagram.....	3
3.	Installation Details.....	4
4.	Operation Details.....	6
5.	Precautions.....	7
6.	Accessories.....	8
7.	Video Content Playing.....	8

 <b>完美智能</b> PERFECT INTELLIGENT TECHNOLOGY	<b>Stretched Display User Manual</b>	Model	PDI350UFP01
		Version	1.0
		Page	2

# 1. Product Descriptions

This Stretched Display is a display device consisted of ARM Cortex A9 Quad Cores, which supports JPEG, video, audio playing and TF cards.

## Parts List

Item	Parts	Quantity	Diagram	Remarks
1	Main Body	1		
2	Fixed Plate	1		for fixing the main body (screws not included)
3	Power Supply	1		power input: AC 100V-240v~50/60Hz 0.8A power output: 12V/2A

 <div>圖美智能 PERFECT INTELLIGENT TECHNOLOGY</div>	<b>Stretched Display User Manual</b>	Model	PDI350UFP01
		Version	1.0
		Page	3

## 2. Product Diagram

unit: mm

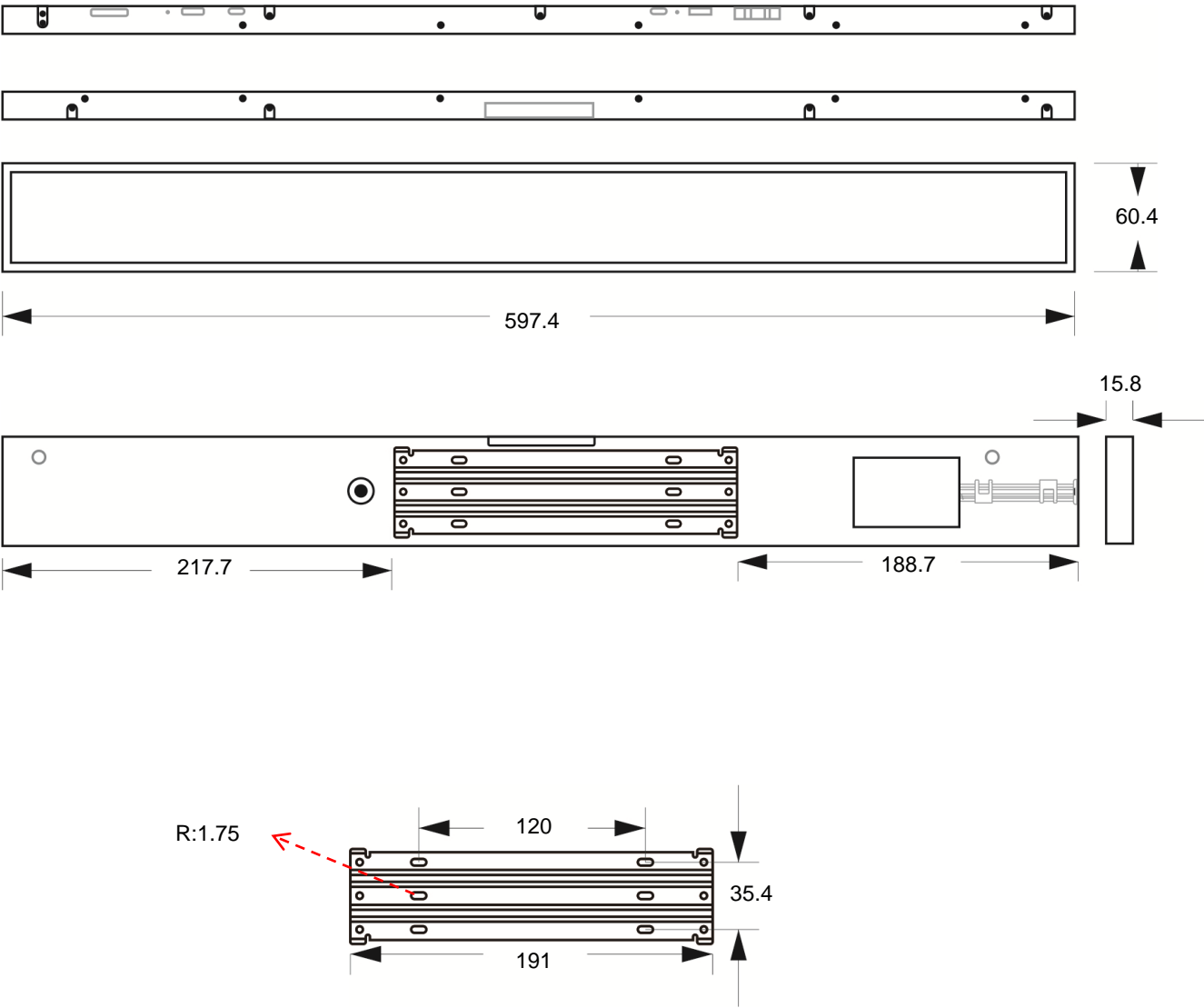

## 3. Installation Details

- **Fix the Fixed Plate to the shelf by fastening screws.**

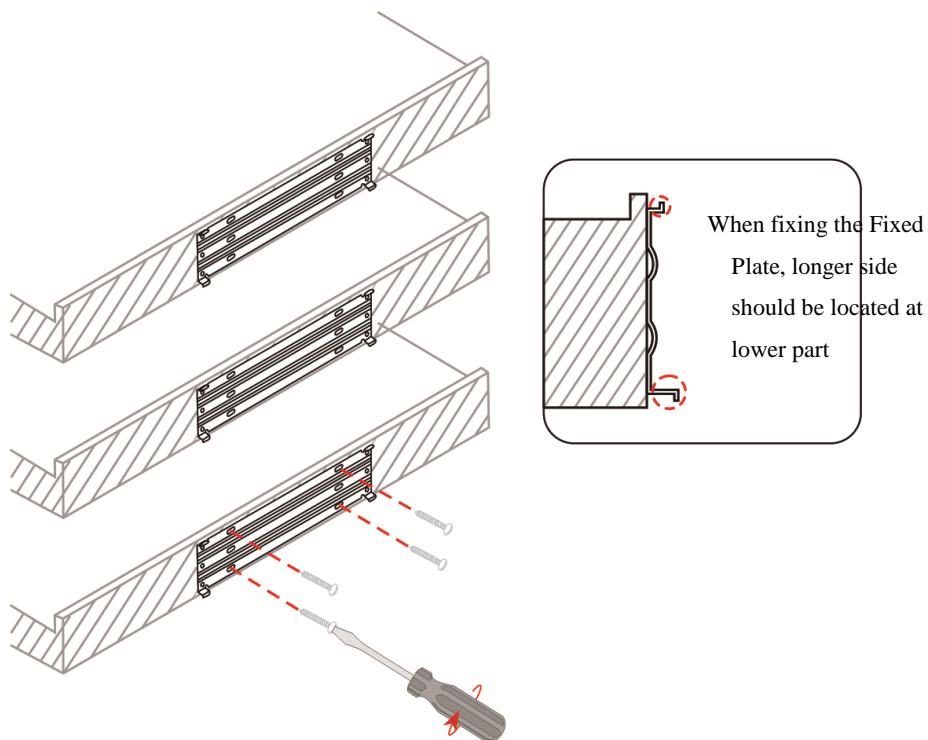

- **Power Supply (Type-C) connecting to the main device.**

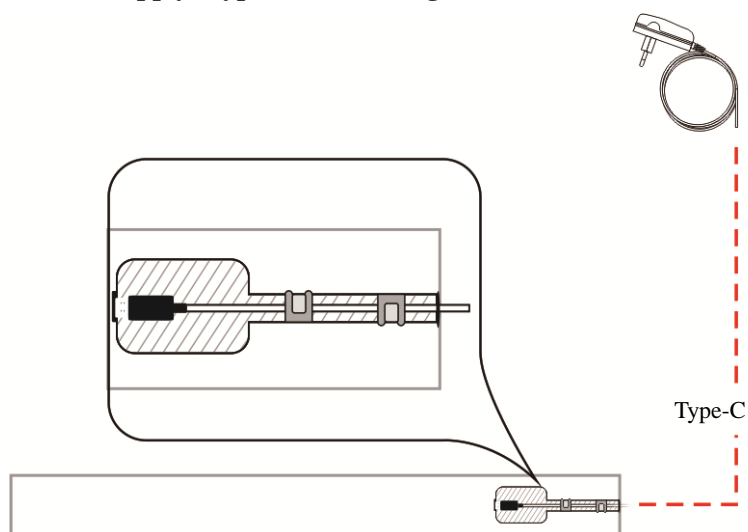

- Slide the buckle to outward direction (release), then fixing the main body to the fixed plate, slide the buckle to inward direction (lock).

1. Release the Buckle

2. Alignment

3. Lock

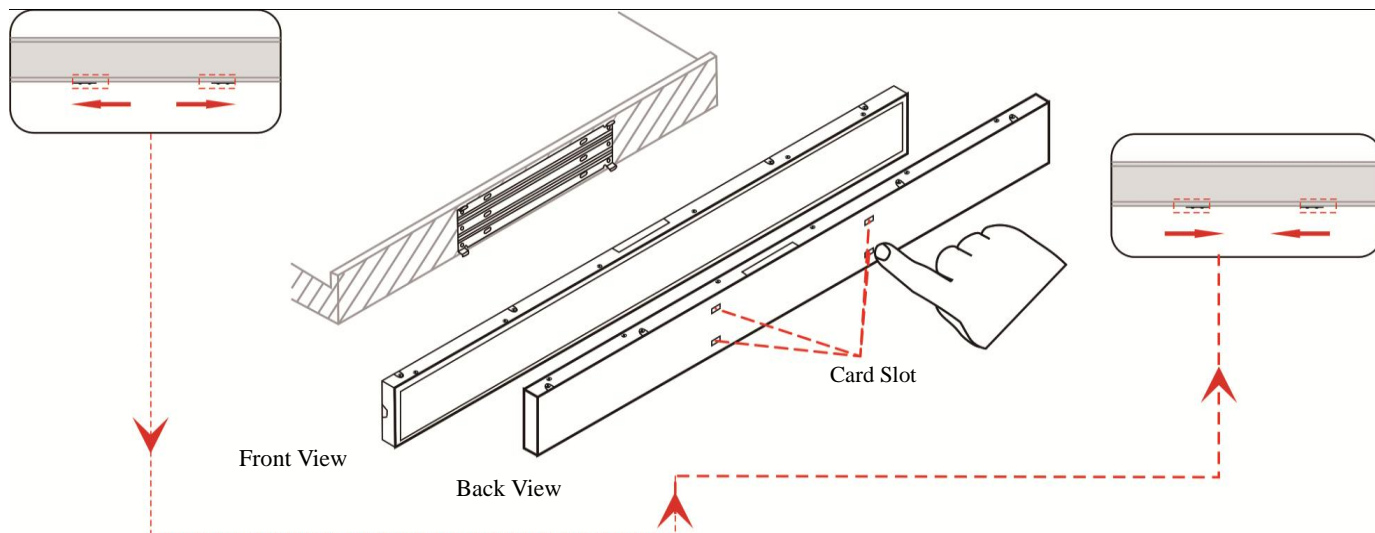

**Remark:** To uninstall the device from the shelf.

- Slide the buckle to outward direction (release), take up the main body and away from shelf.

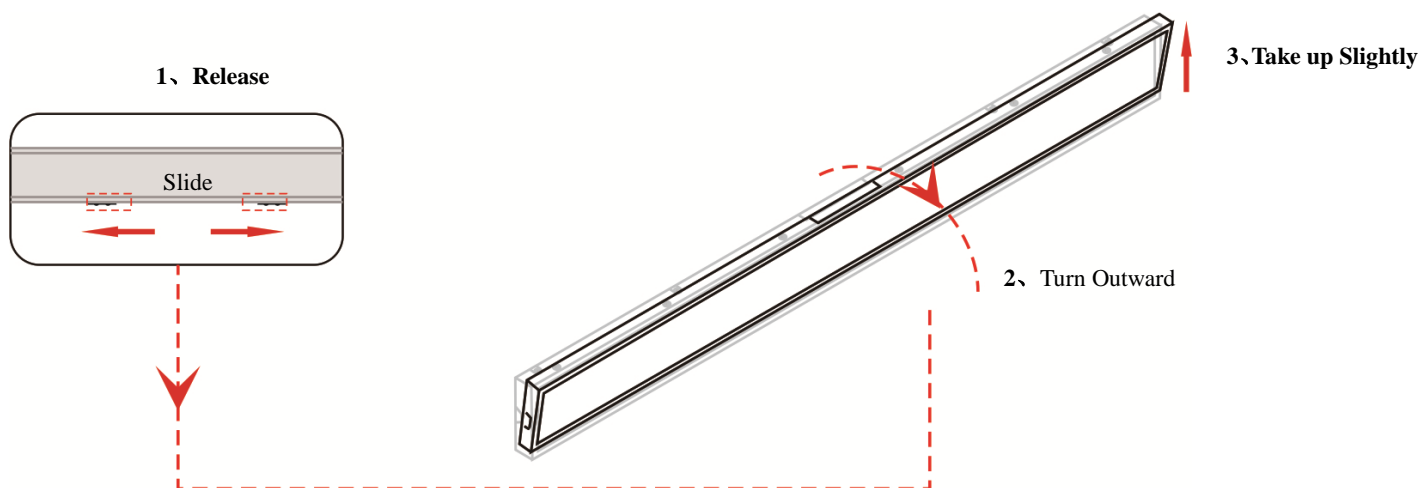

 <b>完美智能</b> PERFECT INTELLIGENT TECHNOLOGY	<b>Stretched Display User Manual</b>	Model	PDI350UFP01
		Version	1.0
		Page	6

4. Operation Details

- Plug in Power Supply, wait for around 10 seconds.

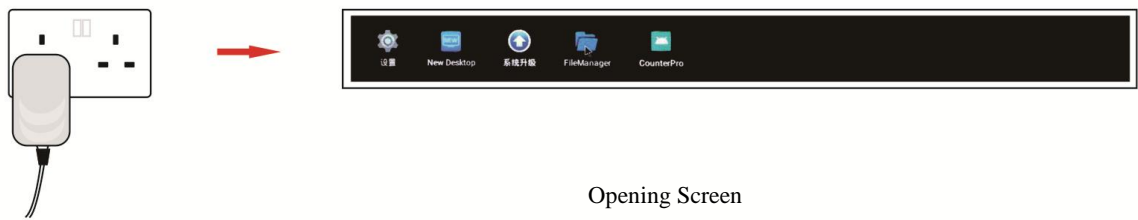

- Plug in TF card, connect a mouse and start operation (right click the mouse = return key)

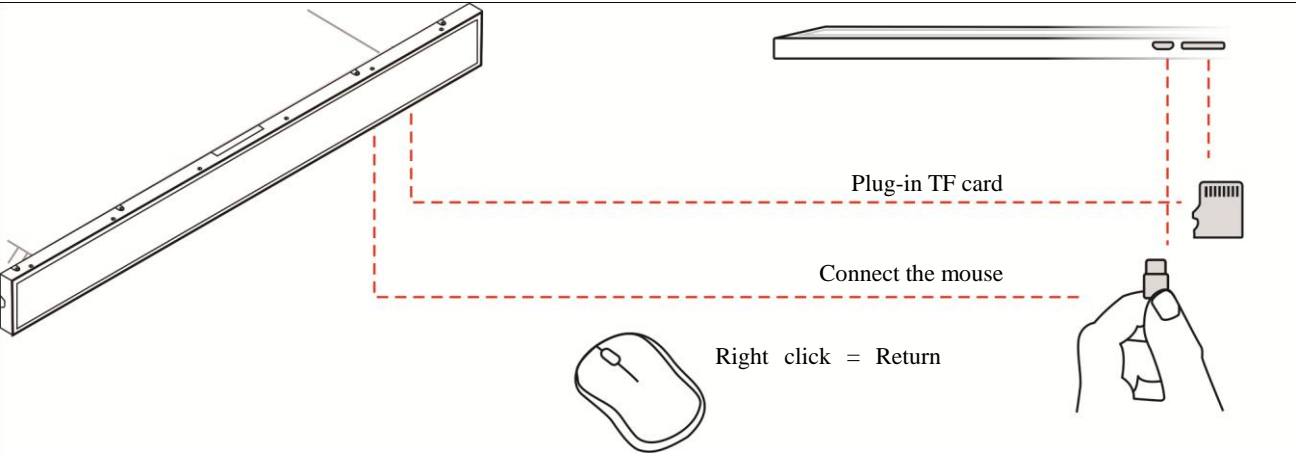

-  **WIFI connection: manual / automatic**

Manual Connection WIFI:

1> Click the screen



 <b>完美智能</b> PERFECT INTELLIGENT TECHNOLOGY	<b>Stretched Display User Manual</b>	Model	PDI350UFP01
		Version	1.0
		Page	7

## 2> Enter into Set-Up:



## 3> Click WLAN, search relevant WLAN and input passwords, then connect

### Automatic WIFI

1> Ensure this APPS  New Desktop has been installed and already in use,



2> Set up  config.txt InstallApp & UninstallApp document file config.txt file at TF card,

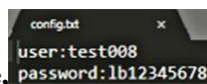

3> Open config.txt file,  input WIFI passwords, (user = account name)

**Remarks:** if need to install APK file to InstallApp (if APK already installed, the new APK must be at a higher version, otherwise has to delete the APK manually beforehand), put the uninstalled APK to uninstall APK file.

➤ **Brightness Setting:** click Set-up, enter into the interface

Find the  icon, then click and adjust the preferred brightness.

## 5. Precautions

1. Before clean-up the device, make sure plug-off the power supply. Use a soft cloth to clean the screen. Don't spray any cleaning detergent directly to the screen.
2. Don't place the device under sunshine, rainfall.
3. Don't stuck the hole on the device body, make sure the device is under good condition of ventilation.
4. Don't dissemble / repair the device by yourself, let the professional / experienced maintenance staff to do so.

 <b>完美智能</b> PERFECT INTELLIGENT TECHNOLOGY	<b>Stretched Display User Manual</b>	Model	PDI350UFP01
		Version	1.0
		Page	8

5. Ensure the power supply and electric current are under stable condition. Avoid sharing the same power supply with high voltage consumption appliances
6. When plug and unplug the TF card, please do it gently.
7. If the device is not in use, please unplug the power supply.

## 6. Accessories

Function	Description	Remarks
CPU	High-performance single-chip ARM Cortex A9 Quad Cores	
DDR	1G DDR3	
FLASH	8GB /16GB EMMC	
DISPLAY	23.1 inch , Innolux S231AJ1 TFT LCD 158*1920	
TF CARD	Support TF card expansion	Support multimedia playback
USB PORTS	Provides 3 USB 2.0 ports, and is connected to the computer as a software upgrade interface and U disk, camera, TP and other peripheral expansion	
POWER INPUT	DC 12V/2A Power input, TYPE_C interface	Standby<0.5W
LANGUAGE	Support	
WIFI	Support 2.4G	

## 7. Video Content Playing

(Sheet I)

Video F+A2:D16ormat / Codec	Decoder	Details	Supported File Type(s) / Container Formats
H.263	•	Support for <b>H.263</b> is optional in Android 7.0+	• 3GPP (.3gp)
			• MPEG-4 (.mp4)
H.264 AVC	•		• 3GPP (.3gp)



 <b>圖美智能</b> <b>PERFECT INTELLIGENT TECHNOLOGY</b>		<b>Stretched Display User Manual</b>		Model	PDI350UFP01
				Version	1.0
				Page	9
Baseline Profile (BP)				<ul style="list-style-type: none"> <li>• MPEG-4 (.mp4)</li> <li>• MPEG-TS (.ts, AAC audio only, not seekable, Android 3.0+)</li> </ul>	
H.264 AVC Main Profile (MP)	•	The decoder is required, the encoder is recommended.			
H.265 HEVC	• (Android 5.0+)	Main Profile Level 3 for mobile devices and Main Profile Level 4.1 for Android TV		<ul style="list-style-type: none"> <li>• MPEG-4 (.mp4)</li> </ul>	
MPEG-4 SP	•			3GPP (.3gp)	
VP8	• (Android 2.3.3+)	Streamable only in Android 4.0 and above		<ul style="list-style-type: none"> <li>• <a href="#">WebM (.webm)</a></li> <li>• Matroska (.mkv, Android 4.0+)</li> </ul>	
VP9	• (Android 4.4+)			<ul style="list-style-type: none"> <li>• <a href="#">WebM (.webm)</a></li> <li>• Matroska (.mkv, Android 4.0+)</li> </ul>	

**(Sheet II)**

Image Format / Codec	Decoder	Details	Supported File Type(s) / Container Formats
BMP	•		BMP (.bmp)
GIF	•		GIF (.gif)
JPEG	•	Base+progressive	JPEG (.jpg)
PNG	•		PNG (.png)
WebP	• (Android 4.0+) (Lossless, Transparency, Android 4.2.1+)		WebP (.webp)
HEIF	• (Android 8.0+)		HEIF (.heic; .heif)

	<b>Stretched Display User Manual</b>	Model	PDI350UFP01
		Version	1.0
		Page	10

## **FCC Caution:**

This device complies with part 15 of the FCC Rules. Operation is subject to the following two conditions: (1) This device may not cause harmful interference, and (2) this device must accept any interference received, including interference that may cause undesired operation.

Any Changes or modifications not expressly approved by the party responsible for compliance could void the user's authority to operate the equipment.

**Note:** This equipment has been tested and found to comply with the limits for a Class B digital device, pursuant to part 15 of the FCC Rules. These limits are designed to provide reasonable protection against harmful interference in a residential installation. This equipment generates uses and can radiate radio frequency energy and, if not installed and used in accordance with the instructions, may cause harmful interference to radio communications. However, there is no guarantee that interference will not occur in a particular installation. If this equipment does cause harmful interference to radio or television reception, which can be determined by turning the equipment off and on, the user is encouraged to try to correct the interference by one or more of the following measures:

- Reorient or relocate the receiving antenna.
- Increase the separation between the equipment and receiver.
- Connect the equipment into an outlet on a circuit different from that to which the receiver is connected.
- Consult the dealer or an experienced radio/TV technician for help.

RF warning for Mobile device:

This equipment should be installed and operated with minimum distance 20cm between the radiator& your body.