

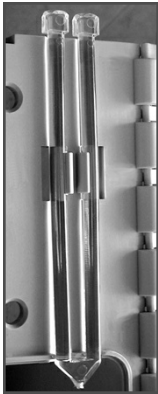

TROUBLE SHOOTING

Read down the PROBLEM column on the left to find which applies to your CatGenie®

BEEPS & BLINKS WARN OF PROBLEMS

Problem	Probable Cause	Solution
<p>1. ONE Beep sounds and Error LED Blinks at the same time. Means Water Level Sensor detects a problem.</p>	<p>A. Part of the Hopper is clogged and full of water.</p>  <p>B. The Hopper is NOT clogged or filled with water. Water Level Sensor, which is inside Hopper, is not securely in place, is dirty, or is missing.</p> <p>C. Unit malfunction.</p>	<p>A. Do not unplug Genie Electric Cord. Press Start Cycle/Pause Button to silence Beep. Go to Gray Box on page 11 and follow directions.</p> <p>B. Unplug the Genie Electric Cord. Remove Hopper Cover, Processing Unit, and Brim from Base. SLOWLY pull Hopper up out of the Base. Unsnap all clips. Open like a book. Check that Water Level Sensor is securely fixed in place. Use a soft, lint-free cloth to wipe off Sensor and Hopper. If Sensor is missing, go to page 9 for details. Re-assemble and plug in Electric Cord when finished. Press the Start Cycle/Pause Button for exactly 4 seconds, then Release. CatGenie should resume.</p> <p>C. Call +972-9-7445012</p>
<p>2. TWO Beeps sound and Error LED Blinks at the same time. Means water doesn't fill the CatGenie® within a reasonable amount of time.</p>	<p>A. Genie Water Supply Line not connected to home water supply or to the back of the Processing Unit.</p> <p>B. Home's water supply and/or water supply valve is shut off (no water).</p> <p>C. Genie Water Supply Line is compressed or kinked.</p> <p>D. Very low water pressure.</p> <p>E. Water empties out because Genie DrainHose is below water intake line.</p> <p>F. Unit malfunction.</p>	<p>A. Do not unplug the Genie Electric Cord. Connect the Genie Water Supply Line to the cold-water line or to the Processing Unit.</p> <p>B. Turn on the cold water supply line valve.</p> <p>C. Decompress or unkink the CatGenie Water Supply Line so that waste can easily evacuate.</p> <p>D. Check if dishwasher, washing machine, or shower are in use. Don't run all at the same time.</p> <p>E. Raise the Genie DrainHose at least 2 feet above the CatGenie Bowl. Just a short run is needed.</p> <p>F. Call +972-9-7445012</p>
<p>3. THREE Beeps sound and the Error LED Blinks at the same time. Means CatGenie does not drain properly.</p> <p>3a. Unit is clean and dry but Beeps</p>	<p>A. Genie DrainHose or its Hook is kinked, bent, or pinched between toilet seat and rim. Or Hook squeezed in laundry drain pipe.</p>  <p>B. Impeller is stuck or clogged.</p> <p>C. Unit malfunction.</p>	<p>A. Do not unplug Genie Electric Cord. Press Start Cycle Button to silence Beeps. Straighten kinks or sharp bends in DrainHose. Check that toilet seat bottom has lifts or feet so that the seat does NOT pinch the Hook. Press Start Cycle Button for exactly 4 seconds then Release. Unit should resume working.</p> <p>B. Unplug the GenieCord. Go to Gray Box on top of page 11 and follow Methods 1 and 2. If neither works, follow Method 3. If Method 3 fails, call.</p> <p>C. Call +972-9-7445012</p>
<p>4. FOUR Beeps and Error LED Blinks at same time. Means Dryer is Overheating.</p>	<p>A. Rear air intake vent is blocked or CatGenie is too close to the wall.</p> <p>B. Hot Air Blower is blocked by a toy or towel.</p> <p>C. Unit malfunction.</p>	<p>A. Remove towels, toys, etc. blocking intake on back of Processing Unit. Move CatGenie to allow airflow.</p> <p>B. Remove any obstruction in the Bowl that blocks dryer's hot airflow.</p> <p>C. Call +972-9-7445012</p>

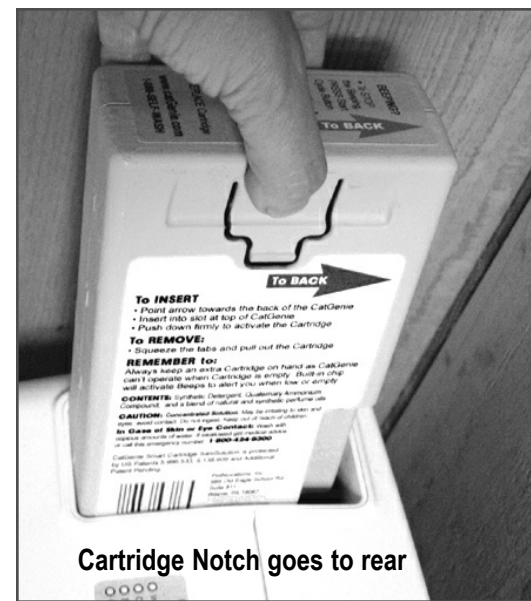
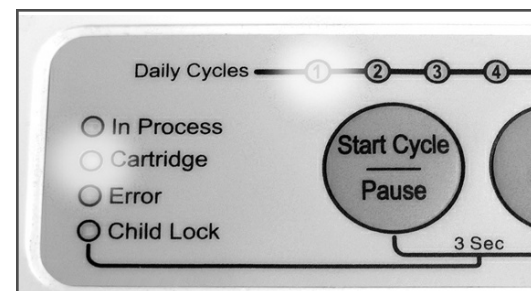

THE SMART CARTRIDGE PROTECTS THE SANISOLUTION™ and it is key to CatGenie® operations.

The Smart Cartridge keeps the concentrated SaniSolution liquid safely contained. It accurately dispenses, monitors, and controls the proportion of Solution to water for the maximum safety of your cats and the optimal operation of your CatGenie.

A SaniSolution Smart Cartridge lasts for 60 wash cycles. When empty, replace the Cartridge or CatGenie will not function. Always have extra Smart Cartridges on hand, so your CatGenie can work for you without interruption.

HEED THE CARTRIDGE WARNINGS.

Low Level:

When 10 of the 60 SaniSolution portions remain in the Cartridge, the Cartridge LED will light and a repetitive, One-Beep Warning will continuously sound. To stop the Beeps, Press & Release the Start Cycle/Pause Button and check that you have an extra Cartridge or ORDER IMMEDIATELY. The Cartridge LED will stay lit to remind you that you will soon need to replace this Cartridge.

Critical Level:

When 3 wash cycles remain in the Cartridge, the Cartridge LED will light and the repetitive, One-Beep Warning will sound again. To stop the Beep, Press & Release the Start Cycle/Pause Button. The Cartridge LED will stay lit to remind you that only 3 wash portions remain and that CatGenie can not run on empty.

Empty Cartridge or No Cartridge:

After 60 cleaning cycles, the Cartridge is empty. The Cartridge LED will blink and a repetitive, Two-Beep Warning will continuously sound. To mute the Beep, Press & Release the Start Cycle/Pause Button. The LED will blink and the CatGenie can not start a wash cycle.

If you try to start a cycle, manually or automatically, the Double Beep will reactivate. Incorrect Cartridge placement also causes Beeps. Replace correctly to stop. The CatGenie will not start manually or automatically unless it has a Smart Cartridge containing SaniSolution placed correctly in the Processing Unit.

NEVER remove a Cartridge while Unit is running:

Removing the Cartridge during a cleaning cycle will NOT extend Cartridge life. Removal will cause the CatGenie to not clean thoroughly, not dry completely, and not destroy bacteria and odors effectively.

Removal before a cleaning cycle will cause the CatGenie to not run at all.

ABOUT THE SANISOLUTION.

SaniSolution is safe and non-toxic for cats and humans when properly used in the CatGenie. The ingredients are similar to disinfectants used by veterinarians to clean and sterilize their exam and operating areas.

CAUTION: This is a concentrated Solution that may be irritating to skin and eyes, so avoid contact. Do not ingest. Keep out of reach of children. In case of skin or eye contact, wash with copious amounts of water. If swallowed get medical advice or call this emergency number: +972-9-7445012.

SIMPLE SETUP

See Simple Setup Guide for Complete Directions.



BATHROOM SETUP

1. Shut off the cold water by turning the valve on the toilet or sink cold-water supply line all the way counter-clockwise.
2. Unscrew the cold water line hose and attach it to the provided 3/8" T-Adapter. Then attach the T-Adapter to the cold water line.
3. Screw the Genie Water Supply Line to the T-Adapter. Make sure T-Adapter's black washer is in place. Turn cold water back on. Check for leaks or drips.
4. Put the Genie DrainHose Hook over the toilet rim under the seat. You can keep the Hook there and still use the toilet.
5. Plug the Genie Electric Cord into a GFCI electric outlet.

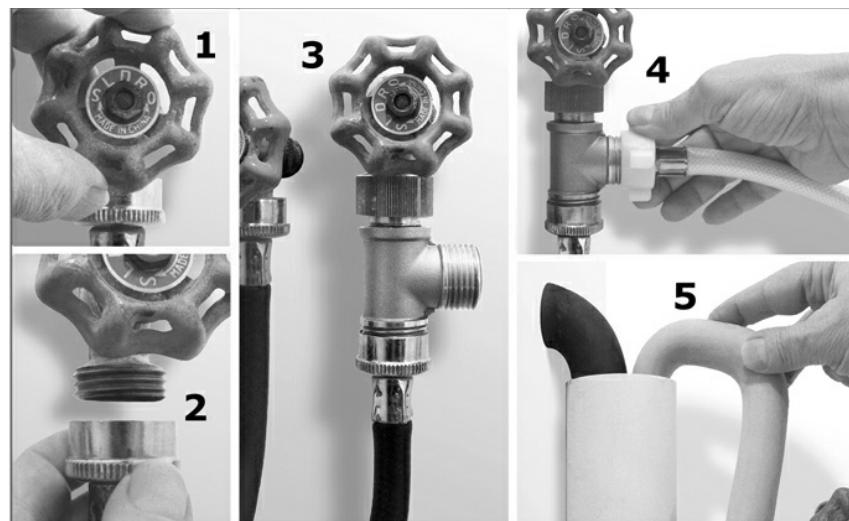

LAUNDRY ROOM SETUP

1. Turn the cold water valve counter-clockwise to shut off cold water.
2. Unscrew the washing machine cold water supply hose from the valve.
3. Attach the washing machine hose to the provided 3/4" T-Adapter, then attach the T-Adapter to the cold water line valve.
4. Screw Genie Water Supply Line onto T-Adapter, turn on cold water.
5. Put Genie DrainHook into Washer's waste pipe with Washer's drain hook. Don't squeeze either hook. To avoid a clog and overflow, make sure that the Washer drainhook is less than 5 inches long inside the waste pipe.
6. Plug the Genie Electric Cord into a GFCI electric outlet.

INSIDE YOUR CATGENIE®

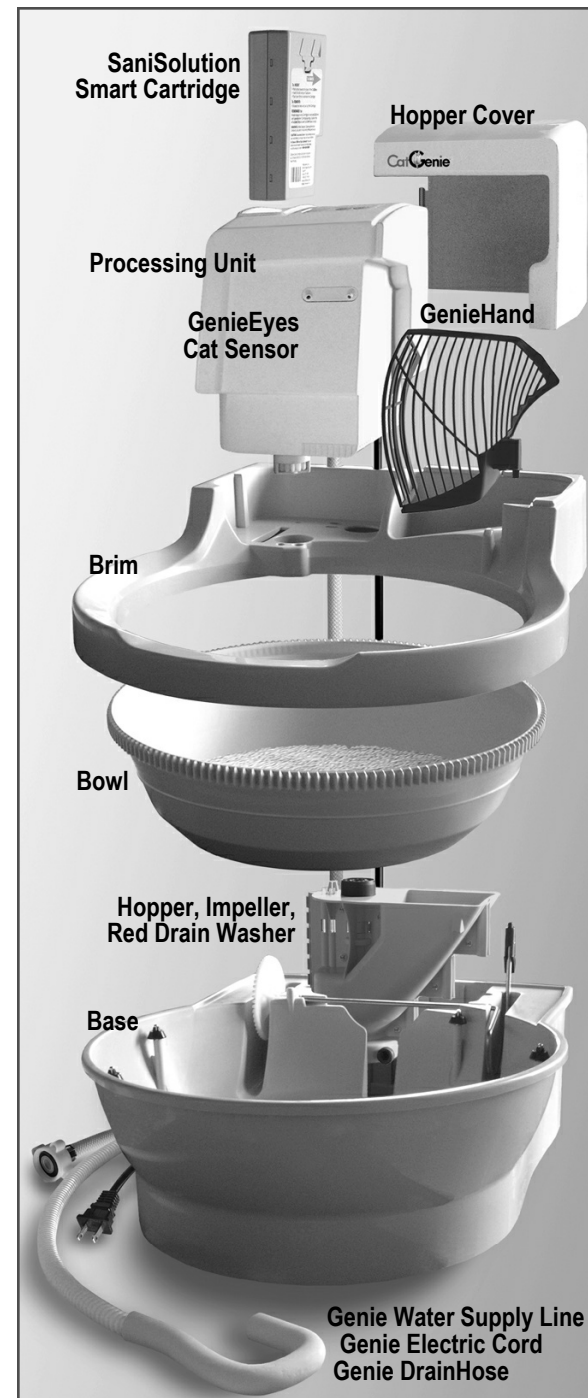

TIP: Watch Video of What to Expect During Cleaning at CatGenie.co.il /Customer Service

If you have any problem or question please call us.

+972-9-7445012

Don't attempt to fix or tamper with the CatGenie.

HOW TO GET INSIDE YOUR CATGENIE.® If you need to replace a part.

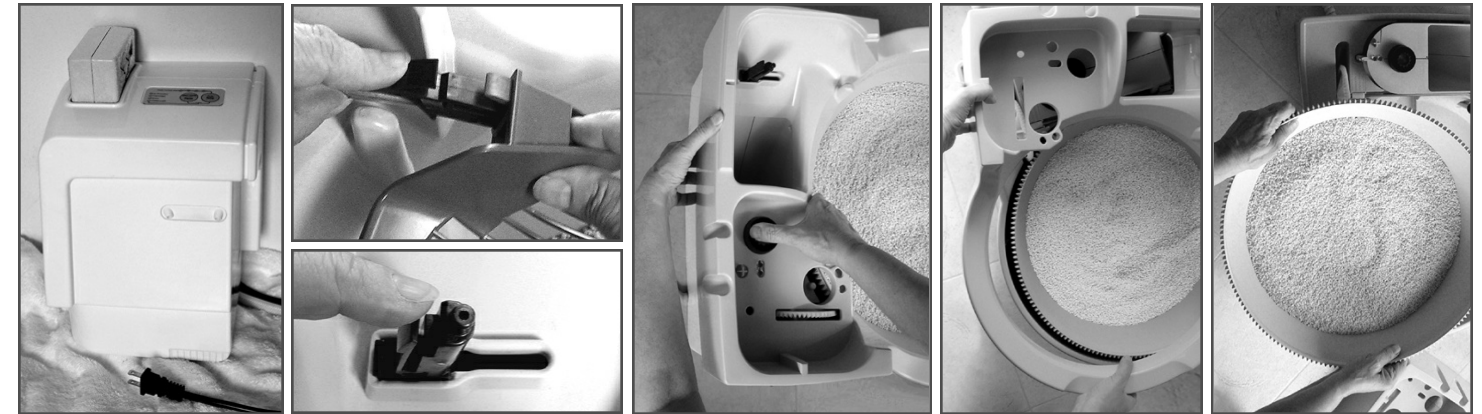

FIRST unplug Genie Electric Cord. Carefully move installed CatGenie away from the wall. Keep DrainHose in toilet or drainpipe. Put a towel on floor by the wall. Remove Hopper Cover. Remove Processing Unit and place on the towel. Lean Unit against the wall. Unclip GenieHand.

Push Arm and Black Clip back into its opening. To remove Brim, push on Black button for leverage as you pull up the Brim back. Put aside. Remove Bowl with Granules and set aside. Hopper is accessible for removal if necessary. Clean out any Granules in the Base.

WARNING: Unless Manual instructs otherwise, always unplug the Genie Electric Cord before working on your CatGenie.

HOW TO REPLACE PARTS. Spares available under Genie Base. Or from us.

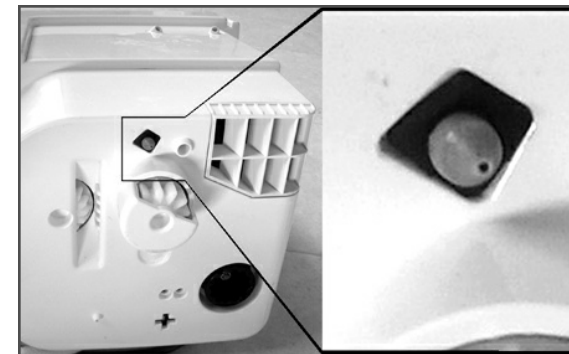

ORANGE NIPLET: Find on bottom of Processing Unit. **FUNCTION:** Prevents SaniSolution from drying out and clogging black dispenser Nozzle under Processing Unit. **REPLACEMENT:** Unplug Electric Cord. Carefully lift Unit from its slot. Check that Niplet is clean and in place. To clean, squeeze out clumped Solution and wash with warm water. Replace if missing. Attach Niplet on to the black Nozzle. Clean out Unit slot. Wipe off Unit bottom with a soft cloth. Carefully place Unit back into its slot; make sure it is secure. **Plug in Genie Electric Cord.**

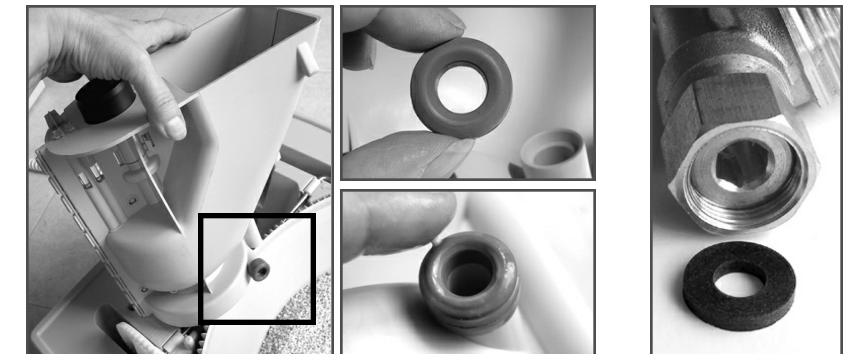

RED WASHER. Attaches to outside of the Hopper. Hopper is below Hopper Cover and under the Brim. **FUNCTION:** Critical piece. Seals connection to Genie DrainHose. Prevents wastewater backup. Don't misplace. **REPLACEMENT:** Unplug Cord. **Slowly** pull Hopper out of its slot. Check that Red Washer is in place, clean, smooth and not crushed. If missing or damaged, replace. Swab outside of Washer with any cooking or baby oil. Carefully slide Hopper back into its slot. Reassemble CatGenie. **Plug in Genie Electric Cord when done.**

T-ADAPTER WASHER Check if Lock-Nut side of T-Adapter has its Black Washer. If missing, purchase washer at hardware store. Or call us at +972-9-7445012.

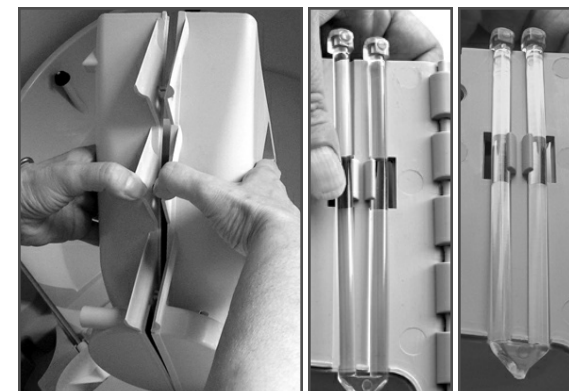

WATER SENSOR: Located inside Hopper. **FUNCTION:** Reads if water level is correct. May just need cleaning and not replacement. **REPLACE or CLEAN:** Unplug Electric Cord. **SLOWLY** pull Hopper out of its slot. Unsnap clips. Open like a book. Wash Water Sensor with soap and water. OR replace old Sensor. Carefully clip new Sensor in one side at a time. Push in on each clip. Line up as shown. Point **V** down. Snap Hopper closed. Place in slot. Reassemble CatGenie. **Plug in Electric Cord.**

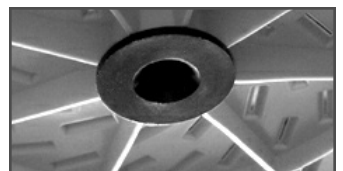

BLACK RING: Located under bottom of Bowl. Bowl can't turn without it. Follow "Get Inside" instructions above to access Bowl bottom. If Black Ring is missing, call +972-9-7445012.