



Smart Cat Feeder F3 WiFi

model name:F3 WiFi,F3 LCD,F2 Wi-Fi,W1 Wi-Fi

Manufacture :Shenzhen Petwant Pet Products Co.,Ltd.

SmartFeeder User's Guide

Dear users:

Thank you for choosing Petwant smart cat feeder.

We hope to help you live a high-quality pet-keeping life.

For your convenience,
please read carefully and follow the instructions
in the guide.

Scan the QR code and follow our
Facebook,through which you could get
high-quality after-sales service.



Meet Your Smart Feeder

Petwant Smart Cat Feeder not only has a minimalist design, but also means zero guesswork and individually personalized feedings. To meet cats' dietary needs, F3 Wi-Fi especially introduce feeding notion that is "less food and multiple meals". User can up to set 6 meals each day and each portion can be set low to 5g. Power switch and reset button are at the bottom of the feeder, which prevents pets from touching. Adapter input is also at the bottom of the feeder.

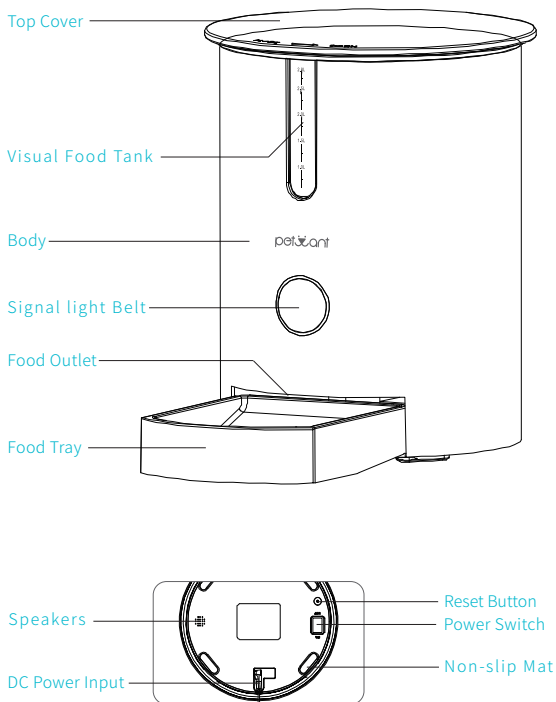

Download Petwant APP

To configure your smart pet feeder, you need to download the Petwant APP.



Petwant

Method 1:

Petwant APP is available on the Apple APP Store and Google Play. You can search "Petwant" to download APP.

Method 2:

Scan the QR code to enter the download page to install APP according to the guidance.



After APP is installed, users need to allow the APP access to the location and network, or it will affect feeder's performance.

Select Region

Open the Petwant APP,then choose the correct country or region to help the feeder associate with the most appropriate server.**If not,it may affect the feeder's performance.** (Countries and regions are sorted by alphabetical order)

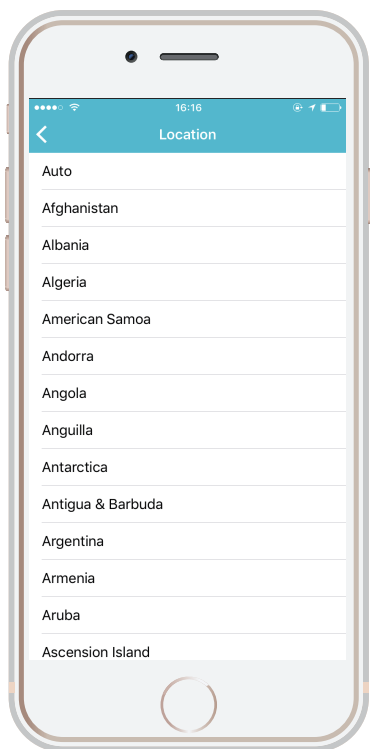

Create Your Petwant Account

Method 1:

Click "Sign up", then follow the directions on the Petwant APP to create your user account.

Method 2:

Users can also sign up through other ways, such as Twitter and Facebook authorized login.

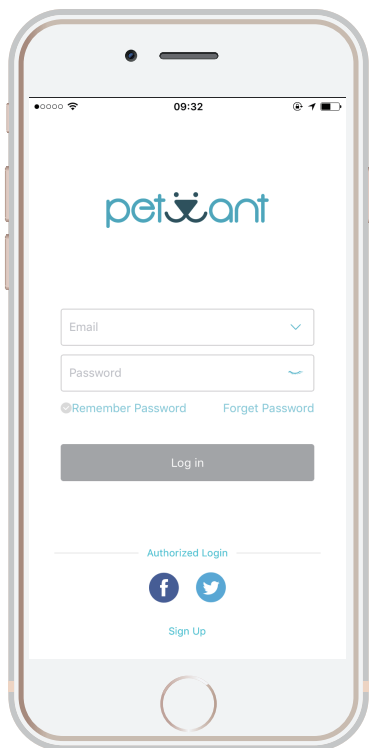

Preparations for Device Connection

Plug in the power supply and turn on the switch at the bottom of the device, then hold and press the reset button to ensure the Signal belt is blinking, next users can connect feeder to Wi-Fi. Please be sure that cell phone has been connected to Wi-Fi during initial connection process.

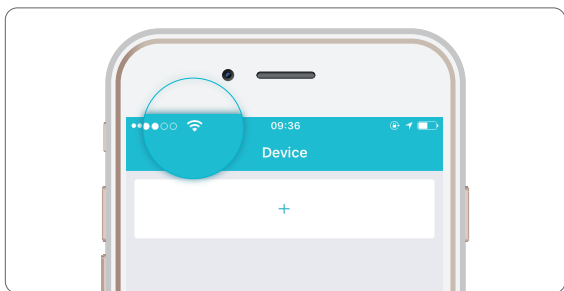

If Signal belt is not blinking, please hold and press Reset button for 5s to reset.

Add Device

Click “+” button to enter Devices interface. Then, click “Add New Devices” to enter “Select Device Model” interface. Select right device model—F3 Wi-Fi.

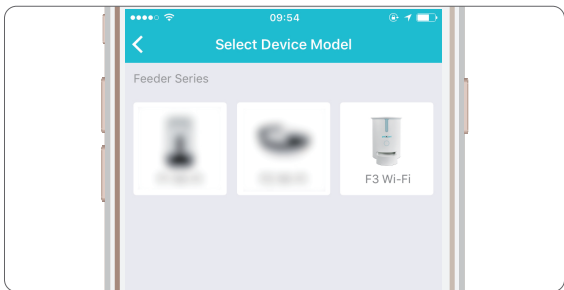
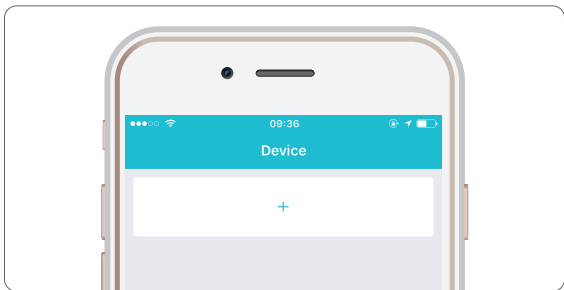

Add Device

Please reconfirm Signal belt is blinking, then tick the box and click "Next" to enter "Device Connection" interface. Please enter right Wi-Fi password to ensure pet feeder is working properly. The time required to connect is affected by the network environment, which probably needs 10-20s. Please wait with patience.

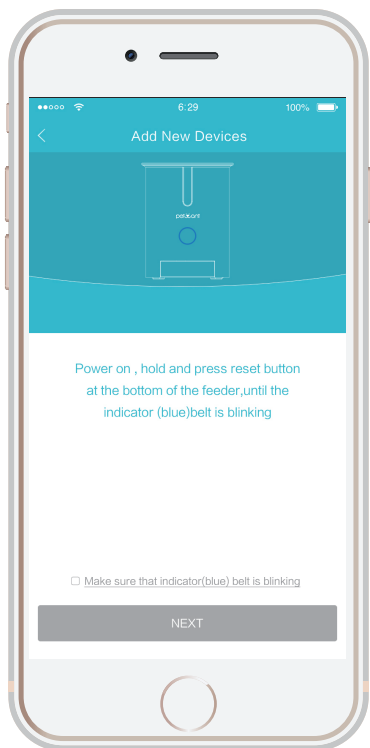

Enter Serial Number Password

After completing the "Add Device" operation, you can find a paired device in "Nearby Devices". Each feeder is equipped with a unique serial number to ensure your using process is safe and reliable. Enter the initial serial number password "123456" to connect to the paired device.

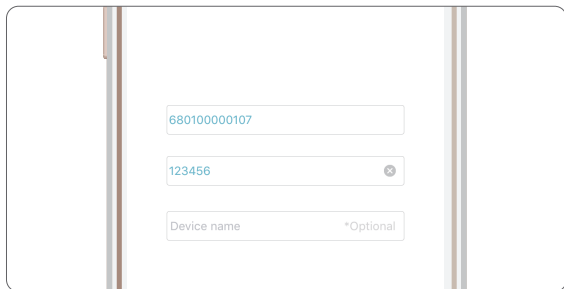
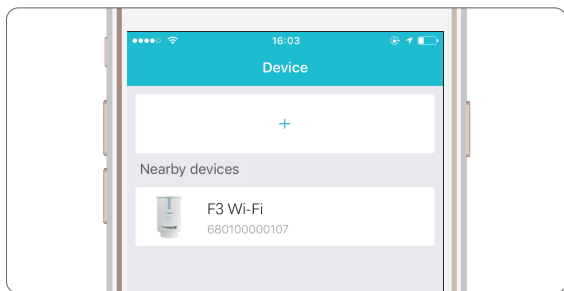

APP Homepage

Feeding Information

Device Information

Countdown and
Manual feeding

Change Feeding
Interface



Automatic Feeding Setting

Click "+" button to add feedings. According to pets' feeding habits, user can set feeding meals and portions independently, up to 6 meals per day and 6 portions per meal(about 5g per portion). After setting is completed, you can also choose to enable or disable meals and feeding alarm independently. If you want to cancel a meal, select the meal and slide towards left and click delete to cancel meals.



Manual Feeding

Hold and press Countdown until Manual Feeding interface appears to enable manual feeding. You can set portions independently to suit your pet's feeding habits. Each meal can be set up to 6 portions (about 5g per portion).

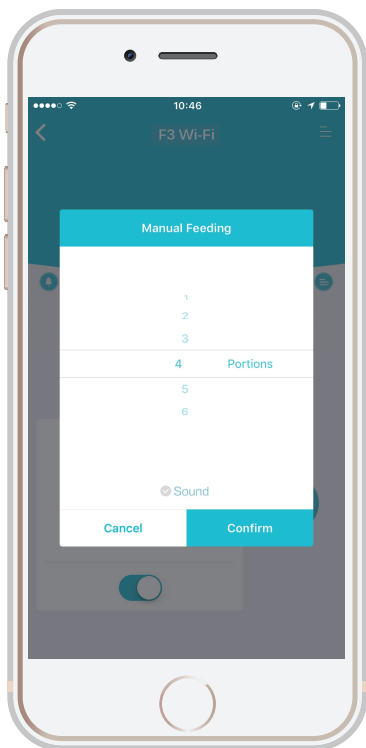

Add Pet's Information

Click "User" icon to enter User Information interface. Click "+" icon, then you can add pets' information.

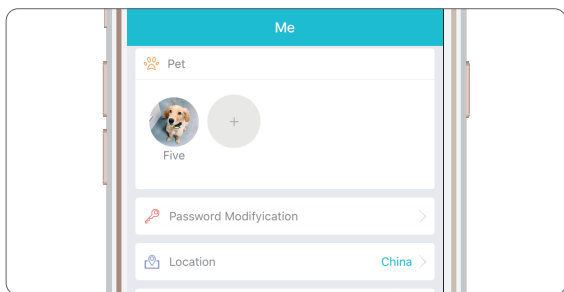

If you want to delete pet's information, just press and hold pet's profile, then delete interface will pop-up. Click "Comfirm" to delete selected pet's information.

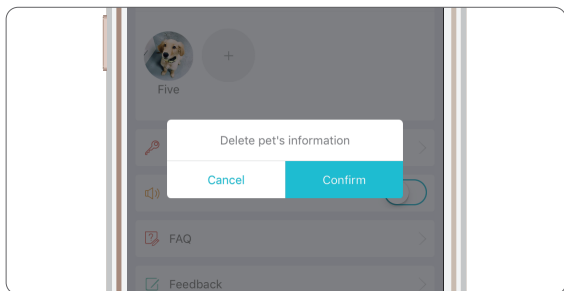

Other Setting

Password modification, location modification, feedback and asking for after-sales service can all be achieved when you enter User interface. Users can not modify the password when users choose authorization login.

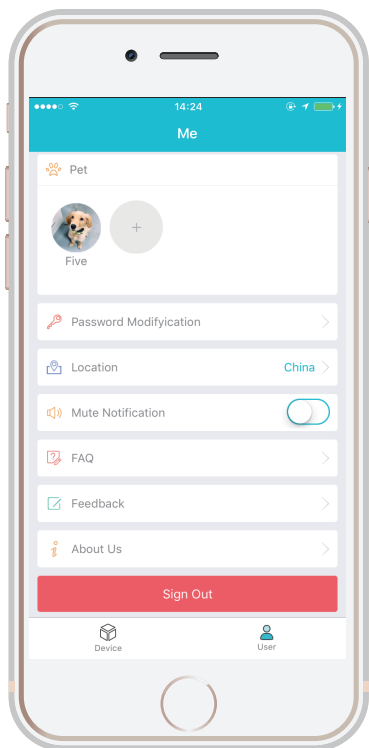

Add and Delete pet's information

If you want to disconnect the app from the device, select device then slide towards left and click "Unbind" to disconnect it.

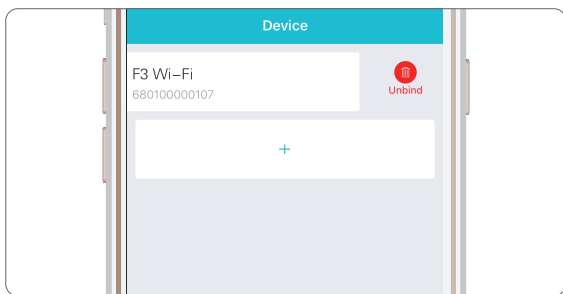

If you want to modify the device name or password, hold and press the device icon, then a interface will pop-up for information modification.

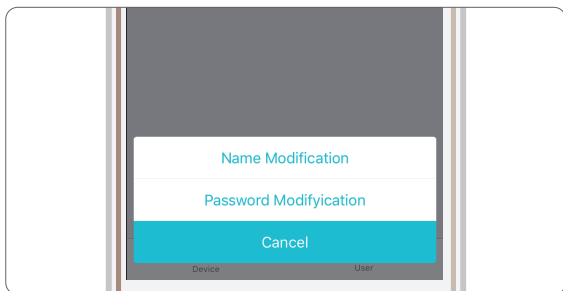

Assemble & Disassemble

Assemble & Disassemble food tank:

Hold both sides of the food tank and lift upwards for removal; for installation, rotate the central rotary impeller to align the bottom slot.

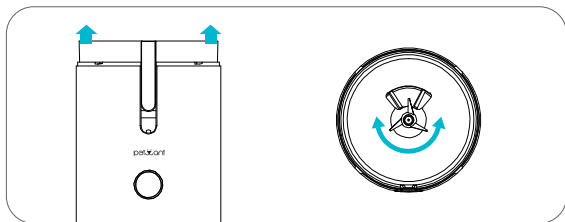

Assemble & Disassemble food tray:

Assemble food tray: Hold the feeder slightly backwards, and fit the tray into the buckle below, then push it towards the body.

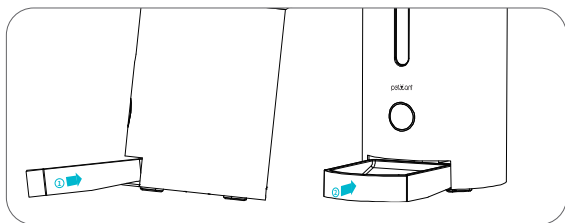

Cleaning Your Smart Feeder

1. Please cut off and unplug the device before cleaning
 2. Clean the unit with a damp cloth rather than a soaked cloth.
 3. The food tray and tank can be removed for washing or cleaning in the automatic dishwasher.
 4. The base can't be immersed in water at any time, or it may cause short-circuit of the device
 5. It needs to be wiped clean and completely dry before refilling the food.
-

Important Safety Information

Explanation of Attention Words and Symbols used in this guide



This is the safety alert symbol. It is used to alert you to potential personal injury hazards. Obey all safety messages that follow this symbol to avoid possible injury or death.



WARNING indicates a hazardous situation which if not avoided could result in death or serious injury.

CAUTION

CAUTION used without the safety alert symbol, indicates a hazardous situation which if not avoided could result in harm to your pets.

NOTICE

NOTICE is used to address safe use practices not related to personal injury.



- ★ Do NOT place any foreign object in the pet feeder.
 - ★ Do NOT use outdoors. FOR INDOOR HOUSEHOLD USE ONLY.
 - ★ Do NOT use an appliance for anything other than its intended use.
 - ★ Do NOT allow children to play or around pet feeder.
 - ★ Do NOT place anything on top of the pet feeder. The unit starts automatically.
 - ★ Do NOT disassemble the pet feeder other than components as instructed in this operating guide.
 - ★ Do NOT install or store pet feeder where it will be exposed to weather or temperatures below -20°C.
 - ★ Base should NOT be submerged in water at any time, as this may damage electronic components.
 - ★ Do NOT use this pet feeder with puppies or kittens. Dogs or cats not able to reach the food tray or with any physical disability.
 - ★ Do NOT operate any appliance if it has a damaged power cord or plug, or if malfunction or has been damaged. Call the Customer Care Center immediately for further instructions.
 - ★ Do NOT allow pets to chew on or swallow any parts. If you are concerned about the power cord, purchase a cord conduit (a hard plastic protector) in to protect the power cord.
 - ★ Do NOT attempt to repair the pet feeder by yourself.
-

Important Safety Information

- ★ If an extension cord is necessary, an extension cord with a proper rating should be used.
- ★ Do NOT use pet feeder for anything other than intended use. Using attachments not recommended or sold by the manufacturer may cause an unsafe condition.
- ★ Do NOT lift pet feeder by lid, hopper, bowl or bowl holder. Lift and carry feeder using both hands and hopper base, while keeping unit in upright position.
- ★ For dry food only. DO NOT use wet, canned or moist food.
- ★ To avoid tripping, always position power cord out of the way of foot traffic.
- ★ If the plug of this device gets wet, turn off the electricity to that wall outlet. Do not attempt to unplug.
- ★ Examine this appliance after installation. Do not plug in if there is water on the Power Cord or plug.
- ★ To reduce the risk of injury, close supervision is necessary when an appliance is used by or near children.
- ★ If using power cord, do not place power cord or plug in water or other liquids.
- ★ Dispose of all packaging materials properly. Some items may be packed in polybags; these bags could cause suffocation; keep away from children and pets.

CAUTION

- ★ Intended for small dogs or cats only.
- ★ Pet feeder should be placed on a level surface.
- ★ Always unplug any appliance when not in use, before putting on or taking off parts and before cleaning. Never pull on the electrical power cord to remove the plug from the wall outlet.

NOTICE

- ★ Read and observe all important notices listed on the pet feeder and in the packaging.
- ★ Attention: Rated voltage and rated current for USB interface is 5V 1A. If the power supply does not meet the requirements, it may cause damage to the feeder.

SAVE THESE INSTRUCTIONS

Statement



FCC STATEMENT :

★ This device complies with Part 15 of the FCC Rules. Operation is subject to the following two conditions:

- ★ This device may not cause harmful interference.
- ★ This device must accept any interference received, including interference that may cause undesired operation.



Declaration of Conformity

"Hereby, Shenzhen Petwant Pet Products Co., Ltd, declares that this F3 Wi-Fi is in compliance with the essential requirements and other relevant provisions of Directive 2014/53/EU.

FCC Caution.

This device complies with part 15 of the FCC Rules. Operation is subject to the following two conditions:

- (1) This device may not cause harmful interference, and
- (2) this device must accept any interference received, including interference that may cause undesired operation.

Any Changes or modifications not expressly approved by the party responsible for compliance could void the user's authority to operate the equipment.

Note: This equipment has been tested and found to comply with the limits for a Class B digital device, pursuant to part 15 of the FCC Rules. These limits are designed to provide reasonable protection against harmful interference in a residential installation. This equipment generates uses and can radiate radio frequency energy and, if not installed and used in accordance with the instructions, may cause harmful interference to radio communications. However, there is no guarantee that interference will not occur in a particular installation. If this equipment does cause harmful interference to radio or television reception, which can be determined by turning the equipment off and on, the user is encouraged to try to correct the interference by one or more of the following measures:

- Reorient or relocate the receiving antenna.
- Increase the separation between the equipment and receiver.
- Connect the equipment into an outlet on a circuit different from that to which the receiver is connected.
- Consult the dealer or an experienced radio/TV technician for help.

This equipment complies with FCC radiation exposure limits set forth for an uncontrolled environment. This equipment should be installed and operated with minimum distance 20cm between the radiator & your body.