

For product support, visit
Para obtener asistencia técnica, visite
Pour en savoir plus sur l'assistance sur les produits, visitez le site

www.hd.philips.com

CSS2133B

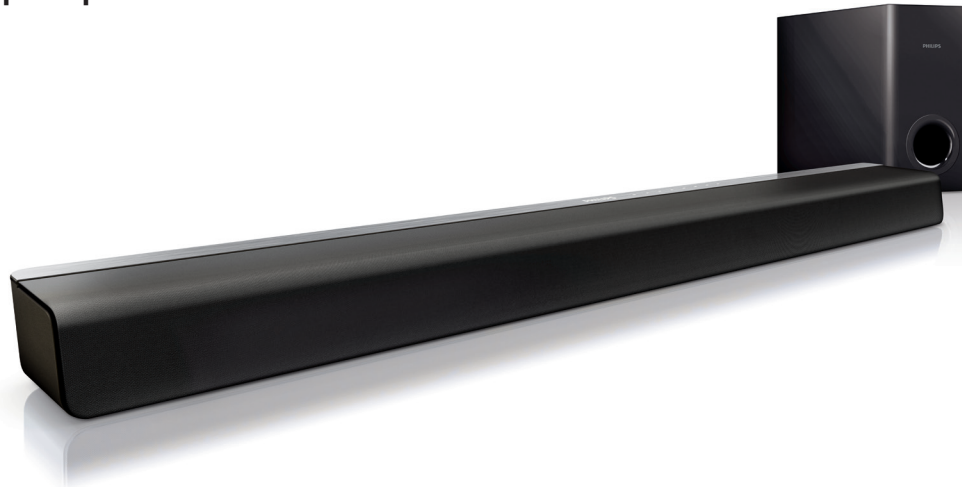

Quick start guide

P&F USA, Inc.

PHILIPS



- EN** Before using your product, read all accompanying safety information
- FR-CA** Avant d'utiliser votre produit, prenez le temps de lire toute l'information de sécurité connexe
- ES** Antes de usar el producto, consulte la información de seguridad que se encuentra adjunta



- EN** For further assistance, call the customer support service in your country.
To obtain assistance in the U.S.A., Canada, Puerto Rico, or the U.S. Virgin Islands, contact Philips Customer Care Center at 1-866-310-0744
To obtain assistance in Mexico, contact Philips Customer Care Center at 01 800 504 6200
- FR-CA** Pour obtenir de l'aide supplémentaire, communiquez avec le centre de service à la clientèle de votre pays.
Pour obtenir de l'aide aux États-Unis, au Canada, à Puerto Rico ou aux Îles Vierges américaines, communiquez avec le centre de service à la clientèle Philips au : 1-866-310-0744
Pour obtenir l'aide au Mexique, entrez en contact avec le centre de soin de client de Philips à 01 800 504 62 00
- ES** Para obtener más información, llame al servicio de soporte al cliente de su país.
Para obtener asistencia en los Estados Unidos, en Canada, Puerto Rico o en las Islas Virgenes de los Estados Unidos, comuníquese con Centro de atención al cliente de Philips al 1-866-310-0744
Solo para Mexico CENTRO DE ATENCION A CLIENTES LADA, 01 800 504 62 00 Solo Para Mexico.

- EN** For Product recycling information, please visit - www.recycle.philips.com
- FR-CA** Para obtener información de productos de reciclaje, por favor visite - www.recycle.philips.com
- ES** Para obtener información del reciclaje de productos, por favor visite - www.recycle.philips.com



- EN** What's in the box
FR-CA Contenu de la boîte
ES Contenido de la caja

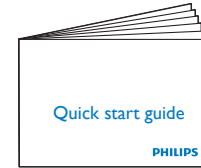
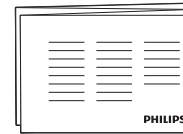
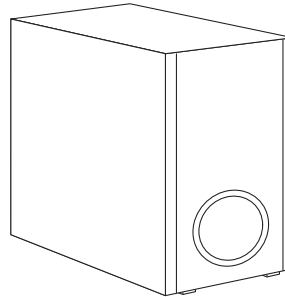
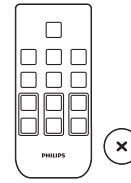
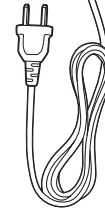
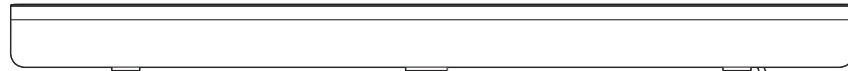



1

- EN** Position the SoundBar
- FR-CA** Positionnez le SoundBar
- ES** Posicione el sistema SoundBar

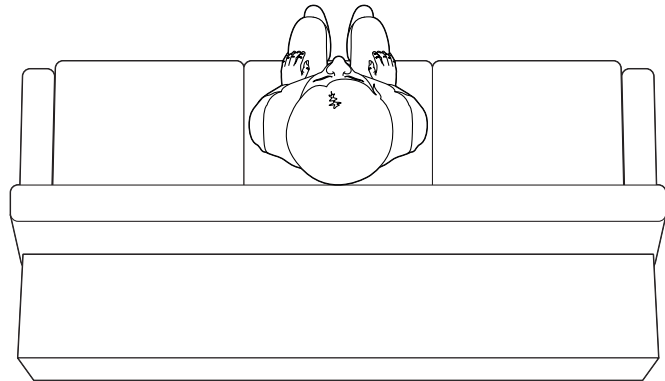
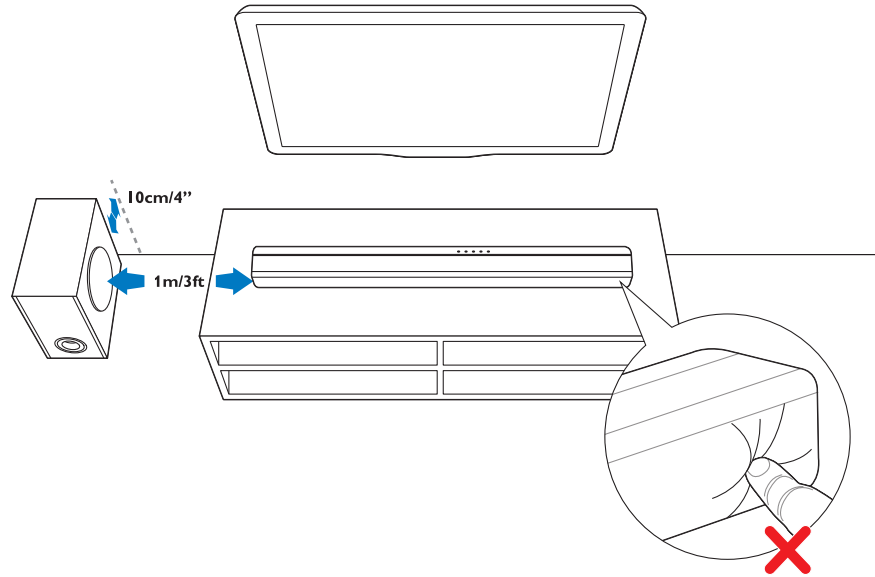



2

- EN** Connect the SoundBar
- FR-CA** Branchez le SoundBar
- ES** Conecte el sistema SoundBar

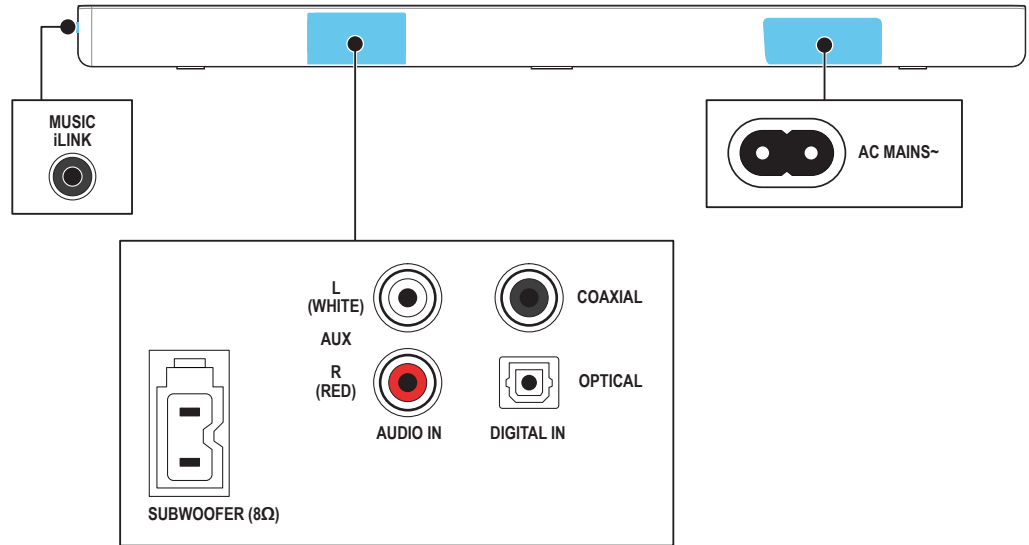

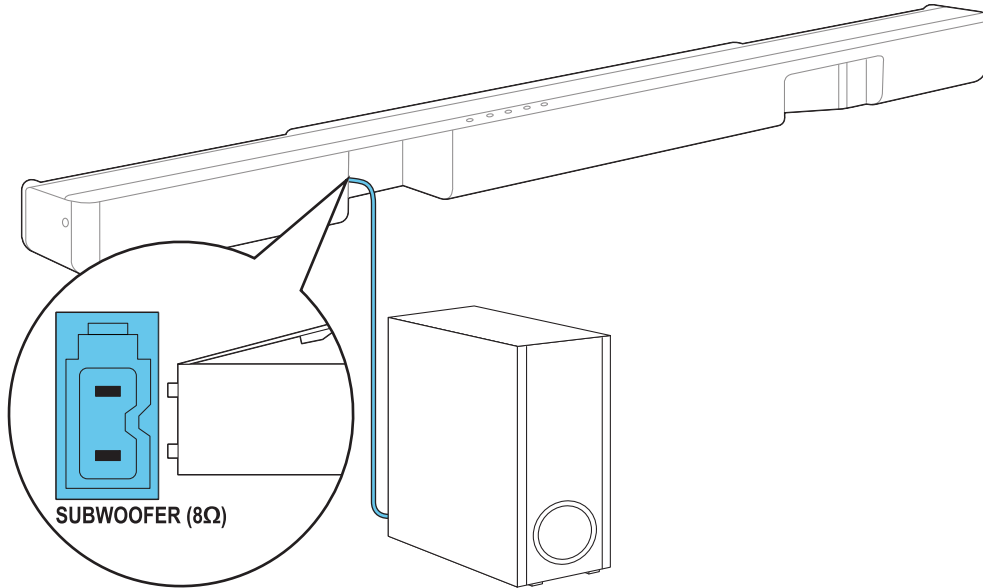



3

EN Connect the SoundBar to TV in one of the following ways

FR-CA Le branchement du SoundBar au téléviseur peut se faire des façons suivantes

ES Conecte la SoundBar a la TV de una de las siguientes formas

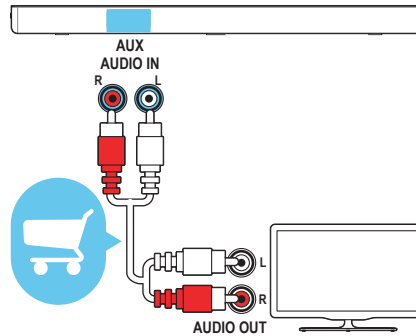
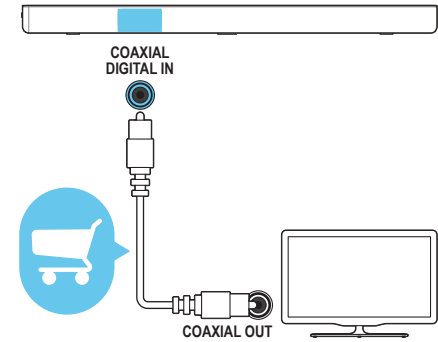
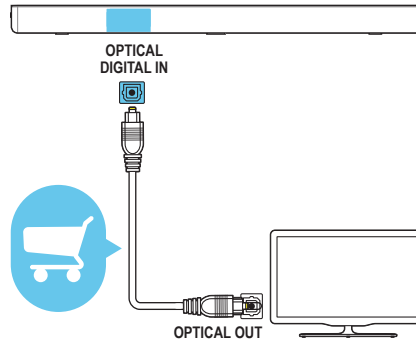

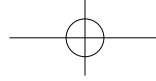

4

EN Connect the SoundBar to other devices in one of the following ways

FR-CA Le branchement du SoundBar à d'autres appareils peut se faire des façons suivantes

ES Conecte el sistema SoundBar a otros dispositivos de una de las siguientes formas

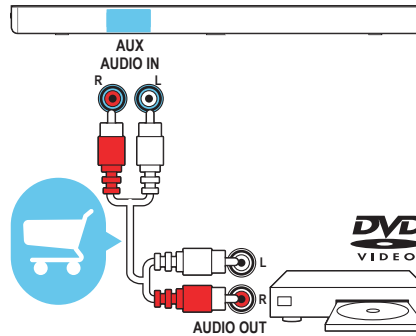
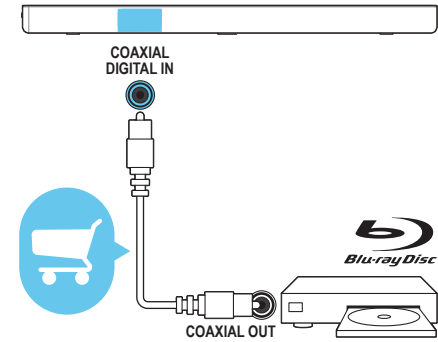
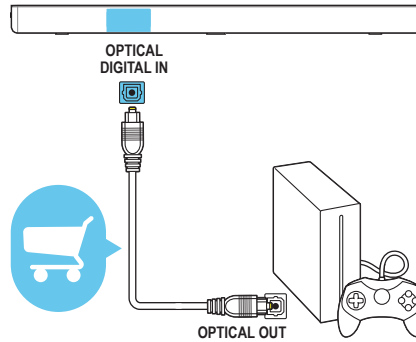



5

- EN** Switch on the SoundBar
- FR-CA** Allumez le SoundBar
- ES** Encienda el sistema SoundBar

1

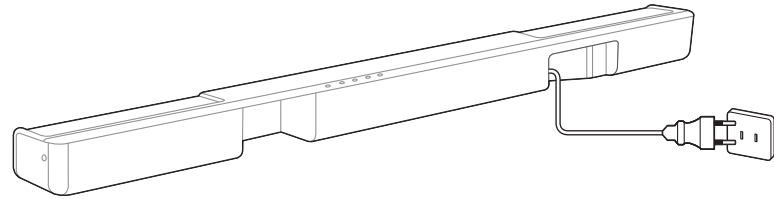

2

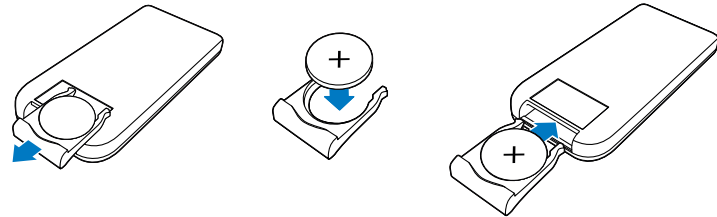

3

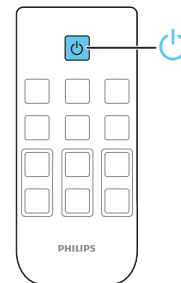



- EN** Mute your TV
FR-CA Coupez le son du téléviseur
ES Silencie el televisor

3

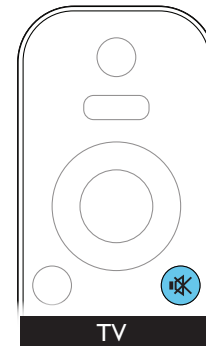
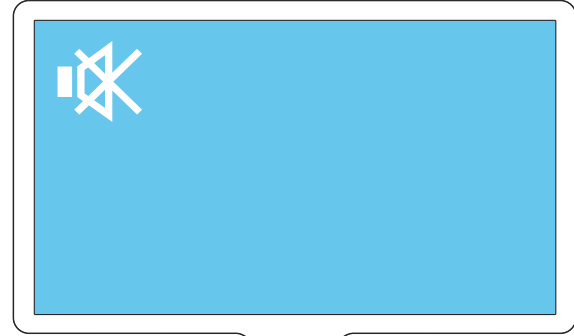

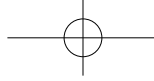

7

- EN** Select an audio source
- FR-CA** Sélectionnez une source audio
- ES** Seleccione una fuente de audio

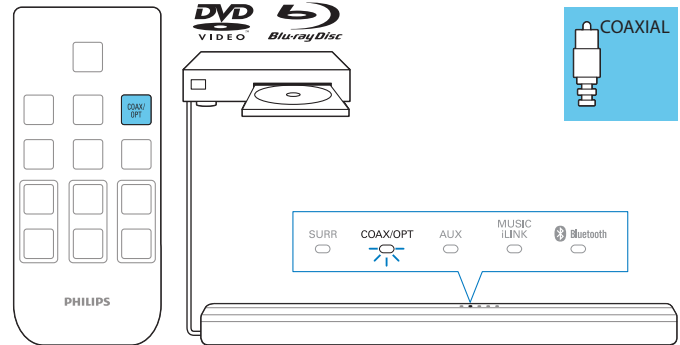
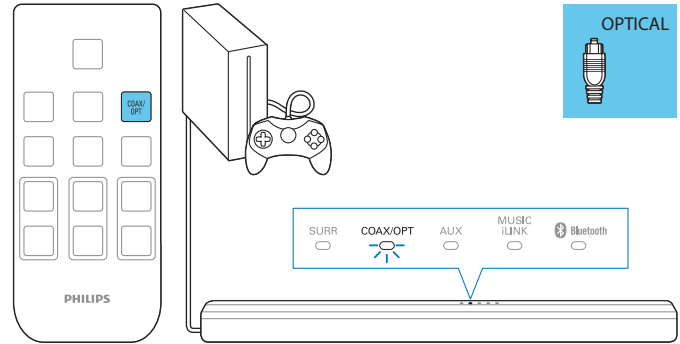

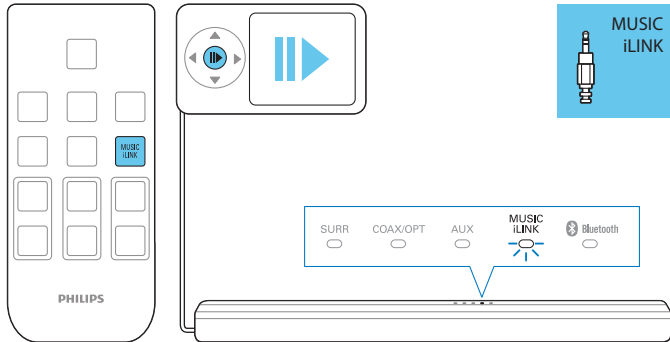
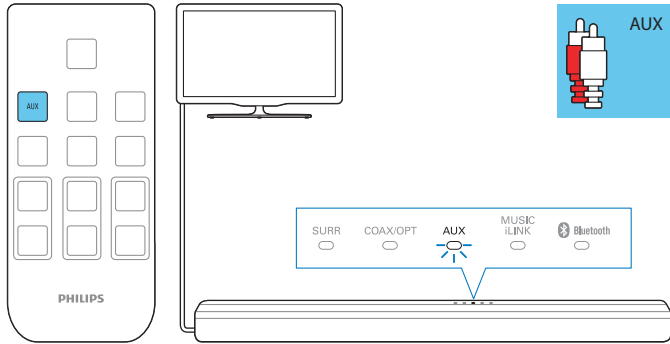



8

EN Play audio through Bluetooth

FR-CA Lisez du contenu audio par connexion Bluetooth

ES Reproducción de audio a través de Bluetooth

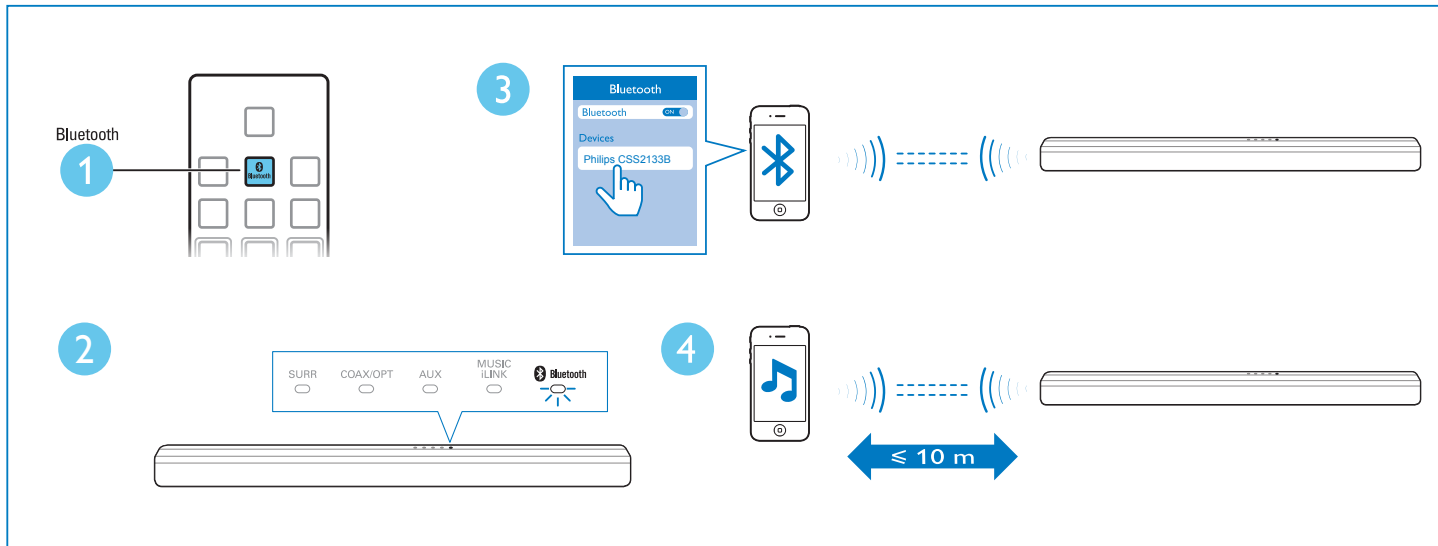

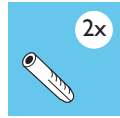

EN Wall mount the SoundBar (optional)

FR-CA Fixez le SoundBar au mur (facultatif)

ES Monte el sistema SoundBar en la pared (opcional)

1

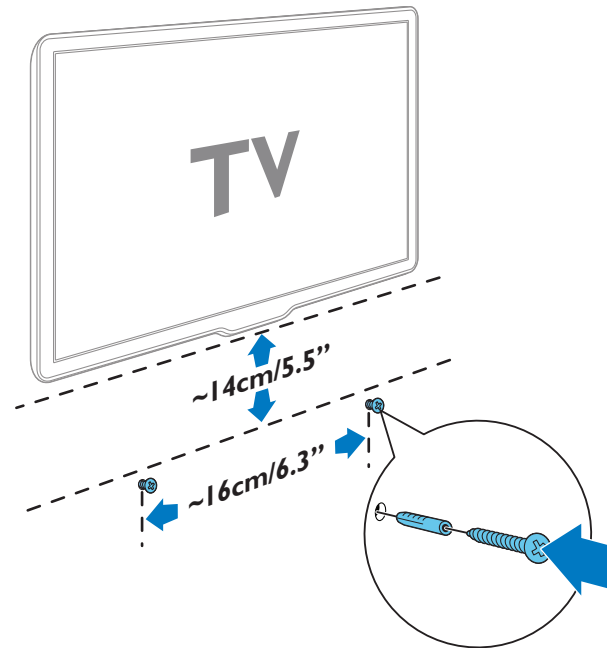

2

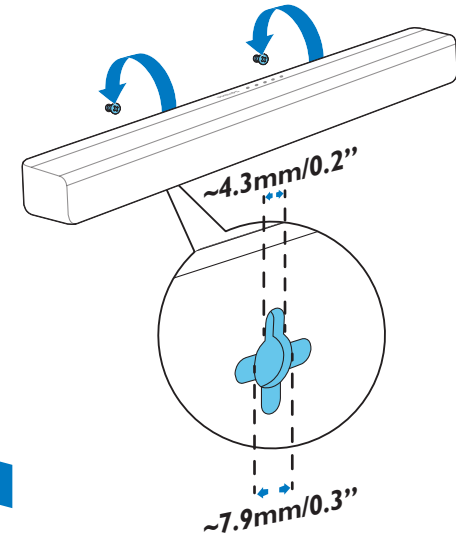

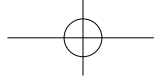

- EN** For more information about using this product, visit www.philips.com/support
- FR-CA** Pour en savoir plus sur l'utilisation de ce produit, visitez le site www.philips.com/support
- ES** Para obtener más información acerca de este producto, visite www.philips.com/support



Manufactured under license from Dolby Laboratories. Dolby and the double-D symbol are trademarks of Dolby Laboratories.





The Bluetooth® word mark and logos are registered trademarks owned by Bluetooth SIG, Inc. and any use of such marks by Philips is under license.

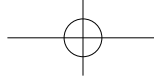

www.philips.com/support



P&F USA, Inc.
PO Box 2248 Alpharetta, GA 30023-2248

Altavoz SoundBar		CSS2133B/F7	
110-127 V~, 60 Hz		20 W	
Consumo de Energía Eléctrica		20 Wh	
Consumo de Energía Eléctrica del aparato en Modo de Espera		0.5Wh	
Comercializado por :	P&F MEXICANA. S.A. DE C.V.		
IMPORTADOR:	P&F MEXICANA. S.A. DE C.V.		
	Av. La Palma #6. Col. San Fernando La Herradura Huixquilucan, Edo. México. MEXICO C.P.52787. Tel: 52 (55) 5269 - 9000		
EXPORTADOR:	P&F USA Inc.		
HECHO EN:	CHINA		
			
GARANTIA INCLUIDA EN EL INSTRUCTIVO DE USO			
LEA CUIDADOSAMENTE ESTE INSTRUCTIVO			
ANTES DE USAR SU APARATO.			



Non-contractual images. / Images non contractuelles. / Außervertragliche Bilder.
All registered and unregistered trademarks are property of their respective owners.
Specifications are subject to change without notice
Trademarks are the property of Koninklijke Philips Electronics N.V. or their respective owners
2013 © Koninklijke Philips Electronics N.V. All rights reserved
www.philips.com
CSS2133B_F7_QSG_V1.0

 **Be responsible**
Respect copyrights

