

Register your product and get support at
www.philips.com/welcome

EN User manual

PHILIPS

Contents

| | | |
|----------|------------------|----------|
| 1 | Important | 4 |
| | Safety | 4 |
| | Notice | 5 |

| | | |
|----------|----------------------------------|----------|
| 2 | Your Entertainment System | 8 |
| | Introduction | 8 |
| | What's in the box | 8 |
| | What else you need | 8 |
| | Overview of the main unit | 8 |
| | Overview of the remote control | 9 |

| | | |
|----------|----------------|-----------|
| 3 | Prepare | 10 |
| | Connect | 10 |

| | | |
|----------|---|-----------|
| 4 | Set up a Wi-Fi network for AirPlay | 12 |
| | Connect the unit to a Wi-Fi network (router) | 12 |
| | Connect an AirPlay device to the same Wi-Fi network | 17 |

| | | |
|----------|--|-----------|
| 5 | Play | 19 |
| | Stream audio from your AirPlay device | 19 |
| | Control play | 20 |
| | Advanced control | 20 |
| | Update firmware | 20 |
| | Play from an external device | 21 |
| | Play and charge your iPod/iPhone/iPad through USB socket | 21 |

| | | |
|----------|----------------------------|-----------|
| 6 | Product information | 23 |
| | Specifications | 23 |

| | | |
|----------|------------------------|-----------|
| 7 | Troubleshooting | 24 |
|----------|------------------------|-----------|

1 Important

Safety

Important Safety Instructions

- ① Read these instructions.
- ② Keep these instructions.
- ③ Heed all warnings.
- ④ Follow all instructions.
- ⑤ Do not use this apparatus near water.
- ⑥ Clean only with dry cloth.
- ⑦ Do not block any ventilation openings. Install in accordance with the manufacturer's instructions.
- ⑧ Do not install near any heat sources such as radiators, heat registers, stoves, or other apparatus (including amplifiers) that produce heat.
- ⑨ Do not defeat the safety purpose of the polarized or grounding-type plug. A polarized plug has two blades with one wider than the other. A grounding type plug has two blades and a third grounding prong. The wide blade or the third prong are provided for your safety. If the provided plug does not fit into your outlet, consult an electrician for replacement of the obsolete outlet.

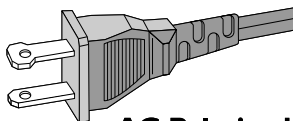

AC Polarized Plug

- ⑩ Protect the power cord from being walked on or pinched, particularly at plugs, convenience receptacles, and the point where they exit from the apparatus.

- ⑪ Only use attachments/accessories specified by the manufacturer.
- ⑫ Use only with the cart, stand, tripod, bracket, or table specified by the manufacturer or sold with the apparatus. When a cart is used, use caution when moving the cart/apparatus combination to avoid injury from tip-over.



- ⑬ Unplug this apparatus during lightning storms or when unused for long periods of time.
- ⑭ Refer all servicing to qualified service personnel. Servicing is required when the apparatus has been damaged in any way, such as power-supply cord or plug is damaged, liquid has been spilled or objects have fallen into the apparatus, the apparatus has been exposed to rain or moisture, does not operate normally, or has been dropped.
- ⑮ **Battery usage CAUTION** – To prevent battery leakage which may result in bodily injury, property damage, or damage to the remote control:
 - Install all batteries correctly, + and - as marked on the remote control.
 - Remove batteries when the remote control is not used for a long time.
 - Batteries (battery pack or batteries installed) shall not be exposed to excessive heat such as sunshine, fire or the like.
- ⑯ Apparatus shall not be exposed to dripping or splashing, keep it away from direct sunlight, naked flames or heat.
- ⑰ This product may contain lead and mercury. Disposal of these materials

may be regulated due to environmental considerations. For disposal or recycling information, please contact your local authorities or the Electronic Industries Alliance: www.eiae.org.

- ⑱ Where the mains plug or an appliance coupler is used as the disconnect device, the disconnect device shall remain readily operable.

Warning

- Never remove the casing of this apparatus.
- Never lubricate any part of this apparatus.
- Never place this apparatus on other electrical equipment.
- Keep this apparatus away from direct sunlight, naked flames or heat.
- Ensure that you always have easy access to the power cord, plug or adaptor to disconnect this apparatus from the power.

Hearing safety

Listen at a moderate volume.

- Using headphones at a high volume can impair your hearing. This product can produce sounds in decibel ranges that may cause hearing loss for a normal person, even for exposure less than a minute. The higher decibel ranges are offered for those that may have already experienced some hearing loss.
- Sound can be deceiving. Over time your hearing 'comfort level' adapts to higher volumes of sound. So after prolonged listening, what sounds 'normal' can actually be loud and harmful to your hearing. To guard against this, set your volume to a safe level before your hearing adapts and leave it there.

To establish a safe volume level:

- Set your volume control at a low setting.
- Slowly increase the sound until you can hear it comfortably and clearly, without distortion.

Listen for reasonable periods of time:

- Prolonged exposure to sound, even at normally 'safe' levels, can also cause hearing loss.
- Be sure to use your equipment reasonably and take appropriate breaks.

Be sure to observe the following guidelines when using your headphones.

- Listen at reasonable volumes for reasonable periods of time.
- Be careful not to adjust the volume as your hearing adapts.
- Do not turn up the volume so high that you can't hear what's around you.
- You should use caution or temporarily discontinue use in potentially hazardous situations. Do not use headphones while operating a motorized vehicle, cycling, skateboarding, etc.; it may create a traffic hazard and is illegal in many areas.

Risk of overheating! Never install this apparatus in a confined space. Always leave a space of at least four inches around this apparatus for ventilation. Ensure curtains or other objects never cover the ventilation slots on this apparatus.

Notice

Notice of compliance

Modifications

The user is cautioned that changes or modifications not expressly approved by the party responsible for compliance could void the user's authority to operate the equipment.

FCC & RSS compliance statement

This device complies with Part 15 of the FCC Rules and Industry Canada licence-exempt RSS standard(s). Operation is subject to the following two conditions:

- ① This device may not cause harmful interference, and
- ② This device must accept any interference received, including interference that may cause undesired operation.

Notice

Notice of compliance

Modifications

The user is cautioned that changes or modifications not expressly approved by the party responsible for compliance could void the user's authority to operate the equipment.

FCC & RSS compliance statement

This device complies with Part 15 of the FCC Rules and Industry Canada licence-exempt RSS standard(s). Operation is subject to the following two conditions:

- ① **This device may not cause harmful interference, and**
- ② **This device must accept any interference received, including interference that may cause undesired operation.**

L'appareil est conforme à la réglementation FCC, section 15 et Industrie Canada RSS standard exempts de licence (s). Son utilisation est soumise à deux conditions :

- (1) L'appareil ne doit pas provoquer d'interférences nuisibles, et
- (2) L'appareil doit supporter les interférences reçues, y compris les interférences empêchant son fonctionnement correct.

FCC Radiation Exposure Statement

This equipment complies with FCC's and IC's RF radiation exposure limits set forth for an uncontrolled environment. The antenna(s) used for this transmitter must be installed and operated to provide a separation distance of at least 20 cm from all persons and must not be collocated or operating in conjunction with any other antenna or transmitter. Installers must ensure that 20cm separation distance will be maintained between the device (excluding its handset) and users.

Este equipo cumple con los límites de exposición a las radiaciones de radiofrecuencia que establece la FCC e IC para proteger el medio ambiente. Las antenas utilizadas para este transmisor deben instalarse y ponerse en funcionamiento para proporcionar una distancia mínima de 20 cm de separación de todas las personas y no deben colocarse ni funcionar junto con cualquier otra antena o transmisor. Los instaladores deben asegurarse de que se mantiene una distancia de 20 cm de separación entre el dispositivo (excluido el microteléfono) y

FCC rules

This equipment has been tested and found to comply with the limits for a Class B digital device, pursuant to Part 15 of the FCC Rules. These limits are designed to provide reasonable protection against harmful interference in a residential installation. This equipment generates, uses and can radiate radio frequency energy and, if not installed and used in accordance with the instructions, may cause harmful interference to radio communications. However, there is no guarantee that interference will not occur in a particular installation.

If this equipment does cause harmful interference to radio or television reception, which can be determined by turning the equipment off and on, the user is encouraged to try to correct the interference by one or more of the following measures:

- Reorient or relocate the receiving antenna.
- Increase the separation between the equipment and receiver.
- Connect the equipment into an outlet on a circuit different from that to which the receiver is connected.
- Consult the dealer or an experienced radio/TV technician for help.

Canada:

This Class B digital apparatus complies with Canadian ICES-003.

Cet appareil numérique de la classe B est conforme à la norme NMB-003 du Canada

Disposal of your old product and batteries

Your product is designed and manufactured with high quality materials and components, which can be recycled and reused.

Never dispose of your product with other household waste. Please inform yourself about the local rules on the separate collection of electrical and electronic products and batteries. The correct disposal of these products helps prevent potentially negative consequences on the environment and human health.

Your product contains batteries, which cannot be disposed of with normal household waste. Please inform yourself about the local rules on separate collection of batteries. The correct disposal of batteries helps prevent potentially negative consequences on the environment and human health.

Please visit www.recycle.philips.com for additional information on a recycling center in your area.

Information about the use of batteries:

Caution

- Risk of leakage: Only use the specified type of batteries. Do not mix new and used batteries. Do not mix different brands of batteries. Observe correct polarity. Remove batteries from products that are not in use for a longer period of time. Store batteries in a dry place.
- Risk of injury: Wear gloves when handling leaking batteries. Keep batteries out of reach of children and pets.
- Risk of explosion: Do not short circuit batteries. Do not expose batteries to excessive heat. Do not throw batteries into the fire. Do not damage or disassemble batteries. Do not recharge non-rechargeable batteries.

Environmental information

All unnecessary packaging has been omitted. We have tried to make the packaging easy to separate into three materials: cardboard (box), polystyrene foam (buffer) and polyethylene (bags, protective foam sheet.)

Your system consists of materials which can be recycled and reused if disassembled by a specialized company. Please observe the local regulations regarding the disposal of packaging materials, exhausted batteries and old equipment.

Made for



iPod



iPhone



iPad



“Made for iPod,” “Made for iPhone,” and “Made for iPad” mean that an electronic accessory has been designed to connect specifically to iPod, iPhone, or iPad, respectively, and has been certified by the developer to meet Apple performance standards. Apple is not responsible for the operation of this device or its compliance with safety and regulatory standards. Please note that the use of this accessory with iPod, iPhone, or iPad may affect wireless performance.

AirPlay, iPod, and iPhone are trademarks of Apple Inc., registered in the U.S. and other countries. iPad is a trademark of Apple Inc.

Note

- The type plate is located on the bottom of the apparatus.

2 Your Entertainment System

Congratulations on your purchase, and welcome to Philips! To fully benefit from the support that Philips offers, register your product at www.philips.com/welcome.

If you contact Philips, you will be asked for the model and serial number of this apparatus. The model number and serial number are on the bottom of the apparatus. Write the numbers here:

Model No. _____

Serial No. _____

Introduction

With this unit, you can:

- stream audio from your iOS 4.2 (or later) enabled device (e.g., an iPod touch/iPhone/iPad) wirelessly by AirPlay.
- stream audio from your Wi-Fi enabled PC or Mac installed with iTunes 10 (or later) wirelessly by AirPlay.
- play audio from other audio devices through AUX IN socket or USB socket.
- charge your iPod/iPhone/iPad through the USB socket with a USB cable (not supplied).

What's in the box

Check and identify the contents of your package:

- Main unit
- Remote control
- 1 x AC power cord

- 1 x MP3 link cable
- Desk top adaptor
- User manual
- Quick start guide

What else you need

To stream audio wirelessly by AirPlay, you need:

- A wireless router that is powered on and working properly.
- An AirPlay device (e.g., an iOS 4.2 (or later) enabled iPod touch/iPhone/iPad or Wi-Fi enabled PC or Mac installed with iTunes 10 (or later)).

Overview of the main unit

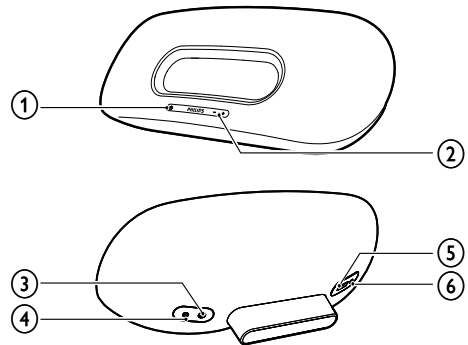

- ① **⏻**
 - Turn on/off the unit.
 - (Press and hold) reset the unit.
 - As the indicator to show the current status of the unit.
- ② **VOLUME +/-**
 - Adjust volume.
- ③ **DC IN**
 - Power socket of the unit.
- ④ **AUX IN**
 - Socket for an external audio player.
- ⑤ **USB** 
 - USB socket.

⑥ WI-FI SETUP

- Connect the unit to a Wi-Fi network.

⑧ ▶||

- Start or pause play.

Overview of the remote control

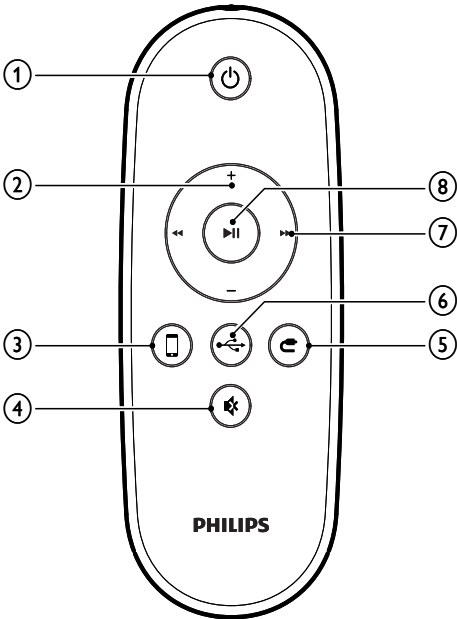

- ① Turn on/off the unit.
- ② Adjust volume.
- ③ Select the AirPlay device audio source.
- ④ Mute or restore volume.
- ⑤ Select the AUX IN audio source.
- ⑥ USB socket.
- ⑦ Skip to the previous/next track.

3 Prepare

Always follow the instructions in this chapter in sequence.

Connect

Connect power

! Caution

- Risk of product damage! Ensure that the power supply voltage corresponds to the voltage printed on the bottom of the unit.
- Risk of electric shock! When you unplug the AC adaptor, always pull the plug from the socket. Never pull the cord.
- Before connecting the AC adaptor, ensure you have completed all other connections.

- 1 Insert the plug from the AC adaptor to the **DC IN** socket on the back of the main unit.

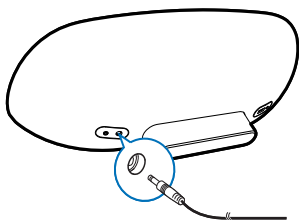

- 2 Connect one end of the AC power cord to the AC adaptor.

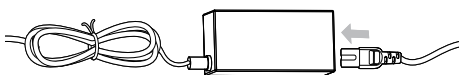

- 3 Connect the other end of the AC power cord to the wall outlet.

↳ It takes about 35 seconds for the speakers to boot up. During boot-up, the ϕ indicator on the front of the main unit blinks in green quickly.

↳ After boot-up, the ϕ indicator starts to blink in green slowly.

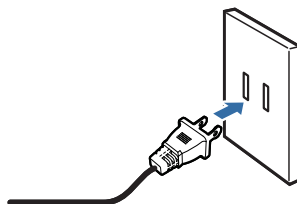

Switch on or to standby mode

The unit switches on automatically after power connection.

- To switch the unit to standby mode, press ϕ on the front of the main unit.
- To switch the unit on from the standby mode, press ϕ again.

Prepare the remote control

! Caution

- Risk of explosion! Keep batteries away from heat, sunshine or fire. Never discard batteries in fire.
- Perchlorate Material - special handling may apply. See www.dtsc.ca.gov/hazardouswaste/perchlorate.

For first-time use:

- 1 Remove the protective tab to activate the remote control battery.

To replace the remote control battery:

- 1 Open the battery compartment.
- 2 Insert one CR2025 battery with correct polarity (+/-) as indicated.
- 3 Close the battery compartment.

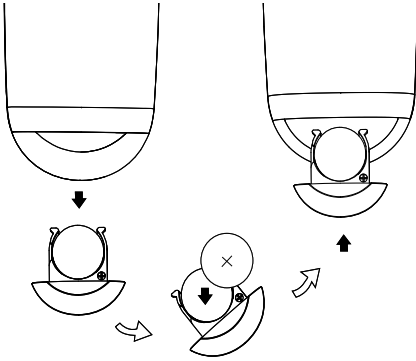

Note

- Before pressing any function button on the remote control, first select the correct source with the remote control instead of the main unit.
- If you are not going to use the remote control for a long time, remove the battery.

4 Set up a Wi-Fi network for AirPlay

Note

- Some operations may vary as you use different types of wireless routers.
- You are recommended to change the SSID of your wireless router to 'PhilipsFidelioAP'. In this way, the unit can get connected to the router automatically after power-on. You can hear a beep after successful connection. Then, proceed to 'Connect an AirPlay device to the same Wi-Fi network' directly.

The unit is compatible with the following iPod/iPhone/iPad models:

- iPod touch (2nd, 3rd, and 4th generation)
- iPhone 4
- iPhone 3GS
- iPad 2
- iPad



Before setup of the Wi-Fi network, check the points below.

- 1 Make sure that the wireless router is powered on and working properly.
- 2 Make sure that the ϕ indicator on the front of the main unit blinks in green slowly.

- 3 Check the type of the wireless router you use.

Connect the unit to a Wi-Fi network (router)

Select a scenario below that matches your router type.

Note

- Each time when the unit is powered on again, the unit enters the latest configured Wi-Fi network automatically.
- In case of setup failure, repeat the steps, or press and hold ϕ on the front of the main unit and try again.

Scenario 1: Connect to a WPS-PBC router

- 1 Press **WI-FI SETUP** on the back of the main unit.
 - ↳ The ϕ indicator blinks in red, green, and yellow alternately.

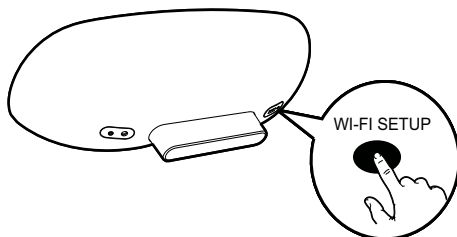

- 2 Press the WPS button on the wireless router.
 - ↳ After a while, the ϕ indicator stops blinking and stays green, and the speaker beeps.
 - ↳ The unit joins the Wi-Fi network successfully.

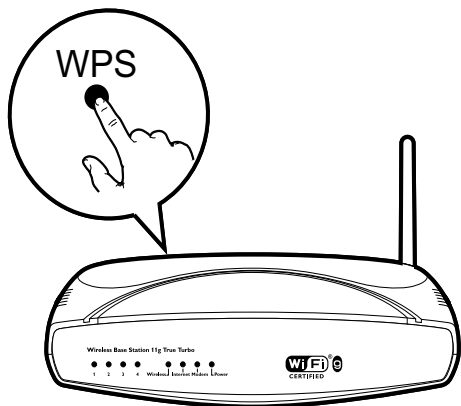

Tip

- To change the name of the unit for AirPlay, proceed with steps 2 to 7 in 'Scenario 2: Connect to a non-WPS router' below.
- For some wireless routers, you may need to hold the WPS button for WPS connection. See the user manuals of the specific routers for details.

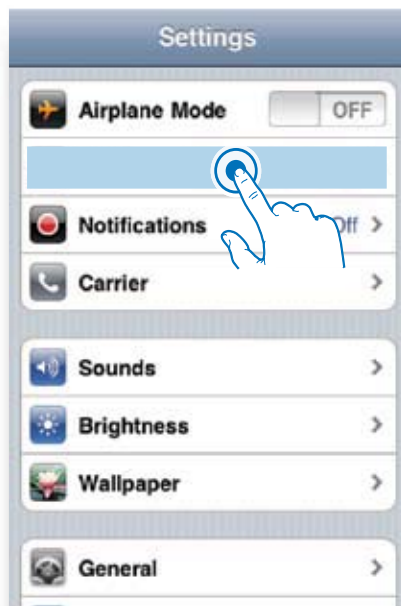

- 3 Select **Philips_Fidelio_AirPlay** from the list of available networks.

Scenario 2: Connect to a non-WPS router

You can connect the unit to a non-WPS router through

- an iOS 4.2 (or later) enabled iPod touch/iPhone/iPad
- a Wi-Fi enabled PC or Mac installed with iTunes 10 (or later)

- 1 Press and hold **WI-FI SETUP** on the back of the main unit for more than 5 seconds.
 - ↳ The ϕ indicator blinks in green and yellow alternately.
- 2 Select **Settings** -> **Wi-Fi** on your iPod touch/iPhone/iPad.
 - Or enter the list of available wireless networks on your PC/Mac.

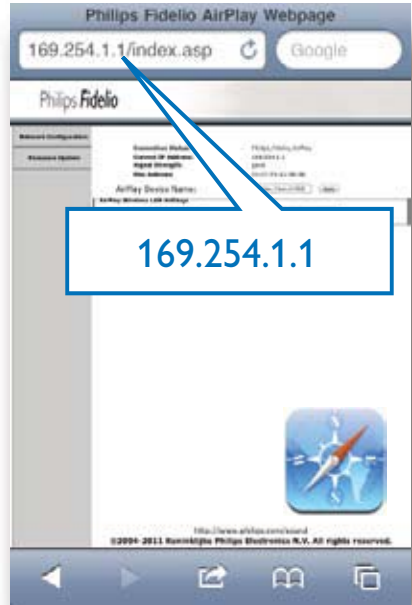

- 4 Wait until successful Wi-Fi connection to the main unit.
 - ↳ A Wi-Fi signal icon is displayed on the iPod touch/iPhone/iPad.
- 5 Open **Safari** on your iPod/iPhone/iPad.
 - Or open the web browser on your PC or Mac.
- 6 Type in **169.254.1.1** at the address bar to enter the DS8800W configuration page.

- 7 Select the **Network Configuration** tab.

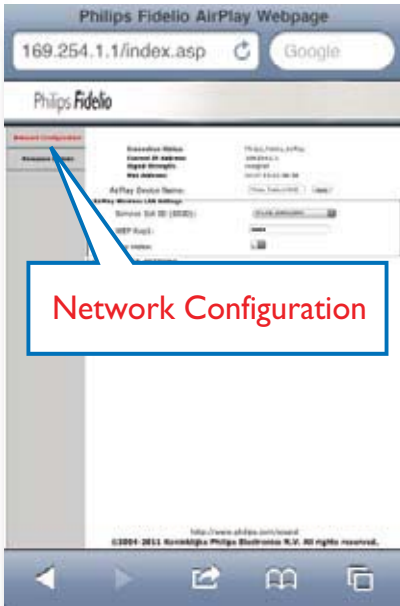

- 8 Change the name of the unit in **Airplay Device Name** if you like.
- 9 Select your router SSID from the pull-down list of **Service Set ID (SSID)**.

- 10 Enter your network key if required (For some routers, you may also need to tick **DHCP** under **Advance Setting**.)

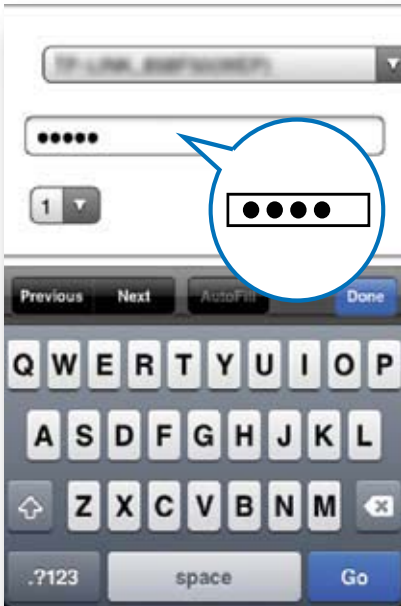

- 11** Click **Apply** at the bottom of the page to apply your settings.
- ↳ A menu for confirmation of your set parameters pops up.

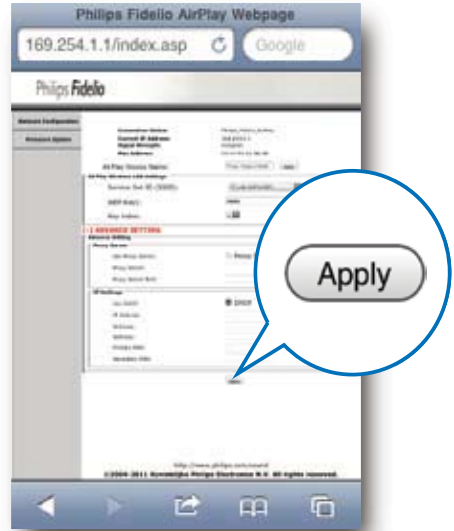

- 12** Click **OK** on the popup menu to confirm your settings.
- ↳ After a while, the ϕ indicator stops blinking and stays green, and the speaker beeps.
 - ↳ The unit joins the Wi-Fi network successfully.

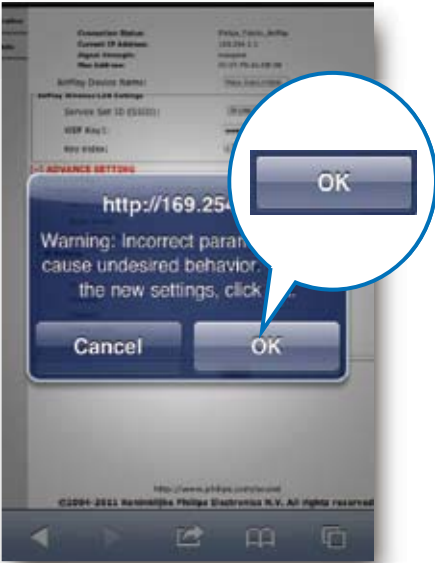

Connect an AirPlay device to the same Wi-Fi network

To work together with the unit, your AirPlay device is required to join the same Wi-Fi network as the unit.

- 1 Select **Settings** -> **Wi-Fi** on your iPod touch/iPhone/iPad.
 - Or enter the list of available wireless networks on your PC/Mac.

- 2 Select your router SSID from the list of available wireless networks.



- 3 Wait until successful Wi-Fi connection to the router:
 - ↳ A Wi-Fi signal icon is displayed on the AirPlay device.

5 Play

Stream audio from your AirPlay device

Note

- Make sure that the AirPlay device is connected to the same Wi-Fi network as the unit.

Stream from your iOS 4.2 (or later) enabled iPod touch/iPhone/iPad

- 1 Open iPod.
- 2 Tap on the AirPlay icon.

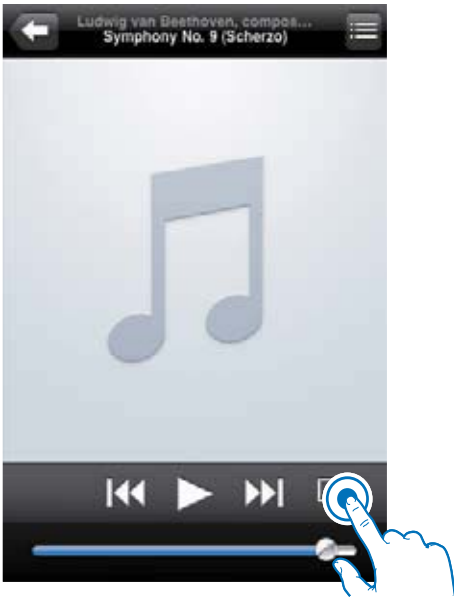

- 3 Select **Philips_Fidelio XXXX** (or user customized name) from the list.



- 4 Select a media file and start play.

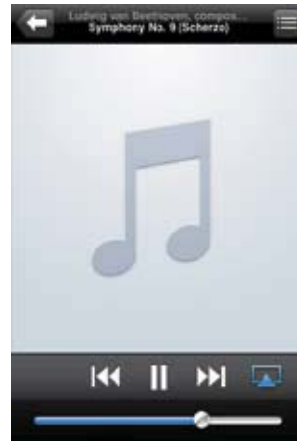

- 5 Wait until successful audio streaming to the speakers.

Stream from your Wi-Fi enabled PC or Mac installed with iTunes 10 (or later)

Note

- Before you open iTunes, make sure that you have enabled Bonjour service in your PC. Take Windows XP for example: to enable the service, you can click **Start->Settings->Control Panel**, and double-click **Administrative Tools-> Services->Bonjour Service**, and then click **Start** followed by **OK** on the pop-up menu.

- 1 Open iTunes 10 (or later).
- 2 Click the AirPlay icon at the bottom right corner of the window.
- 3 Select **Philips_Fidelio_AirPlay XXXX** (or user customized name) from the list.
- 4 Select a media file and start play.
- 5 Wait until successful audio streaming to the speaker.

Control play

You can select different play options from either your AirPlay device or the supplied remote control.

Note

- All the operations below are based on the supplied remote control.

- To start or pause play, press **▶||**.
- To skip to the previous or next track, press **◀/▶**.
- To adjust volume, press **+/-** repeatedly.
- To mute or restore volume, press **🔇**.
- To switch to the AUX IN source (if connected), press **📶**.
- To switch back to the AirPlay device source, press **📶**.

Advanced control

For advanced control, you can use your AirPlay device to download the **Philips Fidelio** application from Apple Application Store.

Update firmware

Note

- You can only update the firmware from a PC/Mac.

Download the update file

- 1 On your PC/Mac, go to www.philips.com/support.
- 2 Enter the model number to find the latest firmware upgrade file available.
- 3 Save the upgrade file to your hard drive.

Update from the configuration page

You can update the firmware in two different ways.

Option 1 (recommended): the unit and PC/Mac connected to the same wireless router

- 1 Make sure that the unit and PC/Mac are connected to the same wireless router.
- 2 Power on the unit (see 'Prepare - Connect - Connect power').
 - ↳ It takes about 35 seconds for the speaker to boot up. During boot-up, the Φ indicator on the front of the main unit blinks in green quickly.
 - ↳ After boot-up, the Φ indicator starts to blink in green slowly.
- 3 Open **Safari** on your PC/Mac, and then select 'Philips_Fidelio XXXX' from the bonjour pull-down list.
 - Or open the web browser on your PC or Mac, and then type in the IP address of DS8800W (available at

the router configuration page) at the address bar:

↳ The DS8800W configuration page is displayed.

- 4 Select the **Firmware Update** tab, and then follow the on-screen instruction to enter the next page.
- 5 Click **Browse** to select the downloaded firmware update file, and then click **Open**.
- 6 Click **Upload** to upload the file, and then compare the current and new file versions.
- 7 After you make sure that the downloaded update file is the latest, click **Ok** to start firmware update.
↳ A progress bar is displayed.
- 8 At completion of the update process, click **Ok** to confirm.

Option 2: the unit connected to PC/Mac directly

- 1 Repeat step 2 in the above.
- 2 Press and hold **WI-FI SETUP** on the back of the main unit for more than 5 seconds.
↳ The Φ indicator blinks in green and yellow alternately.
- 3 Enter the list of available wireless networks on your PC/Mac.
- 4 Select **Philips_Fidelio_AirPlay** (or the user customized name) from the list of available networks.
- 5 Open **Safari** on your PC/Mac, and then select 'Philips_Fidelio XXX' from the bonjour pull-down list.
 - Or open the web browser on your PC or Mac, and then type in **169.254.1.1** at the address bar.
↳ The DS8800W configuration page is displayed.
- 6 Repeat steps 4 to 8 in the above to finish firmware update.

Play from an external device

You can also listen to an external audio player through the unit.

Connect the supplied MP3 link cable to:

- the **AUX IN** socket on the back of the main unit.
- the headphone jack on an external audio player.

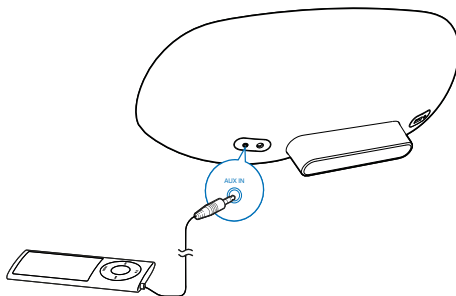

Note

- To play audio from the connected audio player, first press **⏮** to select the **AUX IN** source.

Play and charge your iPod/iPhone/iPad through USB socket

Note

- USB source is only for Apple devices.
- Ensure that the USB connected device contains playable audio contents for supported formats.

- 1 Connect the USB cable (not supplied) to:
 - the **⏮** socket on the back of the main unit.
 - the charging jack on the Apple device (iPod/iPhone/iPad).
↳ The connected iPod/iPhone/iPad begins to charge automatically.

- 2 Press **▶||** to start play.
- To pause or resume play, press **▶||**.
 - To skip to the previous or next track, press **◀/▶**.

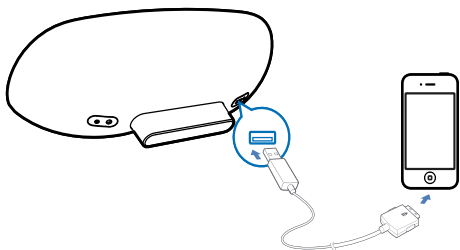

Note

- To play audio from the connected Apple device, first press **⏏** to select the USB source.

Compatible iPod/iPhone/iPad

The USB socket supports the following iPod, iPhone, and iPad models.

Made for:

- iPod touch (1st, 2nd, 3rd, and 4th generation)
- iPod classic
- iPod nano (2nd, 3rd, 4th, 5th, and 6th generation)
- iPhone 4
- iPhone 3GS
- iPhone 3G
- iPhone
- iPad 2
- iPad

6 Product information



Note

- Product information is subject to change without prior notice.

Specifications

Amplifier

| | |
|-----------------------|---------------------------|
| Rated Output Power | 2 X 15 W RMS |
| Frequency Response | 20 - 20000 Hz, ± 3 dB |
| Signal to Noise Ratio | > 90 dB |
| Aux Input | 650 mV RMS 20 kohm |

Speakers

| | |
|-------------------|-------------------------------|
| Speaker Impedance | 8 ohm |
| Speaker Driver | 130 mm woofer + 19 mm tweeter |
| Sensitivity | > 85 dB/m/W |

General information

| | |
|-------------------------------|---|
| AC power | Model: GFP451DA-1825-1 Input: 100 - 240 V~, 50/60 Hz 1.2 A Output: 18V \equiv 2.5 A |
| Operation Power Consumption | 10 W |
| Eco Standby Power Consumption | < 0.5 W |
| Dimensions - Main Unit | 455 x 165 x 150 mm |
| Weight - With Packing | 3.5 kg |
| - Main Unit | 2.5 kg |

7 Troubleshooting



Warning

- Never remove the casing of this apparatus.

To keep the warranty valid, never try to repair the system yourself.

If you encounter problems when using this apparatus, check the following points before requesting service. If the problem remains unsolved, go to the Philips web site (www.philips.com/welcome). When you contact Philips, ensure that the apparatus is nearby and the model number and serial number are available.

No power

- Ensure that the AC power plug of the unit is connected properly.
- Ensure that there is power at the AC outlet.

No sound

- Adjust the volume.
- Check the network connection. Set up the network again if needed (see 'Set up a Wi-Fi network (router)').

No response from the unit

- Press and hold ϕ on the front of the main unit to reset the device. Set up the network again (see 'Set up a Wi-Fi network (router)').
- Disconnect and reconnect the AC power plug, and then switch on the device again.

Wi-Fi network connection failed

- Check if your Wi-Fi router is Wi-Fi certified. This device is only compatible with Wi-Fi certified routers.
- This device does not support WPS-Pin routers.
- This device does not support all WPS-PBC routers (see the user manual of your router).
- Enable SSID broadcast on the Wi-Fi router.

- Avoid using Wi-Fi channel which is using or much overlapped by the nearby Wi-Fi network.
- Keep away from potential sources of interference which may affect Wi-Fi signal, such as microwave ovens.
- If you fail to use your PC for Wi-Fi network setup, check whether your PC is using a Wi-Fi network. You cannot use Ethernet connection for AirPlay network setup. If the problem remains, it is strongly recommended to use iPod Touch/iPhone/iPad/Mac to do the first-time Wi-Fi setup as some PC settings may affect the Wi-Fi network setup.
- Make sure that the SSID name of your home router consists of normal characters or digits, with no space or special characters like %/#/* inserted.
- If you choose to rename the AirPlay device 'Philips_Fidelio XXXX' in the setting menu, do not use special characters or symbols.
- If you fail to get connected via WPS, make sure that you are using a WPS certified router. If the problem remains, do not use the default SSID name for your WPS router. The default SSID name may involve security protection that leads to connection failure. Use simple characters or digits only to rename your WPS router.

Occasional breaking of AirPlay music streaming

Do one or all of the following:

- Enable the Auto Channel Scan option (if available on the Wi-Fi router).
- Enable the Wireless Intelligent Stream Handling (WISH) option (if available on the Wi-Fi router).
- Enable the Quality of Service (QoS) option (if available on the Wi-Fi router).
- Turn off other home routers.

No AirPlay icon on Apple AirPlay device or iTunes in my PC

- Make sure that the unit have already joined the AirPlay network.

- Before you open iTunes, make sure that you have enabled Bonjour service in your PC. Take Windows XP for example: to enable the service, you can click **Start->Settings->Control Panel**, and double-click **Administrative Tools-> Services->Bonjour Service**, then click **Start** followed by **OK** on the pop-up menu.
- If the problem remains, try to restart the unit.

AirPlay connection failed with Mac or PC

- Disable the firewalls software and security software, which may block ports that AirPlay uses to stream content.
- Check if your network speed is fast enough (in cases where multiple devices share the same router, the AirPlay performance may be affected). Turn off the other devices connected to your home router.
- In case of audio streaming break or disconnection when you use iPod Touch/ iPhone/iPad/iMac/PC for AirPlay, restart your iPod Touch/iPhone/iPad, iTunes or DS8800W.
- Browsing Internet content like news, music, video and etc. via your home router may affect the AirPlay performance. In case of AirPlay break or disconnection, it is recommended to stop any Internet surfing or disconnect from the Internet.

