

# SHB8000\_QSG\_English

09 June 2013

Page 1

Back

Cover

For your first time use:

1. Manually pair your headphone.
2. Make sure the headphone is fully charged. (Approximately 5 hours)
3. Enable Bluetooth on your device and keep open on screen.
4. Press and hold the Call/Music button until the blue and white LED is flashing alternatively.
5. Your device should start searching for Philips SHB8000.
6. Follow the on screen instructions to pair your device. (Check your phones' user manual for details).

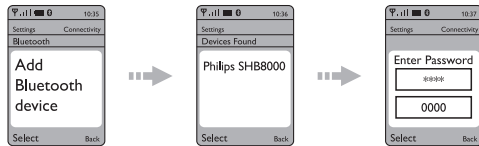

Please refer to [www.philips.com/welcome](http://www.philips.com/welcome) for the full user manual

'0000' not required for some mobile phones

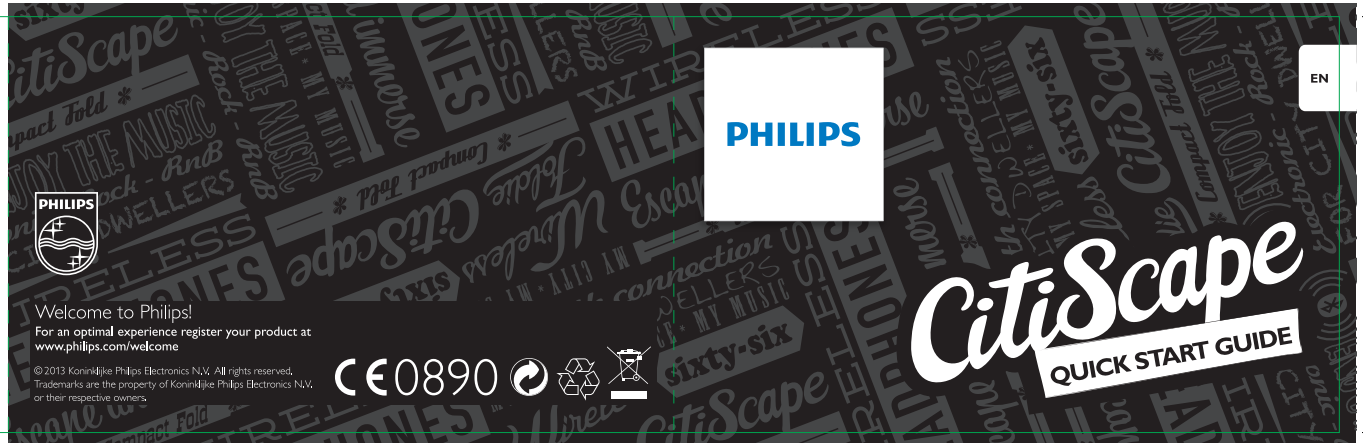

EN

86 mm

88 mm

88 mm

Page 2

Page 3

Page 4

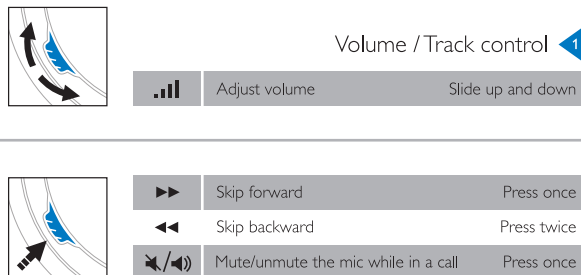

88 mm

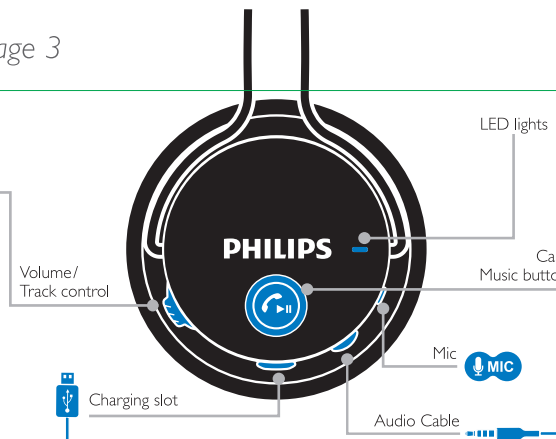

\* When your battery is empty you can carry on listening with an added audio cable. Please ensure you fully turn off your headphone before using this cable.

88 mm

## 2 Call / Music button

Turn headset on/off	On: press 1 second	Off: press 4 seconds
Play/Pause/Pick up call/Hang up	Press once	
Reject incoming call	Long press	
Redial	Press twice	
Switch caller while in a call	Press twice	
In pairing mode	Blue and white LED is flashing alternatively	
Paired and connected mode	Blue LED flashing at every 8 sec	
100% fully charged	White LED goes out once it is fully charged when cable is connected	
Low battery	White LED flashing	

86 mm