



Philips Norelco  
PowerTouch  
wet and dry electric razor  
with Aquatec wet and dry  
and Pop-up trimmer

**TripleTrack heads**

SmartPivot heads

**PowerTouch**

**AT920**

## TripleTrack, shaves faster

PowerTouch with Aquatec adds power to your morning, with more minutes per charge, fully washable heads, and TripleTrack heads for a faster shave. The Aquatec seal ensures a comfortable dry shave and a refreshing wet shave.

### Close shaving performance

- Patented Super Lift & Cut blade raise hairs to cut closer
- Triple track heads cover 50% for more skin surface at a time

### Comfort Contour Following

- Heads Pivot and Flex to follow every curve for comfort

### Easy to use

- Anti-slip grip provides complete control
- Up to 60 shaving minutes, 1 hour charge
- For easy cleaning, and wet & dry use
- Perfect for trimming your sideburns and moustache

### Skin friendly

- Aquatec: refreshing wet shave with foam or an easy dry shave
- Glides smoothly over the curves of your face
- Low- friction SkinGlide for an extra smooth shave



**PHILIPS**  
**NORELCO**  
sense and simplicity

# Highlights

## (Patented) Super Lift & Cut

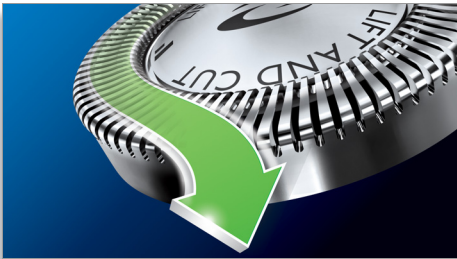

The first blade raises each hair while the second blade comfortably cuts it below skin level, for a really smooth result.

## Anti-slip grip

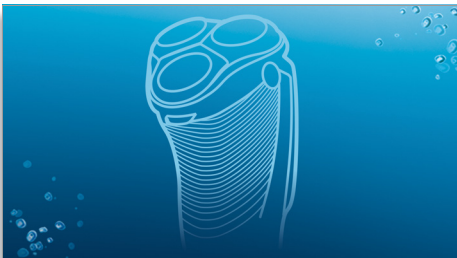

The grip's unique, ergonomic design and anti-slip materials make it easy to shave with precision and comfort.

## Aquatec wet and dry



The AquaTec seal on the Philips electric shaver makes it 100% waterproof. Use it in the shower with your favorite shaving gel or foam for extra skin comfort. Naturally you can also shave dry for convenience

## Cordless use only



An efficient, powerful lithium-ion battery gives you more shaves per charge. Charge it for an hour and you'll have up to 60 minutes of shaving time – that's around 20 shaves. The shaver automatically adjusts its power to suit the way you shave, so your actual shaving time may vary. Charge it for 3 minutes and you'll have enough power for one shave.

## Skin protection system

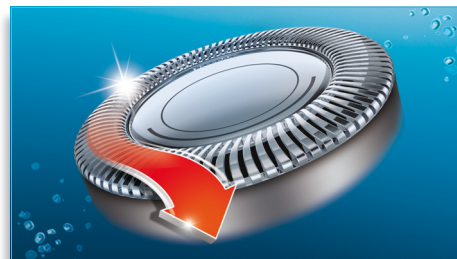

Rounded low-friction heads adjust to the contours of your face to limit skin irritation.

## SkinGlide system

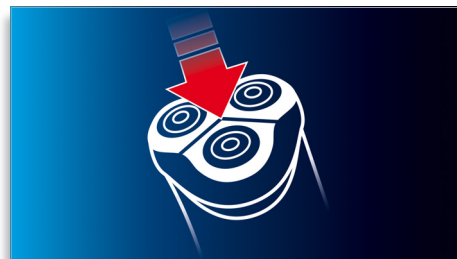

The low-friction SkinGlide shaving surface slides smoothly along your skin for a close, easy shave.

## Pivoting and Flexing Heads



Flexing heads stay in close contact with your skin, while the pivoting neck adds an extra dimension of movement – all giving you a close, fast, and comfortable shave.

## TripleTrack heads



TripleTrack heads with three shaving tracks cover 50% more skin surface at a time., while comfortably shaving both long hair and stubble.

## Water-resistant

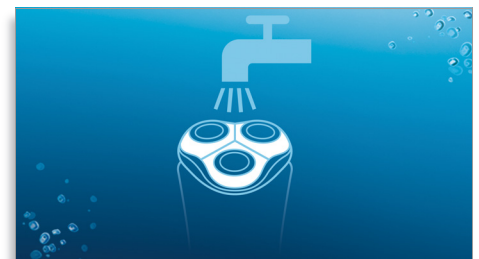

For easy cleaning, and wet & dry use

# Specifications

## Accessories

- Maintenance: Cleaning brush, Protection cap
- Pouch: Travel pouch
- Stand: Charging stand

## Ease of use

- Shaving minutes: 60+
- Shaving time: Up to 21 days
- Display: 1 LED indication, Battery full indication, Battery low indication, Charging indication, Quick

charge indication

## Service

- Replacement head: Replace every yr with HQ9

## Shaving Performance

- Contour-following: Dynamic contour response, Pivoting and Flexing heads
- Shaving System: Super Lift&Cut, TripleTrack heads
- Styling: Integrated pop up trimmer



Issue date 2013-03-29

Version: 2.1.1

© 2013 Koninklijke Philips Electronics N.V.  
All Rights reserved.

Specifications are subject to change without notice.  
Trademarks are the property of Koninklijke Philips  
Electronics N.V. or their respective owners.

[www.philips.com](http://www.philips.com)