

Register your product and get support at
www.philips.com/welcome

HTS9810



EN	DVD Home Theatre System	5
ES_LA	Sistema Home Theatre DVD	53
PT_BR	DVD Home Theater System	101

PHILIPS

Es necesario que lea cuidadosamente su instructivo de manejo.



Descripción: Reproductor de Disco de Video Digital
 Modelo: HTS9810
 Alimentación: 120 V / 230 V~50-60 Hz Switchceable
 Consumo: 120 W
 Importador: Philips Mexicana, S.A. de C.V.
 Domicilio: Av. La Palma No. 6,
 Col. San Fernando, La Herradura
 Huixquilucan, Edo de Mexico
 C.P. 52784, Mexico
 Localidad y Tel.: Tel. 52 69 90 00
 Exportador: Philips Electronics HK, Ltd.
 País de Origen: China

Nº de Serie: _____

LEA CUIDADOSAMENTE ESTE INSTRUCTIVO
 ANTES DE USAR SU APARATO.

AVISO IMPORTANTE

Philips Mexicana, S.A. de C.V. no se hace responsable por daños o desperfectos causados por:

- *Maltrato, descuido o mal uso, presencia de insectos o roedores (cucarachas, ratones etc.).*
- *Cuando el aparato no haya sido operado de acuerdo con el instructivo del uso, fuera de los valores nominales y tolerancias de las tensiones (voltaje), frecuencia (ciclaje) de alimentación eléctrica y las características que deben reunir las instalaciones auxiliares.*
- *Por fenómenos naturales tales como: temblores, inundaciones, incendios, descargas eléctricas, rayos etc. o delitos causados por terceros (choques asaltos, riñas, etc.).*

'CONSUMERS SHOULD NOTE THAT NOT ALL HIGH DEFINITION TELEVISION SETS ARE FULLY COMPATIBLE WITH THIS PRODUCT AND MAY CAUSE ARTIFACTS TO BE DISPLAYED IN THE PICTURE. IN CASE OF 525 OR 625 PROGRESSIVE SCAN PICTURE PROBLEMS, IT IS RECOMMENDED THAT THE USER SWITCH THE CONNECTION TO THE 'STANDARD DEFINITION' OUTPUT. IF THERE ARE QUESTIONS REGARDING OUR TV SET COMPATIBILITY WITH THIS MODEL 525p AND 625p DVD PLAYER, PLEASE CONTACT OUR CUSTOMER SERVICE CENTER.'

NOTE: This equipment has been tested and found to comply with the limits for a Class B digital device, pursuant to Part 15 of the FCC Rules. These limits are designed to provide reasonable protection against harmful interference in a residential installation. This equipment generates, uses and can radiate radio frequency energy and, if not installed and used in accordance with the instructions, may cause harmful interference to radio communications. However, there is no guarantee that interference will not occur in a particular installation.

If this equipment does cause harmful interference to radio or television reception, which can be determined by turning the equipment off and on, the user is encouraged to try to correct the interference by one or more of the following measures:

- Reorient or relocate the receiving antenna.
- Increase the separation between the equipment and receiver.
- Connect the equipment into an outlet on a circuit different from that to which the receiver is connected.
- Consult the dealer or an experienced radio/TV technician for help.

“Evite o uso prolongado do aparelho com volume superior a 85 decibéis pois isto poderá prejudicar a sua audição.”

Nível de Decibéis	Exemplos
30	Biblioteca silenciosa, sussurros leves
40	Sala de estar, refrigerador, quarto longe do trânsito
50	Trânsito leve, conversação normal, escritório silencioso
60	Ar condicionado a uma distância de 6 m, máquina de costura
70	Aspirador de pó, secador de cabelo, restaurante ruidoso
80	Tráfego médio de cidade, coletor de lixo, alarme de despertador a uma distância de 60 cm
OS RUIDOS ABAIXO PODEM SER PERIGOSOS EM CASO DE EXPOSIÇÃO CONSTANTE	
90	Metrô, motocicleta, tráfego de caminhão, cortador de grama
100	Caminhão de lixo, serra elétrica, furadeira pneumática
120	Show de banda de rock em frente às caixas acústicas, trovão
140	Tiro de arma de fogo, avião a jato
180	Lançamento de foguete



Manufactured under license from Dolby Laboratories. Dolby, Pro Logic and the double-D symbol are trademarks of Dolby Laboratories.



Manufactured under license under U.S. Patent #'s: 5,451,942; 5,956,674; 5,974,380; 5,978,762; 6,487,535 & other U.S. and worldwide patents issued & pending. DTS and DTS Digital Surround are registered trademarks and the DTS logos and Symbol are trademarks of DTS, Inc. © 1996-2007 DTS, Inc. All Rights Reserved.



DivX, DivX Ultra Certified, and associated logos are trademarks of DivX, Inc. and are used under license.

Official DivX® Ultra Certified product.

Plays all versions of DivX ® video (including DivX ® 6) with enhanced playback of DivX® media files and the DivX® Media Format.



Windows Media and the Windows logo are trademarks, or registered trademarks of Microsoft Corporation in the United States and/or other countries.



HDMI, and HDMI logo and High-Definition Multimedia Interface are trademarks or registered trademarks of HDMI licensing LLC.



The USB-IF Logos are trademarks of Universal Serial Bus Implementers Forum, Inc.



'DCDi' is a trademark of Faroudja, a division of Genesis Microchip, Inc.



ENERGY STAR and the ENERGY STAR mark are registered U.S. marks

LASER

- Type Semiconductor laser GaAlAs
- Wave length 650 - 660 nm (DVD)
784 - 796 nm (CD)
- Output Power 1.46 mW (DVD)
160 uW (CD)
- Beam divergence 60 degrees

Contents

1 Important	6
Safety and important notice	6
2 Your product	7
Features highlight	7
Product overview	8
3 Connect	11
Place the unit	11
Connect video cables	12
Connect junction box	14
Connect rear wireless speakers	14
Connect front and centre speakers to subwoofer	15
Connect radio antenna	15
Connect audio cables/other devices	16
Mount the DVD Home Theatre unit	18
4 Get started	19
Prepare the remote control	19
Find the correct viewing channel	20
Start Ambisound setup	20
Turn on Progressive Scan	22
Optimise wireless transmission	23
Adjust speakers output	24
Activate EasyLink control	25
Select a play source	26
5 Play	27
Play from disc	27
Play video	28
Play music	31
Play photo	32
Play from USB device	33
Play from portable media player	34
Play from radio	34
6 Adjust sound	37
Control the volume	37
Adjust Bass/Treble	37
Select Ambisound	37
Select a preset sound effect	38
7 Adjust settings	39
General setup	39
Audio setup	41
Video setup	43
Preference Setup	46
8 Additional information	48
Update software	48
Care	48
Specifications	49
9 Troubleshooting	50
10 Glossary	52

1 Important

Safety and important notice

Warning!

Risk of fire or electric shock!

- Ensure that air can circulate freely through the ventilation holes on this unit. Allow at least 5~10 cm clearance around the unit.
- Never place this unit, remote control or batteries near naked flames or other heat sources, including direct sunlight.
- Never place this unit on other electrical equipment.
- Keep away from this unit during lightning storms.
- Never remove the casing of this unit. Please leave all maintenance work to qualified personnel.
- Keep this unit away from water, moisture and liquid-filled objects.

Caution!

- Remove batteries if they are exhausted or if the remote control is not to be used for a long time.
- Do not mix batteries (old and new or carbon and alkaline, etc.).
- Batteries contain chemical substances, they should be disposed of properly.
- Visible and invisible laser radiation when open. Avoid exposure to beam.
- Where the MAINS plug or an appliance coupler is used as the disconnect device, the disconnect device shall remain readily operable.

Recycle notice

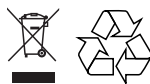

This electronic equipment contains a large number of materials that can be recycled or reused if disassembled by a specialised company. If you are disposing of an old machine, please take it to a recycling centre. Please observe the local regulations regarding disposal of packaging materials, exhausted batteries and old equipment.

Copyright notice



This product incorporates copyright protection technology that is protected by method claims of certain U.S. patents and other intellectual property rights owned by Macrovision Corporation and other rights owners. Use of this copyright protection technology must be authorised by Macrovision Corporation, and is intended for home and other limited viewing uses only unless otherwise authorised by Macrovision Corporation. Reverse engineering or disassembly is prohibited.

2 Your product

Congratulations on your purchase, and welcome to Philips! To fully benefit from the support that Philips offers, register your product at www.philips.com/welcome.

This DVD Home Theatre is designed to complement your home perfectly. Enjoy the DVD Home Theatre with 9.1 multi-channel surround sound and excellent picture quality.

Features highlight

Video upscaling to 1080p

You can now watch the DVDs in the highest picture quality available for your HDTV. This DVD Home Theatre offers full high-definition video playback up to 1080p resolution for an amazing viewing experience. A highly detailed picture and increased sharpness delivers a more true-to-life picture.

EasyLink

EasyLink uses the HDMI CEC (Consumer Electronics Control) industry standard protocol to share functionality with all HDMI CEC compliant devices over HDMI. It enables the connected devices to control each other with a single remote control.



Note

- Philips does not guarantee 100% interoperability with all HDMI CEC devices.

Ambisound

Philips Ambisound technology reproduces multi-channel surround sound with fewer speakers to give an embracing surround experience without the hassle of setting up a full range of speaker systems.

USB direct and MP3 link

Simply plug your USB device into the USB socket to play your MP3/WMA/JPEG/DivX files; or plug your portable media player to the MP3 LINK socket to enjoy the music play in superb sound quality.

Sync the audio output with the video play

This DVD Home Theatre provides you the feature of delaying the audio output if the video signals that go directly to the TV is slower than the audio streams.

Region codes

DVD movies are usually not released at the same time in all regions of the world, thus all DVD players are programmed to a specific region code.

Countries	DVD region code	
Asia Pacific, Taiwan, Korea		
Australia, New Zealand		
China		
India		

Product overview

Remote control

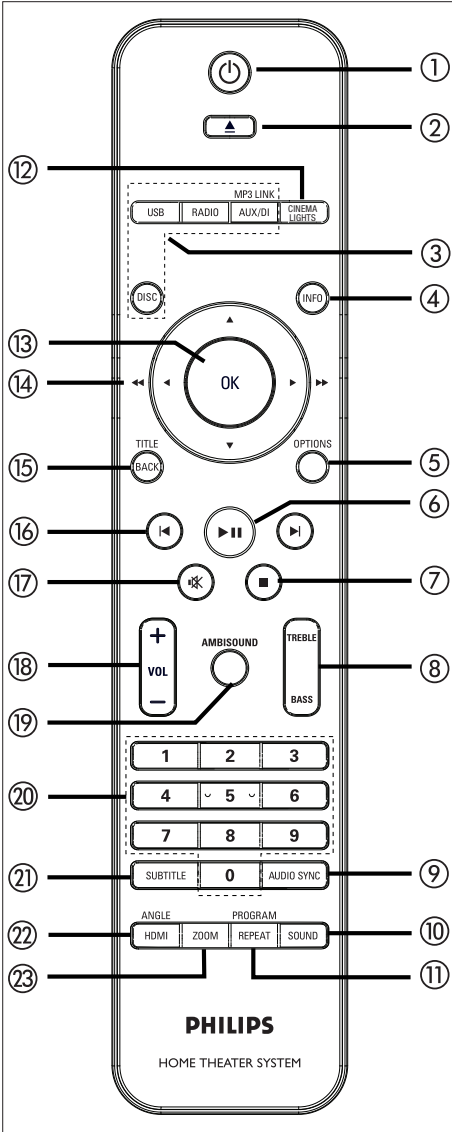

- ①
 - Turn on this unit or turn off to standby mode.
 - Press and hold to turn off this unit and all the HDMI CEC compliant TV/ devices (for EasyLink control only).
- ② (Eject)
 - Eject or pull in the disc.
- ③ **Source buttons**
 - **DISC**: switch to DISC mode. While in disc mode, access or exit disc menu.
 - **USB**: switch to USB mode.
 - **RADIO**: switch to FM or AM/MW band.
 - **AUX/DI /MP3 LINK**: switch to AUX 1-2-3 INPUT, OPTICAL INPUT 1-2, COAXIAL INPUT or MP3 LINK that corresponds to the socket you used to connect the external device.
- ④ **INFO**
 - Display the current status or disc information.
 - Display photo files in 12 thumbnails view.
- ⑤ **OPTIONS**
 - Access or exit Options menu (this menu provides various setting options).
- ⑥ (Play/Pause)
 - Start or pause disc play.
 - **RADIO**: start auto radio installation (only available for first time setup).
- ⑦ (Stop)
 - Stop disc play.
 - **RADIO**: press and hold to erase the current preset radio station.

- ⑧ **TREBLE / BASS**
- Switch to treble or bass mode. Then press **VOL + -** to set its level setting.
- ⑨ **AUDIO / SYNC**
- Select an audio language/channel.
 - Press and hold to access audio sync setting. Then press **VOL + -** to set the audio delay time.
 - **RADIO**: toggle between FM stereo and mono mode.
- ⑩ **SOUND**
- Select a predefined sound effect.
- ⑪ **REPEAT / PROGRAM**
- Select various repeat or shuffle modes; turns off repeat or shuffle mode.
 - **RADIO**: press this button to start manual radio preset.
 - **RADIO**: press and hold this button to start automatic radio preset.
- ⑫ **CINEMA LIGHTS**
- Turn on/off the lights on the speaker stands to create the cinema ambiance if the cinema light is enabled.
 - Press and hold to enable or disable cinema lights feature.
- ⑬ **OK**
- Confirm an entry or selection.
- ⑭ **Cursor buttons (▲ ▼ ◀ ▶)**
- Navigate through the on-screen menu.
 - Press left or right for fast backward or forward search.
 - **RADIO**: press up or down to tune the radio frequency.
 - **RADIO**: press left or right to start auto search.
- ⑮ **BACK / TITLE**
- Return to the previous display menu.
 - For DVD, go to title menu.
 - For VCD version 2.0 or SVCD with PBC turned on: return to the menu during playback.
- ⑯ **◀ / ▶ (Previous/Next)**
- Skip to the previous or next title/ chapter/track.
 - **RADIO**: select a preset radio station.
- ⑰ **✖ (Mute)**
- Mute or restore the volume.
- ⑱ **VOL + -**
- Adjust the volume level.
- ⑲ **AMBISOUND**
- Select different types of surround sound output.
- ⑳ **Numeric buttons**
- Enter a preset number or item to play.
- ㉑ **SUBTITLE**
- Select DVD or DivX subtitle language.
- ㉒ **HDMI / ANGLE**
- Select a video resolution setting for HDMI output.
 - Press and hold to select a different viewing angle of a DVD movie.
- ㉓ **ZOOM**
- Zoom in or out the picture on the TV.

Main unit

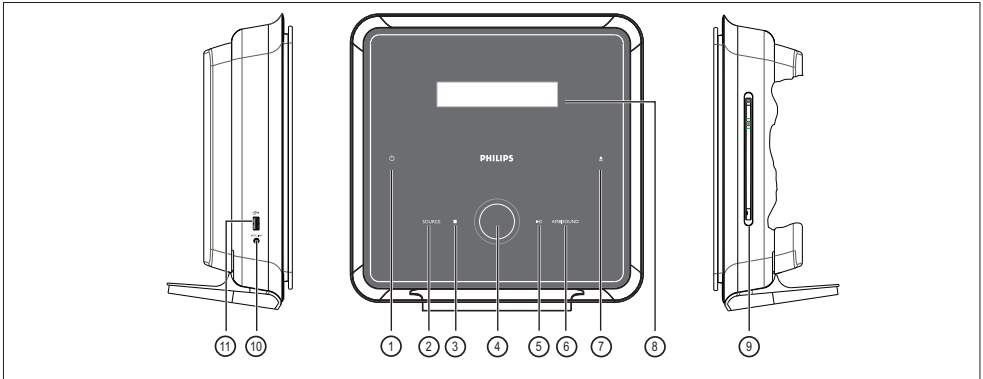

① (Standby)

- Turn on this unit or turn off to standby mode.
- Press and hold to turn on this unit from low power standby mode.

② SOURCE

- Select a play media: DISC, USB, RADIO FM, RADIO AM/MW, OPTICAL INPUT 1-2, COAXIAL INPUT, AUX 1-2-3 INPUT or MP3 LINK.

③ (Stop)

- Stop disc play.
- **RADIO:** press and hold to erase the current preset radio station.

④ Volume control

- Adjust the volume level.

⑤ (Play/Pause)

- Start or pause disc play.
- **RADIO:** start auto radio installation (only available for first time setup).

⑥ AMBISOUND

- Select different types of surround sound output.

⑦ (Eject)

- Eject or pull in the disc.

⑧ Display panel

Right side panel

⑨ Disc compartment

Left side panel

⑩ MP3 LINK socket

- To connect portable audio player.

⑪ (USB) socket

- To connect USB flash drive, USB memory reader or digital camera.



Tip

- Control buttons on this DVD Home Theatre unit are operated through touch screen display. The control displays will be dimly lit after one second of inactivity.
- To change the brightness of the touch screen display, see chapter 'Adjust settings' - [**General Setup**] > [**Display Dim**].

3 Connect

This section describes the basic connections required for this DVD Home Theatre unit before it can be used.

Basic connections:

- Place the unit
- Connect video cables
- Connect junction box
- Connect rear wireless speakers
- Connect front and centre speakers to subwoofer
- Connect radio antenna

Optional connections:

- Connect audio cables/other devices
 - Connect audio from TV
 - Connect audio from cable box/recorder/game console
 - Connect portable media player
 - Connect USB device
- Mount the DVD Home Theatre unit

Note

- Refer to the type plate at the rear or bottom of the product for identification and supply ratings.
- Before you make or change any connections, ensure that all the devices are disconnected from the power outlet.

Place the unit

You can place the main unit on top of a table or mount it on the wall.

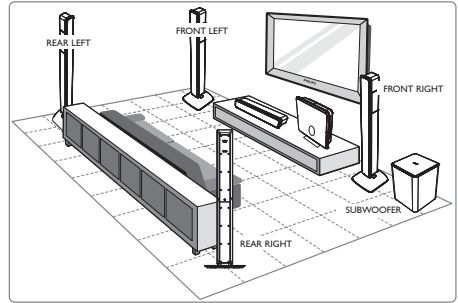

- 1 Place this DVD Home Theatre unit near to the TV.
- 2 Place the speaker system as per the diagram shown above.
 - Find the most suitable placement based on your room layout and set up to ensure optimum sound performance.
- 3 Place the subwoofer at the corner of the room or at least one metre away from the TV.
- 4 Place the junction box behind the TV, shelf or table.
 - Use the supplied velcro strip for fixing purpose.

Note

- Rear speakers are labelled as REAR LEFT / RIGHT.
- Front speakers are labelled as FRONT LEFT / RIGHT.
- To avoid magnetic interference or unwanted noise, never place the speakers too close to the TV or any radiation devices.
- Install this unit near the AC outlet where the AC power plug can be easily reached.

Connect video cables

This section describes how to connect this DVD Home Theatre unit to your TV so to enable viewing of disc play.

Select the best video connection that your TV can support.

- **Option 1:** Connect to HDMI socket (for a HDMI, DVI or HDCP-compliant TV).
- **Option 2:** Connect to component video socket (for a standard TV or Progressive Scan TV).
- **Option 3:** Connect to Video (CVBS) socket (for a standard TV).

Note

- You must connect this unit directly to a TV.

Option 1: Connect to HDMI socket

- 1 Before you connect, remove the rear cover of the main unit by pushing it upwards and outwards.

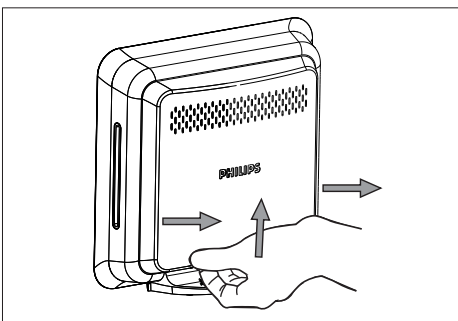

- 2 Connect a HDMI cable (supplied) from the **HDMI OUT** on this unit to the HDMI IN socket on your TV.

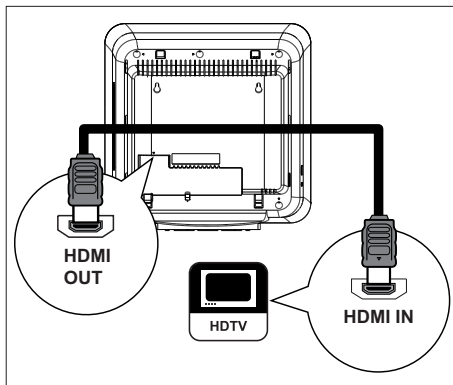

Note

- The HDMI connector is only compatible with HDMI compliant TVs and DVI-TVs.

Tip

- To optimise the video output, see chapter 'Adjust settings' > [**Video Setup**] > [**Advanced Picture**] for details.
- This unit is HDMI CEC compatible. It enables connected TV/device to control each other over HDMI, see chapter 'Activate EasyLink control' for details.
- Use a HDMI/DVI adaptor in case your TV has only a DVI connection. An extra audio connection is needed to complete this connection.
- To route the audio from your TV to this DVD Home Theatre unit, connect an audio cable from the audio input on this unit to the audio output on your TV.
- This type of connections provide best picture quality.

Option 2: Connect to component video socket

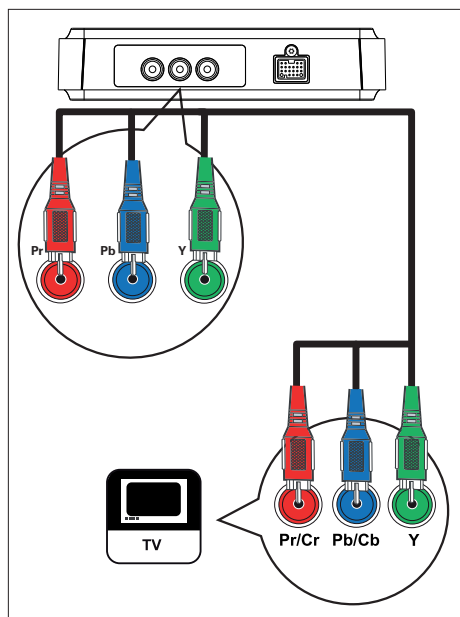

1 Connect the component video cables (not supplied) from the **Y Pb Pr** sockets on this unit to the component video input sockets on your TV.

- If a progressive scan TV is used, you may turn on the progressive scan mode (see chapter 'Turn on Progressive Scan' for details).

Tip

- The component video input socket on your TV may be labelled as Y Pb/Cb Pr/Cr or YUV.
- This type of connections provide good picture quality.

Option 3: Connect to Video (CVBS) socket

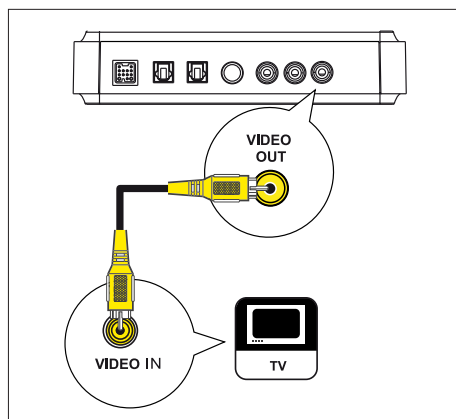

1 Connect a composite video cable (supplied) from the **VIDEO OUT** socket on this unit to the video input socket on your TV.

Tip

- The video input socket on your TV may be labelled as A/V IN, VIDEO IN, COMPOSITE or BASEBAND.
- This type of connections provide standard picture quality.

Connect junction box

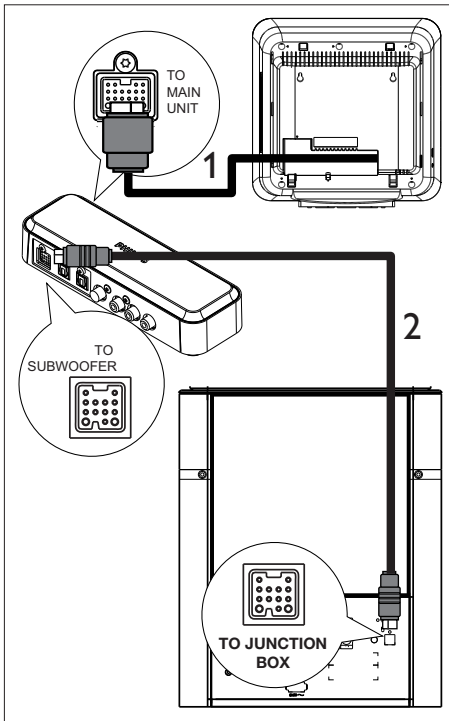

- 1 Unwind the DC cable from the main unit and connect it to the **TO MAIN UNIT** socket on the junction box.
 - Once complete, close the main unit rear cover.
- 2 Connect interconnect cable between **TO SUBWOOFER** socket on the junction box and **TO JUNCTION BOX** socket on the subwoofer.

Connect rear wireless speakers

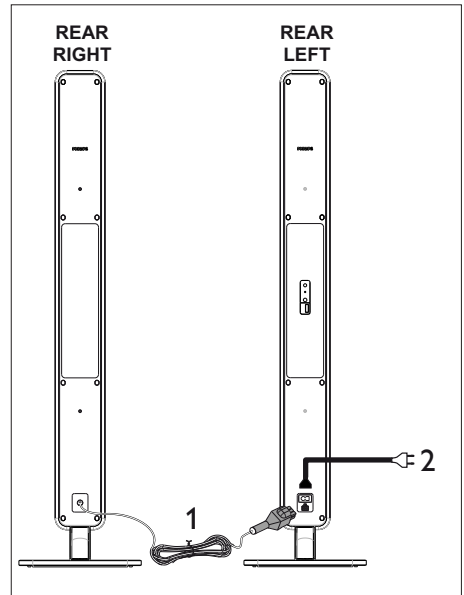

- 1 Connect the cable from the right rear speaker to the left rear speaker socket.
- 2 Connect the power cord from the left rear speaker to the power outlet when all the required connections are complete.

Connect front and centre speakers to subwoofer

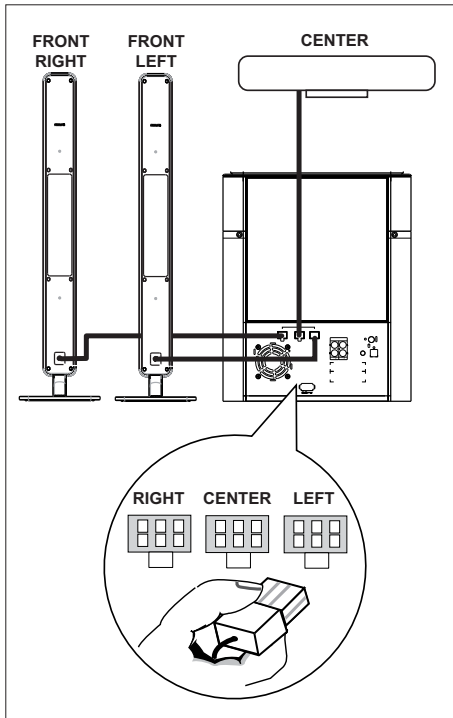

- 1 Connect the centre, left front and right front speakers to the matching sockets on the subwoofer.

Note

- Ensure that the front portion of the plug is fully inserted into the socket.
- To disconnect the Ambisound speakers, press down the catch on the plug before pulling out.

Connect radio antenna

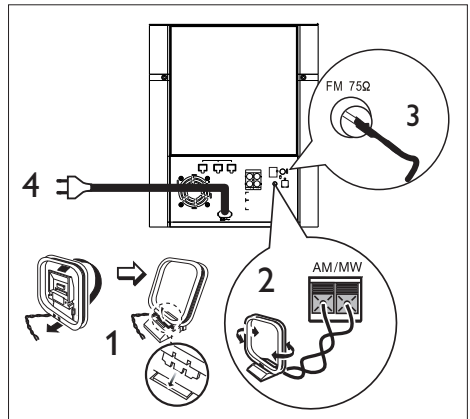

- 1 Stand the AM/MW loop antenna (supplied) upright to fix its claw into the slot.
- 2 Connect the AM/MW loop antenna to the **AM/MW** socket. Then place the AM/MW loop antenna on a shelf, or attach it to a stand or wall.
- 3 Connect the FM antenna (supplied) to the **FM75Ω** socket on the subwoofer (for some models, this cable has been connected). Extend the FM antenna and fix its ends to the wall.
- 4 Connect the power cord when all the required connections are complete and you are ready to enjoy this DVD Home Theatre unit.

Note

- Before connect to power outlet, ensure that the voltage selector (at the rear of this unit) is set to the local power line voltage.

Connect audio cables/other devices

This section describes how you can route the sound from other devices to this DVD Home Theatre unit in order to enjoy sound output or audio play with multi-channel surround capabilities.

Connect audio from TV (also used for EasyLink control)

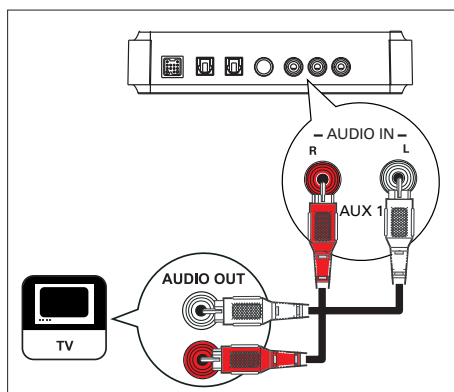

- 1 Connect an audio cable (not supplied) from the **AUDIO IN-AUX1** sockets on the junction box to the **AUDIO OUT** sockets on your TV.

Note

- To listen to the audio output from this connection, press **AUX/DI /MP3 LINK** repeatedly until 'AUX1 INPUT' is displayed on the display panel.

Connect audio from cable box/ recorder/game console

You can choose to connect to analogue or digital socket depending on the device capabilities.

Connect to analogue sockets

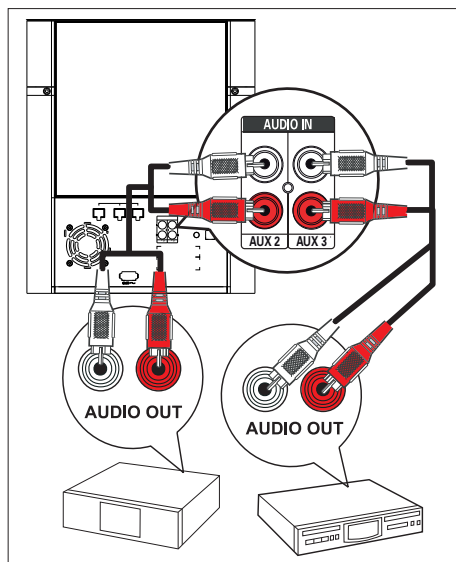

- 1 Connect an audio cable (not supplied) from the **AUDIO IN-AUX2** or **AUX3** sockets on the subwoofer to the **AUDIO OUT** sockets on the device.

Note

- To listen to the audio output from this connection, press **AUX/DI /MP3 LINK** repeatedly until 'AUX2 INPUT' or 'AUX3 INPUT' is displayed on the display panel.

Connect to digital/optical socket

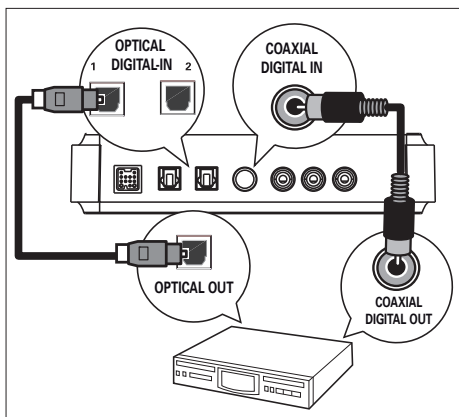

- 1 Connect a coaxial cable (not supplied) from the **COAXIAL DIGITAL IN** socket on the junction box to the **COAXIAL/DIGITAL OUT** socket on the device.



Note

- To listen to the audio output from this connection, press **AUX/DI /MP3 LINK** repeatedly until 'COAXIAL INPUT' is displayed on the display panel.

or

- 1 Connect an optical cable (not supplied) from the **OPTICAL DIGITAL IN 1 or 2** socket on the junction box to the **OPTICAL OUT** socket on the device.



Note

- To listen to the audio output from this connection, press **AUX/DI /MP3 LINK** repeatedly until 'OPTICAL INPUT 1' or 'OPTICAL INPUT 2' is displayed on the display panel.

Connect portable media player

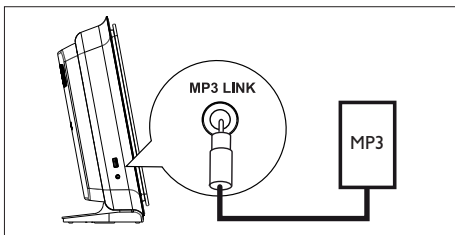

- 1 Connect a 3.5mm stereo audio cable (supplied) from the **MP3 LINK** socket on this unit to the phone socket on your portable media player (such as MP3 player).



Note

- To listen to the audio output from this connection, press **AUX/DI /MP3 LINK** repeatedly until 'MP3 LINK' is displayed on the display panel.

Connect USB device

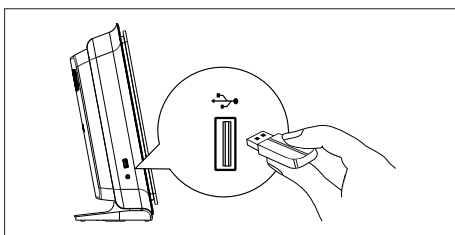

- 1 Connect the USB device to **↔ (USB)** socket on this unit.



Note

- This DVD Home Theatre unit can only play/view MP3, WMA/WMV9, DivX (Ultra) or JPEG files that are stored on such devices.
- To listen to the audio output from this connection, press **USB**.

Mount the DVD Home Theatre unit



Caution!

- Risk of personal injury and damage to the unit. Allow only qualified persons to mount the unit.

- 1 Pull up the catch to remove the main unit rear cover.

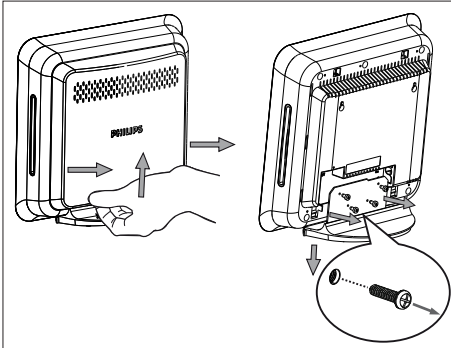

- 2 Remove the screws and detach the DVD Home Theatre stand.
- 3 Place two screws on the wall.
 - The distance between two screws is 15cm.
- 4 Hook the DVD Home Theatre unit firmly onto the screws, slide through the key holes to lock into position.

4 Get started

Prepare the remote control

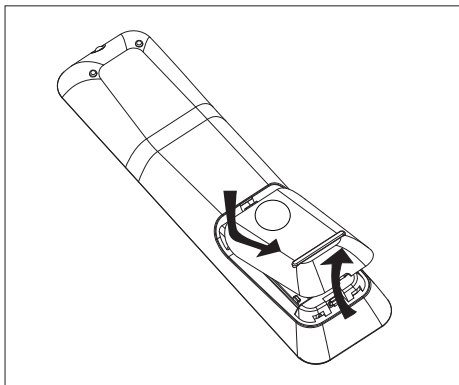

- 1 Push to open the battery compartment cover.
- 2 Insert two batteries type R03 or AAA. Match the indications (+ -) inside the battery compartment.
- 3 Close the cover.



Note

- If you are not going to use the remote control for a long time, remove the batteries.

Control a play source



- 1 Select the source you wish to control by pressing the **DISC**, **USB**, **RADIO** or **AUX/DI/MP3 LINK** button.
- 2 Then select the desired function (for example **◀**, **▶**).

Navigate through the menu

- 1 Point the remote control directly at the remote sensor on this unit and select the desired function.
- 2 Use the following buttons on the remote control to navigate through the on-screen menus.

Button	Action												
▲ ▼	Move up or down.												
◀ ▶	Move left or right.												
OK	Confirm a selection.												
<table border="1"><tr><td>1</td><td>2</td><td>3</td></tr><tr><td>4</td><td>5</td><td>6</td></tr><tr><td>7</td><td>8</td><td>9</td></tr><tr><td colspan="3">0</td></tr></table>	1	2	3	4	5	6	7	8	9	0			Enter numbers.
1	2	3											
4	5	6											
7	8	9											
0													

Find the correct viewing channel

- 1 Press  to turn on the DVD Home Theatre unit.
- 2 Press **DISC** to switch to disc mode
- 3 Turn on the TV and switch it to the correct video-in channel.
 - You may go to the lowest channel on your TV, then press the Channel Down button on your TV's remote control until you see the Video In channel.
 - You may press  button repeatedly on your TV's remote control.
 - Usually this channel is between the lowest and highest channels and may be called FRONT, AV IN, VIDEO, etc..



Tip

- See TV's user manual on how to select the correct input on your TV.

Start Ambisound setup

When you turn on this unit for the first time, follow the instructions on the TV to complete the Ambisound setup in order to obtain the best possible surround sound effect.



Note

- Before you start, ensure that you have made all the required connections.
- Complete the Ambisound setup for this unit before you insert a disc to play.

- 1 Press **DISC** to switch to disc mode
- 2 Turn on the TV and switch it to the correct video-in channel.
 - ↳ Language menu is displayed.

OSD Language

Please choose your language:

- English
- Español
- Português

 Stop: Exit  Change  Select

- 3 Select a language for on-screen display, then press .
 - ↳ A welcome message is displayed.

Welcome

The next few steps will help you set up your Home Theater System to match your listening environment.

To optimize the Ambisound surround effect for your home, please begin with this simple setup.

 Stop: Exit  Continue

- To skip the Ambisound setup, press  to exit.

- 4 Press  to continue.
↳ [**Room Acoustics**] menu is displayed.

Room Acoustics

Please select the type of walls that surround your room:

- Hard (Concrete, wood)
- Soft (Curtains, open space)

 Back  Change  Select

- 5 Select the condition of the room, then press .
↳ [**Rear Speaker Placement**] menu is displayed.



Rear Speaker Placement

Select the placement of the rear speakers in your room:

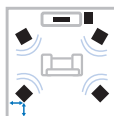
- Against both wall (<0.5m)
- Against both wall (>0.5m)
- Against side wall (>0.5m)
- Against back wall (>0.5m)



 Back  Change  Select

- 6 Select the rear speakers placement in the room, then press .
- 7 The speaker setting is complete, press  to exit.

This DVD Home Theatre unit is now ready for use.



Tip

- To change the menu display language, see chapter 'Adjusting settings' - [**General setup**] > [**OSD Language**] for details.
- If you connect this unit to a HDMI CEC compliant TV using a HDMI cable, it switches automatically to the menu display language as per your TV setting.

Turn on Progressive Scan

If you connect this unit to TV with the component video connection (see chapter 'Connect video cables - Option 2: Connect to component video jack' for details), you can turn on the progressive scan output if your TV supports progressive scan.

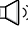
- 1 Turn on the TV to the correct viewing channel for this unit.
- 2 Press **DISC**.
- 3 Press **OPTIONS**.
- 4 Press **▼** to select  [**Video Setup**] in the menu, then press **▶**.

Video Setup		
	TV Type	On
	TV Display	Off
	Picture Settings	
	Advanced Picture	
	Closed Caption	
	Progressive	
		

- 5 Select [**Progressive**] > [**On**], then press **OK**.
↳ A warning message is displayed.
- 6 To proceed, select [**OK**] in the menu and press **OK**.
↳ The progressive setup is complete.

Note

- If a blank/distorted screen is displayed, wait for 15 seconds for the auto recover.
- If no picture displayed, turn off the progressive scan mode as follows:
 - 1) Press **▲** to open the disc compartment.
 - 2) Press **▶**.
 - 3) Press **SUBTITLE**.

- 7 To exit the menu, press **OPTIONS**.
- 8 You can now turn on the progressive scan mode on your TV (see the TV user manual).

Note

- There are some progressive scan TVs that are not fully compatible with this unit, resulting in an unnatural picture when playing back a DVD VIDEO disc in the progressive scan mode. In such case, turn off the progressive scan feature on this unit and your TV.





Optimise wireless transmission

After connecting the speakers and subwoofer, you can adjust the wireless settings to optimise the wireless performance.

Note

- Before you start, ensure that the left rear speaker and subwoofer are connected to the power outlets.
- The wireless receiver is built into the left rear speaker and the transmitter is built into the subwoofer.
- For optimum wireless transmission, ensure that there is no obstructions between the left rear speaker and subwoofer.

- 1 Press **DISC**.
- 2 Press **OPTIONS**.
- 3 Press **▼** to select  [**Audio Setup**] in the menu, then press **►**.

Audio Setup		
	Ambisound Setup	Pair Receiver
	HDMI Audio	Switch Channel
	Speaker Volume	
	Speaker Delay	
	Night Mode	
	Wireless	
		

- 4 Select [**Wireless**] > [**Pair Receiver**], then press **OK**.
- 5 Press and hold **CONNECT** on the left rear speaker to start pairing the receiver to the transmitter.
 - ↳ The light flashes while in pairing mode.
 - ↳ A confirmation message is displayed once the pairing process is complete.
 - Pairing has to be done within 30 seconds and audio is muted during this process.

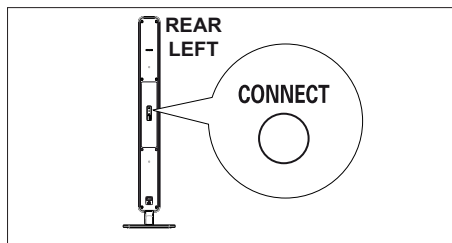

- 6 Press **OK** to confirm and exit.

Change the frequency channel

You can change the frequency channel of this wireless system if the transmission signal is interfering with other wireless devices/networks in your home.

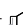
- 1 Press **OPTIONS**, then select  [**Audio Setup**].
- 2 Select [**Wireless**] > [**Switch Channel**], then press **OK**.





Options	Descriptions
[Auto]	It selects the best channel to operate automatically.
[Channel A]	Frequency corresponding to Wi-Fi channel 1.
[Channel B]	Frequency corresponding to Wi-Fi channel 6.
[Channel C]	Frequency corresponding to Wi-Fi channel 11.

- 3 Press **▲▼** to select a setting, then press **OK**.
- 4 To exit the menu, press **OPTIONS**.

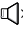
Adjust speakers output

Ideally the distance between listening position and all the speakers should be the same. If not, change the speaker settings based on their distance from the listening position in order to obtain the best possible surround sound.







- 1 Press **DISC**.
- 2 Press **OPTIONS**.
- 3 Press **▼** to select  [**Audio Setup**] in the menu, then press **▶**.

Audio Setup	
	Ambisound Setup
	HDMI Audio
	Speaker Volume
	Speaker Delay
	Night Mode
	Wireless
	

- You cannot access speaker setup options if this Home Theatre unit is not in a complete stop mode. In such case, press **■** twice.

To set the speakers volume level



- 4 Select [**Speakers Volume**] in the menu, then press **▶**.

Speakers Level Setup	
Front Left	 0dB
Front Right	 0dB
Center	 0dB
Subwoofer	 0dB
Rear Left	 0dB
Rear Right	 0dB

- 5 Press **◀▶** to adjust the volume level, then press **OK**.
 - ↳ The test tone is emitted from the speaker which you are adjusting.
 - Repeat the above setting for other speakers until all the speakers output level sounds equally balance.

To set the output delay time (centre and rear speakers only)

- 6 Select [**Speakers Delay**] in the menu, then press **▶**.

Speakers Delay Setup	
Center	 0ms
Rear Left	 0ms
Rear Right	 0ms

- 7 Press **◀▶** to set the delay time, then press **OK**.
 - Repeat the above setting for other speakers until the sound output from different speakers reach the listening position at the same time.
- 8 To exit the menu, press **OPTIONS**.

Tip

- Set longer delay time if the centre or rear speakers are closer to the listening position than the front speakers.
- 1ms setting for every 30cm distance between the speaker and the listening position.

Activate EasyLink control

This feature is only applicable if this unit is connected to HDMI CEC compliant TV/device. It enables all the linked devices response or react to certain commands simultaneously with one touch control.

- 1 Turn on the HDMI CEC operations on your TV and other connected devices. See TVs/devices manual for details.
- 2 You can now enjoy the EasyLink controls.

One touch play [Auto Wake-up TV]

When you press PLAY button, this unit will wake-up from standby mode and start disc play (if a video disc is found in the disc compartment) and it will also turn on your TV and switch to the correct viewing channel.

One touch power off [System Standby]

When you press and hold STANDBY button, it will turn off this unit and all the linked devices to standby.

This unit also responses to standby command from other HDMI CEC devices.

One touch audio input switching [System Audio Control]

This unit is able to render the audio signals from the active source. It switches automatically to the corresponding audio input and output the sound from its speaker system.

- Before you can enjoy this function, you have to map the audio inputs to the connected devices.
- You can use any HDMI CEC TV/device remote control to adjust the volume.

Note





- To enable one touch play function, a video disc must be placed in the disc compartment before operation.
- Philips does not guarantee 100% interoperability with all HDMI CEC compliant devices.

Map the audio inputs to the connected devices

Note



- Before you start, ensure that an audio connection has been made between this unit and your TV/ devices.

- 1 Press **DISC**.
- 2 Press **OPTIONS**.
↳ [**General Setup**] menu is displayed.
- 3 Press **▶**.
- 4 Select [**EasyLink**], then press **▶**.

General Setup		
	EasyLink	Auto Wake-up TV
	Disc Lock	System Standby
	Display Dim	System Audio Control
	OSD Language	Audio Input Mapping
	Screen Saver	
	Sleep Timer	
	Standby Mode	
	DivX(R) VOD Code	

- [**Auto Wake-up TV**] and [**System Standby**] functions are turned on by default in the factory.
- 5 Select [**System Audio Control**] > [**On**], then press **OK**.
 - 6 Select [**Audio Input Mapping**], then press **OK**.

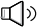
- 7 Select [**OK**] in the menu, then press **OK** to start scanning of devices.
 ↳ Once complete, audio input mapping menu is displayed.

Audio Input Mapping		
	AUX1 Input	TV
	AUX2 Input	Other (non-HDMI)
	AUX3 Input	
	Digital Input	
		
		

- For example, if your TV audio is connected to the AUX IN-AUX 1 sockets on this unit, select [**AUX1 Input**] and map with the TV (brand name) at the right panel.
- 8 Select the audio input of this unit that is used to connect to other HDMI device (e.g. AUX1 Input, AUX2 Input), then press **▶**.
- 9 Select the correct connected device, then press **OK**.
- Repeat steps 8~9 to map other connected devices.
- 10 To exit the menu, press **OPTIONS**.

Select a play source

On the main unit

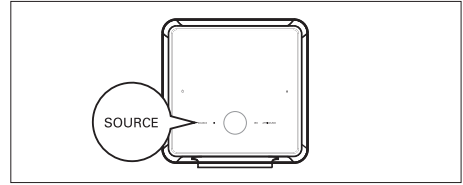

- 1 Press **SOURCE** repeatedly to select:
DISC > USB > RADIO FM > RADIO AM/MW > OPTICAL INPUT 1-2 > COAXIAL INPUT > AUX 1-2-3 INPUT > MP3 LINK > DISC ...

On the remote control

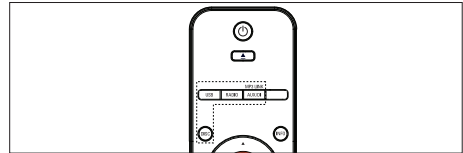

- Press **DISC** to switch to DISC mode.
- Press **USB** to switch to USB mode.
- Press **RADIO** to switch to FM or AM/MW band.
- Press **AUX/DI /MP3 LINK** repeatedly to select other external devices.

Display	Device connected to
AUX1 INPUT	AUDIO IN-AUX1 sockets.
AUX2 INPUT	AUDIO IN-AUX2 sockets.
AUX3 INPUT	AUDIO IN-AUX3 sockets.
OPTICAL INPUT 1	OPTICAL DIGITAL IN-1 socket.
OPTICAL INPUT 2	OPTICAL DIGITAL IN-2 socket.
COAXIAL INPUT	COAXIAL DIGITAL IN socket.
MP3 LINK	MP3 LINK socket.

5 Play

Play from disc

Playable discs



DVD Video

- Region 3 (Asia Pacific, Taiwan, Korea)
- Region 4 (Australia, New Zealand)
- Region 6 (China)
- Region 5 (India)



DVD±RW (DVD Rewritable)



DVD±R (DVD Recordable)



DVD+R DL (DVD+R Double Layer)



CD-RW (CD-Rewritable)



CD-R (CD-Recordable)



Audio CD (Compact Disc Digital Audio)



Video CD

- Formats 1.0, 1.1, 2.0



Super Video CD



Note

- DVDs and DVD players are designed with regional restrictions. Ensure that the DVD video you play is for the same region zone as your player (indicated on its rear).
- This unit can support playback of the following file formats: MP3/WMA/JPEG/DivX/WMV9.
- About WMV9 - this unit only supports Main Profile (low level) and Simple Profile. Advanced Profile and DRM-protected video files are not supported.

Play a disc



Caution!

- Never place any objects other than discs into the disc compartment.
- Ensure ample space is available at the right hand side for ease of disc handling.

- 1 Insert a disc with its label facing out.
 - For double-sided disc, load the side to play faces out.
 - To view disc play, turn on the TV to the correct viewing channel for this DVD Home Theatre unit.
- 2 To stop disc play, press **■**.
- 3 To remove the disc, press **▲**.



Tip

- If the password entry menu is displayed, you have to enter the 4-digit password before it can be played.
- Screen saver displays automatically if the disc play is stopped for about 15 minutes. To wake up from screen saver, press **DISC**.
- This unit automatically switches to standby mode if you do not press any buttons within 30 minutes after a disc has stopped playing.
- The cinema lights on the speaker stands will gradually turn off when you start movie play. To turn it on, press **CINEMA LIGHTS**.

Play video



Note

- For video disc, playback always resumes from the point where it was last stopped. To start playback from the beginning, press **◀** while the message is displayed.

Control a title

- 1 Play a title.
- 2 Use the remote control to control the title.

Button	Action
	Pause/ resume play.
	Stop play.
	Jump to the next title/chapter.
	Return to the beginning of the current title/chapter or jump to the previous title/chapter.
	Search backward/ forward. <ul style="list-style-type: none">• To change search speed, press this button repeatedly.
	Slow motion reverse/ forward play. <ul style="list-style-type: none">• To change play speed, press this button repeatedly.• For VCD, only forward play is possible.

Change video play

- 1 Play a title.
- 2 Use the remote control to change the video play.

Button	Action
	Change audio language. <ul style="list-style-type: none">• Only applicable to discs with multiple audio language or channel.
	Change subtitle language. <ul style="list-style-type: none">• Only applicable to discs with multiple subtitle language.
	Toggle through various repeat/shuffle play mode; or turn off repeat mode. <ul style="list-style-type: none">• Repeat options vary depending on the disc type.• For VCDs, repeat play is only possible when the PBC mode is turned off.
	Zoom in/out. <ul style="list-style-type: none">• To pan through the zoomed image, press the cursor buttons.
	Display current play status. <ul style="list-style-type: none">• You can change the video play options here without interrupting disc play.
	Press and hold to view DVD play from different camera angles. <ul style="list-style-type: none">• Only applicable to DVDs that contain sequences recorded from different camera angles.

Access DVD menu

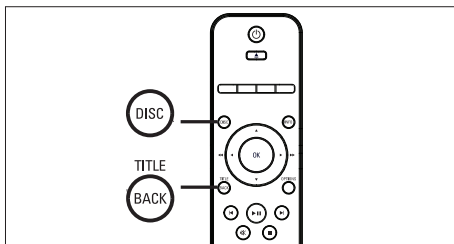

- 1 Press **DISC** to access disc main menu.
- 2 Select a play option, then press **OK**.
 - In some menus, press **number buttons** to input your selection.
 - To return to the title menu during playback, press **TITLE**.

Access VCD menu

The PBC (Playback Control) for VCD is turned on by default in the factory. When you load in a VCD, the contents menu is displayed.

- 1 Press **▲▼** to select a play option, then press **OK** to start play.
 - If PBC is off, it skips the menu and starts play from the first title.
 - During playback, you can press **BACK** to return to the menu (if the PBC mode is on).



Tip

- The default setting for PBC is on. To change the default setting, see chapter 'Adjust settings' - [**Preference Setup**] > [**PBC**] for details.

Sync audio output with video play

If the video play is slower than the audio output (sound does not match with the pictures,) you can delay the audio output to match the video.

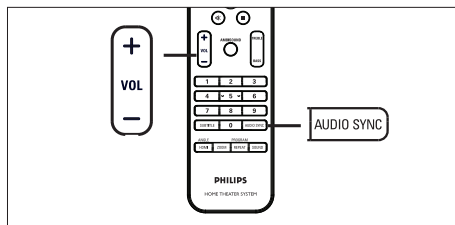

- 1 Press and hold **AUDIO / SYNC** until 'AUDIO SYNC XXX' is displayed.
 - 'XXX' denotes the delay time.
- 2 Within five seconds, press **VOL + -** to set the delay time for audio output.



Note

- If the volume control is not used within 5 seconds, it resumes normal volume control function.

Quick skip play to a specific time

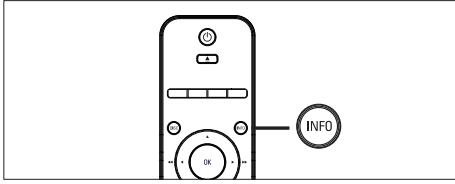





- 1 During playback, press **INFO**.
↳ The disc status menu is displayed.
- 2 Select the current elapsed playing time in the menu, then press **OK**.
 - [**TT Time**] (title time)
 - [**CH Time**] (chapter time)
 - [**Disc Time**] (disc time)
 - [**Track Time**] (track time)
- 3 Press the **number buttons** to change the time where you want to skip to, then press **OK**.

Play DivX® video

DivX video is a digital media format that retains high quality despite a high rate of compression. This unit is DivX® Certified that allows you to enjoy DivX video.

- 1 Insert a disc or USB that contains the DivX videos.
- 2 Press **DISC** or **USB**.
↳ A contents menu is displayed.
- 3 Select a title to play, then press **▶||**.
- 4 Use the remote control to control the title.

Button	Action
	Change subtitle language.
	Change audio language/track.
	Stop play. <ul style="list-style-type: none">• For DivX Ultra video, press this button again to display the contents menu.
	Display DivX Ultra video information.

Note

- Only those DivX videos that were rented or purchased using the DivX registration code of this unit can be played (see chapter 'Adjust settings' > [**General Setup**] > [**DivX(R) VOD Code**] for details).
- If the subtitle does not appear correctly, change the subtitle language (see chapter 'Adjust settings' - [**Preference Setup**] > [**DivX Subtitle**] for details).
- The subtitle can only be displayed up to an average of 45 characters.
- This unit can play DivX video files that are up to 4GB in size.

Play music



Note

- For some commercial audio disc, playback may resume from the point where it was last stopped. To start playback from first track, press **◀**.

Control a track

- 1 Play a track.
- 2 Use the remote control to control the track.

Button	Action
	Pause/ resume play.
	Stop play.
	Jump to the next track.
	Return to the beginning of the current track or jump to the previous track.
	Direct input the track number.
	Search backward/ forward. <ul style="list-style-type: none"> • To change search speed, press this button repeatedly.
	Toggle through various repeat/ shuffle play mode; or turn off repeat mode. <ul style="list-style-type: none"> • Repeat options vary depending on the disc type.

Play MP3/WMA music

MP3/WMA is a type of highly compressed audio file (files with .mp3 or .wma extensions).

- 1 Insert a disc or USB that contains the MP3/WMA music.
- 2 Press **DISC** or **USB**.
 - ↳ A contents menu is displayed.
- 3 Select a folder, then press **OK**.
- 4 Select a track to play, then press **▶||**.
 - To return to the main menu, press **▲** until 'Previous' folder is selected, then press **OK**.



Note

- For CDs recorded in multiple sessions, only the first session is played.
- This unit does not support MP3PRO audio format.
- If any special characters are present in the MP3 track name (ID3) or album name, it might not be displayed correctly on the screen because these characters are not supported.
- Some WMA is protected by Digital Rights Management (DRM), it cannot be played on this unit.
- Folders/files exceed the supported file limit of this unit will not be displayed or played.



Tip

- To display the data disc contents without folders, see chapter 'Adjust settings' - **[Preference Setup] > [MP3/JPEG Nav]** for details.

Play photo

Play photos as slideshow

This unit can play JPEG photos (files with .jpeg or .jpg extensions).

- 1 Insert a disc or USB that contains the JPEG photos.
- 2 Press **DISC** or **USB**.
 - ↳ For a Kodak disc, the slideshow begins automatically.
 - ↳ For a JPEG disc, the photo menu is displayed.
- 3 Select the folder/album you want to play.
 - To preview the photos in the folder/album, press **INFO**.



- To go to previous or next screen display, press **◀** / **▶**.
 - To select a photo, press the cursor buttons.
 - To display the selected photo only, press **OK**.
- 4 Press **▶||** to start slideshow play.
 - To return to the menu, press **BACK**.

Note

- It may require longer time to display the disc contents on the TV due to the large number of songs/photos compiled onto one disc.
- If the JPEG photo is not recorded with an 'exif' type file, the actual thumbnail picture will not be shown on the display. It will be replaced with a 'blue mountain' thumbnail picture.
- This unit can only display digital camera pictures according to the JPEG-EXIF format, typically used by almost all digital cameras. It cannot display Motion JPEG and pictures in formats other than JPEG, or sound clips associated with pictures.
- Folders/files exceed the supported file limit of this unit will not be displayed or played.

Control photo play

- 1 Play photo slideshow.
- 2 Use the remote control to control the photo.

Button	Action
◀	Skip to the previous photo.
▶	Skip to the next photo.
▲	Rotate the photo clockwise.
▼	Rotate the photo anti-clockwise.
ZOOM	Zoom in/ out. <ul style="list-style-type: none">• Play will pause while in zoom mode.
◻	Stop play.

Play musical slideshow

Play MP3/WMA music files and JPEG photo files simultaneously to create musical slideshow. The MP3/WMA and JPEG files must be stored on the same disc or USB device.

- 1 Play MP3/WMA music.
- 2 Navigate to the photo folder/album and press **▶||** to start slideshow play.
 - ↳ Slideshow begins and continues till the end of the photo folder or album.
 - ↳ Audio continues to play till the end of the disc.
 - To return to the menu, press **BACK**.
- 3 To stop slideshow play, press **■**.
- 4 To stop music play, press **■** again.

Play from USB device

This unit can only play/view MP3, WMA/WMV9, DivX (Ultra) or JPEG files that are stored on such devices.

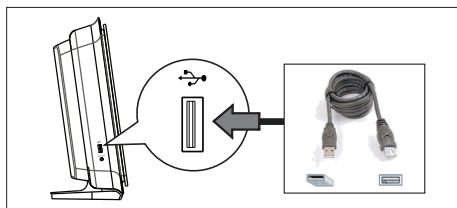

- 1 Connect USB flash drive or USB memory card reader to the **USB** socket on this unit.
- 2 Press **USB**.
 - ↳ A contents menu is displayed.
- 3 Select a file to play, then press **▶||**.
 - For more information, see chapters 'Play music, Play photo, Play video' for details.
- 4 To stop play, press **■** or remove the USB device.



Tip

- If the device does not fit into the USB socket, connect it through a USB extension cable.
- If a multiple USB card reader is used, only one of the connected USB drive contents can be accessed.
- If a USB HDD is used, ensure that an auxiliary power cord connected to the USB HDD for proper operations.
- Digital cameras that use PTP protocol or require additional programme installation when connected to a PC are not supported.

Play from portable media player

Simply connect your portable media player (e.g. MP3 player) to this unit to enjoy superb sound quality from your music collections.

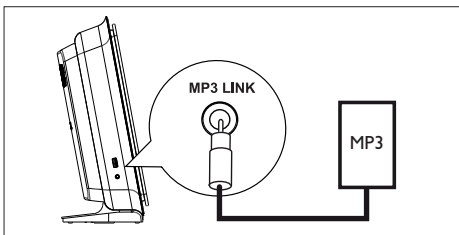

- 1 Connect a 3.5mm stereo audio cable (supplied) from the **MP3 LINK** socket on this unit to the 'headphone' socket on your portable media player.
- 2 Press **AUX/DI /MP3 LINK** repeatedly until 'MP3 LINK' is displayed.
- 3 Start play on your portable media player.
 - See chapter 'Adjust Sound' to enhance the audio output.
- 4 To stop play, press **STOP** button on your portable media player.

Note

- Control playback is only possible on your portable media player.
- Stop play on the portable media player before you switch to other play media/source.

Play from radio

Check if the FM antenna has been connected to the subwoofer. If not, connect the supplied FM antenna to the FM 75Ω socket and fix its ends to the wall.

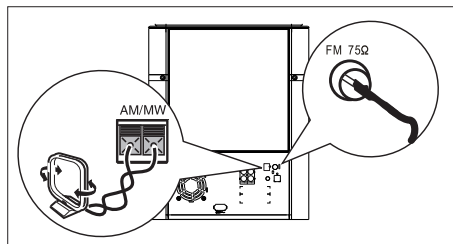

Note

- For China/Latin America region only, if you want to receive AM/MW radio band, connect the AM/MW loop antenna (supplied) to the AM/MW sockets on the subwoofer.

Tip

- For better FM stereo reception, connect an external FM antenna (not supplied).
- Position the antenna as far away as possible from your TV, VCR or other radiation source to prevent unwanted interference.

First time tuning

The first time when you access 'RADIO' mode, follow the instructions to install the radio stations.

- 1 Press **RADIO**.
↳ 'AUTO INSTALL ... PRESS PLAY' is displayed.
- 2 Press **▶||**.
↳ All detected radio stations are stored.
↳ Once complete, it tunes to the first preset radio station.
 - To stop auto tuning, press **■**.



Note

- This unit can store up to a maximum of 40 radio stations (and 20 radio stations from AM/MW band).
- If auto installation is not activated or less than 5 radio stations are stored, 'AUTO INSTALL' will be displayed again the next time you turn on to radio mode.

Listen to radio

- 1 Press **RADIO** repeatedly to select 'FM' or 'AM/MW' band.
- 2 Use the remote control to control the radio.

Button	Action
	Select a preset radio station.
	Tune the radio frequency backward/ forward.
	Toggle between FM stereo and FM mono mode.
	Press and hold this button to delete the preset station from the preset list. <ul style="list-style-type: none"> • The preset number for other radio stations remain unchanged

Reinstall all the radio stations

- 1 Press **RADIO** repeatedly to select 'FM' or 'AM/MW' band.
- 2 Press and hold **PROGRAM** until 'STARTING INSTALL' is displayed.
↳ All previously stored radio stations will be replaced.



Note

- If no stereo signal is detected or less than 5 stations are detected during radio installation, 'CHECK ANTENNA' is displayed.

Search and store radio stations individually

- 1 Press **RADIO** repeatedly to select 'FM' or 'AM/MW' band.
- 2 Press **◀▶**.
↳ The radio frequency indication starts to change until a radio station is detected.
- 3 Repeat step 2 until you tune to the radio station you wish to store.
 - To finetune the radio frequency, press **▲▼**.
- 4 Press **PROGRAM**.
 - If no action is carried out within 20 seconds after the above step, it exits the preset mode.
- 5 Press **◀▶** (or the **number buttons**) to select a preset number to store.
- 6 Press **PROGRAM** to confirm.

Change tuning grid

In some countries, the frequency step between adjacent channels in FM band is 50 kHz or 100 kHz (AM/MW band is 9 kHz or 10 kHz).



Note

- This feature only applicable for certain region.
- Change tuning grid erases all preset radio stations.

- 1 Press **RADIO** repeatedly to select 'FM' or 'AM/MW' band.
- 2 Press **■**.
- 3 Press and hold **▶||** until 'GRID 9' or 'GRID 10' is displayed.
 - 'GRID 9' for FM 50 kHz (or AM 9 kHz) and 'GRID 10' for FM 100 kHz (or AM 10 kHz).

6 Adjust sound

Control the volume

- 1 Press **VOL + -** to increase or decrease the volume level.
 - To mute the volume, press **MUTE**.
 - To restore the volume, press **MUTE** again or press the volume button.

Adjust Bass/Treble

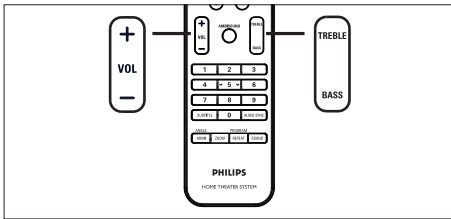

- 1 Press **BASS / TREBLE**.
- 2 Press **VOL + -** repeatedly to set the level for low (**BASS**) or high (**TREBLE**) tone.

Note

- If the volume control is not used within 10 seconds, it resumes normal volume control function.

Select Ambisound

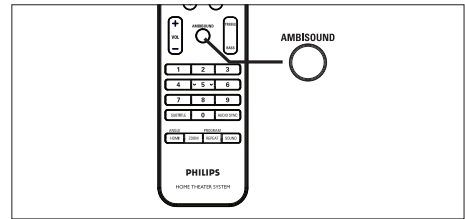

- 1 Press **AMBISOUND** repeatedly to select a best Ambisound output that most suits the video or music you play.

DVD/Multi-channel source

AMBISOUND 9.1 (default setting)	9.1 multi-channel output with embracing Ambisound. Ideal for maximised movie experience.
MULTI-CHANNEL 5.1	5.1 multi-channel output for a standard movie experience.
AMBISOUND STEREO 9.1	Duplicate Ambisound stereo to front and rear speakers. Ideal for a party.
AMBISOUND STEREO	Enhanced stereo sound from your two front speakers.

CD/Stereo source

STEREO (default setting)	Stereo sound from your two front speakers.
AMBISOUND STEREO	Enhanced stereo sound from your two front speakers.
AMBISOUND STEREO 9.1	Duplicate Ambisound stereo to front and rear speakers. Ideal for a party.
MULTI-CHANNEL 9.1	Create a multi-channel movie experience from stereo/VCD sources.

Select a preset sound effect

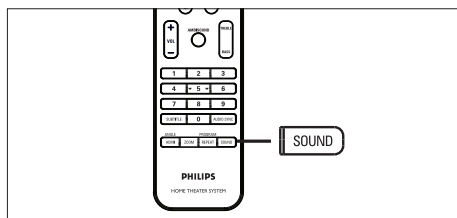





- 1 Press **SOUND** repeatedly to select a sound effect that most suits the video or music you play.

Video / Music /	Descriptions
ACTION / ROCK /	Enhanced low and high range for great sounding movie effects and atmosphere. Great for action movies and rock/pop music.
DRAMA / JAZZ	Clear mid and high range. Recreates the atmosphere of a live club with the artist just in front of you. Good for Jazz music and watching dramas.
CONCERT / CLASSIC	Flat and pure sound mode. Ideal for listening to classical music and watching live concert DVDs.
GAMING / PARTY	Slightly enhanced low range and strong mid range ideal for party music and video gaming.
SPORTS	Moderate mid range and surround effects for clear vocals and the atmosphere of a live sports venue.
NEWS	Enhanced mid range for clear vocals/speech.



7 Adjust settings

This section describes the various setting options of this unit.

Symbol	Options
	[General Setup]
	[Audio Setup]
	[Video Setup]
	[Preference Setup]

General setup

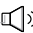
- 1 Press **OPTIONS**.
↳ [**General Setup**] menu is displayed.
- 2 Press **▶**.
- 3 Select an option, then press **OK**.

General Setup	
	EasyLink
	Disc Lock
	Display Dim
	OSD Language
	Screen Saver
	Sleep Timer
	Standby Mode
	DivX(R) VOD Code

- See the explanations of the above options in the following pages.
- 4 Select a setting, then press **OK**.
 - To return to the previous menu, press **BACK**.
 - To exit the menu, press **OPTIONS**.

[EasyLink]

This feature is only applicable if this unit is connected to HDMI CEC compliant TV/ device. It enables all the linked devices response or react to certain commands simultaneously with one touch control.

Options	Descriptions
[Auto Wake-up TV]	It wake-ups your TV automatically when you press PLAY to power up this unit and start disc play (if a video disc is found in the disc compartment). <ul style="list-style-type: none"> • To disable this feature, select [Off].

[System Standby]	Respond to standby command from other HDMI CEC compliant TV/devices. <ul style="list-style-type: none"> • To disable this feature, select [Decline].
---------------------------	--

[System Audio Control]	It enables this DVD Home Theatre unit to switch automatically to the audio input of the active device. <ul style="list-style-type: none"> • To enable this feature, select [On]. Then proceed to [Audio Input Mapping] to scan and map all the connected devices.
---------------------------------	--

-
- [Audio Input Mapping]** Map the audio input to the connected TV/ devices correctly to enable automatic switching of input source.
1. Press **OK** to start scanning of devices.
 2. Select the audio input to map (e.g. AUX1 Input, AUX2 Input), then press **▶**.
 3. Select the correct device that connected to this audio input, then press **OK**.
-



Note

- Your TV and other connected devices must be compliant with HDMI CEC.
- You must turn on the HDMI CEC operations on your TV/devices before you can enjoy the EasyLink controls. See your TVs/devices manual for details.
- Philips does not guarantee 100% interoperability with all HDMI CEC compliant devices.

[Disc Lock]

Set play restriction for a specific discs. Before you start, place the disc in the disc compartment (maximum 40 discs can be locked).

- **[Lock]** – restrict access to the current disc. The next time you want to play this disc or unlock it, you need to enter the password.
- **[Unlock]** – all discs can be played.



Tip

- To set or change your password, go to **[Preference Setup] > [Password]**.

[Display Dim]

Change the brightness level of the display panel to suit the lighting in your room.

- **[100%]** – normal brightness.
- **[70%]** – medium brightness.
- **[40%]** – dimmest display.

[OSD Language]

Select the default on-screen menu language.

[Screen Saver]

Turn off or on the screen saver mode. It helps to protect the TV screen from being damage due to over exposure to a static image for too long.

- **[On]** – set the screen saver to appear after 15 minutes of inactivity (for example, in pause or stop mode).
- **[Off]** – disable screen saver mode.

[Sleep Timer]

Switch to standby automatically after the preset time.

- **[Off]** – disable sleep mode.
- **[15, 30, 45, 60 mins]** – select the count down time before it switches to standby.

[Standby Mode]

Set the standby mode.

- **[Normal]** – normal standby power consumption.
- **[Low Power]** – low standby power consumption. However, it requires longer time to power up.

[DivX(R) VOD Code]





Display the DivX® registration code.

Tip

- Enter this unit's DivX registration code when you rent or purchase video from www.divx.com/vod. The DivX videos rented or purchased through the DivX® VOD (Video On Demand) service can be played only on the device to which it is registered.

Audio setup

- 1 Press **OPTIONS**.
↳ [**General Setup**] menu is displayed.
- 2 Press ▼ to select  [**Audio Setup**], then press ►.
- 3 Select an option, then press **OK**.

Audio Setup	
	Ambisound Setup
	HDMI Audio
	Speaker Volume
	Speaker Delay
	Night Mode
	Wireless
	

- 4 Select a setting, then press **OK**.
 - To return to the previous menu, press **BACK**.
 - To exit the menu, press **OPTIONS**.

[Ambisound Setup]

Change the Ambisound setup by selecting the room environment and rear speakers placement.



Tip

- See chapter 'Get Started - Start Ambisound setup' for detailed information.

[HDMI Audio]

When you connect this unit and TV with HDMI cable, select the audio output setting for this connection.

- [**On**] – the sound is output through both your TV and this speaker system. If the audio format on the disc is not supported, it will be downmixed to two-channel sound (linear-PCM).
- [**Off**] – disable audio output from your TV. The sound is only output through this speaker system.

[Speakers Volume]

When all the speakers are not placed in an equal distance from the listening position, change the volume level of the speakers so that for those placed closer to the listening position will not sound too loud.

1. To start, press **OK**.
2. Select a speaker in the menu, then press ◀ ▶ to adjust the volume level.
3. Press **OK** to confirm and exit.



Tip

- The test tone is emitted from the speaker while adjusting volume level.

[Speakers Delay]

When the centre or rear speakers are placed closer to the listening position than the front speakers, set the delay time for these speakers so that the sound outputs from all speakers reach the listening position at the same time.

1. To start, press **OK**.
2. Select a speaker in the menu, then press ◀ ▶ to set the delay time.
3. Press **OK** to confirm and exit.



Tip

- 1ms setting for every 30cm distance between the speaker and the listening position.

[Night Mode]

Make loud sound level softer and soft sound level louder so that you can watch the DVD movies at a low volume, without disturbing others.

- [**On**] – for quiet viewing at night (DVDs only).
- [**Off**] – enjoy surround sound with a full dynamic range.

[Wireless]

Set up the wireless system for the rear speakers to enable audio output in multichannel mode.

- [**Pair Receiver**] – pair the receiver (in the left rear speaker) with the transmission signal code of the transmitter (in the subwoofer).



1. To start, press **OK**.
2. Press **CONNECT** on the left rear speaker for 3 seconds.
3. When pairing process is complete, press **OK** to confirm and exit.

- [**Switch Channel**] – switch to another frequency channel to minimise interference with other wireless devices in the room.

Options	Descriptions
[Auto]	It selects the best channel to operate automatically.
[Channel A]	Frequency corresponding to Wi-Fi channel 1.
[Channel B]	Frequency corresponding to Wi-Fi channel 6.
[Channel C]	Frequency corresponding to Wi-Fi channel 11.

Video setup

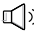
- 1 Press **OPTIONS**.
↳ [**General Setup**] menu is displayed.
- 2 Press ▼ to select  [**Video Setup**], then press ►.
- 3 Select an option, then press **OK**.

Video Setup	
	TV Type
	TV Display
	Picture Settings
	Advanced Picture
	Closed Caption
	Progressive

- See the explanations of the above options in the following pages.

- 4 Select a setting, then press **OK**.
 - To return to the previous menu, press **BACK**.
 - To exit the menu, press **OPTIONS**.

[TV Type]

Change this setting only if the video does not appear correctly. By default, this setting matches the most common setting for TVs in your country.

- [**PAL**] – for PAL-system TV.
- [**NTSC**] – for NTSC-system TV.
- [**Multi**] – for TV that is compatible with both PAL and NTSC.

[TV Display]

Select the screen format according to how you want the picture to appear on your TV.

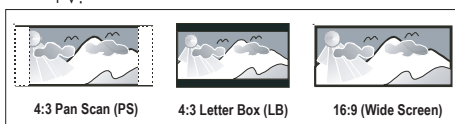

- [**4:3 Pan Scan**] – for standard TV, a full-height screen display with the sides trimmed.
- [**4:3 Letter Box**] – for standard TV, a 'wide-screen' display with black bars on the top and bottom.
- [**16:9 Wide Screen**] – for wide-screen TV (frame ratio 16:9).

[Picture Settings]

Select a predefined set of picture colour settings or customise your personal setting.

- [**Standard**] – original colour setting.
- [**Bright**] – vibrant colour setting.
- [**Soft**] – warm colour setting.
- [**Personal**] – customise the colour setting. Set the level of brightness, contrast, tint and colour saturation in the menu, then press **OK**.

[Advanced Picture]

This is an advanced setting to optimise the video output. This option is only applicable for video connection through HDMI or Component Video with Progressive Scan output.

- [**DCDi**] – Turn on or off Directional Correlation Deinterlacing feature. It fills the missing lines to optimise video content. It is especially effective during slow motion play.

Note

- DCDi setting is only available for progressive scan output.

- [**Gamma**] – Adjust picture intensity. Positive values bring out the detail in dark scenes, while negative values emphasise contrast.
- [**Chroma Delay**] – Adjust the colour of an image element (pixel) to produce a perfect and clear picture.
- [**True Life**] – Increase the contrast and colour intensity to produce a more dynamic picture.

Note

- To adjust the above settings, select an option and press **OK**. Then press cursor left or right to change the value/level setting and press **OK** to confirm.

- [**Wide Screen Format**] – define the wide screen format for disc play.

Options	Descriptions
[Superwide]	Centre position of the screen is stretched less than the side. This setting is only applicable if the video resolution is set to 720p or 1080i/p.
[4:3 Pillar Box]	No stretching of the picture. Black bars are displayed on both sides of the screen.
[Off]	Picture will be displayed according to the format of the disc.



Note

- This setting is only available if you have set the [**TV Display**] setting to [**16:9 Wide Screen**].

- [**HDMI Video**] – select a video resolution that is compatible with your TV display capability.

Options	Descriptions
[Auto]	It detects and selects the best supported video resolution automatically.
[480p, 576p, 720p, 1080i, 1080p]	Select a video resolution that best supported by your TV. See your TV's manual for details.



Note

- If the setting is not compatible with your TV, a blank screen appears. Wait for 15 seconds for auto recover or press **HDMI** repeatedly until the picture appears.

[**Closed Caption**]

(for certain region only)

Turn on or off display captions.

- [**On**] – show the sound effects in subtitle. Only applicable to disc with Closed Caption information included and your TV supports this feature.
- [**Off**] – disable closed caption.

[**Progressive**]

If your TV can support progressive signals, you can activate the progressive scan mode of this unit.

- [**On**] – turn on progressive scan mode.
- [**Off**] – disable progressive scan mode.







Tip

- See chapter 'Get Started - Turn on Progressive Scan' for detailed information.

Preference Setup

- 1 Press **OPTIONS**.
↳ [**General Setup**] menu is displayed.
- 2 Press ▼ to select  [**Preference Setup**], then press ►.
- 3 Select an option, then press **OK**.

Preference Setup	
	Audio
	Subtitle
	Disc Menu
	Parental
	PBC
	MP3/JPEG Nav
	Password
	DivX Subtitle ▼

- See the explanations of the above options in the following pages.
- 4 Select a setting, then press **OK**.
 - To return to the previous menu, press **BACK**.
 - To exit the menu, press **OPTIONS**.

[Audio]

Select the default audio language for DVDs.

[Subtitle]

Select the default subtitle language for DVDs.

[Disc Menu]

Select the menu language for DVDs.

Note

- If the language you have set is not available on the disc, the disc uses its own default language.
- For some DVDs, the subtitle/audio language can only be changed from the disc menu.
- To select the languages that are not listed in the menu, select [**Others**]. Then check the Language Code list at the back of this user manual and enter the respective 4-digit language code.

[Parental]

Restrict access to DVDs that are unsuitable for your children. These types of DVDs must be recorded with ratings.

1. To start, press **OK**.
2. Select a rating level in the menu, then press **OK**.
3. Press the **number buttons** to enter your 4-digit password.

Note

- Rated DVDs above the level you set in [**Parental**] require a password to be played.
- The ratings are country-dependent. To allow all discs to play, select '8'.
- Some DVDs have ratings printed on them but are not recorded with ratings. This function has no effect on such DVDs.

Tip

- To set or change your password, go to [**Preference Setup**] > [**Password**].

[PBC]

For VCDs/SVCDs recorded with PBC (playback control,) you can access the disc contents through an interactive menu.

- **[On]** – an index menu is displayed when you load a disc for play.
- **[Off]** – skip the menu and start play from the first title.

[MP3/JPEG Nav]

Turn off or on MP3/WMA folder display when you play a media that contains MP3/WMA files.

- **[With Menu]** – display the folders of MP3/WMA files.
- **[Without Menu]** – display all the files.

[Password]

Follow the instructions on the TV to set or change the password for locked discs and play restricted DVDs.

Change Password	
Old Password	<input type="password"/>
New Password	<input type="password"/>
Confirm PWD	<input type="password"/>
<input type="button" value="OK"/>	

1. Press the **number buttons** to enter '0000' or your last set 4-digit password at **[Old Password]** field.
2. Enter the new password at **[New Password]** field.
3. Enter the new password again at **[Confirm PWD]** field.
4. Press **OK** to exit the menu.

**Note**

- If you forget your 4-digit password, enter '0000' before you set a new password.

[DivX Subtitle]

Select a character set that supports the DivX subtitle.

[Standard]	English, Irish, Danish, Estonian, Finnish, French, German, Italian, Portuguese, Luxembourgish, Norwegian (Bokmål and Nynorsk), Spanish, Swedish, Turkish
[Central Europe]	Polish, Czech, Slovak, Albanian, Hungarian, Slovene, Croatian, Serbian (Latin script), Romanian
[Cyrillic]	Belarusian, Bulgarian, Ukrainian, Macedonian, Russian, Serbian

**Note**

- Ensure that the subtitle file has the exact same file name as the movie file. If for example the filename of the movie is 'Movie.avi', then you will need to name the text file 'Movie.sub' or 'Movie.srt'.

[Version Info]

Display the software version of this unit.

**Tip**

- This information is required when you want to find out if a newest software version is available at the Philips website that you may download and install on this unit.

[Default]

Reset all the settings of this unit to factory default, except for **[Disc Lock]**, **[Password]** and **[Parental]** settings remain unchanged.





8 Additional information

Update software

Philips provides software updates to ensure that this unit is compatible with the newest formats.

To check the updates, compare the current software version of this unit with the latest software version available at the Philips website.

- 1 Press **OPTIONS**.

Preference Setup	
	Disc Menu ▲
	Parental
	PBC
	MP3/JPEG Nav
	Password
	DivX Subtitle
	Version Info
	Default

- 2 Select [**Preference Setup**] > [**Version Info**], then press **OK**.
- 3 Write down the version number, then press **OPTIONS** to exit the menu.
- 4 Go to www.philips.com/support to check the latest software version available for this unit.
- 5 If the latest software version is higher than the software version of this unit, download it and store onto a CD-R or USB flash drive

- 6 Connect the software update cable (supplied) between SOFTWARE UPDATE socket on the left rear speaker and subwoofer.
- 7 Insert the CD-R or USB flash drive to this unit.
- 8 Press **DISC** or **USB**, then follow the instruction on the TV to confirm update operation.

Note

- Do not remove the CD-R or USB when software updating is in progress.

- 9 Once software update is complete, this unit turns off to standby automatically.

Note

- We recommend that you disconnect the power cord for a few seconds and connect again to reboot the system.

Care

Caution!

- Never use solvents such as benzene, thinner, cleaners available commercially, or anti-static sprays intended for discs.

Clean discs

Wipe the disc with a micro fibre cleaning cloth from the centre to the edge in a straight line movement.

Clean main unit screen

Wipe the screen surface with a micro fibre cleaning cloth.

Specifications



Note

- Specification and design are subject to change without notice.

Accessories supplied

- Quick Start Guide
- Remote control and batteries
- Composite video cable
- HDMI cable
- 3.5mm stereo audio cable
- Interconnect cable (connect between junction box and subwoofer)
- Software cable
- 2 power cables
- Subwoofer
- 1 centre, 2 front and 2 rear speakers
- Junction box
- Velcro tape (to fix the junction box)
- FM wire antenna / AM-MW loop antenna
- Round-to-Flat pin adaptor (for certain region only)
- Micro fibre cleaning cloth

Amplifier

- Total output power (Home Theatre): 800W RMS (10% THD)
- Frequency response: 20 Hz - 20 kHz / ± 3 dB
- Signal-to-noise ratio: > 65 dB (CCIR)

Disc

- Laser Type: Semiconductor
- Disc diameter: 12cm / 8cm
- Video decoding: MPEG1/ MPEG2 / DivX / DivX Ultra / WMV9
- Video DAC: 12 bits, 148 MHz
- Signal system: PAL / NTSC
- Video S/N: 56 dB
- Audio DAC: 24 bits / 192 kHz
- Frequency response: 4 Hz - 20 kHz (44.1 kHz)
4 Hz - 22 kHz (48 kHz)
4 Hz - 44 kHz (96 kHz)
- PCM: IEC 60958
- Dolby Digital, DTS: IEC60958, IEC61937

Wireless rear speakers

- Power supply: 110-127V / 220-240V, ~ 50 -60 Hz
For China: 220-240V, ~ 50 Hz
- Power consumption: 60 W
- Standby power consumption: < 0.5W

USB

- Compatibility: Hi-Speed USB (2.0)
- Class support: UMS (USB Mass Storage Class)

Radio

- Tuning range: FM 87.5-108 MHz (50/100 kHz),
MW 531-1602 kHz (9 kHz)
MW 530-1700 kHz (10 kHz)
- 26dB quieting sensitivity: FM 20 dBf, MW 4 μ V/m
- IF rejection ratio: FM 60 dB, MW 45 dB
- Signal-to-noise ratio: FM 60 dB, MW 40 dB
- Harmonic distortion: FM 3%, MW 5%
- Frequency response: FM 180 Hz - 10 kHz / ± 6 dB
- Stereo separation: FM 26 dB (1 kHz)
- Stereo Threshold: FM 23.5 dB

Power (Subwoofer)

- Power supply: 110-127V / 220-240V, ~ 50 -60 Hz
For China: 220-240V, ~ 50 Hz
- Power consumption: 120 W
- Standby power consumption
 - Normal: < 4 W
 - Low standby: < 0.3 W
- System: Bass Reflex System
- Impedance: 4 ohm
- Speaker drivers: 165 mm (6 1/2") woofer
- Frequency response: 35 Hz - 200 Hz
- Dimensions (WxHxD): 336 x 424.5 x 366 (mm)
- Weight: 12.7 kg

Main unit

- Dimensions (WxHxD): 304.2 x 309.8 x 130.1 (mm)
- Weight: 3.7 kg

Junction Box

- Dimensions (WxHxD): 168 x 37 x 65 (mm)
- Weight: 0.2 kg

Speakers

- System: full range satellite
- Speaker impedance: 4 ohm (centre),
6 ohm (Front/Rear)
- Speaker drivers:
 - Centre: 1x 2.5" woofer + 1x 1.5" tweeter
 - Front/Rear: 2x 2.5" woofer + 1x 1.5" tweeter
- Frequency response: 150 Hz - 20 kHz
- Dimensions (WxHxD):
 - Centre: 435.4 x 103.8 x 95.4 (mm)
 - Front/Rear: 275 x 1117.8 x 288 (mm)
- Weight:
 - Centre: 1.54 kg
 - Front/ Rear: 6.32 kg / 7.14 kg

9 Troubleshooting



Warning!

- Risk of electric shock. Never remove the casing of this unit.

To keep the warranty valid, never try to repair the system yourself.

If you encounter problems when using this unit, check the following points before requesting service. If the problem remains unsolved, register your product and get support at www.philips.com/welcome.

Main unit

The buttons on this unit do not work.

- Disconnect this unit from the power outlet for a few minutes, then connect again.
- Ensure that the interconnect cable from the subwoofer is connected to the DVD Home Theatre unit.

Picture

No picture.

- See TVs manual for correct video input channel selection. Change the TV channel until you see the DVD screen.
- Press **DISC**.
- If this happens when you change the TV type setting, you have to switch to its default mode:
 1. Press **▲** to eject the disc (if any).
 2. Press **◀** (for TV type).
 3. Press **SUBTITLE**.

No picture on HDMI connection.

- Check if the HDMI cable is faulty. Replace a new HDMI cable.
- If this happens when you change the HDMI video resolution, press **HDMI** repeatedly until the picture appears.

Sound

- | | |
|---|--|
| No sound. | <ul style="list-style-type: none"> • Ensure that the audio cables are connected and press the correct input source (for example, AUX/DI /MP3 LINK, USB) to select the device you want to play. |
| No sound on HDMI connection. | <ul style="list-style-type: none"> • You may not hear any sound from the HDMI output if the connected device is non-HDCP compliant or only DVI-compatible. • Ensure that the [HDMI Audio] setting is turned on. |
| No sound from TV programmes. | <ul style="list-style-type: none"> • Connect an audio cable from the AUDIO input on this unit to the AUDIO output on your TV. Then press AUX/DI /MP3 LINK repeatedly to select the corresponding audio input source. |
| Interference on rear wireless speakers or existing wireless network in your home. | <ul style="list-style-type: none"> • Switch to another frequency channel. <ol style="list-style-type: none"> 1. Press OPTIONS. 2. Select [Audio Setup] > [Wireless] > [Switch Channel] in the menu, then press OK. 3. Select a channel option, then press OK. |
| No sound from rear wireless speakers. | <ul style="list-style-type: none"> • Check if all the connections to the wireless speakers are properly connected and connect the power cable. • Press AMBISOUND to turn on the Ambisound mode. • See chapter 'Getting Started - Optimise wireless transmission' for proper wireless setup. |

Play

- | | |
|---|--|
| DivX video files cannot be played. | <ul style="list-style-type: none"> • Ensure that the DivX file is encoded according to the 'Home Theatre Profile' with the DivX encoder. • Ensure that the DivX video file is complete. |
| DivX subtitle are not displayed correctly. | <ul style="list-style-type: none"> • Ensure that the subtitle file name is the same as the movie file name. • Select the correct character set. See chapter 'Adjust Settings - Preference Setup - [DivX Subtitle]'. |
| The contents of the USB flash drive cannot be read. | <ul style="list-style-type: none"> • The USB flash drive format is not compatible with this unit. • Drive is formatted with different file system which is not supported by this unit (e.g. NTFS). • Maximum size of memory supported is 160GB. |

10 Glossary

Aspect ratio

Aspect ratio refers to the length to height ratio of TV screens. The ratio of a standard TV is 4:3, while the ratio of a high-definition or wide TV is 16:9. The letter box allows you to enjoy a picture with a wider perspective on a standard 4:3 screen.

DivX

The DivX code is a patent-pending, MPEG-4 based video compression technology, developed by DivX Networks, Inc., that can shrink digital video to sizes small enough to be transported over the internet, while maintaining high visual quality.

Dolby Digital

A surround sound system developed by Dolby Laboratories containing up to six channels of digital audio (front left and right, surround left and right, centre and subwoofer).

HDMI

High-Definition Multimedia Interface (HDMI) is a high-speed digital interface that can transmit uncompressed high definition video and digital multichannel audio. It delivers high quality picture and sound quality, completely free from noise. HDMI is fully backward-compatible with DVI.

As required by the HDMI standard, connecting to HDMI or DVI products without HDCP (High-bandwidth Digital Content Protection) will result in no Video or Audio output.

HDCP

High-bandwidth Digital Content Protection is a specification that provides a secure transmission of digital contents between different devices (to prevent unauthorised copyright).

JPEG

A very common digital still picture format. A still-picture data compression system proposed by the Joint Photographic Expert Group, which features small decrease in image quality in spite of its high compression ratio. Files are recognised by their file extension 'JPG or JPEG'.

MP3

A file format with a sound data compression system. 'MP3' is the abbreviation of Motion Picture Experts Group 1 (or MPEG-1) Audio Layer3. By using the MP3 format, one CD-R or CD-RW can contain about 10 times more data than a regular CD. Files are recognised by their file extension '.MP3'.

MPEG

Motion Picture Experts Group. A collection of compression systems for digital audio and video.

Progressive Scan

The progressive scan displays twice the number of frames per seconds than ordinary TV system. It offers higher picture resolution and quality.

WMA

Windows Media™ Audio. Refers to an audio compression technology developed by Microsoft Corporation. WMA data can be encoded by using Windows Media Player version 9 or Windows Media Player for Windows XP. Files are recognised by their file extension 'WMA'.

WMV

Windows Media Video. Refers to a video compression technology developed by Microsoft Corporation. WMV content can be encoded by using Windows Media® Encoder 9 series. Files are recognised by their file extension 'WMV'.

Language code

Abkhazian	6566	Inupiaq	7375	Pushto	8083
Afar	6565	Irish	7165	Russian	8285
Afrikaans	6570	Íslenska	7383	Quechua	8185
Amharic	6577	Italiano	7384	Raeto-Romance	8277
Arabic	6582	Ivrit	7269	Romanian	8279
Armenian	7289	Japanese	7465	Rundi	8278
Assamese	6583	Javanese	7486	Samoan	8377
Avestan	6569	Kalaallisut	7576	Sango	8371
Aymara	6589	Kannada	7578	Sanskrit	8365
Azerhajani	6590	Kashmiri	7583	Sardinian	8367
Bahasa Melayu	7783	Kazakh	7575	Serbian	8382
Bashkir	6665	Kernewek	7587	Shona	8378
Belarusian	6669	Khmer	7577	Shqip	8381
Bengali	6678	Kinyarwanda	8287	Sindhi	8368
Bihari	6672	Kirghiz	7589	Sinhalese	8373
Bislama	6673	Komi	7586	Slovensky	8373
Bokmål, Norwegian	7866	Korean	7579	Slovenian	8376
Bosanski	6683	Kuanyama; Kwanyama	7574	Somali	8379
Brezhoneg	6682	Kurdish	7585	Sotho; Southern	8384
Bulgarian	6671	Lao	7679	South Ndebele	7882
Burmese	7789	Latina	7665	Sundanese	8385
Castellano, Español	6983	Latvian	7686	Suomi	7073
Catalán	6765	Letzeburgesch;	7666	Swahili	8387
Chamorro	6772	Limburgan; Limburger	7673	Swati	8383
Chechen	6769	Lingala	7678	Svenska	8386
Chewa; Chichewa; Nyanja	7889	Lithuanian	7684	Tagalog	8476
中文	9072	Luxembourgish;	7666	Tahitian	8489
Chuang; Zhuang	9065	Macedonian	7775	Tajik	8471
Church Slavic; Slavonic	6785	Malagasy	7771	Tamil	8465
Chuvash	6786	Magyar	7285	Tatar	8484
Corsican	6779	Malayalam	7776	Telugu	8469
Česky	6783	Maltese	7784	Thai	8472
Dansk	6865	Manx	7186	Tibetan	6679
Deutsch	6869	Maori	7773	Tigrinya	8473
Dzongkha	6890	Marathi	7782	Tonga (Tonga Islands)	8479
English	6978	Marshallese	7772	Tsonga	8483
Esperanto	6979	Moldavian	7779	Tswana	8478
Estonian	6984	Mongolian	7778	Türkçe	8482
Euskara	6985	Nauru	7865	Turkmen	8475
Ελληνικά	6976	Navaho; Navajo	7886	Twi	8487
Faroese	7079	Ndebele, North	7868	Uighur	8571
Français	7082	Ndebele, South	7882	Ukrainian	8575
Frysk	7089	Ndonga	7871	Urdu	8582
Fijian	7074	Nederlands	7876	Uzbek	8590
Gaelic; Scottish Gaelic	7168	Nepali	7869	Vietnamese	8673
Gallegan	7176	Norsk	7879	Volapuk	8679
Georgian	7565	Northern Sami	8369	Walloon	8765
Gikuyu; Kikuyu	7573	North Ndebele	7868	Welsh	6789
Guarani	7178	Norwegian Nynorsk;	7878	Wolof	8779
Gujarati	7185	Occitan; Provençal	7967	Xhosa	8872
Hausa	7265	Old Bulgarian; Old Slavonic	6785	Yiddish	8973
Herero	7290	Oriya	7982	Yoruba	8979
Hindi	7273	Oromo	7977	Zulu	9085
Hiri Motu	7279	Ossetian; Ossetic	7983		
Hrwatski	6779	Pali	8073		
Ido	7379	Panjabi	8065		
Interlingua (International)	7365	Persian	7065		
Interlingue	7365	Polski	8076		
Inuktitut	7385	Português	8084		

POLIZA DE GARANTIA

ESTA POLIZA ES GRATUITA

Este aparato ha sido cuidadosamente diseñado y se ha fabricado con los mejores materiales bajo un estricto control de calidad, garantizando su buen funcionamiento por los periodos establecidos según el aparato (ver lista en la parte inferior) **a partir de la entrega del aparato al consumidor.**

Esta póliza incluye la reparación o reposición gratuita de cualquier parte o componente que eventualmente fallase y la mano de obra necesaria para su reparación, así como los gastos de transportación razonablemente erogados dentro de nuestros centros de servicio, misma que se hará efectiva en cualquiera de nuestros centros de servicio autorizados en el país.

Si su aparato llegase a requerir de nuestro servicio de garantía, acuda al centro de servicio más cercano a su domicilio, de tener alguna duda por favor llame a nuestro **CENTRO DE INFORMACIÓN AL CLIENTE LADA** sin costo en toda la republica al **01 800 504 62 00** en donde con gusto le indicaremos el centro de servicio autorizado más cercano a su domicilio.

PHILIPS MEXICANA S.A. de C.V. a través de sus centros de servicio autorizados **reparará y devolverá a usted su aparato en un plazo no mayor a 20 días hábiles,** contados a partir de la fecha de ingreso, impresa en la orden de servicio de cualquiera de nuestros centros de servicio autorizados.

La garantía de esta póliza cubre cualquier desperfecto o daño eventualmente ocasionado por los trabajos de reparación y/o traslado del aparato en el interior de nuestros centros de servicio autorizados.

Esta póliza sólo tendrá validez, si está debidamente requisitada, sellada por la casa vendedora, en caso de extravío de esta póliza, podrá hacer efectiva su garantía con la presentación de su factura de compra.

ESTA POLIZA NO SE HARA EFECTIVA EN LOS SIGUIENTES CASOS:

-Cuando el aparato sea utilizado en condiciones distintas a las normales.

-Cuando el aparato no haya sido operado de acuerdo con el instructivo de uso que se le acompaña.

-Cuando la causa de la falla o mal funcionamiento sea consecuencia de una reparación inadecuada o alteración producida por personas no autorizadas por PHILIPS MEXICANA S.A. de C.V.

PERIODOS DE GARANTIA

36 MESES.- Monitores para computadora.

12 MESES.- Televisores con y sin reproductor de video digital DVD, videocassetteras, reproductores de discos de video digital DVD, reproductores de disco de video digital con pantalla incluida, grabadores reproductores de disco de video digital DVD, grabadores reproductores de disco compacto, Radiograbadoras con y sin reproductor de disco compacto, reproductores de disco compacto portátil, video proyectores (excepto la lámpara) , cámaras de video, decodificadores de señal (IRD), televisores para hotel, sistemas de observación, televisores de proyección, teléfonos celulares, pagers, minisistemas de audio, minisistemas de audio con reproductor de disco de video digital integrado, microsistemas de audio, sistemas de cine en casa, sistemas reproductores de disco de video digital, equipos modulares, sintonificadores, facsímils, LNB, antenas de recepción de satélite, DVD ROM, CDR ROM y CDRW ROM para computadora.

6 MESES.- reproductores de cassette portátil, radio relojes, radios A.M.F.M., reproductores de audio digital MP3 (Internet), auto estéreos, teléfonos, teléfonos inalámbricos, cámaras digitales.

3 MESES.- Accesorios, controles remotos, bocinas, cintas para fax y para cámaras de videoconferencia, micrófonos, audífonos.

PHILIPS

Philips Mexicana, S.A. de C.V.

Producto Importado por:
Philips Mexicana, S.A. de C.V.

Av. La Palma No.6
Col. San Fernando La Herradura
Huixquilucan, Edo. de México, C.P. 52784
Tel. 52 69 90 00

Centro de Información al Cliente
Información General

LADA SIN COSTO PARA TODA LA REPUBLICA
01 800 504 62 00
CORREO ELECTRONICO
philips@merkafon.com

MODELO _____ No. DE SERIE _____

La presente garantía contará a partir de: DIA _____ MES _____ AÑO _____

En caso que en su producto presente alguna falla, acuda al centro de servicio más cercano a su domicilio (según listado de talleres anexo) y en caso de tener alguna duda o pregunta por favor llame a nuestro **Centro de información al Cliente**, en donde con gusto le atenderemos en todo lo relativo a:

- * Servicio de sus aparatos Philips
- * Información de productos y Talleres Autorizados Philips
- * Asesoría en el manejo e instalación de su producto Philips
- * Información en donde puede adquirir productos y accesorios Philips

Para hacer efectiva la garantía de su producto, es necesario presentar esta póliza debidamente requisitada o de lo contrario, presentar su factura de compra.

CENTROS DE SERVICIO AUTORIZADOS PHILIPS EN LAS PRINCIPALES CIUDADES

NOTA: Los Centros que tengan (S) solo proporcionan Servicio y los que tengan (SR) venden refacciones, accesorios y proporcionan Servicio

CIUDAD	LADA	TELEFONO	CORREO ELECTRONICO		CIUDAD	LADA	TELEFONO	CORREO ELECTRONICO	
ACAPULCO, GRO	744	483-32-96	serproa@yahoo.com.mx	S	MEXICO, D. F., ZONA NORTE	55	55-67-19-92 55-67-52-56	chyr_electronica@yahoo.com.mx	S
AGUASCALIENTES, AGS	449	915-61-81	jmsaale@hotmail.com	S	MEXICO, D. F., ZONA ORIENTE	55	87-58-89-37	cnogueta@mterra.com.com	S
CAMPECHE, CAMP	981	816 25 75	oreza@hotmail.com	S	MEXICO, D. F., ZONA PONIENTE	55	58 12 44 12	raulmtrm3@avante.net	S
CANCUAN, Q ROO.	998	984 18 74	gammacancon@webtelmex.net.mx	S	MONTERREY, N.L.	818	375-16-17 400-54-03	mcesa@prodigy.net.mx	S
CD. JUAREZ, CHIH	656	618-21-28 623-46-20	telleservicio@prodigy.net.mx	S	MORELIA, MICH	443	312-03-17	multiservicios_profesionales_de_zamorano@msn.com	S
CD. OBREGON, SON	644	412-41-51 419-20-93	mena747@prodigy.net.mx	S	NEZAHUALCOYOTL, EDO. MEX	55	57-33-34-98	vicentegutierrez@prodigy.net.mx	S
CD. VICTORIA, TAMPS	834	315-66-03 312-51-93	eml_emitter@yahoo.com.mx	S	OAXACA, OAX	951	516-47-37	elfrancistor@prodigy.net.mx	S
COUIMA, COL	312	314-03-01	tv_antenas@hotmail.com	S	ORIZABA, VER	272	724 38 53	barreda_electronics@hotmail.com	S
GUERNAVACA, MOR	777	313-00-49 313-50-92	centroserviciohertz@hotmail.com	S	PACHUCA, HGO	771	714-15-81	zaratefc@hotmail.com	S
CUILACAN, SIN	667	716-15-10	stereovox@cln.megared.net.mx	S	POZA RICA, VER	782	824 47 82	sonydigital@prodigy.net.mx	S
CHIHUAHUA, CHIH	614	421-69-30 421-63-61	comercialdomestica@hotmail.com	S	PUEBLA, PUE	222	248-77-64 231-63-77	rascon12@prodigy.net.mx	S
CHILPANCINGO, GRO.	747	471 72 73	ingelec_gro@hotmail.com	S	QUERETARO, QRO	442	216-10-09		S
DURANGO, DGO	618	825-00-05	evsurdigo@yahoo.com	S	SALTILLO, COAH	844	415 35 80	electronicaadigital_07@hotmail.com	S
GUADALAJARA, JAL	33	36-15-72-82 36-16-83-27	www. Leecom.com.mx	S	SAN LUIS POTOSI, S.L.P	444	815-34-07	centro_servicioslp@prodigy.net.mx	S
HERMOSILLO, SON	662	210-54-95 210-05-86	manuelw@prodigy.net.mx	S	SATELITE, EDO. MEX	55	55 62 59 73	missus_satelite@hotmail.com	S
IRAPUATO, GTO	462	626-51-10	tv_gasa@hotmail.com	S	TAMPICO, TAMPS	833	214 13 60	electromovie@prodigy.net.mx	S
LA PAZ, B.C.S	612	122-95-99	cenafaz@prodigy.net.mx	S	TEPIC, NAY	311	212-86-63	spe_tn@hotmail.co	S
LEON, GTO	477	770-26-99	tecospecializados@hotmail.com	S	TJUANA, B.C.N	664	621-22-15	www.ej1@telhor.net	S
MATAMOROS, TAMPS	868	813-60-13	digitalelectronica@comunicable.net	S	TOLUCA, EDO. MEX	722	214-83-09		S
MAZATLAN, SIN	669	982-42-21	e_santel@hotmail.com	S	TOLUCA, EDO. MEX	722	213 62 94		S
MERIDA, YUC	999	928-59-05	evia2@prodigy.net.mx	S	TORREON, COAH	871	732-49-49	jpmar02@prodigy.net.mx	S
MEXICALI, B.C.N	686	561-98-08 561-98-18	bajaelectronics@ad.com	S	TUXTLA GUTIERREZ, CHIS	961	618-19-08	kcvidae@prodigy.net.mx	S
MEXICO D.F., ZONA ABASCON	55	57 94 06 34	philipservice@hotmail.com	S	URUAPAN, MICH	452	524-08-38 524-37-78	rosaliaa@mich1.telmex.net.mx	S
MEXICO D.F. ZONA CENTRO	55	55 21 60 07	unifilmex@yahoo.com.mx	SR	VERACRUZ, VER	229	932-79-23 932-44-44	antza@ver.megared.net.mx	S
MEXICO, D. F., ZONA SUR	55	55-36-71-03 55-36-25-75	centrosdeservicioelectronico@hotmail.com	S	VILLAHERMOSA, TAB	893	314-31-36 314-81-67	villaltec@intrasar.net.mx	S
MEXICO, D. F., ZONA NORTE	55	53 68 30 21	tissaser@prodigy.net.mx	S	ZACATECAS, ZAC.	492	922 31 63	sertecmur@hotmail.com	S

Para mayor referencia de Talleres de Servicio Autorizados en otras ciudades comunicarse al 01 800 504 62 00 (lada sin costo)

Validez de la garantía

Todos los productos de la línea de audio y video Philips, se regirán por un año de garantía internacional (365 días), salvo para Chile donde los productos de las líneas CD Portable y RCR CD, los cuales se rigen por 6 meses de garantía (182 días)

Condiciones de la garantía

Esta garantía perderá su validez si:

- El defecto es causado por uso incorrecto o en desacuerdo con el manual de instrucciones
- El aparato sea modificado, violado por una persona no autorizada por Philips
- El producto esté funcionando con un suministro de energía (red eléctrica, batería, etc.) de características diferentes a las recomendadas en el manual de instrucciones
- El número de serie que identifica el producto se encuentre de forma adulterada.

Están excluidos de garantía,

- Los defectos que se generen debido al incumplimiento del manual de instrucciones del producto
- Los casos fortuitos o de la fuerza mayor, como aquellos causados por agentes de la naturaleza y accidentes, descargas eléctricas, señales de transmisión débiles.
- Los defectos que se generen debido al uso de los productos en servicios no doméstico/residencial regulares o en desacuerdo con el uso recomendado
- Daños ocasionados por fluctuaciones de voltajes, voltaje fuera de norma o por causas fuera de Philips, como cortocircuitos en los bafles o parlantes.
- En las ciudades en donde no existe el taller autorizado del servicio de Philips, los costos del transporte del aparato y/o el técnico autorizado, corren por cuenta del cliente.
- La garantía no será válida si el producto necesita modificaciones o adaptaciones para que funcione en otro país que no es aquél para el cual fue mercadeado.

El único documento válido para hacer efectiva la garantía de los productos, es la Factura o Boleta de compra del consumidor final.

Aquellos productos que hayan sido adquiridos en otros países y que no estén en el rango normal del país donde se efectuará la reparación, dicha prestación de servicio tomará mas tiempo de lo normal ya que es necesario pedir las partes/piezas al centro de producción correspondiente.

Centros de información

Líneas de atención al consumidor

Chile: 600-7445477

Colombia: 01-800-700-7445

Costa Rica: 0800-506-7445

Ecuador: 1-800-10-1045

El Salvador: 800-6024

Guatemala: 1-800-299-0007

Panama: 800-8300

Peru: 0800-00100

Rep. Dominicana: 1-800-751-2673

Venezuela: 0800-100-4888

LISTA DE SERVIÇO AUTORIZADO - BRASIL

ACRE
CRUZEIRO DO SUL 68-33224432
RIO BRANCO 68-32214164
RIO BRANCO 68-32249146

ALAGOAS
ARAPIRACA 82-5223467
MACEIO 82-32414727
PALMEIRA DOS INDIOS 82-4213452
UNIAO DOS PALMARES 82-32811305

AMAPA
MACAPA 96-2175934
SANTANA 96-2811080

AMAZONAS
MANAUS 92-36330305
MANAUS 92-36633366
MANAUS 92-32324522

Bahia
ALAGOINHAS 75-4211128
BARRERAS 77-36117592
BOM JESUS DA LAPA 77-4814335
BRUMAD 77-4412381
CAETITE 77-34541183
CAMACARI 71-36218288
CICERO DANTAS 75-32782767
CRUZ DAS ALMAS 75-6212839
ESPLANADA 75-4271454
EUNAPOLIS 73-2815181
FEIRA DE SANTANA 75-32232882
FEIRA DE SANTANA 75-2213923
GANDU 73-3254164
ILHEUS 73-3215995
IRECE 74-36410202
ITABERABA 75-32512358
ITABUNA 73-36137777
ITAPETINGA 77-2613003
JACOBINA 74-36211323
JEQUIE 73-35254141
JUAZEIRO 74-36116456
JUAZEIRO 74-36110022
LAURO DE FREITAS 71-3784021
MURITIBA 75-4241960
PAULO AFONSO 75-4413710
POCOS 77-4311890
RIBEIRA DO POMBAL 75-2761853
SALVADOR 71-32473659
SALVADOR 71-2675000
SALVADOR 71-3335233
SANTO AMARO 75-3241371
SENHOR DO BONFIM 74-5413143
SERRINHA 75-32611794
STO ANTONIO JESUS 75-36314470
TEIXEIRA DE FREITAS 73-30111600
VALENCA 75-6413710
VITORIA DA CONQUISTA 77-34241183

CEARA
BREJO SANTO 88-5310133
CRATEUS 88-6910019
CRATO 88-5212501
FORTALEZA 85-32875506
FORTALEZA 85-40088555
IBAPINA 88-36531223
IGUATU 88-35810512
ITAPIPOCA 88-6312060
JUAZEIRO DO NORTE 88-35112637
LITORAL DO NORTE 88-4219328
OROS 88-5841217
SOBRAL 88-36110605
TIANGULA 88-36713336
UBAJARA 88-6341233

DISTRITO FEDERAL
BRASILIA 86-3226998
BRASILIA 61-33016666
GAMA 61-5564840

ESPÍRITO SANTO
ALEGRE 28-3526349
ARACAJU 27-32561521
BAIXO GUANDU 27-32321142

BARRA S FRANCISCO
CASTELO 27-37562245
COLATINA 28-35420482
GUARAPARI 27-37222288
LINHARES 27-33614355
S GABRIEL DA PALHA 27-33710148
SAO MATEUS 27-37271153
VILA VELHA 27-37673806
VITORIA 27-32321899

GOIAS
ANAPOLIS 62-3243562
CACU 64-6561811
CALDAS NOVAS 64-4523878
CATALAO 64-4412786
FORMOSA 61-6318166
GOIANIA 62-32919095
GOIANIA 62-32292908
GOIATUBA 94-34952272
INHUMAS 62-5111840
IPAMERI 62-4511184
ITAPURANGA 62-3551484
ITUMBUIARA 64-34310837
JUSSARA 62-3731806
LUZIANIA 61-6228519
MINERIOS 64-6618259
PIRES DO RIO 64-4611133
RIALMA 62-3971320
RIO VERDE 64-36210173
TRINDADE 62-5051505
URUCUI 62-3571285

MARANHÃO
ACALANDIA 99-35381889
BACABAL 99-36212794
BALSAS 99-5410113
CAROLINA 98-7311335
CAXIAS 99-35212377
CHAPADINHA 98-4711364
CODO 99-36611277
CODO 99-36612942
COELHO NETO 98-34731351
IMPERATRIZ 99-35244699
PEDREIRAS 99-36423142
PRESIDENTE DUTRA 99-36631815
SANTA INES 98-36537533
SAO JOSE DE RIBAMAR 98-2241581
SAO LUIS 98-32323236
SAO LUIS 98-32315276

MATO GROSSO
ALTA FLORESTA 66-35212460
ALTO ARAUJIA 66-4811726
BARRA DO GARGAS 66-4011394
CUIABA 65-36230421
LUCAS DO RIO VERDE 65-5491333
PONTES E LACERDA 65-2662326
PRIMAVERA DO LESTE 66-4981682
RONDONOPOLIS 66-4233888
SINOP 65-5314592
TANGARA DA SERRA 65-3261431
VARZEZA GRANDE 65-6826502

MATO GROSSO DO SUL
AMBIAI 67-4811543
CAMPO GRANDE 67-33242804
CAMPO GRANDE 67-3831540
CAMPO GRANDE 67-3213898
DOURADOS 67-4217117
IVINHEIRA 67-4421244
NAVIRAÍ 67-4612486
NOVA ANDRANIRA 67-4413851
PONTE PORA 67-4314313
RIO BRILHANTE 67-4527950
TRES LAGOAS 67-5212007

MINAS GERAIS
ALFENAS 35-32927104
ALMENARA 33-7211234
ANDRADAS 35-37312970
ARAXA 34-36611132
ARAXA 34-36691869
ARCOZ 37-33513455
BAMBULI 37-3311473
BARBACENA 32-3310283

BELO HORIZONTE
BELO HORIZONTE 31-3225762
BELO HORIZONTE 31-32254064
BELO HORIZONTE 31-34420944
BELO HORIZONTE 31-34181919
BELO HORIZONTE 31-3295700
BELO HORIZONTE 31-34491000
BELO HORIZONTE 31-21027373
BETIM 31-35323088
BOM DESPACHO 37-35212906
BOM DESPACHO 37-3522511
CARANGOLA 32-37412017
CASSIA 35-35412293
CONGONHAS 31-37311638
CONS LAFAIETE 31-37637384
CONTAGEM 31-33912994
CONTAGEM 31-33953461
CONTAGEM 31-38418004
CURVELO 38-37213009
CORONEL FABRICIANO 31-38418004
CURVELO 38-37213009
DIVINOPOLIS 37-32212353
FORMIGA 37-33214177
FRUTAL 34-34252579
GOV. VALADARES 33-32716650
GUAXUPÉ 35-35513891
GUAXUPÉ 35-35514124
IPATINGA 31-38223232
ITABIRA 31-38316218
ITAJUBA 35-36211515
ITAPECERICA 37-33411326
ITAPECERICA 37-33411326
ITUALINA 37-32412468
ITUJUBA 34-32682131
JOAO MONLEVADE 31-38512909
JOAO MONLEVADE 31-38521112
JOAO PINHEIRO 38-35611327
JUIZ DE FORA 32-30842584
JUIZ DE FORA 32-32151514
LAGOA DA PRATA 37-32613493
LAVRAS 35-38219188
MARIJACU 33-33314735
MONTE CARMELO 34-38420020
MONTE SANTO DE MINAS 35-35911888
MONTES CLAROS 38-32218925
MURIAE 32-32724334
MUZAMBINHO 35-5712419
NANUQUE 33-36212165
NOVA LIMA 31-35412806
OLIVEIRA 37-33314444
PARA DE MINAS 37-32316369
PARA DE MINAS 37-32321975
PARACATU 38-36711250
PASSOS 35-35214342
PATOS DE MINAS 34-38223588
PATROCINIO 34-38315313
PINGULI 37-32716232
PIUMHI 37-33714632
POCOS DE CALDAS 35-37121866
POCOS DE CALDAS 35-37224448
PONTE NOVA 31-38172486
POUSO ALEGRE 35-34212120
S SEBASTIAO PARAISO 35-35313094
S SEBASTIAO PARAISO 35-35312054
SANTOS DUMONT 32-32516390
SAO JOAO DEL REI 32-33718906
STO ANTONIO MONTE 37-32811258
TEOFILO OTONI 32-3525831
TIMOTEO 31-38482278
UBA 32-35323626
UBERABA 34-33332520
UBERLANDIA 34-32123636
UBERLANDIA 34-32360764
VARZINHA 35-32212809
VARZEZA DA PALMA 38-37311548
VAZANTE 34-38131420
VICOSA 31-38918000

PARA
ABETUBA 91-37512272
BELEM 91-32690040
BELEM 91-32421090
CAPANEMA 91-34621100
CASTANHAL 91-37215052
ITAITUBA 93-5181545
MARABA 94-3211891
OBDON 91-34512716
PARAGOMINAS 91-30110778

PARNABA
CAMPCA GRANDE 83-3212128
ESPERANCA 83-3612273
GUARABIRA 83-2711159
JOAO PESSOA 83-3246489
JOAO PESSOA 83-3246404
JOAO PESSOA 83-32210460
NOVA FLORESTA 83-3741014
SAPE 83-2832479
SOLANEA 83-3631241

PARANA
AMPERE 46-5471605
ANTONINA 41-3421782
APUCARANA 43-34225306
ARAPONGAS 43-2753723
ASSIS CHATELAUBRIAND 44-3285491
BANDERANTES 43-5421711
CAMPO MOURAO 44-35238970
CASCAVEL 45-32254005
CIANORTE 46-4292842
CURITIBA 41-33334764
CURITIBA 41-32648791
CURITIBA 41-32534991
FOZ DO IGUAU 45-32323029
FOZ DO IGUAU 45-3524115
FRANCISCO BELTRAO 46-35233310
GRUAPUAVIA 42-36235325
IBATI 43-5461162
IBIPORA 43-2581863
IRATI 42-34221337
LAPA 41-36222400
LOANDA 44-4252053
LONDRIINA 43-3241002
MADAGUARI 44-2331335
MARINGA 44-32264620
MEDIANEIRA 45-32642580
PALMEIRA 42-2523006
PARANAGUA 41-34225804
PATO BRANCO 46-32228786
PONTA GROSSA 42-32226590
RIO NEGRO 47-36450251
ROLANDIA 42-2651947
S JOS DO PINHAIS 41-32822522
S MIGUEL DO IGUAU 45-5651429
SANTA FE 44-2471147
SAO JORGE D'OESTE 46-5341305
STO ANTONIO PLATINA 43-35341809
TELEMACIO BORBA 42-32726044
TOLEDO 45-32522471
UMUARAMA 44-36231233

PERNAMBUCO
BELO JARDIM 81-37261918
CABANO ST AGOSTINHO 81-32318223
CAMARA AGEIBRE 81-34588246
CARUARU 81-37220235
FLORESTA 81-87711274
JUAZEIRO
GARANHUNS 87-37611090
GARANHUNS 87-37610085
PAULISTA 81-34331142
RECIFE 81-32313999
RECIFE 81-2162111
RECIFE 81-34656040
RECIFE 81-34629092
SALGUEIRO 87-38716309
SERRA TALHADA 87-38311409

PISUAÍ
CAMPO MAIOR 86-32521376
FLORIANO 89-5211154
OEBRAS 89-4621066
PARNAIBA 86-3222877
PICOS 89-4224444
PICOZ 89-34515315
TERESINA 86-32213535
TERESINA 86-32230825
TERESINA 86-32214618

PORTO TROMBETAS
SANTAREM 93-35253522

RIO DE JANEIRO
JESUS TABOAOANA 22-38312216
BELFORD ROXO 21-27616090

LISTA DE SERVIÇO AUTORIZADO - BRASIL

CABO FRIO	22-26451819	SAO BORJA	55-34311850	BOTUCATU	14-38821081	SAO PAULO	11-32223211
CAMPOS GOYTACAZES	22-72721499	SAO FCO DE PAULA	54-2441466	BOTUCATU	14-38155044	SAO ROQUE	11-47842509
CANTAGALO	22-2555303	SAO GABRIEL	55-232883	CAMPINAS	19-32369199	SAO VICENTE	13-34628031
DIQUE DE CAXIAS	21-27711508	SAO JOSE DO OURO	54-3521216	CAMPINAS	19-32544819	SOROCABA	15-32241710
ITAOACARA	22-38612740	SAO LUIZ GONZAGA	55-33521365	CAMPINAS	19-32336498	SOROCABA	15-32241710
ITAPERUNA	22-38220605	SAO MARCOS	54-2911462	CAMPINAS	19-37372500	STA BARBARA D OESTE	19-34631211
MACAE	22-27626235	SOROCANHOS	55-3753409	CAMPO LIMPO PAULISTA	11-40392060	TABOAO DA SERRA	11-47871400
MACAE	22-27591358	STA CRUZ DO SUL	51-37155456	CAMPOS DO JORDAO	12-36622142	TACUARATINGA	16-32524309
MAGE	21-26330605	STA CRUZ DO SUL	51-37153048	CANDUVA	17-35232524	TAUBATE	12-36219080
NITEROI	21-26220157	TAPAJARA	54-3442353	CERQUILHO	15-32842121	TAUBATE	14-34965956
NOVA FRIBURGO	22-25227692	TAPERAA	54-3851160	CRUZEIRO	12-31433859	VINHEDO	19-38765100
NOVA IGUAÇU	21-26675663	TAQUARI	51-6531291	DIADEMA	11-40430669	VOTUPORANGA	17-34215726
PETROPOLIS	24-23217237	TORRES	51-4641940	DIACENA	18-30212479		
RESENDE	24-23550101	TRES DE MAIO	55-3535101	FERNANDOPOLIS	17-34323921		
RIO DE JANEIRO	21-25894622	TRES DE MAIO	55-3538827	FRANCA	16-37223898	ARACAJU	79-32119764
RIO DE JANEIRO	21-25892030	URUGUAIANA	55-34121791	FRANCO DA ROCHA	11-44492608	ARACAJU	79-32176080
RIO DE JANEIRO	21-25097136	VACARIA	54-2311396	GUARUAJÁ	13-33582942	ESTANCIA	79-5222325
RIO DE JANEIRO	21-24315426	VENANCIO AIRES	51-37411443	GUARULHOS	11-64513576	ITABAIANA	79-4313023
RIO DE JANEIRO	21-31579290	VERA CRUZ	51-37181350	GUARULHOS	11-64431153	LAGARTO	79-6312656
RIO DE JANEIRO	21-33916353			IGARAPAVA	16-31724600		
RIO DE JANEIRO	21-23627814	RONDÔNIA		INDAIALUBA	19-30753831	TOCANTINS	
RIO DE JANEIRO	21-11592187	ARIQUEMES	49-35353491	ITAPETINGINGA	15-32710936	ARAGUAIANA	63-4121857
RIO DE JANEIRO	21-38675252	CACAO	49-4431415	ITAPIRA	19-38633802	ARAGUAIANA	63-4111818
RIO DE JANEIRO	21-25714999	CERSEJERAS	49-33422251	ITARARE	15-35322743	GUARAI	63-34651930
RIO DE JANEIRO	21-24451123	GUAJARA-MIRIM	49-35414430	ITU	11-40230188	GURUPI	63-33511058
SAO GONCALO	21-27013214	JF. PARANA	49-34211891	ITUVERAVA	16-7293365	GURUPI	63-33214270
TERESOPOLIS	21-27494667	POKTO VELHO	49-3227377	JABOTICABAL	16-32021580		
TRES RIOS	24-23555687	ROLIM DE MOURA	49-4451179	JALES	17-36234479		
TRES RIOS	24-25251388	VILHENA	49-33223321	JAU	14-36221217		
				JUNDIAI	11-45862182		
RIO GRANDE DO NORTE		RORAIMA		LEME	19-35713528		
CAICO	84-4171844	BOA VISTA	95-32249605	LIMEIRA	19-34413179		
MOSSORO	84-33147809	BOA VISTA	95-6233456	MARILIA	14-34547437		
NATAL	84-32332349			MATAO	16-32821046		
NATAL	84-32332345	SANTA CATARINA		MALIA	11-35165233		
PAU DOS FERROS	84-3512334	BLUMENAU	47-3227242	MOGI DAS CRUZES	11-47941814		
		CANOINHAS	47-6223615	MOGI-GUAÇU	19-38181171		
RIO GRANDE DO SUL		CANOINHAS	47-6223615	MOGI-MIRIM	19-38624401		
AGUDO	55-2651036	CAPINZAL	49-35552266	OLIMPIA	17-2812184		
ALEGRETE	55-34221969	CHAPECO	49-33223304	OSASCO	11-36837343		
BAGE	53-2241295	CHAPECO	49-33221144	OURINHOS	14-32224567		
BENTO GONCALVES	54-6268265	CONCORDIA	49-34633704	PIRACICABA	19-34340454		
CAMAQUA	51-36711686	CRICIUMA	48-34375155	PIRASSUNUNGA	19-35614091		
CAMPINAS DO SUL	54-3661300	CURITIBA PORA	49-6460043	PORTO FERREIRA	19-35812441		
CANELA	54-32821551	CURITIBANOS	49-32410851	PRES PRUDENTE	18-2251268		
CAPOA DA CANOA	51-6652638	DESCANSO	49-36230245	PRES. EPITACIO	18-2814184		
CARAZINHO	54-3302292	FLORIANOPOLIS	48-32254149	PRES. PRUDENTE	18-2277943		
CAXIAS DO SUL	54-2153107	INDAIAL	47-33332375	PROFESSAO	14-35411696		
CAXIAS DO SUL	54-2368020	IPORA DO OESTE	49-36345789	RIBEIRAO PRETO	16-36105989		
CERRO LARGO	55-33591973	ITAIOPOLIS	476-522282	RIBEIRAO PRETO	16-36368156		
CORONEL BICACO	55-35571397	ITAJAI	47-33444777	RIBEIRAO PRETO	16-36107553		
ERECHIM	54-3211933	JARAGUA DO SUL	47-33720250	RIO CLARO	19-35348543		
ESTANCIA VELHA	51-35612142	JOACABA	49-35220418	S BERNARDO CAMPO	11-41257000		
FARRAOPOLHA	54-26884603	JOINVILLE	47-34331146	S BERNARDO CAMPO	11-43681788		
FAXINAL DO SOTURNINO	55-3261150	LAGES	49-2232355	S CAETANO DO SUL	11-42214334		
FLORES DA CUNHA	54-2922625	LAGES	49-32244414	S JOAO BOA VISTA	19-36223990		
FREDERICO WESTPHALEN	55-37441850	LAGUNA	48-36461221	S JOSE CAMPOS	12-39329508		
GETULIO VARGAS	54-3411888	LAURO MULLER	48-4643202	S JOSE DO RIO PARDO	19-36085760		
GIRUA	55-33611764	MARAVILHA	49-6640052	S JOSE RIO PRETO	17-32325680		
GRAVATAI	51-4882830	PNHALZINHO	497-661014	S JOSE RIO PRETO	17-2352381		
HORIZONTINA	55-35371680	PORTO UNIAO	42-35232839	SALTO	11-40296563		
IBIRARAAS	54-5551359	RIO DO SUL	47-5211920	SANTO ANDRE	11-4985588		
IJUÍ	55-3327766	SAO MIGUEL D' OESTE	49-36220026	SANTOS	13-32272447		
IMBE	51-36272704	SEARA	49-4521034	SANTOS	13-32847339		
LAJEADO	51-37145155	SOMBRIÓ	48-531225	SÃO CARLOS	16-33614913		
MARAU	54-33424571	TAIÓ	478-620576	SAO JOSE DO CAMPOS	12-39122728		
MONTENEGRO	51-624187	TUBARAO	48-6224448	SAO JOSE RIO PRETO	17-2355241		
NONOAI	54-3621126	TUBARAO	48-6261651	SAO PAULO	11-2964622		
NOVA PRATA	54-2421328	TURVO	48-5250273	SAO PAULO	11-47036116		
NOVO HAMBURGO	51-35823191	URUSSANGA	484-651137	SAO PAULO	11-69791184		
OSORIO	51-36632524	VIDEIRA	49-35660376	SAO PAULO	11-38659897		
PALMEIRA MISSOES	55-37421407	XANXERÊ	49-4333026	SAO PAULO	11-62156667		
PANAMBI	55-33753488			SAO PAULO	11-69545517		
PASSO FUNDO	54-33111104	SÃO PAULO		SAO PAULO	11-36726766		
PELOTAS	53-32223633	AGUAS DE LINDOIA	19-38741524	SAO PAULO	11-66949101		
PORTO ALEGRE	51-32316941	AMERICANA	19-34626914	SAO PAULO	11-32077111		
PORTO ALEGRE	51-33256653	AMPARO	19-38072674	SAO PAULO	11-39757996		
PORTO ALEGRE	51-32268834	ARACATUBA	18-36218775	SAO PAULO	11-62976464		
RIO GRANDE	53-32232311	ARARAQUARA	16-33368710	SAO PAULO	11-56679695		
SANTA DO LIVRAMENTO	55-3241899	ATIBAIA	11-44118145	SAO PAULO	11-38751333		
SANTA MARIA	53-2222235	AVARE	14-37322142	SAO PAULO	11-55321515		
SANTA ROSA	55-35211991	BARETOS	17-3322242	SAO PAULO	11-64380941		
SANTA VITORIA DA PALMAR	53-32633992	BATATAIS	16-37614455	SAO PAULO	11-32217317		
SANTO ANGELO	55-33131183	BAURUR	14-32239551	SAO PAULO	11-37714709		
SANTO AUGUSTO	55-37811511	BIRIGUI	18-36424011	SAO PAULO	11-25770899		

CERTIFICADO DE GARANTIA NO BRASIL

Este aparelho é garantido pela Philips da Amazônia Indústria Eletrônica Ltda., por um período superior ao estabelecido por lei. Porém, para que a garantia tenha validade, é imprescindível que, além deste certificado, seja apresentada a nota fiscal de compra do produto.

A Philips da Amazônia Indústria Eletrônica Ltda. assegura ao proprietário consumidor deste aparelho as seguintes garantias, a partir da data de entrega do produto, conforme expresso na nota fiscal de compra, que passa a fazer parte deste certificado:

Garantia para rádios e reprodutores de CD portáteis (sem caixa acústica destacável): 180 dias

Garantia para os demais produtos da marca Philips: 365 dias.

Esta garantia perderá sua validade se:

- O defeito apresentado for ocasionado por uso indevido ou em desacordo com o seu manual de instruções.
- O produto for alterado, violado ou consertado por pessoa não autorizada pela Philips.
- O produto for ligado a fonte de energia (rede elétrica, pilhas, bateria, etc.) de características diferentes das recomendadas no manual de instruções e/ou no produto.
- O número de série que identifica o produto estiver de alguma forma adulterado ou rasurado.

Estão excluídos desta garantia defeitos decorrentes do descumprimento do manual de instruções do produto, de casos fortuitos ou de força maior; bem como aqueles causados por agentes da natureza e acidentes. Excluem-se igualmente desta garantia defeitos decorrentes do uso dos produtos em serviços não doméstico/residencial regular ou em desacordo com o uso recomendado. **ESTÃO EXCLUÍDAS DA GARANTIA ADICIONAL AS PILHAS OU BATERIAS FORNECIDAS JUNTO COM O CONTROLE REMOTO.**

Nos municípios onde não exista oficina autorizada de serviço Philips, as despesas de transporte do aparelho e/ou do técnico autorizado, correm por conta do Sr. Consumidor requerente do serviço.

A garantia não será válida se o produto necessitar de modificações ou adaptações para habilitá-lo a operar em qualquer outro país que não aquele para o qual foi designado, fabricado, aprovado e/ou autorizado, ou ter sofrido qualquer dano decorrente deste tipo de modificação.

Philips da Amazônia Indústria Eletrônica Ltda.

Dentro do Brasil, para informações adicionais sobre o produto ou para eventual necessidade de utilização da rede de oficinas autorizadas, ligue para o Centro de Informações ao Consumidor (CIC). Em São Paulo - Capital e demais localidades com DDD 011 - tel. 2121-0203, nas demais localidades e estados - tel. 0800 701 02 03 (discagem direta gratuita), ou escreva para Caixa Postal: nº 21.315 - CEP04602-970 - São Paulo - SP, ou envie um e-mail para: cic@philips.com.br
Horário de atendimento: de segunda à sexta-feira, das 08:00 às 20:00 h; aos sábados das 08:00às13:00h.

*Para atendimento fora do Brasil, contate a Philips local ou a:
Philips Consumer Service
Beukenlaan 2
5651 CD Eindhoven
The Netherlands*

Certificado de Garantía en Argentina

Artefacto:

Modelo:

**Fabricante/Importador: Philips Argentina S.A.
y/o Fábrica Austral de Productos Eléctricos S.A.
Dirección: Vedia 3892 - Buenos Aires
Fecha de Venta:**

	Nro. de serie
--	----------------------

Firma y sello de la casa vendedora.

PHILIPS ARGENTINA S.A. en adelante denominada “la empresa”, garantiza al comprador de este artefacto por el término de (1) año a partir de la fecha de adquisición, el normal funcionamiento contra cualquier defecto de fabricación y/o vicio de material, y se compromete a reparar el mismo —sin cargo alguno para el adquirente— cuando el mismo fallare en situaciones normales de uso y bajo las condiciones que a continuación se detallan:

1. Este certificado de garantía es válido únicamente en la Republica Argentina. El certificado debe ser completado por la casa vendedora y ser presentado por el usuario conjuntamente con la factura original de compra.
2. Serán causas de anulación de esta garantía en los casos que corresponda:
 - 2.1. Uso impropio o distinto del uso doméstico.
 - 2.2. Exceso o caídas de tensión eléctrica que impliquen uso en condiciones anormales.
 - 2.3. Instalación y/o uso en condiciones distintas a las marcadas en el “Manual de instalación y uso” que se adjunta a esta garantía.
 - 2.4. Cualquier intervención al artefacto por terceros no autorizados por la empresa.
3. La garantía carecerá de validez si se observare lo siguiente:
 - 3.1. Enmiendas o raspaduras en los datos del certificado de garantía o factura.
 - 3.2. Falta de factura original de compra que detalle tipo de artefacto, modelo, número de serie y fecha que coincida con los del encabezamiento del presente certificado.
4. No están cubiertos por esta garantía los siguientes casos:
 - 4.1. Los daños ocasionados al exterior del gabinete.
 - 4.2. Las roturas, golpes, caídas o rayaduras causadas por traslados.
 - 4.3. Los daños o fallas ocasionados por deficiencias, sobretensiones, descargas o interrupciones del circuito de alimentación eléctrica o rayos, deficiencias en la instalación eléctrica del domicilio del usuario o conexión del artefacto a redes que no sean las especificadas en el Manual de Uso del mismo.
 - 4.4. Las fallas, daños, roturas o desgastes producidos por el maltrato o uso indebido del artefacto y/o causadas por inundaciones, incendios, terremotos, tormentas eléctricas, golpes o accidentes de cualquier naturaleza.
 - 4.5. Las fallas o daños ocasionados en desperfectos en la línea telefónica.
 - 4.6. Las fallas producidas por una mala recepción ocasionada en el uso de una antena deficiente o en señales de transmisión débiles.
5. Las condiciones de instalación y uso del artefacto se encuentran detalladas en el Manual de Uso del mismo.
6. La empresa no asume responsabilidad alguna por los daños personales o a la propiedad al usuario o a terceros que pudieran causar la mala instalación o uso indebido del artefacto, incluyendo en este último caso a la falta de mantenimiento.
7. En caso de falla, el usuario deberá requerir la reparación a la empresa a través del Service Oficial y/o Talleres Autorizados más próximos a su domicilio y cuyo listado se acompaña al presente. La empresa a segura al usuario la reparación y/o reposición de piezas para su correcto funcionamiento en un plazo no mayor a 30 días contados a partir de la fecha de solicitud de reparación, salvo caso fortuito o fuerza mayor.

8. Toda intervención del servicio técnico realizada a pedido del usuario dentro del plazo de garantía, que no fuera originada por falla o defecto alguno cubierto por este certificado, deberá ser abonado por el interesado de acuerdo a la tarifa vigente.
9. El presente certificado anula cualquier otra garantía implícita o explícita, por la cual y expresamente no autorizamos a ninguna otra persona, sociedad o asociación a asumir por nuestra cuenta ninguna responsabilidad con respecto a nuestros productos.
10. En caso de que durante el período de vigencia de esta garantía el artefacto deba ser trasladado a las Delegaciones Oficiales y/o Talleres Autorizados de Service para su reparación, el transporte será realizado por la empresa y serán a su cargo los gastos de flete y seguros y cualquier otro que deba realizarse para su ejecución.



PHILIPS

Red de Talleres Autorizados en Argentina

CAPITAL FEDERAL

ATTENDANCE S.A.

- Av. Monroe 3351 (C1430BKA) Cap. Fed.
- Tel.: 4545-5574/0704 ó 6775-1300
- Ventas de Repuestos y Accesorios
- Tel.: 4545-0854

DIG TRONIC

- Av. San Martín 1762 (C1416CRS) Cap. Fed.
- Tel.: 4583-1501

ELECTARG S.R.L.

- Av. Córdoba 1357 (C1055AAD) Cap. Fed.
- Ventas de Repuestos y Accesorios
- Tel.: 4811-1050

Caballito Electarg J. M. Moreno 287 4903-6967/6854/8983

BUENOS AIRES

Azul	Herlein Raúl Horacio	Av. 25 de Mayo 1227	(02281) 428719
Bahía Blanca	Neutron	Soler 535	(0291) 4535329
Bragado	Yacovino Juan J.	San Martín 2141	(02342) 424147
Campana	Electricidad Krauter	Lavalle 415	(03489) 432919
Chivilcoy	Fama	Coronel Suárez 110	(02346) 424129
Junín	Junín Service	Alsina 537	(02362) 442754
La Plata	Da Tos e Hijos	Calle 68 N° 1532	(0221) 4516021
La Plata	Service Técnico La Plata	Av. 51 N° 1051 esq. 16	(0221) 4108155
Mar de Ajó	Tauro Electrónica	Catamarca 14	(02257) 421750
Mar del Plata	Central Service	Olazábal 2249	(0223) 4721639/4729367
Mar del Plata	Service Integral	Diag. Pueyrredón 3229	(0223) 4945633
Necochea	Electrónica Camejo	Calle 63 N° 1745	(02262) 426134
Pehuajó	Calcañi Carlos Alberto	Zubiría 794	(02396) 472665
Pergamino	ACV Sistemas	Dr. Alem 758	(02477) 421177
Pergamino	El Service	Juan B. Justo 1931	(02477) 418000

San Nicolás	Servicec	Bv. Alvarez 148	(03461) 454729/429578
San Pedro	Electrónica Menisale	Mitre 1695	(03329) 425523
Tandil	Lazarini Oscar Rafael	Pellegrini 524	(02293) 442167
Trenque Lauquen	Labruno Electrónica	Av. San Martín 426	(02392) 423248
Tres Arroyos	Saini Fabián y Sergio	Av. Belgrano 562	(02983) 427369
Zárate	Electrónica Spinozzi	Ituzaingó 1030	(03487) 427353

GRAN BUENOS AIRES

Avellaneda	Casa Torres S.A.	Av. Mitre 2559	4255-5854
Florencio Varela	Casa Torres S.A.	San Martín 2574	4255-5854
Gregorio de Laferrere	Electrónica Alvarez	Honorio Luque 6084	4626-1322
Lomas de Zamora	Attendance S.A. Lomas	Laprida 485	4292-8900
Merlo	Argentónica S.H.	Pte. Cämpora 2175	(0220) 4837177/4829934
Moreno	Argentónica S.H.	Bmé. Mitre 2977 loc.2	(0237) 4639500
Morón	Servotronic	Ntra. Sra. del Buen Viaje 1222	4627-5656
Olivos	Appliance	Av. Libertador 2684	4794-7700
Quilmes	Casa Torres S.A.	E. Ríos esq. Gran Canaria	4255-5854
Ramos Mejía	Electarg S.R.L. Suc.	Belgrano 224	4656-0619
San Miguel	Servotronic San Miguel	Belgrano 999	4664-4131
Villa Ballester	Servotronic	J. Hernández 3101	4767-2515/4768-5249

CATAMARCA

Catamarca	Omicron Central de Serv.	San Martín 225	(03833) 427235
-----------	--------------------------	----------------	----------------

CHACO

Resistencia	Freschi Jorge Oscar	Av. Avalos 320	(03722) 426030
-------------	---------------------	----------------	----------------

CHUBUT

Comodoro Rivadavia	C.A.S. S.R.L.	Alem 145	(0297) 4442629
Trelew	Fagtron Electrónica	Brasil 253	(02965) 427073

CORDOBA

Córdoba Capital	Servelco S.R.L.	Pje. E. Marsilla 635	(0351) 4724008/4732024
Río Cuarto	Maurutto Victor G.	Bv. Almaguer 487	(0358) 4660204
Río Cuarto	Capaldi Abel	Paunero 832	(0358) 4623003
Río Tercero	Service Omega	Homero Manzi 149	(03571) 423330
San Francisco	Acuña Walter Electrónica	M. Moreno 360	(03564) 425367
Villa María	Grasso Electrónica	Bv. Alvear 541	(0353) 4521366
Villa María	Vanguard Sist. Electrónicos	México 421	(0353) 452951

