

PHILIPS
AC1213

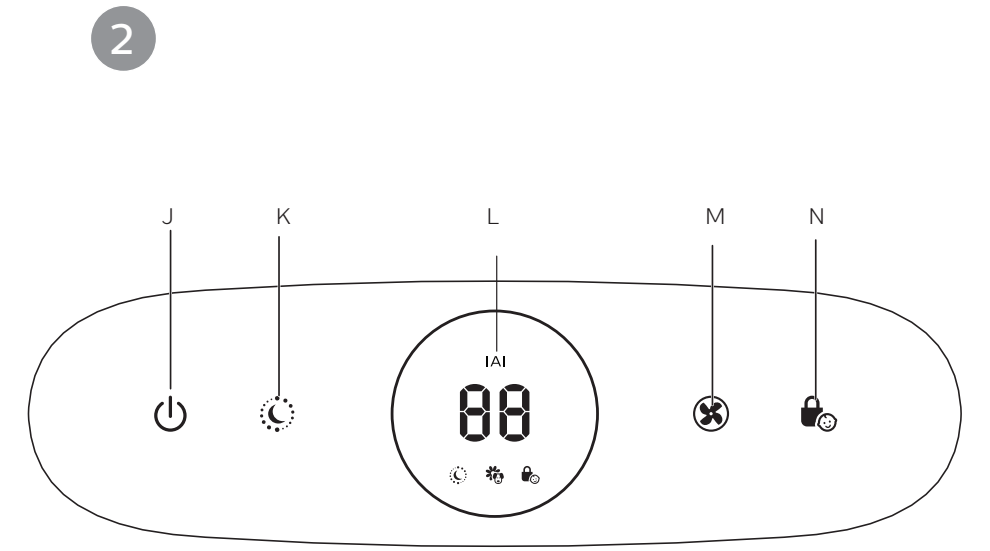

EN User manual 1

ZH-T 使用手冊 17

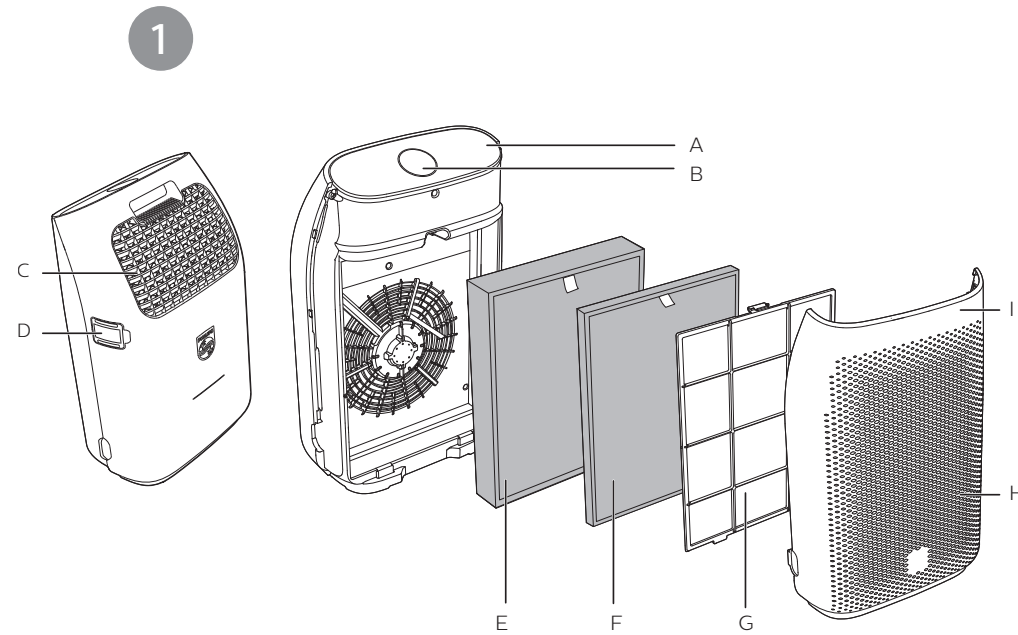

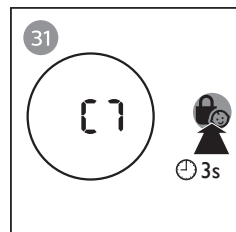
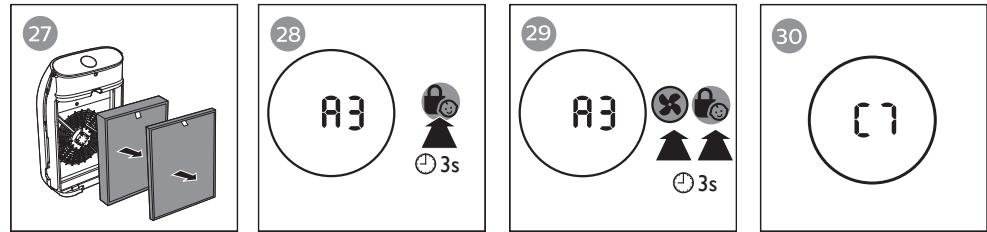
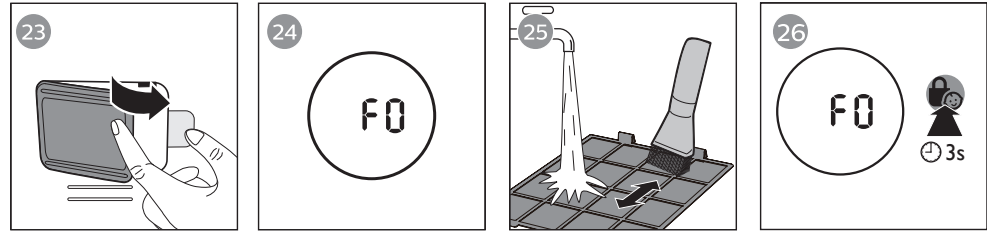
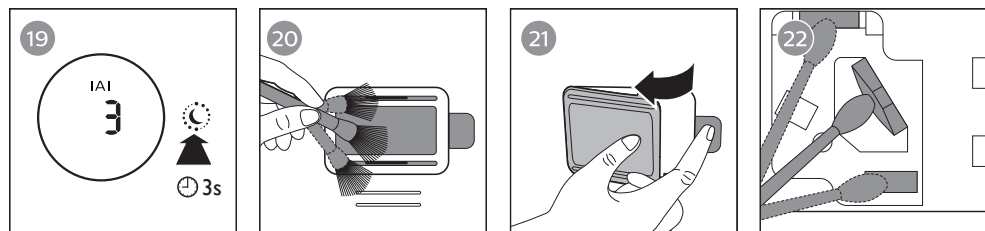
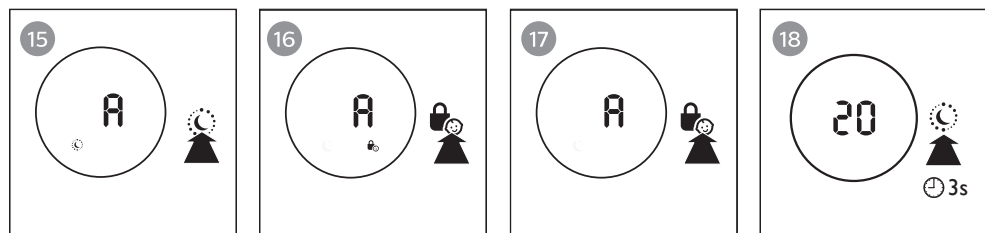
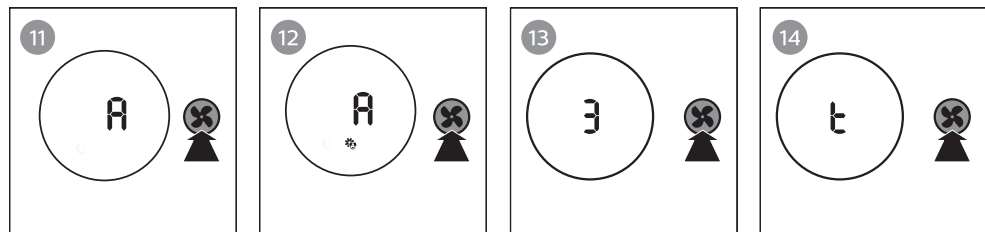
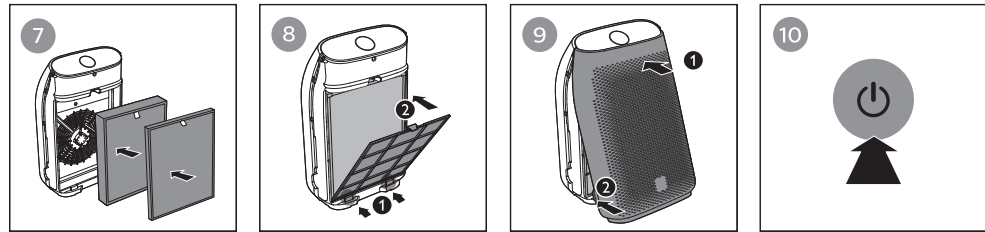
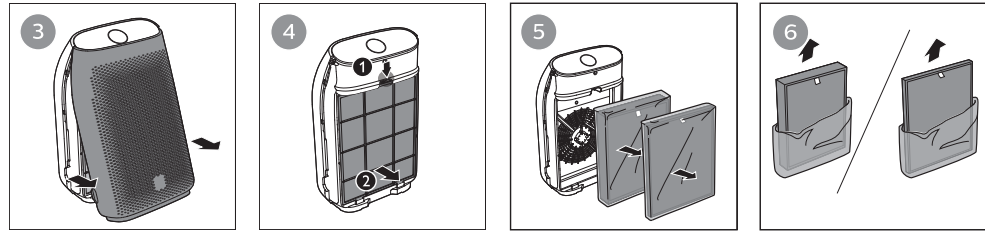

Contents

1 Important	2	8 Troubleshooting	13
2 Your air purifier	5	9 Guarantee and service	15
Product overview (Fig. ①)	5	Order parts or accessories	15
Controls overview (Fig. ②)	5		
3 Getting started	5	10 Notices	15
Installing the filters	5	Electromagnetic fields (EMF)	15
		Recycling	16
4 Using the air purifier	6		
Understanding the air quality light	6		
Turning on and off	6		
Changing the fan speed	7		
Light sensor	7		
Night sensing mode	7		
Setting the child lock	8		
Switching the display mode	8		
5 Cleaning	9		
Cleaning the body of the air purifier	9		
Cleaning the air quality sensor	9		
Cleaning the pre-filter	10		
6 Replacing the filters	11		
Filter replacement indicator	11		
Replacing the filters	11		
Filter reset	12		
7 Storage	12		

Environmental friendly paper used. Thanks for your contribution to save trees.

1 Important

Read this user manual carefully before you use the appliance, and save it for future reference.

Danger

- Do not let water or any other liquid or flammable detergent enter the appliance to avoid electric shock and/or a fire hazard.
- Do not clean the appliance with water, any other liquid, or a (flammable) detergent to avoid electric shock and/or a fire hazard.
- Do not spray any flammable materials such as insecticides or fragrance around the appliance.

Warning

- Check if the voltage indicated on the appliance corresponds to the local power voltage before you connect the appliance.
- If the power cord is damaged, you must have it replaced by Philips, a

service center authorized by Philips, or similarly qualified persons in order to avoid a hazard.

- Do not use the appliance if the plug, the power cord, or the appliance itself is damaged.
- This appliance can be used by children aged from 8 years and above and persons with reduced physical, sensory or mental capabilities or lack of experience and knowledge if they have been given supervision or instruction concerning use of the appliance in a safe way and understand the hazards involved. Child shall not play with the appliance. Cleaning and maintenance shall not be made by children without supervision.
- Do not block the air inlet and outlet, e.g. by placing items on the air outlet or in front of the air inlet.
- Make sure that foreign objects do not fall into the appliance through the air outlet.

Caution

- This appliance is not a substitute for proper ventilation, regular vacuum cleaning, or use of an extractor hood or fan while cooking.
- If the power socket used to power the appliance has poor connections, the plug of the appliance becomes hot. Make sure that you plug the appliance into a properly connected power socket.
- Always place and use the appliance on a dry, stable, level, and horizontal surface.
- Leave at least 20cm free space behind and on both sides of the appliance and leave at least 30cm free space above the appliance.
- Do not place anything on top of the appliance.
- Do not sit or stand on the appliance. Sitting or standing on the appliance may lead to potential injury.
- Do not place the appliance directly below an air conditioner to prevent condensation from dripping onto the appliance.
- Make sure all filters are properly installed before you switch on the appliance.
- Only use the original Philips filters specially intended for this appliance. Do not use any other filters.
- Combustion of the filter may cause irreversible human hazard and/or jeopardize other lives. Do not use the filter as fuel or for similar purpose.
- Avoid knocking against the appliance (the air inlet and outlet in particular) with hard objects.
- Always lift or move the appliance by the handle on back side of the appliance.
- Do not insert your fingers or objects into the air outlet or the air inlet to prevent physical injury or malfunctioning of the appliance.

- Do not use this appliance when you have used indoor smoke-type insect repellents or in places with oily residues, burning incense, or chemical fumes.
- Do not use the appliance near gas appliances, heating devices or fireplaces.
- Always unplug the appliance after use and before cleaning, or carrying out other maintenance or replacing the filters.
- Do not use the appliance in a room with major temperature changes, as this may cause condensation inside the appliance.
- To prevent interference, place the appliance at least 2 meters away from electrical appliances that use airborne radio waves such as TVs, radios, and radio-controlled clocks.
- The appliance is only intended for household use under normal operating conditions.
- Do not use the appliance in wet surroundings or in surroundings with high ambient temperatures, such as the bathroom, toilet, or kitchen.
- The appliance does not remove carbon monoxide (CO) or radon (Rn). It cannot be used as a safety device in case of accidents with combustion processes and hazardous chemicals.
- If you need to move the appliance, disconnect the appliance from the power supply first.
- Do not move the appliance by pulling its power cord.
- Always wash your hands thoroughly after changing or cleaning a filter.

2 Your air purifier

Congratulations on your purchase, and welcome to Philips!

To fully benefit from the support that Philips offers, register your product at www.philips.com/welcome.

Product overview (Fig. ①)

- A Control panel
- B Air quality light
- C Air outlet
- D Air quality sensor
- E NanoProtect filter HEPA Series 3 (FY1410)
- F NanoProtect filter Active Carbon (FY1413)
- G Pre-filter
- H Air inlet
- I Front panel

Controls overview (Fig. ②)

- J On/Off button
- K Night sensing mode button
- L Display screen
- M Fan speed button
- N Child lock button

3 Getting started

Installing the filters

Note

- Make sure the air purifier is unplugged from the electrical outlet before installing the filters.
- Make sure the side of the filter with the tag is pointing towards you.

- 1 Pull the bottom part of the front panel and gently lift to remove it from the air purifier (Fig. ③).
- 2 Press the clip down (1) and pull the pre-filter towards you (2) (Fig. ④).
- 3 Remove all filters (Fig. ⑤).
- 4 Remove all packaging materials from the filters (Fig. ⑥).
- 5 Place the thick HEPA filter (FY1410) into the air purifier and then the thin Active Carbon filter (FY1413) (Fig. ⑦). The model numbers are shown on each filter.
- 6 Attach the pre-filter back into the air purifier (Fig. ⑧).

Note

- Make sure the side with the clip is pointing towards you, and that all hooks of the pre-filter are properly attached to the purifier.

- 7 Reattach the front panel by pressing the top part of the panel onto the top of the air purifier (1). Then, gently push the panel against the body of the air purifier (2) (Fig. ⑨).
- 8 Wash your hands thoroughly after installing filters.

4 Using the air purifier

Understanding the air quality light

Indoor Allergen Index (IAI) is a real-time numerical display that provides visual and immediate feedback on indoor allergen level. It indicates potential indoor allergen risk level which is converted from indoor particle pollutants concentration. Higher IAI means higher risk.



IAI	PM2.5	Air quality light color	Air quality level
1-3	0-12	Blue	Good
4-6	13-35	Blue-violet	Fair
7-9	36-55	Red-purple	Poor
10-12	>56	Red	Very poor

The air quality light automatically goes on when the air purifier is switched on, and lights up all colors in sequence. After approximately 30 seconds, the air quality sensors select the color that corresponds to the surrounding air quality of airborne particles.

Turning on and off

Note

- Always place the air purifier on a stable, horizontal, and level surface with the front of the unit facing away from walls or furniture.
- For optimum purification performance, close doors and windows.
- Keep curtains away from the air inlet or air outlet.

- 1 Put the plug of the air purifier in the wall outlet.
- 2 Touch  to switch on the air purifier (Fig. 10).
 - ↳ The air purifier beeps.
 - ↳ The air purifier operates under the auto mode by default.
 - ↳ When the air purifier is warming up, "—" displays on the screen.
 - ↳ After measuring the air quality for approximately 30 seconds, the air quality sensor automatically selects the appropriate air quality light color.
- 3 Touch and hold  for 3 seconds to switch off the air purifier.

Note

- If the air purifier stays connected to the electrical outlet after turning OFF, the air purifier will operate under the previous settings when turned ON again.
- If the air purifier accidentally shuts off during running, it restarts automatically and operates under previous settings when the power supply is resumed.

Changing the fan speed



There are several fan speeds available. You can choose the auto mode, speed 1, 2, 3 or turbo mode (t).

Auto(A)

- Touch the fan speed button  repeatedly to select the auto mode (Fig. 11).

Allergen mode

The specially designed allergen mode can effectively reduce common allergens such as pollen and pet dander.

- Touch the fan speed button  to select the Allergen mode (Fig. 12).
 - ↳ Auto (A) and  display on the screen.

Manual

- Touch the fan speed button  repeatedly to select the fan speed you need (Fig. 13).

Turbo (t)

In turbo mode, the air purifier operates on the highest speed.

- Touch the fan speed button  to select the turbo mode (t) (Fig. 14).

Light sensor

With the light sensor, the air purifier can work according to the ambient light.

When the ambient light dims for 10 seconds, all the lights on the control panel will turn off slowly. During this period, you can touch any of the buttons, all lights will turn on again. If you don't perform other operations within 10 seconds, all lights will turn off.

After the ambient light becomes bright and lasts at least for 10 seconds, all lights will turn on again.

Night sensing mode

You can activate the night sensing mode in two ways.



Activating the night sensing mode manually

- Before you go to sleep, touch  manually to activate the night sensing mode (Fig. 15).
 - ↳ If the air quality light is blue, the air purifier directly goes to the night sensing mode. The air purifier operates quietly and the air quality light will be dimmed.
 - ↳ If the air quality light is not blue, the air purifier operates under turbo mode for a maximum of 10 minutes, the air quality light blinks slow during this time, and then goes to the night sensing mode.





Auto activating the night sensing mode

When the air purifier operates in auto mode or allergen mode, if the light sensor detects the lights in your room are turned off, the air purifier goes to the night sensing mode automatically. The air purifier will adjust the fan speed in real-time to make sure the air in your room is good. The air quality light will be dimmed.

Note

- The light sensor detects the lights in your room after 11 hours in the night sensing mode.
- If the lights in your room are turned on, the air purifier will quit the night sensing mode and operate under the previous mode. The air quality light and the display will be on again.
- To exit the night sensing mode manually, touch  or  button.

Setting the child lock

- 1 Touch and hold the child lock button  for 3 seconds to activate child lock (Fig. 16).
 - ↳ The child lock icon  displays on the screen.
 - ↳ When the child lock is on, all the other buttons are not responsive, only the child lock icon  blinks.
- 2 Touch and hold the child lock button  for 3 seconds again to deactivate child lock (Fig. 17).
 - ↳ The child lock icon  disappears.

Note



- The child lock function is automatically unlocked when the pre-filter cleaning code or the filter replacement code displays on the screen.

Switching the display mode

The air purifier has dual display mode, IAI display and PM2.5 display.

Note

- The air purifier operates in IAI display mode by default.
- If the PM2.5 level is higher than 99, "--" will be displayed on the screen.

- 1 Touch  for 3 seconds to switch to PM2.5 display mode (Fig. 18).
 - ↳ The actual PM2.5 level displays on the screen.
- 2 Touch  for 3 seconds again to switch back to IAI display mode (Fig. 19).
 - ↳ The IAI level displays on the screen.

5 Cleaning

Note

- Always turn the air purifier off and unplug the air purifier from the electrical outlet before cleaning.
- Never immerse the air purifier in water or any other liquid.
- Never use abrasive, aggressive, or flammable cleaning agents such as bleach or alcohol to clean any part of the air purifier.
- Only the pre-filter is washable. The air filter is not washable.
- Do not attempt to clean the filters or air quality sensor with a vacuum.

Cleaning the body of the air purifier

Regularly clean the inside and outside of the air purifier to prevent dust from collecting.

- 1 Use a soft, dry cloth to clean both the interior and exterior of the air purifier.
- 2 The air outlet can also be cleaned with a dry, soft cloth.
- 3 Detach the front cover from the air purifier and wash it under running tap water.

Cleaning the air quality sensor

Clean the air quality sensor every 2 months for optimal functioning of the purifier.

Note

- If the air purifier is used in a dusty environment, it may need to be cleaned more often.
- If the humidity level in the room is very high, condensation may develop on the air quality sensor and the air quality light may indicate a more poor air quality even though the air quality is actually good. If this occurs, clean the air quality sensor or use the air purifier on a manual speed setting.

- 1 Switch off the air purifier and unplug from the wall outlet.
- 2 Clean the air quality sensor inlet and outlet with a soft brush (Fig. 20).
- 3 Remove the air quality sensor cover (Fig. 21).
- 4 Clean the air quality sensor, the dust inlet and the dust outlet with a damp cotton swab (Fig. 22).
- 5 Dry all parts thoroughly with a dry cotton swab.
- 6 Reattach the air quality sensor cover (Fig. 23).

Note

- Always keep air quality cover closed while the air purifier is working.

Cleaning the pre-filter

Clean the pre-filter when **F0** is displayed on the screen (Fig. 24).

- 1 Switch off the air purifier and unplug from the wall outlet.
 - 2 Pull the bottom part of the front panel and then gently lift to remove it from the air purifier (Fig. 3).
 - 3 Press the clip down (1) and pull the pre-filter towards you (2) (Fig. 4).
 - 4 If the pre-filter is very dirty, use a soft brush to brush away the dust. Then wash the pre-filter under running tap water (Fig. 25).
 - 5 Allow the pre-filter to air dry thoroughly before placing back in the air purifier.
- 7 To reattach the front panel, press the top part of the panel onto the top of the air purifier (1). Then, gently push the panel against the body of the air purifier (2) (Fig. 9).
 - 8 Put the plug of the air purifier in the wall outlet.
 - 9 Touch and hold the  for 3 seconds to reset the pre-filter cleaning time (Fig. 26).
 - 10 Wash your hands thoroughly after installing filters.



Note

- To optimize the lifetime of the pre-filter, make sure it dries completely after cleaning.
- Wash your hands after handling the filter.

- 6 Put the pre-filter back into the air purifier (Fig. 8).



Note

- Make sure the side with the clip is pointing towards you, and that all hooks of the pre-filter are properly attached to the air purifier.

6 Replacing the filters

Filter replacement indicator

This air purifier is equipped with a filter replacement indicator to make sure that the air purification filter is in optimal condition when the air purifier is operating. When the filters need to be replaced, the filter code displays on the screen.

If the filters are not replaced in 14 days, the air purifier will stop operating and automatically lock.

Replacing the filters



Note

- The filters are not washable or reusable.
- Always turn off the air purifier and unplug from the electrical outlet before replacing the filters.
- Do not clean the filter with a vacuum.
- If the pre-filter is damaged, worn or broken, do not use. Visit www.philips.com/support or contact the Consumer Care Center in your country.

Filter alert light status	Action
A3 displays on the screen	Replace NanoProtect filter HEPA Series 3 (FY1410)
C7 displays on the screen	Replace NanoProtect filter Active Carbon (FY1413)
A3 and C7 display on the screen alternately	Replace both filters

- 1 Turn off the air purifier and unplug from the wall outlet.
- 2 Take out the used air filter according to the filter alert light status displayed on the screen (Fig. 27). Discard used filters.



Note

- Do not touch the pleated filter surface, or smell the filter as it has collected pollutants from the air.

- 3 Remove all packaging material from the new filter (Fig. 6).
- 4 Place the new filters into the air purifier (Fig. 7).
- 5 Put the plug of the air purifier in the wall outlet.
- 6 Touch and hold the  for 3 seconds to reset the filter lifetime counter (Fig. 28).
- 7 Wash your hands after changing a filter.







Note

- This air purifier has no other user-serviceable parts. For assistance, contact the Consumer Care Center in your country.

Filter reset

You can replace filters even if there is no filter replacement code displayed on the screen. After replacing a filter, you need to reset the filter lifetime counter manually.

- 1 Touch  and  simultaneously for 3 seconds to enter the filter reset mode (fig. 29).
 - ↳ Code (A3) of the NanoProtect filter HEPA Series 3 displays on the screen.
- 2 Touch and hold  for 3 seconds to force reset the filter lifetime counter of the NanoProtect filter HEPA Series 3 (fig. 28).
- 3 Code (C7) of the NanoProtect Active Carbon filter displays on the screen after the lifetime counter of the NanoProtect filter HEPA Series 3 filter has been reset (fig. 30).
- 4 Touch and hold  for 3 seconds to force reset the filter lifetime counter of the NanoProtect filter Active Carbon and exit the filter reset mode (fig. 31).



7 Storage

- 1 Turn off the air purifier and unplug from the wall outlet.
- 2 Clean the air purifier, air quality sensor and pre-filter (see chapter 'Cleaning').
- 3 Let all parts dry thoroughly before storing.
- 4 Wrap the filter and pre-filter separately in air tight plastic bags.
- 5 Store the air purifier, the filter and pre-filter in a cool, dry location.
- 6 Always thoroughly wash hands after handling filters.e

8 Troubleshooting

This chapter summarizes the most common problems you could encounter with the air purifier. If you are unable to solve the problem with the information below, visit www.philips.com/support or contact the Consumer Care Center in your country.

Problem	Possible solution
The air purifier does not work even though it is plugged in to the wall outlet and switched on.	<ul style="list-style-type: none"> • Try a different electrical outlet or check the wall switch. • The filter alert status is displaying the filter code. Replace the corresponding filter and reset the filter lifetime counter (see chapter "Replacing the filter"). • If the problem persists, visit www.philips.com/support or contact the Consumer Care Center in your country.
The air purifier does not work even though it is switched on.	<ul style="list-style-type: none"> • The filter replacement indicator has been on continuously but you have not replaced the corresponding filter, and the air purifier is now locked. In this case, replace the filter and reset the filter lifetime counter.
The air purifier accidentally powers off.	<ul style="list-style-type: none"> • The air purifier restarts automatically and goes to the previous mode when the power resumes.
The airflow that comes out of the air outlet is significantly weaker than before.	<ul style="list-style-type: none"> • The pre-filter is dirty. Clean the pre-filter (see chapter "Cleaning").
The air quality does not improve, even though the air purifier has been operating for a long time.	<ul style="list-style-type: none"> • One of the filters has not been placed in the air purifier or the filter is not placed properly. Make sure that all filters are properly installed in the following order, starting with the innermost filter: <ol style="list-style-type: none"> 1) NanoProtect filter HEPA Series 3 (FY1410); 2) NanoProtect filter Active Carbon (FY1413) 3) pre-filter. • The air quality sensor is wet. Make sure that the air quality sensor is clean and dry (see chapter "Cleaning").
The color of the air quality light always stays the same.	<ul style="list-style-type: none"> • The air quality sensor is dirty. Clean the air quality sensor (see chapter "Cleaning").

Problem	Possible solution
<p>The air purifier produces a unpleasant smell.</p>	<ul style="list-style-type: none"> • The first few times you use the air purifier, it may produce a plastic smell. This is normal. The air purifier may also produce an unpleasant smell when the filter is dirty. In this case, clean or replace the appropriate filter. • If the air purifier produces a burnt odor, switch OFF and unplug from the electrical outlet. Contact the Consumer Care Center in your country.
<p>The air purifier is loud.</p>	<ul style="list-style-type: none"> • If the air purifier is too loud, change the fan speed to a lower fan speed level. When using the air purifier in a bedroom at night, choose the night sensing mode or select a lower fan speed level.
<p>The air purifier still indicates that I need to replace a filter, but I already did.</p>	<ul style="list-style-type: none"> • Perhaps you did not reset the filter lifetime counter. Plug in the air purifier, touch  to switch on the air purifier, and touch and hold the  for 3 seconds.
<p>Error codes "E1", "E2", "E3" or "E4" displays on the screen.</p>	<ul style="list-style-type: none"> • The air purifier has malfunctions. Visit www.philips.com/support or contact the Consumer Care Center in your country.

9 Guarantee and service

If you need information or if you have a problem, please visit the Philips website at www.philips.com or contact the Philips Consumer Care Center in your country (you find its phone number in the worldwide guarantee leaflet). If there is no Consumer Care Centre in your country, go to your local Philips dealer.

Order parts or accessories

If you have to replace a part or want to purchase an additional part, go to your Philips dealer or visit www.philips.com/support.

If you have problems obtaining the parts, please contact the Philips Consumer Care Center in your country (you can find its phone number in the worldwide guarantee leaflet).

10 Notices

Electromagnetic fields (EMF)

This Philips appliance complies with all applicable standards and regulations regarding exposure to electromagnetic fields.

Compliance with EMF

Koninklijke Philips N.V. manufactures and sells many products targeted at consumers, which, like any electronic apparatus, in general have the ability to emit and receive electromagnetic signals.

One of Philips' leading Business Principles is to take all necessary health and safety measures for our products, to comply with all applicable legal requirements and to stay well within the EMF standards applicable at the time of producing the products.

Philips is committed to develop, produce and market products that cause no adverse health effects. Philips confirms that if its products are handled properly for their intended use, they are safe to use according to scientific evidence available today.

Philips plays an active role in the development of international EMF and safety standards, enabling Philips to anticipate further developments in standardization for early integration in its products.

Recycling

Do not throw away the product with the normal household waste at the end of its life, but hand it in at an official collection point for recycling. By doing this, you help to preserve the environment.

App Store is a service mark of Apple Inc.
Google Play is a trademark of Google Inc.

目錄

1 重要事項	18	9 保固與服務	27
		訂購零件或配件	27
2 您的空氣清淨機	20	10 聲明	27
產品概覽 (圖 ①)	20	電磁場 (EMF)	27
控制項目概覽 (圖 ②)	20	回收	27
3 快速入門	20		
安裝濾網	20		
4 使用空氣清淨機	21		
瞭解空氣品質指示燈	21		
開關機	21		
變更風速	21		
光源感測器	22		
夜間感應模式	22		
設定兒童鎖	22		
切換顯示模式	22		
5 清潔	23		
清潔空氣清淨機的機體	23		
清潔空氣品質感測器	23		
清潔前層濾網	23		
6 更換濾網	24		
濾網更換指示器	24		
更換濾網	24		
濾網重設	25		
7 收納	25		
8 疑難排解	26		

使用環保紙張。感謝您為守護樹木貢獻一份心力。

1 重要事項

在使用本產品前，請先仔細閱讀本使用手冊，並保留說明以供日後參考。

危險

- 請勿讓水或其他液體，或是易燃清潔劑進入產品內，以避免觸電和 / 或火災。
- 請勿用水、其他液體，或是 (易燃) 清潔劑清潔產品，以避免觸電和 / 或火災。
- 請勿在產品周圍噴灑殺蟲劑或芳香劑等任何易燃物質。

警示

- 在您連接電源之前，請檢查本地的電源電壓是否與產品所示的電壓相符。
- 如果電源線損壞，您必須將其交由飛利浦、飛利浦授權之服務中心，或是具備相同資格的技師進行更換，以免發生危險。
- 當插頭、電源線或產品本身受損時，請勿使用本產品。
- 本產品可供 8 歲以上孩童、身體官能或心智能力退化者，或是經驗與使用知識缺乏者使用，但需要有人在旁監督或適當指示如何安全使用本產品，以及可能遭受的危險。請勿讓孩童把玩本產品。若無人在旁監督，不得讓孩童清潔與維護本產品。

- 請勿在出風口上方或進風口前面放置物品，擋住進出風口。
- 確定沒有異物透過出風口掉入產品。

注意

- 本產品不可用來作為維持良好通風的設備、替代吸塵器清潔，或烹調時用來當作抽油煙機使用。
- 如果供應產品電力的電源插座接頭不良，產品插頭會發熱。請確定將產品插入接頭良好的插座。
- 請將本產品放置在乾燥平穩的水平面上使用。
- 產品的背面及側面須至少保留 20 公分的間隔距離，頂部則至少保留 30 公分的間隔距離。
- 產品頂部請勿放置任何物品。
- 請勿坐在或站在產品上。站或坐在本產品上可能引發潛在傷害。
- 請勿將產品放置在冷氣機正下方，以免冷氣機滴水，造成產品發生水滴凝結的現象。
- 請在開啟產品電源前，先確認所有濾網皆已正確安裝。
- 請僅使用產品專用的飛利浦原廠濾網。請勿使用其他濾網。

- 燃燒濾網可能會對人體造成不可逆危險和/或危及其他生命。請勿將濾網當成燃料，或以類似目的使用濾網。
- 切勿使用硬物敲打產品 (特別是進風口及出風口)。
- 請務必使用產品背面的握把提起或搬動產品。
- 請勿將手指或物體插入出風口或進風口，以避免身體受傷或損壞產品。
- 當您使用室內噴霧式驅蟲劑或在充滿油漬、燒香、香煙的火星或化學煙霧的地方時，請勿使用本產品。
- 請勿在氣體用品、加熱裝置或壁爐附近使用本產品。
- 使用完畢後，以及在進行清潔或其他維修或更換濾網之前，請務必先拔除產品的電源插頭。
- 請勿在溫差變化極大的室內使用本產品，因為室溫差距太大會造成本產品內部凝結水珠。
- 請將本產品遠離使用無線電電波的電器至少 2 公尺以避免干擾，例如電視、無線電廣播、無線電信號控制的時鐘。
- 本產品為家用產品，僅限於在正常操作環境下使用。
- 請勿在極為潮濕或周遭溫度很高的環境下使用本產品，例如浴室、廁所或廚房。
- 本產品無法清除一氧化碳 (CO) 或氫氣 (Rn)。發生燃燒意外及危險化學物品意外時，本產品無法當作安全裝置使用。
- 若您需要搬動產品，請先切斷產品電源供應。
- 請勿以拉動電源線的方式移動本產品。
- 更換或清潔濾網之後請務必徹底洗淨雙手。

2 您的空氣清淨機

感謝您購買本產品。歡迎來到飛利浦的世界！

請至 www.philips.com/welcome 註冊您的產品，以獲得飛利浦提供的完整支援。

產品概覽 (圖 ①)

- A 控制面板
- B 空氣品質指示燈
- C 出風口
- D 空氣品質感測器
- E 奈米級勁護 HEPA S3型濾網 (FY1410)
- F 奈米級勁護 活性炭濾網 (FY1413)
- G 前層濾網
- H 進風口
- I 前面板

控制項目概覽 (圖 ②)

- J 開/關按鈕
- K 夜間感應模式按鈕
- L 顯示畫面
- M 風速按鈕
- N 兒童鎖按鈕

3 快速入門

安裝濾網

備註

- 請確定已從電源插座拔除空氣清淨機的電源插頭後，再安裝濾網。
- 請確認濾網有拉片的一側朝向自己。

- 1 拉出正面護板的底部，將它從空氣清淨機輕輕提起取出 (圖 ③)。
- 2 按壓固定夾 (1)，再朝自己的方向拉出前層濾網 (2) (圖 ④)。
- 3 取出所有濾網 (圖 ⑤)。
- 4 拆下濾網的所有包裝材料 (圖 ⑥)。
- 5 將較厚的 HEPA 濾網 (FY1410) 裝至空氣清淨機，然後裝上較薄的活性炭濾網 (FY1413) (圖 ⑦)。在每個濾網上皆會顯示型號。
- 6 將前層濾網裝回空氣清淨機 (圖 ⑧)。

備註

- 請確認具固定夾的一側朝向自己，且前層濾網的所有扣鉤皆已正確裝入清淨機。

- 7 重新裝入正面護板，請先將護板頂部壓入空氣清淨機頂部 (1)。接著，輕輕將護板輕推入空氣清淨機機體 (2) (圖 ⑨)。
- 8 裝好濾網後，請徹底清潔雙手。

4 使用空氣清淨機

瞭解空氣品質指示燈

室內過敏原指數 (IAI) 為即時的數字顯示，對室內過敏原等級提供立即可見的回饋資訊。IAI 指數表示透過室內顆粒污染物濃度所轉換出的室內實際潛在過敏原風險等級。

IAI	PM2.5	空氣品質指示燈顏色	空氣品質等級
1-3	0-12	藍色	很棒
4-6	13-35	紫羅蘭色	普通
7-9	36-55	紫紅色	不良
10-12	>56	紅色	非常不良

空氣清淨機電源開啟後，空氣品質指示燈會自動亮起，並依序閃爍所有燈色。在約 30 秒後，空氣品質感測器會選擇符合周遭空氣粒子品質的相應顏色。

開關機

備註

- 請務必將空氣清淨機放在平穩的水平表面上，產品正面背對牆壁或家具。
- 為達最佳淨化效能，請關閉門窗。
- 進風口或出風口需遠離窗簾。

1 將空氣清淨機的插頭插入電源插座。

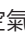
2 按下  以開啟空氣清淨機的電源 (圖 10)。

- ↳ 空氣清淨機會發出嗶聲。
- ↳ 空氣清淨機預設以自動模式運作。
- ↳ 空氣清淨機正在暖機時，螢幕上會顯示「--」。
- ↳ 測量空氣品質約 30 秒後，空氣品質感測器會自動選擇適當的空氣品質指示燈顏色。

3 按住  3 秒鐘即可關閉空氣清淨機的電源。

備註

- 如果空氣清淨機在關閉之後保持連接至電源插座，則當空氣清淨機再次開啟時，會以先前的設定運作。
- 如果空氣清淨機在運轉期間意外關閉，系統會自動重新啟動，並在恢復供電後以先前的設定繼續運作。

變更風速



有多種風扇速度可選擇。您可以選擇自動模式，有速度 1、2、3 或加速增強模式 (t)。

自動 (A)

- 重複按下風速按鈕 ，選擇自動模式 (圖 11)。

過敏原模式

經特殊設計的過敏原模式可有效減少常見的過敏原，例如花粉和寵物皮屑。

- 按下風速按鈕 ，選擇過敏原模式 (圖 12)。
- ↳ 螢幕上會顯示自動 (A) 和 。

手動

- 重複按下風速按鈕 ，選擇所需風速 (圖 13)。

加速增強 (t)

在加速增強模式下，空氣清淨機會以最高速度運作。

- 按下風速按鈕 ，選擇加速增強模式 (t) (圖 14)。

光源感測器

配備光線感應器的空氣清淨機可根據環境光線變化運作。

環境光線變暗 10 秒後，控制面板上的所有指示燈將會慢慢熄滅。在此期間，只要觸控任何按鈕，所有指示燈即會再度亮起。如果您在 10 秒鐘內沒有執行其他操作，所有指示燈將會熄滅。

環境光線變明亮且持續至少 10 秒之後，所有指示燈會再度亮起。

夜間感應模式

有兩種方式可以啟動夜間感應模式。



手動啟動夜間感應模式

- 在上床之前，請先觸控  以手動啟動夜間感應模式 (圖 15)。
 - ↳ 如果空氣品質指示燈顯示為藍色，空氣清淨機會直接進入夜間感應模式。空氣清淨機會安靜運作，且空氣品質指示燈將會變暗。
 - ↳ 如果空氣品質指示燈不是顯示藍色，空氣清淨機會在加速增強模式下運作最長達 10 分鐘，在這段期間空氣品質指示燈會緩慢閃爍，然後進入夜間感應模式。



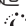

自動啟動夜間感應模式

當空氣清淨機以自動模式或過敏原模式運作期間，若光線感應器因偵測到室內有光線而熄滅時，空氣清淨機會自動進入夜間感應模式。空氣清淨機會即時調整風速，確保室內空氣品質良好。空氣品質指示燈將會變暗。

備註

- 光線感應器會在夜間感應模式下運轉 11 小時後偵測室內光線。
- 如果您的室內電燈開啟，空氣清淨機將離開夜間感應模式，並以先前模式運作。空氣品質指示燈和顯示螢幕會再度亮起。
- 若要手動退出夜間感應模式，觸控  或  按鈕。

設定兒童鎖

- 1 按住兒童鎖按鈕  3 秒鐘，可啟動兒童鎖 (圖 16)。
 - ↳ 螢幕會顯示兒童鎖圖示 。
 - ↳ 兒童鎖啟用時，所有其他按鈕都不會有反應，僅有兒童鎖圖示  會閃爍。
- 2 再次按住兒童鎖按鈕  3 秒鐘，即可停用兒童鎖 (圖 17)。
 - ↳ 兒童鎖圖示  會消失。

備註



- 當螢幕上顯示前層濾網清潔代碼或濾網更換代碼時，兒童鎖功能會自動解除鎖定。

切換顯示模式

空氣清淨機具有雙顯示模式，即 IAI 顯示以及 PM2.5 顯示。

備註

- 空氣清淨機預設為以 IAI 顯示模式運作。
- 如果 PM2.5 等級高於 99，螢幕會顯示「--」。

- 1 觸控  3 秒鐘即可切換至 PM2.5 顯示模式 (圖 18)。
 - ↳ 螢幕會顯示實際的 PM2.5 等級。
- 2 再次觸控  3 秒鐘，即會切換回 IAI 顯示模式 (圖 19)。
 - ↳ 螢幕會顯示 IAI 等級。

5 清潔

備註

- 清潔空氣清淨機之前，務必先關閉電源，並從電源插座拔掉插頭。
- 切勿讓空氣清淨機浸入水或其他液體中。
- 切勿使用漂白劑或酒精等具磨蝕性、刺激性或易燃洗劑清潔空氣清淨機的任何部分。
- 只有前層濾網可水洗。空氣濾網不可水洗。
- 請勿試圖以吸塵器清理濾網或空氣品質感測器。

清潔空氣清淨機的機體

定期清潔空氣清淨機的內部與外殼，可避免累積灰塵。

- 1 使用柔軟乾布清潔空氣清淨機的內外部。
- 2 出風口亦可使用柔軟乾布清潔。
- 3 拆下空氣清淨機的前蓋，並以流動的自來水清洗。

清潔空氣品質感測器

每 2 個月清理一次空氣品質感測器，可確保清淨機發揮最佳效果。

備註

- 若在佈滿灰塵的環境中使用空氣清淨機，可能需要更常清潔。
- 若房間溼度過高，空氣品質感測器可能有水滴凝結，在這種情況下，即使空氣品質良好，空氣品質指示燈也可能指示空氣品質不佳。若發生此種情形，請清潔空氣品質感測器，或以手動風速設定使用本空氣清淨機。

- 1 關閉空氣清淨機的電源，從電源插座拔掉插頭。
- 2 使用軟刷來清潔空氣品質感測器的進風口及出風口 (圖 20)。
- 3 取下空氣品質感測器的護蓋 (圖 21)。
- 4 使用溼棉棒清潔空氣品質感測器、覆有灰塵的進風口和出風口 (圖 22)。
- 5 使用乾棉棒擦乾所有零件。
- 6 重新裝上空氣品質感測器的護蓋 (圖 23)。

備註

- 空氣清淨機運作時，空氣品質感測器的護蓋務必要關上。

清潔前層濾網

當螢幕顯示 FO 時，請清潔前層濾網 (圖 24)。

- 1 關閉空氣清淨機的電源，從電源插座拔掉插頭。
- 2 拉出正面護板的底部，將它從空氣清淨機輕輕提起取出 (圖 3)。
- 3 按壓固定夾 (1)，再朝自己的方向拉出前層濾網 (2) (圖 4)。
- 4 如果前層濾網很髒，請使用軟刷來清除灰塵。接著，以流動的自來水清洗前層濾網 (圖 25)。
- 5 先確保前層濾網徹底風乾後，再放回空氣清淨機。

備註

- 為使前層濾網壽命最佳化，清潔後請確認濾網完全乾燥。
- 裝卸濾網後請洗手。

- 6 將前層濾網裝回空氣清淨機 (圖 8)。

備註

- 請確認有固定夾的一側朝向自己，且前層濾網的所有扣鉤皆已正確裝入空氣清淨機。

- 若要重新裝入正面護板，請先將護板頂部壓入空氣清淨機頂部 (1)。接著，輕輕將護板輕推入空氣清淨機機體 (2) (圖 9)。
- 將空氣清淨機的插頭插入電源插座。
- 按住  3 秒鐘，可重設前層濾網清潔時間 (圖 26)。
- 裝好濾網後，請徹底清潔雙手。

6 更換濾網

濾網更換指示器

本空氣清淨機配備了濾網更換指示燈，用以確保空氣清淨機運作時空氣淨化濾網處於最佳狀態。濾網需要更換時，螢幕上會顯示濾網代碼。

如果沒有在 14 天內更換濾網，空氣清淨機會停止運作，並自動鎖定。

更換濾網

備註

- HEPA 和活性炭濾網皆不得水洗或重複使用。
- 更換濾網前，請務必關閉空氣清淨機電源，再從電源插座拔掉插頭。
- 請勿使用吸塵器清潔濾網。
- 如果前層濾網損壞、磨損或破裂，則請勿使用。請造訪 www.philips.com/support 或聯絡您所在國家/地區的客戶服務中心。

濾網警示燈狀態	動作
螢幕上顯示 A3	更換奈米級勁護 HEPA S3型濾網 (FY1410)
螢幕上顯示 C7	更換奈米級勁護 活性炭濾網 (FY1413)
A3 和 C7 會交替在螢幕上顯示	更換兩個濾網

- 關閉空氣清淨機的電源，從電源插座拔掉插頭。
- 根據螢幕顯示的濾網警示燈狀態，取出用過的空氣濾網 (圖 27)。丟棄用過的濾網。

備註

- 請勿碰觸有皺摺的濾網表面或嗅聞濾網，因為它收集了空氣中的污染物。





- 3 拆下新濾網的所有包裝材料 (圖 6)。
- 4 將新濾網裝至空氣清淨機 (圖 7)。
- 5 將空氣清淨機的插頭插入電源插座。
- 6 按住  3 秒鐘，可重設濾網使用壽命計數器 (圖 28)。
- 7 更換濾網後請清洗雙手。

備註

- 此空氣清淨機沒有其他使用者可自行維修的零件。如需協助，請聯絡您所在國家/地區的客戶服務中心。

濾網重設

即使螢幕未顯示濾網更換代碼，您仍可以更換濾網。更換濾網後，您需要手動重設濾網使用壽命計數器。

- 1 同時按下  和  3 秒鐘，可進入濾網重設模式 (圖 29)。
↳ 螢幕會顯示奈米級勁護 HEPA S3 型濾網的代碼 (A3)。
- 2 按住  3 秒鐘，可強制重設奈米級勁護 HEPA S3 型濾網的使用壽命計數器 (圖 28)。
- 3 在重設奈米級勁護 HEPA S3 型濾網的使用壽命計數器後，螢幕會顯示奈米級勁護 活性炭濾網的代碼 (C7) (圖 30)。
- 4 按住  3 秒鐘，可強制重設奈米級勁護 活性炭濾網的使用壽命計數器，並退出濾網重設模式 (圖 31)。

7 收納

- 1 關閉空氣清淨機的電源，從電源插座拔掉插頭。
- 2 清潔空氣清淨機、空氣品質感測器和前層濾網 (參閱「清潔」單元)。
- 3 收納之前，請確保所有零件徹底乾燥。
- 4 將濾網和前層濾網分別包在氣密塑膠袋中。
- 5 將空氣清淨機、濾網和前層濾網存放在涼爽乾燥處。
- 6 接觸過濾網後，請務必徹底清洗雙手。

8 疑難排解

本單元概述您使用空氣清淨機時最常遇到的問題。如果下方資訊無法解決您遇到的問題，請造訪 www.philips.com/support 或聯絡您所在國家/地區的客戶服務中心。

問題	可能的解決方法
即使空氣清淨機已插電且電源已開啟，仍無法運作。	<ul style="list-style-type: none">嘗試插入不同的電源插座或檢查電源開關。濾網警示狀態會顯示濾網代碼。更換相應濾網，並重設濾網壽命計數器 (參閱「更換濾網」單元)。如果問題持續發生，請造訪 www.philips.com/support 或聯絡您所在國家/地區的客戶服務中心。
即使空氣清淨機電源已開啟，仍無法運作。	<ul style="list-style-type: none">濾網更換指示燈持續亮起，但卻未更換相應濾網，如今空氣清淨機已鎖定。在此情況下，請更換濾網並重設濾網壽命計數器。
空氣清淨機電源意外關閉。	<ul style="list-style-type: none">空氣清淨機自動重新啟動，並在電源恢復時進入先前的模式。
出風口流出的風速比之前慢很多。	<ul style="list-style-type: none">前層濾網髒污。清潔前層濾網 (參閱「清潔」單元)。
即使空氣清淨機已經長時間運作，空氣品質仍未獲得改善。	<ul style="list-style-type: none">其中一個濾網尚未裝在空氣清淨機中或濾網未妥善安裝。請確認所有濾網都已按照下列順序正確安裝，濾網從內至外分別為：1) 奈米級勁護 HEPA S3型濾網 (FY1410)；2) 奈米級勁護 活性碳濾網 (FY1413)；3) 前層濾網。空氣品質感測器潮溼。請確認空氣品質感測器乾淨且乾燥 (參閱「清潔」單元)。
空氣品質指示燈的顏色一直維持不變。	<ul style="list-style-type: none">空氣品質感測器髒污。清潔空氣品質感測器 (參閱「清潔」單元)。
空氣清淨機產生異味。	<ul style="list-style-type: none">使用空氣清淨機的前幾分鐘，可能會產生塑膠味。這是正常現象。濾網髒污時，空氣清淨機可能也會產生異味。在此情況下，請清潔或更換濾網。若空氣清淨機產生燒焦味，請關機並拔掉插頭。請聯絡您所在國家/地區的客戶服務中心。
空氣清淨機聲音過大。	<ul style="list-style-type: none">如果空氣清淨機聲音過大，可將風速變更為較低的速度等級。夜間於臥室使用空氣清淨機時，請選擇夜間感應模式或選擇風速較低的速度等級。
空氣清淨機不斷要求更換濾網，但濾網已經更換了。	<ul style="list-style-type: none">您或許未重設濾網壽命計數器。將空氣清淨機插上電源，觸控  以開啟空氣清淨機的電源，然後按住  3 秒鐘。
螢幕顯示錯誤代碼「E1」、「E2」、「E3」或「E4」。	<ul style="list-style-type: none">空氣清淨機故障。請造訪 www.philips.com/support 或聯絡您所在國家/地區的客戶服務中心。

9 保固與服務

若您需要相關資訊，或是有任何問題，請造訪飛利浦網站：www.philips.com，或聯絡您所在國家/地區的飛利浦客戶服務中心（您可在全球保證書上找到電話號碼）。若當地沒有客戶服務中心，請洽詢當地的飛利浦經銷商。

訂購零件或配件

如果您必須更換零件或想購買其他零件，請聯絡您的飛利浦經銷商，或造訪 www.philips.com/support。

如果您有取得零件方面的問題，請聯絡您所在國家/地區的飛利浦客戶服務中心（您可在全球保證書上找到電話號碼）。

10 聲明

電磁場 (EMF)

本飛利浦產品符合所有電磁場暴露的相關適用標準和法規。

符合 EMF 標準

Koninklijke Philips N.V. 製造銷售多項消費性產品，這些產品就如同其他電器，通常能收發電磁訊號。

飛利浦的一大企業原則，就是針對自身的產品進行必要的健康與安全檢測，以符合所有適用的法律規定，以及在產品生產期間符合適用的 EMF 標準。

飛利浦致力於開發、生產及銷售不危害健康的產品。飛利浦保證，只要依照正確用途並妥善使用，根據現有的科學研究資料，使用本公司產品並無安全顧慮。

飛利浦積極參與國際 EMF 與安全標準的開發，因此得以掌握標準化的發展，及早將標準化與自身的產品整合。

回收

本產品使用壽命結束時，請勿與一般家庭廢棄物一併丟棄。請將該產品送至政府指定的回收點或進行回收。此舉能為環保盡一份心力。

App Store 是 Apple Inc 的服務標章。

Google Play 是 Google Inc 的商標。

設備名稱：飛利浦空氣清淨機， 型號 (型式)：AC1213 Equipment name Type designation (Type)						
單元 Unit	限用物質及其化學符號 Restricted substances and its chemical symbols					
	鉛 Lead (Pb)	汞 Mercury (Hg)	鎘 Cadmium (Cd)	六價鉻 Hexavalent chromium (Cr ⁶⁺)	多溴聯苯 Polybrominated biphenyls (PBB)	多溴二苯醚 Polybrominated diphenyl ethers (PBDE)
電源線 power cord	○	○	○	○	○	○
馬達 motor	○	○	○	○	○	○
電路板 PCBA	○	○	○	○	○	○
外殼 plastic	○	○	○	○	○	○
備考1：“超出0.1 wt %”及“超出0.01 wt %”係指限用物質之百分比含量超出百分比含量基準值。 Note 1: "Exceeding 0.1 wt %" and "exceeding 0.01 wt %" indicate that the percentage content of the restricted substance exceeds the reference percentage value of presence condition.						
備考2：“○”係指該項限用物質之百分比含量未超出百分比含量基準值。 Note 2: "○" indicates that the percentage content of the restricted substance does not exceed the percentage of reference value of presence.						
備考3：“-”係指該項限用物質為排除項目。 Note 3: The "-" indicates that the restricted substance corresponds to the exemption.						