

ENGLISH

HQ 564/563
Philishave
Cool Skin

Instructions for use

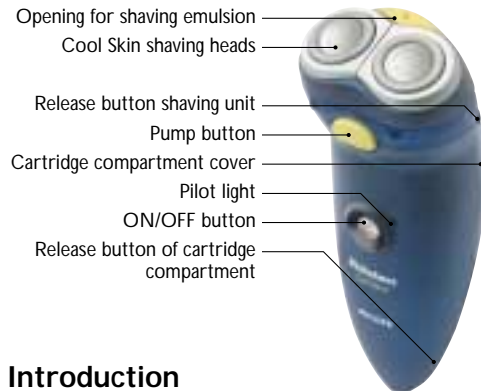

Introduction

Cool Skin is a new shaving system by Philishave. The shaver has a special compartment for cartridges containing Nivea for Men moisturising shaving emulsion. This emulsion is applied to the skin during shaving. The Nivea for Men shaving emulsion prepares the skin and beard for the shave, ensuring that the shaver moves smoothly over your face and makes perfect contact with the skin. You will enjoy an unexpectedly close and comfortable shave and your skin will feel soft and fresh afterwards. After shaving, you can clean the appliance by simply rinsing it under a hot tap.

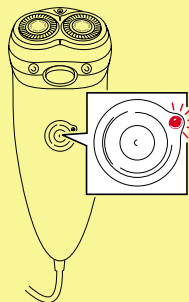

Important

Allow your skin at least two weeks to become accustomed to the Philishave shaving system. Do not press the shaver too hard against the skin while shaving!

With this shaving system, you can shave when your skin is either wet or dry. The Nivea for Men shaving emulsion has an immediately moisturising effect on the skin.

Remove the cartridge and clean the shaver if you are not going to use the appliance for more than one week.

To obtain the best shaving results, it is necessary to follow the instructions in the 'Cleaning and maintenance' section.

Charging the shaver

Important: only leave the shaver to charge in a dry place!

First put the plug in the appliance and then put the Powerplug in the socket. The Powerplug has an automatic voltage selector and is suitable for mains voltages ranging from 100 to 240 Volts. The pilot light near the ON/OFF button will go on. It will take the appliance approximately 8 hours to recharge completely. A fully recharged shaver has a shaving time of approximately 30 minutes. The shaver has been equipped with a 'battery low' indication: the pilot light will light up when the battery is running low.

About the built-in battery

The shaver has been equipped with a built-in rechargeable battery. To prolong the life of the battery, recharge and store the appliance at a temperature between +5°C and +35°C. Also make sure that you disconnect the shaver from the mains when you are not recharging it.

Inserting the cartridge

The cartridges with moisturising Nivea for Men shaving emulsion are available in boxes containing five cartridges and one plastic connector. Do not throw the connector away; you will need it for all five cartridges!

Use only Philishave Nivea for Men Cool Skin cartridges (HQ 150).

Inserting the first cartridge

Take one cartridge from the box. Take the connector (supplied in the same box) out of its bag and push it into the cartridge until it seats with a click.

Push the release slide downwards and remove the cover from the cartridge compartment.

Slide the cartridge with inserted connector into the shaver. Replace the cover and close it.

Replacing an empty cartridge

Push the release slide downwards and remove the cover from the cartridge compartment. Remove the empty cartridge and pull out the connector. Note: do not throw the connector away!

Insert the connector into a new cartridge. It has been properly inserted when it seats with a click.

Slide the new cartridge with the connector into the shaver. Replace the cover and close it.

About the cartridge

The Nivea for Men shaving emulsion in this cartridge will keep when it is stored at a temperature between 0°C and +40°C.

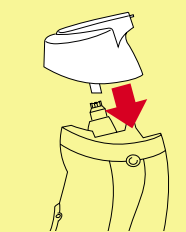
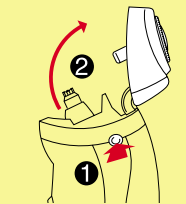
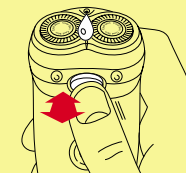
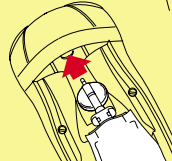
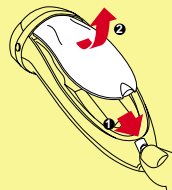
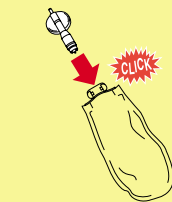

4222 001 83073

Shaving

Switch on the shaver by pressing the ON/OFF button. Hold the shaver against the skin.

Press the yellow pump button to apply Nivea for Men shaving emulsion to the skin. When sufficient shaving emulsion has been released, start moving the shaving heads rapidly over your skin, making both straight and circular movements.

The shaver is suitable for use in the shower.

Grooming sideburns and moustaches

Trimmer

The shaver has a separate trimmer for grooming sideburns and moustaches.

Fitting the trimmer onto the shaver

Switch off the shaver. Clean the shaver before you assemble the trimmer.

Press the release button and pull the shaving unit off the shaver.

Fit the trimmer onto the shaver.

Removing the trimmer

Press the release button and remove the trimmer.

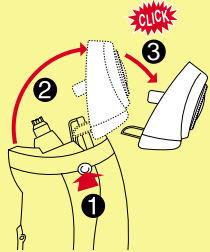

Cleaning and maintenance

If you were charging the appliance, pull the Powerplug out of the wall socket and remove the appliance plug from the shaver .

Clean the shaving unit with very hot water after every shave.

The shaver is fully water resistant and therefore allows easy and quick cleaning.

Important: the Powerplug is not waterproof. Prevent it from getting wet and do not immerse it in water!

Shaving unit

- Press the release button and flip the shaving unit open. If the shaving unit comes detached from the appliance, reattach it by holding it at right angles to the top of the shaver and then reinsert the two projections into the guiding slots.

- Clean the inside of the shaver by rinsing it under a hot tap for some time.

- Rinse the outside of the appliance.

Important: make sure the inside of the shaving unit is really clean.

Close the shaving unit again. Shake off excess water.

Trimmer

Clean the outside of the trimmer with a brush every time you use it. Lubricate the trimmer teeth with a drop of sewing machine oil every six months.

- Flip the trimmer open to clean it on the inside.

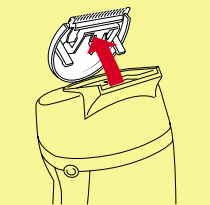
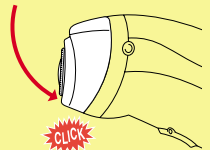
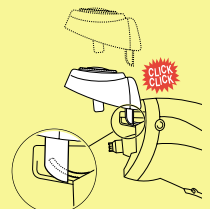

Storage

The pouch has been designed to hold the appliance, its dust cover, two spare cartridges and the Powerplug. The pouch is washable; wash it separately (see washing instructions on the inside of the pouch).

Disposing of the battery

When you discard your shaver in due course, please make sure that the battery is not thrown away with the normal household waste. Remove the battery from the shaver and hand it in at an official collection point.

Tip: you may also take or send your Philishave Cool Skin shaver to a Philips Service Centre. There, the battery will be removed and disposed of in an environmentally safe way.

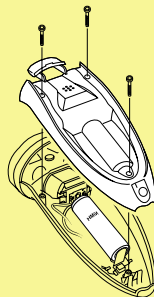

Removing the battery

Before you remove the battery, it must be fully discharged. Let the shaver run until it stops.

- Remove the screws.

- Open the shaver.

- Remove the battery.

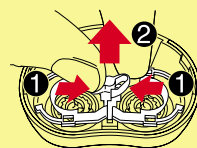

Troubleshooting

Shaving heads do not move smoothly over the skin

Cause: not enough Nivea for Men shaving emulsion has been applied.

- Press the pump button a few times until a sufficient amount of Nivea for Men shaving emulsion has been released to allow the shaving heads to move smoothly over your skin again.

Reduced shaving performance

Cause 1: the shaving heads are dirty

- The shaver has not been cleaned immediately after use and/or has not been rinsed long enough or hot enough. Clean the shaver thoroughly before you continue shaving (see 'Cleaning and maintenance').

Cause 2: long hairs are obstructing the shaving heads

– Clean the cutters and guards

- Remove the retaining plate. Do not clean more than one cutter and guard at a time, since they are all matching sets. If you accidentally mix up the cutters and the guards, it may take several weeks before optimal shaving performance is restored.

- Remove the hairs with the brush supplied.

Cause 3: shaving heads are damaged or worn

– Replace the shaving heads

- Remove the retaining plate. Remove the old shaving heads from the shaving unit and replace them with new ones. Damaged or worn shaving heads (cutters and guards) must only be replaced by the original Philishave Cool Skin shaving heads (HQ 156)!

- Put the retaining plate back onto the shaving unit.

Cover of cartridge compartment cannot be closed

Cause 1: the cartridge has not been inserted correctly

- Insert the cartridge correctly. The cartridge only fits properly into the shaver in one way.

Cause 2: The cartridge has not been pushed far enough into the shaver.

- Press the cartridge until it is properly fixed.

Shaver does not work when the ON/OFF button is pressed

Cause 1: the battery is empty

- Recharge the battery.

Cause 2: the appliance is connected to the mains.

- Remove the Powerplug from the wall socket and pull the appliance plug out of the shaver.

The Nivea for Men shaving emulsion has lost its colour or has turned watery.

Cause: the Nivea for Men shaving emulsion has not been preserved at the right temperature.

In case of other problems

Please visit the Philips Web site at www.philips.com or consult the Philips Customer Care Centre in your country (you will find its phonenumber in the worldwide guarantee leaflet). If there is no Customer Care Centre in your country, turn to your local Philips dealer or contact the Service Department of Philips Domestic Appliances and Personal Care BV..

Beiersdorf, **BDF** and Nivea for Men are registered trademarks of Beiersdorf AG. All other trademarks are owned by Philips Electronics N.V.



100% recycled paper