

# Always there to help you

Register your product and get support at  
[www.philips.com/welcome](http://www.philips.com/welcome)



HTD5520  
HTD5550  
HTD5580

# User manual

**PHILIPS**



# Contents

---

<b>1 Important</b>	2	<b>7 Product specifications</b>	20
Safety	2		
Care for your product	3		
Care of the environment	3		

---

<b>2 Your home theater</b>	4	<b>8 Troubleshooting</b>	22
Main unit	4		
Remote control	4		
Connectors	5		

---

<b>3 Connect and set up</b>	6	<b>9 Notice</b>	24
Connect speakers	6	Copyright	24
Connect to TV	7	Trademarks	24
Connect audio from TV and other devices	8		
Set up speakers	9		
Set up EasyLink (HDMI-CEC control)	9		

---

<b>4 Use your home theater</b>	11	<b>10 Language code</b>	26
Discs	11		
Data files	12		
Play audio through Bluetooth	12		
USB storage devices	13		
Audio, video, and picture options	13		
Radio	14		
MP3 player	15		
Karaoke	15		
Choose sound	16		

---

<b>5 Change settings</b>	17	<b>11 Index</b>	27
Language settings	17		
Picture and video settings	17		
Audio settings	18		
Parental control settings	18		
Display settings	18		
Energy saving settings	18		
Restore default settings	19		

---

<b>6 Update software</b>	19		
Check software version	19		
Update software through USB	19		

# 1 Important

Read and understand all instructions before you use your home theater. If damage is caused by failure to follow instructions, the warranty does not apply.

---

## Safety

### Risk of electric shock or fire!

- Never expose the product and accessories to rain or water. Never place liquid containers, such as vases, near the product. If liquids are spilt on or into the product, disconnect it from the power outlet immediately. Contact Philips Consumer Care to have the product checked before use.
- Never place the product and accessories near naked flames or other heat sources, including direct sunlight.
- Never insert objects into the ventilation slots or other openings on the product.
- Where the mains plug or an appliance coupler is used as the disconnect device, the disconnect device shall remain readily operable.
- Batteries (battery pack or batteries installed) shall not be exposed to excessive heat such as sunshine, fire or the like.
- Disconnect the product from the power outlet before lightning storms.
- When you disconnect the power cord, always pull the plug, never the cable.

### Risk of short circuit or fire!

- Before you connect the product to the power outlet, ensure that the power voltage matches the value printed on the back or bottom of the product. Never connect the product to the power outlet if the voltage is different.

### Risk of injury or damage to the home theater!

- For wall-mountable products, use only the supplied wall mount bracket. Secure the wall mount to a wall that can support the combined weight of the product and the wall mount. Koninklijke Philips Electronics N.V. bears no responsibility for improper wall mounting that results in accident, injury or damage.
- For speakers with stands, use only the supplied stands. Secure the stands to the speakers tightly. Place the assembled stands on flat, level surfaces that can support the combined weight of the speaker and stand.
- Never place the product or any objects on power cords or on other electrical equipment.
- If the product is transported in temperatures below 5°C, unpack the product and wait until its temperature matches room temperature before connecting it to the power outlet.
- Visible and invisible laser radiation when open. Avoid exposure to beam.
- Do not touch the disc optical lens inside the disc compartment.
- Parts of this product can be made of glass. Handle with care to avoid injury and damage.

### Risk of overheating!

- Never install this product in a confined space. Always leave a space of at least four inches around the product for ventilation. Ensure curtains or other objects never cover the ventilation slots on the product.

### Risk of contamination!

- Do not mix batteries (old and new or carbon and alkaine, etc.).
- Danger of explosion if batteries are incorrectly replaced. Replace only with the same or equivalent type.
- Remove batteries if they are exhausted or if the remote control is not to be used for a long time.
- Batteries contain chemical substances, they should be disposed of properly.

### Risk of swallowing batteries!

- The product/remote control may contain a coin/button type battery, which can be swallowed. Keep the battery out of reach of children at all times! If swallowed, the battery can cause serious injury or death. Severe internal burns can occur within two hours of ingestion.
- If you suspect that a battery has been swallowed or placed inside any part of the body, seek immediate medical attention.
- When you change the batteries, always keep all new and used batteries out of reach of children. Ensure that the battery compartment is completely secure after you replace the battery.
- If the battery compartment cannot be completely secured, discontinue use of the product. Keep out of reach of children and contact the manufacturer.



This is CLASS II apparatus with double insulation, and no protective earth provided.

---

## Care for your product

- Do not insert any objects other than discs into the disc compartment.
- Do not insert warped or cracked discs into the disc compartment.
- Remove discs from the disc compartment if you are not using the product for an extended period of time.
- Use only microfiber cloth to clean the product.

---

## Care of the environment



Your product is designed and manufactured with high quality materials and components, which can be recycled and reused.

Never dispose of your product with other household waste. Please inform yourself about the local rules on the separate collection of electrical and electronic products and batteries. The correct disposal of these products helps prevent potentially negative consequences on the environment and human health.

Your product contains batteries, which cannot be disposed of with normal household waste. Please inform yourself about the local rules on separate collection of batteries. The correct disposal of batteries helps prevent potentially negative consequences on the environment and human health.

Please visit [www.recycle.philips.com](http://www.recycle.philips.com) for additional information on a recycling center in your area.

# 2 Your home theater

Congratulations on your purchase, and welcome to Philips! To fully benefit from the support that Philips offers, register your home theater at [www.philips.com/welcome](http://www.philips.com/welcome).

## Main unit

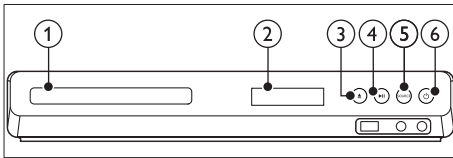

- ① Disc compartment
- ② Display panel
- ③ ▲ (Open/Close)  
Open or close the disc compartment, or eject the disc.
- ④ ▶|| (Play/Pause)  
Start, pause or resume play.
- ⑤ SOURCE  
Select an audio or video source for the home theater.
- ⑥ ⏻ (Standby-On)  
Switch the home theater on or to standby.

Front panel display	Indication
HOME	Home
RADIO	Radio
DISC	Disc
AUX	Aux In
OPT I	Optical In
AUD IO	Audio In
OPEN	Open
CLOSE	Close
LOAD	Load

Front panel display	Indication
PAUSE	Pause
----	Mute

## Remote control

This section includes an overview of the remote control.

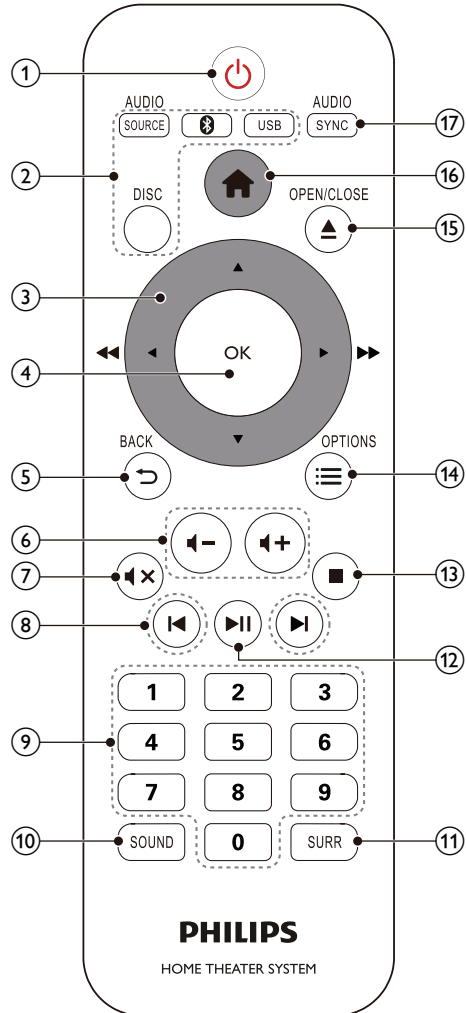

- ① **⏻ (Standby-On)**
  - Switch the home theater on or to standby.
  - When EasyLink is enabled, press and hold for at least three seconds to switch all connected HDMI CEC compliant devices to standby.
- ② **Source buttons**
  - **DISC:** Switch to disc source. Access or exit the disc menu when you play a disc.
  - **AUDIO SOURCE:** Select an audio input source, or radio.
  - **Ⓚ:** Switch to Bluetooth
  - **USB:** Switch to USB storage device.
- ③ **Navigation buttons**
  - Navigate menus.
  - In video mode, press left or right to fast backward or fast forward; press up or down to slow forward or slow backward (for DVD video only).
  - In radio mode, press left or right to search a radio station; press up or down to fine tune a radio frequency.

- ④ **OK**  
Confirm an entry.
- ⑤ **↶ BACK**  
Return to a previous menu screen.
- ⑥ **⏪ +/-**  
Increase or decrease volume.
- ⑦ **⏻ (Mute)**  
Mute or restore volume.
- ⑧ **⏮ / ⏭ (Previous/Next)**
  - Skip to the previous or next track, chapter or file.
  - In radio mode, select a preset radio station.
- ⑨ **Numeric buttons**  
Select an item to play.
- ⑩ **SOUND**  
Select a sound mode.

- ⑪ **SURR**  
Select surround sound or stereo sound.
- ⑫ **▶ || (Play/Pause)**  
Start, pause or resume play.
- ⑬ **■ (Stop)**  
Stop play.
- ⑭ **☰ OPTIONS**
  - Access more play options while playing a disc or a USB storage device.
  - In radio mode, auto install the radio stations.
- ⑮ **▲ (Open/Close)**  
Open or close the disc compartment.
- ⑯ **🏠 (Home)**  
Access or exit the home menu.
- ⑰ **AUDIO SYNC**
  - Select an audio language or channel.
  - Press and hold to access audio delay setting, then press **Navigation buttons** to delay the audio to match the video.

---

## Connectors

This section includes an overview of the connectors available on your home theater.

---

### Front

#### Front connectors

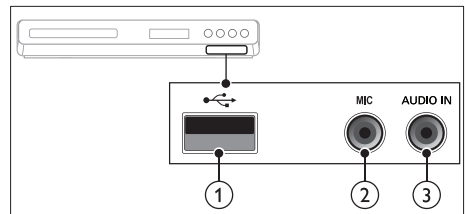

- ① **🔌 (USB)**  
Audio, video or picture input from a USB storage device.

- ② **MIC**  
Audio input from a microphone.
- ③ **AUDIO IN**  
Audio input from an MP3 player (3.5mm jack).

## Back connectors

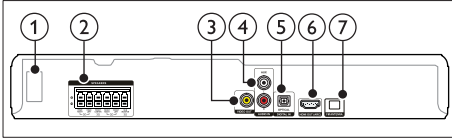

- ① **AC MAINS**  
Connect the supplied AC power cable.
- ② **SPEAKERS**  
Connect to the supplied speakers and subwoofer.
- ③ **VIDEO OUT**  
Connect to the composite video input on the TV.
- ④ **AUDIO IN-AUX**  
Connect to an analog audio output on the TV or an analog device.
- ⑤ **DIGITAL IN-OPTICAL**  
Connect to an optical audio output on the TV or a digital device.
- ⑥ **HDMI OUT (ARC)**  
Connect to the HDMI input on the TV.
- ⑦ **FM ANTENNA**  
Connect the supplied antenna for radio reception.

## 3 Connect and set up

This section helps you connect your home theater to a TV and other devices, and then set it up. For information about the basic connections of your home theater and accessories, see the quick start guide.

### Note

- For identification and supply ratings, see the type plate at the back or bottom of the product.
- Before you make or change any connections, make sure that all devices are disconnected from the power outlet.

## Connect speakers

The speaker cables are color-coded for easy connection. To connect a speaker to your home theater, match the color on the speaker cable to the color on the connector.

Speaker position plays a critical role in setting up a surround sound effect. For best effect, position all the speakers towards the seating position and place them close to your ear level (seated).

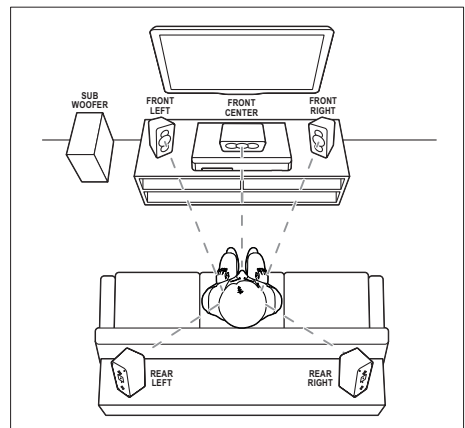

\* The actual speaker shapes may vary from the illustration above.



## Note

- Surround sound depends on factors such as room shape and size, type of wall and ceiling, windows and reflective surfaces, and speaker acoustics. Experiment with the speaker positions to find the optimum setting for you.

Follow these general guidelines for speakers placement.

- 1 Seating position:**  
This is the center of your listening area.
- 2 FRONT CENTER** (front center) speaker:  
Place the center speaker directly in front of the seating position, either above or below your TV.
- 3 FRONT LEFT** (front left) and **FRONT RIGHT** (front right) speakers:  
Place the left and right speakers in the front, and at equal distance from the center speaker. Make sure that the left, right, and the center speakers are at equal distance from your seating position.
- 4 REAR LEFT** (rear left) and **REAR RIGHT** (rear right) speakers:  
Place the rear surround speakers to the left and right side of your seating position, either in line with it or slightly behind it.
- 5 SUBWOOFER** (subwoofer):  
Place the subwoofer at least one meter to the left or right of the TV. Leave about 10-centimeter clearance from the wall.

## Connect to TV

Connect your home theater to a TV to watch videos. You can listen to the TV audio through your home theater speakers. Use the best quality connection available on your home theater and TV.

## Option 1: Connect to TV through HDMI (ARC)

### Best quality video

Your home theater supports HDMI version with Audio Return Channel (ARC). If your TV is HDMI ARC compliant, you can hear the TV audio through your home theater by using a single HDMI cable.

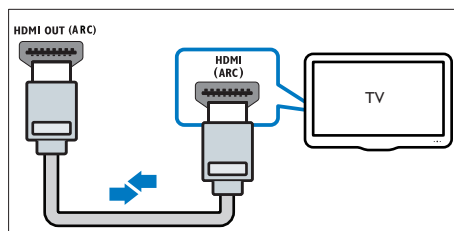

- 1** Using a High Speed HDMI cable, connect the **HDMI OUT (ARC)** connector on your home theater to the **HDMI ARC** connector on the TV.
  - The **HDMI ARC** connector on the TV might be labeled differently. For details, see the TV user manual.
- 2** On your TV, turn on HDMI-CEC operations. For details, see the TV user manual.
  - HDMI-CEC is a feature that enables CEC compliant devices that are connected through HDMI to be controlled by a single remote control, such as volume control for both the TV and the home theater. (see 'Set up EasyLink (HDMI-CEC control)' on page 9)
- 3** If you cannot hear the TV audio through your home theater, set up the audio manually. (see 'Set up the audio' on page 10)

---

## Option 2: Connect to TV through standard HDMI

### Best quality video

If your TV is not HDMI ARC compliant, connect your home theater to the TV through a standard HDMI connection.

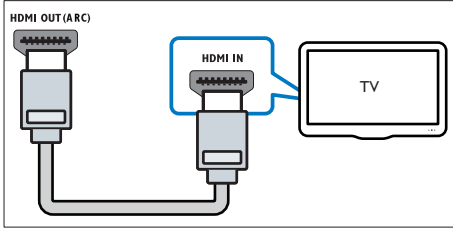

- 1 Using a High Speed HDMI cable, connect the **HDMI OUT (ARC)** connector on your home theater to the **HDMI** connector on the TV.
- 2 Connect an audio cable to hear the TV audio through your home theater (see 'Connect audio from TV and other devices' on page 8).
- 3 On your TV, turn on HDMI-CEC operations. For details, see the TV user manual.
  - HDMI-CEC is a feature that enables CEC compliant devices that are connected through HDMI to be controlled by a single remote control, such as volume control for both the TV and the home theater. (see 'Set up EasyLink (HDMI-CEC control)' on page 9)
- 4 If you cannot hear the TV audio through your home theater, set up the audio manually. (see 'Set up the audio' on page 10)

### Note

- If your TV has a DVI connector, you can use an HDMI/DVI adapter to connect to TV. However, some of the features may not be available.

---

## Option 3: Connect to the TV through composite video

### Basic quality video

If your TV does not have HDMI connectors, use a composite video connection. A composite connection does not support high-definition video.

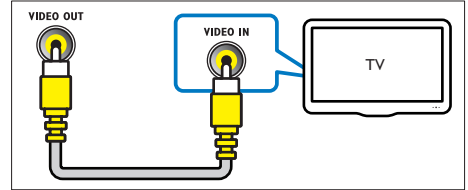

- 1 Using a composite video cable, connect the **VIDEO OUT** connector on your home theater to the **VIDEO IN** connector on the TV.
  - The composite video connector might be labeled **AV IN**, **COMPOSITE**, or **BASEBAND**.
- 2 Connect an audio cable to hear the TV audio through your home theater (see 'Connect audio from TV and other devices' on page 8).
- 3 When you watch TV programs, press **SOURCE** on your home theater repeatedly to select the correct audio input.
- 4 When you watch videos, switch your TV to the correct video input. For details, see the TV user manual.

---

## Connect audio from TV and other devices

Play audio from TV or other devices through your home theater speakers. Use the best quality connection available on your TV, home theater, and other devices.

## Note

- When your home theater and TV are connected through HDMI ARC, an audio connection is not required (see 'Option 1: Connect to TV through HDMI (ARC)' on page 7).

## Option 1: Connect audio through a digital optical cable

### Best quality audio

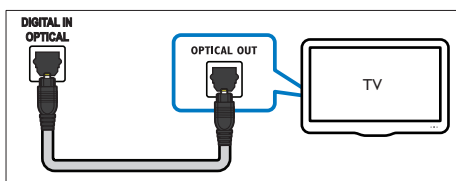

- Using an optical cable, connect the **OPTICAL** connector on your home theater to the **OPTICAL OUT** connector on the TV or other device.
  - The digital optical connector might be labeled **SPDIF** or **SPDIF OUT**.

## Option 2: Connect audio through analog audio cables

### Basic quality audio

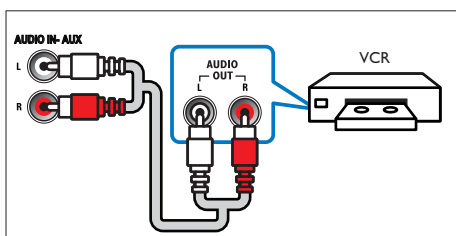

- Using an analog cable, connect the **AUX** connectors on your home theater to the **AUDIO OUT** connectors on the TV or other device.

## Set up speakers

Set up the speakers manually to experience customized surround sound.

### Before you start

Make the necessary connections described in the quick start guide, and then switch the TV to the correct source for your home theater:

- Press **▲ (Home)**.
- Select **[Setup]**, and then press **OK**.
- Select **[Audio] > [Speaker Setup]**.
- Press the **Navigation buttons** and **OK** to select and change:
  - [Speakers Volume]**: Set the volume level of each speaker.
  - [Speakers Delay]**: Set the delay time for speakers which are placed closer to the seating position in order to obtain equal audio transmission from all the speakers.

## Set up EasyLink (HDMI-CEC control)

This home theater supports Philips EasyLink, which uses the HDMI-CEC (Consumer Electronics Control) protocol. EasyLink-compliant devices that are connected through HDMI can be controlled by a single remote control.

## Note

- Depending on the manufacturer, HDMI-CEC is known by many names. For information on your device, see the user manual of the device.
- Philips does not guarantee 100% interoperability with all HDMI-CEC devices.

### Before you start

- Connect your home theater to the HDMI-CEC compliant device through HDMI connection.

- Make the necessary connections described in the quick start guide, and then switch the TV to the correct source for your home theater.

## Enable EasyLink

- 1 Press **⬆** (Home).
- 2 Select **[Setup]**, and then press **OK**.
- 3 Select **[Video]**, and then press **OK**.
- 4 Select **[HDMI Setup]** > **[EasyLink Setup]** > **[EasyLink]** > **[On]**.
- 5 On your TV and other connected devices, turn on HDMI-CEC control. For details, see the user manual of the TV or other devices.
  - On your TV, set the audio output to 'Amplifier' (instead of TV speakers). For details, see the TV user manual.

## EasyLink controls

With EasyLink, you can control your home theater, TV, and other connected HDMI-CEC compliant devices with a single remote control.

- **[1 Touch Play]** (One-touch play): If one-touch play is enabled, press **⏻** (Standby-On) on the remote control of your home theater to wake up the TV from standby.
- **[1 Touch Standby]** (One-touch standby): If one-touch standby is enabled, your home theater can switch to standby with the remote control of the TV or other HDMI-CEC devices.
- **[Sys Audio Control]** (System audio control): If system audio control is enabled, the audio of the connected device is output through your home theater speakers automatically when you play the device.
- **[Audio Mapping]** (Audio input mapping): If system audio control does not work, map the connected device to the correct audio input connector on your home theater (see 'Set up the audio' on page 10).

## Note

- To change the EasyLink control settings, press **⬆** (Home), select **[Setup]** > **[Video]** > **[HDMI Setup]** > **[EasyLink Setup]** > **[EasyLink]**.

## Set up the audio

If you cannot hear the audio output of a connected device through your home theater speakers, do the following:

- Check that you have enabled EasyLink on all the devices, (see 'Set up EasyLink (HDMI-CEC control)' on page 9) and on your TV, set the audio output to "Amplifier" (instead of TV speakers). For details, see the TV user manual, and setup the EasyLink audio control.

- 1 Press **⬆** (Home).
- 2 Select **[Setup]**, and then press **OK**.
- 3 Select **[Video]**, and then press **OK**.
- 4 Select **[HDMI Setup]** > **[EasyLink Setup]** > **[Sys Audio Control]** > **[On]**.
  - To play the audio from the TV speakers, select **[Off]**, and skip the following steps.
- 5 Select **[HDMI Setup]** > **[EasyLink Setup]** > **[Audio Mapping]**.
- 6 Follow the onscreen instructions to map the connected device to the audio inputs on your home theater.
  - If you connect your home theater to the TV through an **HDMI ARC** connection, make sure that the TV audio is mapped to the ARC input on your home theater.

# 4 Use your home theater

This section helps you use the home theater to play media from a wide range of sources.

## Before you start

- Make the necessary connections described in the Quick start guide and the user manual.
- Switch the TV to the correct source for the home theater.

- 1 Press **Home**.  
↳ The home menu is displayed.
- 2 Press the **Navigation buttons** and **OK** to select the following:
  - **[DISC]**: Start disc play.
  - **[USB]**: Access the USB content browser.
  - **[Setup]**: Access menus to change video, audio and other settings.
- 3 Press **Home** to exit.

## Discs

Your home theater can play DVDs, VCDs, and CDs. It can also play discs that you've made at home, such as CD-R discs of photos and music.

- 1 Insert a disc into the home theater.
- 2 If the disc does not play automatically, press **DISC** or select **[DISC]** from the home menu.
- 3 Press the play buttons to control play (see 'Play buttons' on page 11).

## Play buttons

Button	Action
<b>Navigation buttons</b>	Navigate menus.
<b>OK</b>	Confirm an entry.

Button	Action
<b>▶   (Play/Pause)</b>	Start, pause or resume play.
<b>■</b>	Stop play.
<b>◀ / ▶</b>	Skip to the previous or next track, chapter or file.
<b>◀◀ / ▶▶</b>	Fast backwards or fast forwards. Press repeatedly to change the search speed.
<b>Navigation buttons (left/right)</b>	Rotate the picture clockwise or counter-clockwise.
<b>Navigation buttons (up/down)</b>	Flip the picture vertically or horizontally.
<b>DISC</b>	Access or exit the disc menu.
<b>AUDIO SYNC</b>	Select an audio language or channel.
<b>☰ OPTIONS</b>	Access more options when you play your audio, video, or media files. (see 'Audio, video, and picture options' on page 13)

## Synchronize video and sound

If the audio and video are not synchronized, delay the audio to match the video.

- 1 While playing video, press and hold **AUDIO SYNC**.  
↳ Audio sync menu is displayed.
- 2 Press the **Navigation buttons** to synchronize the audio with the video, and then press **OK**.

### Note

- Picture and sound can be synchronized through the setup menu, press **Home**, select **[Setup]** > **[Audio]** > **[Audio Sync]**.

---

## Display menu for VCD and SVCD

Display the content menu on VCD and SVCD discs.

- 1 Press **⬆** (Home).
- 2 Select **[Setup]**, and then press **OK**.
- 3 Select **[Preference]** > **[PBC]**.
  - **[PBC]**: Enable or disable the content menu navigation of VCD and SVCD discs with Play Back Control feature.

---

## Data files

Your home theater can play pictures, audio and video files contained in a disc or a USB storage device. Before you play a file, check that the file format is supported by your home theater.

- 1 Play the files from a disc or USB storage device.
- 2 To stop play, press **■**.
  - To resume the video from where you stopped, press **▶||**.
  - To play the video from the start, press **OK**.

### Note

- To play DivX DRM protected files, connect your home theater to a TV through an HDMI cable.

---

## Subtitles

If your video has subtitles in multiple languages, select a subtitle language.

### Note

- Make sure that the subtitle file has the exact same name as the video file. For example, if the video file is named 'movie.avi', name the subtitle file as 'movie.srt' or 'movie.sub'.
- Your home theater supports the following file formats: .srt, .sub, .txt, .ssa, .ass, .smi, and .sami. If the subtitles do not appear correctly, change the character set.

- 1 Press **≡** **OPTIONS**, and select a subtitle language under **SUBTITLE** option.
- 2 For DivX videos, if the subtitles do not appear correctly, continue the following steps to change the character set.
- 3 Press **⬆** (Home).
- 4 Select **[Setup]**, and then press **OK**.
- 5 Select **[Preference]** > **[DivX Subtitle]**.
- 6 Select a character set that supports the subtitle.

---

Character Set	Language
<b>[Standard]</b>	English, Albanian, Danish, Dutch, Finnish, French, Gaelic, German, Italian, Kurdish (Latin), Norwegian, Portuguese, Spanish, Swedish and Turkish

---

---

## VOD code for DivX

Before you purchase DivX videos and play them on your home theater, register the home theater on [www.divx.com](http://www.divx.com) using the DivX VOD code.

- 1 Press **⬆** (Home).
- 2 Select **[Setup]**, and then press **OK**.
- 3 Select **[General]** > **[DivX(R) VOD Code]**.
  - ↳ The DivX VOD registration code for your home theater is displayed.

---

## Play audio through Bluetooth

Through Bluetooth, connect this product with your Bluetooth device (such as an iPad, iPhone, iPod touch, Android phone, or laptop), and then you can listen to the audio files stored on the device through this product.

### What you need

- A Bluetooth device which supports Bluetooth profile A2DP, AVRCP and with Bluetooth version as 2.1 + EDR.

- The operational range between this product and a Bluetooth device is approximately 10 meters (30 feet).
- 1 Press **0** to select Bluetooth mode.
    - ↳ **[bt]** is displayed on the display panel.
  - 2 On the Bluetooth device, switch on Bluetooth, search for and select the name of this product to start connection (see the user manual of the Bluetooth device on how to enable Bluetooth).
    - If prompted for a password, enter "0000".
  - 3 Wait until you hear a beep sound from this product.
    - ↳ The beep sound from this product indicates that the connection succeeds. **[bt\_rd]** on the display panel is displayed for 2 seconds, and then the display comes back to **[bt]**.
    - ↳ If the connection fails, a beep sound does not emit from this product.
  - 4 Select and play audio files or music on your Bluetooth device.
    - During play, if a call is coming, music play is paused.
    - If music streaming is interrupted, place the Bluetooth device closer to this product.
  - 5 To exit Bluetooth, select other source.
    - When you switch back to Bluetooth mode, Bluetooth connection remains active.

#### Note

- The music streaming may be interrupted by obstacles between the device and this product, such as wall, metallic casing that covers the device, or other devices nearby that operate in the same frequency.
- If you want to connect this product with another Bluetooth device, press and hold **▶||** on the remote control to disconnect the currently connected Bluetooth device.

---

## USB storage devices

Enjoy pictures, audio, and video stored on a USB storage device such as an MP4 player.

### What you need

- A USB storage device that is formatted for FAT or NTFS file system, and complies with the Mass Storage Class.
- A media file in one of the supported file formats.

#### Note

- If you use a USB extension cable, USB HUB or USB multi-reader, the USB storage device may not be recognized.

- 1 Connect a USB storage device to the  (USB) connector on your home theater.
- 2 Press **USB**.
  - ↳ A content browser is displayed.
- 3 Select a file and then press **OK**.
- 4 Use the play buttons to control play.

---

## Audio, video, and picture options

Use advanced features when you play audio, video, or media files from a disc or a USB storage device.

---

### Audio options

- 1 While playing audio, press **≡ OPTIONS** repeatedly to select a repeat mode.

---

### Video options

- 1 While viewing video, press **≡ OPTIONS**.
  - ↳ The video options menu is displayed. Depending on the video source, some options are not available.

- 2 Press the **Navigation buttons** and **OK** to select and change:
- **[Info]**: Display the play information.
  - **[PBC]**: Enable or disable the content menu navigation of VCD and SVCD discs with Play Back Control feature.
  - **[Aspect ratio]**: Select a display ratio of picture that matches your TV screen.
  - **[Repeat]**: Select a repeat play mode.
  - **[Zoom]**: Zoom into a video scene or picture. Press the **Navigation buttons** (left/right) to select a zoom factor.
  - **[Subtitle]**: Select subtitle language for video.
  - **[Angle]**: Select video scenes recorded in different camera angels.
  - **[Microphone]**: Turn the microphone on or off.
  - **[Karaoke setup]**: Access the Karaoke setup menu.
  - **[Vocal]**: Select a Karaoke audio mode, or turn off original vocals.

---

## Picture options

- 1 While viewing pictures, press **≡** **OPTIONS**.
- 2 Press the **Navigation buttons** and **OK** to select and change:
  - **[Color]**: Turn on or off the color mode.
  - **[Photo preview]**: Display the thumbnail of photos.
  - **[Repeat]**: Select a repeat mode for slideshow.
  - **[Zoom]**: Zoom into a video scene or picture. Press the **Navigation buttons** (left/right) to select a zoom factor.
- 3 Press **◀ / ▶** to go to previous or next preview page.
- 4 Press the **Navigation buttons** and **OK** to select a picture.

---

## Musical slideshow

If the picture and audio files are from the same disc or USB storage device, you can create a musical slideshow.

- 1 Select an audio track and then press **OK**.
- 2 Press **↩ BACK** and then go to the picture folder.
- 3 Select a picture and then press **OK** to start the slideshow.
- 4 Press **■** to stop slideshow.
- 5 Press **■** again to stop music.

---

## Radio

Listen to FM radio on your home theater, and store up to 40 radio stations.

### Note

- AM and digital radio are not supported.
- If no stereo signal is detected, you are prompted to install the radio stations again.





- 1 Connect the FM antenna to the **FM ANTENNA** on your home theater.
  - For the best reception, place the antenna away from your TV or other sources of radiation.
- 2 Press **SOURCE** repeatedly to select radio source.
  - ↳ If you have already installed the radio stations, the last channel that you listened to is played.
  - ↳ If you have not installed any radio stations, the message **AUTO INSTALL...PRESS PLAY** appears on the display panel. Press **▶▶** to install radio stations.
- 3 Use the remote control to listen to or change radio stations.



---

## Play buttons

---



Button	Action
 or <b>Alphanumeric buttons</b>	Select a preset radio station.
<b>Navigation buttons</b>	Left/Right: Search for a radio station. Up/Down: Fine tune a radio frequency.
	Press to stop the installation of radio stations. Press and hold to erase the preset radio station.
<b>SOURCE</b> button to access radio	<b>Manual:</b> <ol style="list-style-type: none"><li>1) In radio mode, press  <b>OPTIONS</b>.</li><li>2) When a radio frequency blinks, press <b>OK</b> to store the radio station.</li><li>3) Repeat step 1 and 2 to store other stations.</li></ol> <b>Automatic:</b> <p>In radio mode, press and hold  <b>OPTIONS</b> for three seconds to reinstall all the available radio station.</p>

---

---

## Tuning grid

In some countries, you can toggle the FM tuning grid between 50 kHz and 100 kHz.

- 1 Press **SOURCE** repeatedly to select radio source.
- 2 Press .
- 3 Press and hold  to toggle between 50 kHz or 100 kHz.

---

## MP3 player

Connect a MP3 player to play audio files.

### What you need

- An MP3 player.
- A 3.5mm stereo audio cable.

- 1 Using the 3.5mm stereo audio cable, connect the MP3 player to the **AUDIO IN** connector on your home theater.
  - If you use 6.5mm stereo audio cable, connect the MP3 player to your home theater using a 3.5mm - 6.5mm converter jack.
- 2 Press **AUDIO SOURCE** repeatedly until **AUDIO IN** (Audio In) appears on the display panel.
- 3 Press the buttons on the MP3 player to select and play audio files.

---

## Karaoke

Play a Karaoke disc on your home theater and sing along with the music.

### What you need

- A Karaoke microphone.
- Karaoke discs.

---

### Note

- To prevent loud feedback or unexpected noise, turn the microphone volume to the minimum before you connect the microphone to your home theater.

---

## Play karaoke music

- 1 While playing a karaoke disc, press  (**Home**).
  - ↳ The home menu is displayed.
- 2 Select [**Karaoke**], and then press **OK**.
  - ↳ The karaoke setup menu is displayed.

- 3** Press the **Navigation buttons** (up/down) and **OK** to change the following settings:
- **[Microphone]:** Turn the microphone on or off.
  - **[Mic Volume]:** Change the microphone volume.
  - **[Echo Level]:** Change the echo level.
  - **[Karaoke Scoring]:** Select a difficulty level to score your singing. After a song ends, a score is given.
  - **[Karaoke Idol]:** Have a Karaoke contest with your friends. Follow the on-screen instructions to start the contest.
  - **[Key Shift]:** Change the pitch to match your voice.
  - **[Vocal]:** Select a Karaoke audio mode, or turn off original vocals.

---

## Choose sound

This section helps you choose the ideal sound for your video or music.

---

### Sound mode

Select predefined sound modes to suit your video or music.

- 1** Press **SOUND** repeatedly to select a sound mode.
- **[Movie Mode]:** Enjoy a cinematic audio experience, specially enhanced for movies.
  - **[Music Mode]:** Recreate the original recording environment of your music, in the studio or at a concert.
  - **[Original]:** Experience the original sound of your movies and music, without added sound effects.
  - **[News]:** Hear every word with optimized speech and clear vocals.
  - **[Gaming]:** Enjoy thrilling arcade sounds, ideal for action-packed video games or loud parties.

---

### Surround sound mode

Experience an immersive audio experience with surround sound modes.

- 1** Press **SURR** repeatedly to select a surround mode.
- **[Multi Channel]:** Traditional 5.1 channel for a more relaxing cinematic experience.
  - **[Stereo]:** Two-channel stereo sound. Ideal for listening to music.



#### Note

- If the audio source is a 2.1 channel, multi-channel mode will output 5-channel stereo sound.

# 5 Change settings

The home theater settings are already configured for optimal performance. Unless you have a reason to change a setting, we recommend that you keep the default setting.

## Note

- You cannot change a setting that is grayed out.
- To return to the previous menu, press **↶** **BACK**. To exit the menu, press **🏠** (**Home**).

## Language settings

### Onscreen display language

- 1 Press **🏠** (**Home**).
- 2 Select **[Setup]** and then press **OK**.
- 3 Select **[General]** and then press **OK**.
  - **[OSD Language]**: Select a display language for menu.

### Disc language

- 1 Press **🏠** (**Home**).
- 2 Select **[Setup]** and then press **OK**.
- 3 Select **[Preference]** and then press **OK**.
  - **[Audio]**: Select an audio language for discs.
  - **[Subtitle]**: Select a subtitle language for discs.
  - **[Disc Menu]**: Select a menu language for discs.

## Note

- If your preferred disc language is not available, select **[Others]** from the list, and enter the 4-digit language code found at the end of this user manual (see 'Language code' on page 26).
- If you select a language that is not available on a disc, the home theater uses the default language of the disc.

## Picture and video settings

- 1 Press **🏠** (**Home**).
- 2 Select **[Setup]** and then press **OK**.
- 3 Select **[Video]** and then press **OK**.
  - **[TV System]**: Select a video format supported by the TV.
  - **[TV Display]**: Select a picture format to fit the TV screen.
  - **[Picture Setting]**: Select animation for the slide show.
  - **[HD JPEG]**: Enable this feature to view high-definition JPEG pictures through HDMI connection.
  - **[HDMI Setup]**: Access the following setup through HDMI connection.
    - \* **[Resolution]**: Select a resolution for high definition videos.
    - \* **[HDMI Deep Color]**: Recreate the natural world on your TV screen by displaying vivid images using billion colors. Your home theater must be connected to a Deep Color enabled TV through an HDMI cable.
    - \* **[Wide Screen]**: Select a display format for wide screen videos.
    - \* **[EasyLink Setup]**: Set up EasyLink control (see 'Set up EasyLink (HDMI-CEC control)' on page 9).

## Note

- If you change a setting, make sure that the TV supports the new setting.

---

## Audio settings

- 1 Press **▲** (Home).
- 2 Select **[Setup]** and then press **OK**.
- 3 Select **[Audio]** and then press **OK**.
  - **[HDMI Audio]**: Set the HDMI audio output from your TV, or disable HDMI audio output from the TV.
  - **[Audio Sync]**: Set audio delay if audio and video cannot be matched.
  - **[Speaker Setup]**: Set up speakers for best surround sound experience.
  - **[Sound Mode]**: Select a predefined sound mode to suit your video and music.
  - **[Treble/Bass]**: Set the high frequency (treble) and low frequency (bass) settings of the home theater.
  - **[Night Mode]**: Select quiet or full dynamic sound. Night mode decreases the volume of loud sounds and increases volume of sounds such as speech. Applicable to Dolby Digital encoded DVD discs only.

---

## Parental control settings

### Password and Ratings

- 1 Press **▲** (Home).
- 2 Select **[Setup]** and then press **OK**.
- 3 Select **[Preference]** and then press **OK**.
  - **[Password]**: Set or change your password for parental control access. If you do not have a password or have forgotten your password, enter 000000.
  - **[Parental Control]**: Enable maturity-based restricted access for playback of DVD-video that are recorded with ratings. To play discs irrespective of the rating, select **[8 Adult]**.

---

## Lock disc

- 1 Press **▲** (Home).
- 2 Select **[Setup]** and then press **OK**.
- 3 Select **[General]** and then press **OK**.
  - **[Disc Lock]**: Lock the disc to restrict play. You can lock up to 20 discs on your home theater.



### Note

- To play a locked disc, follow the onscreen instructions to enter the password, and then press **OK**.

---

## Display settings

- 1 Press **▲** (Home).
- 2 Select **[Setup]** and then press **OK**.
- 3 Select **[Preference]** and then press **OK**.
  - **[PBC]**: Enable or disable the content menu navigation of VCD and SVCD discs with Play Back Control feature.

---

## Energy saving settings

- 1 Press **▲** (Home).
- 2 Select **[Setup]** and then press **OK**.
- 3 Select **[General]** and then press **OK**.
  - **[Display Dim]**: Set the brightness of the home theater front panel display.
  - **[Sleep Timer]**: Switch the home theater to standby mode after the elapsed time.
  - **[Auto Standby]**: Switch the home theater to standby mode after 15 minutes of no activity when in disc or USB mode.

---

## Restore default settings

- 1 Press **⬆** (Home).
- 2 Select **[Setup]** and then press **OK**.
- 3 Select **[Preference]** > **[Default]**, and then press **OK**.
- 4 Follow the onscreen message to restore default setting.
  - ↳ Your home theater is reset to its default settings, except for password, parental control and disc lock settings.

# 6 Update software

Philips continually tries to improve its products. To get the best features and support, update your home theater with the latest software.

Compare the version of your current software with the latest version on [www.philips.com/support](http://www.philips.com/support). If the current version is lower than the latest version available on the Philips support website, upgrade your home theater with the latest software.



### Caution

- Do not install a lower version of software than the current version installed on your product. Philips is not liable for problems caused due to software downgrade.

---

## Check software version

Check the version of the current software installed on your home theater:

- 1 Press **⬆** (Home).
- 2 Select **[Setup]** and then press **OK**.
- 3 Select **[Preference]** > **[Version Info]**.
  - ↳ The software version is displayed.

---

## Update software through USB

### What you need

- A USB flash drive that is FAT or NTFS-formatted, with at least 75MB of memory. Do not use a USB hard drive.
- A computer with Internet access.
- An archive utility that supports the ZIP file format.

---

## Step 1: Download the latest software

- 1 Connect a USB flash drive to your computer.
- 2 In your web browser, go to [www.philips.com/support](http://www.philips.com/support).
- 3 At the Philips Support website, find your product and locate the **Software and drivers**.
  - ↳ The software update is available as a zip file.
- 4 Save the zip file in the root directory of your USB flash drive.
- 5 Use the archive utility to extract the software update file in the root directory.
- 6 Disconnect the USB flash drive from your computer.

---

## Step 2: Update the software



### Caution

- Do not switch off the home theater or remove the USB flash drive during the update.

- 1 Connect the USB flash drive containing the downloaded file to your home theater:
  - Make sure that the disc compartment is closed and there is no disc inside.
- 2 Switch your TV to the correct source for your home theater.
- 3 Follow the onscreen instructions to confirm the update.
  - ↳ Once complete, the home theater automatically switches off and restarts. If it does not, disconnect the power cord for a few seconds and then reconnect it.

# 7 Product specifications



### Note

- Specifications and design are subject to change without notice.

---

## Region codes

The type plate on the back or bottom of the home theater shows which regions it supports.

Country	DVD
Europe, United Kingdom	
Asia Pacific, Taiwan, Korea	
Latin America	
Australia, New Zealand	
Russia, India	
China	

---

## Media formats

- DVD-Video, DVD+R/RW, DVD-R/RW, DVD+R-R DL, CD-R/CD-RW, Audio CD, Video CD/SVCD, Picture files, MP3 media, WMA media, DivX media, USB storage device

---

## Supported file formats

- Video: .avi, .divx, .mpg, .mpeg
- Audio: .mp3, .wma
- Picture: .jpg, .jpeg

---

## Playable video files

- Resolution size: 720 x 576 pixels
- Video codec:
  - **.avi, .divx:** DivX3.11, DivX4.x, DivX5.x, MPEG 1, MPEG 2, Xvid
  - **.mpg, .mpeg:** MPEG 1, MPEG 2
- Audio codec:
  - **.avi, .divx:** PCM, AC-3, MP3, WMA
  - **.mpg, .mpeg:** PCM, MPEG, MP3
- Maximum Bit rate: 8Mbps

---

## Playable audio files

- Playable audio codec:
  - **.mp3:** MP3
  - **.wma:** WMA
- Maximum Bit rate:
  - **.mp3:** 320kbps
  - **.wma:** 192kbps

---

## Bluetooth

- Bluetooth profiles: A2DP, AVRCP
- Bluetooth version: 2.1 + EDR

---

## Amplifier

- Total output power: 1000W RMS (+/- 0.5 dB, 10% THD)
- Frequency response: 20 Hz-20 kHz /  $\pm 3$  dB
- Signal-to-noise ratio: > 65 dB (CCIR) / (A-weighted)
- Input sensitivity:
  - AUX: 2 V
  - AUDIO IN: 1 V

---

## Video

- Signal system: PAL / NTSC/Multi
- HDMI output: 480i/576i, 480p/576p, 720p, 1080i, 1080p

---

## Audio

- S/PDIF Digital audio input:
  - Optical: TOSLINK

- Sampling frequency:
  - MP3: 32 kHz, 44.1 kHz, 48 kHz
  - WMA: 44.1 kHz, 48 kHz
- Constant bit rate:
  - MP3: 32 kbps - 320 kbps
  - WMA: 64 kbps - 192 kbps

---

## Radio

- Tuning range:
  - Europe/Russia/China: FM 87.5-108 MHz (50 kHz)
  - Asia Pacific/Latin America: FM 87.5-108 MHz (50/100 kHz)
- Signal-to-noise ratio: FM 50 dB
- Frequency response: FM 200 Hz-12.5 kHz /  $\pm 6$  dB

---

## USB

- Compatibility: Hi-Speed USB (2.0)
- Class support: USB Mass Storage Class (MSC)
- File system: FAT16, FAT32, NTFS
- USB port: 5V  $\pm$ , 500mA

---

## Main unit

- Power supply:
  - Europe/China/Russia/India: 220-240V~, 50 Hz
  - Latin America/Asia Pacific: 110-127V/220-240V~, 50-60 Hz
- Power consumption: 140 W
- Standby power consumption:  $\leq 0.5$  W
- Dimensions (WxHxD): 360 x 58 x 325 mm
- Weight: 2.3 kg

---

## Subwoofer

- Output power: 166 W RMS (+/- 0.5 dB, 10% THD)
- Impedance: 3 ohm
- Speaker drivers: 203 mm (8") woofer
- Dimensions (WxHxD): 178 x 300 x 343 mm

- Weight: 4.1 kg
- Cable length: 3.3 m

---

## Speakers

### Center speaker:

- 166W RMS (+/- 0.5 dB, 10% THD)
- Speaker impedance: 3 ohm
- Speaker drivers: 1 x 78 mm (3") full range
- Dimensions (WxHxD):  
223 x 100 x 80 mm
- Weight: 0.77 kg
- Cable length: 2.25 m

### Front/Rear speaker:

- 4 x 166W RMS (+/- 0.5 dB, 10% THD)
- Speaker impedance: 3 ohm
- Speaker drivers: 1 x 78 mm (3") full range
- Dimensions (WxHxD):
  - **HTD5520:** 90 x 185 x 82 mm (front/rear)
  - **HTD5550:** 90 x 185 x 82 mm (front);  
247 x 1090 x 242 mm (rear)
  - **HTD5580:** 247 x 1090 x 242 mm (front/rear)
- Weight (front):
  - **HTD5520:** 0.63 kg/each
  - **HTD5550:** 0.63 kg/each
  - **HTD5580:** 3.03 kg/each
- Weight (rear):
  - **HTD5520:** 0.63 kg/each
  - **HTD5550/HTD5580:** 3.03 kg/each
- Cable length (front): 3.25 m
- Cable length (rear): 10.25 m

---

## Remote control batteries

- 1 x AAA-R03-1.5V

---

## Laser

- Type: Semiconductor laser GaAlAs (CD)
- Wave length: 650-662 nm (DVD),  
785-795 nm (CD)
- Output power: 6 mW (DVD),  
7 mW (VCD/CD)
- Beam divergence: 60 degrees.

# 8 Troubleshooting



### Warning

- Risk of electric shock. Never remove the casing of the product.

To keep the warranty valid, never try to repair the product yourself.

If you have problems using this product, check the following points before you request service. If you still have a problem, get support at [www.philips.com/support](http://www.philips.com/support).

---

## Main unit

### The buttons on the home theater do not work.

- Disconnect the home theater from the power supply for a few minutes, then reconnect.

---

## Picture

### No picture.

- Make sure that the TV is switched to the correct source for the home theater.

### No picture on a TV connected through HDMI.

- Make sure that the HDMI cable is not faulty. If it is faulty, replace it with a new cable.
- Wait for 10 seconds for auto recovery, or change the HDMI video setting (see 'Picture and video settings' on page 17).

### Disc does not play high-definition video.

- Make sure that the disc contains high-definition video.
- Make sure that the TV supports high-definition video.
- Use an HDMI cable to connect to the TV.



---

## Sound

### No sound from home theater speakers.

- Connect the audio cable from your home theater to your TV or other devices. However, you do not need a separate audio connection when the home theater and TV are connected through an **HDMI ARC** connection.
- Set up the audio for the connected device (see 'Set up the audio' on page 10).
- Reset your home theater to its factory settings (see 'Restore default settings' on page 19), and then switch it off and switch on again.
- On your home theater, press **SOURCE** repeatedly to select the correct audio input.

### Distorted sound or echo.

- If you play audio from the TV through the home theater, make sure that the TV is muted.

### Audio and video are not synchronized.

- 1) Press and hold **AUDIO SYNC**.
- 2) Press the **Navigation buttons** within five seconds to synchronize the audio with the video.

---

## Play

### Cannot play a disc.

- Clean the disc.
- Make sure that the home theater supports the type of disc (see 'Media formats' on page 20).
- Make sure that the home theater supports the region code of the disc (see 'Region codes' on page 20).
- If the disc is a DVD±RW or DVD±R disc, make sure that it is finalized.

### Cannot play a DivX file.

- Make sure that the DivX file is encoded according to the 'Home Theater Profile' with the DivX encoder.
- Make sure that the DivX file is complete.

### DivX subtitles do not display correctly.

- Make sure that the subtitle file name is the same as the movie file name (see 'Subtitles' on page 12).
- Select the correct character set (see 'Subtitles' on page 12).

### Cannot read the contents of a USB storage device.

- Make sure that the format of the USB storage device is compatible with the home theater.
- Make sure that the file system on the USB storage device is supported by the home theater.

### 'input invalid' or 'x' sign appears on the TV.

- The operation is not possible.

### EasyLink does not work.

- Make sure that the home theater is connected to a Philips brand EasyLink TV, and the EasyLink option is turned on (see 'Set up EasyLink (HDMI-CEC control)' on page 9).
- For TVs from different manufacturers, the HDMI CEC could be called differently. Check the TV user manual on how to enable it.

### When you switch on the TV, the home theater automatically switches on.

- This behavior is normal when you are using Philips EasyLink (HDMI-CEC). To make the home theater work independently, switch off EasyLink.

---

## Bluetooth

### A device cannot connect with this product.

- The device does not support the compatible profiles required for this product.
- You have not enabled the Bluetooth function of the device. See the user manual of the device on how to enable the function.

- The device is not correctly connected. Connect the device correctly (see 'Play audio through Bluetooth' on page 12).
- This product is already connected with another Bluetooth device. Disconnect the connected device, then try again.

#### Quality of audio play from a connected Bluetooth device is poor.

- The Bluetooth reception is poor. Move the device closer to this product, or remove any obstacle between the device and this product.

#### The connected Bluetooth device connects and disconnects constantly.

- The Bluetooth reception is poor. Move the device closer to this product, or remove any obstacle between the device and this product.
- Turn off Wi-Fi function on the Bluetooth device to avoid interference.
- For some Bluetooth, the Bluetooth connection can be deactivated automatically to save power. This does not indicate any malfunction of this product.

## 9 Notice

This section contains the legal and trademark notices.

---

### Copyright



This item incorporates copy protection technology that is protected by U.S. patents and other intellectual property rights of Rovi Corporation. Reverse engineering and disassembly are prohibited.

---

### Trademarks



Manufactured under license from Dolby Laboratories. Dolby and the double-D symbol are trademarks of Dolby Laboratories.



DivX<sup>®</sup>, DivX Ultra<sup>®</sup>, DivX Certified<sup>®</sup> and associated logos are trademarks of Rovi Corporation or its subsidiaries and are used under license.

DivX Ultra<sup>®</sup> Certified to play DivX<sup>®</sup> video with advanced features and premium content. ABOUT DIVX VIDEO: DivX<sup>®</sup> is a digital video format created by DivX, LLC, a subsidiary of Rovi Corporation. This is an official DivX Certified<sup>®</sup> device that plays DivX video. Visit [divx.com](http://divx.com) for more information and software tools to convert your files into DivX videos. ABOUT DIVX VIDEO-ON-DEMAND: This DivX Certified<sup>®</sup> device must be registered in order to play purchased DivX Video-on-Demand (VOD) movies. To obtain your

registration code, locate the DivX VOD section in your device setup menu. Go to [vod.divx.com](http://vod.divx.com) for more information on how to complete your registration.



The terms HDMI and HDMI High-Definition Multimedia Interface, and the HDMI Logo are trademarks or registered trademarks of HDMI Licensing LLC in the United States and other countries.



The Bluetooth® word mark and logos are registered trademarks owned by Bluetooth SIG, Inc. and any use of such marks by Philips is under license. Other trademarks and trade names are those of their respective owners.



# 10 Language code

Abkhazian	6566	Inupiaq	7375	Pushto	8083
Afar	6565	Irish	7165	Russian	8285
Afrikaans	6570	Íslenska	7383	Quechua	8185
Amharic	6577	Italiano	7384	Raeto-Romance	8277
Arabic	6582	Ivrit	7269	Romanian	8279
Armenian	7289	Japanese	7465	Rundi	8278
Assamese	6583	Javanese	7486	Samoan	8377
Avestan	6569	Kalaallisut	7576	Sango	8371
Aymara	6589	Kannada	7578	Sanskrit	8365
Azerhijani	6590	Kashmiri	7583	Sardinian	8367
Bahasa Melayu	7783	Kazakh	7575	Serbian	8382
Bashkir	6665	Kernewek	7587	Shona	8378
Belarusian	6669	Khmer	7577	Shqip	8381
Bengali	6678	Kinyarwanda	8287	Sindhi	8368
Bihari	6672	Kirghiz	7589	Sinhalese	8373
Bislama	6673	Komi	7586	Slovensky	8373
Bokmål, Norwegian	7866	Korean	7579	Slovenian	8376
Bosanski	6683	Kuanyama; Kwanyama	7574	Somali	8379
Brezhoneg	6682	Kurdish	7585	Sotho; Southern	8384
Bulgarian	6671	Lao	7679	South Ndebele	7882
Burmese	7789	Latina	7665	Sundanese	8385
Castellano, Español	6983	Latvian	7686	Suomi	7073
Catalán	6765	Letzeburgesch;	7666	Swahili	8387
Chamorro	6772	Limburgan; Limburger	7673	Swati	8383
Chechen	6769	Lingala	7678	Svenska	8386
Chewa; Chichewa; Nyanja	7889	Lithuanian	7684	Tagalog	8476
中文	9072	Luxembourgish;	7666	Tahitian	8489
Chuang; Zhuang	9065	Macedonian	7775	Tajik	8471
Church Slavic; Slavonic	6785	Malagasy	7771	Tamil	8465
Chuvash	6786	Magyar	7285	Tatar	8484
Corsican	6779	Malayalam	7776	Telugu	8469
Česky	6783	Maltese	7784	Thai	8472
Dansk	6865	Manx	7186	Tibetan	6679
Deutsch	6869	Maori	7773	Tigrinya	8473
Dzongkha	6890	Marathi	7782	Tonga (Tonga Islands)	8479
English	6978	Marshallese	7772	Tsonga	8483
Esperanto	6979	Moldavian	7779	Tswana	8478
Estonian	6984	Mongolian	7778	Türkçe	8482
Euskara	6985	Nauru	7865	Türkmen	8475
Ελληνικά	6976	Navaho; Navajo	7886	Twí	8487
Faroese	7079	Ndebele, North	7868	Uighur	8571
Français	7082	Ndebele, South	7882	Ukrainian	8575
Frysk	7089	Ndonga	7871	Urdu	8582
Fijian	7074	Nederlands	7876	Uzbek	8590
Gaelic; Scottish Gaelic	7168	Nepali	7869	Vietnamese	8673
Gallegan	7176	Norsk	7879	Volapuk	8679
Georgian	7565	Northern Sami	8369	Walloon	8765
Gikuyu; Kikuyu	7573	North Ndebele	7868	Welsh	6789
Guarani	7178	Norwegian Nynorsk;	7878	Wolof	8779
Gujarati	7185	Occitan; Provençal	7967	Xhosa	8872
Hausa	7265	Old Bulgarian; Old Slavonic	6785	Yiddish	8973
Herero	7290	Oriya	7982	Yoruba	8979
Hindi	7273	Oromo	7977	Zulu	9085
Hiri Motu	7279	Ossetian; Ossetic	7983		
Hrwatski	6779	Pali	8073		
Ido	7379	Panjabi	8065		
Interlingua (International)	7365	Persian	7065		
Interlingue	7365	Polski	8076		
Inuktitut	7385	Português	8084		

# 11 Index

---

<b>A</b>	
amplifier	21
audio	
predefined modes	16
specifications	21
audio options	13
<hr/>	
<b>C</b>	
care	
product	3
connectors	
front connectors	5
control	
disc play	11
main unit	4
<hr/>	
<b>D</b>	
discs	
audio options	13
control buttons	11
options	13
play	11
synchronize picture and sound	11
time search	13
titles	13
display	
VCD/SVCD menu	12
display panel	4
<hr/>	
<b>F</b>	
FM antenna	6
<hr/>	
<b>H</b>	
HDMI	
<hr/>	
<b>K</b>	
karaoke	15
<hr/>	
<b>L</b>	
language	
language code	26
<hr/>	
<b>M</b>	
main unit	
overview	4
specifications	21
troubleshooting	22
media formats	20
MP3	
connector	5
<hr/>	
<b>O</b>	
options	
picture	14
overview	
main unit	4
remote control	4
<hr/>	
<b>P</b>	
picture	
options	14
troubleshooting	22
picture options	14
play	
discs	11
radio	21
troubleshooting	23
product specifications	20
<hr/>	
<b>R</b>	
radio	
FM antenna	6
specifications	21
tuning grid	15
region codes	20
remote control	
batteries	22
overview	4
repeat	13

---

## S

<b>safety</b>	
use of the product	2
<b>sound</b>	
predefined sound mode	16
surround sound	16
synchronize picture and sound	11
troubleshooting	23
<b>sound mode</b>	16
<b>speakers</b>	
specifications	22
surround sound	16
<b>subwoofer</b>	
specifications	21
<b>synchronize picture and sound</b>	11

---

## T

<b>time search</b>	13
<b>titles</b>	13
<b>trademarks</b>	24
<b>troubleshooting</b>	
connection	22
main unit	22
picture	22
play	23
sound	23
<b>tuning grid</b>	15

---

## U

<b>USB</b>	
format	21
<b>USB storage device</b>	
options	13
specifications	21

---

## V

<b>video</b>	
synchronize picture and sound	11
<b>video formats</b>	21
<b>video options</b>	13

# ***Certificado de Garantía válido para:***

Colombia-Costa Rica-Ecuador-El Salvador-Guatemala-  
Honduras-Nicaragua-Panamá-Perú-República Dominicana-Venezuela

Validez de la garantía

Todos los productos de la línea de audio y video Philips, se regirán por un año de garantía internacional (365 días), salvo para Chile donde los productos de las líneas CD Portable y RCR CD, los cuales se rigen por 6 meses de garantía (182 días)

Condiciones de la garantía

Esta garantía perderá su validez si:

- El defecto es causado por uso incorrecto o en desacuerdo con el manual de instrucciones
- El aparato sea modificado, violado por una persona no autorizada por Philips
- El producto esté funcionando con un suministro de energía (red eléctrica, batería, etc. ) de características diferentes a las recomendadas en el manual de instrucciones
- El número de serie que identifica el producto se encuentre de forma adulterada.

Están excluidos de garantía,

- Los defectos que se generen debido al incumplimiento del manual de instrucciones del producto
- Los casos fortuitos o de la fuerza mayor, como aquellos causados por agentes de la naturaleza y accidentes, descargas eléctricas, señales de transmisión débiles.
- Los defectos que se generen debido al uso de los productos en servicios no doméstico/residencial regulares o en desacuerdo con el uso recomendado
- Daños ocasionados por fluctuaciones de voltajes, voltaje fuera de norma o por causas fuera de Philips, como cortocircuitos en los bafles o parlantes.
- En las ciudades en donde no existe el taller autorizado del servicio de Philips, los costos del transporte del aparato y/o el técnico autorizado, corren por cuenta del cliente.
- La garantía no será válida si el producto necesita modificaciones o adaptaciones para que funcione en otro país que no es aquél para el cual fue mercadeado.

El único documento válido para hacer efectiva la garantía de los productos, es la Factura o Boleta de compra del consumidor final.

Aquellos productos que hayan sido adquiridos en otros países y que no estén en el rango normal del país donde se efectuará la reparación, dicha prestación de servicio tomará mas tiempo de lo normal ya que es necesario pedir las partes/piezas al centro de producción correspondiente.

Centros de información

## Líneas de atención al consumidor

**Colombia:** 01 800 700 7445  
[www.philips.com.co](http://www.philips.com.co)

**Costa Rica:** 0800 507 7445  
[www.centralamerica.philips.com](http://www.centralamerica.philips.com)

**Ecuador:** 1-800-10-1045  
[www.centralamerica.philips.com](http://www.centralamerica.philips.com)

**El Salvador:** 800 6024  
[www.centralamerica.philips.com](http://www.centralamerica.philips.com)

**Guatemala:** 1 800 299 0007  
[www.centralamerica.philips.com](http://www.centralamerica.philips.com)

**Honduras**  
[www.centralamerica.philips.com](http://www.centralamerica.philips.com)

**Nicaragua**  
[www.centralamerica.philips.com](http://www.centralamerica.philips.com)

**Panamá:** 800 8300  
[www.centralamerica.philips.com](http://www.centralamerica.philips.com)

**Perú:** 0800-00100  
[www.philips.com.pe](http://www.philips.com.pe)

**República Dominicana:** 1 800 751 2673  
[www.centralamerica.philips.com](http://www.centralamerica.philips.com)

**Venezuela:** 0800 100 4888  
[www.philips.com.ve](http://www.philips.com.ve)

# CERTIFICADO DE GARANTÍA EN ARGENTINA

## IMPORTANTE

El presente certificado de garantía es válido únicamente en la República Argentina.

Para que el mismo tenga validez, es imprescindible que esté completado por la casa vendedora y ser presentado por el usuario conjuntamente con la factura original de compra.

Producto: \_\_\_\_\_ Modelo: \_\_\_\_\_

Nro. De Serie: \_\_\_\_\_ Fecha de Venta: \_\_\_\_\_

Firma y sello de la casa vendedora: \_\_\_\_\_

**Fabricante/Importador: Philips Argentina S.A.  
y/o Fábrica Austral de Productos Eléctricos S.A.  
Dirección: Vedia 3892 – Buenos Aires, Argentina.**



# PHILIPS

**PHILIPS ARGENTINA S.A.** en adelante denominada "la empresa", garantiza al comprador de este producto, a partir de la fecha de adquisición y por el término de:

- **6 (seis) meses** para los siguientes productos: Mini Sistemas Hi Fi, Micro Sistemas Hi Fi, Parlantes para iPhone & iPod Hi Fi, Reproductores de CD Portátiles, Stereos para automóvil, Parlantes y Potencias para automóvil, Reproductores de audio digital, Radio relojes, Radios portátiles, Cámaras fotográficas digitales y Marcos digitales para fotos, Auriculares / audífonos, accesorios para aplicaciones
- **1 (un) año** para los siguientes productos: Home Theaters, Reproductores de Blu-ray, Reproductores de DVD, Micro Theaters / Micro Sistemas con DVD, Mini Sistemas Hi Fi con reproducción de DVD, Reproductores de DVD Portátiles, Teléfonos, MP3 y MP4

el normal funcionamiento contra cualquier defecto de fabricación y/o vicio de material, y se compromete a reparar el mismo –sin cargo alguno para el adquirente- cuando el mismo fallare en situaciones normales de uso y bajo las condiciones que a continuación se detallan:

1. Este certificado de garantía es válido únicamente en la República Argentina.
2. El certificado debe ser completado por la casa vendedora y ser presentado por el usuario conjuntamente con la factura original de compra.
3. Serán causas de anulación de esta garantía, en los casos que corresponda:
  - 3.1. Uso impropio o distinto del uso doméstico.
  - 3.2. Exceso o caídas de tensión eléctrica que implique uso en condiciones anormales.
  - 3.3. Instalación y/o uso en condiciones distintas a las marcadas en el "Manual de instalación y uso" que se adjunta al producto.
  - 3.4. Cualquier intervención al artefacto por terceros no autorizados por la empresa.
4. La garantía carecerá de validez si se observare lo siguiente:
  - 4.1. Enmiendas o raspaduras en los datos incluidos en la etiqueta del artefacto, certificado de garantía o factura.
  - 4.2. Falta de factura original de compra que detalle tipo de artefacto, modelo, número de serie y fecha que coincida con los del encabezamiento del presente certificado.
5. No están cubiertos por esta garantía los siguientes casos:
  - 5.1. Los daños ocasionados al exterior del gabinete.
  - 5.2. Las roturas, golpes, caídas o rayaduras causadas por traslados.
  - 5.3. Los daños o fallas ocasionados por deficiencias, sobretensiones, descargas o interrupciones del circuito de conexión del artefacto a fuentes de energía (Red eléctrica, pilas, baterías, etc) que no sean las especificadas en el Manual de uso del mismo.
  - 5.4. Las fallas, daños, roturas o desgastes producidos por el maltrato o uso indebido del artefacto y/o causadas por inundaciones, incendios, terremotos, tormentas eléctricas, golpes o accidentes de cualquier naturaleza.
  - 5.5. Las fallas o daños ocasionados en desperfectos en la línea telefónica.
  - 5.6. Las fallas producidas por una mala recepción ocasionada en el uso de una antena deficiente o en señales de transmisión débiles.
6. Las condiciones de instalación y uso del artefacto se encuentran detalladas en el Manual de Uso del mismo.
7. La empresa no asume responsabilidad alguna por los daños personales o a la propiedad al usuario o a terceros que pudieran causar la mala instalación o uso indebido del artefacto, incluyendo en este último caso a la falta de mantenimiento.



8. En caso de falla, el usuario deberá requerir la reparación a la empresa a través del Service Oficial y/o Talleres Autorizados más próximos a su domicilio y cuyo listado se acompaña al presente. La empresa asegura al usuario la reparación y/o reposición de piezas para su correcto funcionamiento en un plazo no mayor a 30 días contados a partir de la fecha de solicitud de reparación, salvo caso fortuito, fuerza mayor.
9. Toda intervención del servicio técnico realizada a pedido del usuario dentro del plazo de garantía, que no fuera originada por falla o defecto alguno cubierto por este certificado, deberá ser abonada por el interesado de acuerdo a la tarifa vigente.
10. El presente certificado anula cualquier otra garantía implícita o explícita, por la cual y expresamente no autorizamos a ninguna otra persona, sociedad o asociación a asumir por nuestra cuenta ninguna responsabilidad con respecto a nuestros productos.
11. En caso de que durante el período de vigencia de esta garantía el artefacto deba ser trasladado a las Delegaciones Oficiales y/o Talleres Autorizados de Service para su reparación, el transporte será realizado por la empresa y serán a su cargo los gastos de flete y seguros y cualquier otro que deba realizarse para su ejecución.

## Centros de Atención al Cliente

### ARGENTINA

Tel.: **0800-888-7532**

(Número gratuito)

(011) **4544-2047**

Para más Información visite nuestra web: [www.philips.com.ar](http://www.philips.com.ar)

#### ■ CAPITAL FEDERAL

#### ELECTARG S.R.L.

**Centro:** Av. Córdoba 1357 - Tel.: (011) 4811-0084/9/1050

**Caballito:** J. M. Moreno 287 - Tel.: (011) 4903-6967/ 6854/8983

**Saladillo:** Saladillo 2527 - Tel.: (011) 5554-9400

#### ATTENDANCE S.A.

Av. Monroe 3351 | Tel.: (011) 4545-5574 - 4545-4700

#### DIG TRONIC

Av San Martín 1762 | Tel.: (011) 4583-1501

#### GATTUSO DEMETRIO

Juan Bautista Alberdi 3425 | Tel.: (011) 4619-1631

#### ■ GRAN BUENOS AIRES

Florencio Varela Casa Torres S.A.

Lomas de Zamora Attendance S.A.

Lomas de Zamora Electarg S.R.L.

Moreno Argentrónica  
Morón Servotronic  
Olivos Electarg S.R.L.

Quilmes Casa Torres S.A.

Ramos Mejía Electarg S.R.L.  
San Isidro MC Zona Nort SRL  
San Miguel TecnoSanMiguel  
Tigre Pantronic  
Villa Ballester Servotronic

San Martín 2574

Av. Hipólito Yrigoyen 9228

Italia 78

Teniente Camilli 102  
Ntra. Sra. Buen Viaje 1222  
D F Sarmiento 3562

Pellegrini 140

Belgrano 224  
Av. Centenario 899  
Belgrano 999  
Almirante Brown 529  
José Hernandez 3064

(011) 4255-5854  
(011) 4467-7140  
(011) 4292-8900  
(011) 4239-2115  
(011) 4244-0397  
(011) 4224-8640  
(0237) 463-9500  
(011) 4627-5656  
(011) 4799-1945  
(011) 4794-7117  
(011) 4255-5854  
(011) 4253-6700  
(011) 4654-8003  
(011) 4656-0619  
(011) 4747-4040  
(011) 4664-4131  
(011) 4749-4040  
(011) 4767-2515  
(011) 4768-5249

#### ■ BUENOS AIRES

Azul Bahía Blanca  
Baradero Berisso

Junín Junín Service  
La Plata Luján

Mar de Ajó Mar del Plata

Marcos Paz Necochea Pehuajó Pergamino San Nicolás San Pedro Tandil Tres Arroyos Zárate

Herleín Raúl Horacio Neutron  
Juan Francisco Mazzarella Electrónica Bander

José Capurzio Junín Service  
Highvision Electro Hogar - Scamarella  
Tauro Electrónica Central Service - Tonelli

Service Integral

Tecnicentro - Leiva Electrónica Camejo  
Calcagni Carlos Alberto ACV/Sistemas Servitec  
Electrónica Menisale Lazzarini Oscar Rafael Saini Fabian y Sergio Electrónica Spinozzi

Av. 25 de Mayo 1227 Soler 535  
Arazo 847 Calle 158 n°107

Primera Junta 436 Alsina 537 Calle 60 n°1033  
25 de Mayo 280 Jorge Newbery 1434 Olazabal 2249

Salta 3519

Monteagudo 208 Calle 63 1745  
Zubiria 794 Dr. Alem 758  
Av. Alvarez 148 Mitre 1695  
Pelegriani 524  
Av. Belgrano 562 Ituzaingó 1030

(02281) 42-8719  
(0291) 453-5329  
(03329) 48-4321  
(0221) 46-14984  
(03489) 42-0372  
(02346) 42-4235  
(02346) 44-2754  
(0221) 45-20180  
(02323) 43-8931  
(02257) 42-1750  
(0223) 472-1639  
(0223) 472-9367  
(0223) 476-0108  
(0223) 476-4918  
(0220) 477-0334  
(02262) 42-6134  
(02396) 47-2665  
(02477) 42-1177  
(03461) 45-4729  
(03329) 42-5523  
(02923) 44-2167  
(02983) 42-7369  
(03487) 42-7353

**■ CATAMARCA**

S. F. del Valle de Catamarca Omicron Central de Servicios San Martín 225 (03833) 45-1498

**■ CHACO**

Resistencia Freschi Jorge Oscar Av. Hermandarias 431 (03722) 42-6030

**■ CHUBUT**

Comodoro Rivadavia C.A.S. SRL Alem 145 (0297) 444-2629 (0297) 15-625-0555  
 Esquel Laboratorio Electrónico Mitre 738 (02945) 45-1457  
 Pto. Madryn Center Electrónica Sarmiento 588 (02965) 45-8439  
 Trelew Fagtron Electrónica Brasil 253 (02965) 42-7073

**■ CORDOBA**

Alta Gracia Serv. Téc. Especializado – Biología Velez Sarsfield 19 (03547) 15-45-9936 (03547) 43-0848  
 Córdoba Electarg S.R.L. Avenida Colón 544 (0351) 425-5999 (0351) 15-670-0070  
 Córdoba Servelco SRL Pje. E. Marsilla 635 (0351) 472-4008 (0351) 473-2024  
 Río Cuarto Capaldi Abel Paunero 832 (0358) 462-3003  
 Río Tercero Service Omega Homero Manzi 149 (03571) 42-3330  
 Villa María Grasso Electrónica Bv. Alvear 541 (0353) 452-1366  
 Villa María Vanguard Sistemas Electrónicos México 421 (0353) 453-2951

**■ CORRIENTES**

Corrientes Los Magos San Martín 589 (03783) 46-6791

**■ ENTRE RIOS**

C. del Uruguay LTV Service 9 de Julio 1442 (03442) 43-3026  
 Concordia El Taller – Mavric San Martín 237 (0345) 421-7069  
 Gualeguaychú Centro de Servicios Electrónicos Santiago Díaz 22 (03446) 42-8380  
 Paraná Laser Electrónica Pascual Palma 382 (0343) 431-3056 (0343) 432-0636

**■ FORMOSA**

Formosa Vallejos Televisión Mitre 276 (03717) 43-5985

**■ JUJUY**

Perico Electrónica Pal-Color – Porfido Escolastico Zegada 47 (0388) 49-11696  
 S. S. de Jujuy Total Service Jujuy Urdininea 233 (0388) 431-0911

**■ LA PAMPA**

Gral. Pico Electrónica M.D. Calle 20 N° 370 (02302) 42-5047  
 Santa Rosa Tecnocyl Centro de Servicios Av. Roca 179 (02954) 42-6602 (02954) 42-6836

**■ LA RIOJA**

La Rioja Telecolor Vásquez España 450 – B° Evita (03822) 46-5354

**■ MENDOZA**

Godoy Cruz Video Sistemas Fray Luis Bellán 1729 (0261) 424-1111/37 (0261) 424-9601  
 San Rafael Diger Service Técnico Chile 314 (02627) 42-5620

**■ MISIONES**

El Dorado Teleson Polonia 24 (03751) 42-4014 (03751) 42-3043  
 Leandro N. Alem Megatones C. de Obligado 247 (03754) 42-1236  
 Posadas Electrónica Cejo Av. Lopez Torres 2623 (03752) 42-5921 (03752) 46-7953

**■ NEUQUEN**

Cutral-Có Servitran Di Paolo 570 (0299) 496-1957  
 Neuquén Gatti Electrónica J.A. Roca 1124 (0299) 443-4855 (0299) 443-1489  
 Neuquén Tevesur Fotheringham 110 (0299) 443-0679  
 S. Martín de los Andes Zener Electrónica Elordi 614 (02972) 42-5155

**■ RIO NEGRO**

Río Colorado A.V.C. Electronica Saenz Peña 297 (02931) 43-2688  
 Bariloche HC Electronica - Sociolovy Av. 12 de Octubre 1575 (02944) 43-0219

**■ SALTA**

Salta Service Salta Alvarado 1066 (0387) 431-7256

**■ SAN JUAN**

San Juan King Electrónica Mendoza 802 (Sur) (0264) 422-8918 (0264) 422-2720

**■ SAN LUIS**

San Luis Rizzotto Carlos Antonio Junin 679 (02652) 42-8747  
 Villa Mercedes Electrónica Ciancia León Guillet 380 (02657) 42-3990

**■ SANTA CRUZ**

Río Gallegos Cosmos Video Mariano Moreno 46 (02966) 42-0456 (02966) 43-7902

**■ SANTA FE**

Rafaela Francesconi Reparaciones Bv. Roca 475 (03492) 42-2292 (03492) 50-2292  
 Reconquista Sponton Alfredo Habbergger 1516 (03482) 42-1523  
 Rosario Electarg S.R.L. Italia 1320 (0341) 421-7700  
 Rosario Imagen y Sonido – Altaria Pte. Roca 371 (0341) 440-1598  
 Rosario SIF S.R.L. España 470 (0341) 425-2625 (0341) 425-8180  
 San Jorge Mandrile Alcides H.Yrigoyen 1543 (03406) 44-0513  
 Santa Fé Electro TV Talcahuano 7301 (0342) 46-03248  
 Santa Fé Litoral Service SRL 9 de Julio 2785 (0342) 453-3563  
 Santa Fé Litoral Service SRL 9 de Julio 2785 (0342) 453-3563  
 Santa Fé Siglo XXI Aristóbul del valle 4554 (0342) 457-2827  
 Santo Tome Siglo XXI Falucho 2201 (0342) 475-1526  
 Venado Tuerto Degiovanni Adalberto Juan Av. Hipolito Yrigoyen 1289 (03462) 42-4613 (03462) 46-3546

**■ SANTIAGO DEL ESTERO**

Stgo. del Estero Barchini Raúl Enrique Rivadavia 833 (0385) 421-3872

**■ TUCUMAN**

S.M. De Tucumán Edu Mag SRL Marco Avellaneda 129 (0381) 422-9078

# CERTIFICADO DE GARANTÍA VALIDO EN BOLIVIA, CHILE, PARAGUAY Y URUGUAY



# PHILIPS

## ¡Felicitaciones! Acaba de adquirir un producto Philips - Lifestyle Entertainment.

Para su total tranquilidad, garantizamos el perfecto funcionamiento de su producto durante el período de garantía estipulado en este documento, y ante cualquier emergencia ponemos a su disposición nuestra **Red de Servicios Técnicos Autorizados** en cada país.

Philips garantiza al comprador de este producto, el normal funcionamiento contra cualquier defecto de fabricación y/o vicio de material, y se compromete a reparar el mismo, incluyendo la mano de obra necesaria, componentes y piezas que necesiten ser reemplazadas - sin cargo alguno para el adquiriente - cuando el mismo fallare en situaciones normales de uso y bajo las condiciones que a continuación se detallan.

### IMPORTANTE

1. El presente certificado de garantía es válido únicamente en los siguientes países:
  - 1.1. Estado Plurinacional de Bolivia,
  - 1.2. República de Chile,
  - 1.3. República del Paraguay,
  - 1.4. República Oriental del Uruguay.
2. Para que el mismo tenga validez, asegúrese de que los siguientes datos se encuentren completos por la casa vendedora y preséntelo conjuntamente con el comprobante original de compra, factura o boleta.

Producto:
Modelo:
Nro. De Serie:
Fecha de Compra:
Lugar de Compra:
Firma y sello de la casa vendedora o distribuidor:

### Datos del comprador:

Nombre:
Cédula de identidad / RUT:
Dirección:
Teléfono:

3. La validez de esta garantía, rige a partir de la fecha de adquisición y por el término de los plazos mencionados en el siguiente cuadro, para cada tipo de producto:

PRODUCTO	GARANTIA
<b>AUDIO PARA EL HOGAR</b>	
Mini Sistemas	1 AÑO
Micro Sistemas	1 AÑO
Parlantes con Dock Android/Apple	1 AÑO
Radio relojes (con o sin dock)	1 AÑO
Parlantes para PC	6 MESES
<b>VIDEO PARA EL HOGAR</b>	
Home Theaters y SoundBars	1 AÑO
Reproductores de Bluray	1 AÑO
Reproductores de DVD	1 AÑO
Mini Sistemas con DVD	1 AÑO
Micro Sistemas con DVD	1 AÑO
<b>ENTRETENIMIENTO PARA AUTOMOVILES</b>	
Autoradios	1 AÑO
Parlantes y potencias	1 AÑO

PRODUCTO	GARANTIA
<b>ENTRETENIMIENTO PORTÁTIL</b>	
Radios portátiles	1 AÑO
Parlantes portátiles	6 MESES
Parlantes Bluetooth	6 MESES
Reproductores de CD portátiles	6 MESES
Cámaras fotográficas digitales	1 AÑO
Reproductores de MP3 y MP4	1 AÑO
Reproductores de DVD Portátiles	1 AÑO
Tablets	1 AÑO
<b>ACCESORIOS</b>	
Marcos para fotos	1 AÑO
Teléfonos inalámbricos	1 AÑO
Cámaras de monitoreo por Wifi	6 MESES
Auriculares / Audífonos	6 MESES
Accesorios para aplicaciones	6 MESES

4. Serán causas de anulación de esta garantía, en los casos que corresponda:
- 4.1. El uso inadecuado del producto o distinto del uso doméstico.
  - 4.2. Exceso o caídas de tensión eléctrica que impliquen su uso en condiciones anormales.
  - 4.3. La instalación y/o uso en condiciones incorrectas y/o distintas a las indicadas en el “Manual de uso” que se adjunta al producto.
  - 4.4. Cualquier intervención del producto por terceros o personas ajenas a los Servicios Técnicos Autorizados de Philips, quienes son los únicos para calificar y reparar las averías de los productos.
  - 4.5. Enmiendas o raspaduras en los datos incluidos en la etiqueta del artefacto, certificado de garantía o factura.
  - 4.6. Falta de comprobante original de compra que detalle tipo de artefacto, modelo, número de serie y fecha que coincida con los del encabezamiento del presente certificado.
5. No están cubiertos por esta garantía los siguientes casos:
- 5.1. Los daños ocasionados al exterior del gabinete.
  - 5.2. Las roturas, golpes, caídas o rayaduras causadas por traslados o descuidos del usuario.
  - 5.3. Los daños o fallas ocasionados por deficiencias, sobretensiones / sobre voltaje, descargas o interrupciones del circuito de conexión del artefacto a fuentes de energía eléctrica (Red eléctrica, pilas, baterías, etc).
  - 5.4. Las fallas, daños, roturas o desgastes producidos por el maltrato o uso indebido del artefacto y/o causadas por inundaciones, incendios, terremotos, tormentas eléctricas, golpes o accidentes de cualquier naturaleza.
  - 5.5. Las fallas producidas por una mala recepción ocasionada en el uso de una antena deficiente o en señales de transmisión débiles.
  - 5.6. Las fallas o daños ocasionados en desperfectos en la línea telefónica.
6. Las condiciones de instalación y uso del artefacto se encuentran detalladas en el Manual de Uso del mismo.
7. La empresa no asume responsabilidad alguna por los daños personales o a la propiedad del usuario o a terceros que pudieran causar la mala instalación o uso indebido del artefacto, incluyendo en este último caso a la falta de mantenimiento.
8. En caso de falla, el usuario deberá requerir la reparación a la empresa a través del Servicio Técnico Autorizado más próximo a su domicilio y cuyo listado acompaña el presente documento. La empresa asegura al usuario la reparación y/o reposición de piezas para su correcto funcionamiento en un plazo no mayor a 30 días contados a partir de la fecha de solicitud de reparación, salvo caso fortuito o de fuerza mayor.
9. Toda intervención del servicio técnico realizada a pedido del usuario dentro del plazo de garantía, que no fuera originada por falla o defecto alguno cubierto por este certificado, deberá ser abonada por el interesado de acuerdo a la tarifa vigente.
10. El presente certificado anula cualquier otra garantía implícita o explícita, por la cual y expresamente no autorizamos a ninguna otra persona, sociedad o asociación a asumir por nuestra cuenta ninguna responsabilidad con respecto a nuestros productos.

## CENTROS DE ATENCIÓN AL CLIENTE

<b>BOLIVIA</b> Tel.: 800 100 664 (Número gratuito)	<b>CHILE</b> Tel.: 600 744 5477 <a href="http://www.philips.cl">www.philips.cl</a>	<b>PARAGUAY</b> Tel.: 009 800 541 0004 (Número gratuito)	<b>URUGUAY</b> Tel.: 0004 054 176 (Número gratuito)
--	--	--	---

## CENTROS DE SERVICIO TÉCNICO AUTORIZADOS

### CENTROS DE SERVICIO TÉCNICO AUTORIZADOS EN BOLIVIA

<b>CESER – BOLIVIA SRL</b>		<a href="mailto:jpasache@entelnet.bo">jpasache@entelnet.bo</a>	(02) 212-4913
Gerente General Ing. Juan Pasache C.			
<b>La Paz</b>	Sr José Luis Mamani	Calle Villalobos N. 100 esq. Busch, Miraflores	(02) 222-4924
<b>La Paz</b> (Solo Talleres)	Sr. José Luis Mamani	Calle Villalobos N. 1337, entre Av. Saavedra y Av. Busch, Miraflores.	-
<b>El Alto</b>	Sr. Heriberto Vera	Calle 4 N. 444, entre Demetrio Moscoso y Francisco Carbajal, Villa Dolores	Cel 775-44269
<b>Cochabamba</b>	Sr. Rolando Rocha A.	Calle Uruguay N. 211 esq. Nataniel Aguirre	(04) 450-1894 (04) 412-6762
<b>Cochabamba</b>	Sr. Remberto Rocha Sr. Amilcar Delgado	Calle Arque N. 1904, entre Angostura y Av. Ayacucho, Zona Sud frente a rieles estación	(04) 412-4724
<b>Quillacollo</b>	Sr. Fernando Rocha	Av. Blanco Galindo N. 410 Km 13,5, al costado de la Residencial Reyna	(04) 436-7513
<b>Santa Cruz</b>	Sr. Antonio Ale.	Calle Colón N. 321, enter Pari y Mercado	(03) 330-3292 (03) 311-4649
<b>Santa Cruz</b> (Línea blanca)	Sr. David Paredes.	Av. Paragua 2415-A, entre 2do y 3er anillo entrando por calle Socoris	(03) 390-1672
<b>Oruro</b>	Sr. Juan Carlos Campos.	Calle Pagador N. 5779, entre Ayacucho y Cochabamba	(02) 511-1866
<b>Sucre</b>	Sr. Amael Cocha	Calle Pando N. 10, Zona Mercado Campesino	(04) 64-65089
<b>Tarija</b>	Sr. Ruben Montoya	Calle Junin 767, entre Bolivar e Ingavi, Cercado	(04) 66-58267
<b>Montero</b>	Centro de Acopio (no atiende clientes)	Av. Circunvalación N. 800 esq. Buenos Aires, Barrio 25 de Diciembre	(03) 92-27523
<b>Potosi</b>	Sr. Amael Cocha	Calle 1ero de Abril N. 700, entre Calle Bustillos y Chayanta, Zona Central	Cel 604-74537

### CENTROS DE SERVICIO TÉCNICO AUTORIZADOS EN CHILE

<b>I</b>	<b>Iquique</b>	Servitec	Hernán Fuenzalida 1030	57 - 2575139
<b>II</b>	<b>Antofagasta</b>	Casa Delta	Prat 789	55 - 2268883 55 - 2261788
	<b>Calama</b>	Servicio Técnico Carvajal	Latorre 1452	55 - 2361046
<b>III</b>	<b>Copiapó</b>	Electrónica El Palomar	Salitrera Rosario 2192, El Palomar	52 - 2233328 52 - 2364767
	<b>La Serena</b>	Centro Técnico Acuarela	Balmaceda 373	51 - 2222729 51 - 2225229
<b>IV</b>	<b>La Serena</b>	Electrónica Nueva Zener	O'Higgins 701 B	51 - 2224576
	<b>Coquimbo</b>	Electronica Belen	Los Clarines 870 Psindempart	51 - 2261052
<b>V</b>	<b>San Felipe</b>	Electronica Max Echeverria	Av. Bernardo O'Higgins 279-A	34 - 2505064 34 - 2535433
	<b>Limache</b>	Elena Álvarez	Urmeneta 365	33 - 2412553
	<b>Valparaiso</b>	Servicio Tec. Viña del Mar	Huito 572	32 - 2253925
	<b>Viña del Mar</b>	Servicio Tec. Viña del Mar	Quinta 209	32 - 2882691
<b>VI</b>	<b>Rancagua</b>	Multivisión	Ibieta 223	72 - 2228429
	<b>San Fernando</b>	Electrónica Colchagua	España 711	72 - 2717207
	<b>Santa Cruz</b>	Electronica Livaj	Av. Errázuriz 1096 –A	72 - 2821322

	<b>Curicó</b>	Audio Video Sistemas Ltda.	Vidal 671	75 - 2311561
	<b>Talca</b>	Audiovisión	9 Oriente 1121	71 - 2225974 71 - 2233540
<b>VII</b>	<b>Talca</b>	Servital	7 Norte 3060	(movil) 9-5491620
	<b>Talca</b>	Centro de Atención Técnica Ltda.	2 Sur 1667, entre 9 y 10 Oriente	71 - 2212576 71 - 2210729
	<b>Linares</b>	Tecnihogar	Lautaro 533	73 - 2213031
	<b>Chillán</b>	Telestereo	5 de Abril 336	42 - 2224155 42 - 2329272 42 - 2231515
<b>VIII</b>	<b>Concepción</b>	Cristina C. Avello M	Las Heras 259, 2° piso.	41 - 2232641 41 - 2981508
	<b>Los Ángeles</b>	Julio Quiroz	Galvarino 420	43 - 2313161
	<b>Angol</b>	ABT Electronica	Covadonga 1475	(movil) 7-4564738
	<b>Temuco</b>	Esina (Temuco)	Manuel Montt 198	45 - 2261885 45 - 2242727
<b>IX</b>	<b>Castro</b>	BRADI Servicios de Ingeniería SpA	Sargento Aldea 589	65 - 2534647
	<b>Pucon</b>	Marcelo Alejandro Ciraulo	Brasil 445	45 - 2441823
	<b>Osorno</b>	Servitodo Electrónica	Perez 559	64 - 2232874
<b>X</b>	<b>Puerto Montt</b>	Full Service	Antonio Varas 70 B	65 - 2717720 65 - 2254867
<b>XI</b>	<b>Coyhaique</b>	Servitelco	General Parra 220, Loc 2	67 - 2231149
<b>XII</b>	<b>Punta Arenas</b>	Electrónica MT	Belisario García 0781	61 - 2218841
	<b>Providencia</b>	Plus Service	Av. Santa María 0858 - Providencia	2 - 24840800
<b>RM</b>	<b>La Florida</b>	INSEL	Avenida La Florida 9039	2 - 22873808
	<b>Maipú</b>	PCElectrónica	Chacabuco 271 - Maipú	2 - 25340927
	<b>Melipilla</b>	Jaime Osorio y Cia.	Ortuzar 164 Melipilla	2 - 28323153
<b>XIV</b>	<b>Valdivia</b>	Esina (Valdivia)	Arauco 842	63 - 2253505 58 - 2231981 58 - 2314026
<b>XV</b>	<b>Arica</b>	Centro Tecnico Integral	Juan Noe 1233	
<b>CENTROS DE SERVICIO TÉCNICO AUTORIZADOS EN PARAGUAY</b>				
	<b>Asunción</b>	<b>Umesys SRL</b>	<b>R.I. 6 Boquerón 1559, c/ Serafina Dávalos</b>	<b>(021) 623835</b>
	<b>Asunción</b>	Sirio SRL	Iturbe 470 e/cerro Corá y 25 de Mayo	(021) 449753 (021) 447333
	<b>Asunción</b>	SCJ Service	Av. Gral. Artigas N° 1295 c/ Av. Gral. Santos	(021) 203465 (021) 226583
	<b>Ciudad del Este</b>	Audio & Video	Paso de Patria c/ Av. Gral. Bernardino Caballero	(061) 502962
	<b>Concepción</b>	Electrónica Concepción	Prof. Hernan Aponte c/ Antonio Caba (Bo. Primavera)	(0331) 240960
	<b>Coronel Oviedo</b>	Electrónica Total	Gral. Eugenio A. Garay N°148 C/Tte. Fariña	(0521) 205466 (071) 202616
	<b>Encarnación</b>	Makoto Servicio Técnico	Villarrica 472 c/ Carlos Antonio López	(071) 202516
	<b>Pedro Juan Caballero</b>	VICSA Electrónica	Brasil c/ Teresa Roa Caballero	(0336) 273399
	<b>San Estanislao</b>	Servimas Electrónica	Coronel Zoilo González c/Antequera	(0981) 977654 (0541) 40803
	<b>Villarrica</b>	Néstor Electrónica	República Argentina c/ Ita Ybate	(0981) 631619
<b>CENTROS DE SERVICIO TÉCNICO AUTORIZADOS EN URUGUAY</b>				
	<b>Montevideo</b>	CKL Uruguay S.R.L.	Gaboto 1550 esquina Mercedes	(598) 2402-3951 (598) 2400-8735





Specifications are subject to change without notice  
© 2014 Koninklijke Philips N.V. All rights reserved.  
Trademarks are the property of Koninklijke Philips N.V. or their respective owners.

HTD5520/5550/5580\_55\_UM\_V1.0

