

# Indoor Housings

**Instructions for Use**



## LTC 9350 Series



# IMPORTANT SAFEGUARDS

1. Read Instructions - All the safety and operating instructions should be read before the unit is operated.
2. Retain Instructions - The safety and operating instructions should be retained for future reference.
3. Heed Warnings - All warnings on the unit and in the operating instructions should be adhered to.
4. Follow Instructions - All operating and use instructions should be followed.
5. Cleaning - Unplug the unit from the outlet before cleaning. Do not use liquid cleaners or aerosol cleaners. Use a damp cloth for cleaning.
6. Attachments - Do not use attachments not recommended by the product manufacturer as they may cause hazards.
7. Water and Moisture - Do not use this unit near water - for example, near a bath tub, wash bowl, kitchen sink, or laundry tub, in a wet basement, near a swimming pool, in an unprotected outdoor installation, or any area which is classified as a wet location.
8. Accessories - Do not place this unit on an unstable stand, tripod, bracket, or mount. The unit may fall, causing serious injury to a person and serious damage to the unit. Use only with a stand, tripod, bracket, or mount recommended by the manufacturer, or sold with the product. Any mounting of the unit should follow the manufacturer's instructions, and should use a mounting accessory recommended by the manufacturer.

An appliance and cart combination should be moved with care. Quick stops, excessive force, and uneven surfaces may cause the appliance and cart combination to overturn.





9. Ventilation - Openings in the enclosure, if any, are provided for ventilation and to ensure reliable operation of the unit and to protect it from overheating. These openings must not be blocked or covered. This unit should not be placed in a built-in installation unless proper ventilation is provided or the manufacturer's instructions have been adhered to.
10. Power Sources - This unit should be operated only from the type of power source indicated on the marking label. If you are not sure of the type of the power supply you plan to use, consult your appliance dealer or local power company. For units intended to operate from battery power, or other sources, refer to the operating instructions.
11. Grounding or Polarization - This unit may be equipped with a polarized alternating-current line plug (a plug having one blade wider than the other). This plug will fit into the power outlet only one way. This is a safety feature. If you are unable to insert the plug fully into the outlet, try reversing the plug. If the plug should still fail to fit, contact your electrician to replace your obsolete outlet. Do not defeat the safety purpose of the polarized plug.  

Alternately, this unit may be equipped with a 3-wire grounding-type plug, a plug having a third (grounding) pin. This plug will only fit into a grounding-type power outlet. This is a safety feature. If you are unable to insert the plug into the outlet, contact your electrician to replace your obsolete outlet. Do not defeat the safety purpose of the grounding-type plug.
12. Power-Cord Protection - Power-supply cords should be routed so that they are not likely to be walked on or pinched by items placed

upon or against them, paying particular attention to cords and plugs, convenience receptacles, and the point where they exit from the appliance.

13. Power Lines - An outdoor system should not be located in the vicinity of overhead power lines or other electric light or power circuits, or where it can fall into such power lines or circuits. When installing an outdoor system, extreme care should be taken to keep from touching such power lines or circuits as contact with them might be fatal. U.S.A. models only - refer to the National Electrical Code Article 820 regarding installation of CATV systems.
14. Overloading - Do not overload outlets and extension cords as this can result in a risk of fire or electric shock.
15. Object and Liquid Entry - Never push objects of any kind into this unit through openings as they may touch dangerous voltage points or short-out parts that could result in a fire or electric shock. Never spill liquid of any kind on the unit.
16. Servicing - Do not attempt to service this unit yourself as opening or removing covers may expose you to dangerous voltage or other hazards. Refer all servicing to qualified service personnel.
17. Damage Requiring Service - Unplug the unit from the outlet and refer servicing to qualified service personnel under the following conditions:
  - a. When the power-supply cord or plug is damaged.
  - b. If liquid has been spilled, or objects have fallen into the unit.
  - c. If the unit has been exposed to rain or water.
  - d. If the unit does not operate normally by following the operating instructions. Adjust only those controls that are covered by the operating instructions, as an improper adjustment of other controls may result in damage and will often require extensive work by a qualified technician to restore the unit to its normal operation.
  - e. If the unit has been dropped or the cabinet has been damaged.
  - f. When the unit exhibits a distinct change in performance--this indicates a need for service.
18. Replacement Parts - When replacement parts are required, be sure the service technician has used replacement parts specified by the manufacturer or have the same characteristics as the original part. Unauthorized substitutions may result in fire, electric shock or other hazards.
19. Safety Check - Upon completion of any service or repairs to this unit, ask the service technician to perform safety checks to determine that the unit is in proper operating condition.
20. Coax Grounding - If an outside cable system is connected to the unit, be sure the cable system is grounded. U.S.A. models only--Section 810 of the National Electrical Code, ANSI/NFPA No.70-1981, provides information with respect to proper grounding of the mount and supporting structure, grounding of the coax to a discharge unit, size of grounding conductors, location of discharge unit, connection to grounding electrodes, and requirements for the grounding electrode.
21. Lightning - For added protection of this unit during a lightning storm, or when it is left unattended and unused for long periods of time, unplug it from the wall outlet and disconnect the cable system. This will prevent damage to the unit due to lightning and power-line surges.

# SAFETY PRECAUTIONS

	<b>CAUTION</b> RISK OF ELECTRIC SHOCK. DO NOT OPEN!	
<b>CAUTION: TO REDUCE THE RISK OF ELECTRICAL SHOCK, DO NOT OPEN COVERS. NO USER SERVICEABLE PARTS INSIDE. REFER SERVICING TO QUALIFIED SERVICE PERSONNEL.</b>		

This label may appear on the bottom of the unit due to space limitations.

 The lightning flash with an arrowhead symbol, within an equilateral triangle, is intended to alert the user to the presence of uninsulated "dangerous voltage" within the product's enclosure that may be of sufficient magnitude to constitute a risk of electric shock to persons.

 The exclamation point within an equilateral triangle is intended to alert the user to presence of important operating and maintenance (servicing) instructions in the literature accompanying the appliance.

<b>Warning</b> To prevent fire or shock hazard, do not expose this unit to rain or moisture.
---

## CONTENTS

<b>1 UNPACKING</b> .....	<b>3</b>
<b>3 DESCRIPTION</b> .....	<b>3</b>
<b>4 INSTALLATION</b> .....	<b>3</b>
4.1 Models.....	3
4.2 Low Voltage Operation .....	3
4.3 Camera/Lens Installation.....	3
<b>5 ILLUSTRATION</b> .....	<b>6</b>
<b>6 RECOMMENDED APPLICATIONS</b> .....	<b>7</b>
<b>7 PARTS LIST</b> .....	<b>8</b>

## 1 UNPACKING

Unpack carefully. This is electro-mechanical equipment and should be handled with care.

Check for the following items:

- Model number of unit.
- Installation and Operating Instructions.

If an item appears to have been damaged in shipment, replace it properly in its carton and notify the shipper. If any items are missing, notify your Philips Communication & Security Systems Inc. Sales Representative or Customer Service.

The shipping carton is the safest container in which the unit may be transported. Save it for possible future use.

## 2 SERVICE

If the unit ever needs repair service, the customer should contact the nearest Philips Communication & Security Systems Inc. Service Center for return authorization and shipping instructions.

### Service Centers

U.S.A. & Canada: 800-366-2283  
 Mexico & Central America: 52-5-564-2726  
 Europe & Middle East: 44-1932-765666  
 South America: 54-1-956-0837  
 Australia: 61-2-888-9000  
 New Zealand: 64-4-237-7297

## 3 DESCRIPTION

The LTC 9350 Series of environmental housings are attractive aluminum enclosures designed for indoor CCD camera installations. Slim and compact, the LTC 9350 Series are available in three lengths.

## 4 INSTALLATION

 **THIS INSTALLATION SHOULD BE MADE BY QUALIFIED SERVICE PERSONNEL AND SHOULD CONFORM TO ALL LOCAL CODES.**

### 4.1 Models

#### LTC 9352/00:

Accepts cameras up to 64 W x 54 H mm (2.5 x 2.1 in), lenses up to 58 W x 64 H mm (2.3 x 2.5 in), and camera/lens combinations up to 190 mm L (7.5 in).

#### LTC 9352/01:

Accepts cameras up to 64 W x 54 H mm (2.5 x 2.1 in), lenses up to 58 W x 64 H mm (2.3 x 2.5 in), and camera/lens combinations up to 216 mm (8.5 in).

 **Caution: For UL and cUL Approved LTC 9352/01 Models, Use only Class 2 power source with this unit.**

#### LTC 9353/00:

Accepts cameras up to 64 W x 54 H mm (2.5 x 2.1 in), lenses up to 58 W x 64 H mm (2.3 x 2.5 in), and camera/lens combinations up to 224 mm L (8.8 in).

#### LTC 9358/00:

Accepts cameras up to 64 W x 54 H mm (2.5 x 2.1 in), lenses up to 58 W x 64 H mm (2.3 x 2.5 in), and camera/lens combinations up to 325 mm L (12.8 in).

See **RECOMMENDED APPLICATIONS**.

### 4.2 Low Voltage Operation

Do not exceed 30 VAC input on 24 VAC model cameras. Operation above 30 VAC violates low voltage operation (Class 2 Specifications). Normal operation is 24 VAC.

### 4.3 Camera/Lens Installation

**Note: LTC 9352/01 Models do not contain a wiring terminal block.**

1. Remove the two (2) 6-32 x 1/2-inch long Phillips head screws from the end cap. See **Figure 1**.

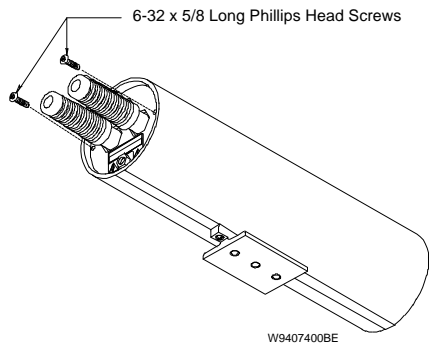

**Figure 1: Remove Phillips Head Screws**

- Remove the end cap from the housing by pulling out the cradle assembly. See **Figure 2**.

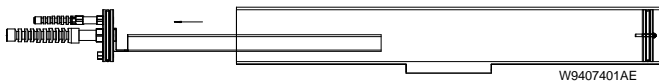

**Figure 2: Remove Cradle Assembly**

- Place the camera/lens on the cradle assembly. The correct positioning for mounting either a camera with a fixed lens or a camera with a zoom lens is shown in **Figure 3**.

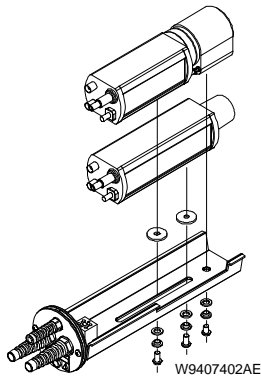

**Figure 3: Camera/Lens Mounting Positions**

- Fixed Lens Cameras:** Secure the camera/lens to the cradle with the 1/4-20 x 1/2-inch screw, nylon bushing, 5/16-inch flat washer, and 2.5 mm (0.100 inch) plastic washer. Make sure the thermoplastic shield is under the camera in the correct position. Be sure that the nylon bushing is in place. All hardware shown below **must** be used. For LTC 0240 Series cameras, use 1/4-20 x 7/8 inch BHCS, nylon bushing, 5/16-inch flat washer, and 9.8 mm (0.385 inch) plastic spacer. See **Figure 4**.

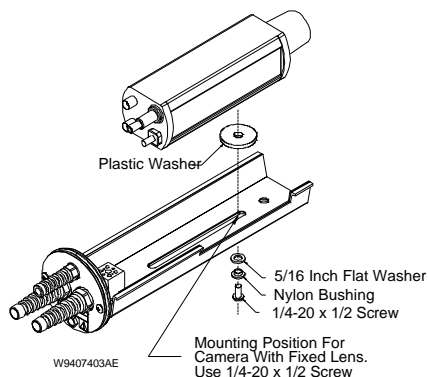

**Figure 4: Camera/Fixed Lens Mounting Position**

**Zoom Lens Cameras:** Use same procedure as fixed lens cameras. All hardware shown below **must** be used. See **Figure 4a**.

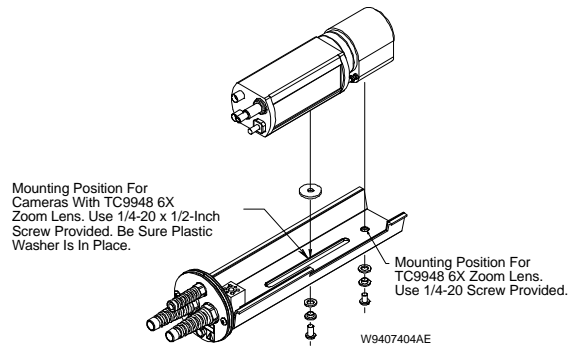
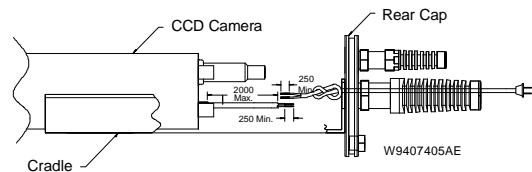

**Figure 4a: Camera/Zoom Lens Mounting Positions LTC 9353/00 and LTC 9358/00 Only**

**Note:** Refer to section 5a for LTC 9352/01 model power wiring instructions.

- When installing 120 or 220 volt cameras, the camera power cord must be cut leaving enough cable to strip and attach to the terminal block. Strip no less than 6 mm (1/4 in) and no more than 8 mm (5/16 in) of insulation away from the wires, making sure not to nick the wires. Attach the wires to the terminal block. See **Figure 5** and **Figure 6**.

Insert the loose end of the power supply cable or the remainder of the camera power cord through the lower right fitting. The fitting accepts cables with diameters from 1.8 mm (0.07 in) to 6.6 mm (0.26 in). Tie a figure-eight knot in the wire to prevent strain on internal circuits. Repeat the same procedure for stripping the wires. Attach the wires to the opposite side of the terminal block. Crimp the ground wire to the ground lug located on the reverse side of the cradle. See **Figure 5** and **Figure 6**.



**Figure 5: Cut Camera Power Cord**

**Note:** If power is supplied from a pan/tilt feed thru, follow the same instructions as above for wiring procedures. **Figure 6** shows the relationship with color codes.

**Hint:** For ease of wiring, remove the terminal block from its mounted position. Wire accordingly and remember to maintain polarity. Remount the terminal block with the wires in place. See **Figure 6**.

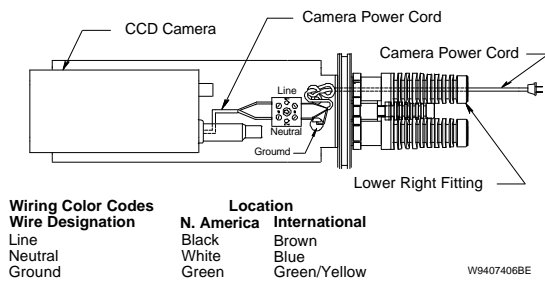

**Figure 6: Terminal Block Wiring**

Pull excess wire out of the cradle assembly. Tighten the fitting around the cable to create a liquid tight fit.

**Note:** LTC 9352/01 models do not contain a wiring terminal block.

- 5a. **LTC 9352/01 Models Only:** Strip the power supply cable ends by removing no less than 6 mm (0.25 in) and no more than 8 mm (5/16 in) of insulation away from the wires, making sure not to nick the wires. Insert the loose end of the power supply cable through the lower right fitting. Tie a figure-eight knot in the wire to prevent strain on internal circuits. Connect the cable directly to the terminal block located on the rear of the camera. Crimp the ground wire to the ground lug located on the reverse side of the cradle (if available).
6. Pull the video cable through the top fitting on the end cap. The fitting accepts cables with diameters from 2.9 mm (0.11 in) to 6.4 mm (0.25 in).

Attach a BNC connector to the video cable and connect it to the camera. See **Figure 7**. Pull excess cable out of the cradle assembly. Tighten the fitting around the cable to create a liquid tight fit. Use the tie wrap (included) to provide strain relief on the video cables at the exit point.

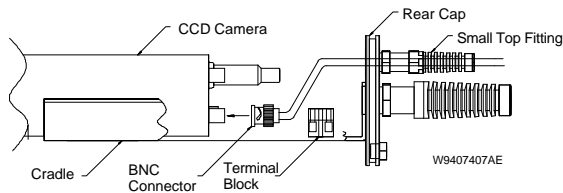
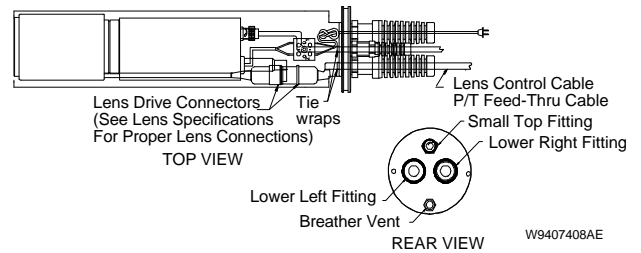

**Figure 7: BNC Connection**

7. **If installing a zoom lens,** insert the lens control cable through the lower left fitting of the end cap. Attach the lens wiring to the lens mating connector (if supplied), and connect to the lens. If a mating connector is not

available, connect directly to the lens cables. Pull any excess wire out of the cradle assembly. Tighten the fitting around the cable to create a liquid tight fit. See **Figure 8**. Use the tie wrap to provide strain relief on the lens control cable at the exit point.

If installing a fixed lens, go to step 9.



**Figure 8: Completed Wiring Diagram**

8. **If using a pan/tilt with a feedthru cable,** insert the camera/lens function cable through the lower left fitting of the end cap. The fitting accepts cables with diameters from 1.8 mm (0.07 in) to 6.6 mm (0.26 in).  
Wire the functions, as described above (steps 5-7), or as needed. Pull any excess wire out of the cradle assembly. Tighten the fitting around the cable to create a liquid tight fit. See **Figure 8**. Use the tie wrap to provide strain relief on cable at the exit point.
9. Adjust the camera focus and iris if necessary.
10. Replace the cradle into the side rails and slide the assembly into the housing until the end cap is securely closed.
11. Replace the two (2) Phillips head screws and tighten.
12. Attach the housing to the appropriate mount or pan/tilt using the instructions provided.

# 5 ILLUSTRATION

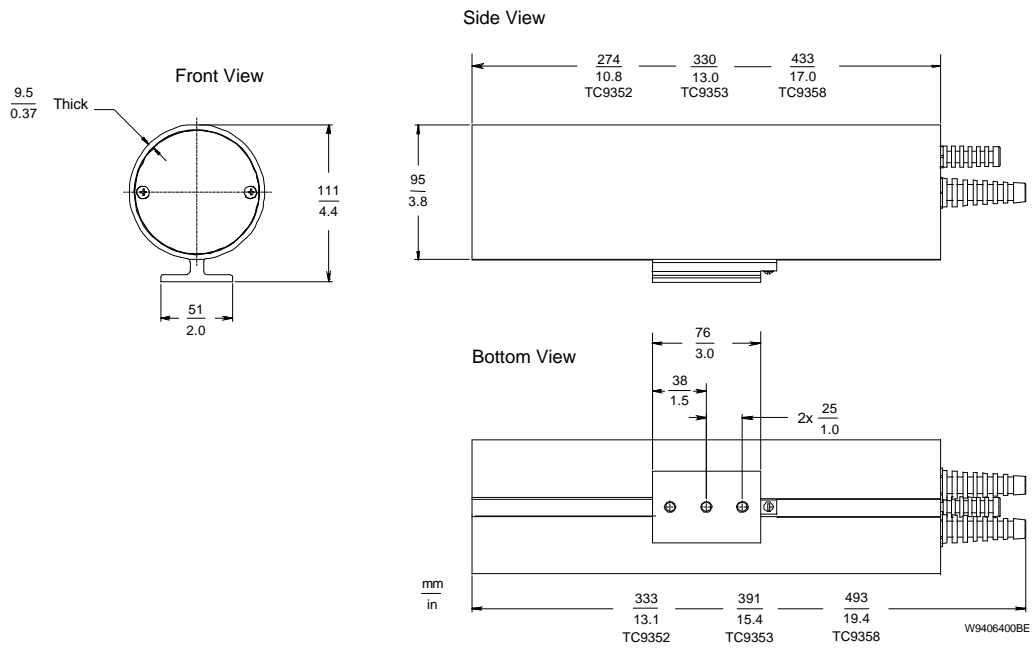

Figure 9: Dimensional Outline

## 6 RECOMMENDED APPLICATIONS

The LTC 9350 Series are UL Listed to Standard 1409. The following cameras must be used in these housings to maintain the UL Listing.

Camera Models	Rated Operating Voltage	Suggested Lenses			
		LTC 9352/00 Housing	LTC 9352/01 Housing	LTC 9353/00 Housing	LTC 9358/00 Housing
LTC 0142/60	120 VAC	with 3 mm lens	with 3 mm lens	with 3 mm lens	with 3 mm lens
LTC 0143/60	120 VAC	with 6 mm lens	with 6 mm lens	with 6 mm lens	with 6 mm lens
LTC 0142/20	24 VAC or 12 VDC	with 3 mm lens	with 3 mm lens	with 3 mm lens	with 3 mm lens
LTC 0143/20	24 VAC or 12 VDC	with 6 mm lens	with 6 mm lens	with 6 mm lens	with 6 mm lens
LTC 0242/60	120 VAC	with 3 mm lens	with 3 mm lens	with 3 mm lens	with 3 mm lens
LTC 0243/60	120 VAC	with 6 mm lens	with 6 mm lens	with 6 mm lens	with 6 mm lens
LTC 0242/20	24 VAC or 12 VDC	with 3 mm lens	with 3 mm lens	with 3 mm lens	with 3 mm lens
LTC 0243/20	24 VAC or 12 VDC	with 6 mm lens	with 6 mm lens	with 6 mm lens	with 6 mm lens
LTC 0330/20	24 VAC or 12 VDC	Fixed	Fixed	Fixed	Fixed, TC9938, TC9948A
LTC 0330/60	120 VAC	Fixed	Fixed	Fixed	Fixed, TC9938, TC9948A
LTC 0350/20	24 VAC or 12 VDC	Fixed	Fixed	Fixed	Fixed, TC9938, TC9948A
LTC 0350/60	120 VAC	Fixed	Fixed	Fixed	Fixed, TC9938, TC9948A
LTC 0430/20	24 VAC or 12 VDC	Fixed	Fixed	Fixed	Fixed, TC9938, TC9948A
LTC 0430/60	120 VAC	Fixed	Fixed	Fixed	Fixed, TC9938, TC9948A
LTC 0450/20	24 VAC or 12 VDC	Fixed	Fixed	Fixed	Fixed, TC9938, TC9948A
LTC 0450/60	120 VAC	Fixed	Fixed	Fixed	Fixed, TC9938, TC9948A
TC351A	120 VAC	---	---	Fixed	Fixed, TC9948A
TC352A	24 VAC	---	---	Fixed	Fixed, TC9948A
TC355AC	12 VDC	---	---	Fixed	Fixed, TC9948A
TC360 Series	120 VAC, 24 VAC, 12 VDC	---	Fixed	Fixed	Fixed, TC9948A
TC370 Series	120 VAC, 24 VAC, 12 VDC	---	Fixed	Fixed	Fixed, TC9938, TC9948A
TC380 Series	120 VAC, 24 VAC, 12 VDC	---	Fixed	Fixed	Fixed, TC9948A
TC390 Series	120 VAC, 24 VAC, 12 VDC	---	Fixed	Fixed	Fixed, TC9938, TC9948A
TC551A	120 VAC	---	---	Fixed	Fixed, TC9938, TC9948A
TC552A	24 VAC	Fixed	Fixed	Fixed, TC9938, TC9948A	Fixed, TC9938, TC9948A
TC590 Series	120 VAC, 24 VAC, 12 VDC	---	Fixed	Fixed	Fixed, TC9938, TC9948A
TC652BT	24 VAC	---	---	Fixed	Fixed, TC9948A
TC652B	24 VAC	Fixed	Fixed	Fixed, TC9948A	Fixed, TC9948A
TC952	24 VAC	Fixed	Fixed	Fixed	Fixed
TC972	24 VAC	Fixed	Fixed	Fixed	Fixed
<b>50 Hz Cameras</b>					
LTC 0142/50	220 VAC	with 3 mm lens	with 3 mm lens	with 3 mm lens	with 3 mm lens
LTC 0143/50	220 VAC	with 6 mm lens	with 6 mm lens	with 6 mm lens	with 6 mm lens
LTC 0142/10	24 VAC or 12 VDC	with 3 mm lens	with 3 mm lens	with 3 mm lens	with 3 mm lens
LTC 0143/10	24 VAC or 12 VDC	with 6 mm lens	with 6 mm lens	with 6 mm lens	with 6 mm lens
LTC 0242/50	220 VAC	with 3 mm lens	with 3 mm lens	with 3 mm lens	with 3 mm lens
LTC 0243/50	220 VAC	with 6 mm lens	with 6 mm lens	with 6 mm lens	with 6 mm lens
LTC 0242/10	24 VAC or 12 VDC	with 3 mm lens	with 3 mm lens	with 3 mm lens	with 3 mm lens
LTC 0243/10	24 VAC or 12 VDC	with 6 mm lens	with 6 mm lens	with 6 mm lens	with 6 mm lens
LTC 0330/10	24 VAC or 12 VDC	Fixed	Fixed	Fixed	Fixed, TC9938, TC9948A
LTC 0330/50	220 VAC	Fixed	Fixed	Fixed	Fixed, TC9938, TC9948A
LTC 0350/10	24 VAC or 12 VDC	Fixed	Fixed	Fixed	Fixed, TC9938, TC9948A
LTC 0350/50	220 VAC	Fixed	Fixed	Fixed	Fixed, TC9938, TC9948A
LTC 0430/10	24 VAC or 12 VDC	Fixed	Fixed	Fixed	Fixed, TC9938, TC9948A
LTC 0430/50	220 VAC	Fixed	Fixed	Fixed	Fixed, TC9938, TC9948A
LTC 0450/10	24 VAC or 12 VDC	Fixed	Fixed	Fixed	Fixed, TC9938, TC9948A
LTC 0450/50	220 VAC	Fixed	Fixed	Fixed	Fixed, TC9938, TC9948A
TC352AX	24 VAC	---	---	Fixed	Fixed, TC9948A
TC355ACX	12 VDC	---	---	Fixed, TC9948A	Fixed, TC9948A
TC362X	24 VAC	Fixed	Fixed	Fixed	Fixed, TC9948A
TC365X	12 VDC	Fixed	Fixed	Fixed	Fixed, TC9948A
TC372X	24 VAC	Fixed	Fixed	Fixed	Fixed, TC9938, TC9948A
TC375X	12 VDC	Fixed	Fixed	Fixed	Fixed, TC9938, TC9948A
TC382X	24 VAC	Fixed	Fixed	Fixed	Fixed, TC9948A
TC385X	12 VDC	Fixed	Fixed	Fixed	Fixed, TC9948A
TC392X	24 VAC	Fixed	Fixed	Fixed	Fixed, TC9938, TC9948A
TC395X	12 VDC	Fixed	Fixed	Fixed	Fixed, TC9938, TC9948A
TC552AX	24 VAC	Fixed	Fixed	Fixed, TC9938, TC9948A	Fixed, TC9938, TC9948A
TC592X	24 VAC	---	Fixed	Fixed	Fixed, TC9938, TC9948A
TC595X	12 VDC	---	Fixed	Fixed	Fixed, TC9938, TC9948A
TC652BX	24 VAC	Fixed	Fixed	Fixed, TC9948A	Fixed, TC9948A
TC952X	24 VAC	Fixed	Fixed	Fixed	Fixed
TC972X	24 VAC	Fixed	Fixed	Fixed	Fixed

The following cameras are to be used only with housings that require 220-240 volt power supplies. Contact your local Philips Communication & Security Systems Inc. Sales Representative for correct camera/lens combinations.

50 Hz Cameras	Rated Operating Voltage	Suggested Lenses		
		LTC 9352/00 Housing	LTC 9353/00 Housing	LTC 9358/00 Housing
TC354AX	220-240 VAC	---	Fixed	Fixed, TC9948A
TC364X	220-240 VAC	Fixed	Fixed	Fixed, TC9948A
TC374X	220-240 VAC	Fixed	Fixed	Fixed, TC9938, TC9948A
TC384X	220-240 VAC	Fixed	Fixed	Fixed, TC9948A
TC394X	220-240 VAC	Fixed	Fixed	Fixed, TC9948A, TC9938
TC554AX	220-240 VAC	---	Fixed	Fixed, TC9948A, TC9938
TC594X	220-240 VAC	Fixed	Fixed	Fixed, TC9938, TC9948A
TC654BX	220-240 VAC	---	Fixed	Fixed, TC9948A

**Suggested CS Mount Auto-Iris Fixed and Zoom Lenses:**

TC9902: 1/3-inch 2.8 mm, f/1.2, fixed	TC9904: 1/3-inch 4 mm, f/1.2, fixed	TC9908: 1/3-inch 8 mm, f/1.2, fixed
TC9903A: 1/2-inch 3.7 mm, f/1.6, fixed	TC9906A: 1/2-inch 6 mm, f/1.4, fixed	TC9907: 1/2-inch 6 mm, f/1.4, fixed
TC9912A: 1/2-inch 12 mm, f/1.4, fixed	TC9913A: 1/2-inch 12 mm, f/1.4, fixed	
TC9938: 1/3-inch 6.38-38 mm, f/1.2, 6X zoom	TC9948A: 1/2-inch 8-48 mm, f/1.4, 6X zoom	

**Suggested CS Mount, Manual Iris, Fixed Lenses (1/3-inch Cameras):**

TC9702: 1/3-inch 2.8 mm, f/1.3	TC9704: 1/3-inch 4 mm, f/1.2	TC9708: 1/3-inch 8 mm, f/1.2	TC9712: 1/2-inch 12 mm, f/1.4
--------------------------------	------------------------------	------------------------------	-------------------------------

## 7 PARTS LIST

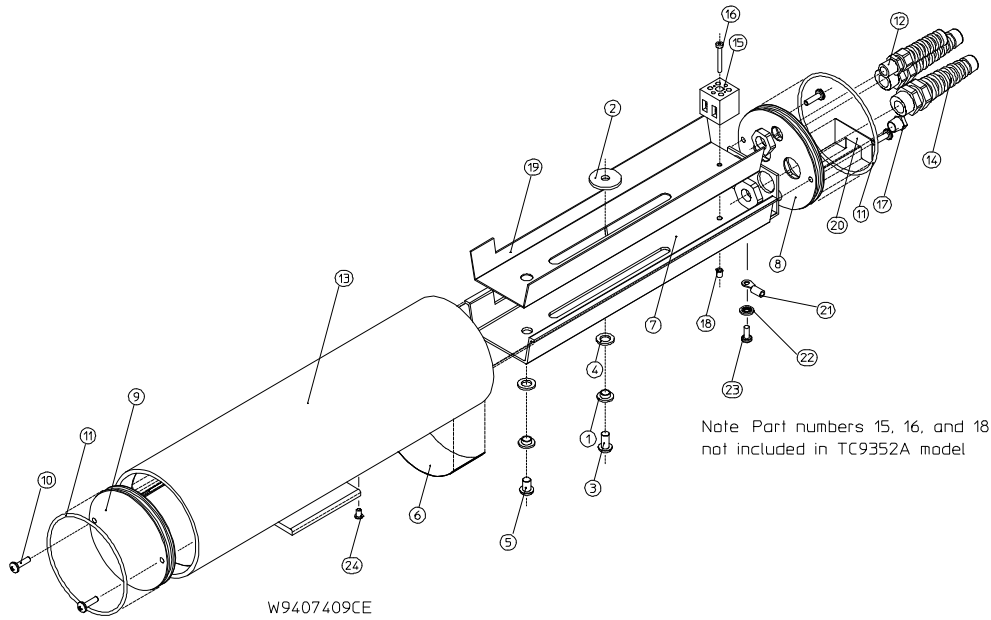

Figure 10: Exploded View



<b>Hardware Kit - 315 1715 001</b>			
<b>No.</b>	<b>Quan.</b>	<b>Part Number</b>	<b>Description</b>
-	2	-	Cable Tie
1	2	-	Nylon Bushing
2	1	-	2.5 mm (0.100-inch) Plastic Washer
2	1	-	9.8 mm (0.385 inch) Plastic Washer
3	1	-	1/4-20 x 1/2-inch Screw
3	1	-	1/4-20 x 7/8-inch BHCS
4	2	-	5/16-inch Flat Washer
5	1	-	1/4-20 x 3/8-inch Screw
<b>Replacement Part Kits</b>			
<b>No.</b>	<b>Quan.</b>	<b>Part Number</b>	<b>Description</b>
<b>11-inch Cradle Assembly Kit - 315 2790 001</b>			
7	1	-	11-inch Cradle Assembly
15 <sup>1</sup>	1	-	Terminal Block
16 <sup>1</sup>	1	-	M2.5 x 12 Screw
18 <sup>1</sup>	1	-	M2.5 PEM Nut
19	1	-	11-inch Plastic Shield
21	1	-	#8 Ring Tongue Terminal
22	1	-	#8 Lock Washer
23	1	-	M4 x 8 Screw
<b>13-inch Cradle Assembly Kit - 315 2791 001</b>			
7	1	-	13-inch Cradle Assembly Kit
15 <sup>1</sup>	1	-	Terminal Block
16 <sup>1</sup>	1	-	M2.5 x 12 Screw
18 <sup>1</sup>	1	-	M2.5 PEM Nut
19	1	-	13-inch Plastic Shield
21	1	-	#8 Ring Tongue Terminal
22	1	-	#8 Lock Washer
23	1	-	M4 x 8 Screw
<b>17-inch Cradle Assembly Kit - 315 2792 001</b>			
7	1	-	17-inch Cradle Assembly
15 <sup>1</sup>	1	-	Terminal Block
16 <sup>1</sup>	1	-	M2.5 x 12 Screw
18 <sup>1</sup>	1	-	M2.5 PEM Nut
19	1	-	17-inch Plastic Sunshield
21	1	-	#8 Ring Tongue Terminal
22	1	-	#8 Lock Washer
23	1	-	M4 x 8 Screw
<b>End Cap Kit - 315 2793 001</b>			
8	1	-	End Cap
10	2	-	#8-32 x 5/8 Screw
11	1	315 1740-900	O-Ring
12	1	315 1741 900	Small Flex Fitting
14	2	315 1743 900	Large Flex Fitting
17	1	-	Breather Vent
20	1	-	Caution Label
<b>Faceplate Kit - 315 2794 001</b>			
9	1	-	Faceplate
10	2	-	#8-32 x 5/8 Screws
11	1	315 1740-900	O-Ring
<b>11-inch Housing Kit - 315 2795 001</b>			
6	1	-	ID Label
13	1	-	11-inch Housing
24	1	-	#6-32 x 1/4-inch Brass Screw
<b>13-inch Housing Kit - 315 2796 001</b>			
6	1	-	ID Label
13	1	-	13-inch Housing
24	1	-	#6-32 x 1/4-inch Brass Screw
<b>17-inch Housing Kit - 315 2797 001</b>			
6	1	-	ID Label
13	1	-	17-inch Housing
24	1	-	#6-32 x 1/4-inch Brass Screw

1. Terminal block not included on LTC 9352/01 Models.