

# Roger Clip-On Mic

User guide



roger



**PHONAK**  
life is on

---

# Contents

<b>1. Welcome</b>	<b>4</b>
<b>2. Getting to know your Roger Clip-On Mic</b>	<b>6</b>
2.1 Check the package content	6
2.2 How the Roger Clip-On Mic works	7
2.3 Descriptions of the devices	8
2.4 Indicator lights (LED status)	9
<b>3. Getting started</b>	<b>10</b>
3.1 Setting up the docking station	10
3.2 Charging your Roger Clip-On Mic	15
3.3 Switching on and off	18
3.4 Using your Roger receiver	19
3.5 Connecting a receiver	20
<b>4. Using Roger Clip-On Mic</b>	<b>22</b>
4.1 Wearing Roger Clip-On Mic	22
4.2 Using the lanyard	24
4.3 Connecting to multimedia devices	27

---

<b>5. Special functions</b>	<b>30</b>
5.1 Mute	30
5.2 Disconnecting Roger devices (NewNet)s	31
5.3 Verification mods	31
<b>6. Adding additional microphones</b>	<b>33</b>
6.1 Connect	33
6.2 Using additional microphones	37
<b>7. Troubleshooting</b>	<b>40</b>
<b>8. Important information</b>	<b>44</b>
<b>9. Service and warranty</b>	<b>50</b>
<b>10. Information and explanation of symbols</b>	<b>52</b>

---

# 1. Welcome

Congratulations on choosing the Roger Clip-On Mic from Phonak. This compact microphone uses adaptive wireless transmission to help people with a hearing loss understand more speech in noise and over distance. It is ideal for use by a partner or friend, plus it includes an audio input for listening to multimedia and TV connectivity. It can also be used alongside other Roger Clip-On Mics and Roger Pens in a microphone network.

Your Roger Clip-On Mic is a Swiss premium-quality product developed by Phonak, the world's leading hearing healthcare company.

---

Please read this User Guide thoroughly to benefit from all the possibilities your Roger Clip-On Mic offers.

If you have any questions, please consult your hearing care professional or local Phonak support center.

Phonak – life is on

[www.phonak.com](http://www.phonak.com)



---

## 2. Getting to know your Roger Clip-On Mic

### 2.1 Check the package content

Roger Clip-On Mic



Docking station



Lanyard



Storage pouch



Power supply with country adapter and charging cable



Star sticker



Audio cable for docking station



micro-USB audio cable (suitable for travelling)



RCA/Cinch adapter for TV or HiFi



Quick Setup Guide



---

## 2.2 How the Roger Clip-On Mic works

Roger Clip-On Mic transmits the speaker's voice directly into your ears. The system consists of three main elements: your hearing aids, Roger receivers and your Roger Clip-On Mic.

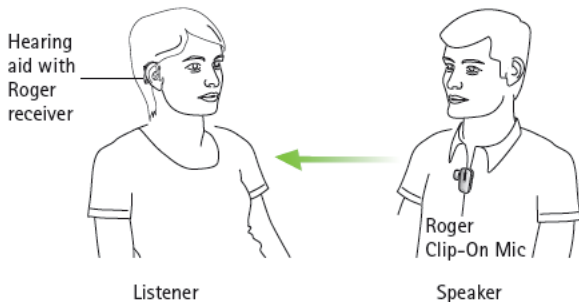

---

## 2. Getting to know your Roger Clip-On Mic

### 2.3 Descriptions of the devices

#### Roger Clip-On Mic



- ① Indicator light (LED)
- ② Microphones
- ③ Charging and audio input (micro-USB)
- ④ Connect button
- ⑤ On/ Off/ Mute

#### Dockingstation

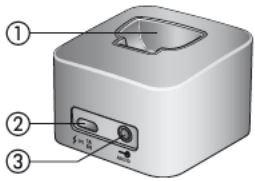

- ① Slot for Roger Clip-On Mic
- ② Charger input (micro-USB)
- ③ Audio input (3.5 mm / 1/8 inch jack)



---

## 2.4 Indicator lights (LED status)

*Indicatorlight*    *Meaning*

---



Switching on



Switching off



Audio input detected



Microphone / audio input muted



Charging



Fully charged



Low battery – charge your  
Roger Clip-On Mic

---

---

## 3. Getting started

### 3.1 Setting up the docking station

The Roger Clip-On Mic docking station is used to both recharge the microphone and transmit audio from a TV or other audio device to the Roger Clip-On Mic (and into your hearing aids).

#### Setting up the power supply

1. Select the power adapter that corresponds to your country.



US



EU



UK



AUS

2. Insert the round corner of the adapter in the round corner of the universal power supply.

3. Click the tail of the adapter in to lock it into place. Make sure the adapter is securely locked.

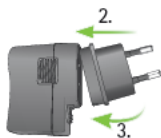

## Remove/Change:

- a. Pull back the tab on the universal power supply.
- b. Gently pull the adapter upwards to remove it.
- c. Start over with step 1 (above).

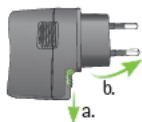

## Connecting the power supply to the docking station

1. Place the docking station next to your TV/audio device and connect the smaller end of the charging cable to the power input of the docking station ⚡  $\approx \frac{1A}{5V}$ .
2. Plug the larger end of the charging cable into the universal power supply Type GPE053B  
5V  $\approx$  1A .
3. Plug the power supply into an easily accessible power socket.

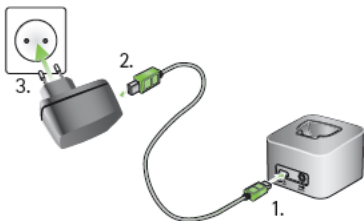

---

### 3. Getting started

#### Connecting the docking station to an a TV/audio device

1. Plug the audio cable into the audio input of the docking station: 
2. Connect the other end of the audio cable to the headphone output of your TV/audio device.

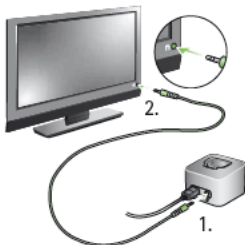

Alternatively, connect the other end of the audio cable to your TV's Cinch/RCA adapter. Connect the red and white plugs to the matching red and white output sockets on your TV.



---

You can also connect via a SCART adaptor, which can be bought from an electronics store or from your Phonak dealer. Connect the other end of the audio cable to the SCART adaptor. Then plug the SCART adaptor into a free SCART output socket on your TV.



If your TV does not include an analog audio output, you need a digital to analog converter. Such converters can be found in electronics stores or may be purchased from your Phonak dealer.

---

### 3. Getting started

- ① When the docking station is plugged into the headset socket of your TV, you can adjust the volume via your TV's remote control.
- ① Some TVs will switch off their loudspeakers when you plug the jack into the headset socket – meaning the TV will not be audible for other people. In such a case use the Cinch / RCA or SCART output socket as described above.
- ① The Roger Clip-On Mic docking station can also be connected to any other audio device such as an MP3 player, PC or HiFi system using the audio cable.

---

### 3.2 Charging your Roger Clip-On Mic

Roger Clip-On Mic contains a built-in lithium polymer battery with fast-charge capability.

To charge your Roger Clip-On Mic, slot it into the docking station. The indicator light turns orange to indicate it is charging. An empty battery will reach its maximum charge in approximately 2 hours. Charging is complete when the indicator light turns solid green.

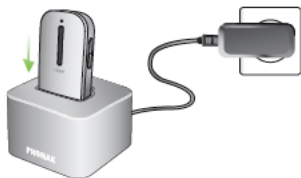

- ① When charging your Roger Clip-On Mic for the first time, let it charge for at least two hours even if the battery indicator light is not lit or turns green earlier.

---

### 3. Getting started

Alternatively, you can also charge your Roger Clip-On Mic without the docking station. This may be useful when travelling.

Using the micro-USB cable:

1. Plug the smaller end (micro-USB) of the charging cable into your Roger Clip-On Mic.
2. Plug the larger end (USB) of the charging cable into the power supply.
3. Plug the power supply into the wall socket.

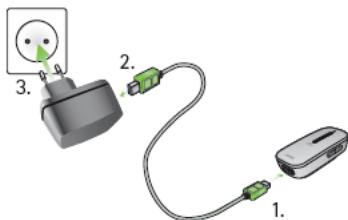



- 
- ① You can also charge your Roger Clip-On Mic by using the charging cable to connect your Roger Clip-On Mic to one of your computer's USB ports.
  - ① If you connect the charging cable to your computer's USB port and the docking station at the same time, your Roger Clip-On Mic will not charge.

### Indicator light (battery status)

<i>Indicatorlight</i>	<i>Meaning</i>
-----------------------	----------------



Charging



Fully charged



Low battery, charge your Roger Clip-On Mic. In addition, you will hear beeps in your hearing aids.

---

## 3. Getting started

### 3.3 Switching on and off

To switch your Roger Clip-On Mic on, press the on/off  button for two seconds until the indicator light turns white.

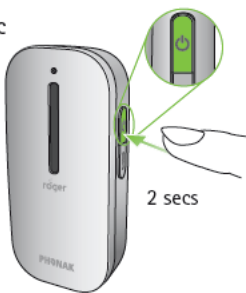

---

### 3.4 Using your Roger receiver

#### Using Roger MyLink

If your Roger receiver is a Roger MyLink, switch your Roger MyLink on and hang it around your neck. Make sure your hearing aids are set to T/MT/T-coil mode.



The Roger MyLink User Guide provides more detailed information on using Roger MyLink.

#### Using Roger receivers attached to your hearing aids

If you have Roger receivers that attach directly to your hearing aids, make sure these are properly attached and your hearing aid is set to its Roger/FM/DAI/EXT program.



---

### 3. Getting started

#### 3.5 Connecting a receiver

Your hearing care professional may already have connected your Roger Clip-On Mic with your hearing aids.

If this is not the case, connect your receiver to your Roger Clip-On Mic as follow:

1. Make sure Roger Clip-On Mic and the Roger receiver are both powered on.
2. Hold Roger Clip-On Mic within 10 cm / 4 inches of the Roger receiver.
3. Press the Connect  button on your Roger Clip-On Mic.

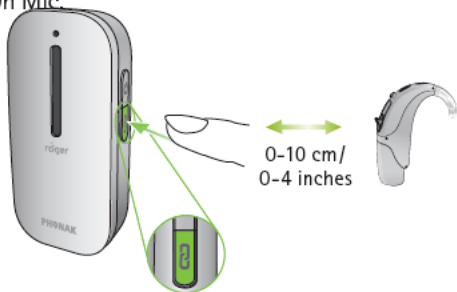

- 
- The indicator light will turn green for two seconds to confirm a successful connection.
  - Repeat steps 2 & 3 to connect a second receiver.
- i** Depending on the receiver type, you may connect a maximum of two Roger ear-level receivers OR one Roger MyLink to your Roger Clip-On Mic.

#### Indicator light (connection status)

After pressing the Connect button, the following feedback may be given by the indicator light:

<i>Indicatorlight</i>	<i>Meaning</i>
-----------------------	----------------



Connection was successful – your Roger receiver is connected to your Roger Clip-On Mic.



Roger Clip-On Mic could not find a Roger receiver. Move Roger Clip-On Mic closer to your Roger receiver and make sure the Roger receiver is powered. Then try to connect again.



The Roger receiver is not compatible with your Roger Clip-On Mic.

---

## 4. Using Roger Clip-On Mic

### 4.1 Wearing Roger Clip-On Mic

The easiest way to attach Roger Clip-On Mic to the person speaking is by using its clip. There are different ways of clipping Roger Clip-On Mic to the speaker's clothes:



Clipped on the collar  
(clip downwards)

or



Clipped on clothing  
(clip upwards)

or



Clipped between buttons  
(clip sideways)

- 
- ① Make sure Roger Clip-On Mic points towards the speaker's mouth.
  - ① The distance between Roger Clip-On Mic and the speaker's mouth should not be greater than 20 cm/8 inches.



max. 20 cm /  
8 inch



Too far away



Not pointing towards  
the mouth

---

## 4. Using Roger Clip-On Mic

### 4.2 Using the lanyard (neckloop)

If it's not possible to clip Roger Clip-On Mic to the speaker's clothing, you can alternatively use the lanyard to hang Roger Clip-On Mic around their neck.

#### Attaching the lanyard

1. Press the Roger Clip-On Mic clip and slide the plastic part of the lanyard over it.



2. Close the clip and make sure it is fully closed.

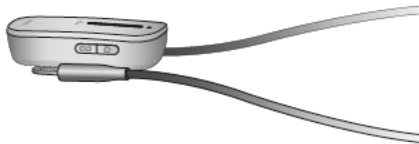



---

To remove the lanyard, open the clip and pull the lanyard out.

1.

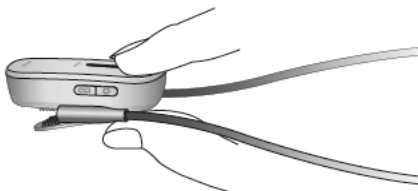

2.



---

#### 4. Using Roger Clip-On Mic

##### Hanging it around the neck

1. Open the lanyard by pulling the magnets apart.



2. Hang the Roger Clip-On Mic around the neck of the speaker and close the lanyard.

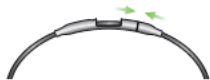

3. Adjust the length of the lanyard to bring Roger Clip-On Mic closer to the mouth. Secure the wire by pulling the cable into the gap.



4. The distance between Roger Clip-On Mic and the mouth should not be more than 20 cm / 8 inches.



---

## 4.3 Connecting to multimedia devices

You can connect your Roger Clip-On Mic to an audio source – such as your TV, tablet or HiFi – to hear it's audio signal directly in your hearing aids.

### Via docking station

Make sure the docking station is powered properly connected to your audio source as described in 'Getting started' (page XX). Slot your Roger Clip-On Mic into the docking station. After turning on your audio source, Roger Clip-On Mic will automatically detect the presence of an audio signal and starts transmitting it.



- ① If the docking station is not powered, Roger Clip-On Mic can still detect and transmit an external audio signal. Simply switch Roger Clip-On Mic on.
- ① When Roger Clip-On Mic transmits an audio signal its microphone is muted.

---

## 4. Using Roger Clip-On Mic

### Via micro-USB audio cable

Alternatively, you can use the short micro-USB audio cable to connect your multimedia device directly to your Roger Clip-On Mic.

1. Plug the round end of the micro-USB audio cable into the headphone output of your multimedia device.

2. Plug the rectangular end (micro-USB) of the micro-USB cable into the socket of your Roger Clip-On Mic.

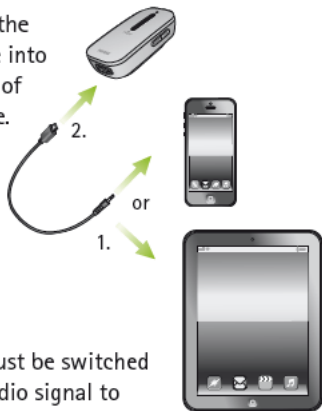

- i** Roger Clip-On Mic must be switched on to transmit the audio signal to your hearing aids. After you have activated your multimedia device's audio signal, Roger Clip-On Mic will detect this signal and will automatically mute its own microphone.



---

## 5. Special functions

### 5.1 Mute

Firmly press the on/off  button to mute Roger Clip-On Mic's microphone or audio input.

When muted, the indicator light will turn solid violet. Press the on/off button again to re-activate the microphones or audio input.



---

## 5.2 Disconnecting Roger devices (NewNet)

To disconnect your Roger Clip-On Mic from any connected receivers or other Roger microphones, hold the Connect  button for 7 seconds. The indicator light will turn orange when Roger Clip-On Mic has been disconnected from all connected devices.

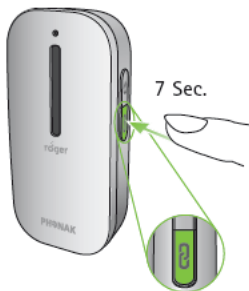

You can now re-start to connect Roger receivers or Roger microphones with your Roger Clip-On Mic.

## 5.3 Verification mode

The Verification mode is used by hearing care professionals to verify a device according to the Roger POP (Roger Phonak Offset Protocol).

To activate verification mode, press the Connect  button 5 times in a row.

---

## 5. Special functions

### Status light (Verification mode)

<i>Indicatorlight</i>	<i>Meaning</i>
-----------------------	----------------





Verification mode activated
-----------------------------

---

- ① Verification mode can only be activated during 60 seconds after Roger Clip-On Mic is switched on.
- ① When Roger Cli-On Mic is switched off, Verification mode is automatically deactivated.

### Reset

If your Roger Clip-On Mic stops responding, reset the device by pressing the on/off  and Connect  buttons simultaneously for 7 seconds.



---

## 6. Adding additional microphones

Roger technology allows you to use multiple microphones in parallel by connecting additional Roger Clip-On Mics and Roger Pens.

### 6.1 Connect

To connect another microphone to your Roger Clip-On Mic, follow these steps:

1. Turn on both microphones.
2. Decide which Roger Clip-On Mic will be your primary device. Mark this device by placing the star-sticker on the back.



---

## 6. Adding additional microphones

3. Hold the two microphones close together (within 10 cm/4 inches).
4. Press the Connect  button of the microphone with the star-sticker.

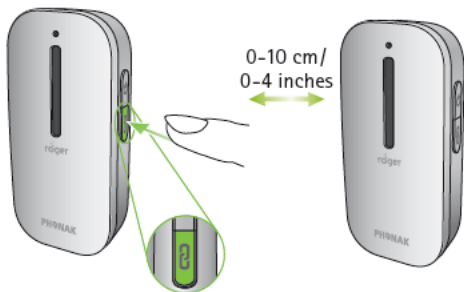

5. The indicator lights of both microphones will turn green for two seconds to confirm a successful connection.



- 
- ① Once you have connected another microphone to your primary microphone, it can only be used together with the primary. The other microphone will blink red if it does not find your primary Roger Clip-On Mic. If you want to disconnect it from your primary Roger Clip-On Mic, use the NewNet function (see chapter 'Special Functions').
  - ① If you want to connect your Roger Clip-On Mic with a Roger Pen, it is recommended to press the Connect button of the Roger Pen, making that the primary microphone.
  - ① It is possible to connect up to 10 Roger microphones to your Roger Clip-On Mic.

---

## 6. Adding additional microphones

### Indicator light (Connection status)

After pressing the Connect button, the following feedback may be given by the indicator light:

<i>Indicatorlight</i>	<i>Meaning</i>
	Connection was successful – the other Roger microphone is now connected to your Roger Clip-On Mic
	Roger Clip-On Mic could not find another Roger microphone. Move Roger Clip-On Mic closer to the other Roger microphone and make sure both microphones are switched on. Then try Connect again.
	The other Roger microphone is not compatible with your Roger Clip-On Mic.

---

## 6.2 Using additional microphones

Hand over the Roger microphones to your speakers. Make sure they are worn properly.

Roger Clip-On Mics automatically detect when your friend or partner talks, before instantly transmitting his/her voice to your hearing aids.

If a speaker wants to temporarily leave the group, they should mute their microphone by firmly pressing the on/off  button.

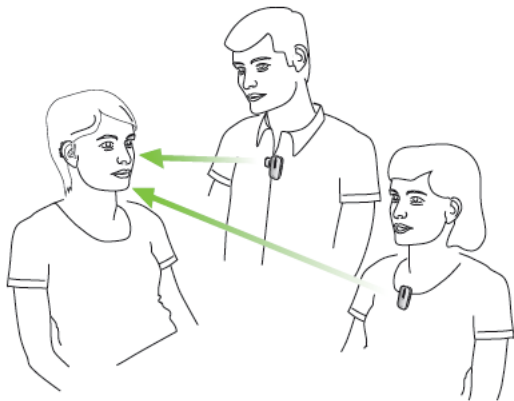

---

## 6. Adding additional microphones

- ① Only one speaker can be heard at a time. When two people speak at the same time, the person who talked first will be heard. When they stop talking, the other speaker will be heard.
- ① The speaker with the primary microphone (the one with the ★-sticker on the back) should never move more than 10 m / 30 feet away from the group as this may disable the other Roger microphones.
- ① If the primary Roger Clip-On Mic is turned off or moves out of range, the secondary Roger microphones will start blinking red and will stop transmitting.

---

## Indicator light (multiple microphone status)

When using multiple Roger microphones, the following feedback may be given by the indicator light:

<i>Indicatorlight</i>	<i>Meaning</i>
-----------------------	----------------



	Your Roger microphone is muted. Unmute it by pressing the on/off  button.
--	--



	Your Roger microphone cannot detect the primary Roger microphone. Switch on the primary Roger microphone and make sure it is within range of your Roger microphone.
--	---

---

## 7. Troubleshooting

*Most probable cause(s)*

*Solution(s)*

### I cannot switch Roger Clip-On Mic on

- The battery is empty

- Charge Roger Clip-On Mic for at least two hours

### Poor speech intelligibility

- The microphone is not positioned correctly

- Move Roger Clip-On Mic closer to the speaker's mouth
- Make sure Roger Clip-On Mic is pointing towards the speaker's mouth

- The microphone openings are covered by fingers or clothing

- Make sure the microphone openings are not covered by fingers, clothing or dirt

### I cannot understand the speaker

- The microphone has been muted

- Check the indicator light – if it is violet, briefly press the on/off button to activate the microphones

- Your hearing aids are not set to the correct program

- Check that your hearing aids are set to the correct program (Roger/FM/DAI/EXT)

- Your Roger receivers are not connected to Roger Clip-On Mic

- Hold Roger Clip-On Mic close to each Roger receiver in turn and briefly press the Connect button



<i>Most probable cause(s)</i>	<i>Solution(s)</i>
<ul style="list-style-type: none"> <li>■ In case of multiple microphones, the primary microphone may not be switched on or may be out of range</li> </ul>	<ul style="list-style-type: none"> <li>■ Check the indicator light – if it is blinking red, switch on the primary microphone and check that it is within range</li> </ul>
<b>I keep losing the audio signal</b>	
<ul style="list-style-type: none"> <li>■ Distance between Roger Clip-On Mic and Roger receiver is too large</li> <li>■ There are obstacles between you and Roger Clip-On Mic</li> </ul>	<ul style="list-style-type: none"> <li>■ Move closer to the Roger Clip-On Mic</li> <li>■ Make sure you can see the Roger Clip-On Mic (line of sight)</li> </ul>
<b>The volume from my multimedia device is too low</b>	
<ul style="list-style-type: none"> <li>■ Incorrect volume settings</li> </ul>	<ul style="list-style-type: none"> <li>■ Increase the volume of your audio source</li> </ul>
<b>I cannot hear my multimedia device</b>	
<ul style="list-style-type: none"> <li>■ The audio source is muted</li> <li>■ Roger Clip-On Mic is using micro-USB audio cable but is not switched on</li> </ul>	<ul style="list-style-type: none"> <li>■ Unmute the audio source</li> <li>■ Switch on Roger Clip-On Mic to listen to the audio source via the micro-USB audio cable</li> </ul>

---

## 7. Troubleshooting

*Most probable cause(s)*

*Solution(s)*

### **Roger Clip-On Mic's light is blinking red (single flash)**

■ Your Roger Clip-On Mic has been connected to another microphone which is no longer available

■ Create a NewNet (press the Connect button for 7 seconds) to make Roger Clip-On Mic a standalone transmitter again

### **The Roger Clip-On Mic's light is blinking red (double flash)**

■ It's battery charge is low

■ Charge Roger Clip-On Mic as soon as possible

### **My Roger Clip-On Mic is not responding**

■ Software issue

■ Reboot Roger Clip-On Mic by simultaneously pressing its two buttons



---

## 8. Important information

### 8.1 Important Safety Information

 Please read the information on the following pages before using your Phonak device.

 This symbol on the product or its packaging means that it should not be disposed of with your other household waste. It is your responsibility to dispose of your waste equipment separately from the municipal waste stream. The correct disposal of your old appliance will help prevent potential negative consequences for the environment and human health.

---

## 8.2 Hazard warnings

- ⚠ Keep this device out of reach of children aged under 3 years.
- ⚠ Opening the device might damage it. If problems occur that cannot be resolved by following the guidelines in the Troubleshooting section of this User Guide, consult your hearing care professional.
- ⚠ Your device should only be repaired by an authorized service center. Changes or modifications to this device that were not explicitly approved by Phonak are not permitted.
- ⚠ Please dispose of electrical components in accordance with your local regulations.
- ⚠ Do not use your device in areas where electronic equipment is prohibited. If in doubt, please ask the person in charge.
- ⚠ Device should not be used on aircrafts unless specifically permitted by flight personnel.

---

## 8. Important information

- ⚠ External devices should only be connected if they have been tested in accordance with corresponding IECXXXXX standards.
- ⚠ Only use accessories that are approved by Phonak AG.
- ⚠ Using your device's cables in any way contradictory to their intended purpose (e.g., wearing the USB cable around the neck) can cause injury.
- ⚠ When operating machinery, ensure that no parts of your device can get caught in the machine.
- ⚠ Do not charge device while it is on your body.
- ⚠ Caution: electric shock. Do not insert plug alone into electrical outlets.

---

## 8.3 Product safety information

- ① Protect the device from excessive shock and vibration.
- ① Do not expose your device to temperatures and humidity outside of the recommended conditions stated in this User Guide.
- ① Never use a microwave or other heating devices to dry the device.
- ① Clean the device using a damp cloth. Never use household cleaning products (washing powder, soap, etc.) or alcohol to clean the device.
- ① Only recharge your device using chargers supplied by Phonak or by stabilized chargers providing 5VDC and  $\geq 500$  mA.
- ① Do not connect an USB or audio cable to your device that exceeds 3 meters (9ft) in length.
- ① When the device is not in use, turn it OFF and store it safely.

---

## 8. Important information

- ① Protect the device from excessive moisture (bathing, swimming), heat (radiator, car dashboard), and direct contact with skin when sweating (workout, fitness, sport).
- ① X-ray radiation, CT or MRI scans may destroy or adversely affect the correct functioning of the device.
- ① Do not use excessive force when connecting your device to its different cables.
- ① Protect all openings (microphones, audio input and charger) from dirt and debris.
- ① If the device has been dropped or damaged, if it overheats during charging, has a damaged cord or plug, or has been dropped into liquid, stop using your device and contact your hearing care professional.
- ① The device has a built-in rechargeable battery. This battery can be charged and discharged hundreds of times but may eventually wear out. The battery may then only be replaced by authorized personnel.



---

## 8.4 Other important information

- Persons with pacemakers or other medical devices should ALWAYS consult their physician or the manufacturer of their device BEFORE using the device. The use of the device with a pacemaker or other medical devices should ALWAYS be in accordance with the safety recommendations of the physician responsible for your pacemaker or the pacemaker manufacturer.
- Device collects and stores internal technical data. This data may be read by a hearing care professional in order to check the device, as well as to help you use your device correctly.
- The digital signal sent from the device to a connected receiver cannot be overheard by other devices which are not in the microphone's network.

---

## 9. Service and warranty

### 9.1 Local warranty

Please ask the hearing care professional, where you purchased your device, about the terms of the local warranty.

### 9.2 International warranty

Phonak offers a one year limited international warranty, valid as of the date of purchase. This limited warranty covers manufacturing and material defects. The warranty is valid only if proof of purchase is shown.

---

### 9.3 Warranty limitation

This warranty does not cover damage from improper handling or care, exposure to chemicals, immersion in water or undue stress. Damage caused by third parties or non-authorized service centers renders the warranty null and void. This warranty does not cover any services performed by a hearing care professional in his/her office.

Serial number:

\_\_\_\_\_

Authorized hearing  
care professional  
(stamp/signature):

Date of purchase:

\_\_\_\_\_

\_\_\_\_\_

---

## 10. Information and explanation of symbols



The CE symbol is confirmation by Phonak Communications AG that this Phonak product is in compliance with the essential requirements and other relevant provisions of Directive 1999/5/EC.

---



This symbol indicates that it is important for the user to read and take into account the relevant information in these user guides.

---



This symbol indicates that it is important for the user to pay attention to the relevant warning notices in these user guides.

---



Important information for handling and product safety.

---

**Operating conditions**

This device is designed such that it functions without problems or restrictions if used as intended, unless otherwise noted in these user guides. 0° to +40° Celsius (+32° to +104° Fahrenheit) and relative humidity of <95% (non condensing).



Australian EMC and Radiocommunications compliance label.



Temperature: -20° to +60° Celsius (-4° to +140° Fahrenheit).



Humidity transportation: Up to 90% (non condensing).  
Humidity storage: 0% to 70%, if not in use.



Atmospheric pressure: 500 hPA to 1100 hPA

---

## 10. Information and explanation of symbols



The symbol with the crossed-out garbage bin is to make you aware that this device may not be thrown away as normal household waste. Please dispose of old or unused device, at waste disposal sites intended for electronic waste, or give your device to your hearing care professional for disposal. Proper disposal protects the environment and health.

This product has an embedded, non-replaceable battery. Do not attempt to open the product or remove the battery as this may cause injury and damage the product.

Please contact the local recycling facility for removal of the battery.

**Manufacturer:**

Phonak Communications AG  
Laenggasse 17  
CH-3280 Murten  
Switzerland

**EU Representative:**

Phonak GmbH  
D-70736 Fellbach-Oeffingen  
Germany

[www.phonak.com/phonak-roger](http://www.phonak.com/phonak-roger)



# Important Safety Information Declaration of Conformity Service and Warranty

# Informations de sécurité importantes Déclaration de conformité Service et garantie

## Devices, appareils:

Roger Pen

Roger Clip-On Mic

The information contained herein is subject to change without notice.

Les informations ci-dessous peuvent faire l'objet de modifications sans notification préalable.



[www.phonak.com](http://www.phonak.com)

**PHONAK**  
life is on



## 1 Important Safety Information











Please read the information on the following pages before using your Phonak device.



This symbol on the product or its packaging means that it should not be disposed of with your other household waste. It is your responsibility to dispose of your waste equipment separately from the municipal waste stream. The correct disposal of your old appliance will help prevent potential negative consequences for the environment and human health.

### 1.1 Hazard warnings

-  Keep this device out of reach of children aged under 3 years.
-  Opening the device might damage it. If problems occur that cannot be resolved by following the guidelines in the Troubleshooting section of this User Guide, consult your hearing care professional.
-  Your device should only be repaired by an authorized service center. Changes or modifications to this device that were not explicitly approved by Phonak are not permitted.
-  Please dispose of electrical components in accordance with your local regulations.
-  Do not use your device in areas where electronic equipment is prohibited. If in doubt, please ask the person in charge.
-  Device should not be used on aircrafts unless specifically permitted by flight personnel.
-  External devices should only be connected if they have been tested in accordance with corresponding IECXXXXX standards.
-  Only use accessories that are approved by Phonak AG.

- ⚠ Using your device's cables in any way contradictory to their intended purpose (e. g., wearing the USB cable around the neck) can cause injury.
- ⚠ When operating machinery, ensure that no parts of your device can get caught in the machine.
- ⚠ Do not charge device while it is on your body.
- ⚠ Caution: electric shock. Do not insert plug alone into electrical outlets.

## 1.2 Product safety information

- ⓘ Protect the device from excessive shock and vibration.
- ⓘ Do not expose your device to temperatures and humidity outside of the recommended conditions stated in this User Guide.
- ⓘ Never use a microwave or other heating devices to dry the device.
- ⓘ Clean the device using a damp cloth. Never use household cleaning products (washing powder, soap, etc.) or alcohol to clean the device.
- ⓘ Only recharge your device using chargers supplied by Phonak or by stabilized chargers providing 5VDC and  $\geq 500$  mA.
- ⓘ Do not connect an USB or audio cable to your device that exceeds 3 meters (9ft) in length.
- ⓘ When the device is not in use, turn it OFF and store it safely.
- ⓘ Protect the device from excessive moisture (bathing, swimming), heat (radiator, car dashboard), and direct contact with skin when sweating (workout, fitness, sport).
- ⓘ X-ray radiation, CT or MRI scans may destroy or adversely affect the correct functioning of the device.
- ⓘ Do not use excessive force when connecting your device to its different cables.
- ⓘ Protect all openings (microphones, audio input and charger) from dirt and debris.

- ① If the device has been dropped or damaged, if it overheats during charging, has a damaged cord or plug, or has been dropped into liquid, stop using your device and contact your hearing care professional.
- ① The device has a built-in rechargeable battery. This battery can be charged and discharged hundreds of times but may eventually wear out. The battery may then only be replaced by authorized personnel.

### **1.3 Other important information**

- Persons with pacemakers or other medical devices should ALWAYS consult their physician or the manufacturer of their device BEFORE using the device. The use of the device with a pacemaker or other medical devices should ALWAYS be in accordance with the safety recommendations of the physician responsible for your pacemaker or the pacemaker manufacturer.
- Device collects and stores internal technical data. This data may be read by a hearing care professional in order to check the device, as well as to help you use your device correctly.
- The digital signal sent from the device to a connected receiver cannot be overheard by other devices which are not in the microphone's network.

## **2 Declaration of Conformity**

In body worn operation, the devices have been found in compliance with the requirements of EN 62209-2, FCC rule paragraph 2.1093, the ANSI/IEEE C95.1:1999, the NCRP Report Number 86 for uncontrolled environment, according to the Health Canada's Safety Code 6 and the Industry Canada Radio Standards Specification RSS-102 for General Population/Uncontrolled exposure.

Hereby, Phonak Communications AG, Länggasse 17, CH-3280 Murten, declares that these Phonak products are in compliance with the essential requirements and other relevant provisions of Directive 1999/5/EC. To obtain a copy of the Declaration of conformity, please contact the manufacturer or the local Phonak representative whose address can be taken from the list on [www.phonak.com](http://www.phonak.com) (worldwide locations).

This device complies with Part 15 of the FCC Rules and with RSS210 of Industry Canada. Operation is subject to the following two conditions: (1) This device may not cause harmful interference, and (2) this device must accept any interference received, including interference that may cause undesired operation. The device has been tested and found to comply with the limits for a Class B digital device, pursuant to Part 15 of the FCC Rules. These limits are designed to provide reasonable protection against harmful interference in a residential installation. The device generates uses and can radiate radio frequency energy and, if not installed and used in accordance with the instructions, may cause harmful interference to radio communications. However, there is no guarantee that interference will not occur in a particular installation. If the device does cause harmful interference to radio or television reception, which can be determined by turning the device off and on, the user is encouraged to try to correct the interference by one of the following measures:

- Reorient or relocate the receiving antenna.
- Increase the separation between the device and receiver.
- Connect the device into an outlet on a circuit different from that to which the receiver is connected.
- Consult the dealer or an experienced radio/TV technician for help.

**FCC Caution: Any changes or modifications not expressly approved by the party responsible for compliance could void the user's authority to operate the device.**

### 3 Service and Warranty

#### Local warranty

Please ask the hearing care professional, where you purchased your device, about the terms of the local warranty.

#### International warranty

Phonak offers a one year limited international warranty, valid as of the date of purchase. This limited warranty covers manufacturing and material defects. The warranty is valid only if proof of purchase is shown.

#### Warranty limitation

This warranty does not cover damage from improper handling or care, exposure to chemicals, immersion in water or undue stress. Damage caused by third parties or non-authorized service centers renders the warranty null and void. This warranty does not cover any services performed by a hearing care professional in his/her office.

Serial number:

---

Purchase date:

---

Authorized hearing  
care professional  
(stamp/signature):

---

# Français

---

## 1 Information de sécurité importante



Veuillez lire les informations sur les pages suivantes avant d'utiliser votre appareil Phonak.



Le symbole apposé sur le présent produit ou son emballage signifie qu'il ne doit pas être jeté avec les autres ordures ménagères. Il vous incombe de jeter votre ancien matériel séparément c'est-à-dire hors système de collecte des ordures ménagères municipal. En éliminant votre ancien matériel en bonne et due forme, vous préviendrez tout risque d'impact néfaste sur l'environnement et la santé publique.

### 1.1 Avertissements de danger

- ⚠ Maintenez cet appareil hors de portée des enfants de moins de 3 ans.
- ⚠ Ouvrir l'appareil peut l'endommager. Si des problèmes surviennent et ne peuvent pas être résolus en suivant les directives de la section Dépannage de ce Mode d'emploi (le cas échéant), consultez votre audioprothésiste.
- ⚠ Votre appareil doit uniquement être réparé par un centre de service autorisé. Les changements ou modifications de cet appareil qui n'ont pas été approuvés explicitement par Phonak ne sont pas autorisés.
- ⚠ Éliminez les composants électriques selon les dispositions locales en vigueur.
- ⚠ N'utilisez pas votre appareil dans les zones où les équipements électroniques sont interdits. En cas de doute, veuillez consulter la personne responsable.
- ⚠ L'appareil ne doit pas être utilisé dans les avions, sauf si le personnel de vol l'autorise spécifiquement.
- ⚠ Les appareils externes ne doivent être connectés que s'ils ont été testés conformes aux normes CEIXXXX correspondantes.
- ⚠ N'utilisez que des accessoires approuvés par Phonak AG.

- ⚠ Utiliser les câbles de votre appareil de manière contraire à leur usage prévu (par ex. porter le câble USB autour du cou) peut provoquer des blessures.
- ⚠ Lors de l'utilisation de machines, assurez-vous qu'aucune partie de votre appareil ne puisse se coincer dans la machine.
- ⚠ Ne chargez pas l'appareil lorsqu'il est sur votre corps.
- ⚠ Avertissement : électrocution. N'insérez pas la fiche seule dans des prises électriques.

## 1.2 Informations sur la sécurité du produit

- ⓘ Protégez l'appareil des chocs et vibrations excessifs.
- ⓘ N'exposez pas votre appareil à des températures et une humidité hors des conditions recommandées dans le présent Mode d'emploi.
- ⓘ N'utilisez jamais de four à micro-ondes ou d'autres appareils de chauffage pour sécher l'appareil.
- ⓘ Nettoyez l'appareil avec un chiffon humide. N'utilisez jamais de produits de nettoyage domestiques (lessive en poudre, savon, etc.) ou d'alcool pour nettoyer l'appareil.
- ⓘ Ne rechargez votre appareil qu'avec les chargeurs fournis par Phonak ou des chargeurs stabilisés fournissant 5 VCC et  $\geq 500$  mA.
- ⓘ Ne connectez pas de câble USB ou audio de plus de 3 mètres de long à votre appareil.
- ⓘ Quand l'appareil n'est pas utilisé, éteignez-le et conservez-le en lieu sûr.
- ⓘ Protégez l'appareil contre l'humidité excessive (bain, natation), la chaleur (radiateur, tableau de bord de voiture) et le contact direct avec la peau lorsque vous transpirez (muscultation, exercice, sport).
- ⓘ Les radiographies, tomographies ou IRM peuvent détruire ou avoir un impact négatif sur le bon fonctionnement de l'appareil.

- ❶ N'exercez pas de force excessive lors de la connexion de votre appareil à ses différents câbles.
- ❶ Protégez toutes les ouvertures (microphones, entrée audio et chargeur) de la saleté et des impuretés.
- ❶ Si l'appareil est tombé ou a été endommagé, s'il surchauffe pendant le chargement, si son cordon ou sa fiche est endommagé ou s'il est tombé dans un liquide, arrêtez de l'utiliser et contactez votre audioprothésiste.
- ❶ L'appareil a une pile rechargeable intégrée. Celle-ci peut être chargée et déchargée des centaines de fois mais peut finir par s'user. La pile ne peut être remplacée que par un personnel autorisé.

### 1.3 Autres informations importantes

- Les personnes portant un stimulateur cardiaque ou d'autres appareils médicaux doivent TOUJOURS consulter leur médecin ou le fabricant de leur appareil AVANT d'utiliser l'appareil. L'utilisation de l'appareil avec un stimulateur cardiaque ou d'autres appareils médicaux doit TOUJOURS être conforme aux recommandations de sécurité du médecin responsable de votre stimulateur cardiaque ou du fabricant du stimulateur cardiaque.
- L'appareil recueille et stocke les données techniques internes. Ces données peuvent être lues par un audioprothésiste afin de contrôler l'appareil et de vous aider à l'utiliser correctement.
- Le signal numérique envoyé par l'émetteur de l'appareil au récepteur connecté ne peut pas être entendu par d'autres appareils non intégrés au réseau de l'émetteur.

## 2 Déclaration de Conformité

Pour l'utilisation sur le corps, cet appareil a été jugé conforme aux exigences d'EN 62209-2, Réglementation de la FCC paragraphe 2.1093, l'ANSI/IEEE C95.1:1999, le rapport numéro 86 du NCRP pour l'environnement non contrôlé, conformément au code de sécurité 6 de Santé Canada et la norme radio CNR-102 d'Industrie Canada pour l'exposition non contrôlée/de la population en général.



Par la présente, Phonak Communications AG, Länggasse 17, CH-3280 Murten, déclare que le produit Phonak est conforme aux exigences principales et autres dispositions pertinentes de la directive 1999/5/CE. Pour obtenir une copie de la Déclaration de conformité, veuillez contacter le fabricant ou le représentant Phonak local dont l'adresse figure sur la liste du site [www.phonak.com](http://www.phonak.com) (sites à travers le monde).

Cet appareil est conforme aux sections 15 des règlements de la FCC et à CNR-210 d'Industrie Canada. Le fonctionnement aux deux conditions suivantes : (1) Cet appareil ne doit pas provoquer d'interférences gênantes et (2) l'utilisateur de cet appareil doit accepter les interférences reçues, y compris les interférences pouvant provoquer un fonctionnement non désiré. Cet équipement a été testé et jugé en conformité avec les limites afférentes à un appareil numérique de classe B, en vertu de la section 15 des règlements de la FCC. Ces normes sont conçues pour assurer une protection raisonnable contre les interférences nuisibles dans un environnement résidentiel. Cet appareil génère, utilise et peut émettre de l'énergie radioélectrique et, s'il n'est pas installé ou utilisé selon les directives, peut causer des interférences nuisibles aux communications radio. Cependant, il n'existe aucune garantie que des interférences ne se produiront pas dans une installation particulière. Si cet appareil est la source d'interférences nuisibles pour la réception des ondes de radio ou de télévision, ce qui peut être déterminé en mettant l'appareil hors tension, puis sous tension, il est recommandé de tenter d'éliminer ces interférences en appliquant l'une ou plusieurs des mesures suivantes :

- Réorienter ou déplacer l'antenne réceptrice.
- Éloigner l'appareil du récepteur.
- Brancher l'appareil dans une prise d'un circuit différent de celui qui alimente le récepteur.
- Consulter le détaillant ou un technicien radio ou télévision qualifié pour obtenir de l'aide.

**Avertissement de la FCC : tout changement ou toute modification non expressément approuvés par la partie responsable de la conformité pourrait entraîner l'annulation des droits d'utilisation de cet appareil.**

### 3 Service et garantie

#### Garantie locale

Veillez consulter l'audioprothésiste à l'endroit où vous avez acheté votre appareil au sujet des conditions de la garantie locale.

#### Garantie internationale

Phonak propose une garantie internationale limitée d'un an, valide à compter de la date d'achat. Cette garantie limitée couvre tous les défauts de fabrication et matériels. La garantie est uniquement valide sur présentation d'une preuve d'achat.

La garantie internationale n'aliène aucun des droits légaux dont vous pouvez bénéficier selon votre législation nationale régissant la vente de produits de consommation.

#### Limitation de garantie

Cette garantie ne couvre pas les dommages dus à une manipulation ou un entretien inadaptés, l'exposition à des produits chimiques, l'immersion dans l'eau ou une sollicitation excessive. Les dommages causés par des tiers ou des centres de service non autorisés annulent la garantie. Cette garantie ne couvre pas les services effectués par un audioprothésiste dans son bureau.

Numéro de série:

---

Date d'achat :

---

Audioprothésiste  
autorisé

(tampon/signature) :

---

