



# Instruction Manual



## King

Flash E-TTL Trigger  
For Canon



### Overview

#### Thank you for purchasing PIXEL product

Thank you for purchasing the Pixel product --- King. King achieves high-speed flash shooting with Canon cameras and other creative lighting functions including E-TTL II, FP, etc. King supports shutter speeds up to 1/8000 s. King has 3 different groups; each group can use multiple units and set each as individual power settings. When using the EOS EX II or 600EX-RT series flash, you can set the flash power in the camera menu, directly.

Please read this instruction manual completely and ensure proper operations with your flashgun before using this product.

### Cautions

1. Make sure the camera and flash are powered off before installing the King.
2. As an electronic accessory this may be affected by rare environmental causes. Normal working operations should not be affected by this.

3. Drops or shocks will lead to product failure.
4. When not in use for long durations, please turn off the transmitter and the receiver's power and remove the battery.
5. The batteries should be installed correctly. Reverse polarity may cause batteries to leak corrosive liquids, heat or explosion.
6. When connecting the cable with the device, do not pull directly on the wires.
7. Do not store in a high temperature, such as an enclosed car under direct sunlight, the dashboard and other high-temperature areas.
8. Keep dry, do not contact wet hands with the product. Do not immerse in water or exposed to rain as this may lead to failure of the device.
9. Do not use near flammable gases. Failure to follow this warning may cause explosion or fire.
10. This product includes batteries: please strictly follow the instruction for proper operation. Failure to follow this may cause explosions, fire or personal injury.

### Included items

Please check the listed items below in the package, please contact your dealer if there are missing items.

King Transmitter	1pc
King Receiver	1pc
PC-1/2 Connecting Cable (6.35mm)	1pc
PC-3.5 Connecting Cable	1pc
USB 2.0 Cable	1pc
Hot Shoe Protector	2pcs
Receiver Holder	1pc
Universal Flash Holder SF-18	1pc
Instruction Manual	1pc



### King Basic

Wireless System	
System Mode	Digital FSK 2.4GHz
Distance Range	Up to 100M
Wireless Channel	7
Performance	
Flash Mode	E-TTL, TTL, M
Sync Mode	1st Curtain, 2nd Curtain, High Speed Sync
Group Control	3 different groups (7 different combinations)
Function	King supports flash zooming, focal length, ISO, shutter speed, FV lock and FP
Sync Speed	1/8000S
Compatible Flash	Flashgun, Studio light and outdoor light
Focusing light	Transmitter support with focusing light
Trigger Mode	
Transmitter	Support PC input.
Receiver	Output support TTL, Hot shoe and connecting cable socket.
Socket	
Transmitter	USB, PC, Cable input socket, Hot shoe input
Receiver	USB, PC, Cable output socket, Hot shoe output
Power	
Suitable Battery	Transmitter AA x 2pcs (support 1.2V rechargeable battery) or DC 5V power
	Receiver AA x 2pcs (support 1.2V rechargeable battery) or DC 5V power
Standby	Transmitter 300Hrs (AA 1.2V 2400mAh rechargeable battery)
	Receiver 200Hrs (AA 1.2V 2400mAh rechargeable battery)

### Function

Support EV
Support FE lock
Support camera group setting
Support flash group setting on transmitter
Support High speed sync for studio and outdoor light
Support well known brand flashes for High speed sync and TTL. (Metz, Sigma, Sunpak, Nissin)
Support well known brand flashes for trigger. (Does not support high speed sync and TTL flash)
Support multi receiver control
Support flash focusing light
Can set flash mode for flashgun via camera, such as E-TTL, M mode.
Support for Canon wireless flash system
Support flashes using mixed modes, such as E-TTL and M together
Can set flash output power for flashgun via camera, such as under E-TTL mode, can set 3 levels of +/- EV. Under M mode, can 1/1 to 1/128 in 23 levels.
Can set shutter sync mode for flashgun via camera, such as 1st curtain, 2nd curtain and high speed sync.
Can set zoom mode for flashgun via camera.
Support for bracket exposure
Can set communication channel and group flash for King Transmitter via camera.
Can set flash light output ratio via camera.
Can set flash mode, output ratio, focal length directly on flash. (But cannot set exposure compensation, FEB compensation on flash. When you set different mode on flash, flash on camera menu settings must be under E-TTL mode.)
All King products support online firmware upgrade.
Follow camera instructions for above usage.
Transmitter's hot shoe is NOT used for flashgun

### Compatible Device

King receiver compatible with	
> Canon EOS flash	Canon EOS 600EX-RT, 580EXII, 580EX, 430EXII, 430EX, 320EX, 270EXII, 270EX Flash
> Aftermarket flash	Metz48, Sigma530, Sunpak, Nissin 622, 866 II
> Studio and outdoor flash	
Support external flash control in camera menu	
> 40D, 50D, 60D, 450D, 550D, 600D, 5D Mark II, 5D Mark III, 6D, 7D, 70D, 1D Mark III, 1D Mark IV, 1Ds, 1Ds Mark II, 1Ds Mark III, 1Dx	
> This function can be controlled the flash directly from camera menu.	
Support camera external flash control flashgun	
> Canon 600EX-RT, 580EX II, 430EX II	

\*All brand name(s), logo(s) are trademarks of third party company registered worldwide and were subject(s) as provided for information purposes only.

#### Using non compatible with menu setting camera model as below:

1. Canon 10D, 20D, 30D, 5D, 300D, 350D, 1D, 1D Mark II, 400D.
2. Above camera model do not have external flash function setting in camera menu; you can only set the channel and group on transmitter.
3. Set flash mode directly on the flash.

### Name of each part



### Eyelet: Use strap or lanyard to hold the device

**Hot Shoe:** Hot shoe output of device, support airborne flash. (Transmitter hot shoe is not available at the moment).

**Channel setting button (CH SET):** Set the device channel. Slightly press the button to check the current status; press again or hold for 2sec to enter setting mode.

**Group setting button (GP SET):** Set the device group. Slightly press the button to check the current status; press again or hold for 2sec to enter setting mode.

**Channel Indicator/Group Indicator:** These indicator lights show the group or channel working status.

**Work indicator:** Indicate the status of power, transmission and output. Blue light flashes slowly after the power is on. Blue light flashed quickly when the camera is in normal communication with the device. Red light flashes means the power is about to run out.

**Battery Compartment:** Compartment for 2pcs AA battery, 1.2V to 1.6V

**Receiver Lock Ring:** Suitable to attach on tripod or screw nut.

**PC Socket:** Output socket, can connect with a flash.

**Power Switch:** Switch to OFF to turn off the device; switch to ON to turn on the device.

**Transmitter Mounting Foot:** Input interface connection with camera hot shoe.

**UBS Socket:** Upgrade the firmware for the device, used DC 5V power input.

**Sticker:** Showing product S/N number, battery type on the sticker.

### 1. Power



### 2. Channel or Group:

- Slightly press CH SET and GP SET button to check the current status and enter setting mode.
- Setting: Press CH SET and GP SET to change the channel and group after entering setting mode; LED will turn off and exit from setting mode after 3sec.

### 3. Channel Indicator

- Channel indicator has 3 red indicators which are L1, L2, and L3. Transmitter and receiver use the same setting method and can be set as 7 different channels. [L1], [L2], [L3], [L1, L3], [L2, L3], [L1, L2], [L1, L2, L3].

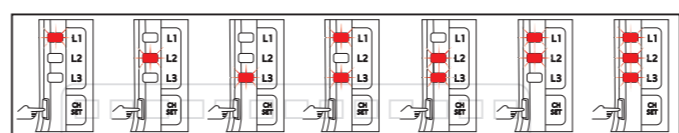

### 4. Group Indicator

- Group indicator has 3 red indicators which are A, B and C. Transmitter and receiver use the same setting method and transmitter can be set as 7 different groups. [A], [B], [C], [A, C], [B, C], [A, B], [A, B, C].

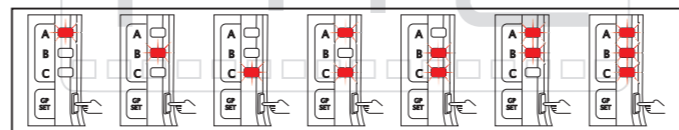

- Receiver can be set as 3 different groups. [A], [B], [C].



### Function Illustration

Below instruction shows the operation of the compatible cameras & compatible flashes. (The above figures are using Canon 5D Mark III with 600EX-RT as shown.)

#### 1 Can set flash mode for flashgun via camera, such as E-TTL, M mode.



#### 2 Can set flash output power for flashgun via camera, such as under E-TTL mode, can set 3 levels of +/- EV. Under M mode, can 1/1 to 1/128 in 23 levels.

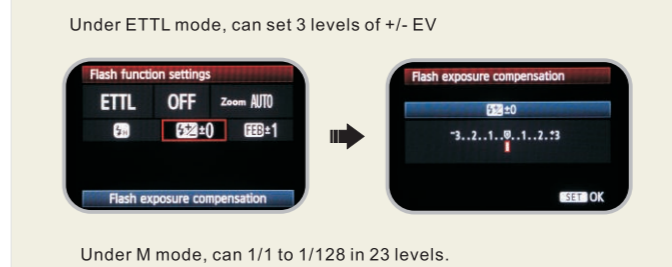

#### 3 Can set shutter sync mode for flashgun via camera, such as 1st curtain, 2nd curtain and high speed sync.

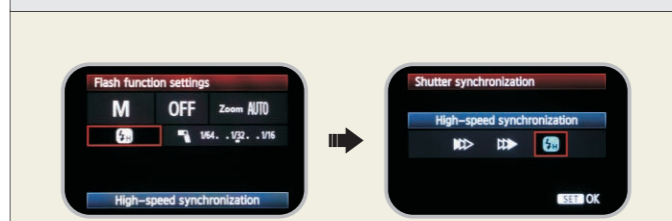

#### 4 Can set zoom mode for flashgun via camera.



#### 5 Can set FEB for flashgun via camera.



#### 6 Can set communication channel and group flash for King Transmitter via camera. (Turn on the wireless function on the flash on-camera setup menu)

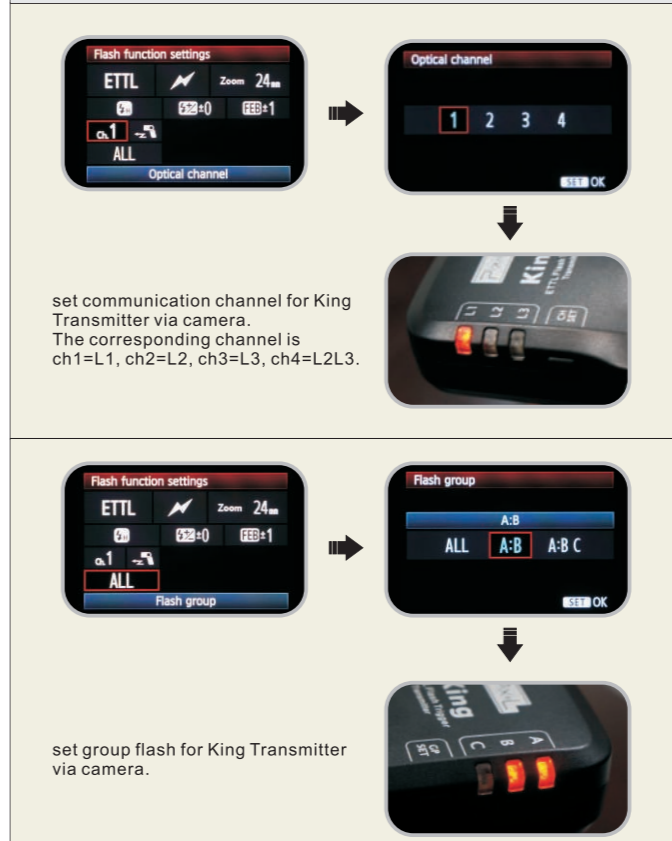

#### 7 Can set flash light output ratio via camera. (Turn on the wireless function on the flash on-camera setup menu)

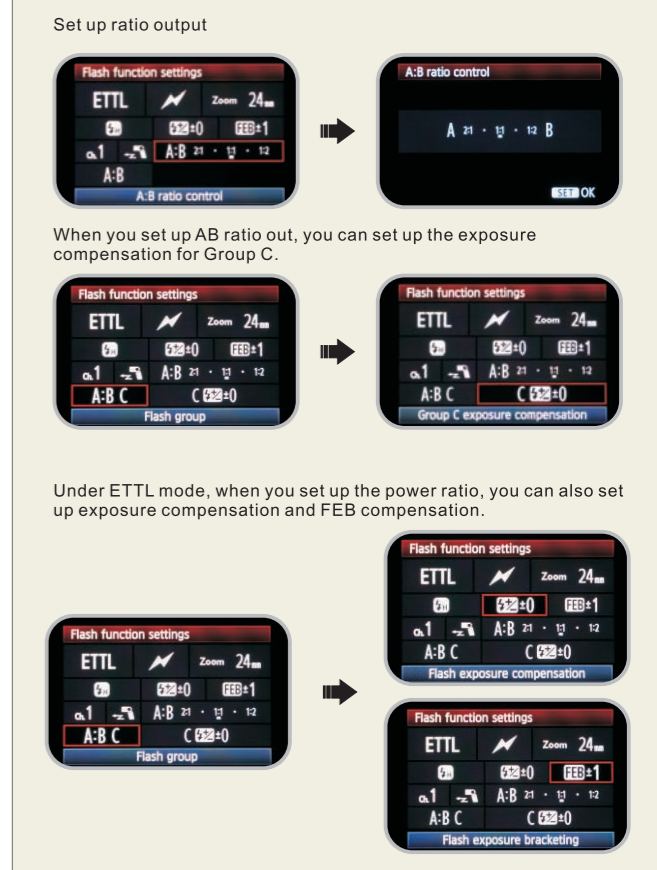

#### 8 When you set up M mode on the flash on-camera setup menu, you can set the output volume of ABC group individually. (Turn on the wireless function on the flash on-camera setup menu)

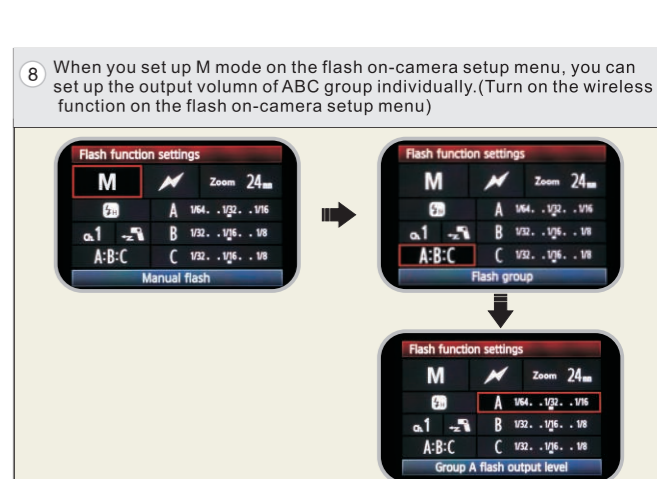

#### 9 Can set flash mode, output ratio, focal length directly on flash. (But cannot set exposure compensation, FEB compensation on flash. When you set different mode on flash, flash on camera menu settings must be under E-TTL mode.)

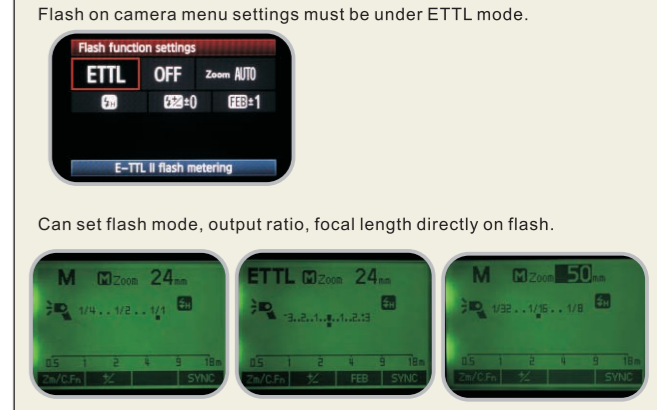

#### 10 Support flashgun settings on Receiver for different flash output mode (For example, E-TTL and M mode output simultaneously, but flash on-camera setup menu should set under E-TTL mode, then flash mode will be set directly on the flashgun.)



#### 11 Support AE Lock, set up directly by pressing the buttons on camera.

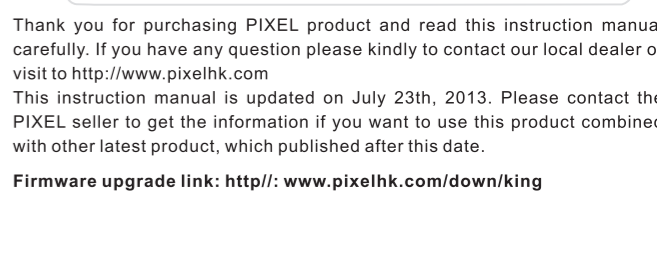

changes or modifications not expressly approved by the party responsible for compliance could void the user's authority to operate the equipment.

This device complies with Part 15 of the FCC Rules. Operation is subject to the following two conditions: (1) this device may not cause harmful interference, and (2) this device must accept any interference received, including interference that may cause undesired operation.

This equipment has been tested and found to comply with the limits for a Class B digital device, pursuant to Part 15 of the FCC Rules. These limits are designed to provide reasonable protection against harmful interference in a residential installation. This equipment generates, uses and can radiate radio frequency energy and, if not installed and used in accordance with the instructions, may cause harmful interference to radio communications. However, there is no guarantee that interference will not occur in a particular installation.

If this equipment does cause harmful interference to radio or television reception, which can be determined by turning the equipment off and on, the user is encouraged to try to correct the interference by one or more of the following measures:

- Reorient or relocate the receiving antenna.
- Increase the separation between the equipment and receiver.
- Connect the equipment into an outlet on a circuit different from that to which the receiver is connected.
- Consult the dealer or an experienced radio/TV technician for help.