

TIPS TO REMEMBER

Listen to the voice (in English only)

Various status alerts include:

- Power on or off
- Remaining talk time
- Battery level
- Maximum volume reached
- Mute status
- Connected or lost connection (to phone)

Play tunes and take calls

Audio will automatically pause to allow you to answer or ignore an incoming call. Once the call ends or is ignored, the streaming audio resumes playback.

2-in-1 charging cable

Charge your headset and your smartphone at the same time, using our custom cable.

plantronics.com



Tel: 0800 410014



Tel: +44 (0)1793 842443*



Tel: +44 (0)1793 842443*



Tel: 80 88 46 10



Deutschland 0800 9323 400
Österreich 0800 242 500
Schweiz 0800 932 340



Tel: +44 (0)1793 842443*



Tel: 902 41 51 91

*Support in English



Tel: 0800 117095



Tel: 0800 945770



Tel: 1800 551 896



Tel: +44 (0)1793 842443*



Tel: +44 (0)1793 842443*



Numero Verde: 800 950934



NL 0800 7526876
BE 0800 39202
LUX 800 24870



Tel: 80011336



Tel: +44 (0)1793 842443*



Tel: 0800 84 45 17



Tel: +44 (0)1793 842443*



Tel: +44 (0)1793 842443*



Tel: 0200 21 46 81



Tel: +44 (0)1793 842443*



EEE Yönetmeliğine Uygundur

© 2011 Plantronics, Inc. All Rights Reserved. Bluetooth is a registered trademark of Bluetooth SIG, Inc. and any use by Plantronics is under license. All other trademarks are the property of their respective owners. Patents US 5,712,453; D628188; Patents Pending.

(07-11) 85845-06 Rev A am85846-06 Printed in China

plantronics®



GET STARTED

MARQUE™ M155 Bluetooth® Headset

DESIGNED IN SANTA CRUZ, CALIFORNIA

MYHEADSET™ APP

Download the MyHeadset App:

Our free MyHeadset app gives you tips, tricks and tools for your Android 3.0 or iPhone. A quick download from the Android marketplace or the Apple app store gets you going.

- Sample your voice quality before a call
- Record a memo then email it
- Learn about A2DP audio streaming
- Check out product FAQs and user guide

TAKE A GOOD LOOK

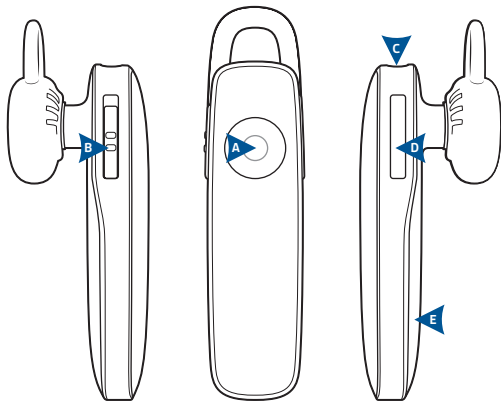

TAKE A GOOD LOOK

A CALL BUTTON

- **Take a call** (1 tap or say "Answer")
- **Reject a call** (1-sec press or say "Ignore")
- **Redial** (2 taps)
- **Initiate phone's voice-dialing** (2-sec press)
- **Reconnect lost connection** (1 tap)
- **Activate pairing mode after initial set up** (press until LED flashes red/white)

B POWER SWITCH

- **On** (slide to reveal green)
- **Off** (slide to conceal green)

NOTE See 'For Your Safety' booklet for important safety, charging, battery, and regulatory information before you use this headset. This headset has an embedded, non-replaceable battery.

Full user guide: plantronics.com/documentation.

Register your headset at plantronics.com/productregistration.

WARNING Always listen at moderate levels. See plantronics.com/healthandsafety for more information on headsets and hearing.

C MICRO USB CHARGING PORT

- **Charge:** 1 hour before first use
2 hours (for full charge)

D VOLUME/MUTE BUTTON

- **Volume presets** (1 tap per level change)
- **Mute on/off** (1-sec press during call)

E INDICATOR LIGHT (LED)

- **Low battery** (3 red flashes at powering on)
- **Pairing mode** (red/white flashes)
- **Charging** (solid red until charged)

TCO DEVELOPMENT

Congratulations! The product you have just purchased carries the TCO Certified Headsets 2 certification. This means that your headset is designed and manufactured according to some of the strictest performance and environmental criteria in the world.



Certified headsets are specifically designed for limiting the risk for hearing impairment. The headsets have acoustic limit protection to protect the user from sudden "sound-spikes" caused by interference on the telephone lines.

Other features of TCO certified headsets:

Ergonomics

- Volume control, individual adjustment and adaptation, replaceable parts, excellent sound quality and durability.

Emissions

- Low SAR value. Low electrical and magnetic fields.

Ecology

- Designed for recycling, manufactured under ISO 14001 certified environmental management system. Corporate Social Responsibility policy promotes good labour relations and working conditions. High efficiency power supply and restrictions on:
 - Chlorinated and brominated flame retardants and polymers
 - Halogenated and non-halogenated substances
 - Hazardous heavy metals such as cadmium, mercury, hexavalent chromium and lead.

All TCO labelled products are verified and certified by TCO Development, an independent third party labelling organisation. For more information visit tcodevelopment.com and plantronics.com/tco

FIND THE BEST FIT

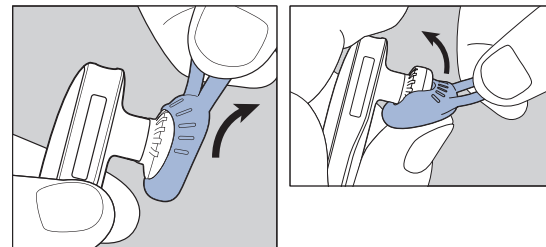
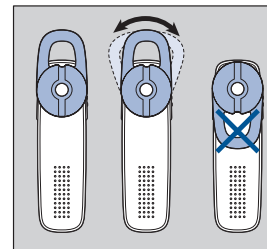

CONNECT TO YOUR PHONE

"Pairing" connects your headset to your phone. "Multipoint" lets you use this headset with two phones.

1 READY

First time: Slide power switch to turn the headset on.

The LED flashes red/white to indicate pairing mode.

Pair new or 2nd phone: Turn on headset. Press Call button until LED flashes red/white (pairing mode).

2 SET

Activate the Bluetooth feature on your phone, then use phone menus to add/search/discover new Bluetooth devices.

iPhone: Settings > General > Bluetooth > On (starts the search for devices)

Android™: Settings > Wireless & networks > Bluetooth settings > Scan for devices

BlackBerry®: Settings/options > Bluetooth: On > Search for devices.

3 CONNECT

Select "PLT_M155" from the list of Bluetooth devices shown on your phone.

If phone asks for a passcode, enter four zeros (0000).

Headset LED will stop flashing red/white once successfully paired/connected.

Our free MyHeadset app gives you tips, tricks and tools for your Android 3.0 or iPhone. Download it now from the Android marketplace or the Apple app store.

UE

Federal Communications Commission Statement

This device complies with FCC Rules Part 15. Operation is subject to the following two conditions:

- This device may not cause harmful interference, and
- This device must accept any interference received, including interference that may cause undesired operation.
-

This equipment has been tested and found to comply with the limits for a class B digital device, pursuant to Part 15 of the Federal Communications Commission (FCC) rules. These limits are designed to provide reasonable protection against harmful interference in a residential installation. This equipment generates, uses, and can radiate radio frequency energy and, if not installed and used in accordance with the instructions, may cause harmful interference to radio communications. However, there is no guarantee that interference will not occur in a particular installation. If this equipment does cause harmful interference to radio or television reception, which can be determined by turning the equipment off and on, the user is encouraged to try to correct the interference by one or more of the following measures:

- Reorient or relocate the receiving antenna.
- Increase the separation between the equipment and receiver.
- Connect the equipment into an outlet on a circuit different from that to which the receiver is connected.
- Consult the dealer or an experienced radio/TV technician for help.

Note:

Any changes or modifications not expressly approved by the grantee of this device could void the user's authority to operate the equipment.

RF exposure warning

This equipment complies with FCC radiation exposure limits set forth for an uncontrolled environment, and must not be co-located or operating in conjunction with any other antenna or transmitter.

Canada regulatory compliance

This device complies with Industry Canada licence-exempt RSS standard(s).
Le présent appareil est conforme aux CNR d'Industrie Canada applicables aux
appareils radio exempts de licence.

Operation is subject to the following two conditions: (1) this device may not cause
interference, and (2) this device must accept any interference, including interference
that may cause undesired operation of this device.

L ' utilisation de ce dispositif est autorisée seulement aux conditions suivantes: (1) il
ne doit pas produire de brouillage et (2) l' utilisateur du dispositif doit être prêt à
accepter tout brouillage radioélectrique reçu, même si ce brouillage est susceptible de
compromettre le fonctionnement du dispositif.