

## NEED MORE HELP?

Read the guides for setup, use and safety. For more help, don't return to the store; find a local phone support number at [plantronics.com/support](http://plantronics.com/support)

**plantronics**  
Simply Smarter Communications™

© 2013 Plantronics, Inc. All Rights Reserved. Bluetooth is a registered trademark of Bluetooth SIG, Inc. and any use by Plantronics is under license. All other trademarks are the property of their respective owners.

Patents  
200461-01 BETA 9.13 MODEL PITE14

## USE SENSORS

Smart sensors respond when you put on or take off your headset.

### Putting on your headset will:

- Answer an incoming call
- Transfer an active call from your phone
- Resume streaming audio

### Taking off your headset will:

- Transfer an active call to your phone handset
- Pause streaming audio
- Lock the Call button to avoid accidental calls
- Deactivate mute

### Reset sensors

You may need to reset the sensors periodically for optimal performance. To reset them, take the headset off, hold it by the boom, power it off for at least 3 seconds and power it on again.

### Disable sensors

To disable the smart sensors, hold the Voice and Call button for more than 6 seconds until the LED flashes purple then red. Press again to reactivate; the LED flashes purple then blue.

## TRY VOICE COMMANDS



Tap the Voice button , wait for a command request, then say a command. "What can I say?" tells you the full list of available commands.

### To disable the "answer/ignore" voice commands:

- 1 Power on the headset.
- 2 Press and hold the Voice button  until you hear "voice answer off."
- 3 Repeat to reactivate the voice answer commands.

## CHARGE

It takes 1.5 hours to fully charge the headset. The indicator light turns off once charging is complete.

To check the headset battery status, tap the Call button  while wearing your headset or tap the Voice button  and say "Check battery."

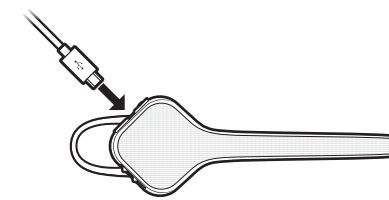

## RESELECT LANGUAGE

Reselect the headset language at any time by putting your headset into pair mode.

- 1 Wearing your headset, power it on.
- 2 Press and hold the Call button  until you hear "pairing."
- 3 Follow voice-guided prompts to select the headset language.

## TIPS

Go to [plantronics.com/documentation](http://plantronics.com/documentation) and download the online user guide to learn how to:

- Use multipoint
- Update language and configure settings
- Receive firmware upgrades
- Get the Find MyHeadset™ app

**plantronics**

# GET STARTED

VOYAGER S™ SERIES

Designed in Santa Cruz, California

## GET PAIRED

The first time you power on your headset, it begins voice-guided language selection and the pairing process.

### Language selection

- 1 Wearing your headset, power it on. Follow the voice-guided prompts to select the headset language.

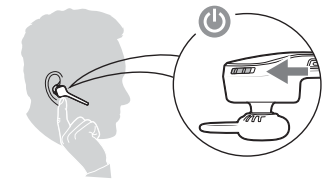

- 2 When completed, you hear "pairing."

NOTE If your phone supports Near Field Communication (NFC), go to NFC pairing.

### Bluetooth pairing

- 1 Activate Bluetooth on your phone and set it to search for new devices.

**iPhone®** Settings > Bluetooth > On  
**Android™ Smartphones\*** Settings > Wireless & Networks > Bluetooth: On > Scan for devices.

\* Menus may vary by device.

- 2 Select "PLT VoyagerS." If necessary, enter four zeros (0000) for the passcode or accept the connection. Once successfully paired, you hear "pairing successful."

### NFC pairing

- 1 Ensure NFC is on and your phone's display is unlocked.
- 2 Tap and hold the headset to the phone's NFC tag location until NFC pairing completes. If necessary, accept the connection.

NOTE The headset's NFC tag is located on the top of the headset. Phone NFC tag locations vary.



## TAKE CONTROL

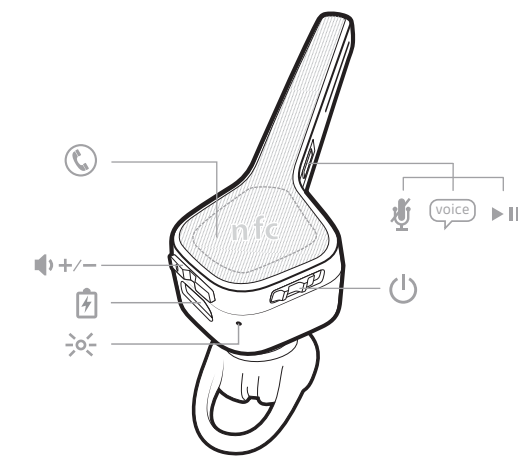

### Answer a call

Choose:

- Put on the headset to answer call, or
- Say "answer" after call is announced, or
- Tap the Call button 

### Decline a call

Choose:

- Say "ignore" after call is announced, or
- Press Call button  for 2 seconds

### End a call

Tap the Call button  to end current call.

### Mute

During a conversation, tap the Mute button . You will hear "mute on" or "mute off." An alert repeats every 15 minutes when mute is on.

### Call back last call

Double-tap the Call button 

### Voice dial (phone feature)

Press the Call button  for 2 seconds, wait for phone prompt and then tell the phone to dial the name of a stored contact.

## FIND YOUR FIT

The loop of the gel eartip tucks into the back curve of your ear for a stable fit.

- 1 With the headset powered off, replace the eartip with one of the two alternate sizes if it feels loose or tight in your ear.

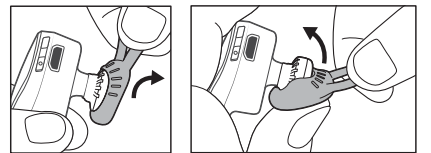

- 2 To adjust the fit, rotate the eartip on the headset or add the optional clip-on earloop.