

Quick Start

**Savi™ Office
Wireless Headset System
WO300/WO350**

Quick Start Guide
Guide de démarrage rapide
Guía de inicio rápido
Guia de Início Rápido

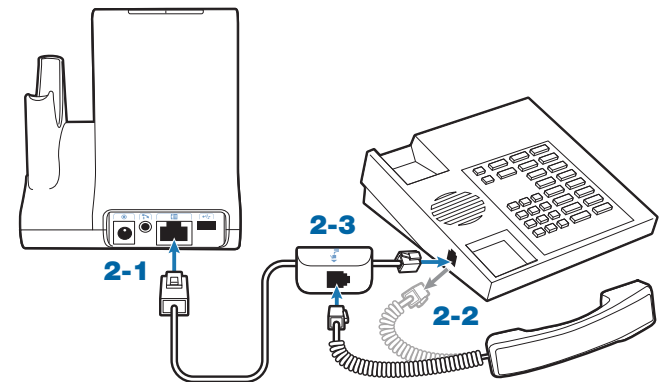

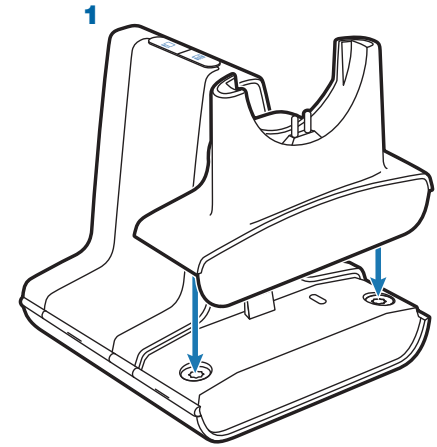
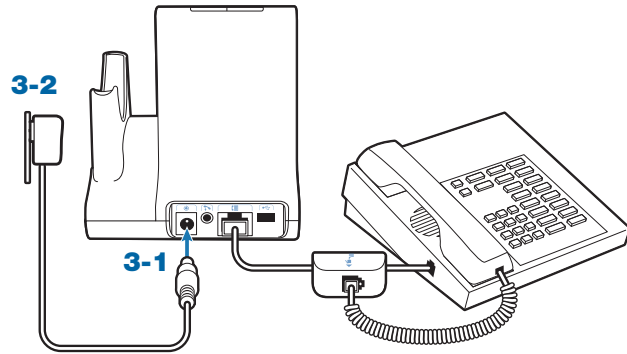

Savi WO1 Base

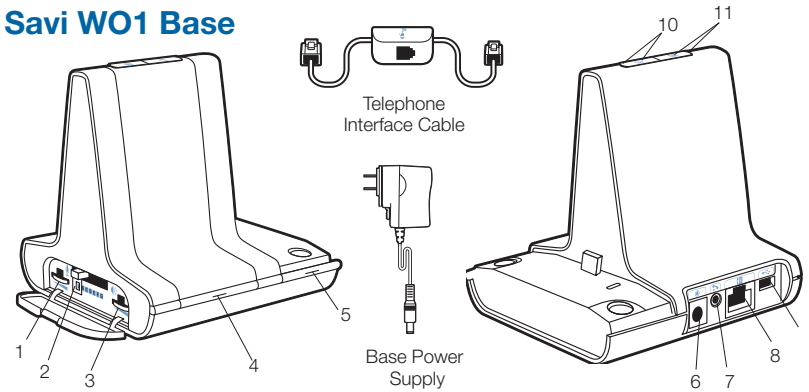

1. Desk Phone Speaking Volume
2. Configuration Switch
3. Desk Phone Listening Volume
4. Subscription Button and Indicator Light
5. Power/Charging Indicator Light
6. Power Jack
7. Handset Lifter Jack
8. Telephone Interface Cable Jack
9. USB Port
10. Desk phone Talk Button and Indicator Light
11. PC Talk Button and Indicator Light

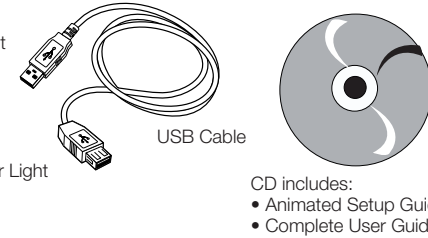
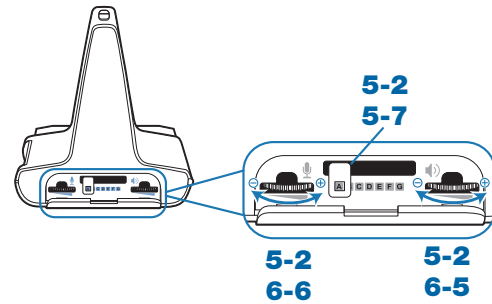

- CD includes:
- Animated Setup Guide
 - Complete User Guide

Savi Headset

Model WH350 (binaural) shown - Model WH300 (monaural) available

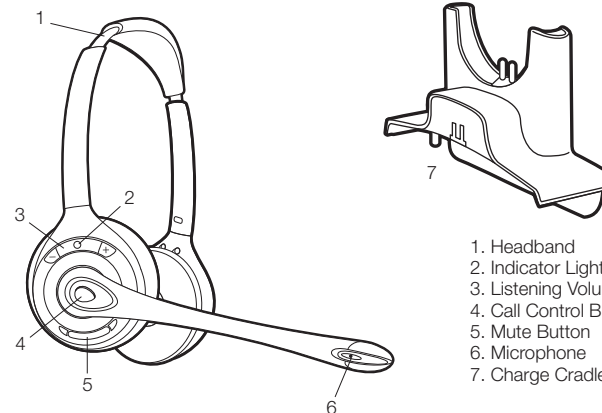

1. Headband
2. Indicator Light
3. Listening Volume
4. Call Control Button
5. Mute Button
6. Microphone
7. Charge Cradle

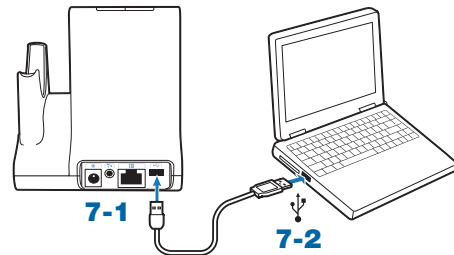
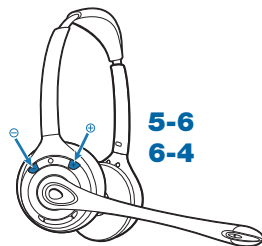

Welcome

Congratulations on purchasing your new Plantronics product. This Quick Start Guide contains instructions for setting up and using your Savi Office WO300/WO350 (WO1 Base + WH300/WH350 Headset) Wireless Headset System.

Please refer to the separate [safety instructions](#) for important product safety information prior to installation or use of the product.

System Requirements

The minimum system requirements for Savi Office are as follows:

- Supported Operating Systems: Windows XP, Windows Vista
- Processor: 400 MHz Pentium processor or equivalent (Minimum); 1 GHz Pentium processor or equivalent (Recommended)
- RAM: 96 MB (Minimum); 256 MB (Recommended)
- Hard Disk: 280 MB (Minimum); 500 MB (Recommended)
- Display: 800 x 600, 256 colors (Minimum); 1024 x 768 high color, 32-bit (Recommended)
- Internet Explorer V6 or better must be on the user's system (Required)

Download and Install PerSono® Suite Software

It is highly recommended that you install the PerSono Suite software. Though your Savi Go system will operate without the software running it will limit the system's capabilities. Go to www.plantronics.com/support and click the Software Downloads tab. Follow the instructions to download and install PerSono Suite software.

We highly recommend that you refer to the CD for Animated Set Up instructions and the complete User Guide.

Registering Your Product

Visit www.plantronics.com/productregistration to register your product online so we can provide you with the best service and technical support.

Getting Assistance

The Plantronics Technical Assistance Center is ready to assist you. You can find answers to frequently asked questions, ask a question using e-mail, receive service over the Internet, or speak directly with a representative. Visit www.plantronics.com/support.

Setting up your Savi Office WO300/WO350 System

1. Attaching Charge Cradle to Base

Connect the headset charge cradle to the base. Push firmly on the cradle until the cradle snaps into place.

2. Connecting Base to Desk Phone

1. Connect the telephone interface cable to the telephone interface cable jack on the base.
2. After disconnecting the handset coil cord from the desk phone, connect the telephone interface cable to the now open handset port on the desk phone.
3. Connect the handset coil cord to the telephone interface cable junction box.

3. Connecting Power Supply to Base

- 3-1. Connect the base power supply into the power jack on the base.
- 3-2. Connect the power supply to outlet.

4. Docking and Charging Headset

Gently push the headset into the charge cradle. Charge for at least 20 minutes prior to the first use. A full charge takes 3 hours.

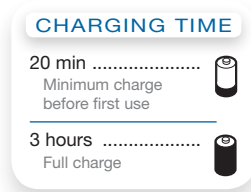

5. Checking Configuration

- 5-1. Set volume on desk phone to mid-range.
- 5-2. On the base, ensure the configuration switch is set to "A" and the desk phone speaking volume and desk phone listening volume are both set to 3.

NOTE For most phones, these factory default settings will sound the best.

- 5-3. With your headset on, press the call control button on headset.
- 5-4. Remove the handset from desk phone cradle.
- 5-5. Listen for a dial tone. If the dial tone sounds clear, press the call control button on headset and continue with **Step 6. Making a Test Call with Desk Phone.**

- 5-6. If the dial tone is too loud or too soft, adjust the headset volume level.
- 5-7. If the dial tone still does not sound clear, adjust the configuration switch until the dial tone sounds the best.

NOTE Multiple settings might work with your phone; however, only one is the optimal position.

- 5-8. Press the call control button on the headset and return the handset to the cradle to complete configuration.

6. Making a Test Call with Desk Phone

- 6-1. With your headset on, press the call control button on headset.
- 6-2. Remove the handset from desk phone cradle.
- 6-3. Dial the number using your desk phone.
- 6-4. If needed, adjust the listening volume on the headset.
- 6-5. If the listening volume is still too loud or too soft, adjust the desk phone listening volume on the base.
- 6-6. If the speaking volume is too loud or too soft for your listener, adjust the desk phone speaking volume on the base.
- 6-7. Press the call control button on the headset and return the handset to the cradle to complete the test call.

 Do not use headphones / headsets at high volumes for an extended period of time. Doing so can cause hearing loss. Always listen at moderate levels. See www.plantronics.com/healthandsafety for more information on headsets and hearing.

7. Connecting to the PC

- 7-1. Connect the USB cable to the USB port on the back of the base.
- 7-2. Connect the other end of the USB cable to the USB port on the PC.
- 7-3. To install the PerSono® Suite software, go to www.plantronics.com/support and click the Software Downloads tab. Follow the instructions to download and install PerSono Suite software.

8. Making a Test Call with PC

- 8-1. Ensure the PerSono Suite software is running on your PC.
- 8-2. With your headset on, press the PC talk button on the base.
- 8-3. Dial the number using your softphone application.
- 8-4. Adjust listening and speaking volume using your softphone application and/or "sound and audio devices" in your PC control panel.
- 8-5. You can fine tune the listening volume on the headset.
- 8-6. To end the test call, press the call control button on the headset.

Please refer to the complete User Guide located on the CD for further details on how to use your Savi Office WO300/WO350 Wireless Headset System.



This device complies with Part 15 of the FCC Rules. Operation is subject to the following two conditions:

1. This device may not cause harmful interference, and
2. This device must accept any interference received, including interference that may cause undesired operation.

This equipment has been tested and found to comply with the limits for a Class B digital device, pursuant to Part 15 of the FCC Rules. These limits are designed to provide reasonable protection against harmful interference in a residential installation. This equipment generates, uses, and can radiate radio frequency energy and, if not installed and used in accordance with the instructions, may cause harmful interference to radio communications. However, there is no guarantee that interference will not occur in a particular installation. If this equipment does cause harmful interference to radio or television reception which can be determined by turning the radio or television off and on, the user is encouraged to try to correct interference by one or more of the following measures:

1. Reorient or relocate the receiving antenna.
2. Increase the separation between the equipment and receiver.
3. Connect the equipment into an outlet on another circuit.
4. Consult the dealer or an experienced radio/TV technician for help.

FCC REGISTRATION INFORMATION — Part 68

This equipment complies with Part 68 of the FCC rules and the requirements adopted by ACTA. On the exterior of this equipment is a label that contains a product identifier in the format US:AAEQ##TXXXX. If requested, this information must be provided to your telephone company.

A plug and jack used to connect this equipment to the premises wiring and telephone network must comply with the applicable FCC Part 68 rules and requirements adopted by ACTA. A compliant telephone cord and modular plug is provided with this product. It is designed to be connected to a compatible jack that is also compliant. See installation instructions for details.

The REN is useful to determine the quantity of devices you may connect to your telephone line. Excessive RENs on a telephone line may result in the devices not ringing in response to an incoming call. In most, but not all areas, the sum of the RENs should not exceed five (5.0). To be certain of the number of devices you may connect to your line, as determined by the REN, contact your local telephone company. For products approved after August 8, 2001, the REN for this product is part of the product identifier that has the format US:AAEQ##TXXXX. The digits represented by ## are the REN without the decimal point. (For example, 03 represents a REN of 0.3.) For earlier producers, the REN is separately shown on the label.

If this telephone equipment causes harm to the telephone network, the telephone company will notify you in advance that temporary discontinuance of service may be required. But if advance notice isn't practical, the telephone company will notify the customer as soon as possible. Also, you will be advised of your right to file a complaint with the FCC if you believe it is necessary.

The telephone company may make changes in its facilities, equipment, operations, or procedures that could affect the proper functioning of your equipment. If they do, you will be notified in advance in order for you to make necessary modifications to maintain uninterrupted service.

If trouble is experienced with this unit, for repair or warranty information, please contact customer service at (800) 544-4660. If the equipment is causing harm to the network, the telephone company may request that you disconnect the equipment until the problem is resolved.

DO NOT DISASSEMBLE THIS EQUIPMENT: it does not contain any user-serviceable components.

We recommend the installation of an AC surge arrester in the AC outlet to which this equipment is connected. Telephone companies report that electrical surges, typically lighting transients, are very destructive to customer terminal equipment connected to AC power sources.

Exposure to RF Radiation

The internal wireless radio operates within the guidelines found in radio frequency safety standards and recommendations, which reflect the consensus of the scientific community. Independent studies have shown that the internal wireless radio is safe for use by consumers. Visit www.plantronics.com for more information.

In order to comply with FCC RF Exposure requirements, the base must be installed and operated such that a minimum separation distance of 20 cm is maintained between the base and all persons during normal operation.

NOTE: Modifications not expressly approved by Plantronics, Inc. could void the user's authority to operate the equipment.

INDUSTRY CANADA REGULATORY INFORMATION

This product meets the applicable Industry Canada technical specifications/Le présent matériel est conforme aux spécifications techniques applicables d'Industrie Canada.

This Class B digital apparatus complies with Canadian ICES-003.

Cet appareil numérique de la classe B est conforme à la norme NMB-003 du Canada.

Plantronics, Inc.

345 Encinal Street

Santa Cruz, CA 95060

United States

Tel: 800-544-4660

Tel: 831-426-5858

www.plantronics.com



©2009 Plantronics, Inc. All rights reserved. Plantronics, the logo design, PerSono, Savi, and Sound Innovation are trademarks or registered trademarks of Plantronics, Inc. All other trademarks are the property of their respective owners.

Patents US 5,210,791; D469,756; Australia 147229; France 651,857-651,865; Germany 40108524.4; GB Regd.Des.No. 2104923; Patents Pending..

82326-02 (7.09)



PLANTRONICS
SOUND INNOVATION™



en	Safety Instructions
ar	ةمالسلا لوج تاداشرلا
bg	Инструкции за безопасност
cs	Bezpečnostní pokyny
da	Sikkerhedsvejledning
de	Sicherheitshinweise
el	Οδηγίες για την ασφάλεια
es	Instrucciones de seguridad
fa	سمنسا سا لمعلاروتسد
fr	Instructions de sécurité
he	תוחיטב תוארה
hr	Sigurnosne upute
hu	Biztonsági előírások
it	Informazioni sulla sicurezza
mk	Безбедносни упатства
nl	Veiligheidsinstructies
no	Sikkerhetsinstruksjoner
pl	Instrukcje bezpieczeństwa
pt	Instruções de Segurança
ro	Instrucțiuni de siguranță
ru	Инструкции по безопасности
sl	Varnostna navodila
sv	Säkerhetsanvisningar
tr	Instrucțiuni de siguranță

Safety Instructions

Please read the following safety and operational instructions before using your Plantronics product. Please keep these instructions for your reference. When using this product, these basic safety precautions and warnings should be followed to reduce the risk of fire, electric shock, injury to persons and damage to property.

General

Operating, charging and storage temperature is 0°C to 40°C (32°F to 104°F).

⚠ Warnings

- Only use those Plantronics products designed for use with this Plantronics system.
- CHILDREN. Never allow children to play with the product—small parts may be a choking hazard.
- Plug the AC adapter into the outlet nearest the equipment that is easily accessible.
- To reduce the risk of electric shock, explosion or fire, use only the supplied charger or Class 2 AC adapter to charge the headset. Ensure that the voltage rating (e.g. 120v, 60 Hz) corresponds to the power supply you intend to use.
- Do not disassemble the product or AC adapter as this may expose you to dangerous voltages or other risks. Incorrect reassembly can cause electric shock or fire when the product is subsequently used.
- Do not insert anything into the product because this may cause damage to the internal components or cause injury to you.
- If this system includes a mobile phone headset, check local laws regarding use of a mobile phone and headset while driving. If you use the headset while driving, ensure your attention and focus remain on driving safely.
- Use of a headset that covers both ears will impair your ability to hear other sounds. Use of such a headset while operating a motor vehicle or riding a bicycle may create a serious hazard to you and/or others, and is illegal in most states and regions.
- If this system includes a Bluetooth headset, observe all signs or instructions that require an electrical device or RF radio product to be switched off in designated areas, such as hospitals, blasting areas, potentially explosive atmospheres, and aircraft.
- Avoid contact with liquids. Do not locate this product near water, for example, near a bathtub, or sink, in a wet basement, or near a swimming pool.
- Discontinue use of product and contact Plantronics if the product overheats, has a damaged cord or plug, if the product has been dropped or damaged, or if the product has come into contact with liquids.
- This product should never be placed over or near a heat register and should not be placed in locations without which do not have proper ventilation.
- If you experience a skin irritation after using this product, discontinue use and contact Plantronics.
- Exposure to high volume sound levels or excessive sound pressure may cause temporary or permanent damage to your hearing. Although there is no single volume setting that is appropriate for everyone, you should always use your headset/headphones with the volume set at moderate levels and avoid prolonged exposure to high volume sound levels. The louder the volume, the less time is required before your hearing could be affected. You may experience different sound levels when using your headset /headphones with different devices. The device you use and its settings affect the level of sound you hear. If you experience hearing discomfort, you should stop listening to the device through your headset/headphones and have your hearing checked by your doctor. To protect your hearing, some hearing experts suggest that you:
 1. Set the volume control in a low position before putting your headset or headphones on your ears and use as low a volume as possible.
 2. Avoid turning up the volume to block out noisy surroundings. Whenever possible, use your headset or headphones in a quiet environment with low background noise.
 3. Limit the amount of time you use headsets or headphones at high volume levels.

4. Turn the volume down if the sound from the headset/headphones prevent you from hearing people speaking near you.

See www.plantronics.com/healthandsafety for more information on headsets/headphones and hearing.

To avoid the risk of electric shock, explosion, fire or leakage of corrosive or toxic chemicals, please observe the following charging and battery warnings:

⚠ Charging Warnings

- Use only the charger supplied by Plantronics to charge the product. Do not use the charger for any other purpose. Ensure that the voltage rating corresponds to the power supply you intend to use.
- Charge the headset/headphones according to the instructions supplied with the unit.
- Plug the AC adapter or charger into an outlet that is near the equipment and will be easily accessible.
- Never charge the battery where the temperature may fall below 0°C (32°F) or rise above 40°C (104°F) - for example in an unattended motor vehicle.
- Avoid charging the battery while it is unattended.

⚠ Headset Battery Warnings

The headset is equipped with a non-replaceable battery. To reduce the risk of fire or injury to persons, read and follow these instructions.

Do not attempt to open the headset or remove the battery.

Do not dispose of the headset or battery in a fire. The battery may explode. Check local laws for disposal instructions.

Do not open or mutilate the battery. There may be corrosive materials which can cause damage to eyes or skin and may be toxic if swallowed.

Charge the headset according to the instructions supplied with the headset.

RECYCLING: The battery used in your headset must be recycled or disposed of properly. Contact your local recycling center for proper disposal of your headset.

عمالسلالوحتاداشرا

طافحتالوحتاداشرا Plantronics حتنم ماذختسالبق فيلاتالليغيشتالو عمالسلالوحتاداشرا عارقوحتري عمالسلالوحتاداشراوحتري بادت عابتا بحتي حتنم الماذ عمالسلالوحتاداشرا دنع. اهليلوحتاداشرا لهذه وطوخوحتاداشرا تاباصلالوحتاداشرا تامدصلالوحتاداشرا طرخ نم فيفختللهذه عتسالالوحتاداشرا رارضالوحتاداشرا

عام

درجات حرارة التشغيل والتسخين والتخزين تتراوح ما بين 0 درجة مئوية و 40 درجة مئوية (ما بين 32 درجة فهرنهايت و 104 درجات فهرنهايت).

تاريخيحت

اذه Plantronics ماظن عم ماذختسالبق عمالسلالوحتاداشرا Plantronics تا حتنم طوق ماذختسالبق عرقصلالوحتاداشرا ببستت دق ذالطالالوحتاداشرا حتنم لاب بع للاب لافطالالوحتاداشرا لافطالالوحتاداشرا لاب

هليلوحتاداشرا لهسبي ذالوحتاداشرا لالوحتاداشرا نذام لاب بوحتاداشرا رايتاللوحتاداشرا

لوحتاداشرا ورفوحتاداشرا حتنم الماذختسالبق عارقوحتاداشرا وراحتاداشرا واهليلوحتاداشرا عمالسلالوحتاداشرا طوخوحتاداشرا نم فيفختلله 60 ملوحتاداشرا 120 المم) عتالوحتاداشرا عتدنا نم ذكات سارالوحتاداشرا عمالسلالوحتاداشرا Class 2 بوحتاداشرا رايتاللوحتاداشرا عتالوحتاداشرا قاطالوحتاداشرا قباطت (زتره