Installation Guide



**POWER
MEASUREMENT**

Notices

For further assistance
please contact us at:



Worldwide Headquarters

2195 Keating Cross Road
Saanichton, BC
Canada V8M 2A5
Tel: 1-250-652-7100
Fax: 1-250-652-0411
Email: support@pwrn.com

www.pwrn.com

© 2005 Power Measurement
Printed in Canada
Revision Date: Feb. 14, 2005
70000-0267-00

Danger



This symbol indicates the presence of dangerous voltage within and outside the product enclosure that may constitute a risk of electric shock, serious injury or death to persons if proper precautions are not followed.

Caution



This symbol alerts the user to the presence of hazards that may cause minor or moderate injury to persons, damage to property or damage to the device itself, if proper precautions are not followed.

Note



This symbol directs the user's attention to important installation, operating and maintenance instructions.

Installation Considerations

Installation and maintenance of the wireless repeater should only be performed by qualified, competent personnel that have appropriate training and experience.

FCC Notice

This equipment has been tested and found to comply with the limits for a Class B digital device, pursuant to Part 15 of the FCC Rules. These limits are designed to provide reasonable protection against harmful interference in a residential installation. This equipment generates, uses, and can radiate radio frequency energy and, if not installed and used in accordance with the instruction manual, may cause harmful interference to radio communications. However, there is no guarantee that interference will not occur in a particular installation. If this equipment does cause harmful interference to radio or television reception, which can be determined by turning the equipment off and on, the user is encouraged to try to correct the interference by one or more of the following measures:

- ◆ Reorient or relocate the receiving antenna
- ◆ Increase the separation between the equipment and receiver. Connect the equipment into an outlet on a circuit different from that to which the receiver is connected.

Modifications: Modifications to this device which are not approved by Power Measurement may void the authority granted to the user by the FCC to operate this equipment.

Limitation of Liability

Power Measurement Ltd. ("Power Measurement") reserves the right to make changes in the device or its specifications identified in this document without notice. Power Measurement advises customers to obtain the latest version of the device specifications before placing orders to verify that the information being relied upon by the customer is current.

Regardless of whether any remedy set forth herein fails of its essential purpose, except to the extent the following limitation is prohibited by applicable law, Power Measurement shall not, in any event or under any legal claim or theory (whether based on contract, indemnity, warranty, tort (including negligence and strict liability) or otherwise), be liable to the original purchaser or any other person or entity for special, indirect, incidental, punitive, liquidated, special or consequential damages whatsoever with respect to any purchased product, including, without limitation, business interruption, loss of use, profit or revenue, even if Power Measurement has been advised of the possibility of such damages. To the extent that a limitation or exclusion of consequential damages are prohibited by applicable law, then Power Measurement's liability shall be limited to twice the amount of the relevant purchased product. Not to limit the foregoing, a) Power Measurement shall not be liable for any claim (other than a claim solely for the breach of one of the above Warranties that is made in accordance with the above described procedures) made by the original purchaser, its employees, agents, or contractors for any loss, damage, or expense incurred due to, caused by, or related to any purchased product; and b) the above Warranties are the original purchaser's exclusive remedy and Power Measurement hereby expressly disclaims all other warranties, express or implied, including, without limitation, warranties of non-infringement and the implied warranties of merchantability and fitness for a particular purpose.

These limited Warranties shall not apply to any product that has been subject to alteration, accident, misuse, abuse, neglect or failure to exactly follow Power Measurement's instructions for operation and maintenance. Any technical assistance provided by Power Measurement's personnel or representatives in system design shall be deemed to be a proposal and not a recommendation. The responsibility for determining the feasibility of such proposals rests with the original purchaser and should be tested by the original purchaser. It is the original purchaser's responsibility to determine the suitability of any product and associated documentation for its purposes. The original purchaser acknowledges that 100% "up" time is not realizable because of possible hardware or software defects. The original purchaser recognizes that such defects and failures may cause inaccuracies or malfunctions. Only the terms expressed in these limited Warranties shall apply and no distributor, corporation or other entity, individual or employee of Power Measurement or any other entity is authorized to amend, modify or extend the Warranties in any way.

The information contained in this document is believed to be accurate at the time of publication, however, Power Measurement assumes no responsibility for any errors which may appear here and reserves the right to make changes without notice.

Power Measurement, ION, ION Enterprise, MeterM@il, WebMeter and "drive energy performance" are either registered trademarks or trademarks of Power Measurement. All other trademarks are property of their respective owners.

Covered by one or more of the following patents:

U.S. Patent No's 6825776, 6813571, 6798191, 6798190, 6792364, 6792337, 6751562, 6745138, 6737855, 6694270, 6687627, 6671654, 6671635, 6615147, 6611922, 6611773, 6563697, 6493644, 6397155, 6186842, 6185508, 6000034, 5995911, 5828576, 5736847, 5650936, D459259, D458863, D443541, D439535, D435471, D432934, D429655, D429533, D427533.

Contents

- ◆ **ION® Wireless Repeater Installation** **7**
 - Wireless Repeater Applications 8
 - Required Tools and Materials 9
 - Before You Begin 9
 - Getting More Information 9
 - Mechanical Dimensions 9
- ◆ **Installation** **10**
 - Step 1: Assemble the Repeater 10
 - Step 2: Position the Repeater 12
 - Step 3: Verify Operation and Communications 13
 - Step 4: Verify Wireless Repeater Properties 13
 - Step 5: Install Mounting Brackets 14

ION[®] Wireless Repeater Installation

The ION Wireless Repeater extends the communication range of ION meters equipped with wireless communications, such as the ION 6300 Socket-Based Wireless Energy Meter. This repeater is powered by a solar-rechargeable battery pack, and communicates through a 1/4-wave internal fixed antenna.

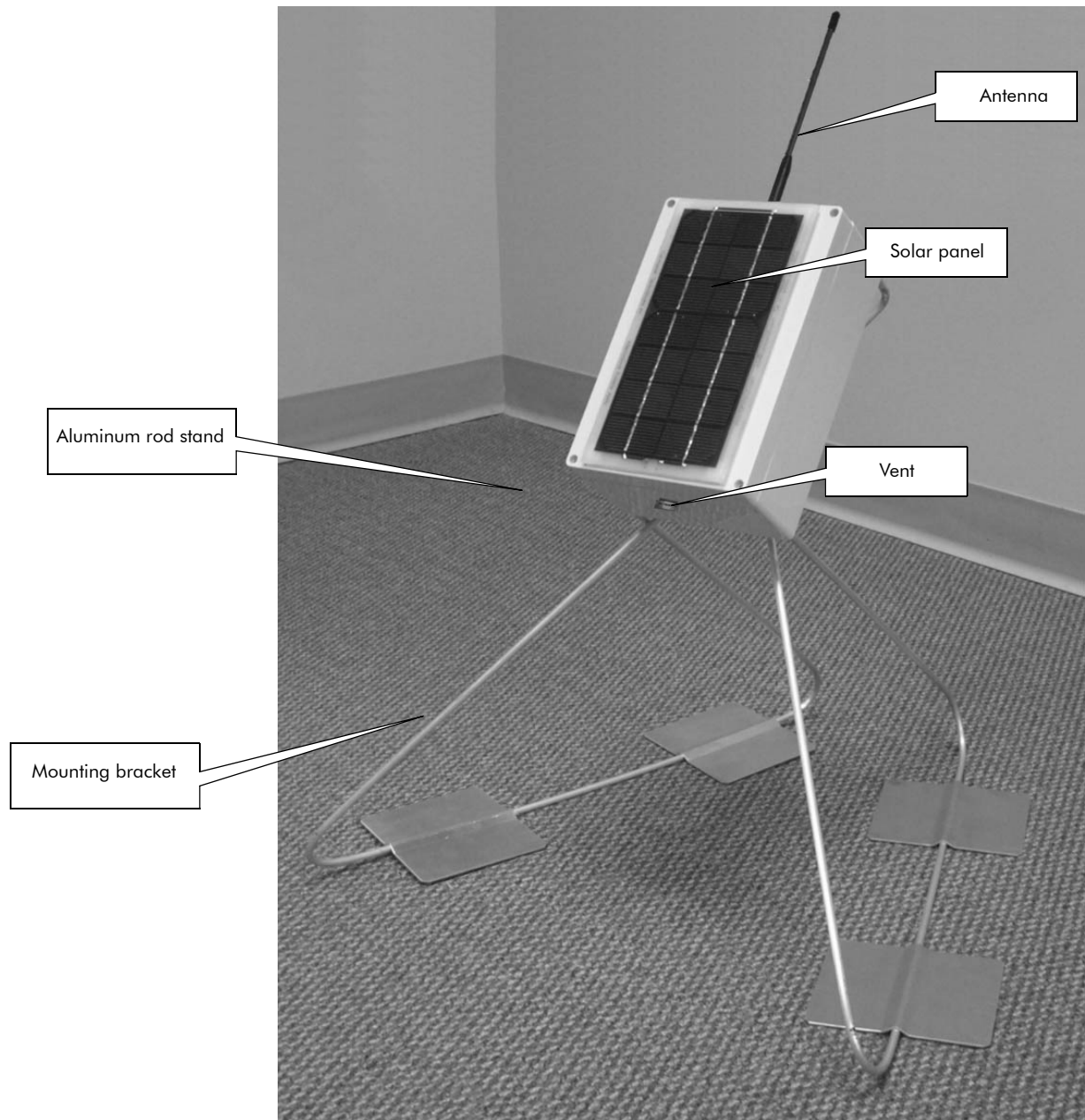

Wireless Repeater Applications

Use the ION Wireless Repeater as a communications bridge between two ION 6300 meters if the physical distance between them is greater than the recommended operating range for wireless communications.

| | |
|---------------------|---|
| Operating frequency | License-free 900 MHz ISM radio band |
| Operating range | Typical 30 meter (100 ft) maximum distance between radios |

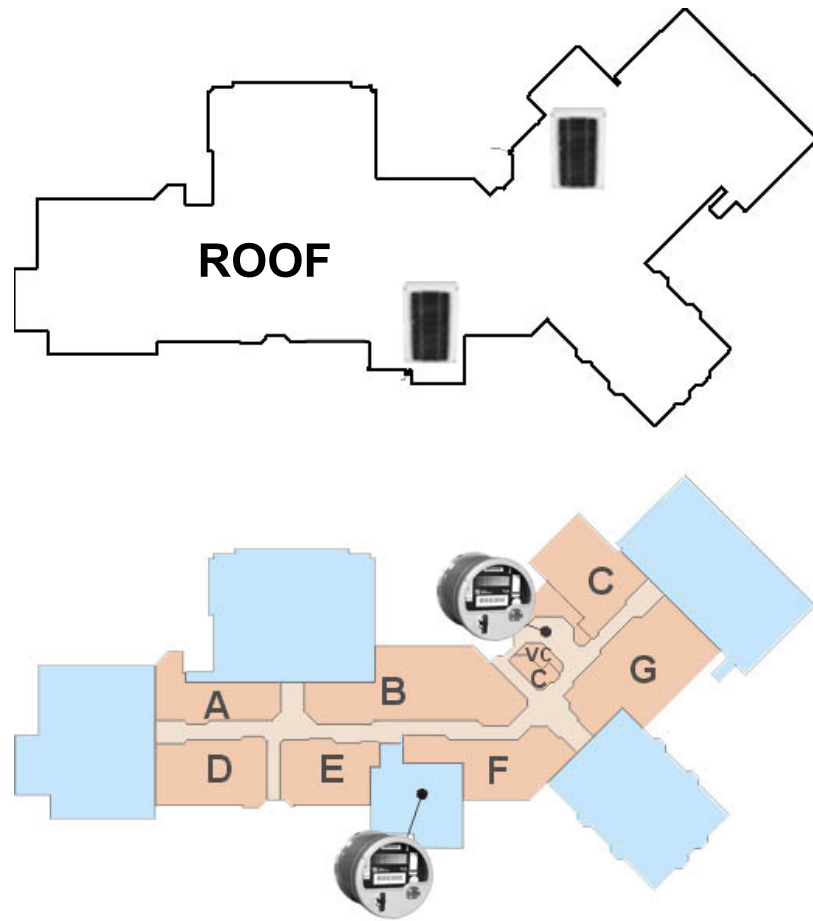

Install the ION Wireless Repeater on the roof (or similar location that is exposed to plenty of sunlight) to ensure proper operation of the solar panel recharging circuitry.

Environmental Conditions

| | |
|-----------------------|-------------------------------|
| Mounting location | Outdoor, exposed to sunlight |
| Operating temperature | 14°F to 158°F (-10°C to 70°C) |
| Relative humidity | up to 90%, non-condensing |
| Gasket rating | NEMA |

Required Tools and Materials

- ◆ Phillips screwdriver
- ◆ Fast-curing roof adhesive compound [insert recommended brand or specification here]

Before You Begin

1. Read this document in its entirety.
2. Prepare drawings or sketches to indicate locations where the wireless repeaters need to be installed.
3. Plan ahead to install the repeaters on two consecutive sunny days.
4. Coordinate the installation of the wireless repeater with the installation of the wireless gateway and the ION 6300 meters. The gateway and ION meters should be installed first so that the meter can provide communications diagnostics immediately after installation.

Getting More Information

Additional material related to the wireless repeater and other Power Measurement products are available online at www.pwrn.com. This document is also available in PDF format and can be downloaded from our website.

Mechanical Dimensions

The four corner screws on the ION Wireless Repeater secure the lid to the unit, and to the aluminum rod stand. Four square aluminum mounting brackets secure the base of the stand to the roof surface.

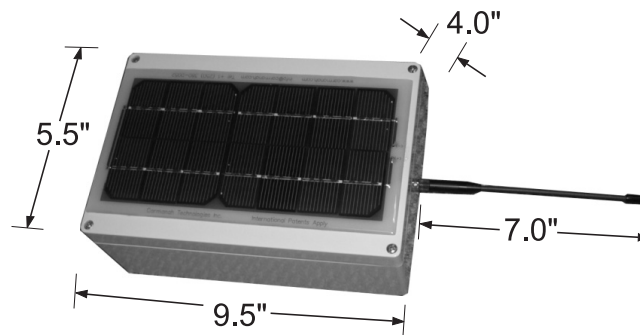

Installation

The ION Wireless Repeater is intended to be mounted on a flat roof surface. Installation of the solar repeater must be done under dry climate conditions. Make sure your wireless network (wireless gateway and devices) is operating properly before permanently securing the repeater assembly.

Step 1: Assemble the Repeater

Perform the following procedure near the ION Gateway in order to configure the A/D (analog-to-digital) circuitry that monitors the battery voltage.

1. Place the ION Wireless Repeater on a clean working surface. Apply liberal amounts of Dow Corning #4 electrical insulating compound to the threaded end of the antenna and to the threaded connector in the top of the repeater case. Screw the antenna into the connector until snug, but do not overtighten.

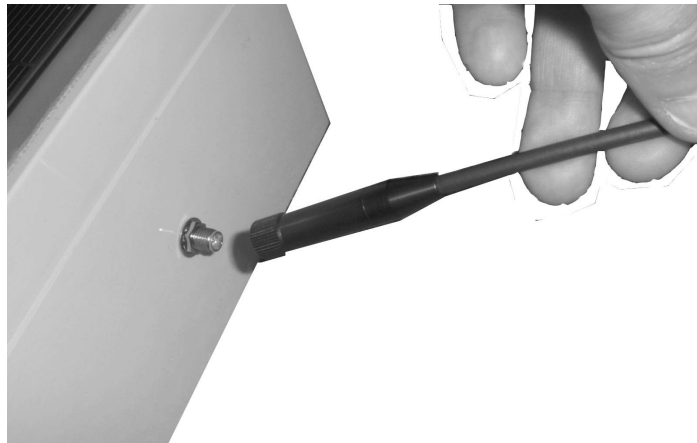

2. Remove the four screws from the front of the unit.



3. Lift the solar panel (lid), taking care not to damage the wiring. Disconnect the wire connectors that secure the wiring between the solar panel (lid) and the charging circuit board (in the chassis). Rest the lid on the ground.

4. Locate the battery power connectors (the mating connectors with three wires) inside the unit and connect them.

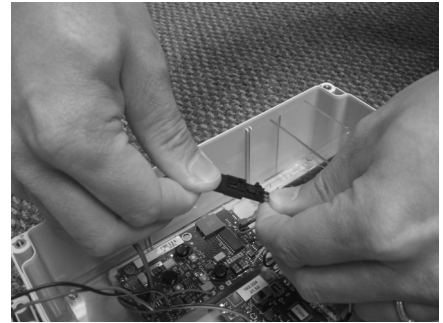
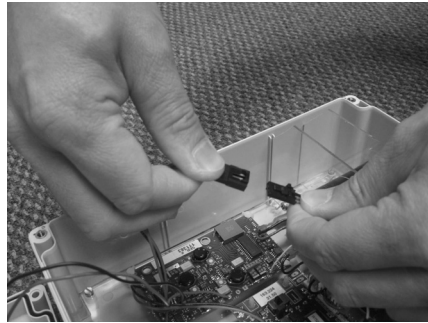

5. Observe the LEDs light up to verify the unit is receiving power from the battery pack.

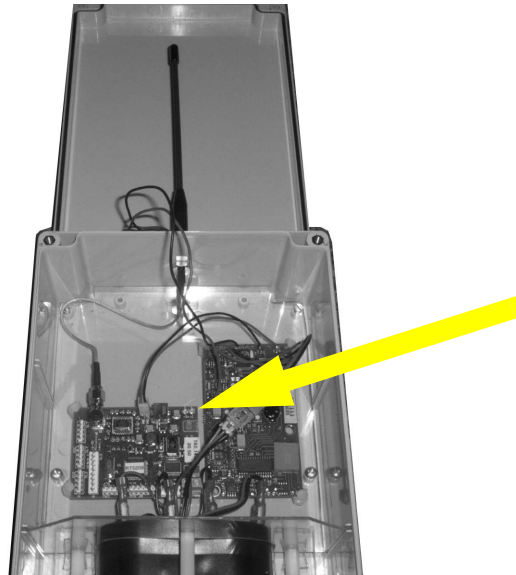

6. Place the lid back on the unit. Thread in the four screws halfway (about 1/2" of the screw remaining).
7. While holding the lid securely to the unit, flip the unit over and rest it on a clean working surface.
8. Insert one leg (aluminum rod stand) into back of unit, making sure it is oriented correctly, i.e. with the vent closest to the base of leg.

 **NOTE**

The vent (hole) indicates the bottom of the unit.

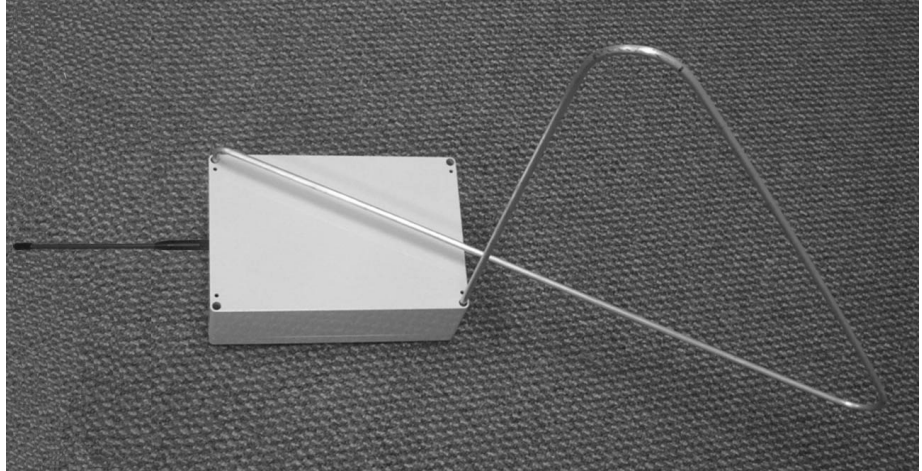

9. Insert the other leg into the back of unit.

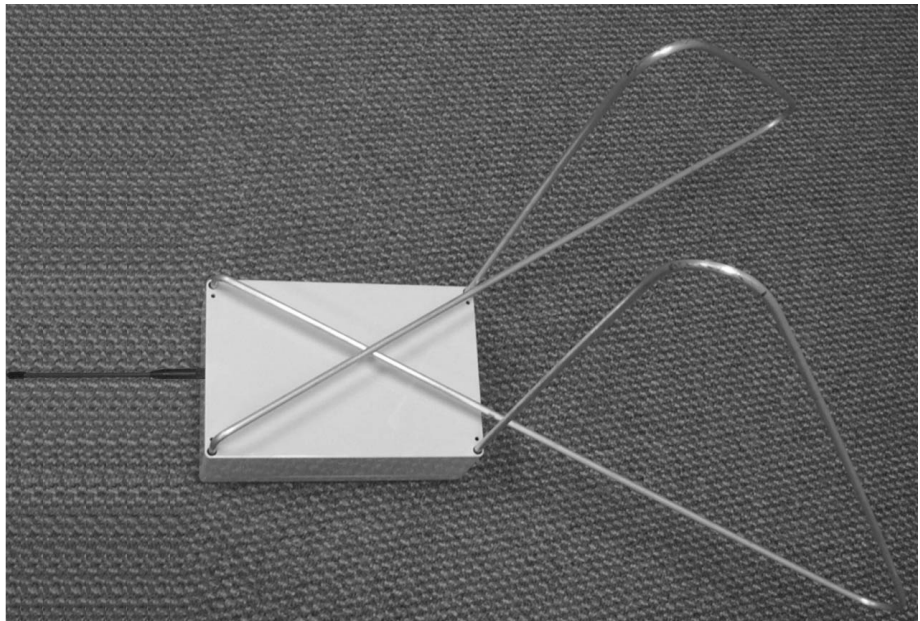

10. Holding the top (lid) securely to the unit, lift and move the entire assembly to the intended mounting location. Stand the unit up on its legs.

Step 2: Position the Repeater

Position the repeater on the roof so the solar panel faces south (i.e. towards the sun at noon).

Step 3: Verify Operation and Communications

1. Carefully remove the lid, then verify wireless communications by observing the LED behavior.

| LED Activity | Description |
|--------------------------------|--|
| Steady Red (continuously ON) | Radio is properly identified in the wireless network |
| Blinking Red (once per second) | Radio is not identified in the wireless network |
| Flashing Green | Radio is transmitting/receiving information (the Green LED flashes once per packet received) |

2. Replace the lid. Attach one of the screws to the unit, pushing the end of the legs towards the base while screwing down to secure it (do not over-tighten). Repeat with the 3 remaining screws.

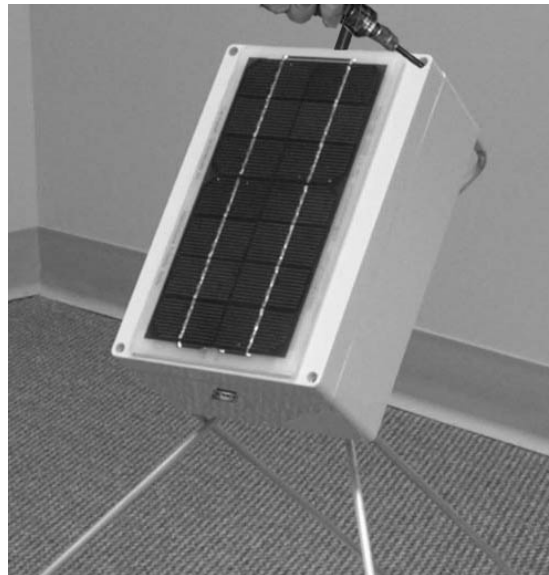

3. Temporarily secure the base of the legs to the roof. Leave the unit for a day, so it is exposed to a cycle of sunlight and darkness.

Step 4: Verify Wireless Repeater Properties

NOTE

Verification of the solar charging circuitry is performed at the factory before the repeater is shipped out.

1. The following day, use ION Enterprise to verify that the wireless repeater is still properly detected in the network. Note the repeater's location ID and radio ID on the floor plan.
2. After verifying that the unit is charging properly, replace the lid and secure with the screws.

Step 5: Install Mounting Brackets

1. Make sure the roof surface is clean of debris.
2. Apply roof adhesive compound to the underside of the square bracket.
3. Position the bracket so its flange is aligned over the base of the leg. Press down and hold for the recommended time, according to the directions on the adhesive container.

MRP: 70000-0267-00
Revision Date: Feb. 14, 2005