



USB Headset V851 / V852

Owner's Manual

Important information

Technical data

- Standard VoIP headset (Voice over Internet Protocol)
- Power supply via the USB port

System requirements

- Windows 2000 and later
- USB port
- 32 MB RAM or more
- Pentium II or higher
- Internet connection from 28 kb/s or broadband connection

1

General information

Intended use

This headset has been developed for use via a USB port on a PC.

Power failure

The headset cannot be used to make calls in the event of a power failure. Always have a standard cable-connected telephone close to hand, which can be used without connection to a PC and Internet, for emergencies.

This equipment is to be supplied from an identified USB port complying with the requirements of Limited Power Source.

Installation location

Normally, neither the cables, housing or other handset elements leave any marks on surfaces with which they make contact. However, due the diverse types of paints and surfaces which come into question, it cannot be fully ruled out that marks will be left on surfaces on which they make contact. Prevent excessive exposure to smoke, dust, vibration, chemicals, humidity, heat or direct sunlight.

Cleaning and upkeep

Clean the housing surfaces with a dry, soft, fluff-free cloth. Never use cleaning agents or aggressive solvents. Apart from occasionally cleaning the housing, no other upkeep is necessary. The cables are not resistant to all cleaning agents. Therefore, the manufacturer cannot be made liable for any damage to furniture or such.

2

Operating Elements

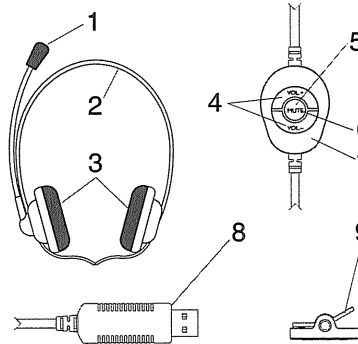

1. Microphone
2. Headband
3. Loudspeaker with earpads
4. Volume control
5. LED for muting function status
6. Muting button
7. Operating unit
8. USB plug
9. Clothes clip

3

Starting Up

Caution: It is essential to read the General Information at the beginning of this manual before starting up.

Connecting the headset to the PC

Connect the USB plug on the headset to a USB port on the PC. When the headset is connected to the PC for the first time, Windows automatically detects the new hardware and installs it. The audio output, such as music, and audio input, via the microphone for example, are thus directed to the headset. If this is not done automatically, please carry out the following steps.

Setting up



The names of the menu items and buttons may vary slightly according to the operating system being used, e.g.: *Sound and audio devices = Multimedia*. The steps for installation, however, are identical.

1. Click on the **Start** button. Select **Settings, Control Panel** and then **Sounds and Audio Devices**.
2. Click on the **Audio** tab control.
3. Select **VoIPvoice USB Phone** from the Default device pulldown menu. Complete this process for both the **Sound playback** as well as the **Sound recording**.
4. Click on the **OK** button to apply the settings and exit from the menu.



4

Functions

Muting function

To deactivate the microphone (muting), press the  button. The LED lights up. To reactivate the microphone, press the  button again. The LED goes out.

Volume control

Use the  and / or  buttons on the operating unit to adjust the volume of the caller during a call.

Note: If you have set a call to very quiet, it is possible that a subsequent caller can hardly be heard if they talk quietly. In such cases, increase the volume again.

Settings

All the necessary settings for the headset are made via the application software you are using or your operating system.

Settings via the operating system

Note: The names of the menu items and buttons may vary slightly according to the operating system being used, e.g.: *Sound and audio devices = Multimedia*. The steps for installation, however, are identical.

1. Click on the **Start** button.
2. Select **Settings, Control Panel** and then **Sounds and Audio Devices**.
3. Click on the **Volume** tab control and then on the **Advanced** button.

5

4. Complete the necessary settings regarding the receiver volume.
5. Open the **Options** menu and select **Properties**.
6. Select **Record** and click the **OK** button.
7. Complete the necessary settings regarding the microphone sensitivity.
8. Close the window, the settings are applied.

Please refer to the operating system documentation for further, more detailed information.

Deactivating the Headset

Deactivate the headset and reset the default computer settings in order, for example, to be able to listen to music via the computer's loudspeakers.

1. Open the **Start** menu.
2. Select **Settings, Control Panel** and then **Sounds and Audio Devices**.
3. Click on the **Audio** tab control.
4. Select the device to be used from the Default device pulldown menu. Complete this process for both the **Sound playback** as well as the **Sound recording**.
5. Click on the **OK** button to apply the settings and exit from the pulldown menu. The headset is now deactivated.

Troubleshooting

Should problems arise with the telephone, refer to the following information.

If no telephone call is possible, check whether the headset is connected correctly,

- the PC is switched on,
- the required application is properly installed and correctly executed,
- the provider is experiencing faults.

Establishment of a connection and possible voice delays could be caused by:

- the current PC utilisation rate,
- the type and speed of the Internet connection,
- the use of security features, such as a firewall.

In the case of technical problems with this product please contact the retailer where the product was purchased.

FCC statement

Warning: Changes or modifications to this equipment not expressly approved by the party responsible for compliance could void the user's authority to operate the equipment.

This device complies with Part 15 of the FCC Rules. Operation is subject to the following two conditions:

- (1) this device may not cause harmful interference, and
- (2) this device must accept any interference received, including interference that may cause undesired operation.

NOTE: This equipment has been tested and found to comply with the limits for a Class B digital device, pursuant to Part 15 of the FCC Rules. These limits are designed to provide reasonable protection against harmful interference in a residential installation. This equipment generates, uses and can radiate radio frequency energy and, if not installed and used in accordance with the instructions, may cause harmful interference to radio communications.

However, there is no guarantee that interference will not occur in a particular installation. If this equipment does cause harmful interference to radio or television reception, which can be determined by turning the equipment off and on, the user is encouraged to try to correct the interference by one or more of the following measures:

- Reorient or relocate the receiving antenna.

- Increase the separation between the equipment and receiver.
- Connect the equipment into an outlet on a circuit different from that to which the receiver is needed.
- Consult the dealer or an experienced radio/TV technician for help.