

## 1 Charge the headset

Using the computer | <Language 2> | <Language 3>  
<Language 4> | <Language 5> | <Language 6>  
<Language 7>

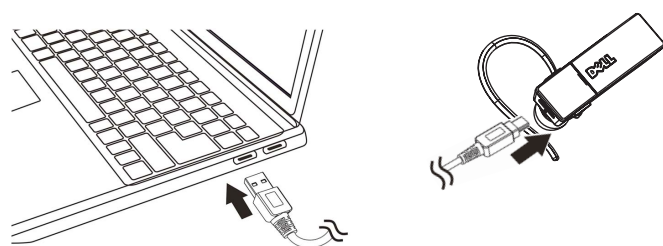

Using the CLA Adapter | <Language 2> | <Language 3>  
<Language 4> | <Language 5> | <Language 6>  
<Language 7>

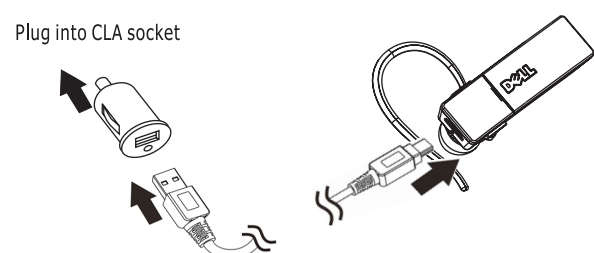

## 2 Turn on and pair the headset

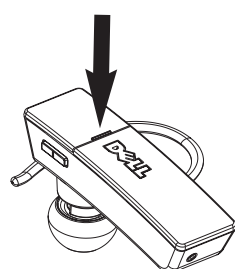

## 3 Wear the headset

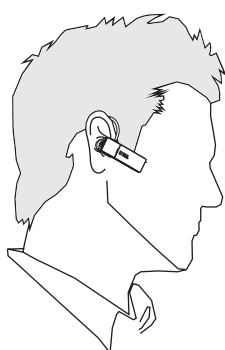

### Verify the contents of the package

- Headset
- Ear hook
- 3 Earplugs of different sizes - medium size earplug is fixed to the headset by default.
- USB charger cable
- Car charger adapter

### Functions and Controls

- |                         |                           |
|-------------------------|---------------------------|
| 1. Earplug              | 6. LED (indicator light)  |
| 2. Microphone           | 7. Ear hook               |
| 3. Volume up (V+) key   | 8. Multifunction (MF) key |
| 4. Volume down (V-) key | 9. 2nd microphone         |
| 5. Micro USB connector  |                           |

### Charging the headset

Connect the USB charger cable to the Micro USB connector on the headset. The LED on the headset lights up to indicate the charge status:

- Solid red — charging
- Blue — fully charged

### Turning on the headset

Press and hold the multifunction key for about 5 seconds. The LED light turns blue, and 4 ascending tones can be heard.

### Turning off the headset

Press and hold the multifunction key for about 5 seconds. The LED light turns red, and 4 descending tones can be heard.

### Manually pairing your headset with a Bluetooth-enabled device

1. Turn off the headset.
2. Press and hold the multifunction key for at least 5 seconds.

The blue LED light flashes rapidly, and 4 ascending tones can be heard. About 1 second later, a single high pitch tone can be heard.

Your headset is now "visible" to your Bluetooth-enabled device (e.g., mobile phone.)

3. Turn on Bluetooth on your mobile phone.
4. Set the mobile phone to search for Bluetooth devices.
5. Select the Bluetooth headset from the phone menu.
6. Enter the pin code 0000 to connect (or "pair") your headset to the phone. Two high pitch tones are heard when pairing is complete.

**NOTE:** If your phone or Bluetooth device supports Bluetooth v2.1 "Simple Pairing" function, no pin code is required.

7. If required (on certain phones), select "AY300" from the device list on your phone. The LED light flashes briefly every 5 seconds when the headset is connected to your phone.

If the headset is on but no connection is established, or a previous connection is dropped, the headset remains in connectable status (blue LED light flashes every 2.5 seconds) for 30 minutes before it automatically turns off.

Your headset can store connection information for up to 8 compatible devices.

### Make a call

1. Ensure that the headset is paired with the mobile phone.
2. Dial the phone number using the mobile phone. The LED light flashes blue during the call.

### Answer and end a phone call

To answer a call, short-press the multifunction key.

To end an active call, short press the multifunction key again.

### Reject a call

To reject a call, double-press the multifunction key.

### Mute/unmute the headset

To mute/unmute the headset during a call, briefly press the volume up key and volume down keys simultaneously, and then release them.

### Voice dialing (phone-dependent)

**NOTE:** See the documentation that came with your phone to know if it supports voice dialing.

To activate voice dialing, press the multifunction button for about 2 to 3 seconds. A single high pitch tone can be heard, indicating the activation.

To deactivate voice dialing, press the multifunction button again.

**NOTE:** Voice dialing cannot be used during an active call.

### Last number redial (phone-dependent)

**NOTE:** See the documentation that came with your phone to know if it supports last number redial.

To redial the last number, press the multifunction key twice.

**NOTE:** Last number redial cannot be used during an active call.

### Switching calls between the phone and headset

To switch an active call from your headset to the phone, press and hold the multifunction button for about 2 seconds. A short tone can be heard, indicating the call switch.

To switch the call back to your headset, press and hold the multifunction button for about 2 seconds. A short tone can be heard, indicating the call switch.

### Reconnecting the paired headset to a compatible phone

1. Turn on your headset.
2. Ensure that Bluetooth is active on your phone.
3. The phone should connect to the headset automatically. If not, pair the headset and phone (see "Manually Pairing Your Headset with a Bluetooth Enabled Device").

If the headset is turned on with no existing pairing information (e.g., first time use or after pairing information is erased), it enters pairing mode automatically.

### Multilink function

The Multilink function enables you to connect the headset simultaneously with multiple Bluetooth enabled devices.

By default, the Multilink function is disabled.

### Turn on/off Multilink function

Turn on Multilink: press the multifunction and volume up keys simultaneously for about 2 seconds. A tone can be heard from earpiece and LED will be steadily lit in blue for 1.5 seconds.

Turn off Multilink: press multifunction and volume up keys simultaneously for about 2 seconds. A tone can be heard from earpiece and LED will be steadily lit in red for 1.5 seconds.

### Operation in Multilink scenario

Your headset can connect with two mobile phones at the same time, but only one call can be taken at a time.

To Multilink two phones with your headset:

1. Pair the headset and phone A.
2. Turn off your headset.
3. Pair the headset with phone B
4. Perform one of the following steps:
  - Connect the headset with phone A, using phone A's menu.
  - Turn off and then turn on the headset. The headset connects to phone A and phone B automatically.

When taking a call from phone A, the connection with phone B will be dropped. The connection with phone B is resumed after the call with phone A is terminated.

Function	Tone	Indication light	Key press duration
Power on	4 ascending tones	Blue for 1 second	MF for 5 seconds
Power off	4 descending tones	Red for 1 second	MF for 5 seconds
Pairing complete	-	Blue every 5 sec	-
Turn on multilink	Two short tones	Blue for 1.5 second	MF & V+ for 3 seconds
Turn off multilink	Two short tones	Red for 1.5 second	MF & V- for 3 seconds
Voice dial	Short tone	-	MF for 2 seconds
Redial	Two short tones	-	Double-press MF briefly
Answer call	Short tone	Blue for 1 second	Press MF briefly
Reject call	Short dual tones	Blue for 1 second	Double-press MF briefly
Mute/unMute	Two short tones	Red every 5 sec	V+ & V- briefly
Switch call	Long tone	Blue for 1 second	MF for 2 seconds

### Troubleshooting

For more information about your headset and troubleshooting steps, go to the Dell Support website at [support.dell.com](http://support.dell.com).

<Language 2>

<Language 2>

Die-cut  
Fold line

Manual size: 420\*432mm