

FCC Statement

This equipment has been tested and found to comply with the limits for a Class B digital device, pursuant to Part 15 of the FCC Rules. These limits are designed to provide reasonable protection against harmful interference in a residential installation. This equipment generates uses and can radiate radio frequency energy and, if not installed and used in accordance with the instructions, may cause harmful interference to radio communications. However, there is no guarantee that interference will not occur in a particular installation. If this equipment does cause harmful interference to radio or television reception, which can be determined by turning the equipment off and on, the user is encouraged to try to correct the interference by one of the following measures:

- Reorient or relocate the receiving antenna.
- Increase the separation between the equipment and receiver.
- Connect the equipment into an outlet on a circuit different from that to which the receiver is connected.
- Consult the dealer or an experienced radio/TV technician for help.

FCC Caution: Any changes or modifications not expressly approved by the party responsible for compliance could void the user's authority to operate this equipment.

IMPORTANT NOTE: FCC Radiation Exposure Statement:

This equipment complies with FCC radiation exposure limits set forth for an uncontrolled environment. This equipment should be installed and operated with minimum distance 20cm between the radiator & your body.

This transmitter must not be co-located or operating in conjunction with any other antenna or transmitter.

This device complies with Part 15 of the FCC Rules. Operation is subject to the following two conditions: (1) This device may not cause harmful interference, and (2) this device must accept any interference received, including interference that may cause undesired operation.



Designed by Icon 7 Inc.
Made in China

Sentido™ WIRELESS Laser Desktop Combo

QUICK GUIDE

1 Insert keyboard/ mouse batteries

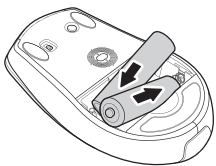
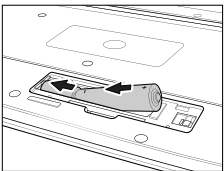

3 Install the driver



2 Connect the keyboard and the mouse to the computer

- 2-1 Insert the receiver
 - 2-2 Turn on the computer
 - 2-3 Turn on the mouse
- * The keyboard will connect automatically

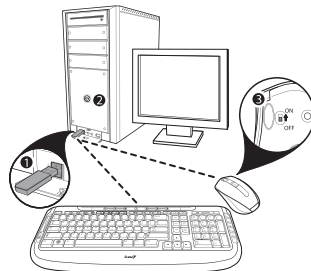

• Functions



- | | | | |
|----------------------------|-----------------------------|--------------------|----------------------------|
| 1. Internet Quick Tab View | 6. Battery Check | 11. Stop | 16. Windows® Vista™ Start |
| 2. Flip 3D | 7. Battery Status Indicator | 12. Previous Track | 17. Enhanced Function Keys |
| 3. Gadget | 8. Sleep | 13. Next Track | 18. 4-way Scrolling |
| 4. iConfig™ | 9. My Music | 14. Volume Control | 19. FastFind™ |
| 5. Hotline1, 2, 3 | 10. Play / Pause | 15. Mute | |

• Indicators

Keyboard

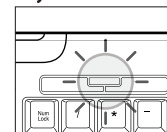

- Green = GOOD battery power
- Green, Blinking = FAIR battery power
- Orange, Blinking = LOW battery power

Mouse

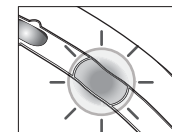

- Orange = GOOD battery power
- Orange, Blinking slowly = FAIR battery power
- Orange, Blinking rapidly = LOW battery power