



Submittal Data Information

101-035

Model 0012 Cartridge Circulator

Effective: June 15, 2010

Supersedes: November 20, 2008

Job: _____ Engineer: _____ Contractor: _____ Rep: _____

ITEM NO.	MODEL NO.	IMP. DIA.	G.P.M.	HEAD/FT.	H.P.	ELEC. CHAR.

Features

- Exclusive ACB Anti-Condensate Baffle with Ambient Air Flow-Protects Motor Windings against Condensate Buildup
- High Velocity Performance-Compact Design
- Quiet, Efficient Operation
- Direct Drive-Low Power Consumption
- Unique Replaceable Cartridge Design-Field Serviceable
- Self Lubricating
- No Mechanical Seal
- Unmatched Reliability-Maintenance Free
- Universal Flange to Flange dimensions
- Cast Iron, low lead Bronze or Stainless Steel Construction

Materials of Construction

- Casing (Volute): Cast Iron, low lead Bronze or Stainless Steel
- Stator Housing: Aluminum
- Cartridge: Stainless Steel
- Impeller: Non-Metallic
- Shaft: Ceramic
- Bearings: Carbon
- O-Ring & Gaskets: EPDM

Model Nomenclature

- F – Cast Iron, Flanged
- BF – Bronze, Flanged
- SF – Stainless Steel, Flanged

Variations:

- Z – Zoning Circulator
- J – Bronze Cartridge with Cast Iron Casing

Performance Data

- Flow Range: 0 – 52 GPM
- Head Range: 0 – 14.5 Feet
- Minimum Fluid Temperature: 40°F (4°C)
- Maximum Fluid Temperature: 230°F (110°C)
- Maximum Working Pressure: 125 psi
- Connection Sizes: 1-1/4", 1-1/2" or 2" Flanged



Application

The Taco 0012 is specifically designed for high flow / medium head applications in large residential and light commercial systems. Ideal for large BTUH Boilers, 2" recirculation loops, Primary/Secondary loops, commercial water heaters and light commercial heating and cooling systems. The Bronze or Stainless Steel 0012 can be used on open loop systems. The unique replaceable cartridge contains all of the moving parts and allows for easy service instead of replacing the entire circulator. Universal flange to flange dimensions and orientation allows the 0012 to easily replace other models. Compact, low power consumption design makes it ideal for high-efficiency jobs. The 0012-F4 is a direct replacement for the HV Series and the 0012-F4-1 is a direct replacement for the 2" Series using existing flanges.

Pump Dimensions & Weights • Flanges included.

Model	Flange	Casing	A		B		C		D		F		G		Ship Wt.	
			in.	mm	in.	mm	in.	mm	in.	mm	in.	mm	in.	mm	lbs.	Kg
0012-F4	1-1/2"	Cast Iron	8-5/8	219	6-3/8	162	4-1/4	108	3-5/16	84	5-1/2	140	8-1/2	216	13.0	5.9
0012-SF4	1-1/2"	St. Steel	8-5/8	219	6-3/8	162	4-1/4	108	3-5/16	84	5-1/2	140	8-1/2	216	13.0	5.9
0012-F4-1	2	Cast Iron	9	229	6-3/8	162	4-1/4	108	3-5/16	84	5-1/2	140	8-1/2	216	13.0	5.9
0012-BF4-1	2	Bronze	9	229	6-3/8	162	4-1/4	108	3-5/16	84	5-1/2	140	8-1/2	216	13.0	5.9

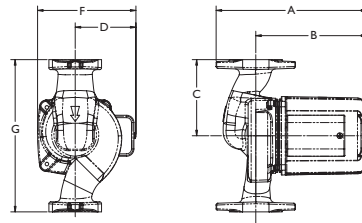

Mounting Positions

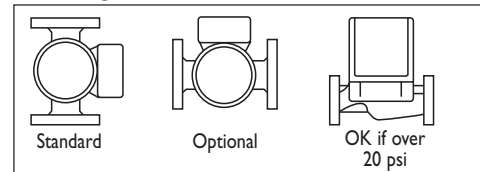

Electrical Data

Model	Volts	Hz	Ph	Amps	RPM	HP
All Models	115	60	1	1.33	3250	1/8
Motor Type	Permanent Split Capacitor Impedance Protected					
Motor Options	220/50/1, 220/60/1, 230/60/1, 100/110/50/60/1					

Flange Orientation

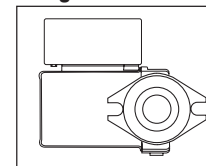

Performance Field – 60Hz

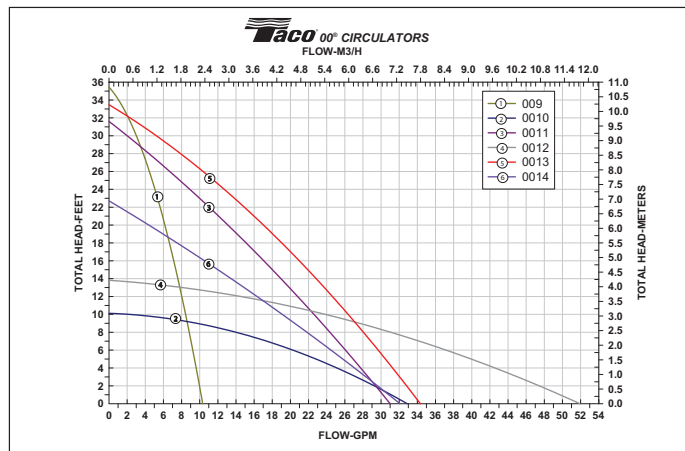

NSF® ≤ .25% Lead
Complies with California
Health and Safety
Code Section
116875 / AB1953
and Vermont Act 193

Do it Once. Do it Right.®

TACO INC., 1160 Cranston Street, Cranston, RI 02920 Telephone: (401) 942-8000 Fax: 942-2360
TACO (Canada), Ltd., 6180 Ordan Drive, Mississauga, Ontario L5T 2B3 Telephone: (905) 564-9422 Fax: (905) 564-9436
Visit our website at: www.taco-hvac.com

Printed in USA
Copyright 2010
TACO, Inc.