



Submittal Data Information

101-099

Model 009-IFC® Cartridge Circulator

Effective: February 10, 2009

Supersedes: June 1, 2004

Job: _____ Engineer: _____ Contractor: _____ Rep: _____

ITEM NO.	MODEL NO.	IMP. DIA.	G.P.M.	HEAD/FT.	H.P.	ELEC. CHAR.

Features

- Integral Flow Check (IFC®)
 - Prevents gravity flow
 - Eliminates separate in-line flow check
 - Reduces installed cost, easy to service
 - Improved performance vs. In-line flow checks
- Optional Priority Zoning control
- Unique replaceable cartridge-Field serviceable
- Unmatched reliability-Maintenance free
- Quiet, efficient operation
- Direct drive - Low power consumption
- Self lubricating, No mechanical seal
- Standard high capacity output - Compact design
- Wide range of applications
- Cast Iron or Stainless Steel construction, Flanged connections

Application

The Taco 009-IFC with Integral Flow Check (IFC®) is designed to reduce installation costs when zoning with 00® circulators on a wide range of residential and light commercial higher-head/lower-flow water circulating applications. Typical uses include hydronic heating, radiant in-floor/panel heating and closed-loop solar heating systems. The Stainless Steel 009-IFC can be used in higher-head/lower-flow heat recovery, open-loop solar heating and light commercial domestic water recirculation systems. The unique replaceable cartridge contains all of the moving parts and allows for easy service instead of replacing the entire circulator. Available with optional Priority Zoning controls.

Pump Dimensions & Weights

Model	Casing	A		B		C		D		F		G		Ship Wt.	
		in.	mm	in.	mm	in.	mm	in.	mm	in.	mm	in.	mm	lbs.	Kg
009-F5-IFC	Cast Iron	7	178	5-11/16	144	3-3/16	81	3-3/8	86	5-1/2	140	6-3/8	162	9.5	4.3
009-SF5-IFC	St. Steel	7	178	5-11/16	144	3-3/16	81	3-3/8	86	5-1/2	140	6-3/8	162	9.5	4.3
009-ZF5-I IFC	Cast Iron	7	178	5-11/16	144	3-3/16	81	3-13/16	97	6	153	6-3/8	162	10.5	4.7
009-ZSF5-IFC	St. Steel	7	178	5-11/16	144	3-3/16	81	3-13/16	97	6	153	6-3/8	162	10.5	4.7

Materials of Construction

- Casing (Volute): Cast Iron or Stainless Steel
 Integral Flow Check:
 Body, Plunger...Acetal
 O-ring Seals.....EPDM
 Spring.....Stainless Steel
- Stator Housing: Aluminum
 Cartridge: Stainless Steel
 Impeller: Non-Metallic
 Shaft: Ceramic
 Bearings: Carbon
 O-Ring & Gaskets: EPDM

Model Nomenclature

- F – Cast Iron, Flanged
 SF – Stainless Steel, Flanged
 IFC – Integral Flow Check
Variations:
 Z – Zoning circulator
 J – Bronze cartridge with Cast Iron casing

Performance Data

- Flow Range: 0 – 10 GPM
 Head Range: 0 – 35 Feet
 Minimum Fluid Temperature: 40°F (4°C)
 Maximum Fluid Temperature: 230°F (110°C)
 Maximum Working Pressure: 125 psi
 Connection Sizes: 3/4", 1", 1-1/4", 1-1/2" Flanged



FOR INDOOR USE ONLY

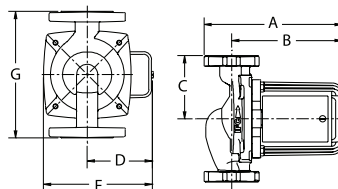

Mounting Positions

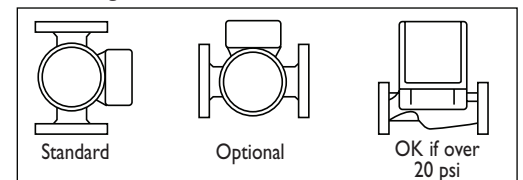

Electrical Data

Model	Volts	Hz	Ph	Amps	RPM	HP
009-F5-IFC	115	60	1	1.40	3250	1/8
009-SF5-IFC	115	60	1	1.40	3250	1/8
Motor Type	Permanent Split Capacitor Impedance Protected					
Motor Options	220/50/1, 220/60/1, 230/60/1, 100/110/50/60/1					

Flange Orientation

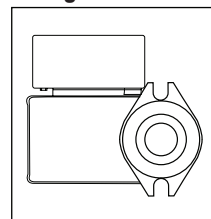

Performance Field - 60Hz

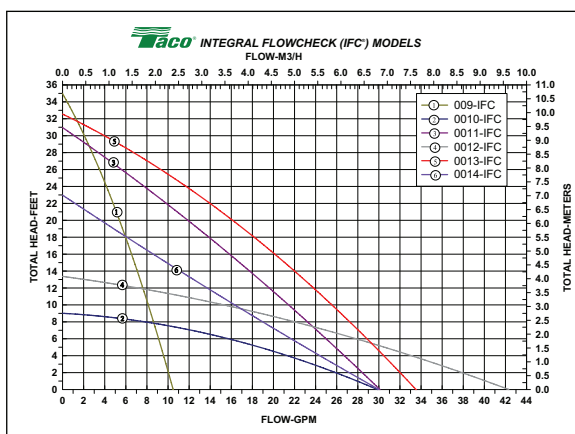

Do it Once. Do it Right.®

TACO INC., 1160 Cranston Street, Cranston, RI 02920 Telephone: (401) 942-8000 Fax: 942-2360
 TACO (Canada), Ltd., 6180 Ordan Drive, Mississauga, Ontario L5T 2B3 Telephone: (905) 564-9422 Fax: (905) 564-9436
 Visit our website at: www.taco-hvac.com

Printed in USA
 Copyright 2009
 TACO, Inc.