

FLAPPER CHECK VALVE

1-1/4" & 1-1/2"

Accessories

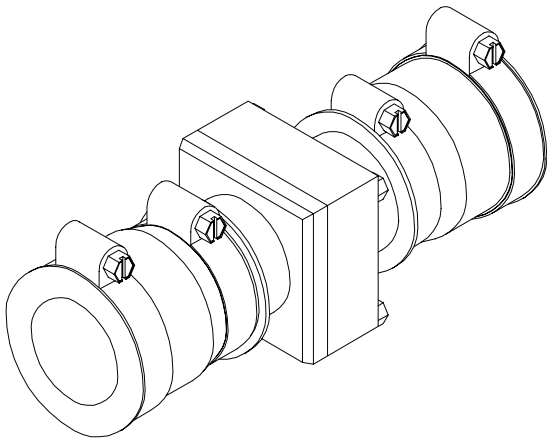

P/N: 1067

The flapper check valve is used for preventing backflow of materials in waste water lines, sump pump disposal lines, sewage lift stations or ejector systems. Also used where minimum head loss or flow resistance is required, or in swimming pools, hot tubs, or spa applications.

FEATURES:

- Full flow port design.
- Angle seat for hinge flapper to eliminate chatter.
- Strong ABS body construction.
- Solid lifetime self cleaning flapper with ball type hinge.
- Encased gasket between bodies eliminates all chances of leakage.
- 4 Stainless steel clamps.
- Adjustable Hose Fits 1-1/4" IPS, 1-1/2" copper or 1-1/2" IPS.

PART NO.	SIZE "A"	SIZE "B"	C
1067	1-1/4" & 1-1/2" (32 & 38)	1-1/4" & 1-1/2" (32 & 38)	7.30 (185)

inches
(mm)

