

USER MANUAL



Waterproof Light speaker

Please read this user manual carefully before using the device.

Packing List



Speaker*1 Manual*1 USB cable*1 Hanging buckle*1

Specifications:

Product Name: waterproof light speaker
 Charging Input:DC5V=1A
 Battery:3.7V
 Charging Time: 2.5-4 hours
 Frequency Range:50Hz-20KHz
 Distortion:>0.5% SNR: ≥65dB
 Speaker specification:Φ52x28mm
 Speaker Unit:4Ω3W
 Bluetooth Protocol:A2DP1.2
 Bluetooth Frequency: 2.4GHz-2.8GHz
 Bluetooth Version:V4.2
 Lighting Power: 2.4W
 Bluetooth Distance: 10 Meter
 Material: ABS+PC. PP. Metal mesh
 Products Size:114x105x46mm

Button explanation:

⏻/M	Power on/off and mode button Long press three seconds for Power on/off Short press for mode switch button
▶	Play/Pause. Answer or end the calling. Radio automatically search.
◀◀	Previous song/Previous stations/Volume down
▶▶+	Next song/Next stations/Volume up
RESET	Reset Button

Key function indication

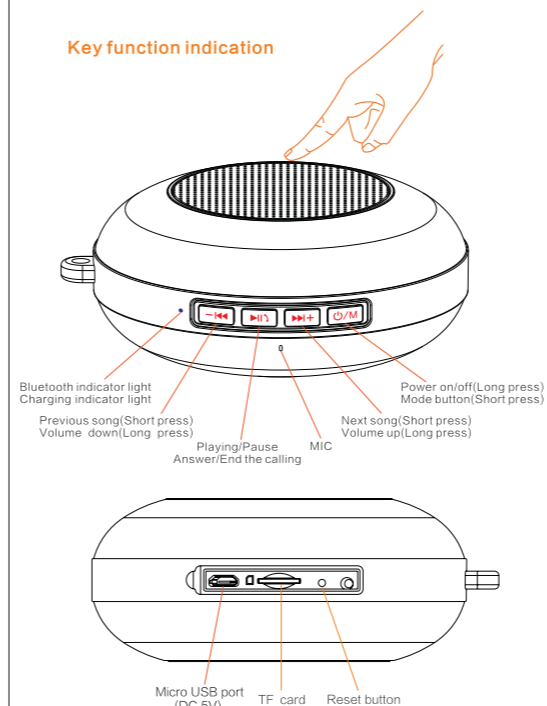

Charging

Please make sure the unit is fully charged before using for the first time. Charge the speaker using the provided USB cable by connecting it to any computer or 5V cell phone charger. The charging LED indicator will remain red while charging and will turn off once the unit is fully charged. Charging time is approximately 4 hours.

Power ON/OFF

Long press the button "⏻/M", the device will be power on. Then long press the button "⏻/M" again, the device will be power off.

Reset button

When there is no reaction of the key operation such as lamp or bluetooth play, press the "RESET" on the side with a small sharp needle to release. Restart the system and resume normal operation.

Lamp mode

Open the table lamp with the touch of your finger on the metal panel when the device is open, there are 3 level light, micro, medium, high bright and SOS distress signal lamp, off the light. The brightness will rotate until to off by simply touching the metal panel. Long touch the panel will convert between the table lamp and Color lighting, the color lighting will be orange red, dark blue, green, pink, light blue, color breathing light, music rhythm light (the light will dance with the music when playing music) in order with the touch of your finger when in the color light mode.

SOS Distress signal light

When the sos distress signal light is needed in emergency, pls press the metal panel under the warm light mode until 3 long 2 short alternating flashing lights.

Mode switch

When power on, the default is bluetooth mode. Click the mode key "⏻/M" to turn into bluetooth mode, FM mode, TF mode and Light mode. When insert TF card, it will automatically switch to TF mode in any mode.

Bluetooth

When the X1 is turned on, it automatically enters Bluetooth mode. If the unit has been previously paired, it will automatically connect to that device. If no device has been paired, upon being powered on, the unit will enter pairing mode. The blue indicator LED will flash and you will hear voice prompts. You may only connect one device at a time. To connect a different device, be sure to turn off Bluetooth mode on the currently connected device and follow the corresponding steps below.

Mobile Device Pairing:

To connect your mobile device (phone, tablet, MP3 player) enter the Bluetooth settings and search for nearby Bluetooth devices. When you see X1 in the list of available devices, select it. If your device requires a password, enter 0000. Once successfully paired, the blue indicator LED will stop flashing and remain solid blue.

Connecting To Computer:

Connecting to a desktop computer or laptop is easy. First make sure that the Bluetooth function is on by entering your computers Bluetooth settings and turning it on. While in the Bluetooth menu find the device name X1 and select it. Your computer should pair with the X1. Once successfully paired, the blue indicator LED will stop flashing and remain solid blue.

Bluetooth connection notification:

- If the speaker has been connected with Bluetooth devices before, it will connect with the last Bluetooth device automatically once it is turned on.
- Other phones or tablets can not be connected with the Bluetooth speaker when the speaker is being connected with a phone or tablet.
- The phone or tablet can not be connected with the Bluetooth speaker if it is connected with other Bluetooth devices. You should turn off your Bluetooth connection and connect your phone with the Bluetooth speaker.

Bluetooth music playing

Open the player device when the connection is successful. Click to play music, and the Bluetooth speaker will play the music. You can operate the connected player to control play, pause, volume up and down. Previous song/next song.

Bluetooth hands free call

Answer and hang up the phone. There will be an alert sound from the speaker when there is a phone call. Touch the top panel or press "▶||" to answer and end the phone.

FM Mode

Press the mode switch button "⏻/M" switch to FM mode, press the button "▶||" to search for stations automatically, do not press any button during the search, the stations will be automatically numbered saved, click "◀◀" "▶▶+" to select the desired station to listen radio. Operations are as follows: Press "▶||" to search for stations. Short press "◀◀" for previous stations, long press for volume down. Short press "▶▶+" for next stations, long press for volume up.

TF Card mode

Press the mode switch button "⏻/M" switch to TF card mode, or insert TF card, Bluetooth speaker will be automatically enter into TF card mode. You could play the music from the TF card, it support MP3, WMA format. You can handle the buttons to control the player when playing the music. Operations are as below: Press "▶||" to play/pause. Short press "◀◀" for previous song, long press for volume down. Short press "▶▶+" for next song, long press for volume up.

Frequently Asked Questions

Unsuccessful pairing and connection repeatedly

- Check the speaker and make sure it is in the searching state or reboot the speaker.
- Connection is difficult when there are too many Bluetooth devices nearby. Turn off other Bluetooth devices.
- Turn off the Bluetooth device that was connected with the Bluetooth speaker last time, and reconnect the speaker.

Muted or distorted sound

- Check the volume of your phone or the speaker, and adjust the volume.
- The battery is low. Please charge it.

Choppy music play

- Check if the device is beyond the effective connection distance.
- Check if there is any obstacle between the speaker and your device.

The indicator not shining in Bluetooth mode

- The battery is low. Please charge it.
- Please reboot the speaker.

Precautions

- Please store and use the product in room temperature environment.
- Do not expose this product in rain or wet conditions.
- Do not drop or bump this product.
- Do not disassemble, repair, or modify the product in private.
- Please use the power charge with rated voltage for the speaker.
- It may cause hearing damage if playing music in high volume for a long time. Avoiding excessively high volume when playing music for a long time.
- Disassemble this product will invalidate the warranty.

Federal Communications Commission (FCC) Statement

This device complies with part 15 of the FCC Rules. Operation is subject to the following two conditions: (1) This device may not cause harmful interference, and (2) this device must accept any interference received, including interference that may cause undesired operation.

Note: This equipment has been tested and found to comply with the limits for a Class B digital device, pursuant to part 15 of the FCC Rules. These limits are designed to provide reasonable protection against harmful interference in a residential installation. This equipment generates, uses and can radiate radio frequency energy and, if not installed and used in accordance with the instructions, may cause harmful interference to radio communications. However, there is no guarantee that interference will not occur in a particular installation. If this equipment does cause harmful interference to radio or television reception, which can be determined by turning the equipment off and on, the user is encouraged to try to correct the interference by one or more of the following measures:

- Reorient or relocate the receiving antenna.
- Increase the separation between the equipment and receiver.
- Connect the equipment into an outlet on a circuit different from that to which the receiver is connected.
- Consult the dealer or an experienced radio/TV technician for help.

Warning: Changes or modifications made to this device not expressly approved by Shenzhen Pythagorean Smart Technology Co., Ltd may void the FCC authorization to operate this device.

Note: The manufacturer is not responsible for any radio or TV interference caused by unauthorized modifications to this equipment. Such modifications could void the user's authority to operate the equipment.