

## D CARE AND WARNING

**WARNING:** Changes or modifications to this unit not expressly approved by the party responsible for compliance could void the user's authority to operate the equipment.

**NOTE:** This equipment has been tested and found to comply with the limits for a Class B digital device, pursuant to Part 15 of the FCC Rules. These limits are designed to provide reasonable protection against harmful interference in a residential installation. This equipment generates, uses and can radiate radio frequency energy and, if not installed and used in accordance with the instructions, may cause harmful interference to radio communications.

However, there is no guarantee that interference will not occur in a particular installation. If this equipment does cause harmful interference to radio or television reception, which can be determined by turning the equipment off and on, the user is encouraged to try to correct the interference by one or more of the following measures:

- Reorient or relocate the receiving antenna.
- Increase the separation between the equipment and receiver.
- Connect the equipment into an outlet on a circuit different from that to which the receiver is connected.
- Consult the dealer or an experienced radio/panel PC technician for help.

This device complies with Part 15 of the FCC Rules. Operation is subject to the following two conditions:

- (1) this device may not cause harmful interference, and
- (2) this device must accept any interference received, including interference that may cause undesired operation.

 Correct Disposal of this product. This marking indicates that this product should not be disposed with other household wastes throughout the EU. To prevent possible harm to the environment or human health from uncontrolled waste disposal, recycle it responsibly to promote the sustainable reuse of material resources. To return your used device, please use the return and collection systems or contact the retailer where the product was purchased. They can take this product for environmental safe recycling.

" FCC & CE RF Radiation Exposure Statement Caution: To maintain compliance with the FCC & CE's RF exposure guidelines, place the product at least 20cm from near by persons. "

Adaptor with ferrite must be used with this equipment to ensure compliance with the Class B FCC limits.

Power Adapter information:

Model No.: KSASB0241200150D5

INPUT: 100-240V~50/60Hz 0.6A

OUTPUT: 12V  $\overline{=}$  1.5A

Qbic Technology Co.,Ltd.  
11F.-9.No.99.Sec.1, Xintai 5th Rd., Xizhi Dist., New Taipei City 221, Taiwan(R.O.C)  
Tel: 886-2-2697-2000 FAX: 886-2-2697-2868

# Quick Start Guide

This quick guide will help you go through installation quickly

## Box PC BXP series

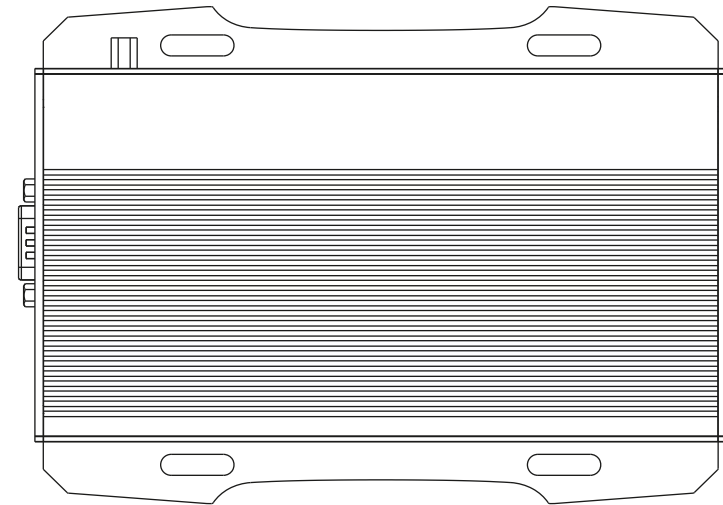

The colour and the appearance may differ depending on the product, and the specifications are subject to change without prior notice to improve the performance.

## A Contents

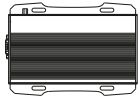

Box PC

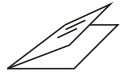

Quick Start Guide



DC Power Adapter

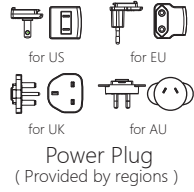

Power Plug  
( Provided by regions )



HDMI Cable  
(BXP-300 with 1pcs  
BXP-301&202 with 2pcs)



Velcro Strip

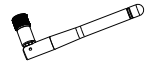

External Antenna

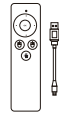

Air Mouse  
(Optional)

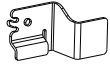

DC & Micro SD  
Card Cover

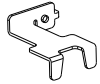

HDMI Cover  
( BXP-300 with 1pcs  
BXP-301&202 with 2pcs)



Setscrew M2  
( BXP-300 with 2pcs  
BXP-301&202 with 3pcs)

## B Indication

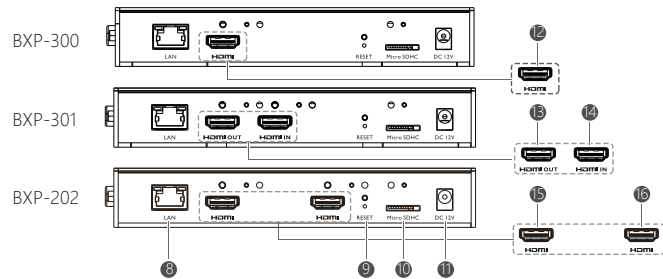
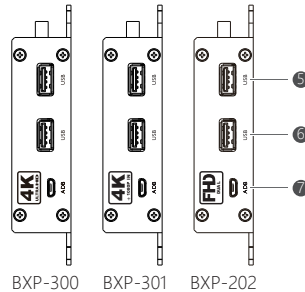
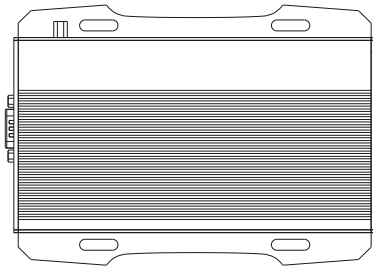
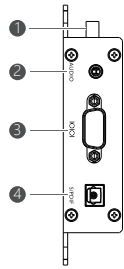

- ① WiFi Antenna
- ② Audio Out
- ③ RS-232(Male)
- ④ S/PDIF
- ⑤ USB
- ⑥ USB
- ⑦ ADB
- ⑧ LAN
- ⑨ Reset
- ⑩ Micro SDHC
- ⑪ DC 12V
- ⑫ HDMI OUT
- ⑬ HDMI OUT
- ⑭ HDMI IN
- ⑮ HDMI OUT
- ⑯ HDMI OUT

## C Installation

### 1. Cables Connection

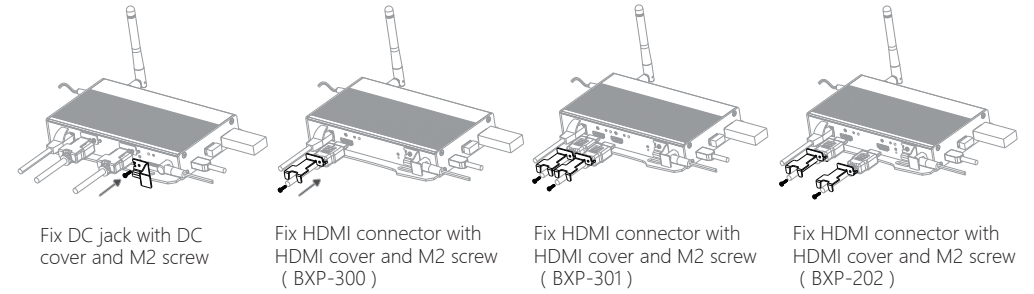
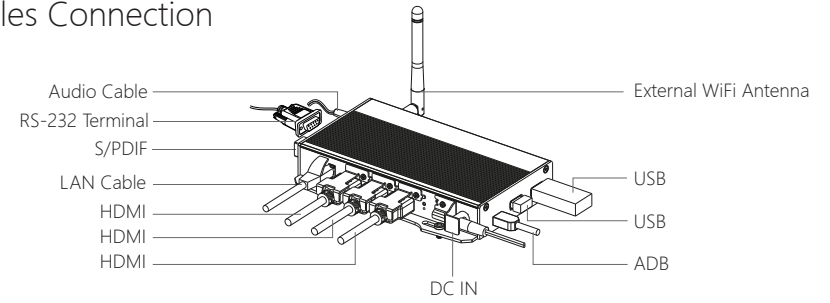

### 2. Surface Mount

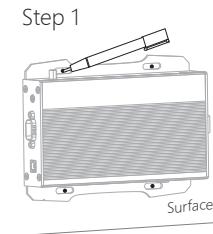

Mark the screw hole location on the surface



Fix Box PC with screws

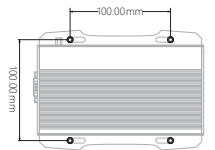

\* Recommend to mount Box PC with four M4 screws according to the above illustration.

### 3. Velcro Mount

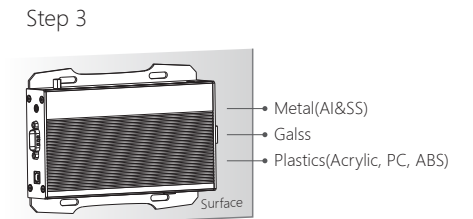
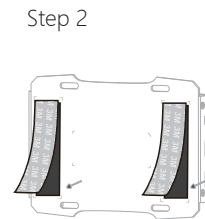
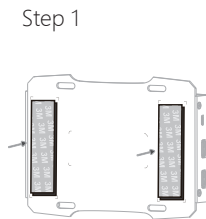

\* Please ensure the mounting surface is clean and smooth before using the Velcro strip.